



FM0205PC BBC low mount alternator Bracket

Tools Required:

- | | |
|----------------------|------------------------------------|
| 1/4" Allen Wrench | 9/16" Open End Wrench |
| 5/16" Allen wrench | Anti-Seize |
| 3/8" Allen Wrench | 7/16-14 Thread Chaser if necessary |
| 1/2" Open End Wrench | |

We recommend applying Anti-Seize to all threads when assembling bracket.

1) Disconnect Battery

2) Clean and prep engine block for installation. Inspect threads in engine block, Run a 7/16" thread chaser if necessary. Thread chasers are available at your local auto parts store or tool dealer and are different from a thread cutting tap.

3) Loosely assemble alternator bracket by inserting the (2) 7/16-14 x 3-1/4" socket head cap screws through the two middle holes on the front bracket. Place (2) 1-7/8" spacers on both bolts. Thread completed assembly through rear bracket two middle holes and into engine block. Do not tighten at this time

4) Thread the (1) 3/8-16 x 3" socket head cap screw through the top hole in front bracket and place in order (1) 1-3/32" spacer, turnbuckle assembly then 5/16" spacer. Finish by threading into rear bracket and finger tighten.

5) Attach small aluminum ear bracket to back of alternator mount boss with (1) 5/16-18 x 7/8" socket head cap screw and tighten (26 ft/lb)

6) Place alternator between front and rear brackets, thread (1) 3/8-16 x 2-3/4" socket head cap screw through bottom hole on front bracket, through alternator boss and into rear bracket. Finger tighten.

7) Swing alternator up to meet turnbuckle assembly and match up holes to aluminum ear bracket and thread (1) 3/8-16 x 1" socket head cap screw through turnbuckle and into aluminum ear bracket and tighten (46 ft/lb)

8) Tighten the (2) 7/16-14 x 3-1/4" socket head cap screws into engine block at this time. (46 ft/lb) Also tighten the (1) 3/8-16 x 3" socket head cap screw at the top of the bracket. (46 ft/lb)

9) Route V-Belt over water pump pulley, crank pulley and alternator pulley. Turn turnbuckle until proper belt tension is achieved. Tighten jam nuts on turn buckle. Tighten alternator 3/8-16 x 2-3/4" socket head cap screw on bottom of bracket at this time. (46 ft/lb) Re-check belt tension.

10) Reconnect electrical and test run motor. Re-check belt tension after 100 miles.

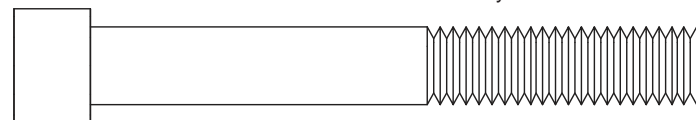
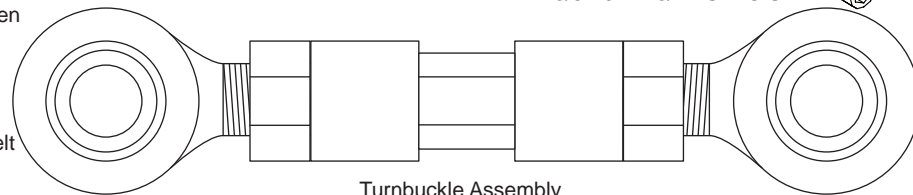
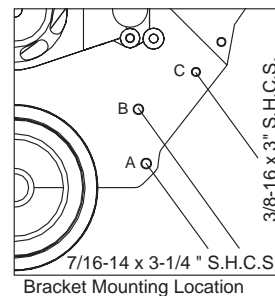
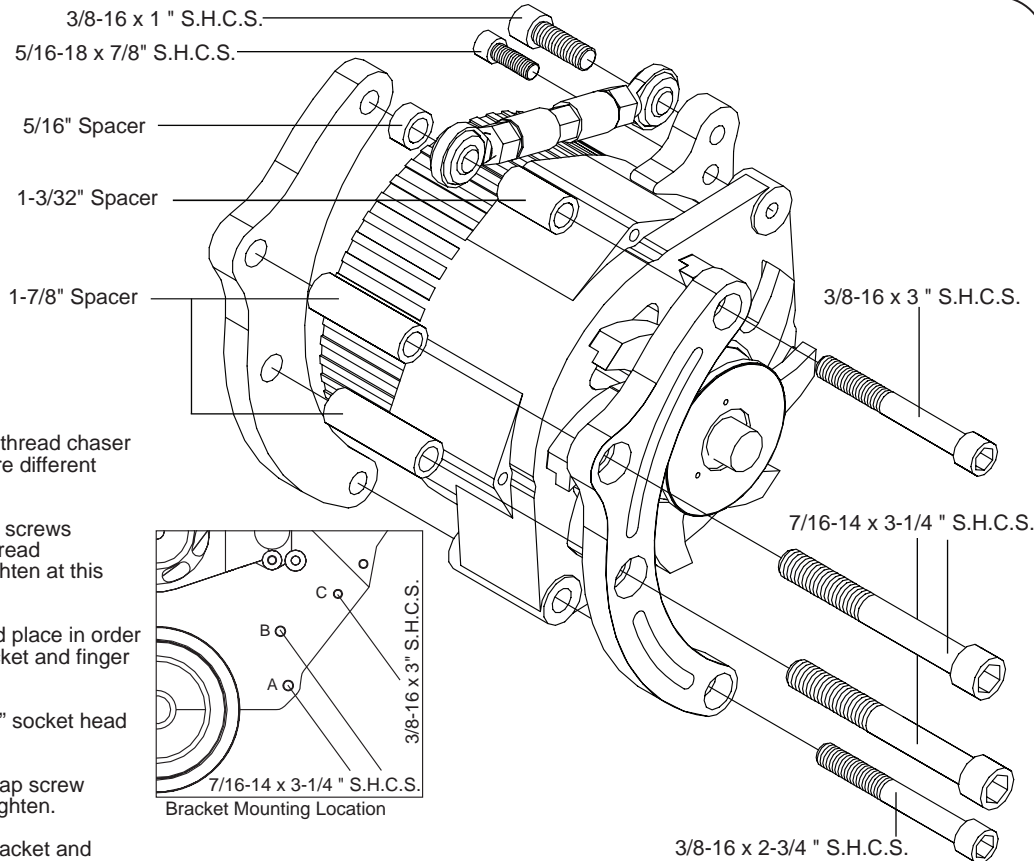

(2) 7/16-14 x 3-1/4" Socket Head Cap Screw



(1) 3/8-16 x 3" Socket Head Cap Screw

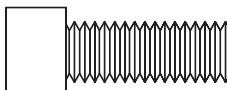

(1) 5/16-18 x 7/8" Socket Head Cap Screw

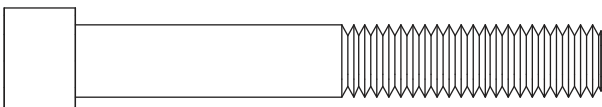

(1) 3/8-16 x 2-3/4" Socket Head Cap Screw

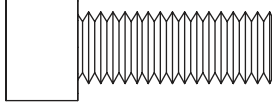

(1) 3/8-16 x 1" Socket Head Cap Screw



5/16" Spacer

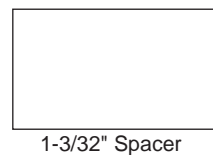

1-3/32" Spacer



(2) 1-7/8" Spacer

