



Billet Gas Pedal

#199110/199115-Rectangle Gas Pedal

#199130/199135-Oval Gas Pedal

#199170/199175-Universal Gas Pedal

#199172/199177-Profile Gas Pedal

Tools Needed:

- 5/32" Allen Wrench
- 17/64" Drill Bit
- Center Punch
- Loc-Tite® Thread Locker

1. Remove carpet and/or insulation from floorboard/firewall.
2. Position gas pedal assembly on floorboard/firewall - keep in mind pedal travel, width of foot, & position of brake pedal.
3. Place paper template between gas pedal and floorboard/firewall and tape template into position.
4. Center-punch (metal) or drill a guide hole (fiberglass) through floorboard/firewall. Finish by drilling with the 17/64" drill bit.
5. Replace carpet and/or insulation.
6. Install pedal base by applying Loc-Tite® to the two provided 1/4-20 x 3/4" button head cap screws and threading them through the floorboard/firewall into the gas pedal mount. A fender washer (not included) may be used for more support.
7. Position pedal arms for correct placement by removing outside arm and indexing on splined bushing.

Other Adjustments Include:

- Pedal base can be switched from left to right.
- Gas pedal has two axle pivot options to adjust pedal up and down on arm.
- Lower gas pedal arm can be flipped for added floor clearance.

IMPORTANT

- Attach throttle cable clevis (not included) to upper pedal arm.
- Check throttle operation before starting vehicle. Gas pedal operation should be smooth and not bind in any way.

1/4-20 x 3/4" B.H.C.S.
Install into bottom of
Gas Pedal Mount

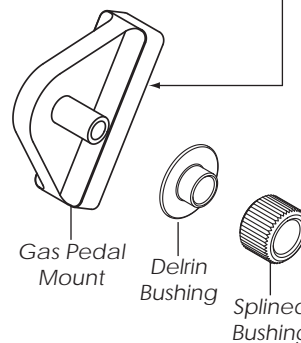
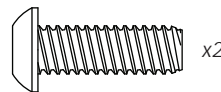

Upper Gas
Pedal Arm

Shim
Washers

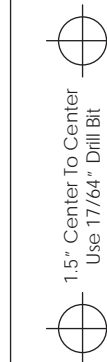

Pedal Mount
Template

Delrin
Bushing

Aluminum
Washer

1/4 -20 x 1/2"
F.H.C.S.

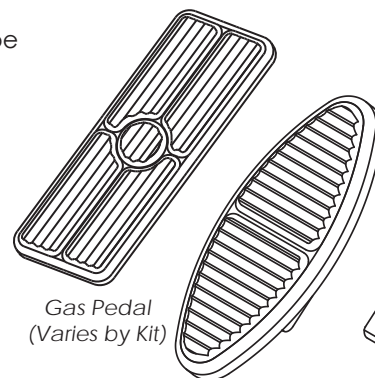

Gas Pedal
(Varies by Kit)

Lower Gas
Pedal Arm

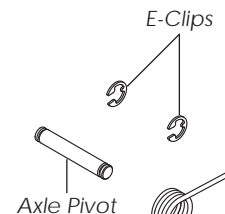

Axle Pivot

Torsion Spring

