



FOR CONVERSION FROM FACTORY THROTTLE LINKAGE TO CABLE STYLE THROTTLE

1967 - 1969 Camaro / Firebird

Gas Pedal #199160 / #199165

Tools Needed:

- 5/32" Allen Wrench
- 3/8" Wrench
- Loc-tite® Thread Locker
- 5/16" drill bit

Also required but not included: Throttle cable and housing.

1. Disconnect Battery & throttle linkage arms from carburetor and firewall, remove and set aside.
2. Remove throttle linkage pivot base from firewall with 3/8" wrench, remove accelerator pedal from inside of vehicle. Save the fasteners for later use.
3. Install the gas pedal pedestal through the firewall and into the interior of the vehicle, secure with the two fasteners removed from the pivot base. (It is recommended to apply a thin bead of RTV Silicone around the pedestal base to seal out the elements). Tighten firmly.
4. Install the gas pedal components as shown in the illustration and finger tighten.
5. Remove carpet and or insulation from floorboard/firewall that may be in the way of where the upper arm comes in contact.
6. Remove the clevis and nut from throttle cable (not included) & temporarily install clevis on gas pedal upper arm. Push upper arm with clevis and nut for proper spacing against firewall and mark position. Find center and drill a small pilot hole followed by 5/16" bit.
7. Install throttle cable (not included) per manufactures instructions.
8. Adjust gas pedal lower arm angle to your liking and apply Loc-Tite® to the threads of the flat head cap screw and tighten firmly. Gas pedal should not bind in any way. Pedal operation should be smooth.
9. Replace carpet and or insulation.

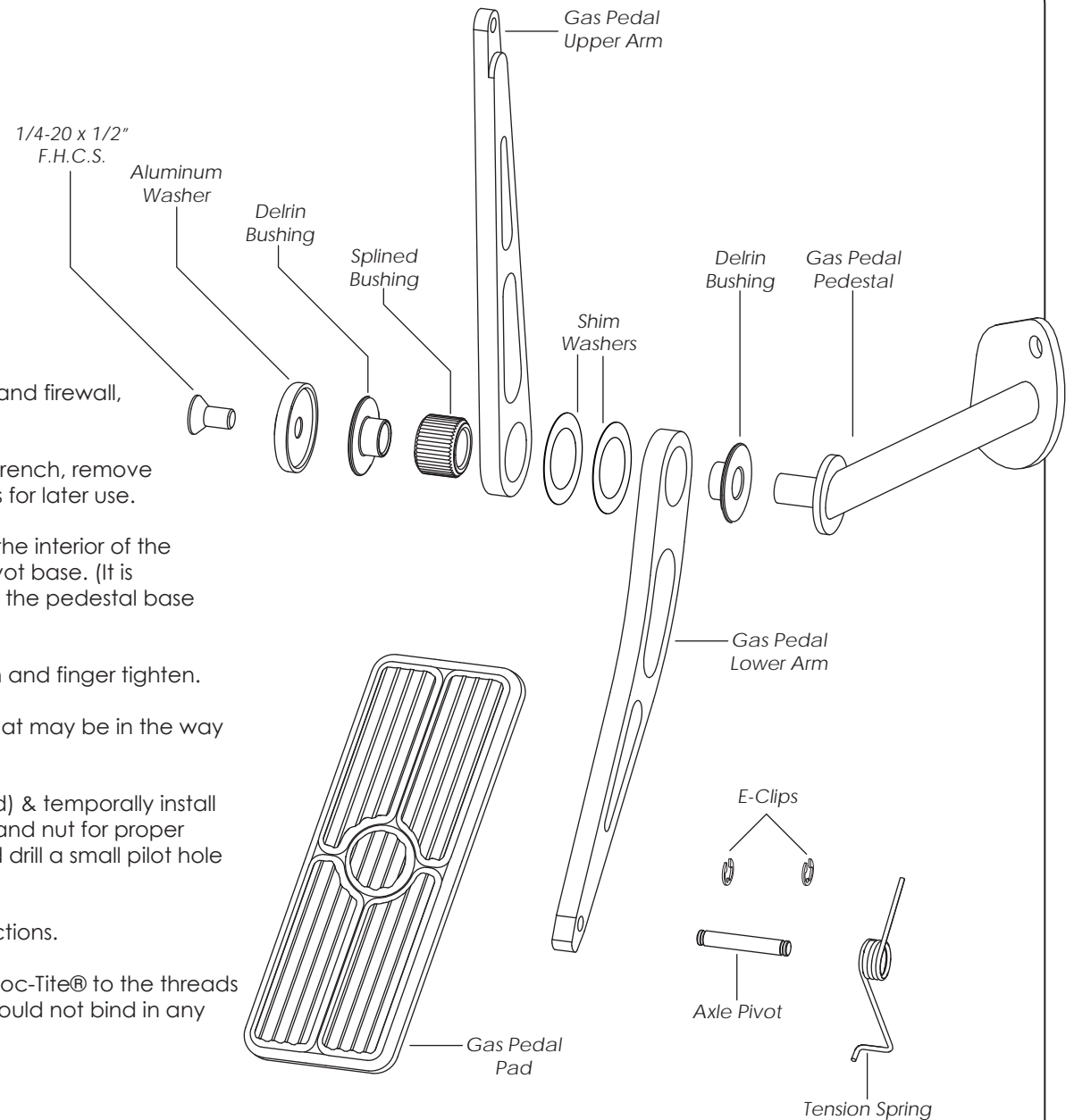

Other Adjustments Include:

- Gas pedal has two axle pivot options to adjust pedal up and down on arm.
- Lower gas pedal arm can be flipped for added floor clearance.

IMPORTANT

- Check throttle operation before starting vehicle. Gas pedal operation should be smooth and not bind in any way.



JAN 10