







# Installation Instructions

## HighRock 4x4™ Replacement Mirrors

### Vehicle Application:

- Jeep Wrangler & Unlimited OEM (Factory)
  - Half Steel Doors 1987 – 2006
  - Full Steel Doors 1994 - 2006
  - Fits all HighRock 4x4™ Element Front Doors
  - Part Number: 51261

INSTALLATION TIME	SKILL LEVEL
 1/2 Hour	 1 - Easy

TOOLS	
 Torx Wrench T27	 Safety Glasses

**⚠ WARNING** This product is designed primarily to enhance the appearance of the vehicle. Do not rely in any way on the components of this product to protect against injury or death in the event of an accident. Never operate the vehicle in excess of manufacturer's specifications.

### WEAR SEAT BELTS AT ALL TIMES

Read and follow, precisely, all installation instructions provided when installing product. Failure to do so may result in a poor fit and could place occupants of the vehicle in a potentially dangerous situation.

# HighRock 4x4™ Replacement Mirrors Installation Instructions

## Parts List

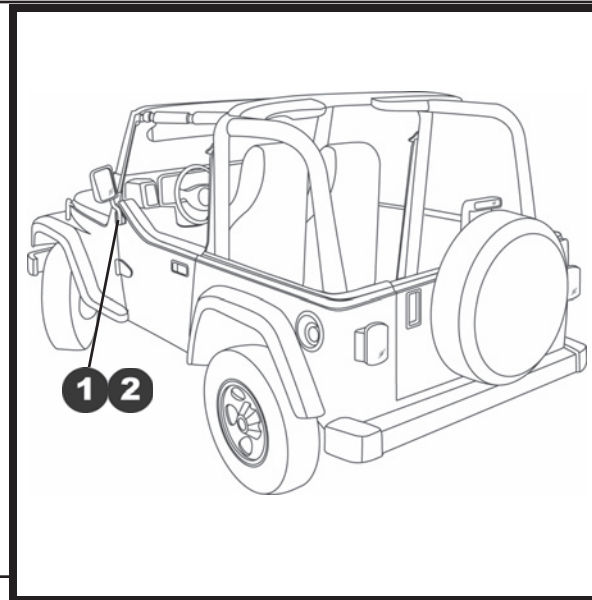
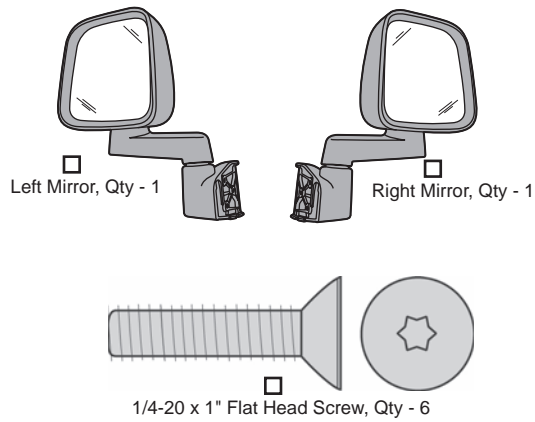

## 2 Install Mirrors

Install the HighRock 4x4™ Replacement Mirrors on the door hinges on each side of the vehicle with the screws that work best for your application.

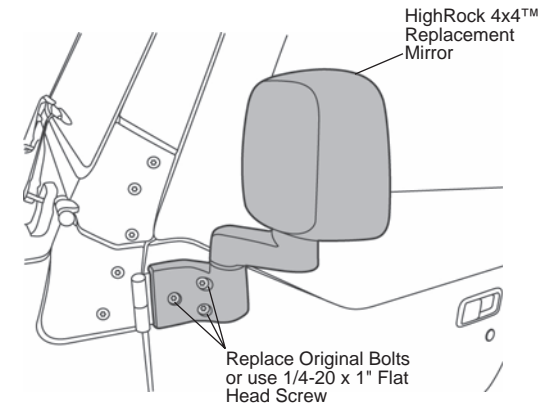

## 1 Remove Existing Mirrors

Use a T27 Torx driver to remove the three (3) bolts that secure each of the old mirrors to the door hinges. Set the bolts aside to install the HighRock 4x4™ Replacement Mirrors.

