







# Installation Instructions

## Door Pin Insert for Lower Steel Doors

### Vehicle Application

- Jeep Wrangler  
1986 – 2006  
Part Number: 51246 and 51247

INSTALLATION TIME	SKILL LEVEL
 <b>1/2 Hour</b>	 <b>1 - Easy</b>

TOOLS	
 Safety Glasses	 Needlenose Pliers





### Installation Tips

Before you begin installing this assembly, read all instructions thoroughly.

#### For a smooth fit:

For ease in installation, the product should be installed at temperatures above 72° F. Below this temperature, the fabric may contract an inch or more, making it difficult to fit to the vehicle. It is normal for fabric to contract and wrinkle when stored in the shipping carton. Within a few days after the installation, the fabric will relax and the wrinkles will disappear.

 **CAUTION** Safety glasses should be worn at all times while installing this product.

 **WARNING** This product is designed primarily to enhance the appearance of the vehicle and to shield the occupants from ordinary weather conditions. Do not rely in any way on the components of this product to contain occupants within the vehicle, or to protect against injury or death in the event of an accident. This product will not protect the occupants from falling objects. Never operate the vehicle in excess of manufacturer's specifications.

### WEAR SEAT BELTS AT ALL TIMES

Read and follow, precisely, all installation instructions provided when installing product. Failure to do so may result in a poor fit and could place occupants of the vehicle in a potentially dangerous situation.

## Installation

### Parts List

Half Door Pin Inserts, Qty - 3

### Step One

Remove Old Pin Inserts

Lift up on the flange part of the old pin inserts and pull them out of the door.

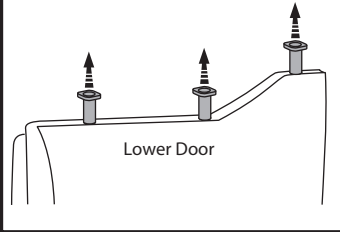

### Step Two

Install Half Door Pin Inserts

Use needle nose pliers to compress the plastic spring retainer just below the flange on one of the inserts. When the spring section of the insert enters the hole in the lower door, remove the pliers and push down on the insert to set it in the hole.

Repeat this with the other two inserts.

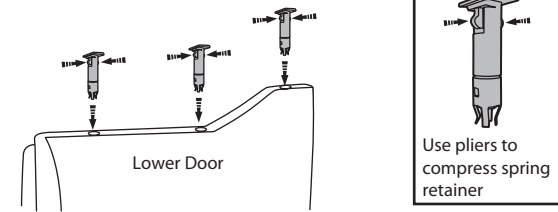

### Step Three

Install the Upper Half Door

Slide the pins on the Upper Half Door into the Half Door Pin Inserts.

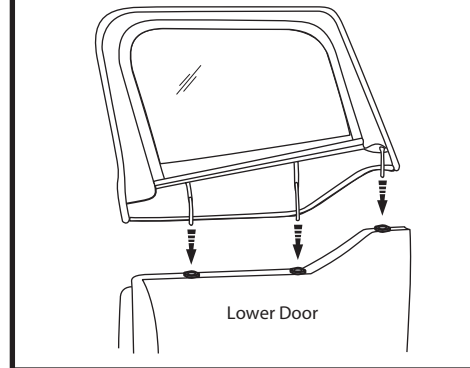

Discover other replacement doors and components on our website.