

## Installation Instruction:



**Product: TVK-10**

**Car Model: 2010 Toyota Sequoia**

### Disclaimer:

We are not responsible to damage, loss or injury caused from attempting or performing the DIY. Further, the [navigation and DVD](#) lock while in motion was originally installed for safety reasons. By unlocking the navigation and DVD lock, we are assuming that the navigation and DVD will be controlled and enjoyed by the passenger and not by the driver. As such, are not responsible to damage, loss or injury from using the bypass modules. Please be responsible drivers!

### **1. REMOVE FRONT DOOR SCUFF PLATE RH**

\* **Optional:** You may skip step#1, if you can perform step#3 without removing the door scuff.

(a) Detach the 9 claws and remove the scuff plate.

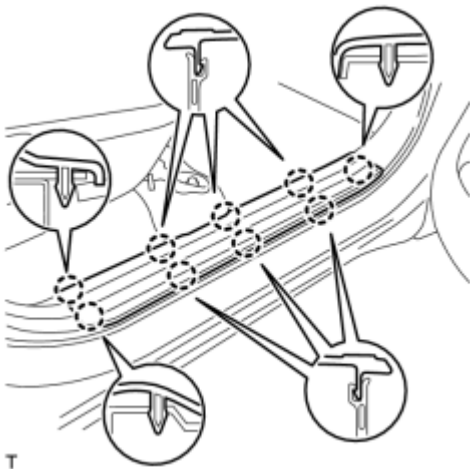

### **2. REMOVE FRONT DOOR SCUFF PLATE LH**

\* **Optional:** You may skip step#2, if you can perform step#3 without removing the door scuff.

HINT: Use the same procedure for both sides.

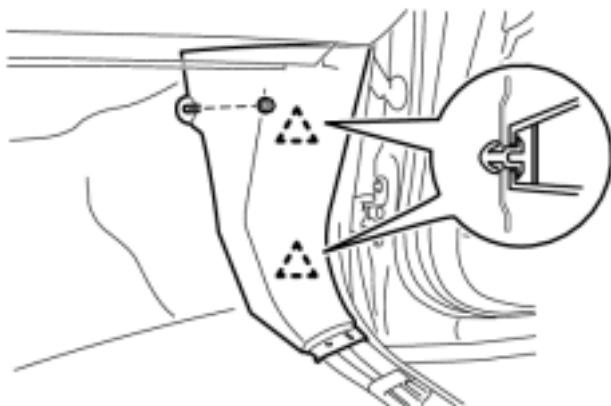

### 3. REMOVE INSTRUMENT SIDE PANEL LH

(a) Using a molding remover, detach the 7 claws and remove the side panel.

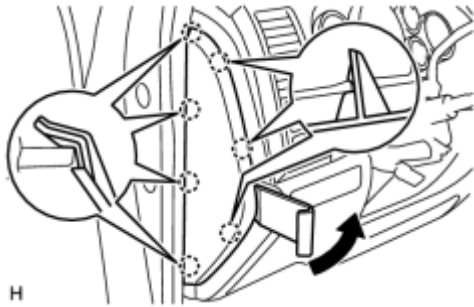

### 4. REMOVE LOWER INSTRUMENT PANEL FINISH PANEL SUB-ASSEMBLY LH

(a) Remove the 2 bolts.

(b) Detach the 9 clips and claw.



(c) Detach the 2 claws and remove the sensor.

(d) Remove the finish panel and then disconnect the connectors.

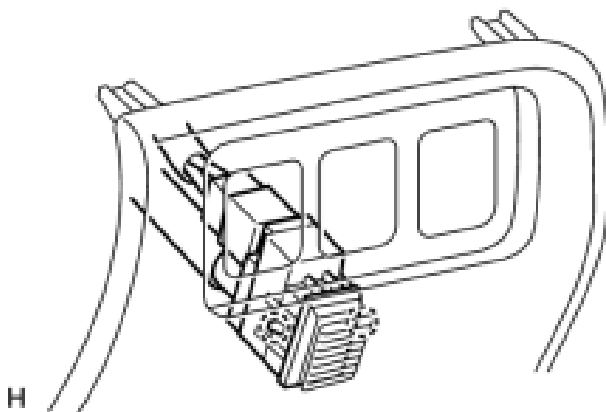

## 5. REMOVE SHIFT LEVER KNOB SUB-ASSEMBLY

(a) Twist the shift lever knob in the direction indicated by the arrow and remove it.



## 6. REMOVE UPPER CONSOLE PANEL SUB-ASSEMBLY

(a) Detach the 12 clips and remove the console panel.

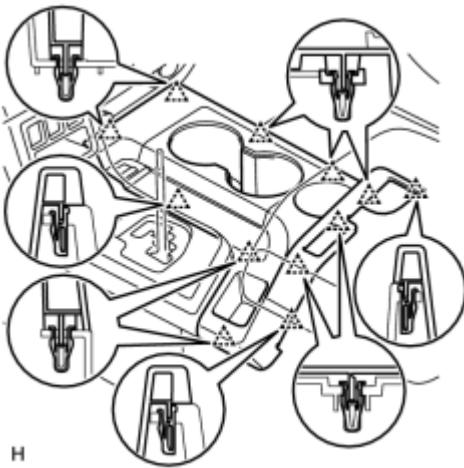

## 7. REMOVE REAR UPPER CONSOLE PANEL SUB-ASSEMBLY

(a) Move the shift lever to N.

(b) Remove the clip.

(c) Detach the 6 clips and remove the console panel.

(d) Disconnect the connector

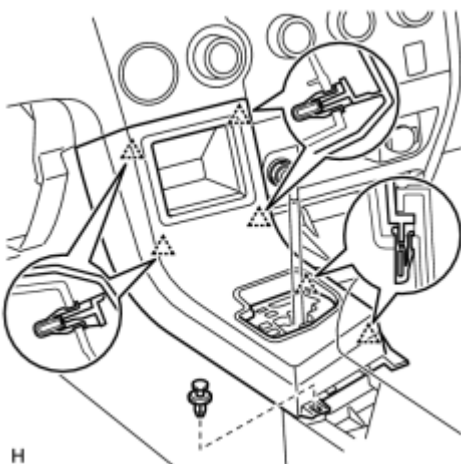

## 8. REMOVE INSTRUMENT CLUSTER FINISH PANEL ASSEMBLY

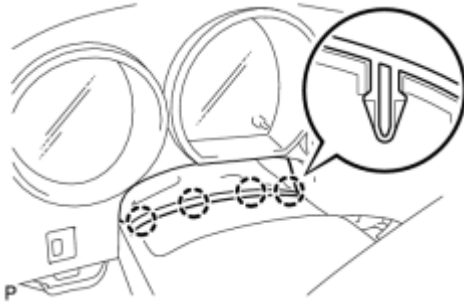

(a) Detach the 4 claws and remove the instrument panel finish panel retainer.

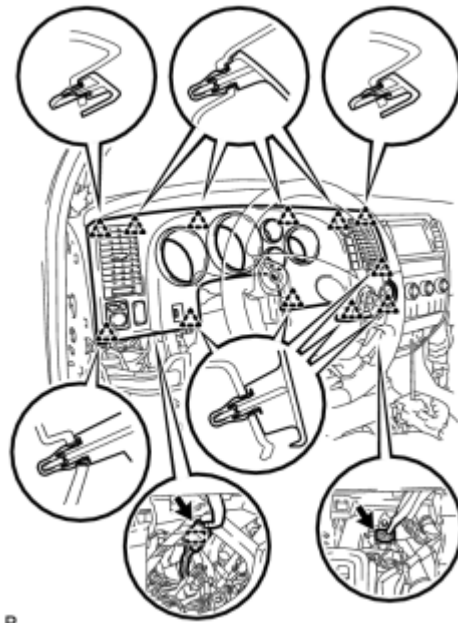

(b) Disconnect the 2 connectors and detach the wire harness clamp.

(c) Detach the 12 clips and remove the finish panel.

## 9. REMOVE CENTER LOWER INSTRUMENT PANEL FINISH PANEL

(a) Detach the 4 clips and 2 claws.

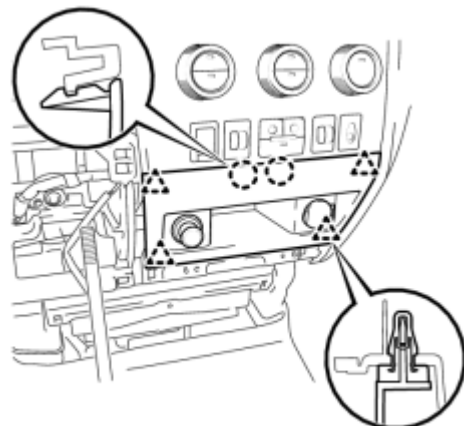

(b) Disconnect the connectors and remove the finish panel.

## 10. REMOVE INTEGRATION CONTROL AND PANEL ASSEMBLY

- (a) Detach the 4 clips and separate the panel.
- (b) Disconnect the connectors and remove the panel.

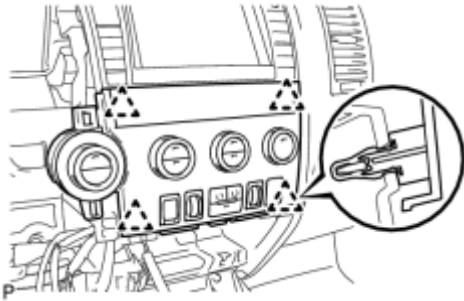

## 11. REMOVE NAVIGATION RECEIVER ASSEMBLY WITH BRACKET (w/ USB Audio System)

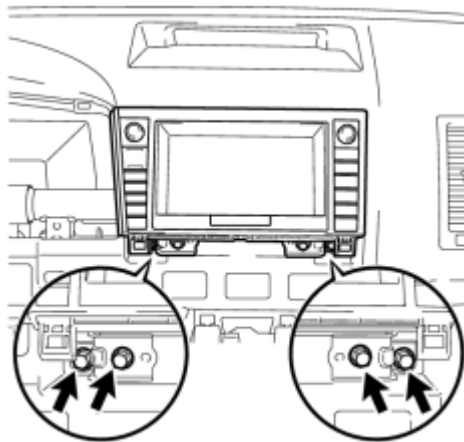

- (a) Remove the 4 bolts.
- (b) Pull the navigation receiver as shown in the illustration to disengage the 3 clips on the backside of the navigation receiver.

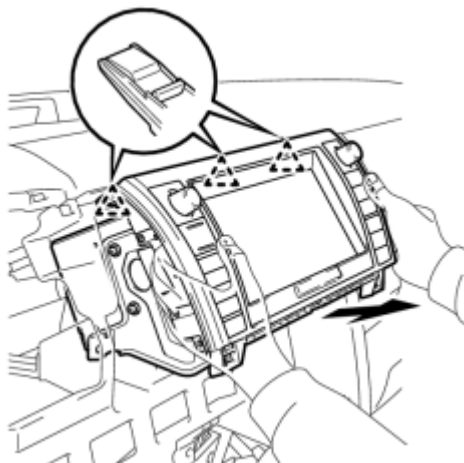

- 12. Unplug the 5-pin matching factory connector located behind the monitor.**
- 13. Connect TVK-10 (5-pin connector) to where the factory 5-pin connector was plugged in.**
- 14. Daisy chain the factory 5-pin connector to the TVK-10 (5-pin connector).**
- 15. Locate the GPS (1-pin) connector and daisy chain it to the TVK-10 (1-pin gray connector). Remove the original GPS connector from the radio, connect it to the female side of the GPS connector on the TVK-10. Then, connect the male side of the GPS connector on the TVK-10 to the monitor.**
- 16. Mount ground wire on the TVK-10 to metal chassis.**

### **17. Button Switch**

Route the button switch wire to the side of the monitor to your desired location. Be sure to clean the surface (preferably with an alcohol wipe) before you stick on the button to the surface.

### **TEST THE UNIT AND REVERSE PROCESS:**

Test the unit to make sure it is working well. Then, perform the above steps in reverse to put everything back to normal and you are done!

## **Operation**

**The TVK-10** module is equipped with a manual functionality switch, where the override of the navigation lock out may be enabled simply by toggling the switch to "TV". Once the switch is engaged, the module tricks the factory navigation system to thinking that it is at a stop, and enables the use of all the controls including the navigation address input, POI, blue-tooth contacts, mp3 music select, etc. When the switch is positioned to "NP", the vehicle will return to its normal state and will take couple of seconds to refresh the correct vehicle location on the map. This module will also allow Video in Motion during vehicle movement if the vehicle is equipped with a factory DVD.