

Part Number	Filter Type
991-FLT1	3/8" Orifice (internal)
991-FLT2	3/8" Poly body (inline)
991-FLT3	1/2" Poly body (inline)
991-FLT4	3/8" Aluminum (inline)

- |          |  |
|----------|--|
| <b>1</b> | <b>Feature:</b><br>All filters feature powerful magnet<br><b>Benefit:</b><br>Removes 99% of contaminants at filter entry point   |
| <b>2</b> | <b>Feature:</b><br>Filters are supplied with built-in safety bypass<br><b>Benefit:</b><br>Ensures power steering operates in the event of filter overload  |
| <b>3</b> | <b>Feature:</b><br>All filters have secondary membrane filter<br><b>Benefit:</b><br>Captures non-ferrous material that contaminates power steering systems   |
| <b>4</b> | <b>Feature:</b><br>Zero leak, high impact, stone and salt resistant polymer casing tested from 100° F to 350° F<br><b>Benefit:</b><br>Longer life and better resistance to high underhood temperatures |
| <b>5</b> | <b>Feature:</b><br>Perforated steel core<br><b>Benefit:</b><br>Reinforces filter media, eliminating collapses and high pressure surges   |
| <b>6</b> | <b>Feature:</b><br>Compact filter design available in 3/8" and 1/2" inlet size<br><b>Benefit:</b><br>Allows for installation into small areas at various angles, fitting all makes and models          |

# Power Steering Products - Benefits & Features

## Steering Pumps

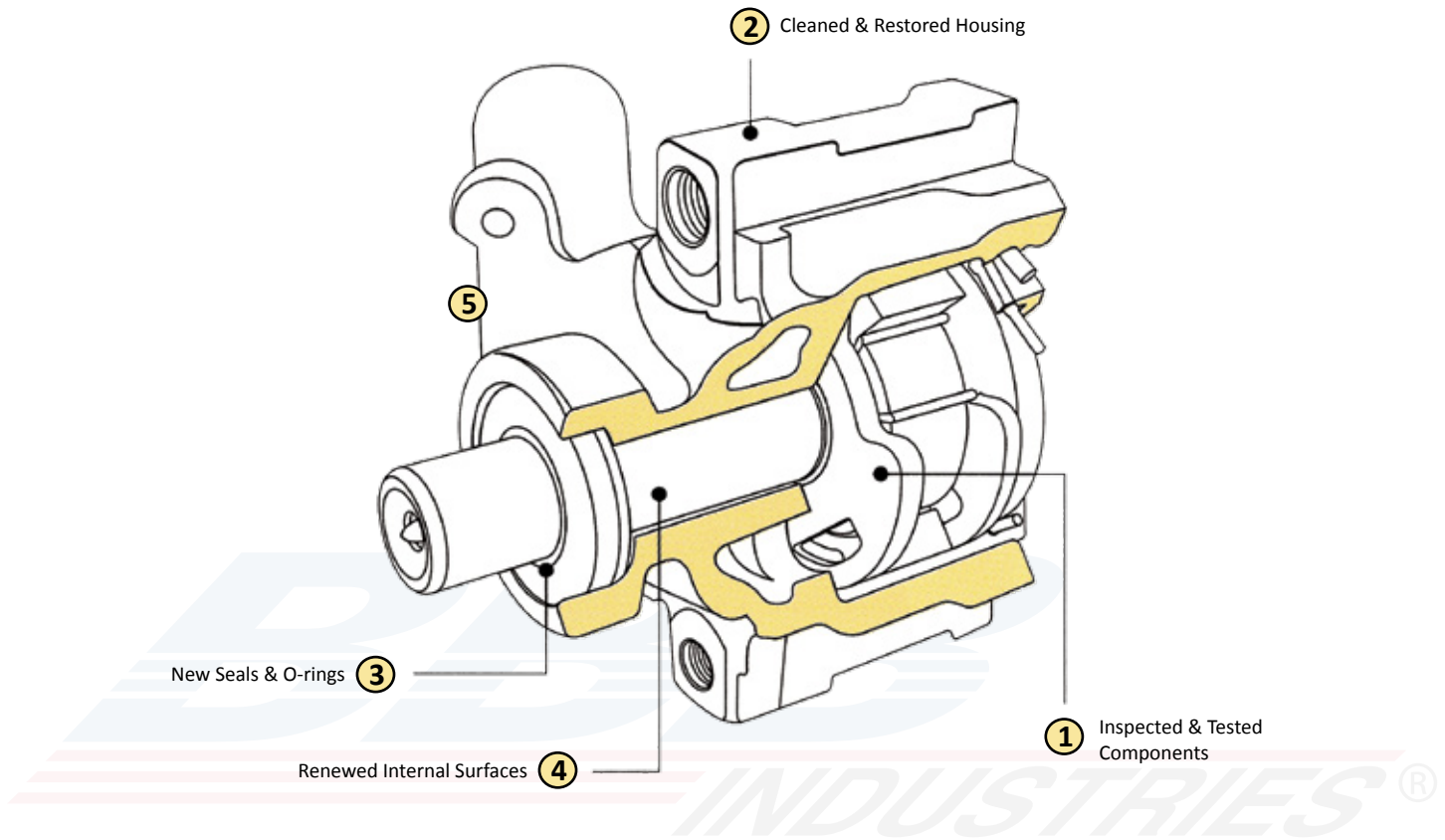

1

**Feature:**

All critical components are inspected and gauged.

**Benefit:**

Detects worn components needing to be replaced to prevent leaks and ensure proper performance.

2

**Feature:**

Cleaned and inspected at multiple stages in the manufacturing process.

**Benefit:**

Eliminates corrosion and rust prior to component assembly ensuring long service life.

3

**Feature:**

Seals and O-rings are replaced with new, OE-equivalent parts.

**Benefit:**

Extended life and reliability of the pump.

4

**Feature:**

Sealing surfaces are polished, restored and checked for smoothness.

**Benefit:**

Maximum sealing to eliminate leaks and ensure long service life of the pump.

5

**Feature:**

Assembled units 100% functionally tested for leaks and performance prior to packaging.

**Benefit:**

Guarantees unit performance that meets OE specifications.