

**banks**

with Installation Instructions  
**Owner's Manual**

# **Banks Monster® Exhaust System**

**2008 Ford 6.8L (V-10) &  
2011 Ford 6.2L (V-8) Crew Cab Short (6.75ft) Bed  
F-250/F-350 Super Duty**

THIS MANUAL IS FOR USE WITH MONSTER EXHAUST SYSTEMS 48725

**BANKS**

## General Installation Practices

1. Before starting work, familiarize yourself with the installation procedure by reading all of the instructions.
2. The exploded view (**Figure 1**) provides only general guidance. Refer to each step and section diagram in this manual for proper instruction.
3. Throughout this manual, the left side of the vehicle refers to the driver's side, and the right side to the passenger's side.
4. Disconnect the negative (ground) cable from the battery (or batteries, if there are two) before beginning work.
5. Route and tie wires and hoses a minimum of 6" away from exhaust heat, moving parts and sharp edges. Clearance of 8" or more is recommended where possible.
6. When raising the vehicle, support it on properly weight-rated safety

stands, ramps or a commercial hoist. Follow the manufacturer's safety precautions. Take care to balance the vehicle to prevent it from slipping or falling. When using ramps, be sure the front wheels are centered squarely on the topsides; put the transmission in park; set the hand brake; and place blocks behind the rear wheels. **Caution! Do not use floor jacks to support the vehicle while working under it. Do not raise the vehicle onto concrete blocks, masonry or any other item not intended specifically for this use.**

7. During installation, keep the work area clean. Do not allow anything to be dropped into intake, exhaust, or lubrication system components while performing the installation, as foreign objects will cause immediate engine damage upon start-up.

### Tools Required:

- 1/2" and 3/8" drive ratchets with standard and metric sockets and 1/2" and 3/8" drive extension
- Standard and metric combination or open-end wrenches
- Standard screwdriver
- Clean shop towels or rags
- Pry-bar

### Highly recommended tools and supplies:

- Foot-pound torque wrench
- Penetrating oil or light lubricant spray

**Figure 1** General assembly diagram

Item #	Description	Part #	QTY
1	Hanger Clamp, Intermediate	53144	1
2	Intermediate Pipe	53143	1
3	Hanger Clamp, Front Muffler	53145	1
4	Monster 3.5" Muffler	54008	1
5	Hanger Clamp, Rear	53146	1
6	Tailpipe	53147	1
7	Banks Urocalcs	96009	1

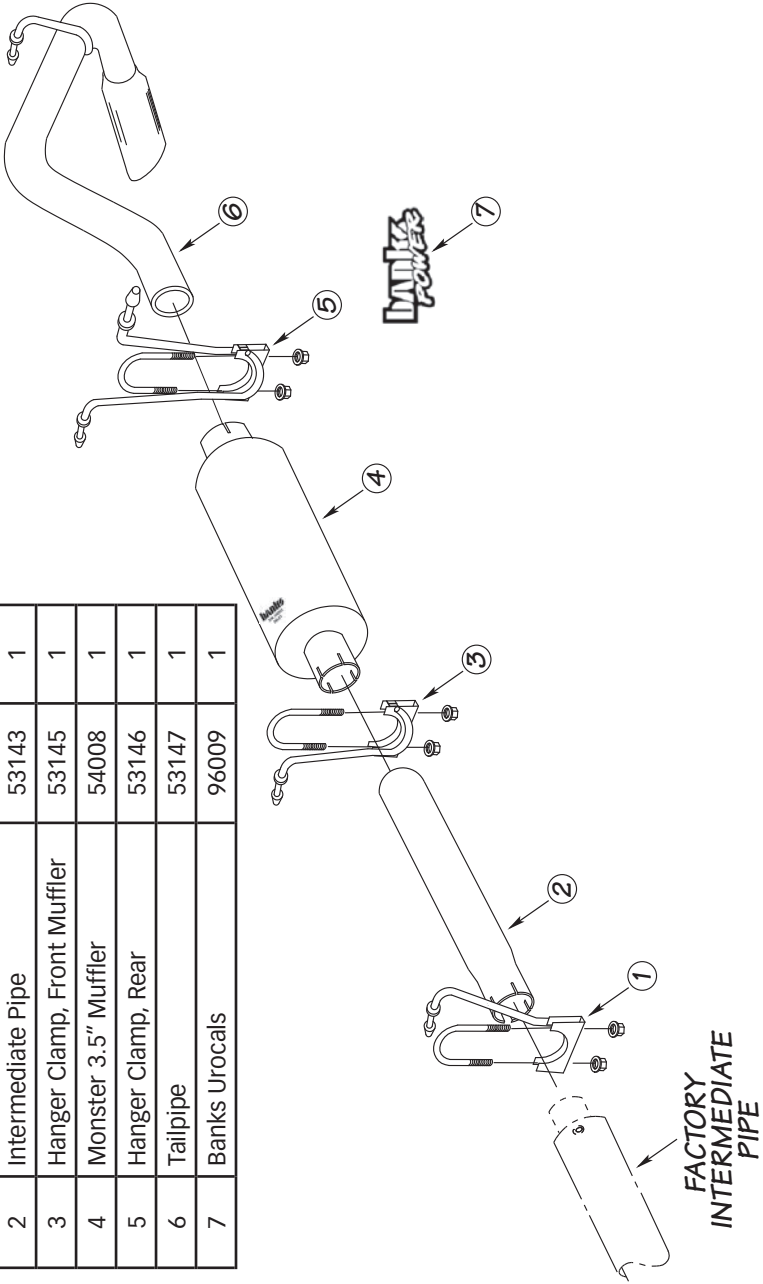

# Monster Exhaust System Installation

**1.** Disconnect the negative (ground) cable from the battery (if there is more than one battery, disconnect both negative cables). Secure the cable so it cannot accidentally come in contact with the post.

**2.** Raise the vehicle and support it securely with properly weight-rated safety stands, ramps or a commercial hoist. Take care to balance the vehicle to prevent it from slipping or falling. When using ramps, be sure the wheels are centered squarely on the topsides. Place the transmission in park (automatic), set the parking brake and securely block the wheels that are on the ground.

**CAUTION: DO NOT WORK UNDER ANY VEHICLE SUPPORTED ONLY BY A JACK. SEVERE INJURY MAY RESULT.**

**3.** For 2008 Ford 6.8L Models, from under the vehicle remove the factory exhaust starting at the front of the

muffler. Remove the factory muffler and tailpipe assembly by removing the factory band clamp on the muffler to intermediate pipe connection.

**For 2011 Ford 6.2L Models,** remove the exhaust starting at the front of the resonator as show in **Figure 2**.

*NOTE: Spray lubricant may assist in hanger pin removal.*

**4.** Remove the factory front muffler hanger pin from the rubber grommet. Remove the factory tailpipe hanger pin from the rubber grommet. Supporting the tailpipe, remove the dual rear muffler hanger pins from the rubber grommets. Remove the factory muffler and tailpipe assembly from the vehicle.

**WARNING! The following step may require the use of a torch and/or saw. Proper safety equipment should be used. Failure to use proper safety equipment may result in severe injury.**

**Figure 2** 2011 Ford 6.2L Factory Exhaust

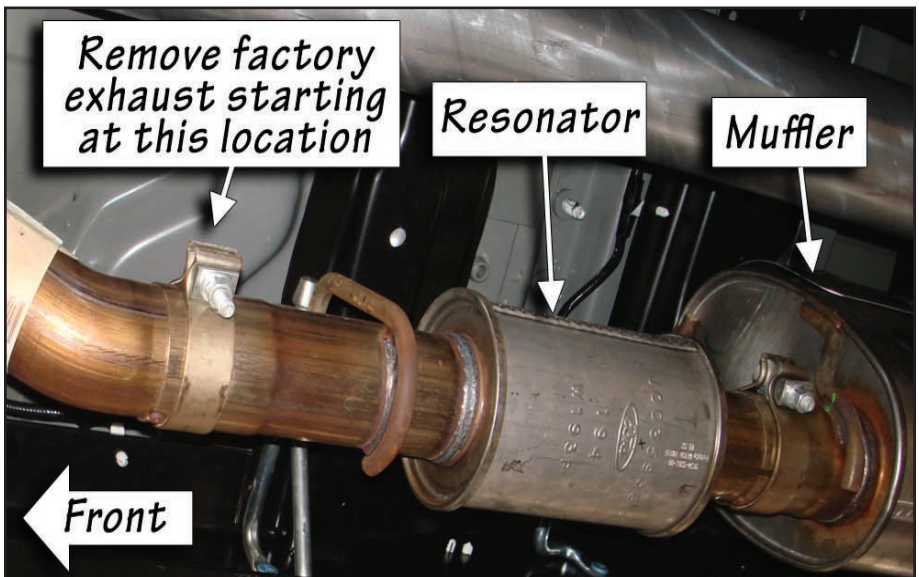

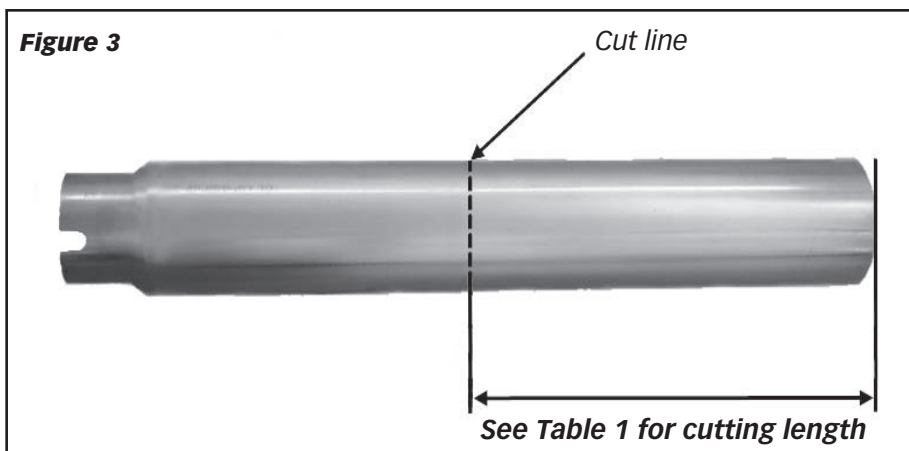

**Table 1**

<b>2008 Ford 6.8L V-10 Super Duty &amp; 2011 Ford 6.2L V-8 Super Duty</b>		
	Wheel Base	Cut this length from the Intermediate Pipe. See <b>Figure 2</b> .
Super Cab/ Short Bed	142"	31.75"
Crew Cab/ Short Bed	156"	16.25"
Crew Cab/ Long Bed	172"	No Cut

**5.** Locate the supplied intermediate pipe and cut the intermediate pipe based on the following configurations. See **Table 1**. Cut the NON-swaged end of the intermediate pipe. See **Figure 3**.

**6.** Install the supplied 3" hanger clamp onto the inlet of the Banks intermediate pipe. Install the Banks intermediate pipe to the factory intermediate pipe outlet. Align the locating pin notch onto the intermediate pipe. Insert hanger clamp pin into the rubber grommet. Lightly tighten the 3" hanger clamp (see **Figure 4**).

*NOTE: All clamps should be positioned at the beginning of the slots (on the 1/2 circle punch) and evenly tightened.*

**7.** Install the front muffler hanger clamp onto the outlet of the intermediate pipe. Insert the hanger clamp pin into the rubber grommet. Install the inlet of the Banks Monster Muffler (note the muffler inlet labeling) onto the intermediate pipe and lightly tighten the front hanger clamp (see **Figure 4**).

**8.** Install the rear muffler dual hanger clamp onto the Banks Muffler outlet. Install the two (2) clamp hanger pins into the corresponding vehicle rubber grommets.

**Figure 4**

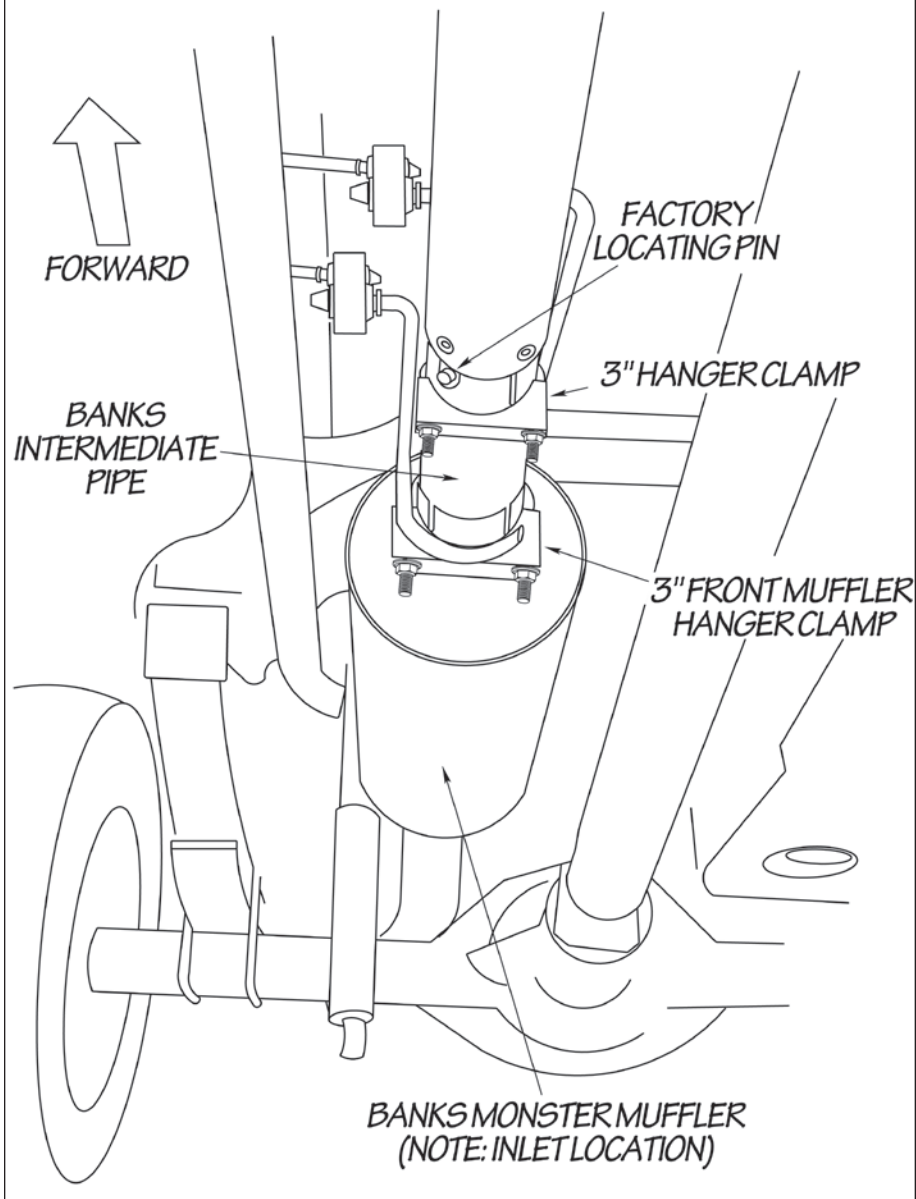

**Figure 5**

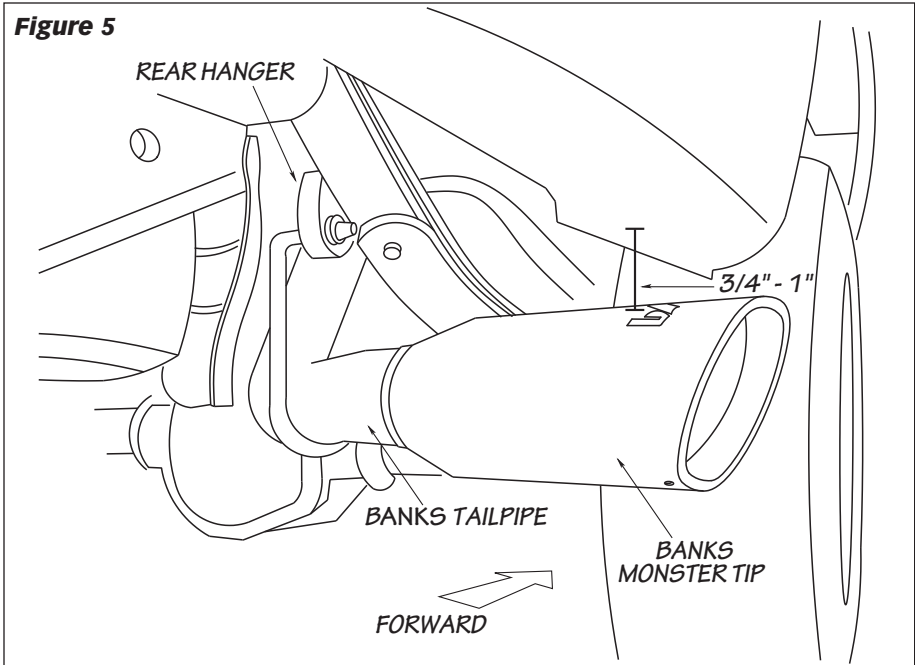

**9.** From the vehicle rear, route the tailpipe over the rear end. Start the tailpipe hanger pin into the corresponding vehicle rubber hanger. Install the tailpipe into the Banks Muffler outlet. Lightly tighten the rear muffler hanger clamp to secure the tailpipe (see **Figure 5**).

**10.** Adjust the Tailpipe Tip 1" under the rear fender such that the tip position is aesthetically pleasing (see **Figure 5**).

**CAUTION: IF THE TAILPIPE IS IN CONTACT WITH THE REAR UNDERCARRIAGE FENDER LINING, USE TEMPLATE 1 TO TRIM THE LINING AS SHOWN IN FIGURE 6.**

**11.** With the exhaust positioned properly, begin to tighten the clamps starting with the ones closest to the front of the vehicle and working your way back. Torque the exhaust clamps

evenly to 35 ft-lbs. Make sure that each slip is fully inserted (+/- 1/4") All rubber hanger should be facing forward (see **Figure 7**).

**12.** Remove the protective covering from the tailpipe tip.

**CAUTION: THE PROTECTIVE COVERING MAY IGNITE AND BURN IF NOT REMOVED PRIOR TO RUNNING THE ENGINE.**

**13.** Your system includes two (2) Banks Power logos designed to complement the Ford Factory emblems on the vehicles front doors.

**14.** Re-connect the negative battery cable. Start the engine and listen for exhaust leaks. Tighten the exhaust clamps as necessary. Whenever possible, tack weld slip connections to prevent disengagement is recommended. The Banks Monster Exhaust installation is now complete.

**Figure 6** Placement of template on Passenger side rear undercarriage lining.



**Figure 7**

