



baja designs[®]
THE SCIENTISTS OF LIGHTING

**Subaru Impreza WRX (18-On)
20" OnX6, S8**



WRX (18-On) 20" S8/OnX6+ Instructions

Tools Required

- 7/16" Socket
- 10mm Socket
- 3/4" Drill or Step drill
- 1/2" Socket
- 10mm Wrench
- Trim tool or Flathead screwdriver

1. In each front fender well, remove the upper plastic push fastener by pressing in the center portion and then prying it out. Then remove the plastic fastener on the underside of the front clip at the bottom of the fender well with the Flathead screwdriver. Pry the center portion first.



2. Along the bottom front edge of the front clip, there are seven more plastic fasteners that will need to be removed with the Flathead screwdriver in the same manner. Then, pull each side of the front clip gently until the panel releases as shown.

3. Now, remove the hood seal at the top edge of the front clip. Use the 10mm socket wrench and flathead to remove the fasteners. Leave one plastic fastener in momentarily.



4. Assistance recommended for this step. Remove the last fastener in the top edge of the hood seal and remove the hood seal strip. With assistance, carefully pull the front end away from the vehicle enough to reach the fog light connectors. Unplug the fog lights (if present). Unplug the front camera (if present). Now, place the front clip aside on a soft surface.

5. With the 10mm socket wrench, remove the two white circled upper bolts. The bottom two black circled bolt holes will also be used to mount the light bracket.

6. Mount the brackets on the upper bolt locations from step 5 and thread the OEM bolts back in loosely.

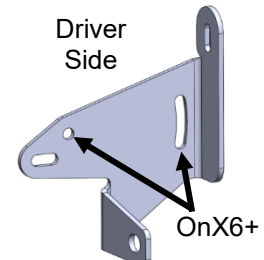
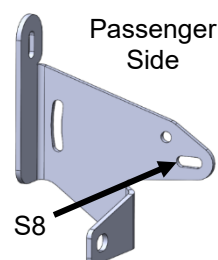

7. For the two lower bolt locations from step 5, thread in the provided 10mm hex head bolts with a washer on each side and into the nyloc nut loosely. Mount the light using the provided 7/16" hex head hardware in the appropriate location according to the image on the previous page.



8. Place the front clip back onto the vehicle to check the placement of the light. The light can be adjusted vertically if desired. Repeat as necessary. Once satisfied, remove the clip, and tighten all the hardware. Route the power cord up through the radiator cover opening on the passenger side.

9. Plug in the light to the provided wiring harness and route the harness across the radiator and around the battery. Wind and zip tie the excess harness in between the battery/fuse panel and the inner driver side fender.



10. There is a small firewall grommet behind the brake hardlines to the left of the brake booster. Remove the grommet and pierce a hole for the wiring harness. Snap a quick photo of the switch terminal configuration and remove the switch. Thread the harness through the grommet a few feet and then route the harness through the firewall.

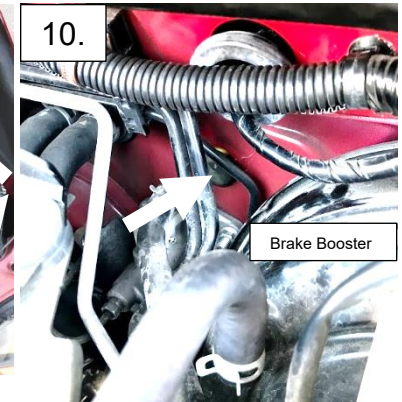

11. Inside the cabin, follow the clutch linkage to where it passes through the firewall. Behind the linkage bracket there is insulation. Reach behind the insulation and pull the switch lead through. Back in the engine compartment, press the grommet back into the firewall.

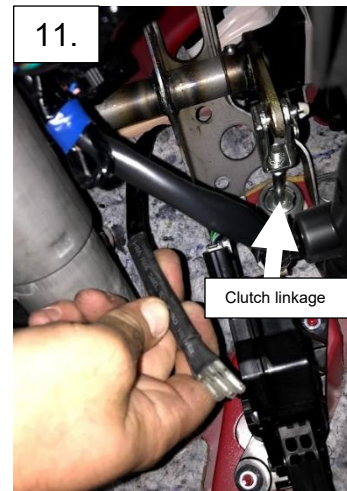

12. Partially remove the dash as shown. Determine an appropriate switch location with clearance behind the dash and drill a 3/4" hole (Two are circled). Route the switch lead of the harness through, attach the switch, and press it into the dash. Snap the dash back on.

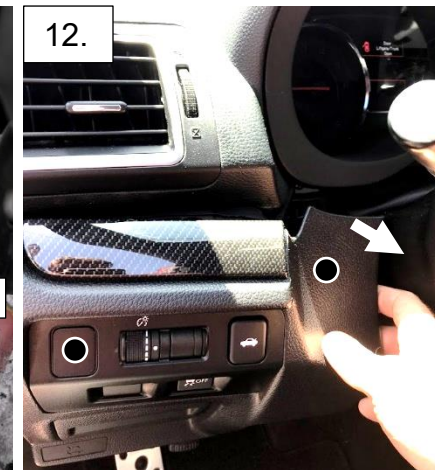

13. Attach the ring terminals of the harness to the battery using the 1/2" socket. The red terminal (+) first, then the black terminal (-).

14. Place the front clip closely to the vehicle and plug in the fog lights and camera (if present). Place the clip on the vehicle and make sure the regions near the headlights seat properly. Install the hood seal and all associated fasteners. Press the sides of the front clip back on from step 2. Install all plastic fasteners in the wheel wells and across the bottom edge of the front clip.

Re-torque all the fasteners after 100 miles.

Your install is now complete! Thank you for choosing Baja Designs.

Learn more about off-road lights on our website.