

# Installation Instructions



## Ventvisor® Deflector

### Important Safety Information



- CAUTION - Before driving, ensure that the vent visor is properly secured to vehicle.
- Do not use automatic "brush-style" car washes.
- Do not use cleaning solvents of any kind.
- Periodically check all components for tightness.

### Contents - 2 Piece Set **NOTE:** Actual product may vary from illustration.



Front Driver  
Side Visor

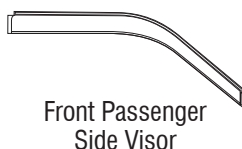

Front Passenger  
Side Visor



Alcohol Pad x2

### Contents - 4 Piece Set



Front Driver  
Side Visor

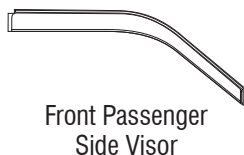

Front Passenger  
Side Visor



Rear Driver  
Side Visor



Rear Passenger  
Side Visor



Alcohol Pad x4

### Tools Required



Appropriate hand tools for loosening of side mirrors.

Some parts require trimming excess tape along the window trim, see **steps 11-12**.



Utility Knife



Safety Gloves

### Preparation Before Painting / Installation

- A trial fit is recommended to ensure proper positioning and fit.
- Check fit of parts before painting as we will not accept the return of modified or painted parts.
- Wash and dry your vehicle to remove any debris and/or dirt from the installation area.

### Installation Steps **NOTE:** Actual application may vary slightly from illustrations.



Clean the window channel with an alcohol pad.



1

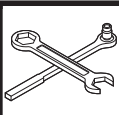

Inside the vehicle, remove the plastic mirror cap and loosen the mirror mounting hardware.

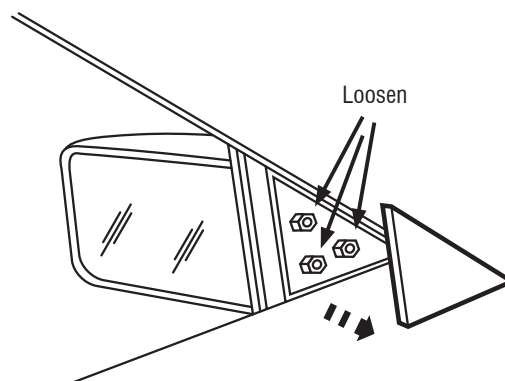

2

## Installation Steps

**NOTE:** Actual application may vary slightly from illustrations.

Peel back 2" (5cm) of tape line from each end of top flange.

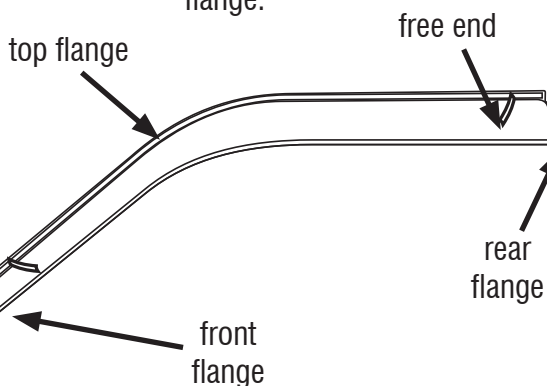

3

Insert visor into window channel rear flange first. Rear flange inserts between the window trim and the exterior surface. Front flange inserts between window trim and mirror cap. Top flange slides into the window channel.

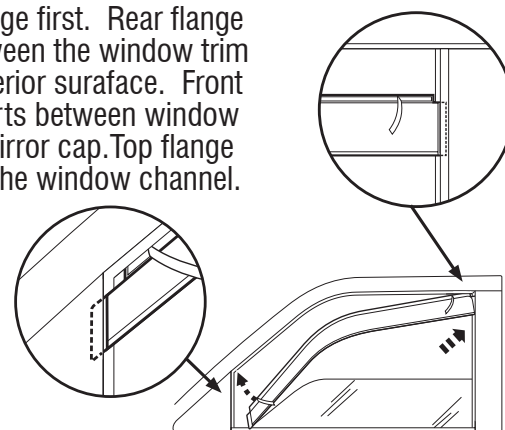

4

Remove tape liner by pulling on free ends. Raise window slowly and leave up for 24 hours to secure visor to window channel.

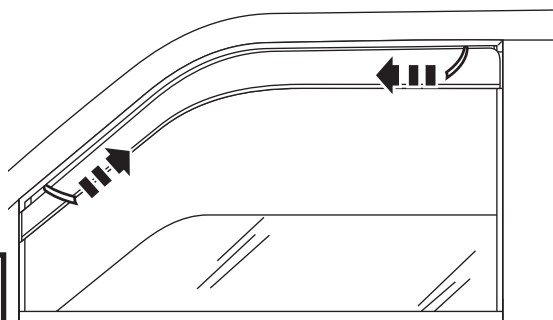

5

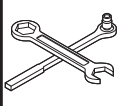

Inside the vehicle, retighten the mirror mounting hardware & replace the plastic mirror cap. Roll window up for 24 hours.

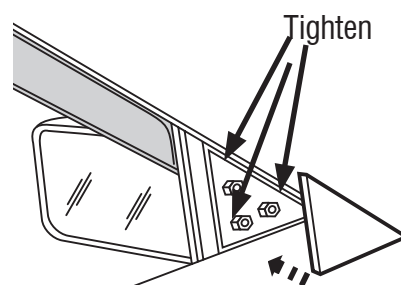

6

**NOTE:** Do not over tighten hardware.

If necessary, cut excess tape along window trim. **NOTE:** Be careful not to cut window trim.

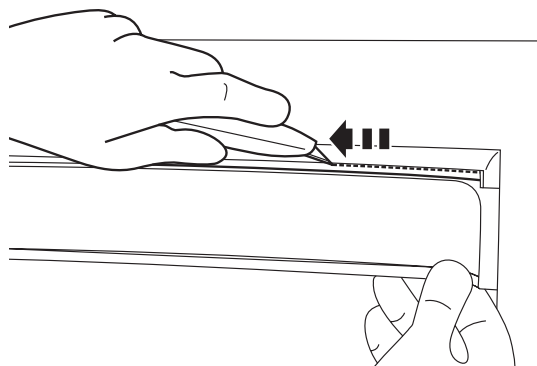
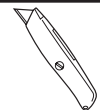

7

Remove trimmed tape by stretching.

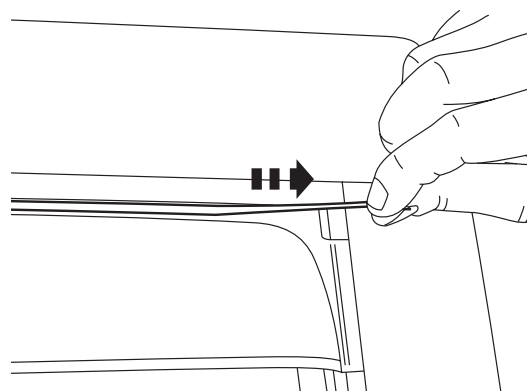

8

## 4 Piece Set

The rear visor attaches with same preparation methods as the front visor. The front and rear flanges fit between the window and exterior surface. The top flange inserts into the window channel.

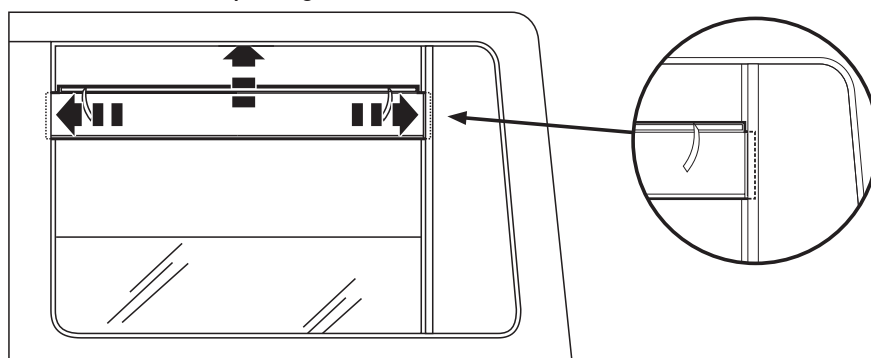

9

## Installation Steps

**NOTE:** Actual application may vary slightly from illustrations.

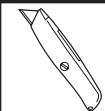

If necessary, remove excess tape from rear visors as in **Steps 7-8**.  
Raise glass and leave up 24 hours to secure.

10

## Care and Cleaning

- Wash only with mild soap & dry with a clean cloth.

## Congratulations!

You have purchased one of the many quality Auto Ventshade™ branded products offered by Lund International, Inc. We take the utmost pride in our products and want you to enjoy years of satisfaction from your investment. We have made every effort to ensure that your product is top quality in terms of fit, durability, finish and ease of installation.

