

Installation Instructions



Ventvisor® Deflector

Important Safety Information



- CAUTION - Before driving, ensure that the vent visor is properly secured to vehicle.
- Do not use automatic "brush-style" car washes.
- Do not use cleaning solvents of any kind.
- Periodically check all components for tightness.

Contents - 2 Piece Set **NOTE:** Actual product may vary from illustration.



Front Driver Side Visor



Front Passenger Side Visor



Clip x2



Alcohol Pad x2

Contents - 4 Piece Set



Front Driver Side Visor



Front Passenger Side Visor



Rear Driver Side Visor



Rear Passenger Side Visor



Clip x4



Alcohol Pad x4

Tools Required



Car Wash Supplies



Clean Towel



Putty Knife

Preparation Before Painting / Installation

- A trial fit is recommended to ensure proper positioning and fit.
- Check fit of parts before painting as we will not accept the return of modified or painted parts.
- Wash and dry your vehicle to remove any debris and/or dirt from the installation area.

Installation Steps **NOTE:** Actual application may vary slightly from illustrations.



Lower window and clean the window channel **thoroughly** with an alcohol pad.



1

Completely peel off and remove red tape liner from all flanged surfaces.

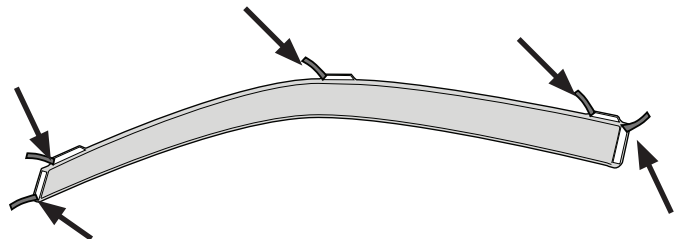

2

Installation Steps

NOTE: Actual application may vary slightly from illustrations.

Slide the visor into the window channel, beginning with the rear flange.

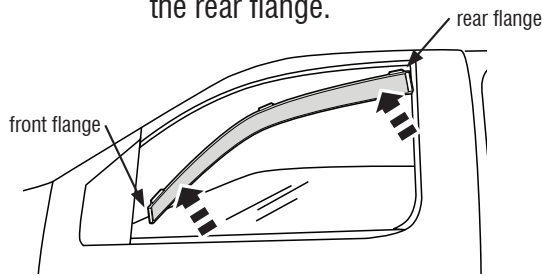

3

Apply pressure to all flange edges to ensure proper adhesion.

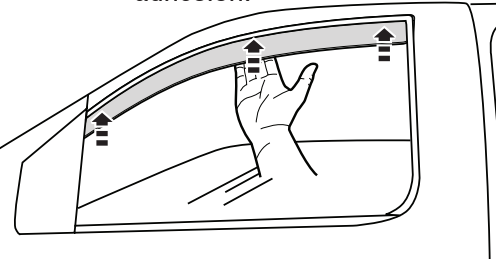

4

With the visor in place insert (1) clip into the window channel behind the visor's front flange.

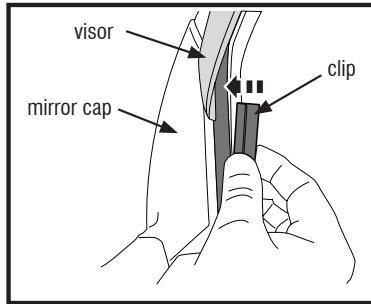

DO NOT SQUEEZE CLIP!

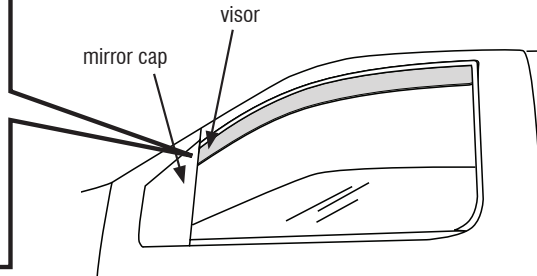

5

Ensure the clip is fully seated inside the window channel by pressing it into place with a putty knife.

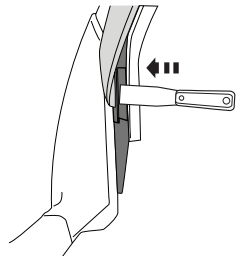

6

Continue to apply pressure to ensure that the visor remains properly seated inside the window channel as window is slowly closed. Leave window up for 24 hours to secure visor to window channel.

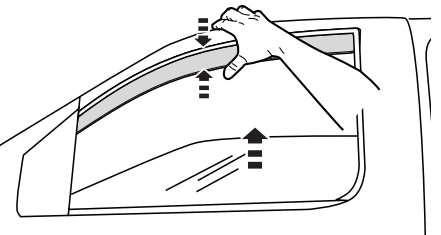

7

Rear Visors

Repeat steps 1 thru 7 for the remaining visors.

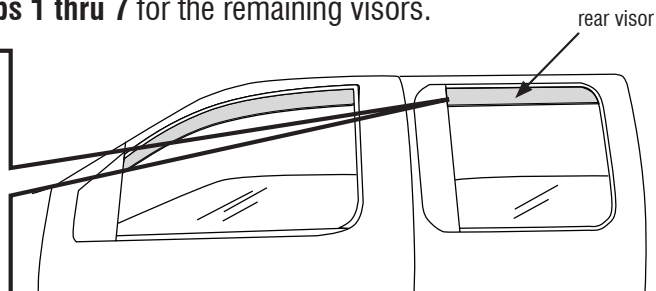
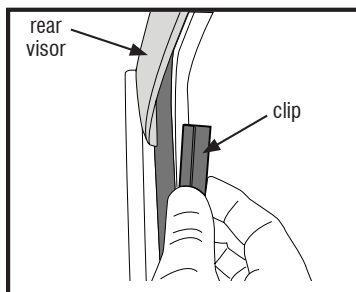

8

Care and Cleaning

- Wash only with mild soap & dry with a clean cloth.

Congratulations!

You have purchased one of the many quality Auto Ventshade™ branded products offered by Lund International, Inc. We take the utmost pride in our products and want you to enjoy years of satisfaction from your investment. We have made every effort to ensure that your product is top quality in terms of fit, durability, finish and ease of installation.

