

Installation Instructions



Bugflector® - Bugflector II® - Carflector® - Chrome Hood Shield™

Important Safety Information



- CAUTION - Before driving, ensure that the hood shield is properly secured to vehicle.
- Do not use automatic "brush-style" car washes.
- Do not use cleaning solvents of any kind.
- Periodically check all components for tightness.

Contents **NOTE:** Actual product may vary from illustration.



Hood shield



Bump On x4



Fastener x4



Washer x2



Self tapping screw x2



Alcohol Pad x2

Tools Required



Car Wash Supplies

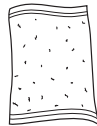

Clean Towel

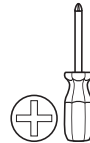

Phillips screwdriver

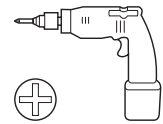

Drill

Preparation Before Painting / Installation

- A trial fit is recommended to ensure proper positioning and fit.
- Check fit of parts before painting as we will not accept the return of modified or painted parts.
- Wash and dry your vehicle to remove any debris and/or dirt from the installation area.

Installation Steps **NOTE:** Actual application may vary slightly from illustrations.

Open hood.

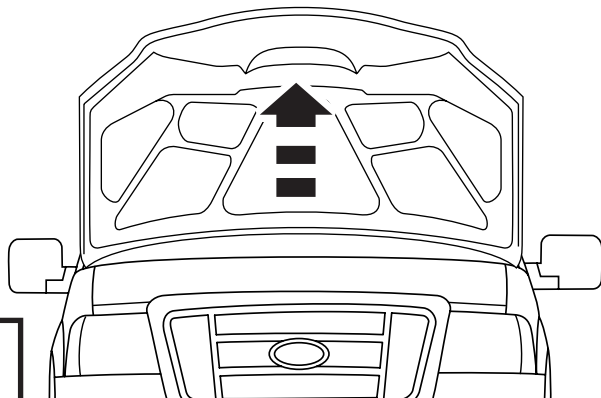

1

If equipped with rubber trim at the edge of hood corners, remove and discard (1) **INBOARD** fastener from each side of hood.

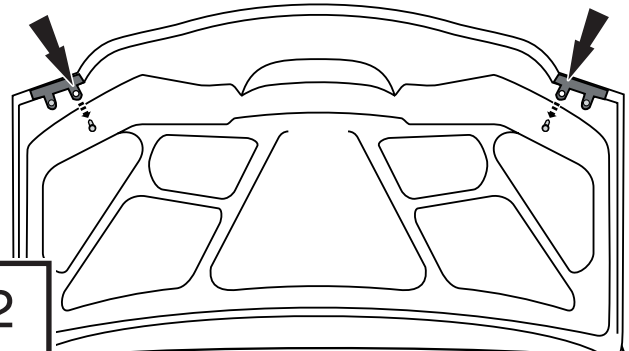

2

Installation Steps

NOTE: Actual application may vary slightly from illustrations.

Align hood shield with holes in hood. If equipped with rubber trim on hood edges, the hood shield slides **UNDER** the rubber trim pieces.

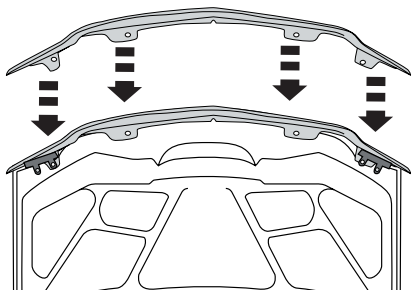

3

When aligning hood shield with hood, take note as to whether your vehicle has (2) or (4) pre existing holes in the hood that will align with the holes in the hood shield. **If (4) holes proceed to step 5. If (2) holes proceed to step 7.**

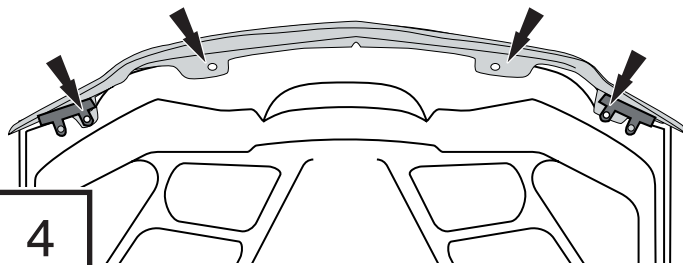

4

If (4) holes are present, remove the hood shield from hood, and completely remove the preinstalled tape strips from both outboard flanges of the hood shield.

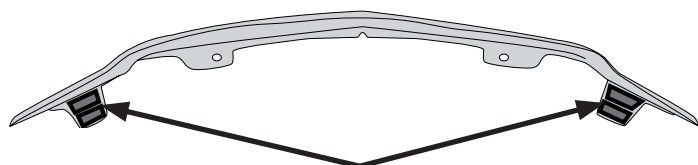

COMPLETELY REMOVE TAPE

5



Replace the hood shield on the hood, align holes, and secure the hood shield to the hood with (4) fasteners. **Proceed to step 12.**

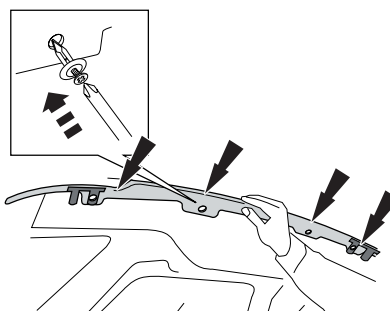

DO NOT OVER TIGHTEN

6

If (2) holes are present, remove the hood shield from hood, and clean the mounting location on the hood with an alcohol pad. Peel back 2" (5 cm) of tape liner off all tape strips on outboard flanges to expose adhesive. Fold free ends over so they will be accessible.

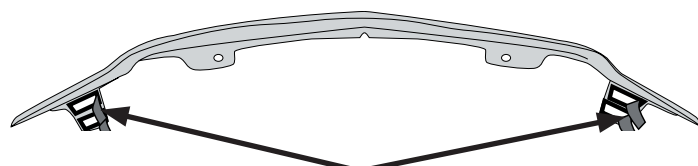

Free Ends

7



Place hood shield on hood, and align with (2) inboard holes. Install (2) fasteners in inboard holes to secure the hood shield in place.

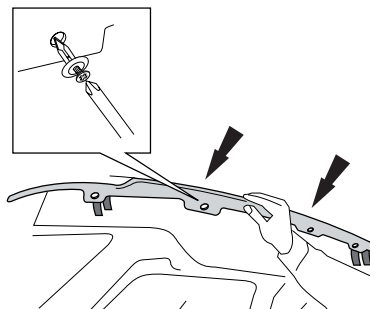

DO NOT OVER TIGHTEN

8

Remove remaining tape liner by pulling on free ends, and apply pressure to adhere tape.

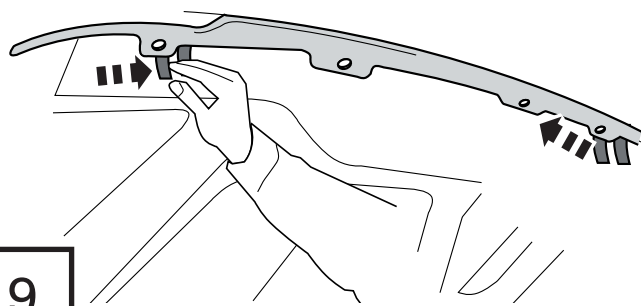

9

Optional Screw Attachment

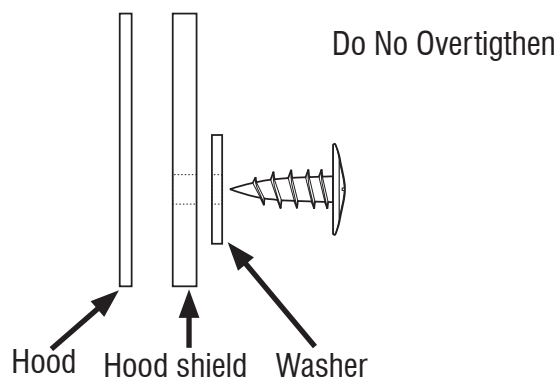

10

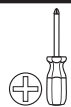
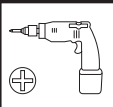

Use holes in hood shield as a guide and install (2) self tapping screws with washers in outboard flanges.



Lower hood and apply (4) bump on's to hood surface.



A power screwdriver is recommended but once the screw penetrates the inside metal panel use a regular phillips screwdriver the remainder of the way.

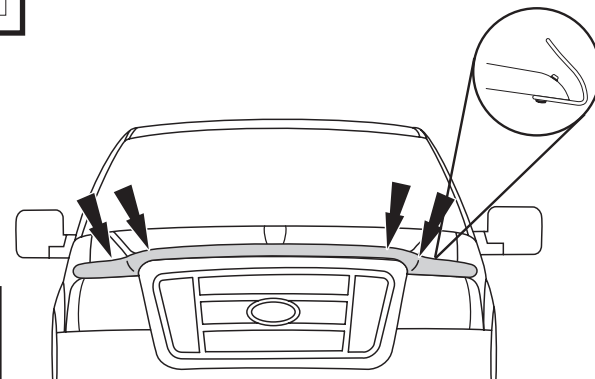
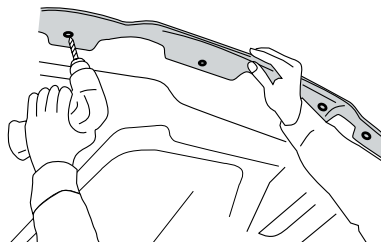

11

12

Care and Cleaning

- Wash only with mild soap & dry with a clean cloth.

Congratulations!

You have purchased one of the many quality Auto Ventshade™ branded products offered by Lund International, Inc. We take the utmost pride in our products and want you to enjoy years of satisfaction from your investment. We have made every effort to ensure that your product is top quality in terms of fit, durability, finish and ease of installation.

