

REV.	ECO#	DESCRIPTION	DRAWN BY	DRAWN DATE	MECH. ENG.	ELEC. ENG.	DEPT. MGR.
1	20437	INITIAL RELEASE FOR NEW PART	AMS	04/20/11	MRG	-	MRG
2	21475	UPDATED AUTO METER LOGO	AMS	10/09/12	MRG	-	MRG

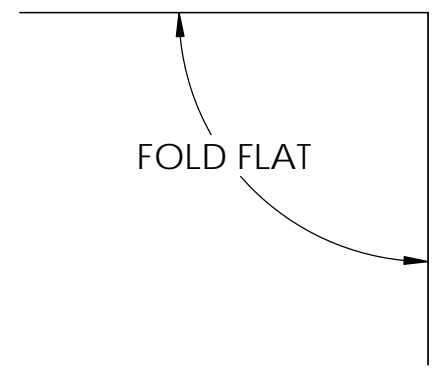
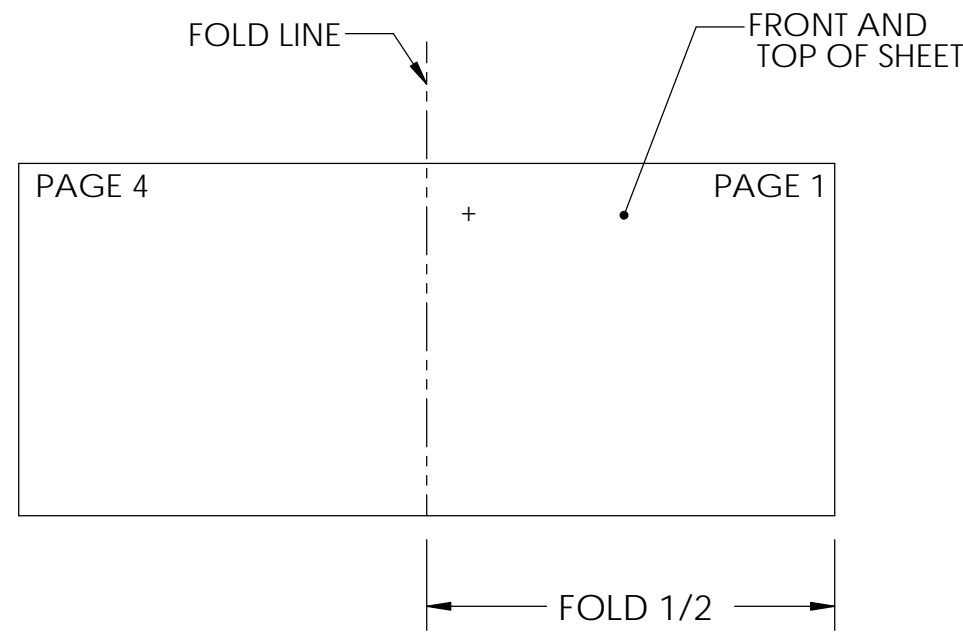

**NOTES:**

- 1) PRINT ON 11" x 17" PAPER DOUBLE-SIDED.
- 2) 5 MILS THICK LAMINATE 11.5" x 17.5"
- 3) SCORE AND FOLD INTO BOOKLET WITH PAGES IN NUMERICAL ORDER.
- 4) DRILL A .25" DIAMETER HOLE ON THE "+" MARK THROUGH ALL PAGES.
- 5) ARTWORK IMAGE ON THIS PRINT IS FOR REFERENCE USE ONLY. CONTACT AUTO METER FOR PRODUCTION ARTWORK.

<p>DO NOT SCALE DRAWING C.A.D. GENERATED DRAWING</p> <p>THIS DOCUMENT HAS BEEN ISSUED FOR ENGINEERING INFORMATIONAL PURPOSES ONLY. ANY REVISIONS TO THE CONTENT OF THIS DOCUMENT MUST BE INCORPORATED INTO THE ORIGINAL CAD FILE.</p> <p>THIRD ANGLE PROJECTION</p>	<p>UNLESS OTHERWISE SPECIFIED DIMENSIONS ARE IN INCHES. DIMENSIONS IN [ ] ARE MILLIMETERS.</p> <p>TOLERANCES ON:</p> <p>.X ± .02 [.508] .XX ± .010 [.254]</p> <p>.XXX ± .005 [.127] ANGULAR ± 0.5°</p> <p>THIS DRAWING CONTAINS PROPRIETARY INFORMATION AND SHALL NOT BE USED, REPRODUCED OR DISTRIBUTED WITHOUT THE PRIOR WRITTEN CONSENT OF AUTO METER PRODUCTS, INCORPORATED</p>	MATERIAL:	<p>PRODUCTS, INCORPORATED</p>
		FINISH:	
		TITLE:	<p>INSTRUCTION, QUICK REF GUIDE, BVA-260</p>

REV.	ECO#	DESCRIPTION	DRAWN BY	DRAWN DATE	MECH. ENG.	ELEC. ENG.	DEPT. MGR.
2	-	See Sheet1	-	-	MRG	-	MRG

4

### How to Use the Tester -Alternator Test-



**WARNING:** Safety glasses or goggles must be worn when using the tester.

Performing a Alternator Test **WARNING:** Use caution handling if battery temperature exceeds 140°.

9. Menu screen will display cursor pointing to >Alternator Test. Press "Y" to continue.



10. The Tester will automatically allow the voltage to stabilize before the test begins; Progress bar will indicate the test is in process. (Be patient, it can take up to 30 seconds for the voltage to stabilize)

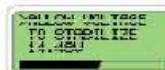

11. Testing Alternator...

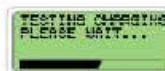

12. If the alternator tests good, this screen will appear.

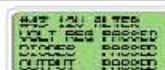

13. Results/Next Step Advice are displayed. Next Step Advice can be viewed on screen by scrolling down using the - / Down button. **NOTE:** Next Step Advice is included on every test result printout.

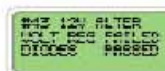

High Regulation will damage the system. Remove the alternator and bench test it.

If measured output is displayed, the output may be low for some systems. See note below.

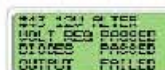

**N** If LCD reads "FAILED OUTPUT", it is recommended you test again  
**O** with the engine at a faster idle (approx. 2000 RPM). If the test still  
**T** reads "FAILED OUTPUT" Remove the Alternator and bench test it.  
**E**



**Auto Meter Products Inc.**  
413 West Elm St  
Sycamore, IL 60178

Service (815) 899-0801  
Toll Free (866) 883-TEST (8378)  
www.autometer.com/test

2650-1568-00 Rev. A 10/11/12

### BVA-260 Hand-Held Battery & System Analyzer



#### WARNING! TESTING OF HYBRID VEHICLES

**DO NOT** test the starter, alternator and/or 12 volt starting battery while it is in the vehicle.  
**DO NOT** remove, service or test the hybrid battery pack under any circumstances.  
Remove the 12 volt starting battery, starter or alternator from the vehicle prior to testing.

- Checks 6 and 12 volt batteries.
- Performs starter test and alternator test on 12V systems.
- Unit uses a replaceable 9-volt alkaline battery to power LCD screen. Prompts when internal battery needs replacement.



Manual On/Off key. The Display will show the model number, date, time, and "Y" for menu when the unit is turned On.

- (1) Cancels a test or progression.
- (2) Returns to the previous menu screen.
- (1) Moves the cursor down in order to select a menu line.
- (2) Decreases certain display values. ie CCA

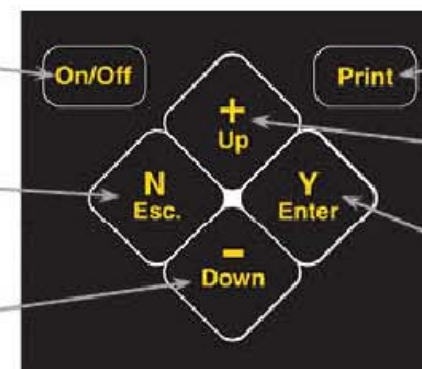

Print test results on in store printer.

- (1) Moves the cursor up in order to select a menu line.
- (2) Increases certain display values. ie CCA

- (1) Selects the next Menu.
- (2) Cursor line item.
- (3) Press "Y" / Yes to proceed with selection.

When a key is pressed the tester will beep.

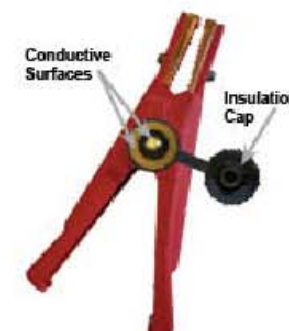

**WARNING!** insulation cap must be installed (on red clamp) when performing in vehicle test to prevent potential arcing.



Carry tester using the carrying handle. Do NOT carry or hang tester by the clamp leads.

Displays menus and test results.



Infrared Print light



Point infrared print light at thermal paper printer or printer IR receiver. Press print button to print.

DO NOT SCALE DRAWING  
C.A.D. GENERATED DRAWING  
THIS DOCUMENT HAS BEEN ISSUED FOR ENGINEERING INFORMATIONAL PURPOSES ONLY. ANY REVISIONS TO THE CONTENT OF THIS DOCUMENT MUST BE INCORPORATED INTO THE ORIGINAL CAD FILE.

THIRD ANGLE PROJECTION

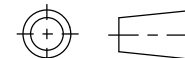

UNLESS OTHERWISE SPECIFIED DIMENSIONS ARE IN INCHES. DIMENSIONS IN [ ] ARE MILLIMETERS. TOLERANCES ON:  
.X ± .02 [.508] .XX ± .010 [.254]  
.XXX ± .005 [.127] ANGULAR ± 0.5°

THIS DRAWING CONTAINS PROPRIETARY INFORMATION AND SHALL NOT BE USED, REPRODUCED OR DISTRIBUTED WITHOUT THE PRIOR WRITTEN CONSENT OF AUTO METER PRODUCTS, INCORPORATED

MATERIAL:

FINISH:

TITLE:

INSTRUCTION, QUICK REF GUIDE, BVA-260

**Auto Meter**

PRODUCTS, INCORPORATED  
413 WEST ELM STREET  
SYCAMORE, ILLINOIS 60178

SCALE: NTS SHEET 2 OF 3

2650-1568-00

REV.	ECO#	DESCRIPTION	DRAWN BY	DRAWN DATE	MECH. ENG.	ELEC. ENG.	DEPT. MGR.
2	-	See Sheet1	-	-	MRG	-	MRG

2

### How to Use the Tester -Battery Test-



**Caution:** The grill on the tester may get hot after repeated use. Be sure to hold the unit from the side grips only. Keep hands away from the grill.

**WARNING:** Safety glasses or goggles must be worn when using the tester.

**Performing a Battery Test**      **WARNING:** Use caution handling if battery temperature exceeds 140°.

- Press On/Off Key  
Startup screen will be displayed automatically.  
Press 'Y' to continue.
- Menu screen will display cursor pointing to >Battery Test.  
Press 'Y' to continue.
- Connect clamps to battery. **Red clamp to (+) Positive battery post**  
**Black clamp to (-) Negative battery post**  
Press 'Y' to continue.  
*NOTE: If beeping check connections message appears, clean corrosion at battery/clamp connections.*
- Point the temperature sensor located on the back of the unit at the battery. Press 'Y' to read battery temperature.   
*NOTE: If the battery temperature exceeds 180°F, the tester will prompt you to allow the battery to cool before proceeding with testing the battery.*
- Enter the CCA rating for the battery. Use the + / Up and the - / Down keys to change the rating. Press Y / Enter key to continue once the rating has been entered.  
*NOTE: Holding down the +/Up or the -/Down key will increase the scroll speed of the CCA rating by increments of 25.*
- Scroll down to choose type of battery. 

Starting Standard	Deep Cycle AGM
Standard AGM	Deep Cycle STD

  
Press 'Y' to continue.
- Confirm Inputs. If inputs are correct, Press 'Y' to continue  
If changes are required, Press 'N' to re-enter battery information.  
Battery Test Begins...
- Results/Next Step Advice are displayed. Next Step Advice can be viewed on screen by scrolling down using the - / Down button. *NOTE: Next Step Advice is included on every test result printout.*

<b>Good Battery</b>	Battery is good.	
<b>Good Battery, Near End of Life</b>	Battery O.K. for mild climate. May not start vehicle in hot or cold weather.	
<b>Good Needs Charge</b>	Battery is good but needs to be charged by the store or customer before being returned to service.	
<b>Charge and Retest</b>	Battery did not have sufficient charge for a complete Load Test. Charge the battery then retest.	
<b>Bad Battery</b>	Replace battery.	

3

### How to Use the Tester -Starter Test-



**Caution:** The grill on the tester may get hot after repeated use. Be sure to hold the unit from the side grips only. Keep hands away from the grill.

**WARNING:** Safety glasses or goggles must be worn when using the tester.

**Performing a Starter Test**      **WARNING:** Use caution handling if battery temperature exceeds 140°.

- Press On/Off Key  
Startup screen will be displayed automatically.  
Press 'Y' to continue.
- Menu screen will display cursor pointing to >Starter Test.  
Press 'Y' to continue.
- Connect clamps to battery. **Red clamp to (+) Positive battery post**  
**Black clamp to (-) Negative battery post**  
Press 'Y' to continue.  
*NOTE: If beeping check connections message appears, clean corrosion at battery/clamp connections.*
- Perform a Battery Test as previously described.
- Preparing for Starting Test...
- Start the Engine as Prompted / *\*Note – The Starting System Test should only be completed if the Battery Test is good*
- Starting System Test in process...
- Results/Next Step Advice are displayed. Next Step Advice can be viewed on screen by scrolling down using the v down button. *NOTE: Next Step Advice is included on every test result printout.*

<b>Start System Passed</b>	If current draw is between 75A and 250A (for gas engine), the starting system is likely good, this screen will appear.
<b>Start System Failed</b>	If current is under 75A, a solenoid connection or corrosion problem is likely & the following screens appear. Check connections, cables at all contact points for corrosion or bad connection. If all connections are good, remove the starter and bench test it.
<b>More Information</b>	If current draw is over 250A, the system will need more information to determine if starter system passed. The next screen will ask what type of engine you are testing, Diesel or Gas. If engine is Diesel, the screens will prompt you to enter the number of cylinders. 
<b>Start System Failed</b>	If Starting System is likely to have a problem, this screen will appear. If all connections are good, remove the starter and bench test it.  

<p>DO NOT SCALE DRAWING C.A.D. GENERATED DRAWING</p> <p>THIS DOCUMENT HAS BEEN ISSUED FOR ENGINEERING INFORMATIONAL PURPOSES ONLY. ANY REVISIONS TO THE CONTENT OF THIS DOCUMENT MUST BE INCORPORATED INTO THE ORIGINAL CAD FILE.</p> <p>THIRD ANGLE PROJECTION </p>	<p>UNLESS OTHERWISE SPECIFIED DIMENSIONS ARE IN INCHES. DIMENSIONS IN [ ] ARE MILLIMETERS. TOLERANCES ON: .X ± .02 [.508] .XX ± .010 [.254] .XXX ± .005 [.127] ANGULAR ± 0.5°</p> <p>THIS DRAWING CONTAINS PROPRIETARY INFORMATION AND SHALL NOT BE USED, REPRODUCED OR DISTRIBUTED WITHOUT THE PRIOR WRITTEN CONSENT OF AUTO METER PRODUCTS, INCORPORATED</p>	MATERIAL:	<p>PRODUCTS, INCORPORATED 413 WEST ELM STREET SYCAMORE, ILLINOIS 60178</p>
		FINISH:	
		TITLE: INSTRUCTION, QUICK REF GUIDE, BVA-260	