

Thank you for purchasing AUTEL TPMS service tool. Manufactured to a high standard, our tool will, if used according to these instructions and properly maintained, give you years of trouble-free performance.

Getting Started

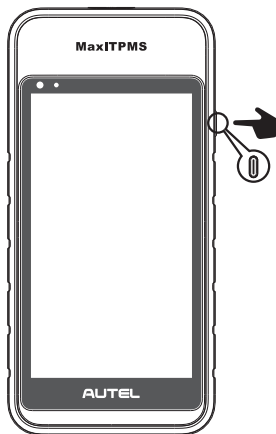

IMPORTANT: Before operating or maintaining this unit, please read the quick guide and user manual carefully, pay extra attention to the safety warnings and precautions. Use this unit correctly and properly. Failure to do so may cause damage and/or personal injury and will void the product warranty.



- Long press the Lock/Power button to turn on the tool.

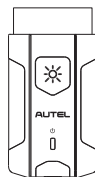

- Connect the MaxiVCI V200 to the Vehicle's OBD-II port and turn the vehicle ignition to the **On** position to pair it with the ITS600 and establish a communication link with the vehicle.



IMPORTANT: Prior to use, update the ITS600 and MaxiVCI V200 with the latest version of software and firmware. Make sure the ITS600 is connected to the Internet and is charged or connected to a power outlet.



NOTE: TPMS software updates are free for the life of the tool. All Systems diagnostics and service function software is available with an additional purchase.

ITS600 Update Instructions

- Tap the **Update** button on the Diagnostics Job Menu; the Update screen displays.
- The screen lists all available updates, tap the **TPMS** icon to download TPMS-related functions or tap the manufacturer specific icon to download the service function of your selection.
- If the additional diagnostic and service software has been purchased, tap the icon of each needed vehicle brand to download the diagnostic and service software to the tablet.
- Tap the **Pause and Resume** button at the top right corner of the screen to suspend or resume the update process.
- When the download is complete, the software will be installed automatically. The previous version will be replaced.

VCI Update Instructions

The MaxiVCI V200 supports Bluetooth (BT) and USB communications.

Upgrade via Bluetooth

- Connect the V200 to the vehicle or charge it with an adapter before pairing with the tool via BT.
- On the Diagnostics Job Menu, tap **Settings > VCI Manager > Bluetooth Connection**, and pair the tool with V200 by tapping the device serial number on the screen.
- When pairing is successful, the connection status displays as connected.
- Tap **Firmware Upgrade > Detect Firmware** to check if an update for the V200 is available.

Upgrade via USB

When the V200 is connected with the tool using a USB-Type C to Type C USB cable (not included), tap **Firmware Upgrade > Detect Firmware** to check if an update for the V200 is available.

Connecting VCI to the Vehicle

Now the ITS600 is ready to use. Connect the V200 to the vehicle's DLC (OBDII port), usually located under the vehicle dash. Ensure the V200 is properly connected to the vehicle and the tool; the VCI status button at the top right corner on the screen displays with a green check mark.

Printing Instructions

Print via PC



Please download the **Maxi PC Suite** from

www.autel.com > *Support > Downloads > Autel Update Tools*, and install to your Windows-based PC.



IMPORTANT: Make sure the tool and the computer are on the same network (Wi-Fi or hard-wired) as the printer.

- Launch the **MaxiSys Printer** on the computer.
- Click **Test Print** to make sure the printer is working successfully.
- Tap **Print** on the toolbar of the tool. A temporary document will be created and sent to the computer.
 - If the **Auto Print** option in the MaxiSys Printer is selected, the MaxiSys Printer will print the received document automatically.
 - If the **Auto Print** option is not selected, click **Open PDF File** to view all the temporary files. Select the files you want to print and click **Print**.



QUICKSTARTGUIDE

ITS600 & TBE200 CONNECTION, DIAGNOSTICS, PROGRAMMING & RELEARN

1

| | ID(HEX) | KPa | MHz | °C | BAT |
|----|----------|------|-----|----|-----|
| LF | 610D1713 | 36.1 | 315 | 91 | OK |
| RF | 610D268D | 38.1 | 315 | 91 | OK |
| RR | 610D2434 | 36.1 | 315 | 87 | OK |
| LR | 610D2587 | 36.1 | 315 | 86 | OK |

STEP ONE

Pair the VCI200 with the TBE200, Insert the dongle into the Vehicle's diagnostic port then select the year, make and model from the main menu. Activate all sensors in the order indicated in the "Check" Function with the "trigger" button

2

| | ID(HEX) | DTC |
|----|----------|----------|
| LF | 610D1713 | 610D1713 |
| RF | 610D268D | 610D268D |
| RR | 610D2434 | 610D2434 |
| LR | 610D2587 | 610D2587 |

STEP TWO

After activating each TPMS sensors with the "Trigger" button, tap the "Diagnostics" tab to perform a TPMS Diagnose. The tool will then compare the physical location of the sensors and ID'S with the module information.

3

| | ID(HEX) | PSN Code |
|----|----------|----------|
| LF | 610D1713 | 610D1713 |
| RF | 610D268D | 610D268D |
| RR | 610D2434 | 610D2434 |
| LR | 610D2587 | 610D2587 |

STEP THREE

After performing the diagnosis, tap the programming tab to create replacement Autel MX-Sensors. The sensors MUST be programmed prior to installation to perform correctly. Choose the programming method and place the sensor near the top of the tool.

4

Original part number information

OEM Sensor Manufacturer: Schrader
 Sensor Frequency: 315MHz
 OEM Sensor Part Number: FR321A189A/F2G21A189A
 wheel nut torque(N·m): NA
 Number on Sensor: FR3V-1A180-AA/FR3V-1A150-AA

Learning Process Guide

Position relearn type: OBD relearn \ Stationary relearn.
 Method 1:

STEP FOUR

Tap the relearn tab to execute a tpms relearn. The directions for each vehicle's relearn procedure will be provided to minimize errors. If there is more than one method it will be indicated. The TPMS service is now complete!



QUICKSTARTGUIDE

ITS600 & TBE200 CONNECTION & PARING OF TBE200

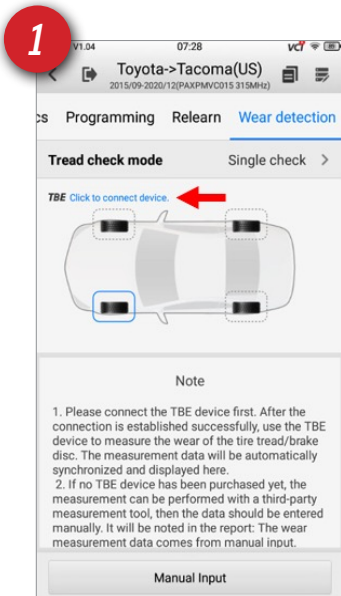

STEP ONE

Verify that both the ITS600 & TBE are connected to the same Wi-Fi network. Tap the Wear Detection tab. Tap "TBE Click to connect device." Tap the Device displayed on the screen to connect the TBE200 to the ITS600

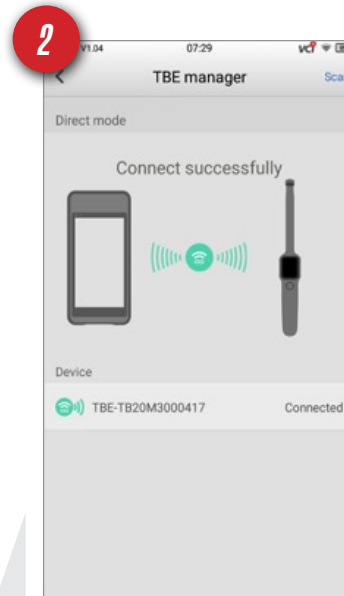

STEP TWO

The 2 tools are now connected successfully. You can now begin tire tread depth measurements with THE TBE200. The values will be displayed on the ITS600 along with service recommendations and wear information.



STEP THREE

Tap "Tire Tread" on the TBE200 to begin using measuring tire tread depth. The values will appear on the ITS600 as well as the TBE200. The tread depth data will now integrate with the TPMS related information on the ITS600. The data can be printed and presented on a scan report

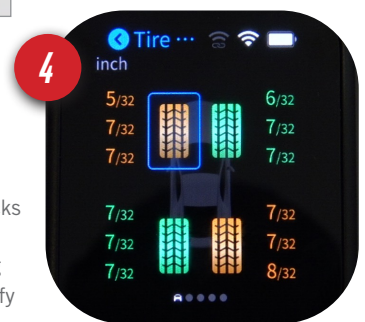

STEP FOUR

The inner middle and outer sections of adjacent tread blocks are measured to get the most accurate information regarding tread wear. The tool can identify uneven wear characteristics. Single or All Check Mode can be selected in the "Check Settings Menu



QUICKSTARTGUIDE

TPMS VEHICLE HEALTH & TBE200 REPORT

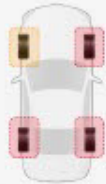

| Basic information | Customer information | Vehicle information |
|--|----------------------|---|
| Workshop name:AAA Tires | Customer:Leo H. | License: Vin:1GCVKPEH6HZ407481 Make/Model:Chevrolet Silverado Year:2016/11-2019/12(315MHz) |
| Time (Y/M/D):2021/06/12 | | Device:ITS600/V1.04,TBE200/V01.08.00 |
| Service & Repairs needed <input type="checkbox"/> TPMS sensor replacement <input type="checkbox"/> Tire repair <input type="checkbox"/> Tire rotation <input type="checkbox"/> Other: | | |
| <input type="checkbox"/> Position relearn <input checked="" type="checkbox"/> Tire replacement <input type="checkbox"/> Seasonal tire swap | | |
| <input checked="" type="checkbox"/> Tire pressure adjustment <input type="checkbox"/> Brake disc replacement <input checked="" type="checkbox"/> Wheel alignment | | |

| Vehicle Summary Status | Diagnostics | Tire Tips |
|---|----------------------------------|---|
|  | DTC information 0DTCs: | Tires should be rotated every six months, or 6,000 to 8,000 miles (10,000 to 12,000 km) or as specified by your vehicle manufacturer. |



Left front wheel

| | | |
|---|---|--------------------------------|
| 78CD1B8D 78CD1B8D Match Pass OK | Sensor status 42.0Psi Normal | Temperature 111°F Normal |
|  11/32" Tire condition:Irregular wear | Tire brand:Federal Tire Tire specification:265/55R20 114S Tire DOT: | |
|  | | |
| Maintenance suggestions: 1.Tires:Check chassis parts for deformation and looseness, and then check 4-wheel alignment parameters. 2.Brake disc:Normal;Check brake disc regularly. | | |



Right front wheel

| | | |
|---|---|--------------------------------|
| 78CD212B 78CD212B Match Pass OK | Sensor status 41.0Psi Normal | Temperature 109°F Normal |
|  3/32" Tire condition:Worn | Tire brand: Tire specification:265/55R20 114S Tire DOT: | |
|  | | |
| Maintenance suggestions: 1.Tires:Replace tire immediately. 2.Brake disc:Normal;Check brake disc regularly. | | |

Right rear wheel

| | | |
|---|---|--------------------------------|
| 78CCF737 78CCF737 Match Pass OK | Sensor status 36.0Psi Normal | Temperature 100°F Normal |
|  3/32" Tire condition:Worn | Tire brand:Federal Tire Tire specification:265/55R20 114S Tire DOT: | |
|  | | |
| Maintenance suggestions: 1.Tires:Replace tire immediately. 2.Brake disc:Normal;Check brake disc regularly. | | |

Left rear wheel

| | | |
|---|---|-------------------------------|
| 78CD20CA 78CD20CA Match Pass OK | Sensor status 42.0Psi Normal | Temperature 98°F Normal |
|  4/32" Tire condition:Worn | Tire brand:Federal Tire Tire specification:265/55R20 114S Tire DOT: | |
|  | | |
| Maintenance suggestions: 1.Tires:Replace tire immediately. 2.Brake disc:Normal;Check brake disc regularly. | | |

Gray: Unchecked; Green: Normal; Yellow: Alert! Replacement recommended; Red: Abnormal! Immediate replacement.