



<b>ROSTRA PART NUMBER</b>	<b>ROSTRA DESCRIPTION</b>
260-1030-TUNB	DRL,LED,CLEAR,TUNDRA,14,BLACK
260-1030-TUNG	DRL,LED,CLEAR,TUNDRA,14,GRAY
260-1030-TUNR	DRL,LED,CLEAR,TUNDRA,14,RED
260-1030-TUNS	DRL,LED,CLEAR,TUNDRA,14,SILVER
260-1030-TUNW	DRL,LED,CLEAR,TUNDRA,14,WHITE
260-1030-TUNU	DRL,LED,CLEAR,TUNDRA,14,UNP

<b>ROSTRA SVC KIT NUMBER</b>	<b>ROSTRA DESCRIPTION</b>
260-1030-TNUL	SVC, DRL,TUNDRA,14,UNPT,DRVR
260-1030-TNUR	SVC, DRL,TUNDRA,14,UNPT,PSGR
260-1030-TNBL	SVC,DRL,TUNDRA,14,202,DRVR
260-1030-TNBR	SVC,DRLTUNDR14-,202,PSGR
260-1030-TNWL	SVC,DRL,TUNDRA,14,040,DRVR
260-1030-TNWR	SVC,DRL,TUNDRA,14,040,PSGR
260-1030-TNGL	SVC,DRL,TUNDRA,14,1G3,DRVR
260-1030-TNGR	SVC,DRL,TUNDRA,14,1G3,PSGR
260-1030-TNSL	SVC,DRL,TUNDRA,14,1D6,DRVR
260-1030-TNSR	SVC,DRL,TUNDRA,14,1D6,PSGR
260-1030-TNRL	SVC,DRL,TUNDRA,14,3L5,DRVR
260-1030-TNRR	SVC,DRL,TUNDRA,14,3L5,PSGR

# SERVICE PARTS IDENTIFICATION

ITEM	QTY	DESCRIPTION	PART NUMBER
1	1	PASSENGER DRL ASSEMBLY	SEE TABLE
2	1	DRIVER DRL ASSEMBLY	SEE TABLE
3	1	DRL EXTENSION HARNESS	260-BLEXT
4	1	DRL TUNDRA MAIN HARNESS	260-TN14-03
5	1	DRL CONTROL UNIT & HARDWARE	260-TN14-02
6	1	DRL TUNDRA SWITCH & HARNESS	260-TN14-01
7	1	15" WIRE TIE	N/A
8	1	DRL, LIGHT BAR, CLEAR, UNIV	260-1030-01

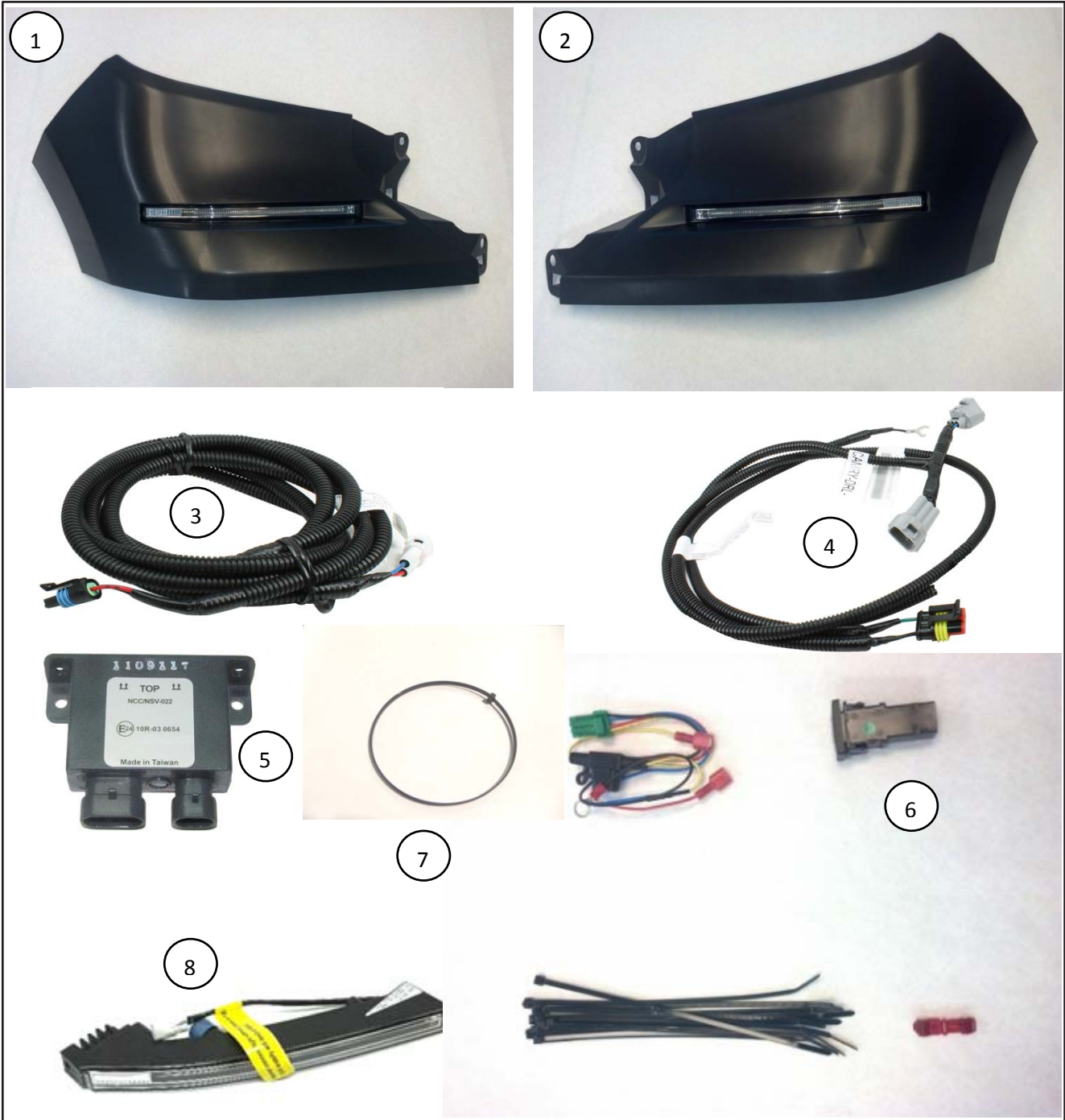

# INSTALLATION



**CAUTION:** It is advisable to disconnect the negative battery cable for 3 minutes before beginning installation to avoid unintended air bag deployment. Note and record any anti-theft radio codes prior to disconnecting.



## VEHICLE PREPARATION



1. LIFT THE HOOD. PLACE PROTECTIVE FENDER COVERS ON THE FENDERS.
2. REMOVE (4) 10MM SCREWS AND 2 CLIPS TO RELEASE THE FRONT GRILL. FIGURES 1 & 2
3. REMOVE THE LEFT AND RIGHT HEADLIGHT TRIM BY DISENGAGING THE TWO CLIPS AS SHOWN IN FIGURE 3.

**NOTE:** BE CAREFUL NOT TO USE EXCESSIVE FORCE ON THE PANELS WHEN REMOVING THEM. USE A TRIM PANEL TOOL AND PULL OUTWARD FROM THE FRONT OF VEHICLE.



FIGURE 1

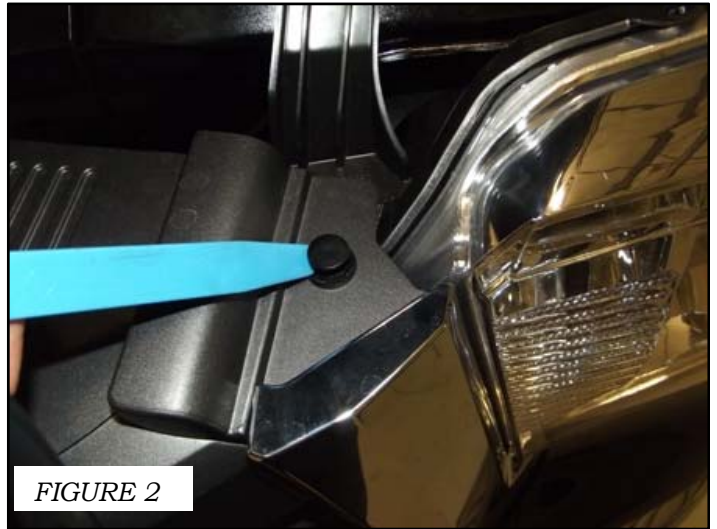

FIGURE 2



FIGURE 3

# VEHICLE PREPARATION

## DRL MOUNTING AND WIRE ROUTING



1. MOUNT THE DRL ASSEMBLIES IN REVERSE ORDER OF REMOVAL OF HEADLIGHT TRIM PANELS. OBSERVE THE PARTS TO MAKE SURE “L” IS MOUNTED ON THE LEFT AND “R” IS MOUNTED ON THE RIGHT. FIGURE 4

2. CONNECT THE DRLs TO THE DRL EXTENSION HARNESS AND ROUTE THE HARNESS ALONG THE FRONT BUMPER SO THAT THE 4-PIN WATERPROOF CONNECTOR AT THE END OF THE HARNESS REACHES THE AREA BEHIND THE LEFT (DRIVER SIDE) HEADLIGHT. SECURE THE HARNESS TO THE FACTORY WIRING AND BUMPER STRUCTURE WITH WIRE TIES. FIGURE 5



FIGURE 4

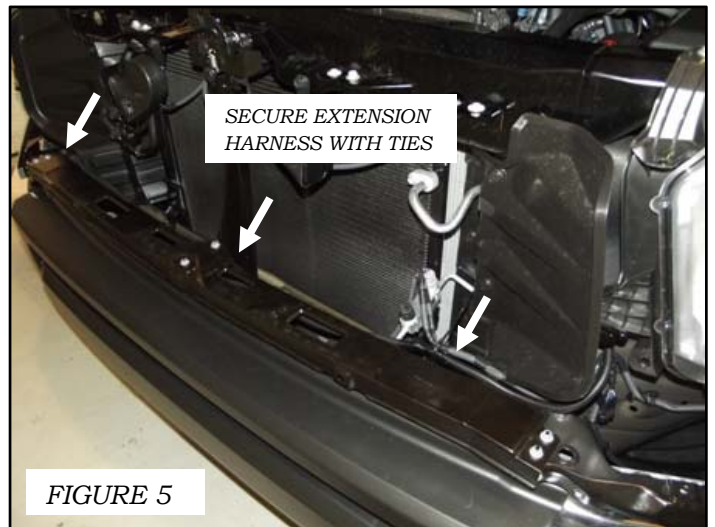

FIGURE 5

# INSTALLATION

## CONTROL MODULE MOUNTING AND WIRE ROUTING



1. MOUNT THE CONTROL MODULE TO THE CHASSIS OF THE VEHICLE IN THE AREA BETWEEN THE LEFT HEADLIGHT AND THE RADIATOR AS SHOWN IN FIGURE 6.

2. CONNECT THE CONTROL MODULE TO THE DRL EXTENSION HARNESS. SECURE THE HARNESS TO OTHER WIRE BUNDLES WITH WIRE TIES.

3. REMOVE THE LEFT PARKING LIGHT CONNECTOR. CONNECT THE SUPPLIED DRL TUNDRA PATCH HARNESS TO THE VEHICLE PARK LIGHT CONNECTOR AND THE PARK LIGHT SOCKET AS SHOWN IN FIGURE 7.

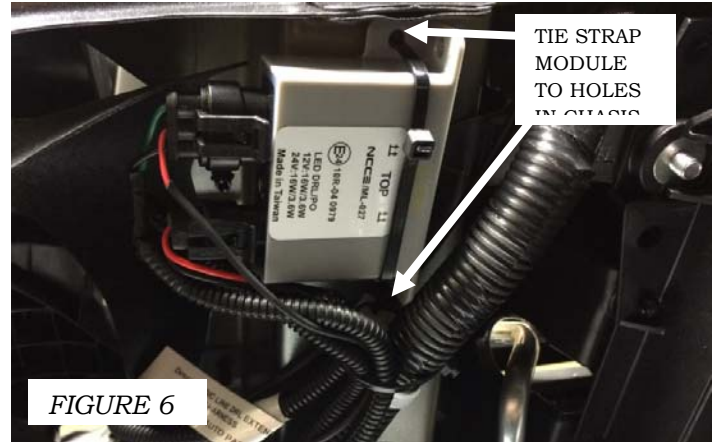

FIGURE 6

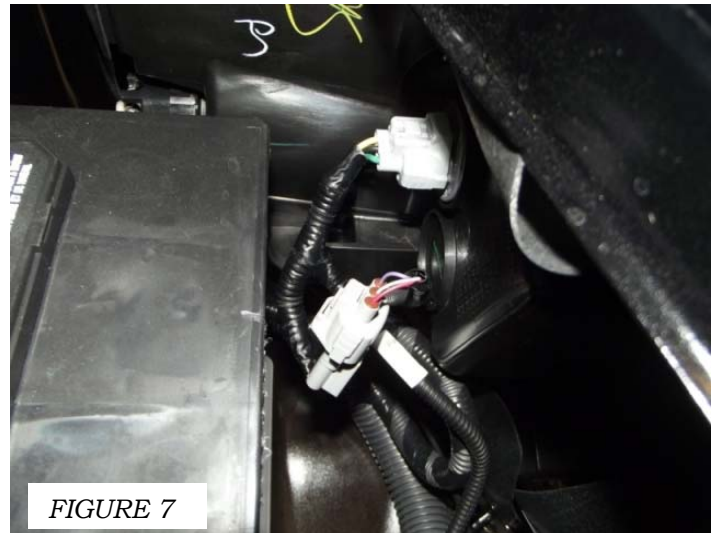

FIGURE 7

# INSTALLATION

## POWER CONNECTIONS AND WIRE ROUTING



1. LOOSEN THE CHASSIS GROUND BOLT TO THE RIGHT OF THE FUSE BOX AND INSERT THE SPADE TERMINAL OF THE BLACK GROUND HARNESS (FROM THE 3-PIN CONNECTOR). TIGHTEN THE GROUND BOLT. FIGURE 8

2. RECONNECT THE 3-PIN SEALED CONNECTOR TO THE CONTROL MODULE. SECURE ALL POWER HARNESSSES TO EXISTING VEHICLE WIRE LOOMS WITH WIRE TIES. USE CARE NOT TO ROUTE THE WIRES TOO TIGHTLY OR NEAR SHARP EDGES.

3. ROUTE THE RED IGNITION WIRE FROM THE CONTROL MODULE TO THE GROMMET ON THE RIGHT SIDE OF THE FIREWALL. CUT HOLE TO ROUTE THE RED WIRE THROUGH THE GROMMET. SECURE THE IGNITION WIRE TO THE FACTORY WIRE LOOM WHERE POSSIBLE. FIGURE 9

4. REMOVE THE LEFT DRIVER DOOR SCUFF PLATE, LOWER LEFT KICKPANEL, AND LEFT SIDE PANEL.

5. ROUTE THE END OF THE RED IGNITION WIRE TO THE AREA IN THE POWER MIRROR CONTROL SWITCH.

6. USING THE RED T-TAP, CONNECT THE YELLOW WIRE OF THE SWITCH HARNESS TO THE LT. GREEN WIRE IN **PIN 8** OF CONNECTOR **J130** ACC TO THE POWER MIRROR CIRCUIT. FIGURES 10 & 11

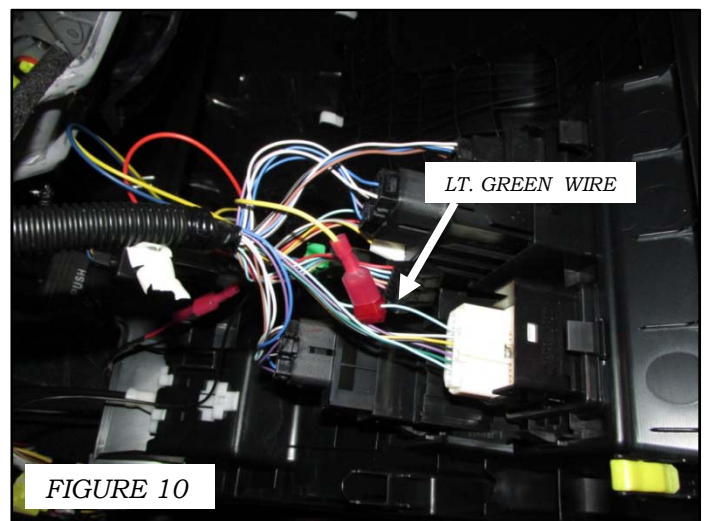
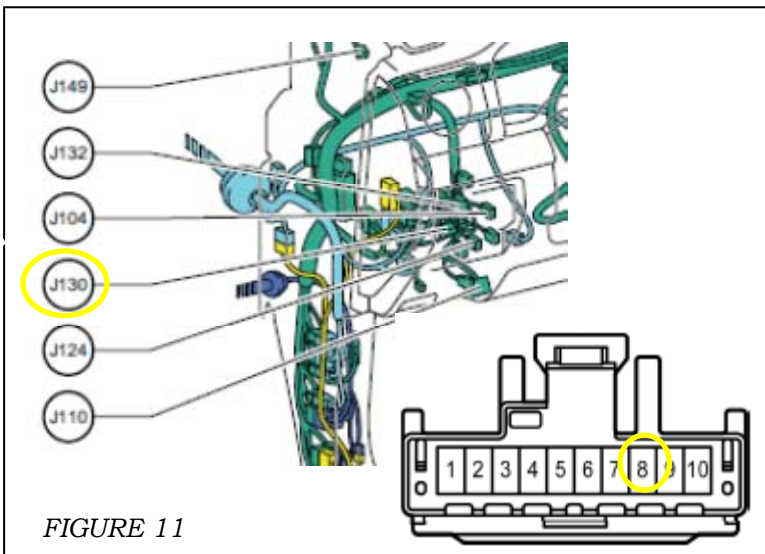
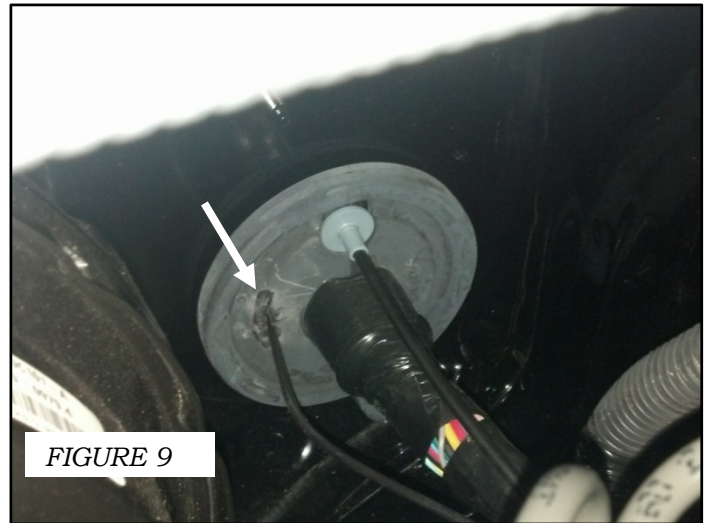
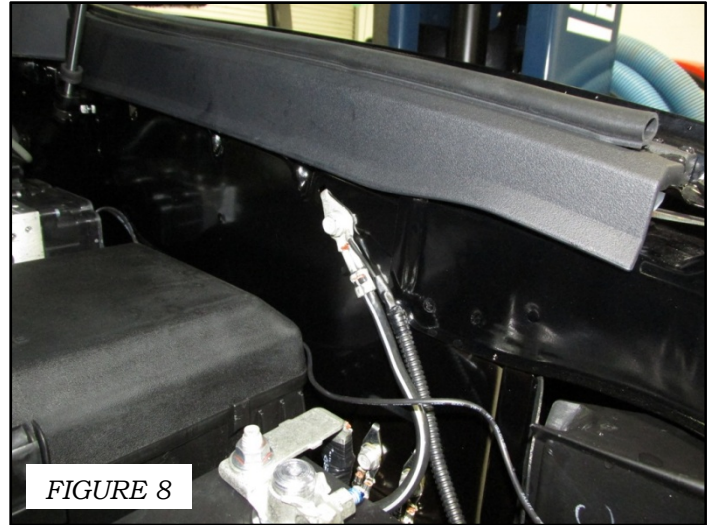

# INSTALLATION

## POWER CONNECTIONS AND WIRE ROUTING (CONT)



7. CONNECT THE RED IGNITION WIRE OF THE SWITCH HARNESS AND THE RED IGNITION WIRE OF THE CONTROL MODULE HARNESS BY MATING THE SPADE TERMINALS. CONNECT THE GROUND RING OF THE LED SWITCH HARNESS TO THE GROUND BOLT AT THE FACTORY GROUND POINT LOCATION. FIGURE 12

8. REMOVE THE KNOCKOUT BLANK ON THE ON THE SWITCH PANEL. INSTALL THE LED SWITCH IN THE PANEL AND CONNECT THE GREEN CONNECTOR OF THE SWITCH HARNESS TO THE SWITCH. FIGURES 13 & 14

## TESTING AND REASSEMBLY



1. REINSTALL ALL TRIM PANELS IN THE ORDER OF REMOVAL, TAKING SPECIAL CARE TO MAKE SURE ALL HARNESSES AND WIRING ARE PROPERLY SECURED. MAKE SURE HARNESSES ARE NOT PINCHED OR BOUND BY TRIM PIECES.



2. RECONNECT NEGATIVE BATTERY CABLE AND TORQUE TO 3 FT LBS. RE-ENTER ANY THEFT DETERRENT INFORMATION IF APPLICABLE.

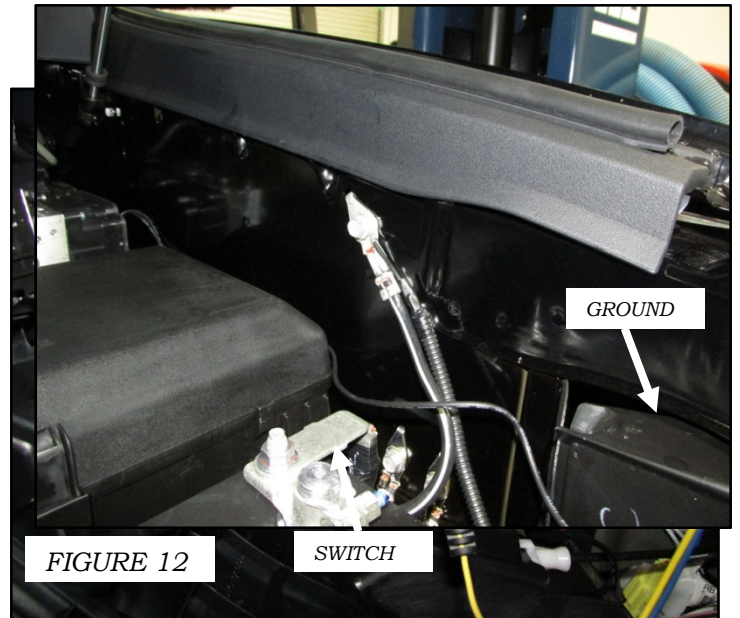

FIGURE 12

SWITCH



FIGURE 13



FIGURE 14



# INSTALLATION

## FUNCTION CHECKS

CHECKLIST - THESE POINTS **MUST** BE CHECKED TO ENSURE A QUALITY INSTALLATION

### ACCESSORY FUNCTION CHECK

CHECK:	LOOK FOR:
DRL LED ARRAYS (LEFT AND RIGHT) IN DAYTIME MODE	TURN THE IGNITION TO THE ON POSITION. VERIFY THAT ALL 10 LEDs ARE ILLUMINATED AT FULL POWER.
DRL LED ARRAYS (LEFT AND RIGHT) IN NIGHTTIME MODE	WITH THE IGNITION ON, TURN THE HEADLIGHT SWITCH TO THE PARKING LAMP POSITION. VERIFY THAT THE PARKING LIGHTS ARE ON AND THAT ALL 10 LEDs ARE ILLUMINATED AT REDUCED POWER.
DRL LED ARRAYS (LEFT AND RIGHT)	VERIFY THAT ALL 10 LEDs ARE OFF WHEN IGNITION IS OFF.

### VEHICLE FUNCTION CHECK

VEHICLE FUNCTION:	VEHICLE FUNCTION DETAIL:
IGNITION	VERIFY THAT THE VEHICLE WILL CRANK.
SRS WARNING LIGHT	CONFIRM SRS WARNING LIGHT ILLUMINATES FOR APPROXIMATELY 6 SECONDS WITH THE IGNITION ON, AND THEN GOES OUT.
CRUISE CONTROL INDICATOR LIGHT (IF EQUIPPED)	WITH IGNITION ON, VERIFY "CRUISE" LIGHT ON INSTRUMENT PANEL ILLUMINATES WHEN THE CRUISE POWER BUTTON IS PRESSED.

### KIT SERVICE INFORMATION

ITEM:	LOCATION:
5-AMP IN-LINE FUSE	THE FUSE IS INSERTED IN THE TOP SLOT OF THE DRL FUSE ADAPTER WHICH IS LOCATED IN POSITION 28 OF THE UNDERHOOD FUSE BLOCK.