

Congratulations on your purchase of an Arnett® air suspension product. We at Arnett Incorporated are proud to offer a high quality product at the industry's most competitive pricing. Thank you for your confidence in us and our product.

Proper installation is essential to experience and appreciate the benefits of this system. Please take a moment to review these installation instructions before you begin to install these components on your vehicle. The removal and installation of air suspension products should only be performed by a fully qualified, ASE Certified, professional.

It is equally important to be aware of all necessary safety measures while installing your new Air Suspension System. This includes proper lifting and immobilizing of the vehicle and isolation of any stored energy to prevent personal injury or property damage.

"Engineered to Ride, Built to Last™"



WARNING: *The air suspension system is under pressure (up to 10 bar, or 150 lbf/in). Verify pressure has been relieved and disconnect power to the air suspension system prior to disassembly. Do not allow dirt or grease to enter the system. Always wear standard hand, ear, and eye protection when servicing the air suspension system.*

GENERAL INFORMATION:

Reading this manual signifies your agreement to the terms of the general release, waiver of liability, and hold harmless agreement.

- Not to be stored below 5°F (-15°C) and above 122°F (50°C).
- Avoid damage to air lines and cables.
- Removal and installation is only to be performed by fully qualified personnel.
- Use car manufacturer's diagnostic software.

CAUTION: *Damage to the vehicle and air suspension system can be incurred if work is carried out in a manner other than specified in the instructions or in a different sequence.*



To avoid the possibility of short circuits while working with electric components consult your owner's manual on how to disconnect your battery.



Consult your vehicle owner's manual, service manual, or car dealer for the correct jacking points on your vehicle and for additional care, safety and maintenance instructions. Under no circumstances should any work be completed underneath the vehicle if it is not adequately supported, as serious injuries and death can occur.

AIR STRUT REMOVAL

1. SET STEERING TO STRAIGHT AHEAD.
2. RAISE VEHICLE.
3. REMOVE FRONT WHEEL.
4. DISCONNECT THE SWAY BAR LINKAGE. (FIGURE 1)

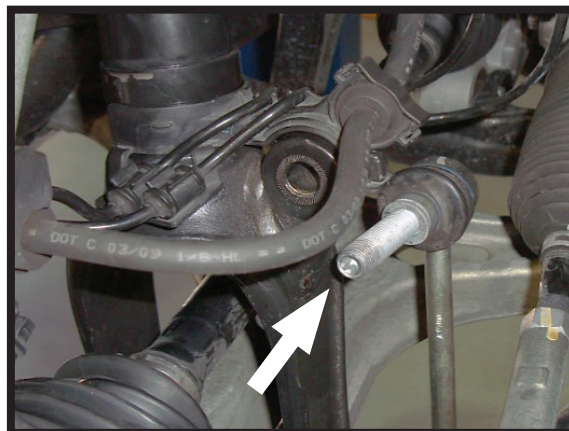

FIGURE 1

5. REMOVE THE NUT FROM THE BALL JOINT AND SEPARATE FROM THE SPINDLE ASSEMBLY. (FIGURE 2)



FIGURE 2

6. CUT THE CABLE TIE SECURING THE WIRE HARNESS MOUNT, THEN REMOVE THE WIRE HARNESS MOUNT FROM SHOCK. (FIGURE 3)

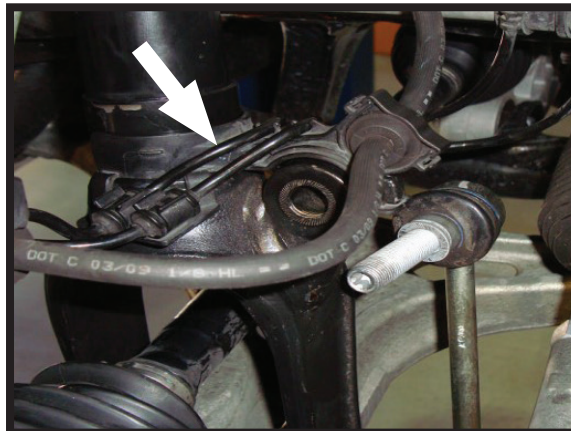

FIGURE 3

7. DISCONNECT THE AIR LINE BY UNSCREWING THE BRASS FITTING FROM THE STRUT'S TOP MOUNT. (FIGURE 4)

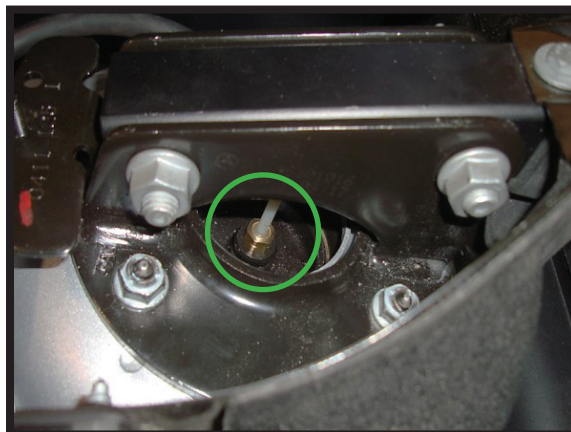

FIGURE 4

8. REMOVE THE THREE (3) UPPER MOUNT FLANGE NUTS. (FIGURE 5)

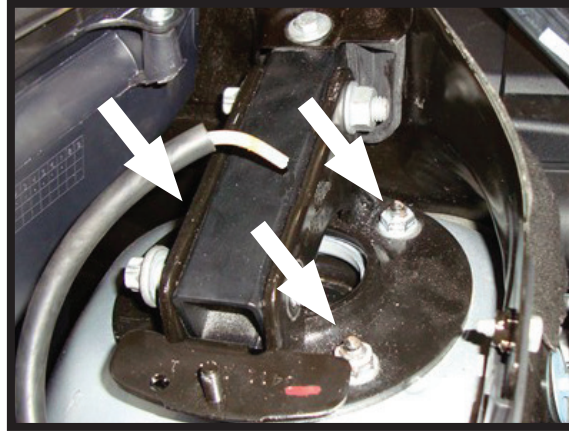

FIGURE 5

9. REMOVE THE LOWER SHOCK MOUNT NUT, FOLLOWED BY THE BOLT AND REMOVE THE STRUT FROM THE VEHICLE. (FIGURE 6)

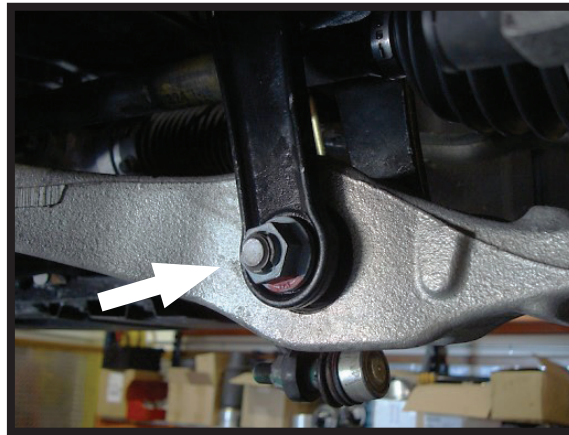

FIGURE 6

AIR STRUT INSTALLATION



Tighten all nuts and bolts to manufacturer's specifications during the installation process.



Do not remove the air fitting from the air strut. Doing so may cause damage and/or void warranty. Remove the white shipping pin from the new air fitting and insert the air line until fully seated.

1. INSTALL THE REPLACEMENT STRUT ONTO THE VEHICLE IN THE SAME ORIENTATION AS REMOVED. (FIGURE 7)



FIGURE 7

2. INSTALL THE LOWER SHOCK MOUNT BOLT AND NUT, TIGHTEN TO MANUFACTURE'S SPECIFICATION. (FIGURE 8)

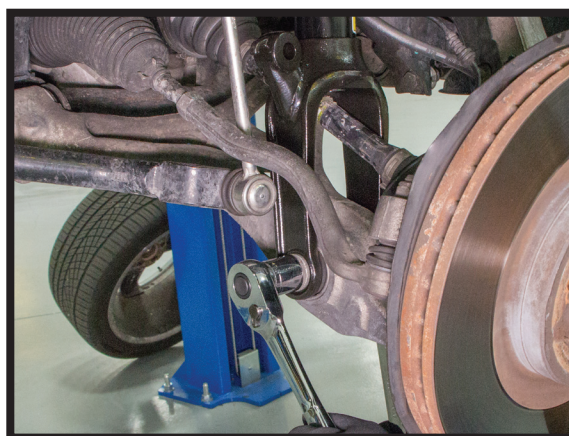

FIGURE 8

3. REATTACH THE SPINDLE ASSEMBLY AND INSTALL THE NUT ONTO THE BALL JOINT, TIGHTEN TO MANUFACTURE'S SPECIFICATION. (FIGURE 9)

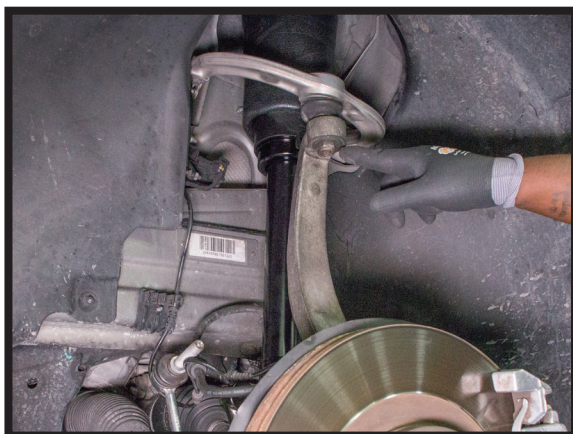

FIGURE 9

4. USING THE SUPPLIED CABLE TIE, SECURE THE WIRE HARNESS MOUNT TO THE SHOCK. (FIGURE 10)

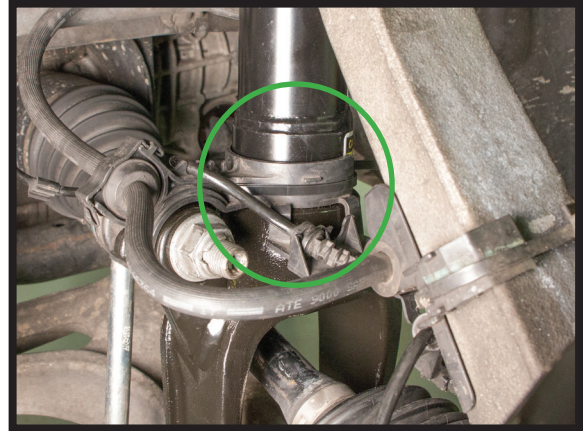

FIGURE 10

5. USING THE SUPPLIED HARDWARE, INSTALL AND TIGHTEN THE TOP MOUNTING NUTS TO MANUFACTURE'S SPECIFICATION . (FIGURE 11)



FIGURE 11

6. REMOVE THE AIR LINE FITTING. TO DO SO, SPREAD THE COLLET OPEN AND THE REMAINING FITTING WILL SLIDE OFF OF THE AIR HOSE. (FIGURE 12)

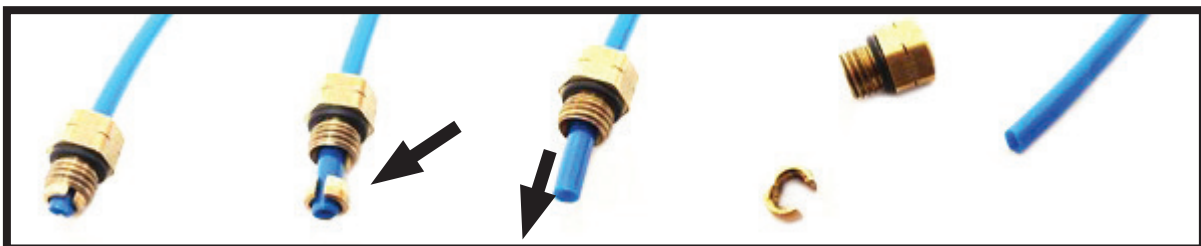

FIGURE 12

7. REMOVE THE PLASTIC SHIPPING PIN FROM THE AIR INLET FITTING, PUSH THE AIR HOSE IN UNTIL FULLY SEATED INTO PLACE (AIR LINE WILL NOT PULL OUT WHEN INSERTED PROPERLY). (FIGURE 13)

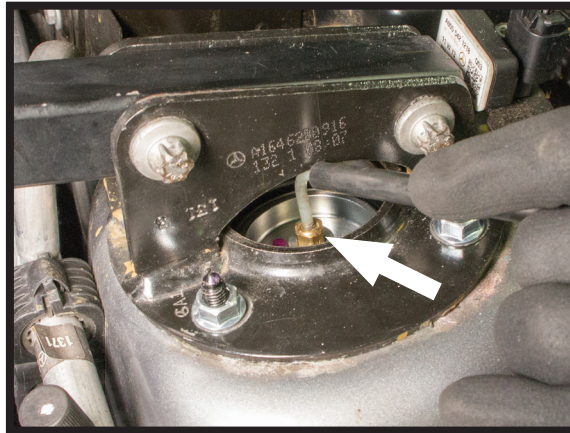

FIGURE 13

8. INSTALLATION COMPLETE.