

# AMP RESEARCH BedStep 2™

Toyota Tundra  
Double Cab / Regular Cab  
2007-2013

PART NUMBER:  
75409-01A

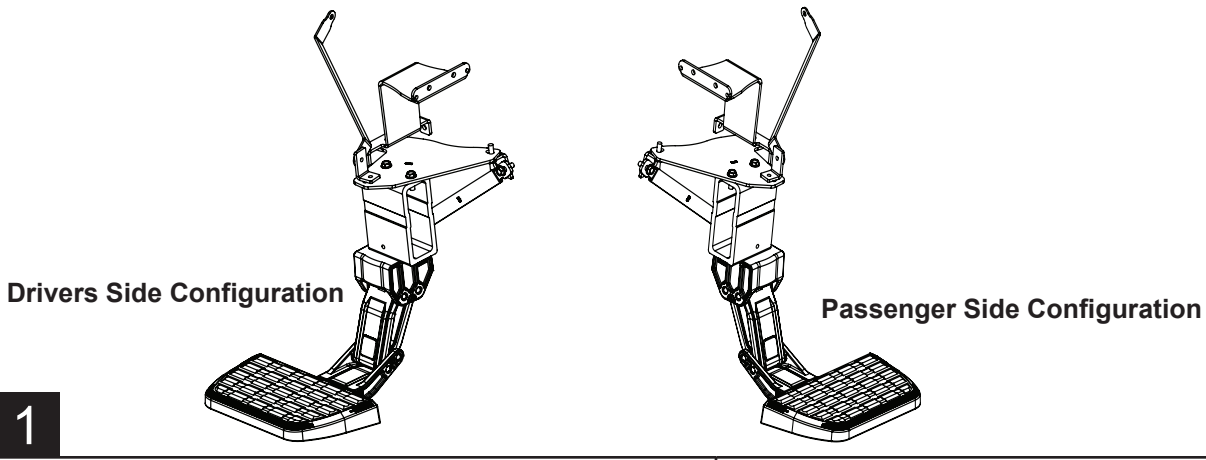
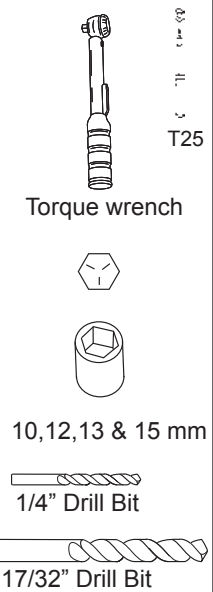
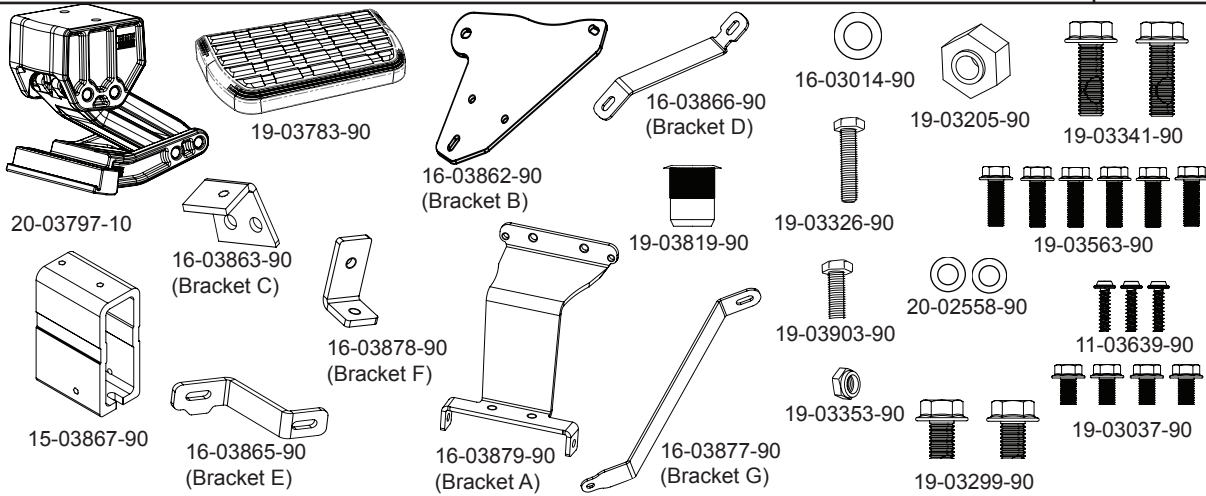

Using a 12mm socket or wrench loosen both brake cable brackets. **Note: Passenger side only has one bracket to remove.**

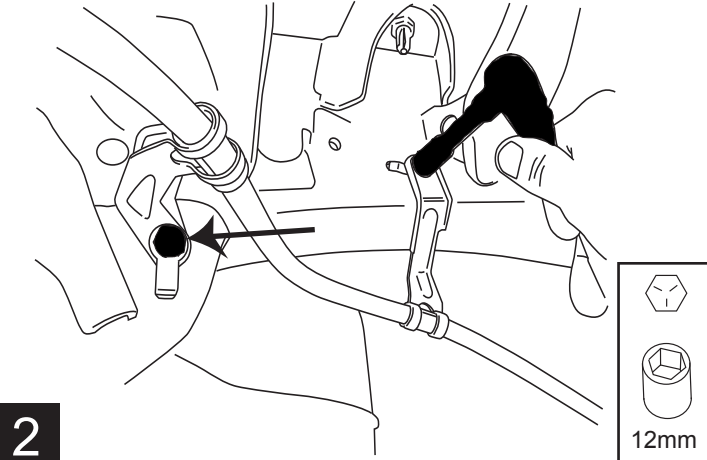

Bolt **Bracket A** up to bed support rib.

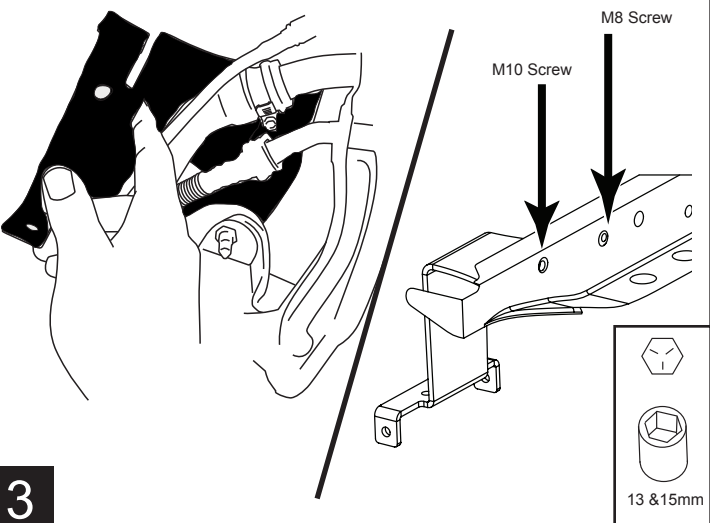

Mark hole to be drilled in frame. Remove **Bracket A**. Center Punch hole, pre drill using an 1/8" drill. Drill to 17/32".

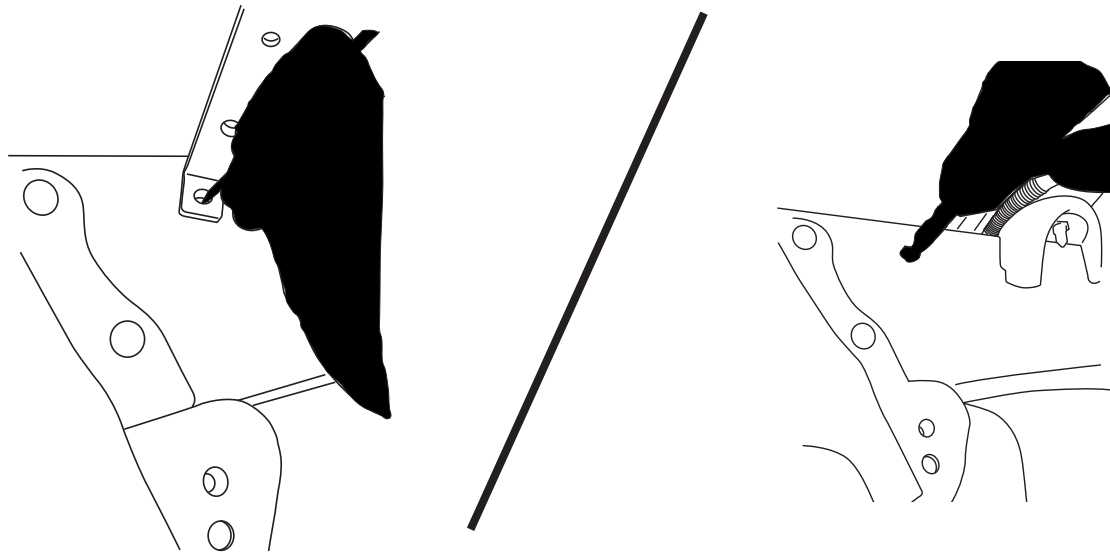

4

With Rivet Nut Tool held in place with 19mm wrench, tighten Hex Bolt until Rivet Nut deforms and secures itself to the frame (20 ft-Lbs. or 4 turns).

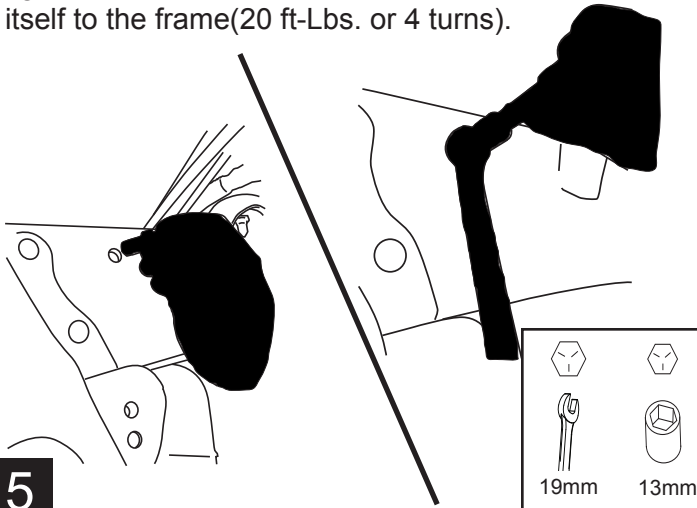

5

Reinstall Bracket A to bed support rib. Install provided bolt into rivet nut installed in step 5.

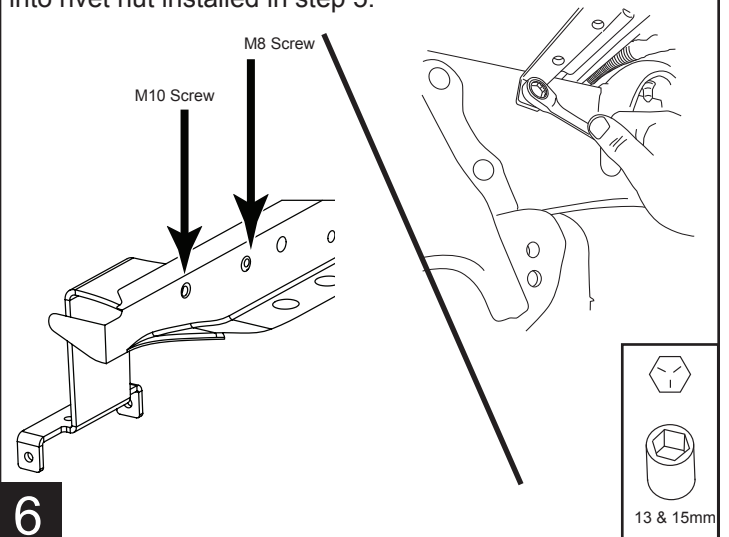

6

Using provided flange head bolt slide brake cable bracket onto bolt then **Bracket C** followed by **Bracket D**. Do not tighten bolt.

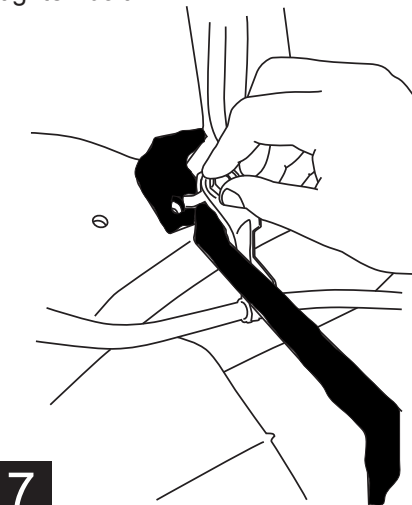

7

Using provided shorter flange head bolt tighten "Bracket B" to "Bracket C". Torque bolt to 16 ft-lbs.

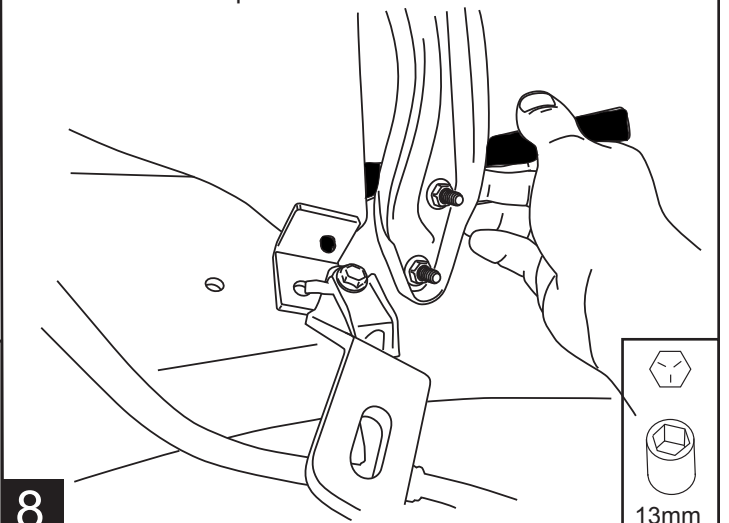

8

Use provided shorter flange head bolt and tighten **Bracket F** to **Bracket B**. Torque to 16 ft-lbs with 13mm socket. Using a 14mm socket or wrench torque body mount bolt from step 5.

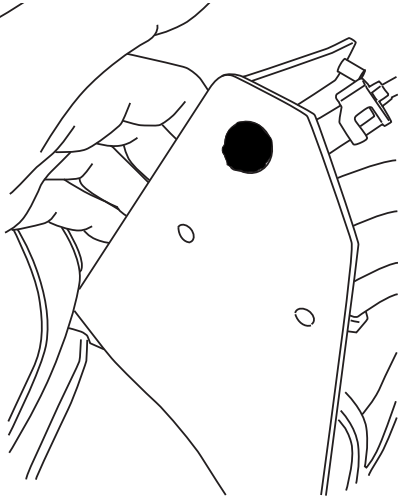

9

Install Bracket G onto Bracket F and use provided bolts, washer and nut to attach bracket to Front support rib.

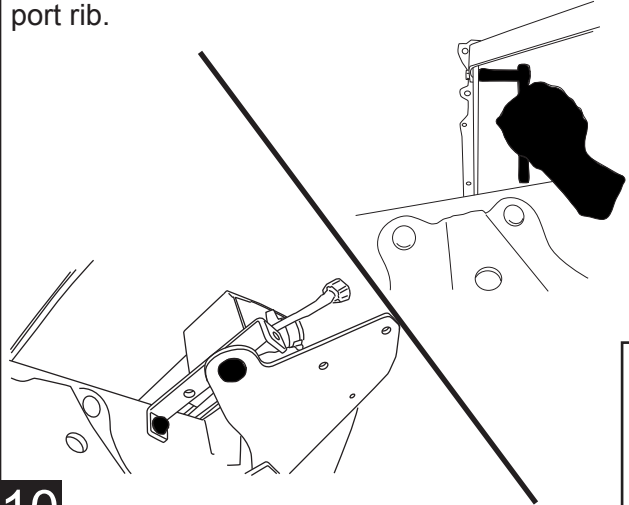

10

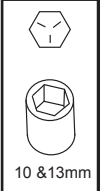

Using "Bracket E" and provided flange head bolt re attach brake cable bracket. Do not tighten.

Driver Side

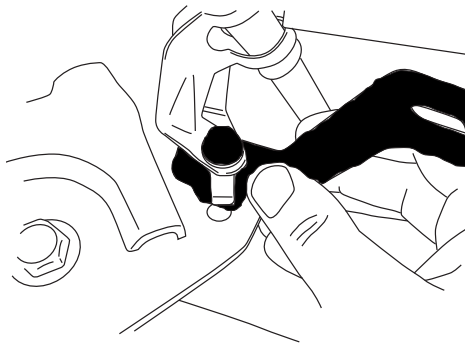

11

Passenger Side



Note: Passenger side bracket will need supplied nut to tighten bracket into place. Use the upper hole. Do not tighten

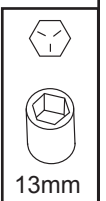

Set Flange bolts in through "Bracket B"

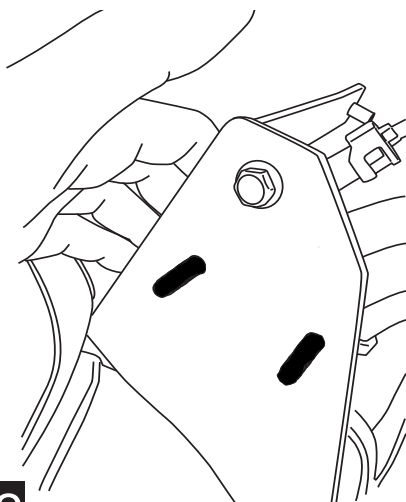

12

Set frame mount into position and tighten two bolts. Torque to 16 ft-lbs. **Note: See step 1 for orientation on passenger side.**

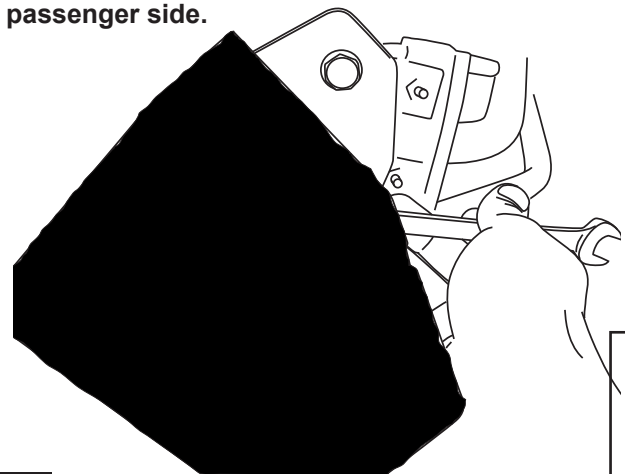

13

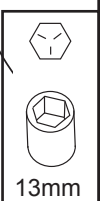

Set "Bracket E" and "Bracket D" together using provided flange head screw tighten bolts. Tighten bolts from Step 6 and 9. Torque to 16ft-lbs.

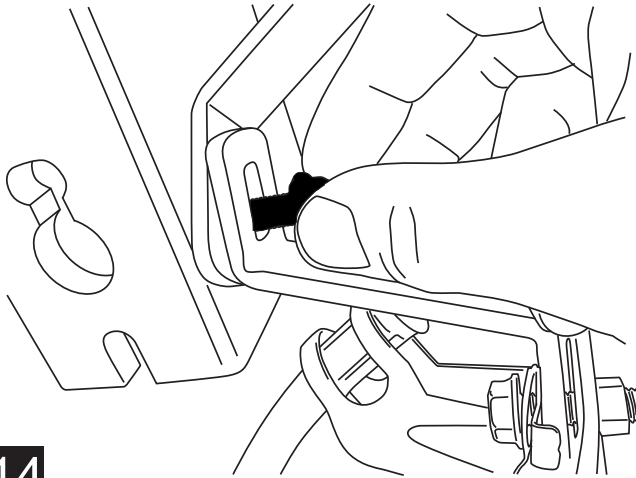

14

Set step pad into center position and tighten screws. Tighten to 5 ft-lbs.



15



Using 15mm socket or wrench install bolts into linkage assembly. Thread bolts in about half way.

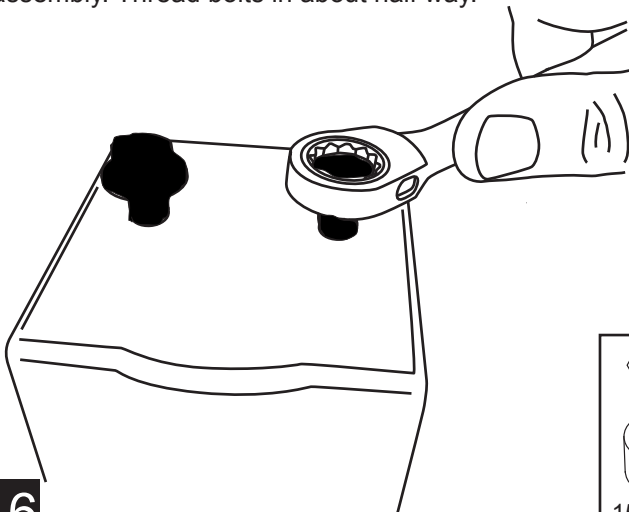

16

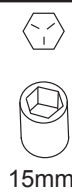

17

Slide linkage assembly into slot and hole and slide into position.

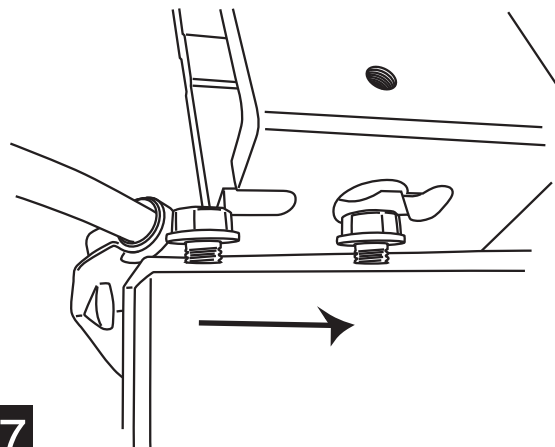

Once step pad is in adjusted position tighten bolts. Torque to 20 ft-lbs.



18

