

INSTALLATION GUIDE

AMP
RESEARCH **Power Step**
MADE IN USA

RUNNING BOARD TRIM STRIP

Requires New Twin Rib Extrusion

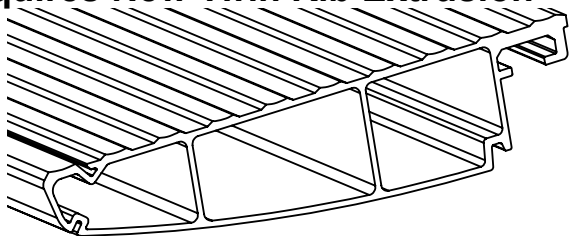

Trim Strip Part #

10-75149-90

10-75150-90

Board Length

79"

85"

INSTALLATION TIME

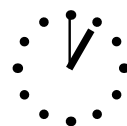

1:00 hr

SKILL LEVEL



2= Moderate

TOOLS REQUIRED

- Safety glasses
- 3/16 Allen
- Saw (some Applications)

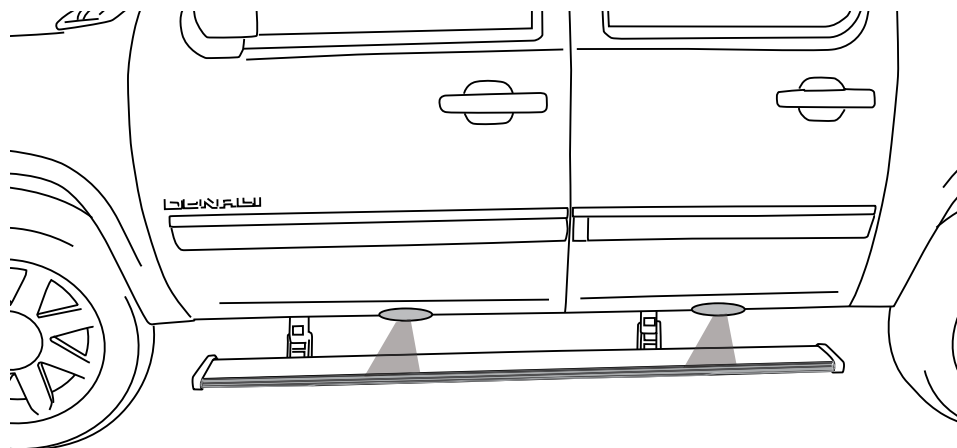

① x2

10-75149-90 (79" Board)
10-75150-90 (85" Board)
Trim Strip

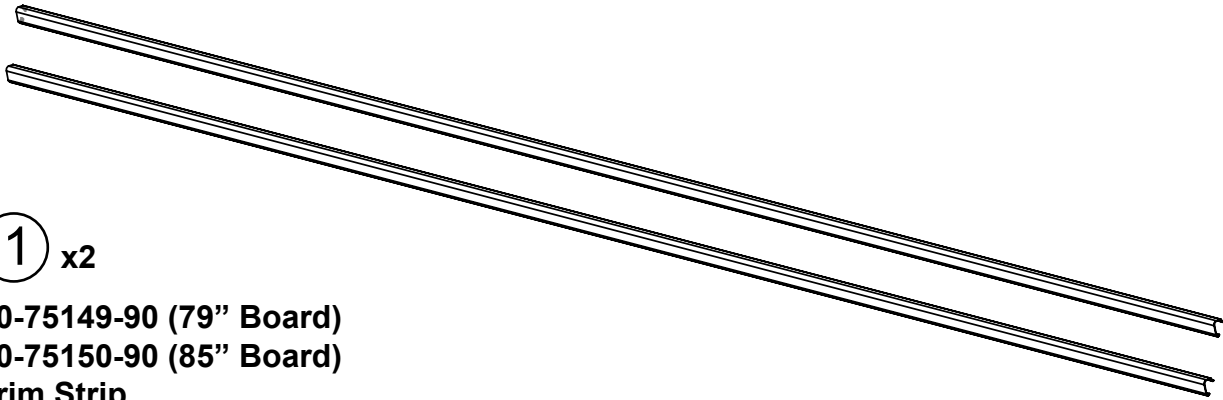

Using a 3/16" Allen head loosen screw on end cap.

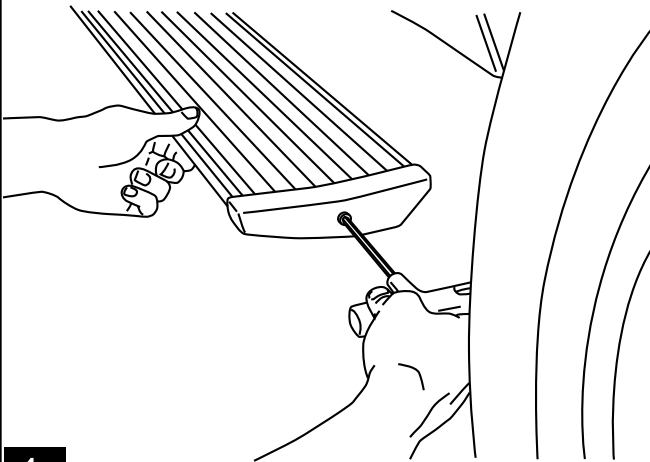

1

Remove end cap.

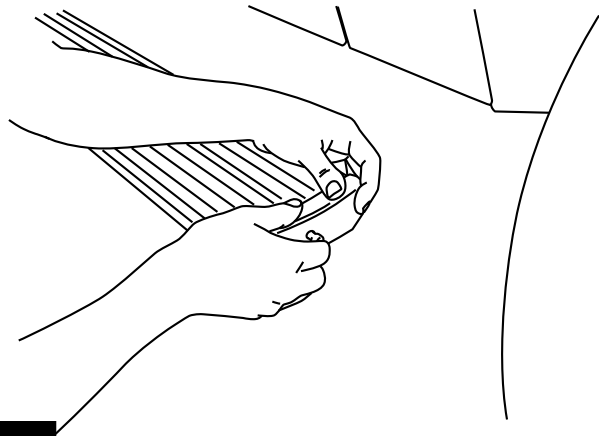

2

Peel off protective film on Trim Strip.

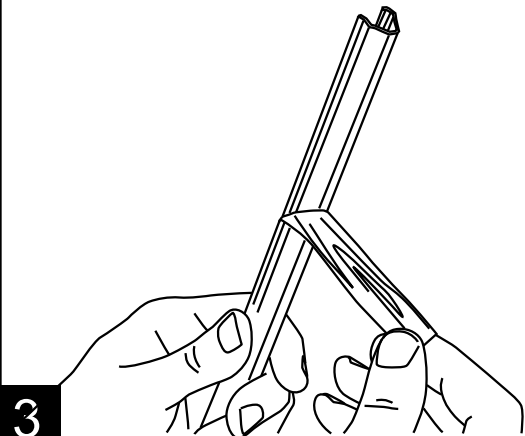

3

Line Trim Strip to the groove on the Running Board Extrusion. See Step 5 for proper Trim Strip engagement. **Caution: Trim Strip edges can be sharp.**

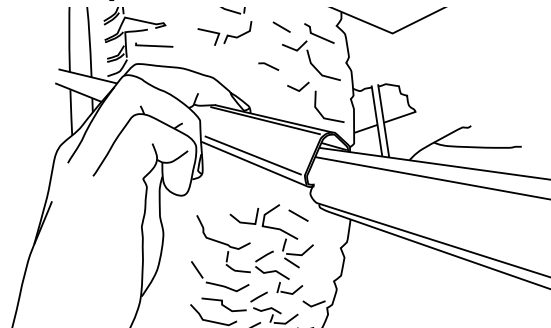

4

NOTE: Wheels may need to be adjusted to allow for clearance during install.

NOTE: Trim Strip should be lined up in both the upper and lower grooves.

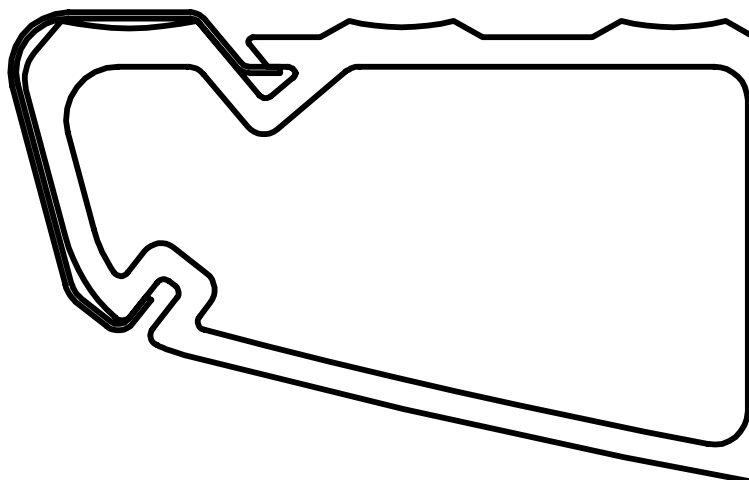

5

With Trim Strip lined up to the groove slide it onto Running Board and under the cap on the opposite end. **Ensure that the Trim Strip does not buckle during install.**
Caution: Trim Strip edges can be sharp.

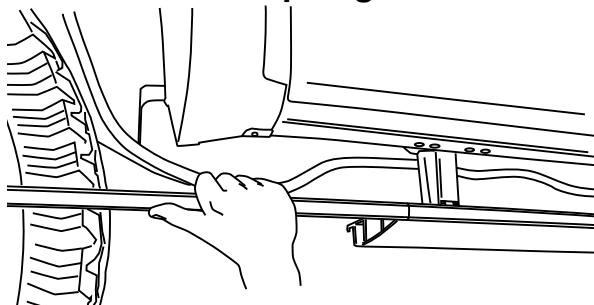

6 Once Trim Strip is installed verify that it is properly engaged along the Running Board.

If End Cap wedge was completely removed reinstall onto End Cap.

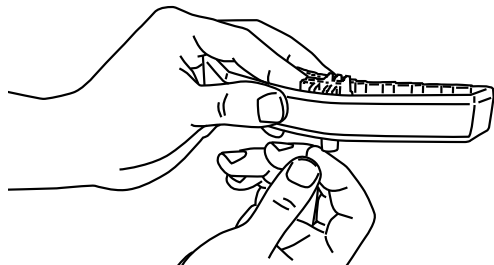

Wedge Orientation

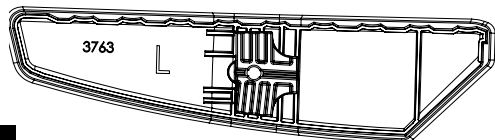

Note: Left and Right End Caps have matching Wedges.

8

Cutting may be required if your Running Board is less than 79". Excess material can be trimmed with a Hacksaw.

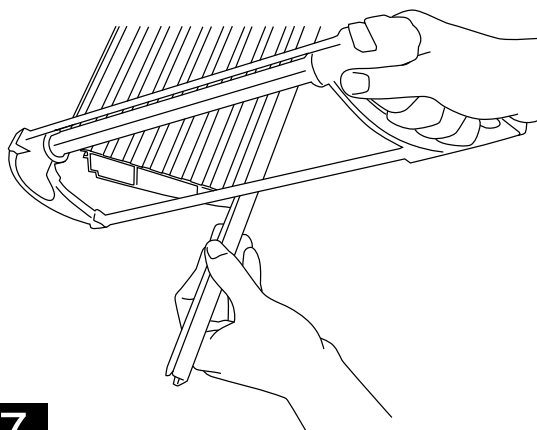

7

Slide End Cap onto board.

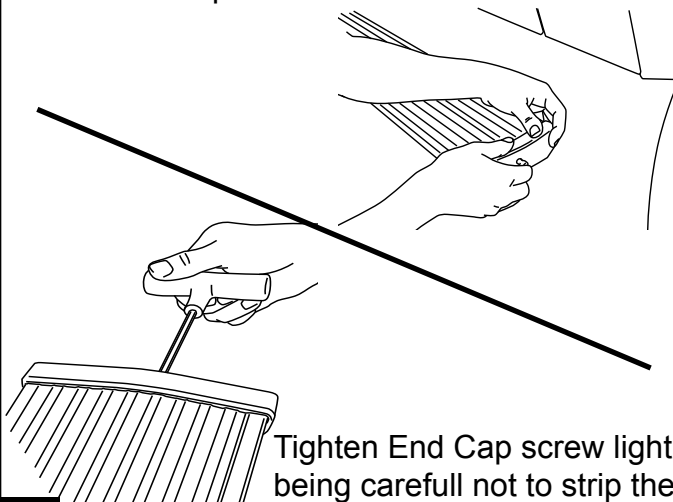

Tighten End Cap screw lightly being carefull not to strip the End Cap Wedge.

9