

# INSTALLATION GUIDE

# **AMP** **RESEARCH** Power Step MADE IN USA

| APPLICATION         | LENGTH | MODEL YR  | PART #    |
|---------------------|--------|-----------|-----------|
| Ford F150 SuperCab  | 72"    | 2009 - up | 75141-01A |
| Ford F150 SuperCrew | 79"    | 2009 - up | 75141-01A |

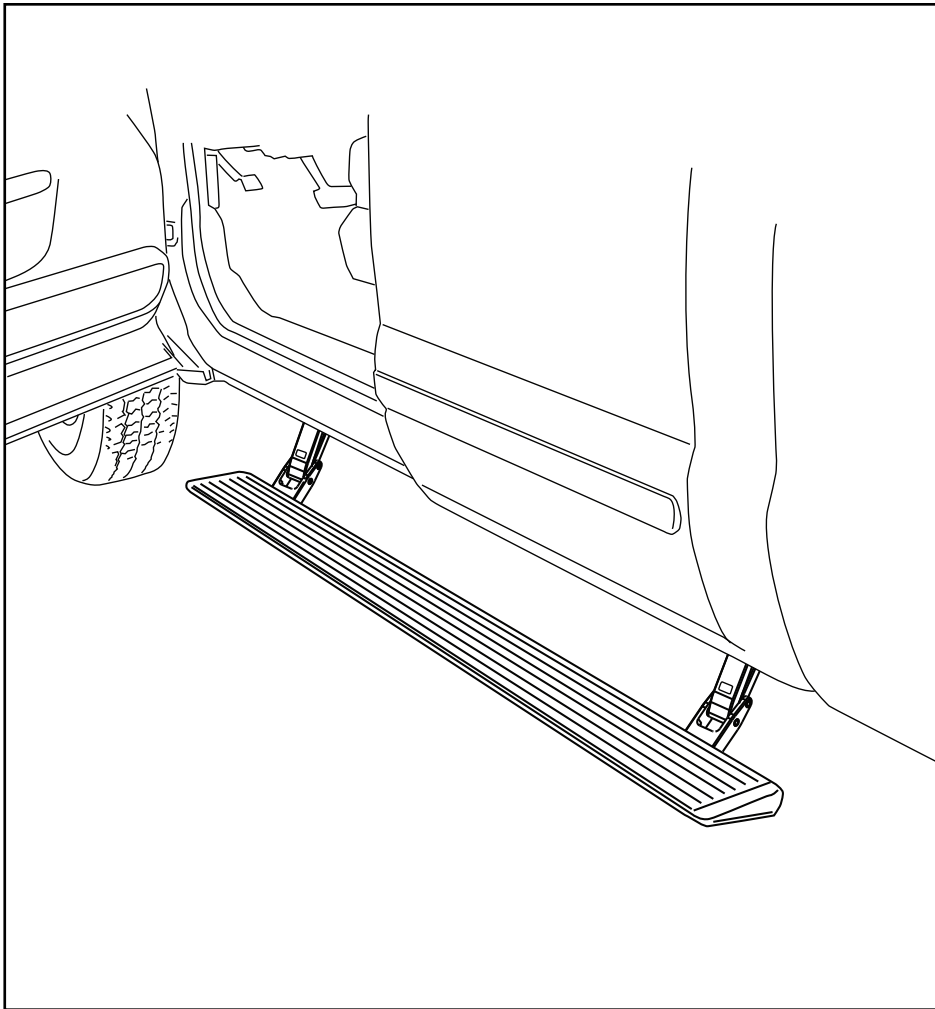

## INSTALLATION TIME

**3-5 Hours**

Professional installation recommended

## SKILL LEVEL



4= Experienced

## TOOLS REQUIRED

- Safety goggles
- 8 mm socket
- 10 mm socket
- 13 mm socket
- 13 mm end wrench
- Ratchet wrench and extension
- Wire stripper
- 3/16" hex key wrench ( allen wrench)
- 4mm hex key wrench ( allen wrench)
- Electrical tape
- Weather proof caulking ( silicone sealer )

## INSTALLATION GUIDE

### Attaching motor to linkage assembly

The motors must be attached to the linkage assemblies before continuing the installation process.

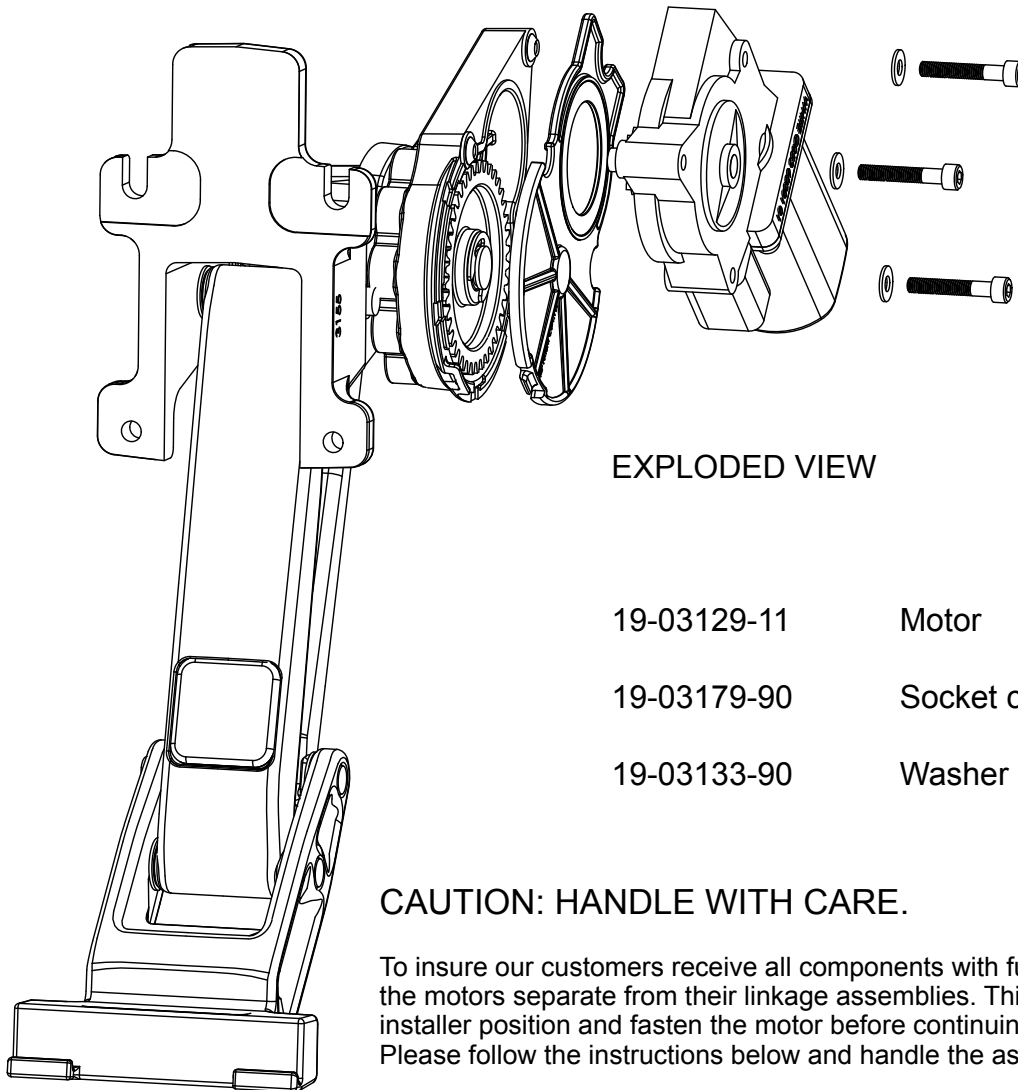

EXPLODED VIEW

|             |                  |
|-------------|------------------|
| 19-03129-11 | Motor            |
| 19-03179-90 | Socket cap screw |
| 19-03133-90 | Washer           |

#### CAUTION: HANDLE WITH CARE.

To insure our customers receive all components with full integrity, we pack the motors separate from their linkage assemblies. This requires that the installer position and fasten the motor before continuing with the install. Please follow the instructions below and handle the assembly carefully.

CAUTION: Dropping the assembly or any excessive impact MAY cause damage to the motor.

#### Instructions:

1. Position the gear cover in place as shown if not already in place.
2. Seat motor into position on the three mounting bosses. This may require an adjustment of the gear by moving the swing arms.
3. After seating into place, fasten the motor with the three motor mount screws with T30 Torx. Tighten screws to 36 in-lbs (4N-m). Do not over torque.

**Note: Some Applications require modification.**

| Application | Cut Length                     |
|-------------|--------------------------------|
| Super Crew  | 79" (No Modification Required) |
| Super Cab   | 72" (Trim 7")                  |

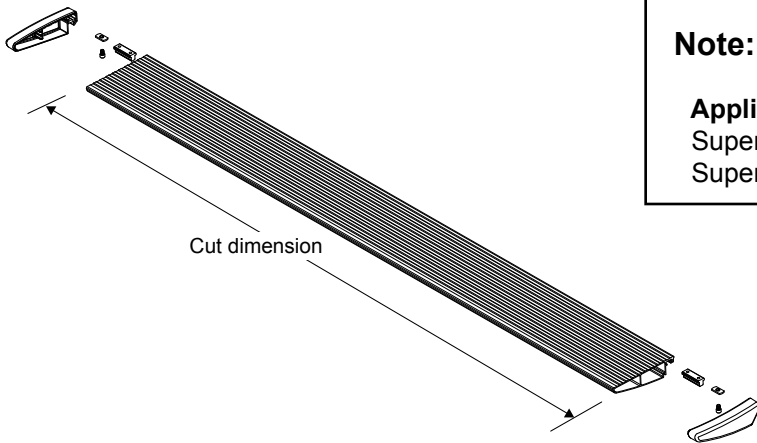

**1** x2  
20-03314-XX  
Running board assembly

- (A) 19-03225-11 End cap left (x1)
- (B) 19-03225-12 End cap right (x1)
- (C) 19-02663-90 T-nut insert (x2)
- (D) 19-03236-90 Socket cap screw (x2)
- (E) 19-03237-90 Nut plate (x2)

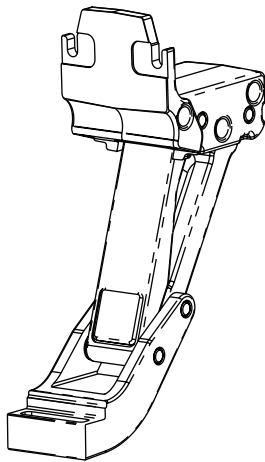

**2** x2  
10-03007-11  
Idler linkage assembly

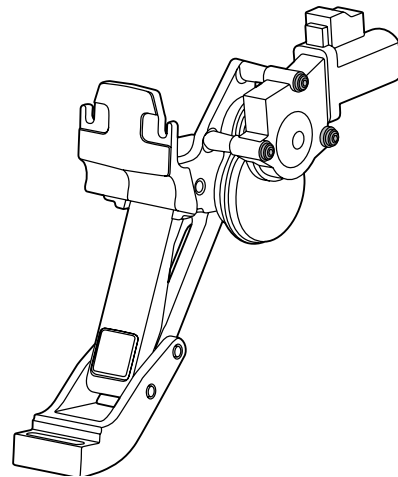

**3** x2  
10-03006-11  
Motor linkage assembly

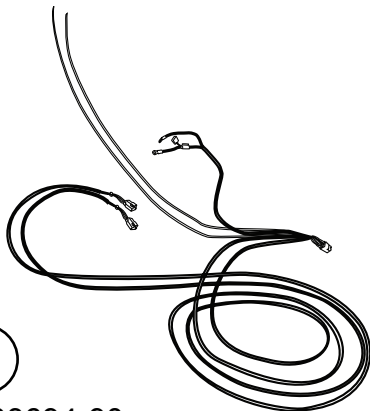

**4**  
19-03694-90  
Wire harness

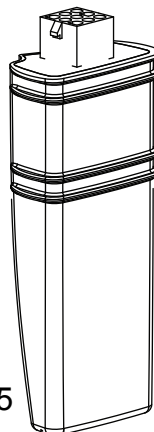

**5**  
19-03297-B05  
Controller

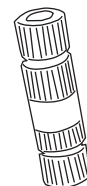

**6** x4  
19-03354-90  
Posi-Tap™ (Red/Grey)

PARTS LIST AND  
HARDWARE  
IDENTIFICATION

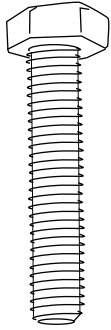

**7** x8  
19-02487-90  
Hex bolt

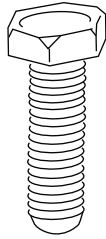

**8** x 8  
19-02849-90  
Hex Bolt

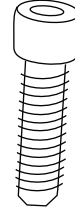

**9** x8  
19-02802-90  
Socket cap screw



**11** x8  
19-02488-90  
U-nut

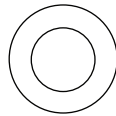

**12** x16  
16-03014-90  
Washer Black

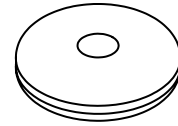

**13**  
19-03699-90  
Grommet



**14** x25  
19-02805-90  
Cable Ties 7"

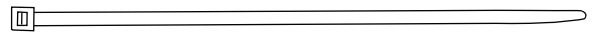

**15** x2  
19-03339-90  
Cable Ties 11"

Locate mounting points; first and last set of holes on the inner sill.

Motor Linkage mounts toward the rear of the truck, with the exception of the passenger side on SuperCab trucks. Mount the motor linkage in front on the passenger side of SuperCab trucks. On SuperCab trucks tie up extra wire with supplied wire ties. **Light wires will need to be pulled out of the harness to allow lights to be installed in proper position.**

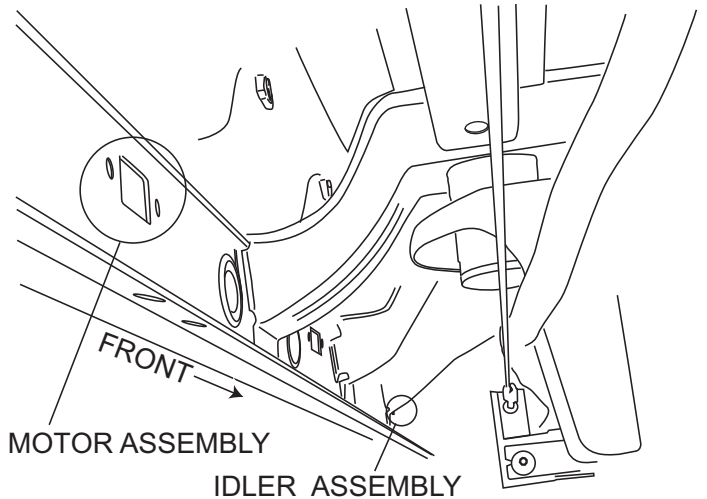

1

Install J-clips and start bolts with washers installed.

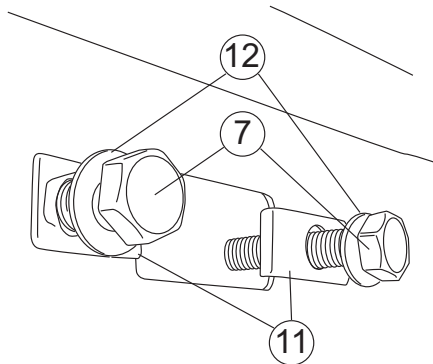

2

Mount idler assembly and motor assembly. Note: Filing of sheet metal edge may be required if the sheet metal holes are misaligned.

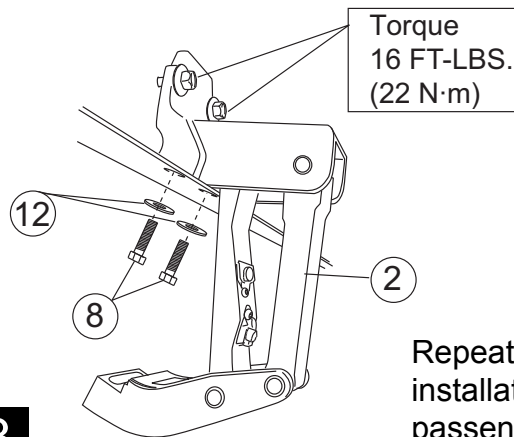

3

Repeat linkage installation on passenger side

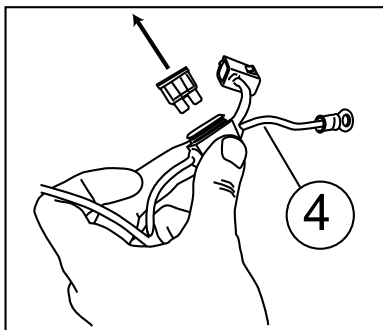

Remove fuse from wire harness

4

Attach wire harness to controller (make sure connector locking tabs fully engage). Mount controller with the two 11" tie wraps to factory conduit.

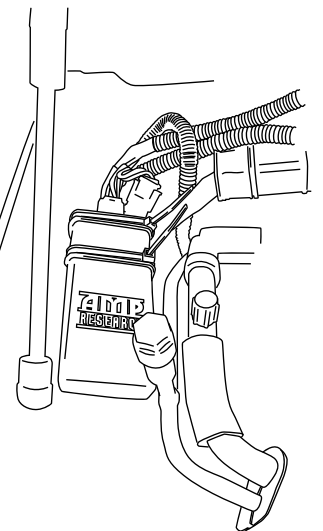

5

Connect red and black power leads to battery. Red lead goes to positive. Route shorter leg of harness down passenger-side wheel well.

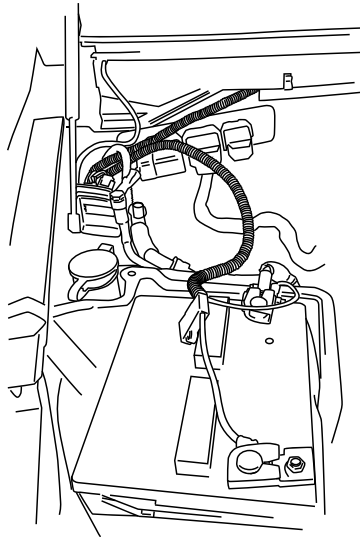

6

Route longer wire harness leg across firewall through plastic cowling to driver side.

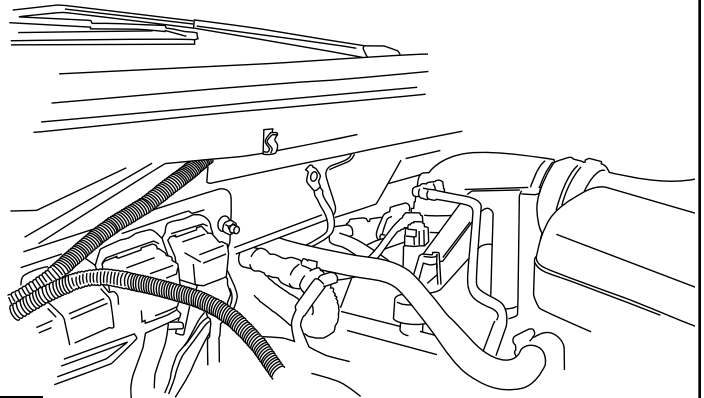

7

Route longer leg of harness down along driver-side wheel well and along frame of vehicle. Secure with tie wraps. NOTE: Super Cab models will have extra wire.

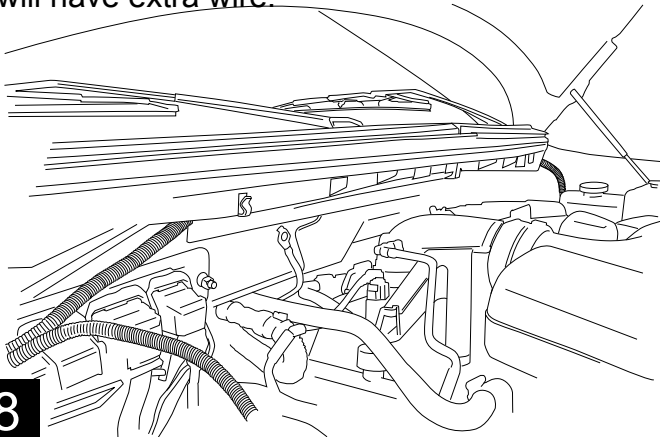

8

Remove passenger side front kick panel and door sill plate. Roll back carpet to access hole for grommet installation.

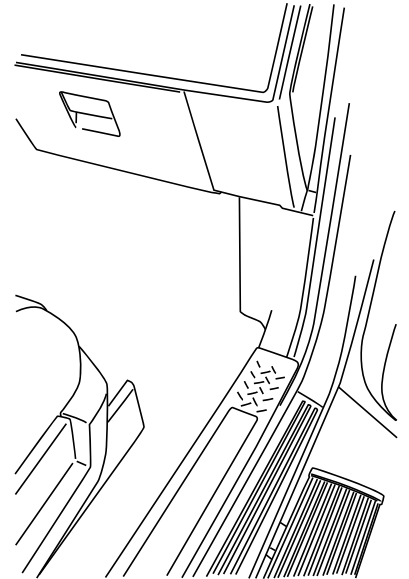

9

Remove tape from 3/4" hole in floor panel above front linkage on passenger side and insert grommet. Thread all four trigger wires through grommet up into the cabin of vehicle. Seal grommet with silicone sealer.

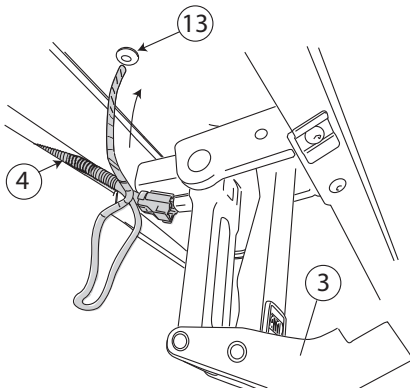

10

Wiring connections are located under the passenger side kick panel.

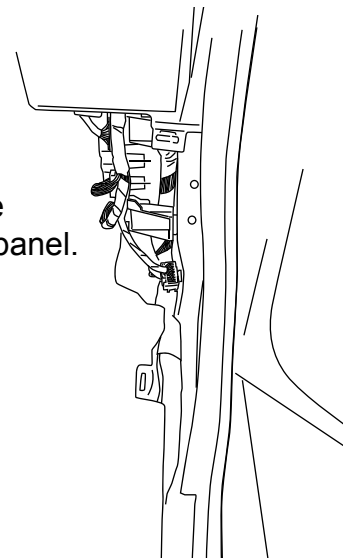

11

Locate this **small** connector highlighted in grey, and unplug for improved access during wire connection. Plug design may vary among model years, location the same.

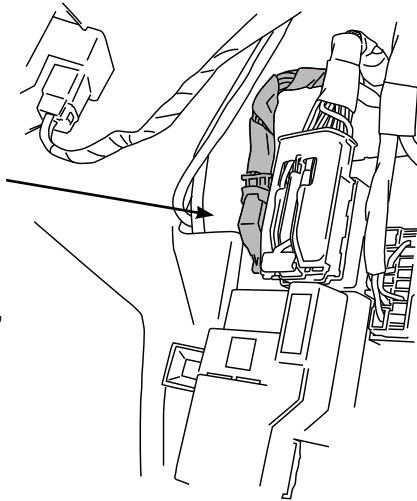

**12** NOT THE BIG CONNECTOR!

Posi-Tap instructions

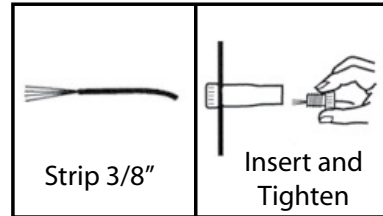
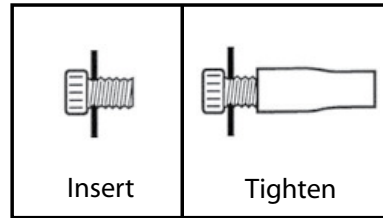

**13**

Using supplied Posi-Tap connectors, connect Power Step trigger wires to like colored wires in factory wire harness as shown in step 15.

|              | SuperCrew    | SuperCab     |
|--------------|--------------|--------------|
| Driver Front | Green/Violet | Green/Violet |
| Pass. Front  | White        | White        |
| Driver Rear  | Green        |              |
| Pass. Rear   | Yellow       |              |

For SuperCab models connect the two extra trigger wires to the same wires listed above, Green connects to Green/Violet and Yellow connects to White.

Make certain each Posi-Tap is making positive contact with the copper wire inside the insulation. Re-connect factory wire harness from step 12.

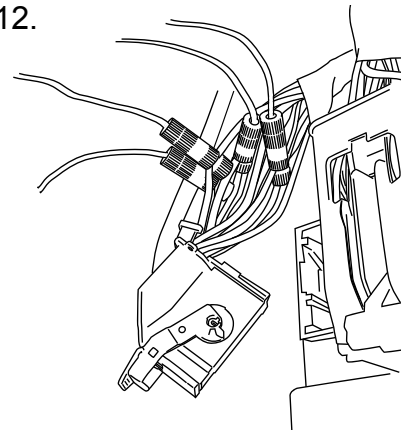

**14**

**15** Note: Later model years may not have lever on plug.

Replace fuse.

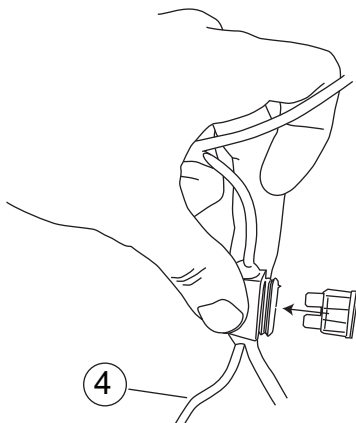

**16**

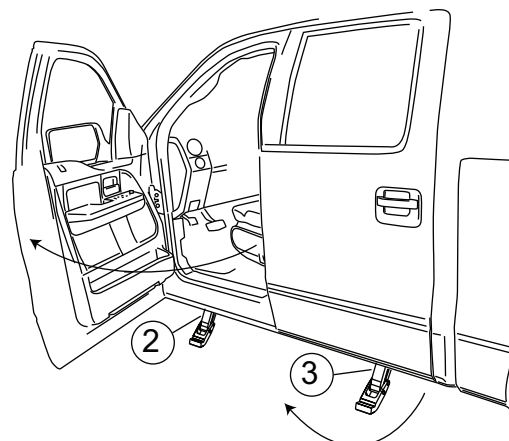

Open doors to extend drive linkage assembly (if not already extended).

**17**

Attach step, sliding the mounting T-nut into position.

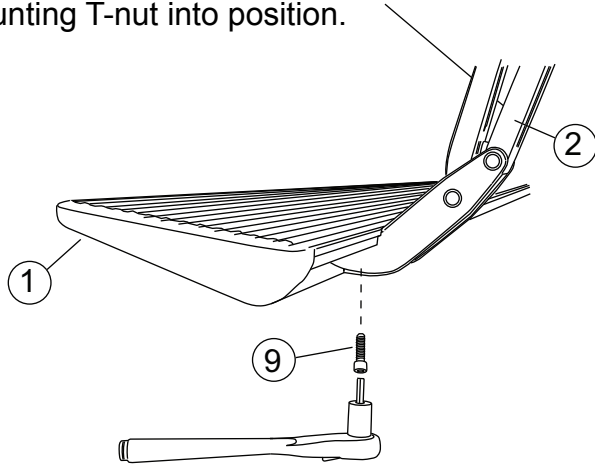

18

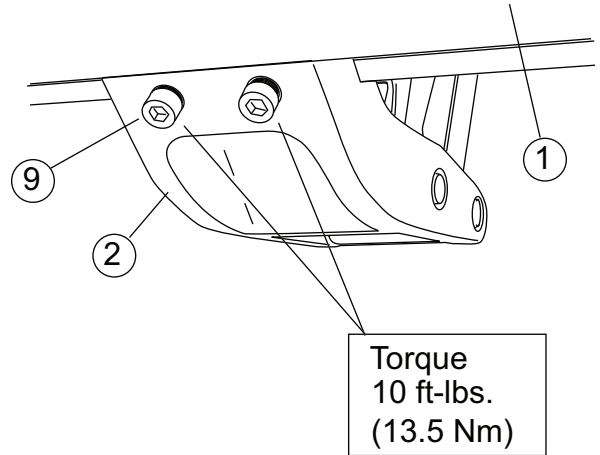

Torque  
10 ft-lbs.  
(13.5 Nm)

19

On each side of the vehicle measure from the front edge of door line on the pinch weld to the specified lengths below. Measure at 20" for front LED Light and 60" for rear LED Light.

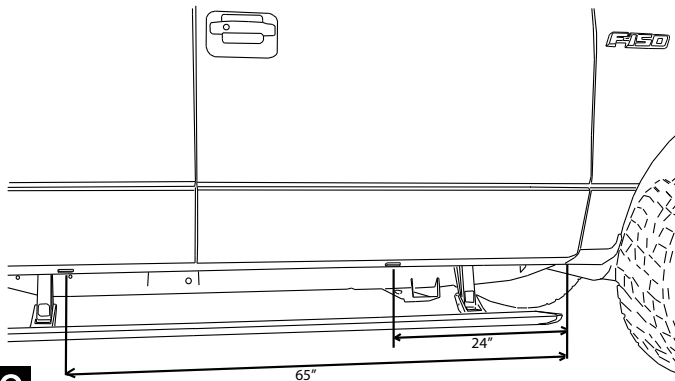

20

Affix lamps to rocker panel surface. Make sure the lamp is affixed to a clean, flat surface. There is a step down midway across the surface. Affix lamp just outside of step down.

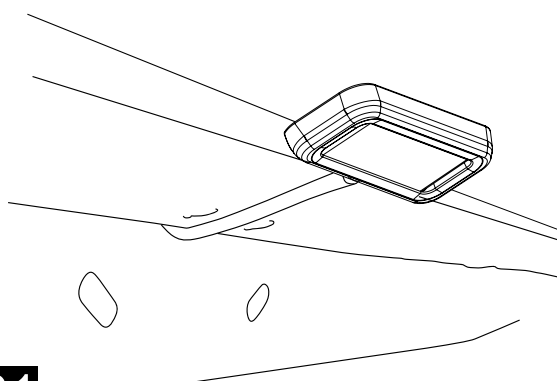

21

Using supplied butt connectors, connect the lamp wires. Red to Red, Black to Black

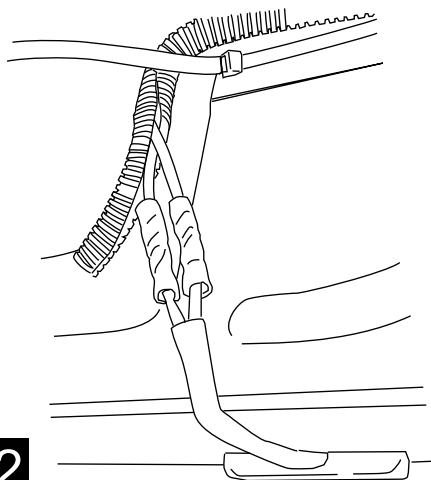

22

Close and wrap with conduit and electrical tape. Secure all loose wires with cable ties, with lamp wires pulled upward to avoid any wire snagging.

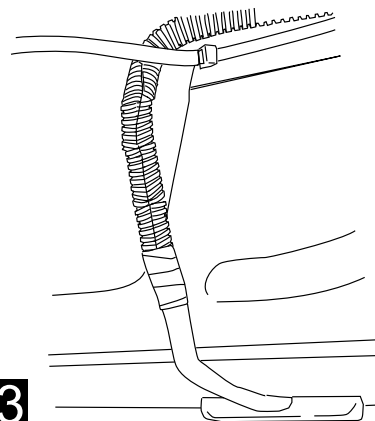

23



Replace fuse.

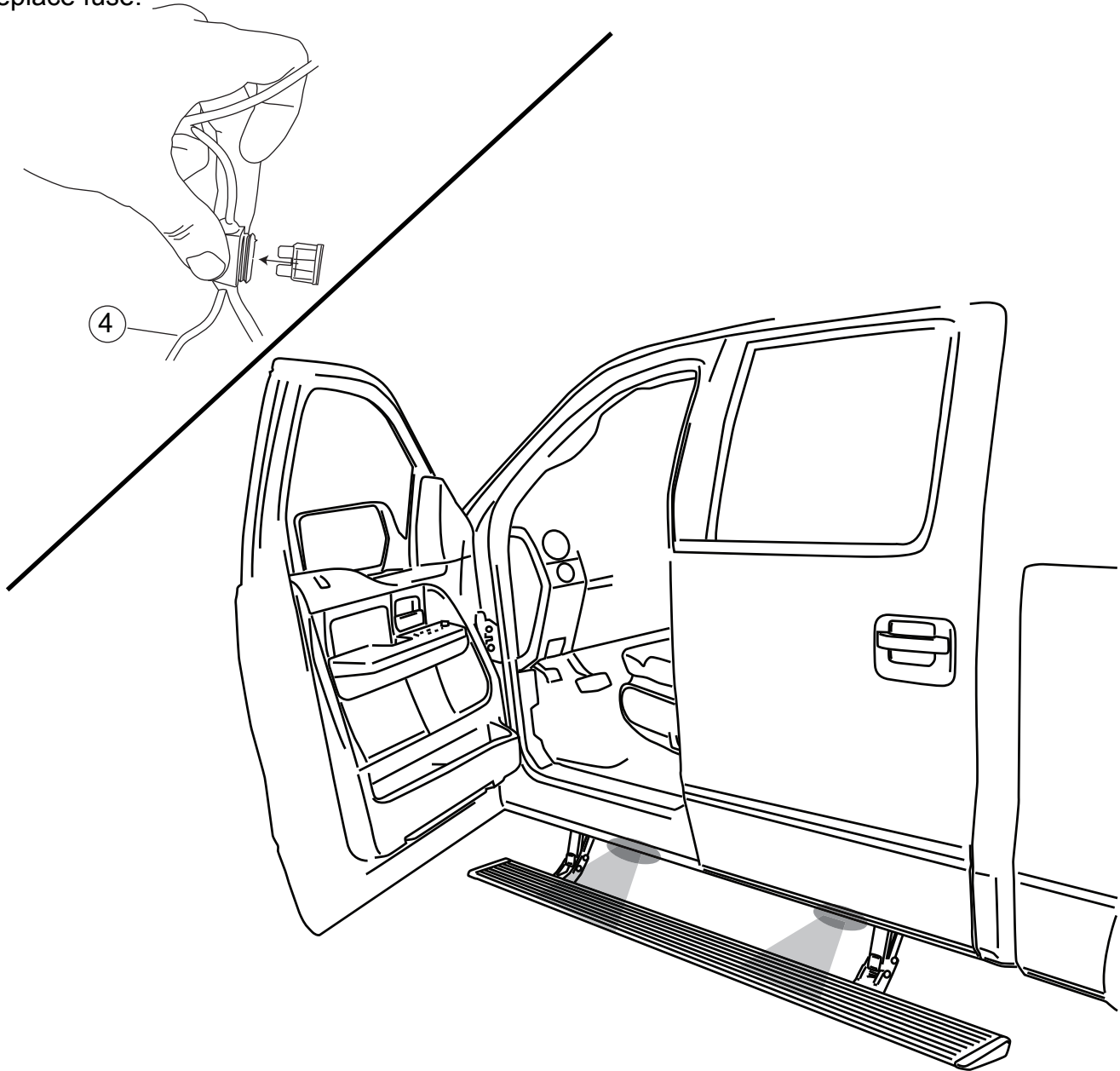

#### FINAL SYSTEM CHECK

Check that all doors activate the PowerStep and the LED lights work when doors open and close.

**NORMAL OPERATION:** When the doors open, PowerStep automatically deploys from under the vehicle.

When the doors are closed, PowerStep will automatically return to the stowed/retracted position. **Note that there is a 2-second delay before the PowerStep returns to the stowed/retracted position.**

**CORRECT OPERATION OF LIGHTS:** All four lamps will illuminate upon opening any door of vehicle. Lamps will stay on until restowing of both Power Steps or until 5 minutes has expired with the doors open. When the lights timeout after 5 minutes, they can be reilluminated by closing and opening any door of vehicle.