

INSTALLATION GUIDE

AMP RESEARCH **Power Step** MADE IN USA

APPLICATION	MODEL YR	PART #
Toyota Tundra Double Cab *	2007 - up	75137-01A
Toyota Tundra CrewMax	2007 - up	75137-01A
Toyota Sequoia *	2008 - up	75137-01A

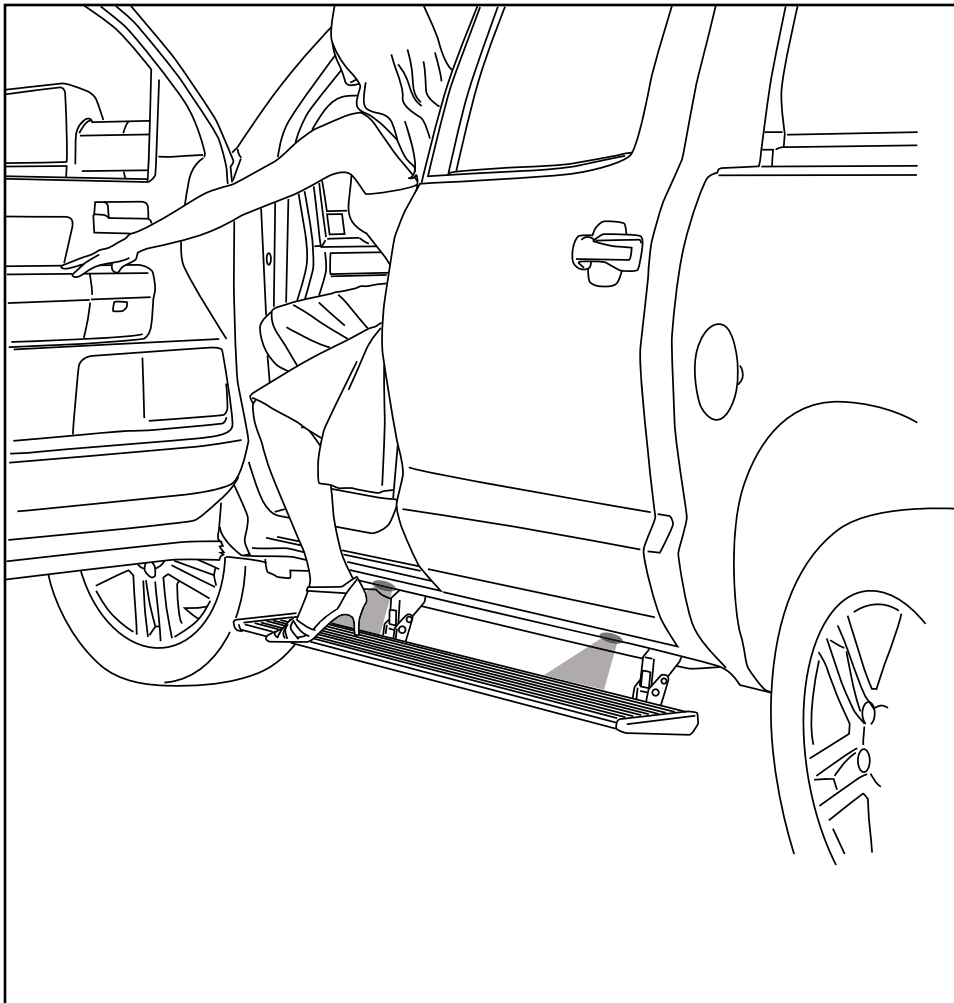

INSTALLATION TIME

3-5 Hours

Professional installation recommended

SKILL LEVEL



4= Experienced

TOOLS REQUIRED

- Measuring tape
- 13 mm socket
- 10 mm socket
- Ratchet wrench and extension
- 13mm end wrench
- Wire stripper / cutter
- 3/16" hex key wrench (allen wrench)
- 5mm hex key wrench (allen wrench)
- 4mm hex key wrench (allen wrench)
- Electrical tape

AMP RESEARCH POWERSTEP™ – TOYOTA TUNDRA / SEQUOIA

Note: Some Applications require modification.

Application	Cut Length
Crew Max	79" (No Modification Required)
Double Cab / Sequoia	63.5" (Trim 15.5")

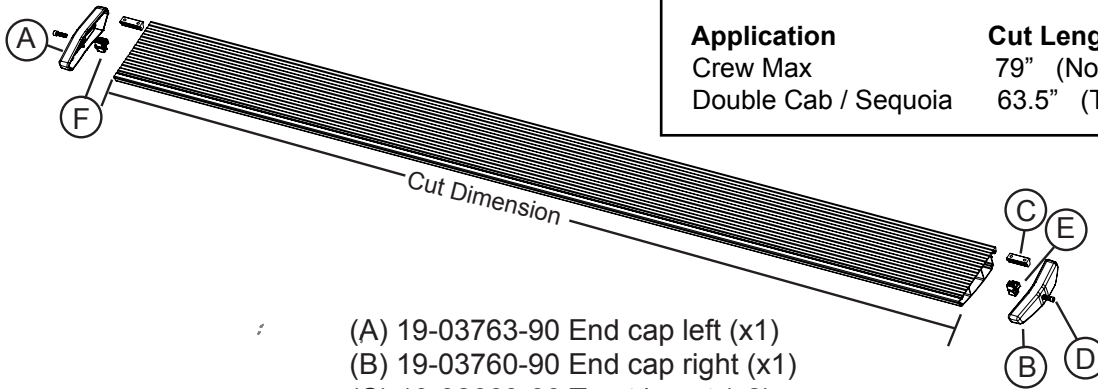

- (A) 19-03763-90 End cap left (x1)
- (B) 19-03760-90 End cap right (x1)
- (C) 19-02663-90 T-nut insert (x2)
- (D) 19-02802-90 Socket cap screw (x2)
- (E) 19-03761-90 End cap wedge right (x1)
- (F) 19-03764-90 End cap wedge left (x1)

1 x2

Running board assembly

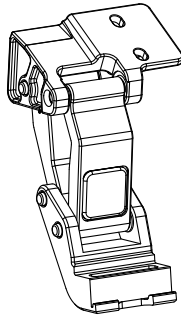

2 x2

10-03565-10
Idler linkage assembly

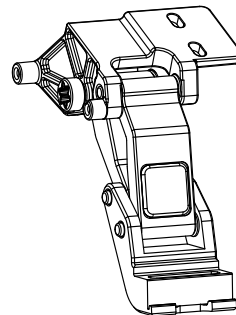

3 x2

10-03564-10
Motor linkage assembly

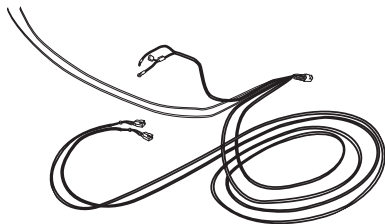

4

19-03568-91L
Wire harness

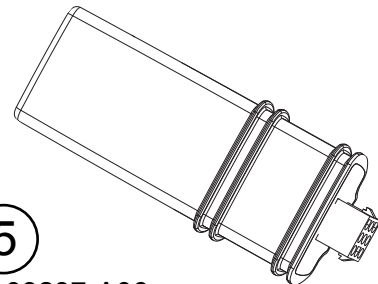

5

19-03297-A06
Controller

AMP RESEARCH POWERSTEP™ – TOYOTA TUNDRA / SEQUOIA

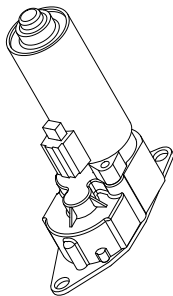

6 x2
20-03289-94
Motor

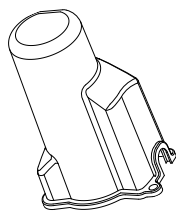

7 x2
19-03238-90
Motor Cover



8 x6
19-02721-90
Cinch Fastener

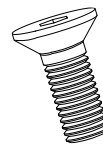

9 x4
19-03352-90
Socket Cap Screw

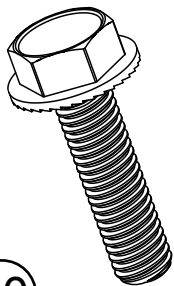

10 x8
19-03563-90
Hex Flange Bolt

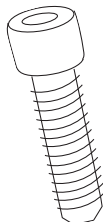

11 x8
19-02802-90
Socket Cap Screw

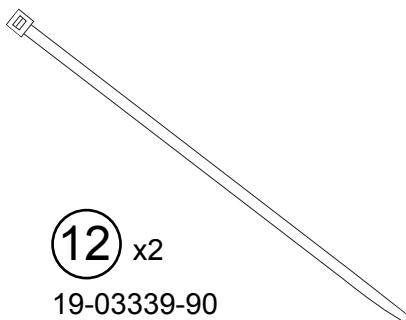

12 x2
19-03339-90
Cable tie (11")

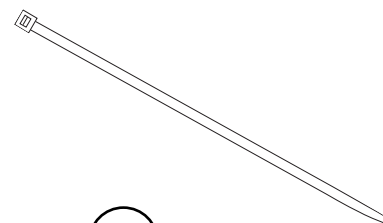

13 x20
19-02805-90
Cable tie (7")



14 x4
19-03354-90
Posi-Tap™

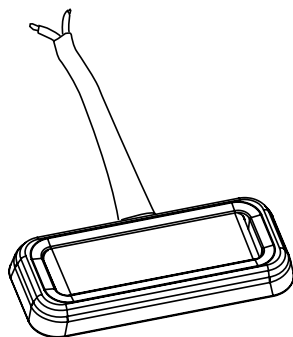

15 x4
19-03302-90
LED Lamp

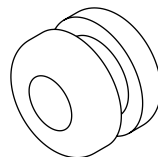

16 x4
19-02640-90
Grommet

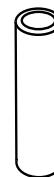

17 x8
19-02989-90
Butt Connector

**STEP 1 & 2 for CREW MAX ONLY.
All others skip to step 3**

Remove parking brake cable support from frame. Separate bracket and remove bracket from brake cable. Flip bracket 180 degrees to cable.

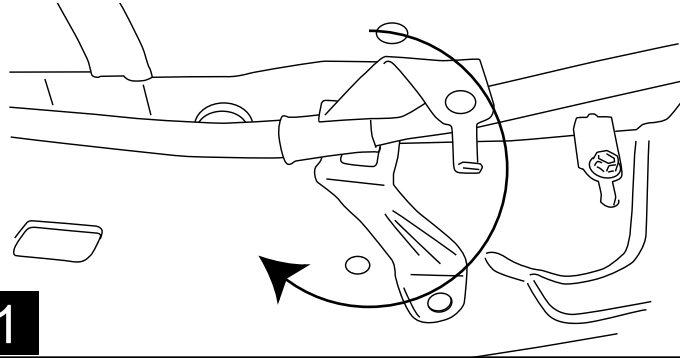

1

Secure parking brake cable support to frame so that the bolt is now below the cable.

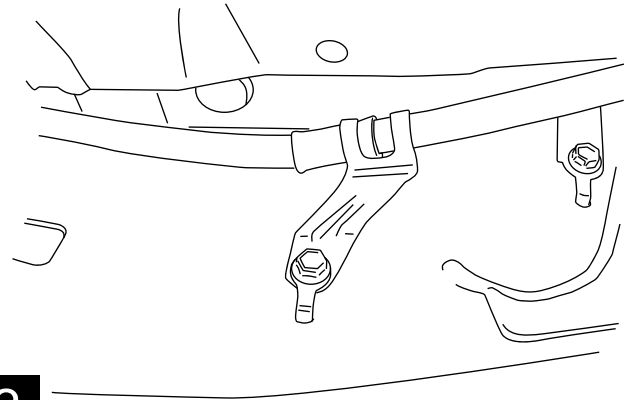

2

Slide motor assembly onto drive shaft and mounting bosses of driving linkage assembly. Use socket head cap screws (9) and tighten to 8 ft-lbs / 11Nm.

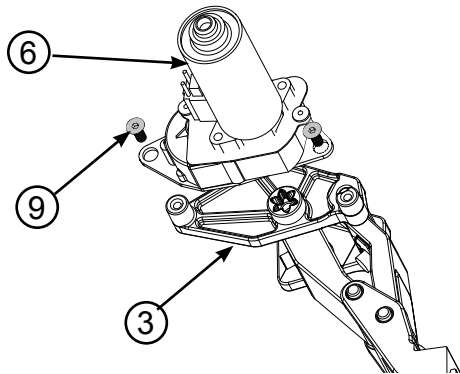

3

Install motor linkage on driver side in second set of factory running board holes from front. Use flange bolts (10) and torque to 22 ft-lbs / 30Nm.

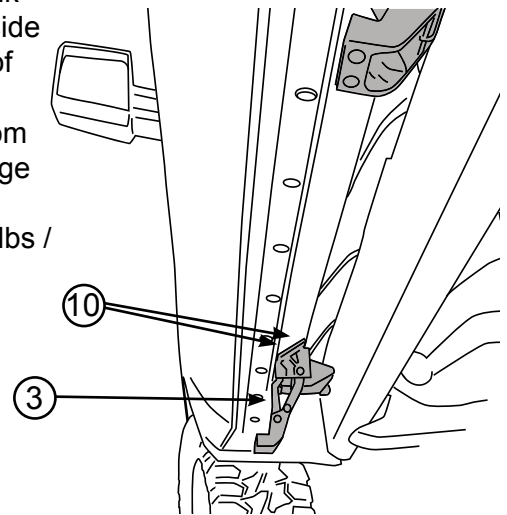

4

Install idler linkage in last set of factory running board holes from front. Use flange bolts (10) and torque to 22 ft-lbs / 30Nm.

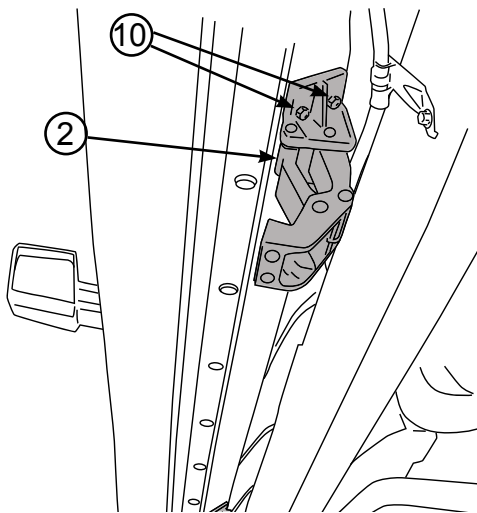

5

Repeat linkage installation on passenger side.

Install running board. See step 7 for alignment.

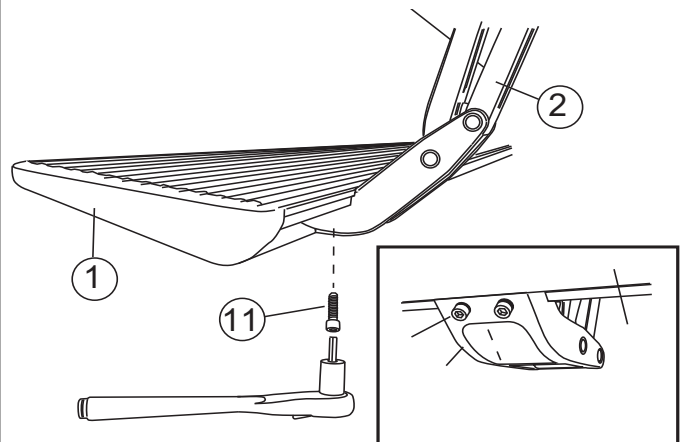

6

AMP RESEARCH POWERSTEP™ – TOYOTA TUNDRA / SEQUOIA

Running board alignment.

Tundra:

Slide mounting T-nut into position. Align rear of running board with back edge of rear door.

Sequoia:

Slide mounting T-nut into position. Align rear of running board to the back edge of the cab.

Mount running board and tighten fasteners to 10 ft-lbs / 14Nm. Insure linkages are squared to body prior to torquing fasteners.

7

Install controller under hood on driver side fender apron. Secure to factory wiring loom with 11" cable ties.

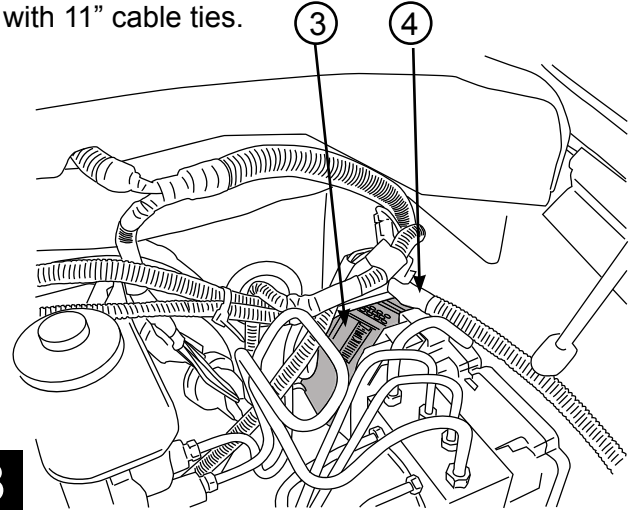

8

Remove power fuse. Connect wire harness to controller and secure locking clip. Connect red power lead to positive battery terminal and black ground lead to grounding lug on fender apron.

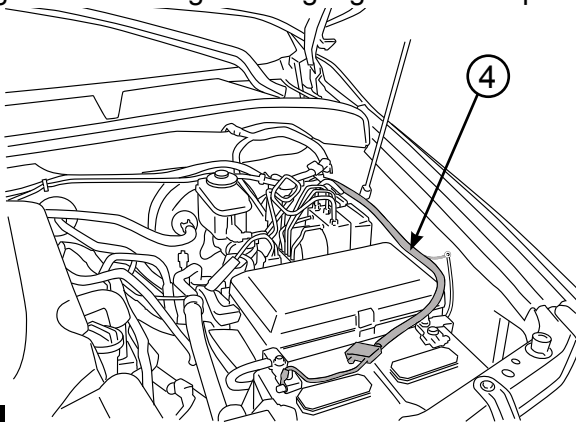

9

Route longest leg of wire harness across fire wall to passenger side and under vehicle outside of frame rail.

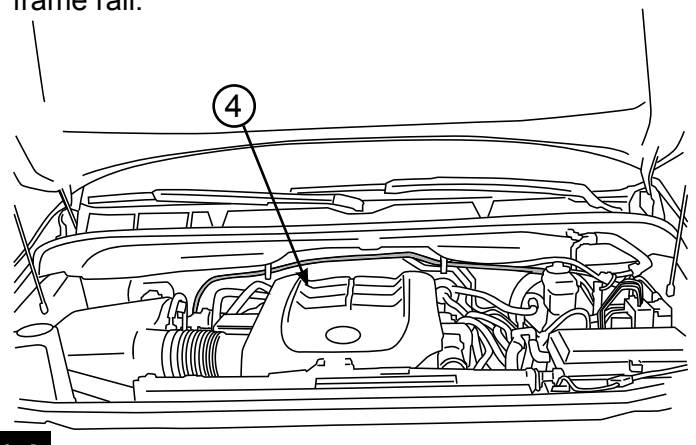

10

Route shorter leg of wire harness down driver side fender well and under vehicle outside of frame rail.

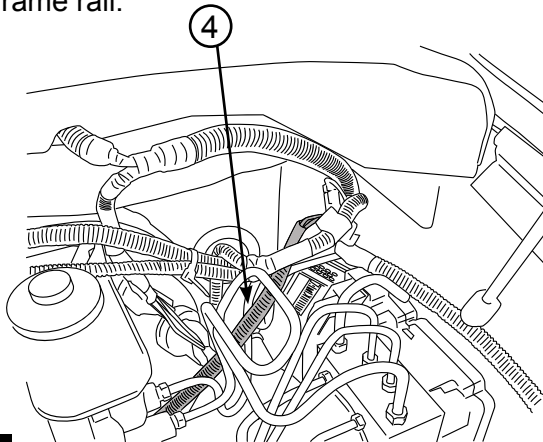

11

Remove driver and passenger front sill plates and kick panels. Pull up carpet. Locate rubber grommets under carpet in forward floorboards. Cut a slit in the rubber grommets and pass the trigger wires up through grommets under carpet on both the driver and passenger side..

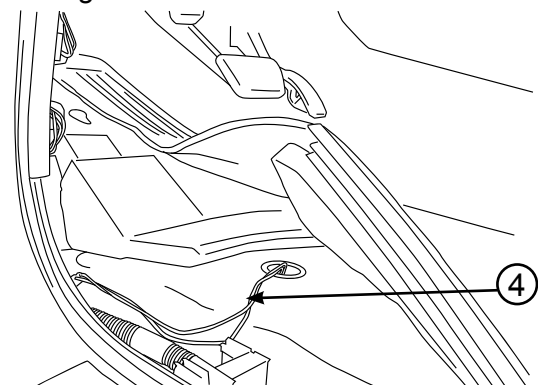

12

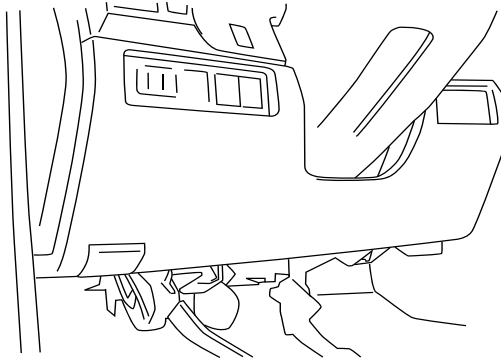

Remove trim panel below steering column

13

Posi-Tap™ instructions

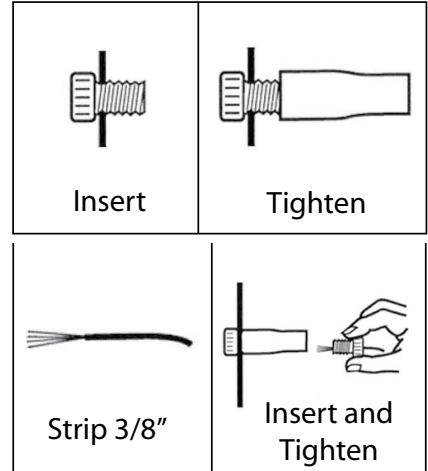

14

Locate main electrical junction box located under dash to the left of the steering column. Connect grey Power Step wire to 18 gage charcoal wire (*Driver Rear*) in pin 2 of connector shown.

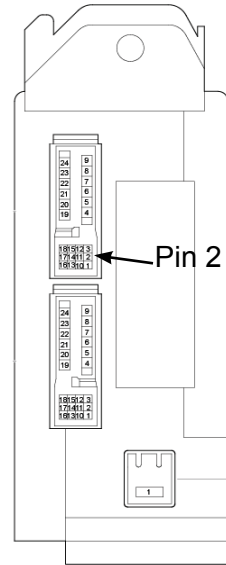
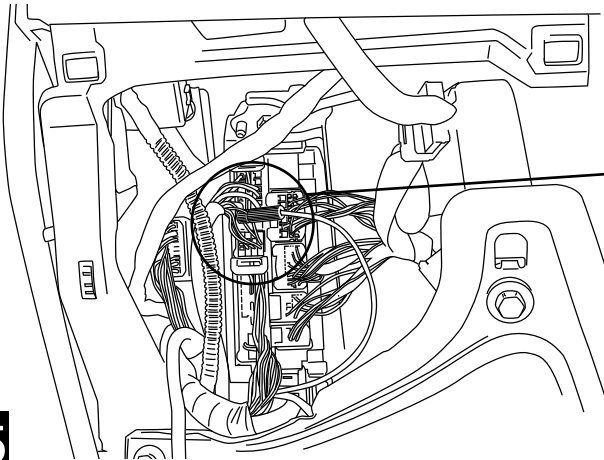

15

Locate black 20 pin connector at bottom of panel on left. Connect blue Power Step wire to 18 gage blue wire (*Driver Front*) in pin 15 of connector shown.

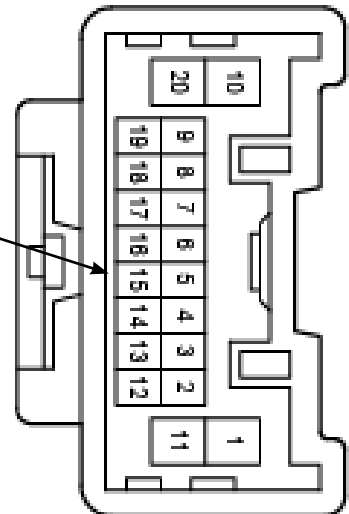
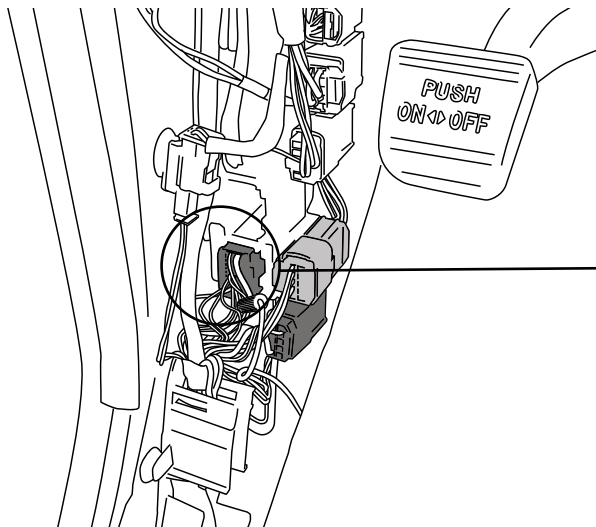

16

AMP RESEARCH POWERSTEP™ – TOYOTA TUNDRA / SEQUOIA

Locate the grey 22 pin connector at the bottom of the passenger side kick panel area. Connect blue Power Step wire to 18 gage blue wire (*Passenger Rear*) in pin 1 and connect white Power Step wire to the 18 gage white wire (*Passenger Front*) in pin 9 of connector shown

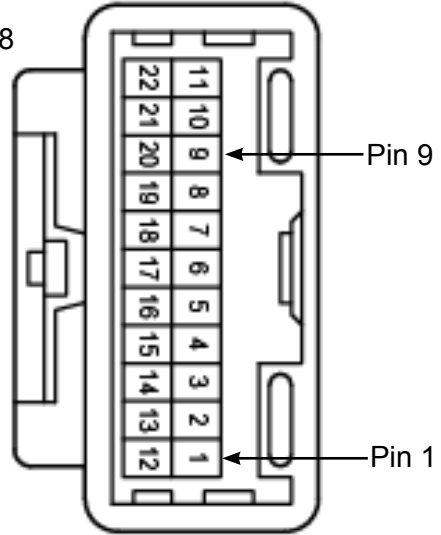
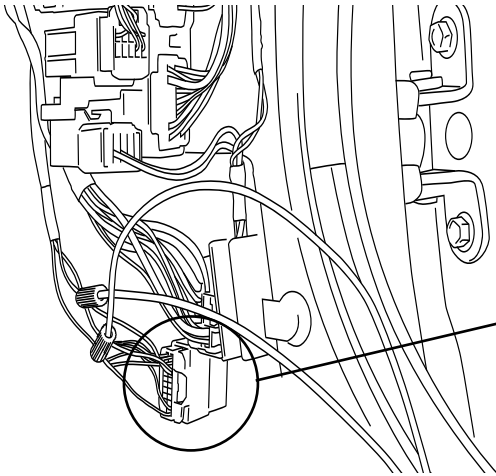

17

Insert plug from wire harness onto motor.

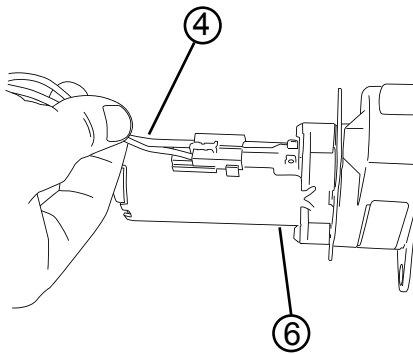

18

Slide rubber grommet on wire harness into slot of motor cover. Install motor cover onto motor.

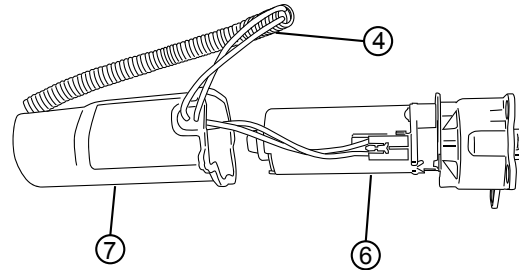

19

Partially separate the plastic rivet from the pin by bending the pin back and forth. Slide motor cover over motor and insert plastic push pin rivets in mounting holes of motor cover. Drive pin flush with rivet head. Use pliers to ease installation.

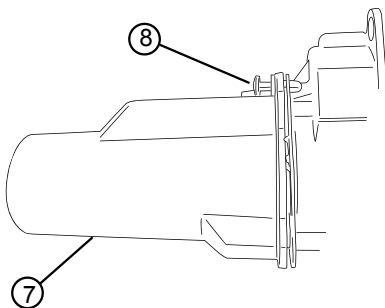

20

On each side of the vehicle measure from the front edge of door line on the pinch weld to the specified lengths below. Measure at 21" for front LED Light and 69" for rear LED Light.

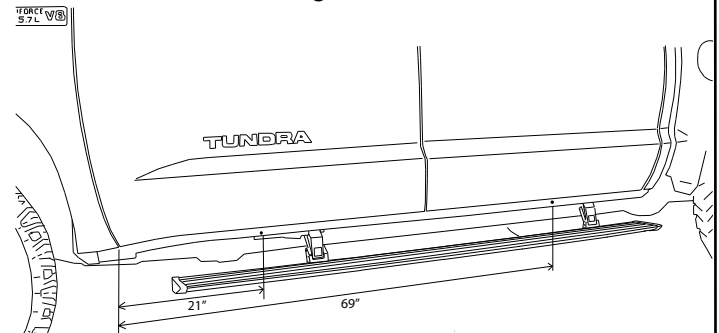

21

Drill a 9/32" hole through the pinch weld at marked locations. Debur all holes.

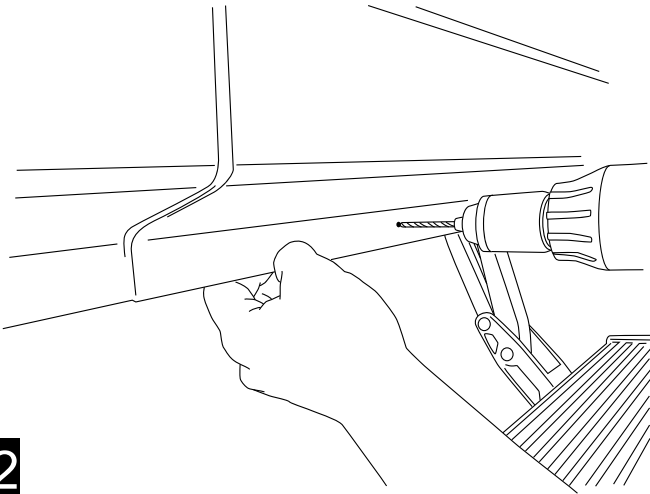

22

Insert grommet into drilled holes. Insert lamp wires through the grommets. (Silicon lube will help wires slip through grommets.)

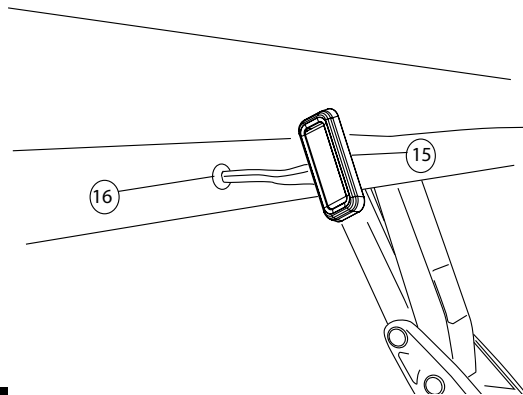

23

Affix lamp through rocker panel surface. Make sure lamp is affixed to a flat, clean surface.

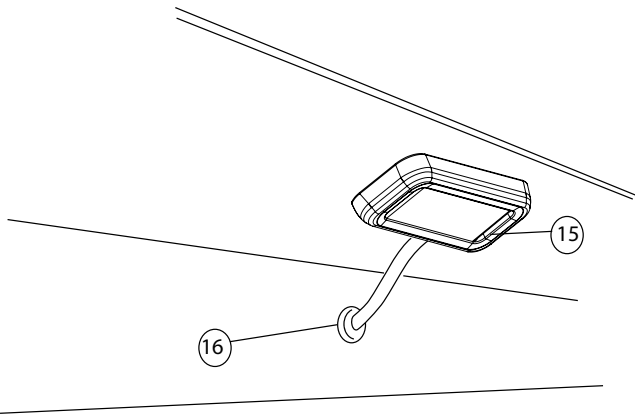

24

Using supplied butt connectors, connect the lamp wires. Red to Red, Black to Black.

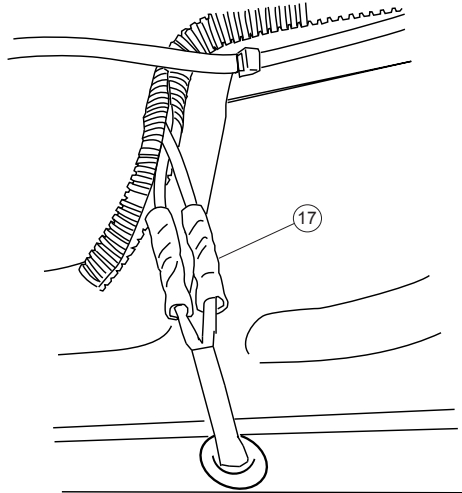

25

Close and wrap with conduit and electrical tape. Secure all loose wires with cable ties, with lamp wires pulled upward to avoid any wire snagging.

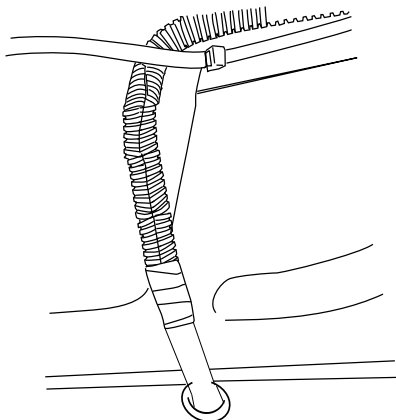

26

Reinstall fuse.

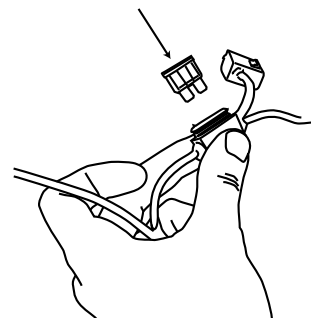

27

Check that all doors activate the Power Step and the LED Lights work when doors open and close. Reinstall any remaining trim panels.

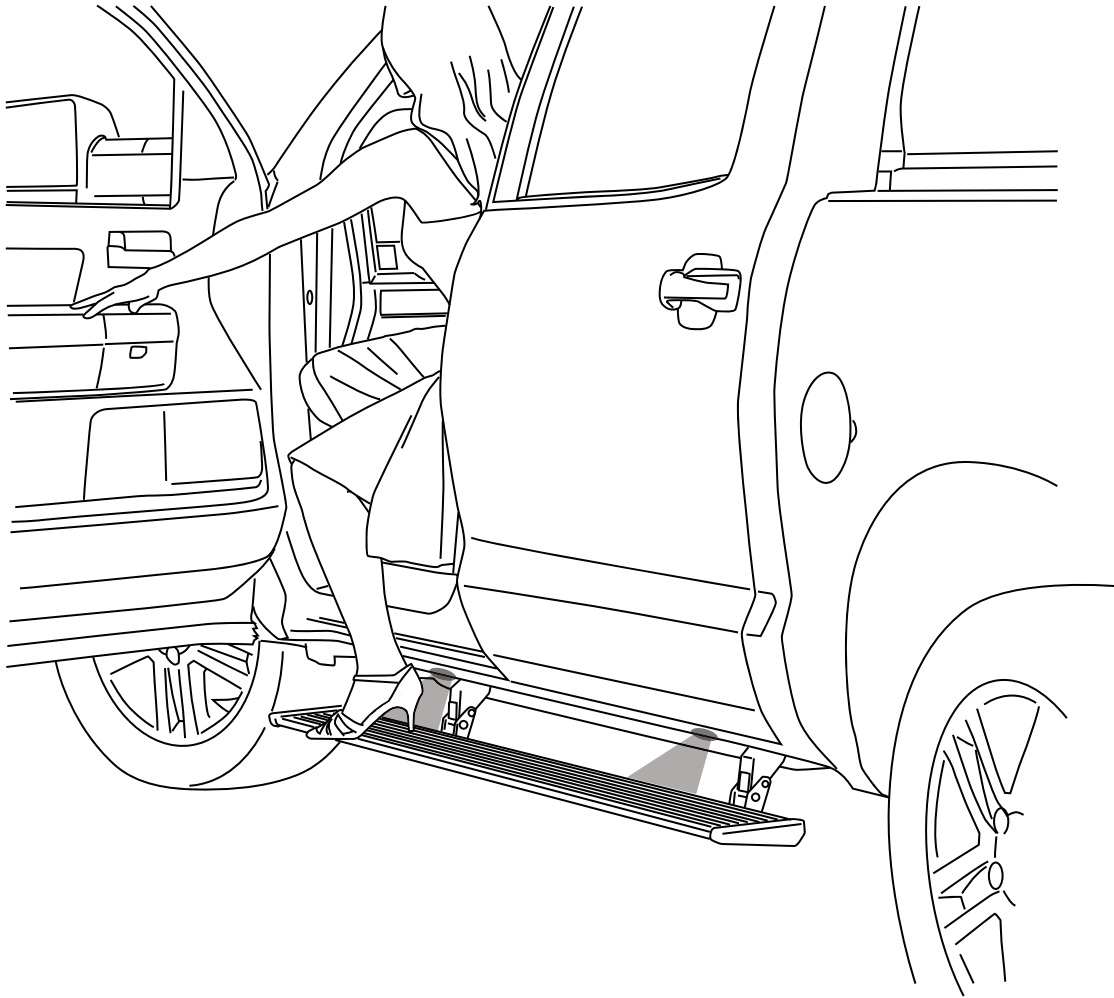

FINAL SYSTEM CHECK

Check that all doors activate the PowerStep and the LED lights work when doors open and close.

NORMAL OPERATION: When the doors open, PowerStep automatically deploys from under the vehicle. When the doors are closed, PowerStep will automatically return to the stowed/retracted position. **Note that there is a 2-second delay before the PowerStep returns to the stowed/retracted position.**

CORRECT OPERATION OF LIGHTS: All four lamps will illuminate upon opening any door of vehicle. Lamps will stay on until restowing of both Power Steps or until 5 minutes has expired with the doors open. When the lights timeout after 5 minutes, they can be reilluminated by closing and opening any door of vehicle.