

# INSTALLATION GUIDE

# **AMP** RESEARCH **Power Step** MADE IN USA

## APPLICATION

Jeep Wrangler Unlimited (JK) 2007–up  
(4-Door Only)

## AMP Part #

75122-01A

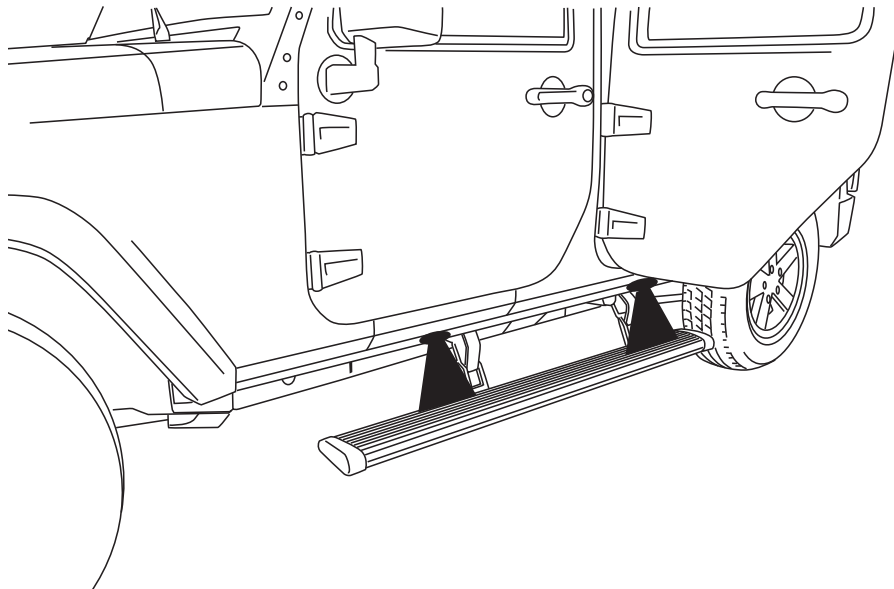

## INSTALLATION TIME

**3-5 Hours**

Professional installation recommended

## SKILL LEVEL



4= Experienced

## TOOLS REQUIRED

- 13 mm socket
- 13 mm end wrench
- Ratchet wrench and extension
- Wire crimpers
- Wire stripper/cutter
- 3/16" hex key wrench (allen wrench )
- 4 mm hex key wrench (allen wrench )
- 5 mm hex key wrench (allen wrench )

## PARTS LIST AND HARDWARE IDENTIFICATION

19-03199-11 End cap left (x1)  
19-03199-12 End cap right (x1)  
19-02663-90 T-nut insert (x2)  
19-03236-90 Socket cap screw (x2)  
19-03237-90 Nut plate (x2)

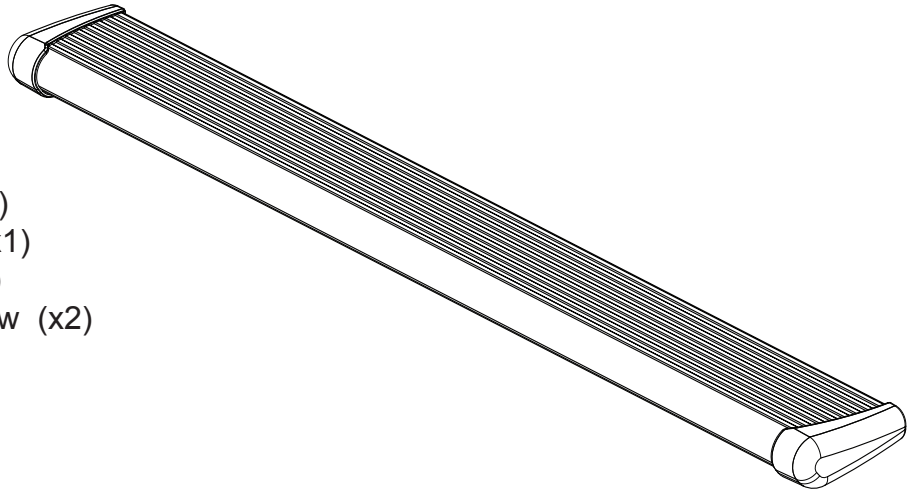

**1** x2 20-03318-70  
Step assembly

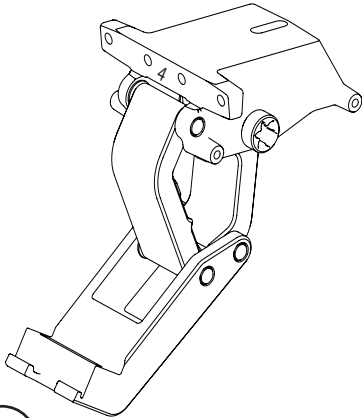

**2** x2  
10-03606-10 Driver  
10-03606-11 Passenger  
Motor Linkage

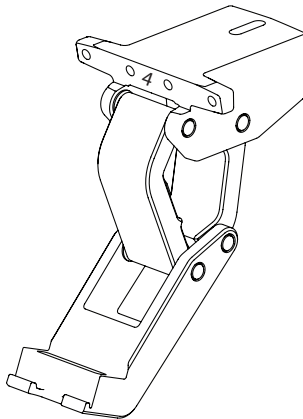

**3** x2  
10-03610-10  
Idler Linkage

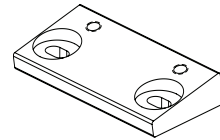

**4** x2  
15-03600-90  
Adaptor

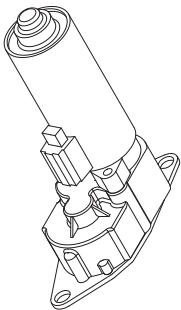

**5** x2  
20-03289-94  
Motor

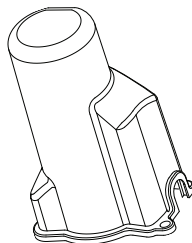

**6** x2  
19-03238-90  
Motor Cover

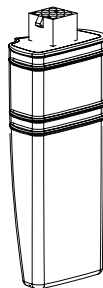

**7**  
19-03297-A06  
Controller

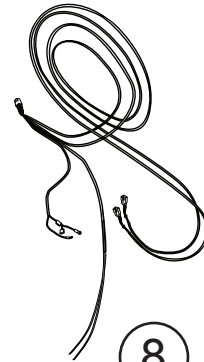

**8**  
19-03717-90L  
Wire Harness

**PARTS LIST AND  
HARDWARE  
IDENTIFICATION**



**9** x2  
19-03467-90  
U nut



**10** x8  
19-02802-90  
Socket Cap

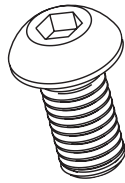

**11** x8  
16-02634-90  
Button Head Bolt



**12** x6  
19-02740-90  
Hex Flange Bolt

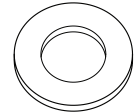

**13** x8  
16-03014-90  
Washer Black



**14** x4  
19-03354-90  
Posi-Taps™ (Red/Grey)



**15** x6  
19-02721-90  
Cinch Fastener

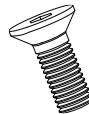

**16** x2  
19-03352-90  
Flat Head  
Cap Screw



**17** x20  
19-02805-90  
Cable Tie 6"

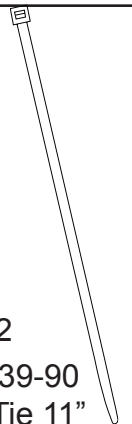

**18** x2  
19-03339-90  
Cable Tie 11"

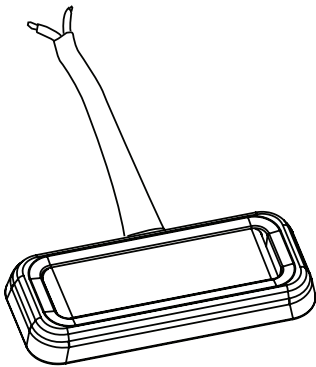

**19** x4  
19-03302-90  
LED Lamp

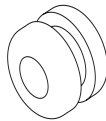

**20** x4  
19-02640-90  
Grommet

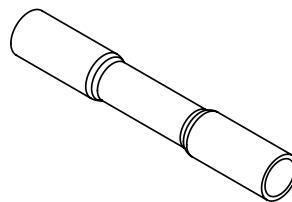

**21** x8  
19-03911-90  
Butt Connector

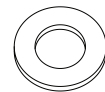

**22** x2  
19-03897-90  
Washer

**23** x2  
19-03918-90  
Hex bolt

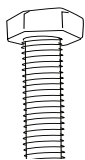

**24** Includes x4  
19-03142-90  
Shim Kit

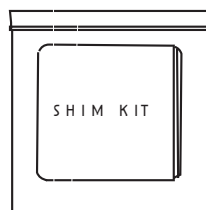

Locate rear linkage installation position in front of rear body mount

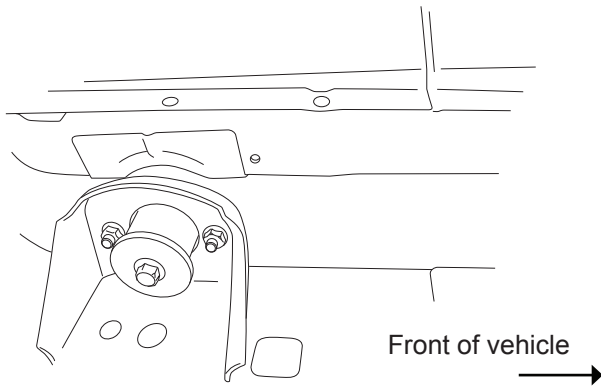

**1** Passenger side shown above

Install adaptor as shown

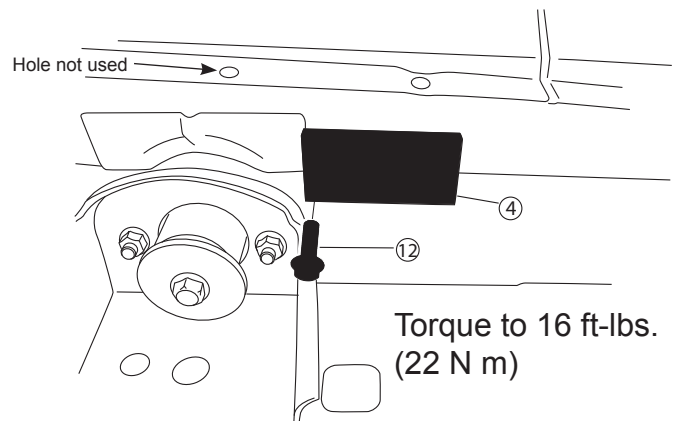

**2**

Install Rear idler linkage.

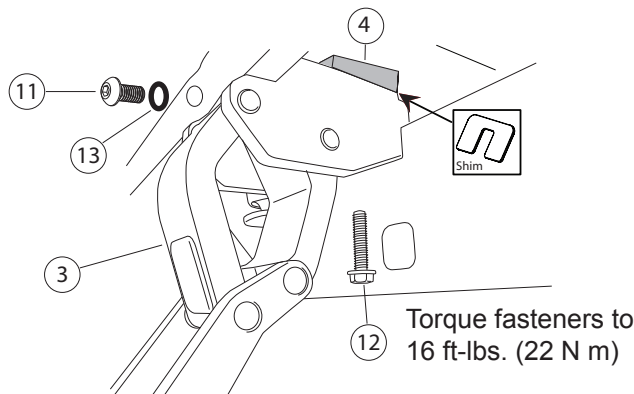

**Note:** Due to variances in sheetmetal, shimming may be required to allow proper retraction of steps. If needed, install shims between adaptor and upper mount.

**3**

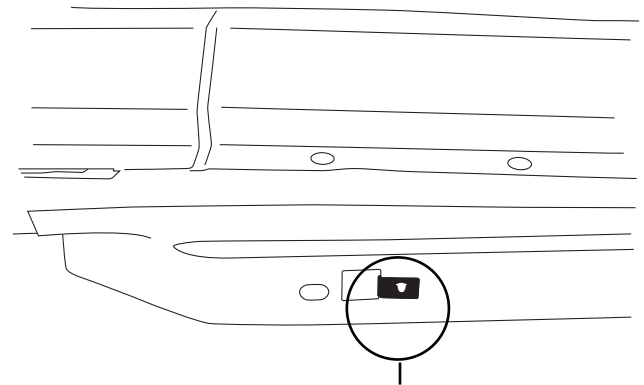

**Install U nut under vehicle, middle of front door for front motor linkage as shown. (Some vehicles with factory steps may already include this u-nut)**

**4**

Slide motor assembly onto drive shaft and mounting bosses of driving linkage assembly. Use flathead socket head cap screw (16) on the inner location. Next use hex bolt (23) and washer (22) on outer location and tighten to 8 ft-lbs / 11Nm.

**Motor faces to front of vehicle**

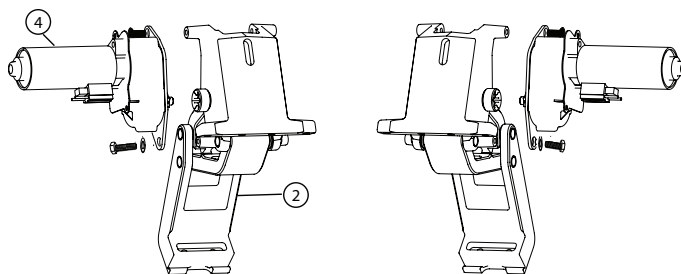

Driver side Motor Linkage

Passenger side Motor Linkage

**5**

Install motor linkage with motor

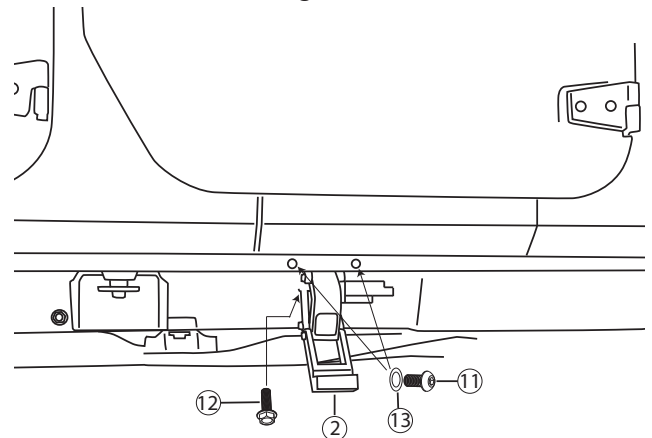

Torque fasteners to 16 ft-lbs. (22 N m)

**6**

Repeat linkage installation on driver side

Mount step extrusion to linkage assemblies. Line up t-nuts in step assembly with slots in lower mounts of linkage assemblies. Fasten loosely to allow for adjustments.

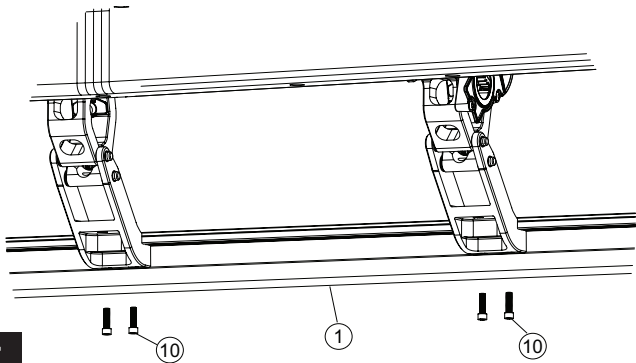

7

Line up rear of step extrusion with rear fender well.

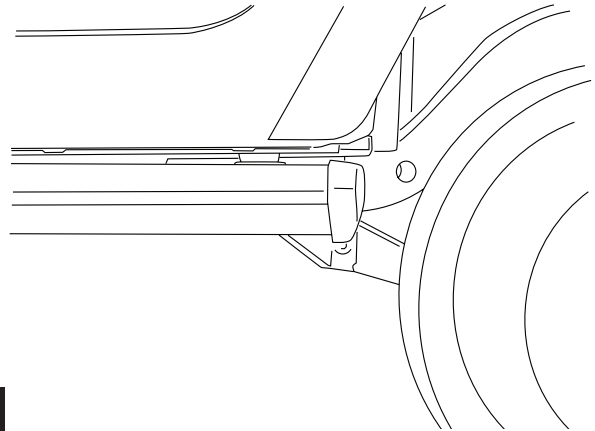

8

Tighten 4 socket cap screws with 3/16" allen wrenr Torque to 10 ft-lbs. (13.5 N-m)

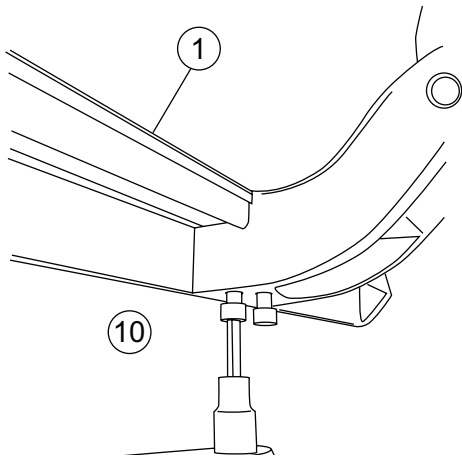

9

Remove fuse from Power Step wire harness.

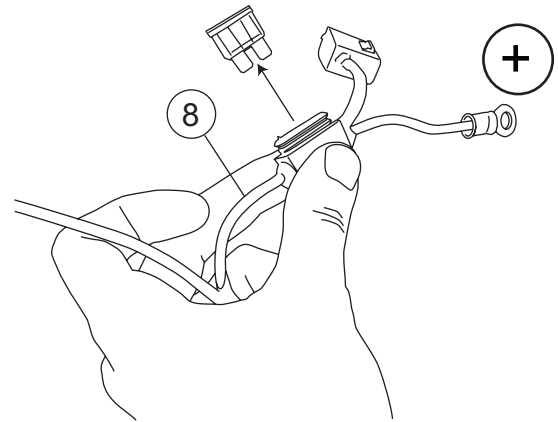

10

Install controller on passenger side at firewall. Secure with 11" cable ties. Connect Red wire to positive battery terminal and Black wire to negative battery terminal.

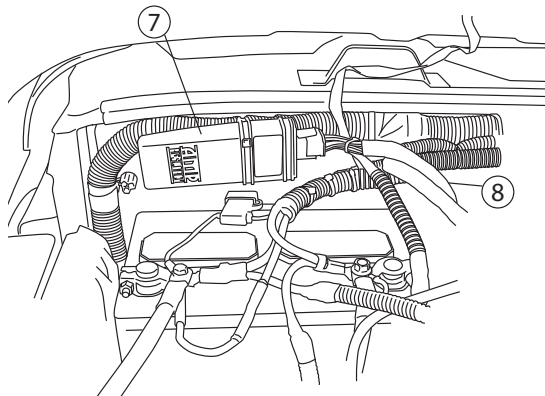

11

Route longest leg of wire harness across fire wall to driver side and under vehicle outside of frame rail. Route shortest leg of wire harness down fire wall and outside of frame rail on passenger side.

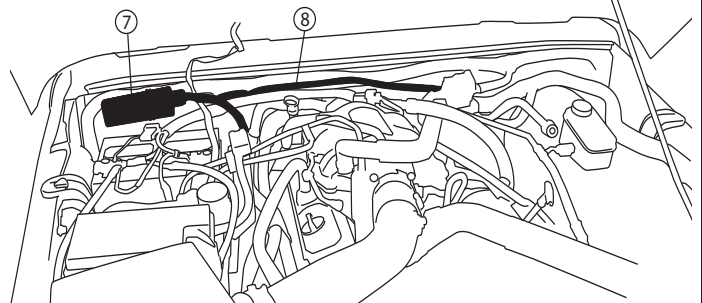

12

Remove passenger side front door sill.

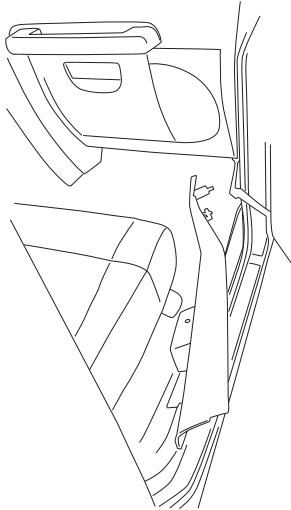

Lift carpet. Slit rubber grommet and pass trigger wires through grommet in floor into passenger compartment.

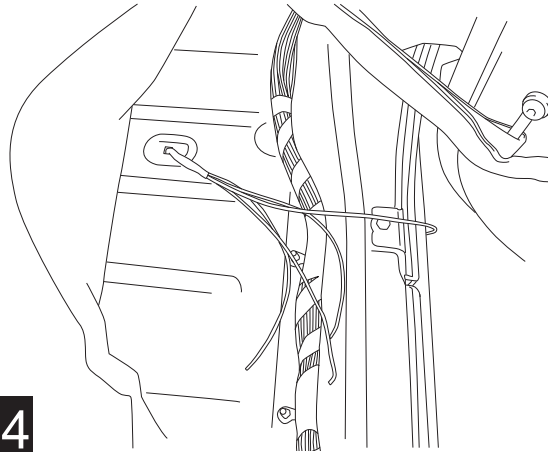

14

Posi-Tap™ instructions

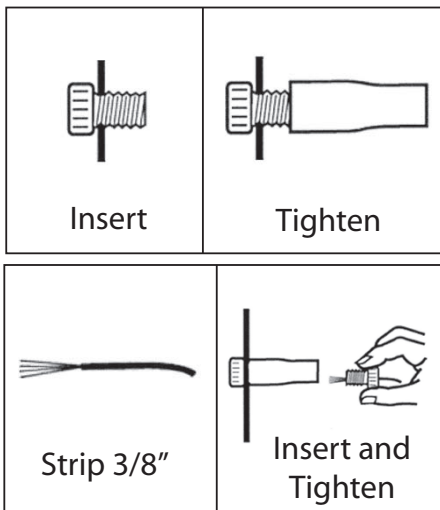

Use Posi-Tap connectors to connect Power Step trigger wires to like colored wires in the factory system as shown: Violet/White wire in loom coming from front door, Violet/Yellow and Violet/Grey in main loom in door sill. **Note: For door removal attach posi tap on chassis side of door harness.**

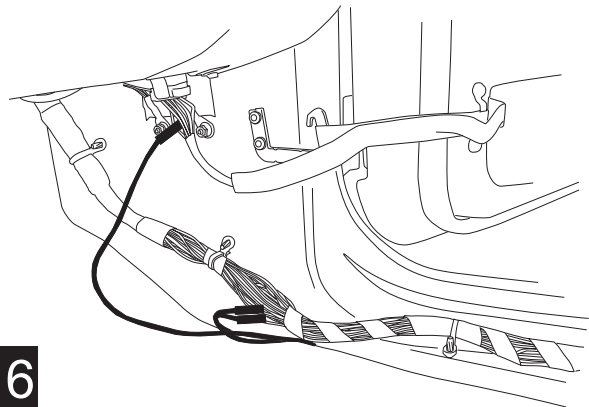

16

Remove driver side door sill and pull up carpet.

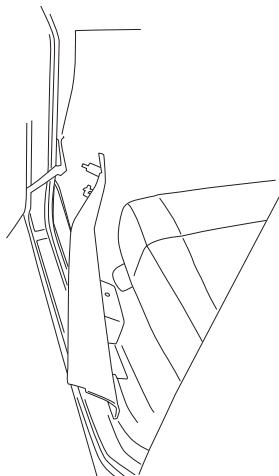

Route Violet wire under carpet to driver side door sill and connect to violet wire coming from door as shown. **Note: For door removal attach posi tap on chassis side of door harness.**

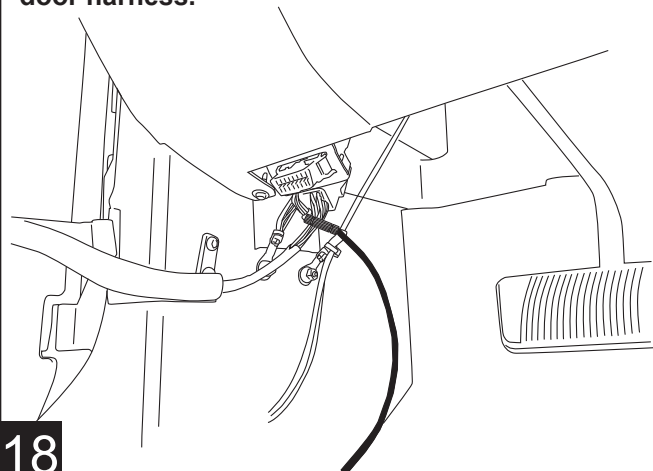

18

17

Insert plug from wire harness onto motor. Slide rubber grommet on wire harness into slot of motor cover. Insert motor cover onto motor. Slide motor assembly onto drive shaft and mounting bosses of driving linkage assembly. Use electrical tape to cover any exposed wire from the motor.

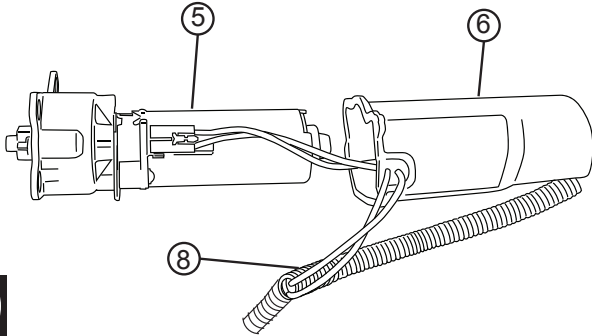

19

Insert plastic push pin rivets in mounting holes of motor cover. Use pliers to ease installation.

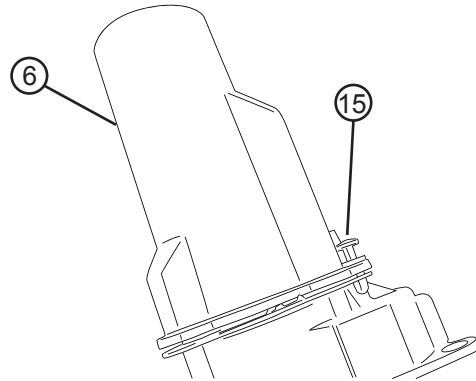

20

On each side of the vehicle measure from the front edge of the door line on the pinch weld to the specified lengths below. Measure at 8" for the front LED lamp and 45" for the rear LED Lamp.

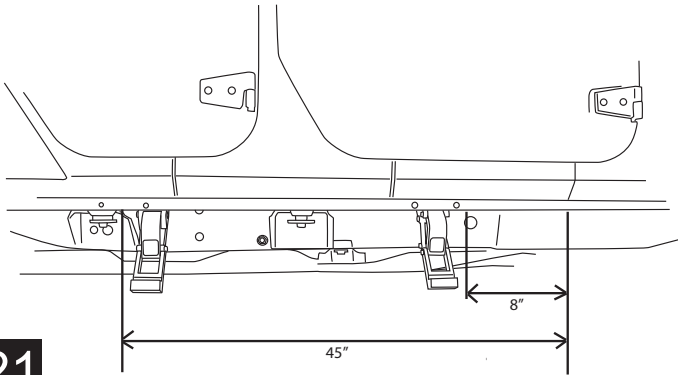

21

Drill a 9/32" hole through pinch weld at locations marked out in step 21.

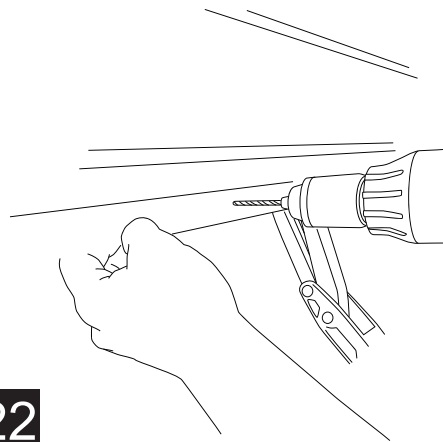

22

Insert grommet and lamp wires through drilled hole. Affix lamp to rocker panel surface. Make sure the lamp is affixed to a clean, flat surface.

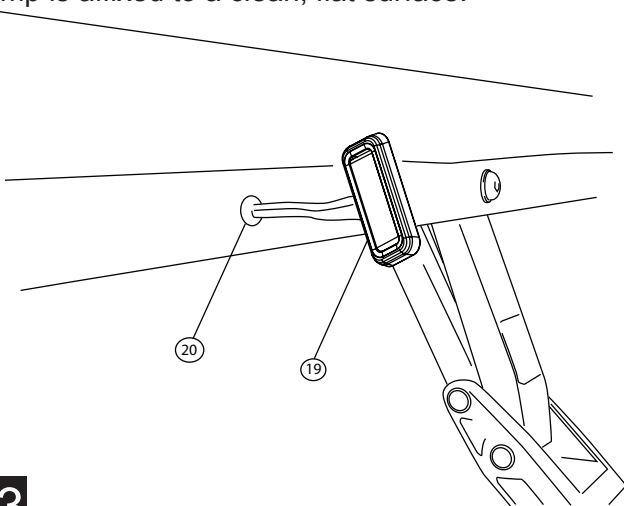

23

Using supplied butt connectors, connect the lamp wires. Red to Red, Black to Black.

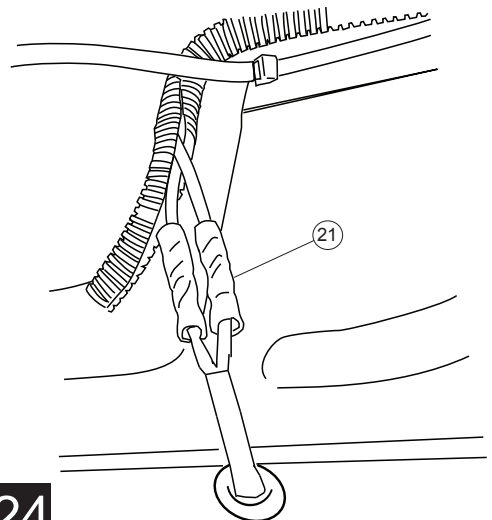

24

Close and wrap with conduit and electrical tape. Secure all loose wires with cable ties, with lamp wires pulled upward to avoid any wire snagging.

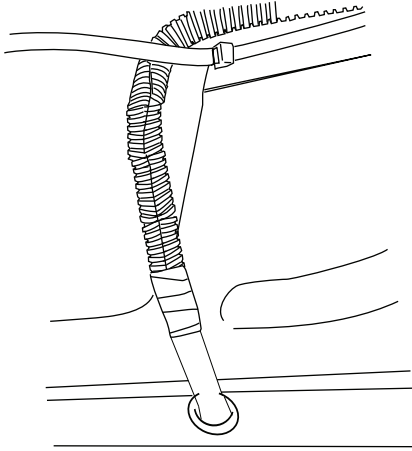

25

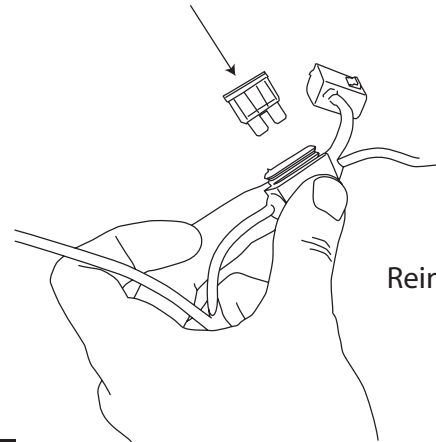

26

Check that all doors activate the Power Step and the LED Lights work when doors open and close. Reinstall any remaining trim panels. **Due to Variances in the sheet metal a shim kit is provided if Steps do not retract properly. See Step 3 for shim placement.**

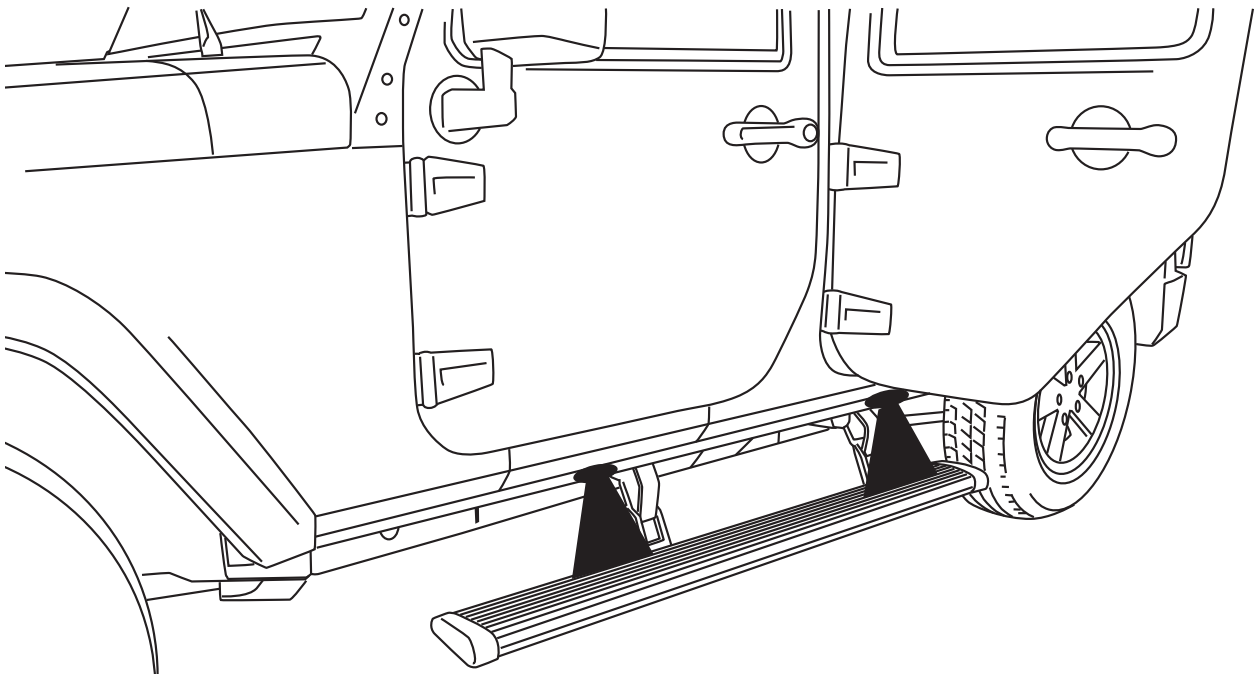

#### FINAL SYSTEM CHECK

Check that all doors activate the PowerStep and the LED lights work when doors open and close.

**NORMAL OPERATION:** When the doors open, PowerStep automatically deploys from under the vehicle.

When the doors are closed, PowerStep will automatically return to the stowed/retracted position. **Note that there is a 2-second delay before the PowerStep returns to the stowed/retracted position.**

**CORRECT OPERATION OF LIGHTS:** All four lamps will illuminate upon opening any door of vehicle. Lamps will stay on until restowing of both Power Steps or until 5 minutes has expired with the doors open. When the lights timeout after 5 minutes, they can be reilluminated by closing and opening any door of vehicle.

27