

AMP RESEARCH Power Step

MADE IN USA

APPLICATION	LENGTH	MODEL YR	PART #
Ford F-250 / F-350 / F-450 Regular Cab *	(48")	2008-2016	76234-01A
Ford F-250 / F-350 / F-450 Super Cab *	(60")	2008-2016	76234-01A
Ford F-250 / F-350 / F-450 Crew Cab	(79")	2008-2016	76234-01A

*Modification required to running board assembly. See Item 1 on page 3.

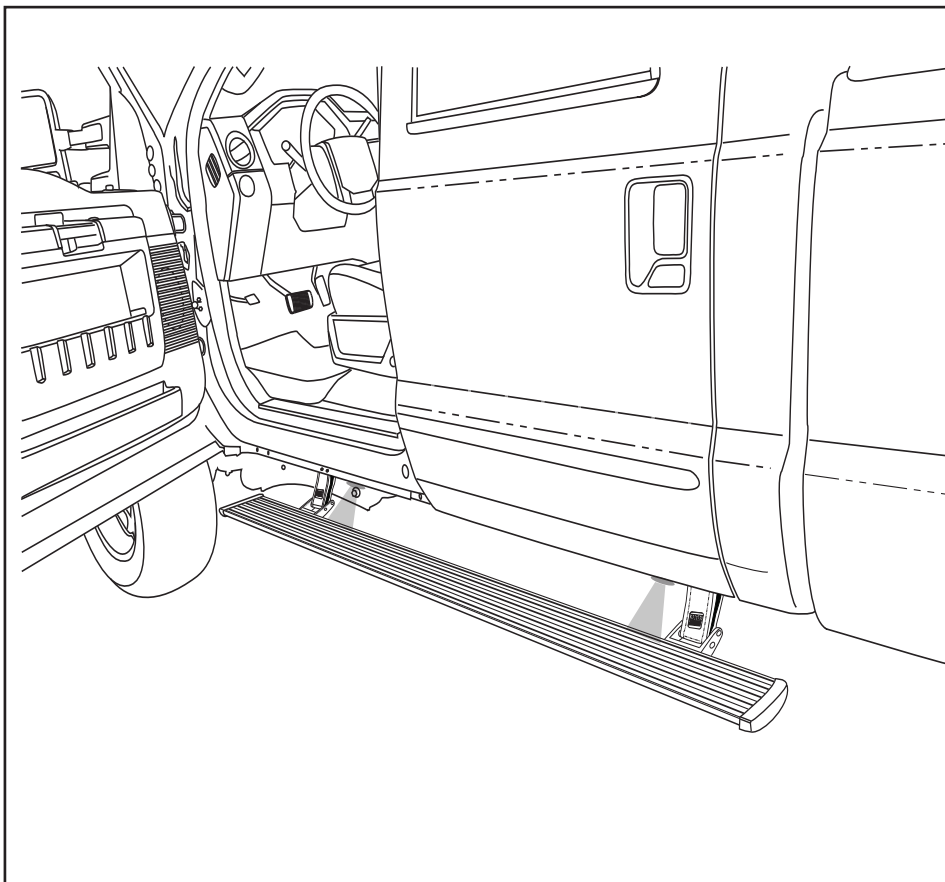

INSTALLATION TIME

2-3 Hours

Professional installation recommended

SKILL LEVEL



4= Experienced

TOOLS REQUIRED

- Safety goggles
- Measuring tape
- Flat blade screwdriver
- Phillips head screwdriver
- 13mm socket
- 8mm socket
- Ratchet wrench and extension
- Wire crimpers
- Wire stripper / cutter
- 3/16" hex key (allen wrench)
- 4mm hex key (allen wrench)
- Electrical tape
- Silicone caulking (sealer)
- 25/64" Drill Bit
- 9/32" Drill Bit

INSTALLATION GUIDE

Attaching motor to linkage assembly

The motors must be attached to the linkage assemblies before continuing the installation process.

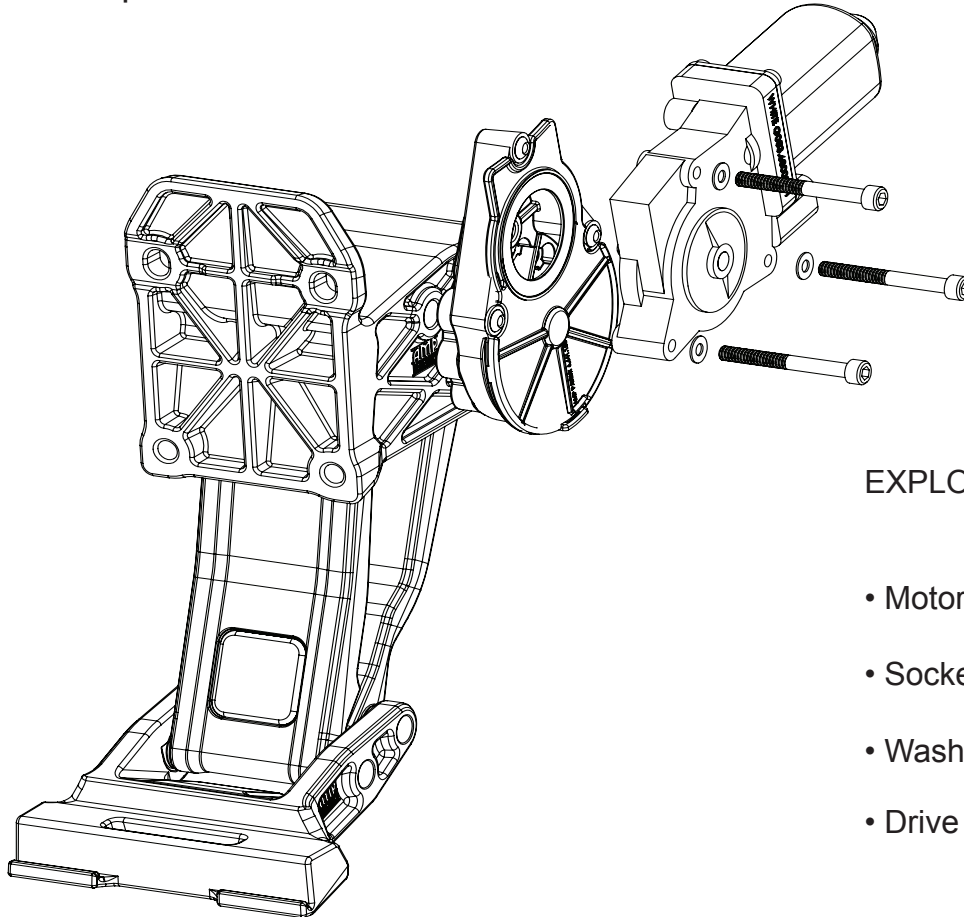

EXPLODED VIEW

- Motor
- Socket cap screw
- Washer
- Drive Gear Housing Cover

CAUTION: HANDLE WITH CARE.

To ensure our customers receive all components with full integrity, we pack the motors separate from their linkage assemblies. This requires that the installer position and fasten the motor before continuing with the install. Please follow the instructions below and handle the assembly carefully.

CAUTION: Dropping the assembly or any excessive impact MAY cause damage to the motor.

Instructions:

1. Position the gear cover in place as shown if not already in place.
2. Seat motor into position on the three mounting bosses. This may require an adjustment of the gear by moving the swing arms.
3. After seating into place, fasten the motor with the three motor mount screws with 4mm Hex Head. Tighten screws to 36 in-lbs (4N-m). **Do not over torque.**

Note: Some Applications require modification.

Application	Cut Length
Crew Cab	79" (No Modification Required)
Super Cab	60" (Trim 19")
Regular Cab	48" (Trim 31")

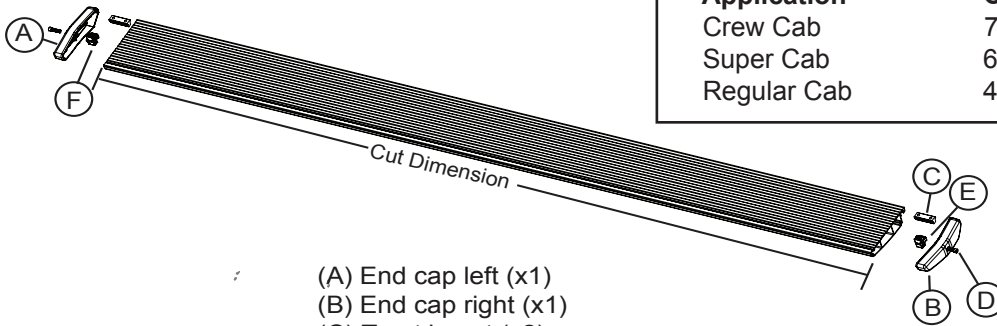

- (A) End cap left (x1)
- (B) End cap right (x1)
- (C) T-nut insert (x2)
- (D) Socket cap screw (x2)
- (E) End cap wedge right (x1)
- (F) End cap wedge left (x1)

1 x2

Running board assembly

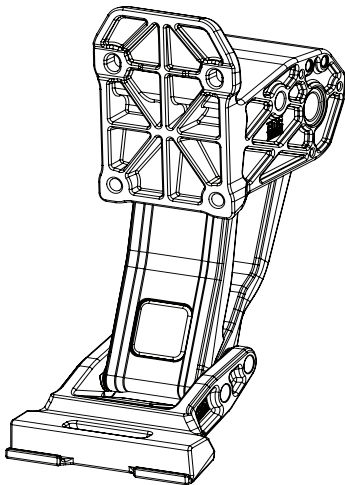

2 x2

Idler linkage assembly

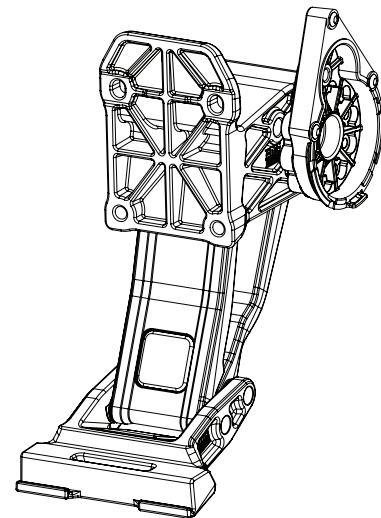

3 x2

Motor linkage assembly

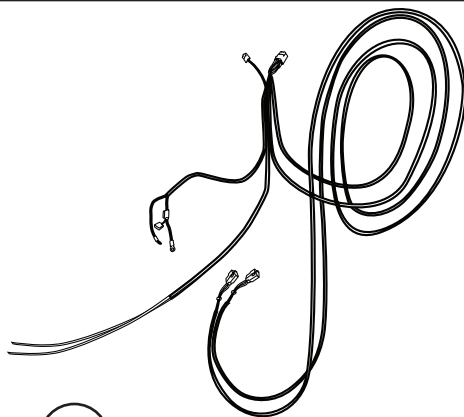

4

Wire harness

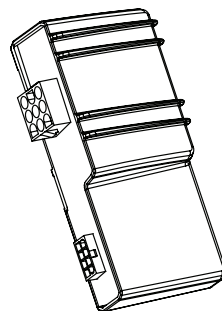

5

Controller STA

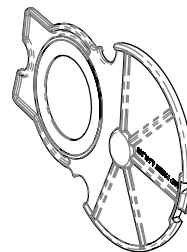

6 x2

Gear Cover

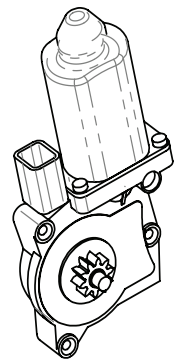

7 x2

Motor

PARTS LIST AND
HARDWARE
IDENTIFICATION

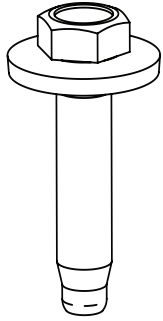

8 x8
Conical Bolt



9 x8
Button head - M10

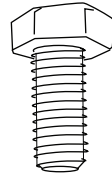

10
Hex head screw

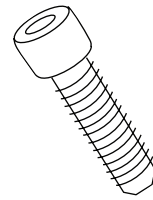

11 x8
Socket cap screw



12 x8
U-nut

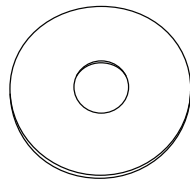

13
Large OD Washer

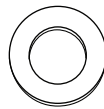

14 x8
M10 Washer (stainless)

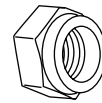

15
Nylock nut-M8



16
Nylock nut-M6

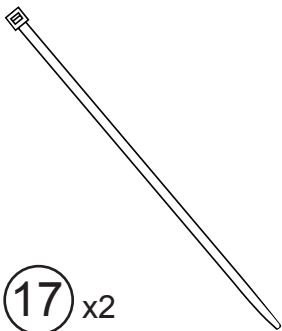

17 x2
Cable tie (11'')

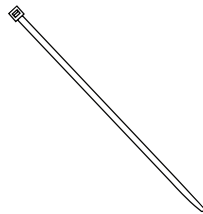

18 x20
Cable tie (7'')

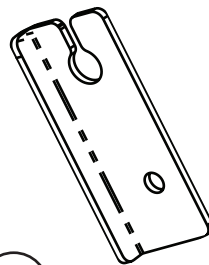

19
Brake cable bracket

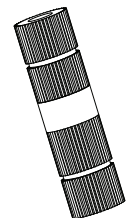

20 x2
Posi-Lock®

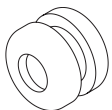

21 x4
Grommet

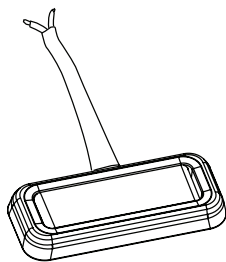

22 x4
LED Lamp

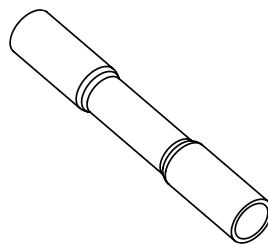

23 x8
Butt connector

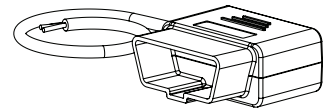

24
OBD II Plug

Driver Side Shown

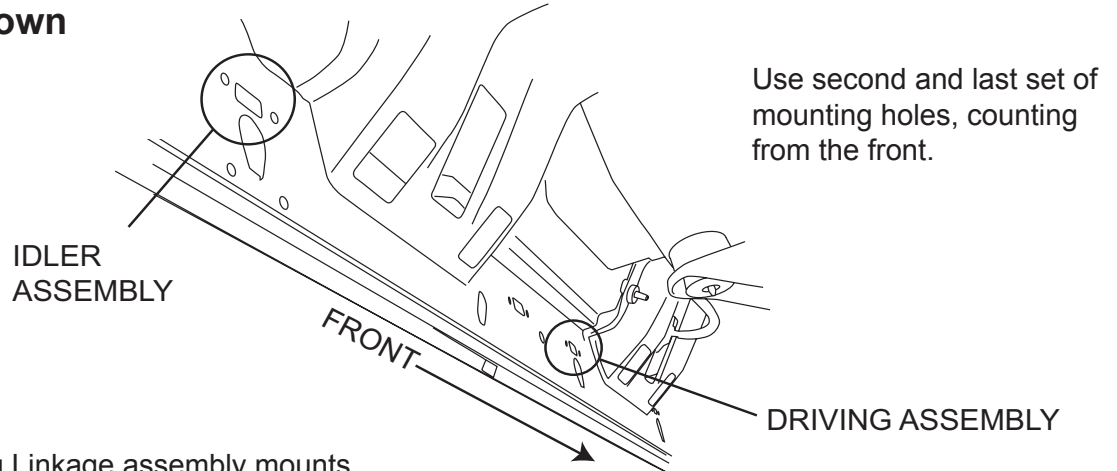

1 NOTE: Driving Linkage assembly mounts in the front; idler mounts in the rear.

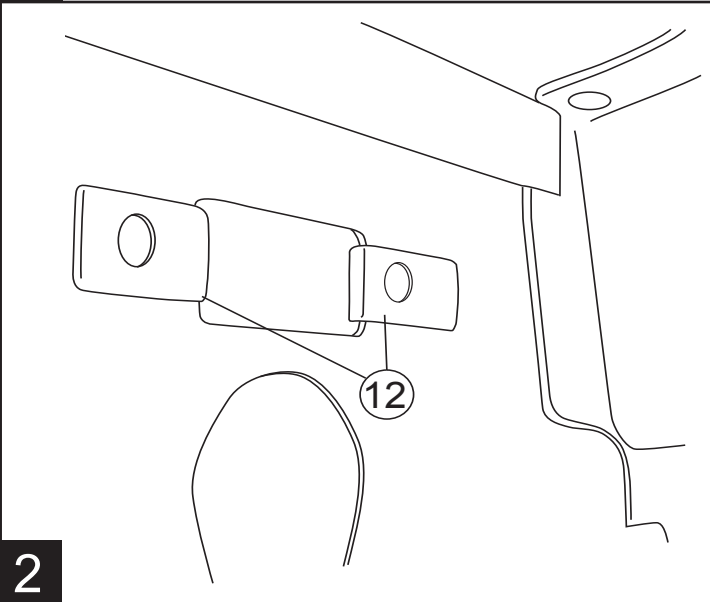

Disengage parking brake.
Pull parking brake cable rearward from forward support bracket to create slack in cable. Secure cable slack with locking pliers.

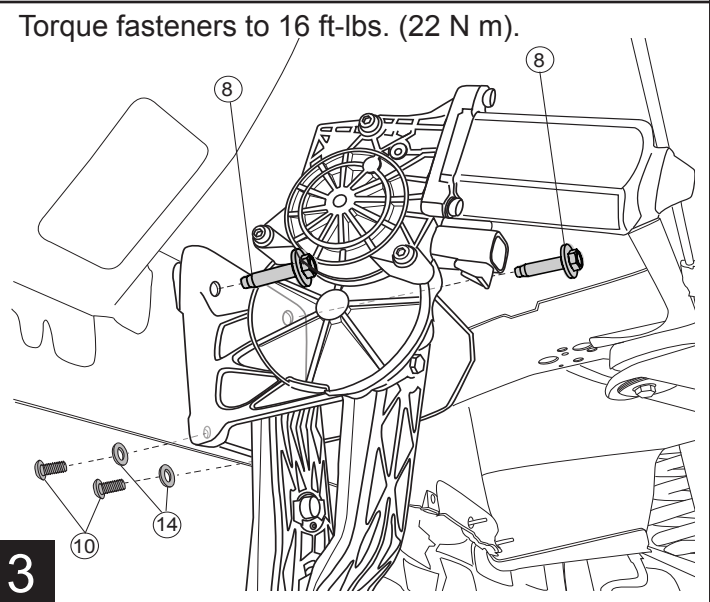

Remove cable from rear support bracket and install cable bracket extension with large washer on front side of bracket. Re-install parking brake cable and remove locking pliers.

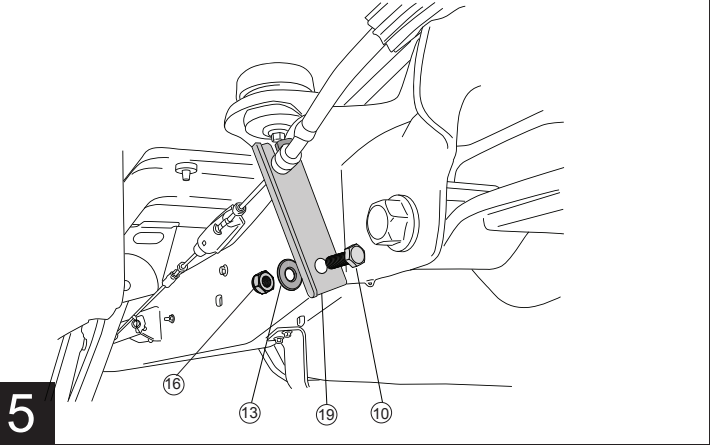
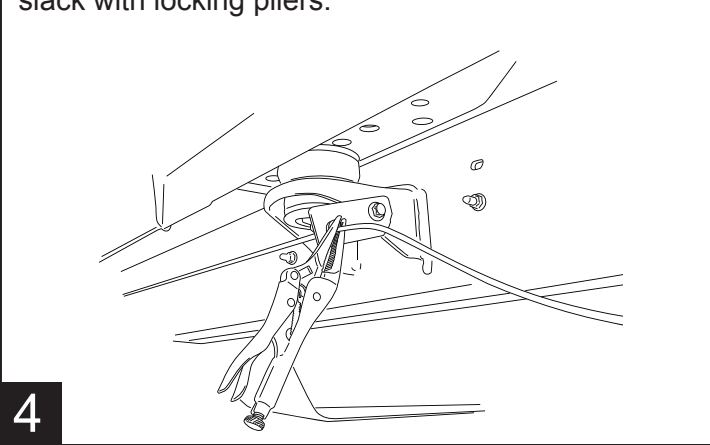

Remove fuse from harness.

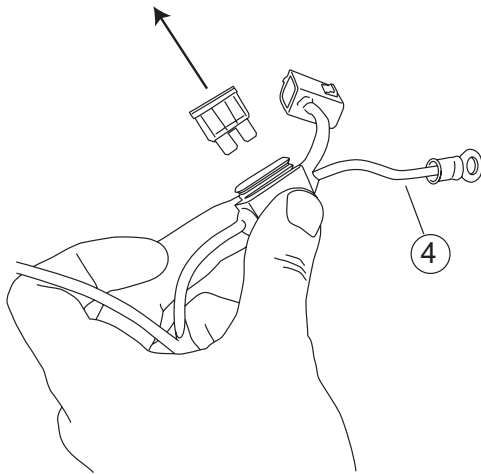

6

Secure controller to vehicle wire loom beside battery (on passenger side) and connect both Power Step wire harness connectors to connectors on controller. Secure locking tabs on connectors.

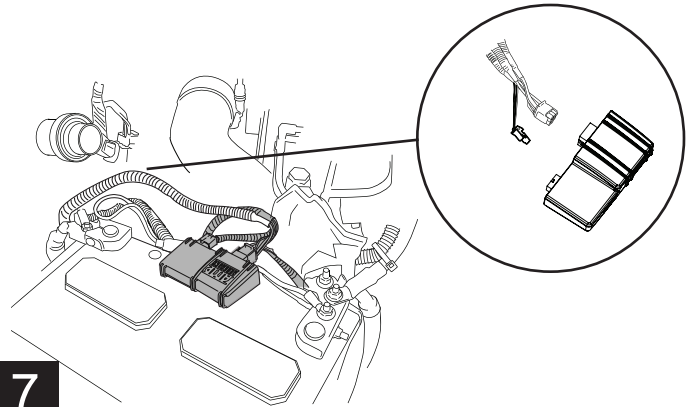

7

Connect power and ground for controller to battery, Red to positive and Black to the negative lead. Route harness legs down over wheel wells toward motor linkages, long leg across front and over to driver side. Secure all loose sections of the harness with cable ties.

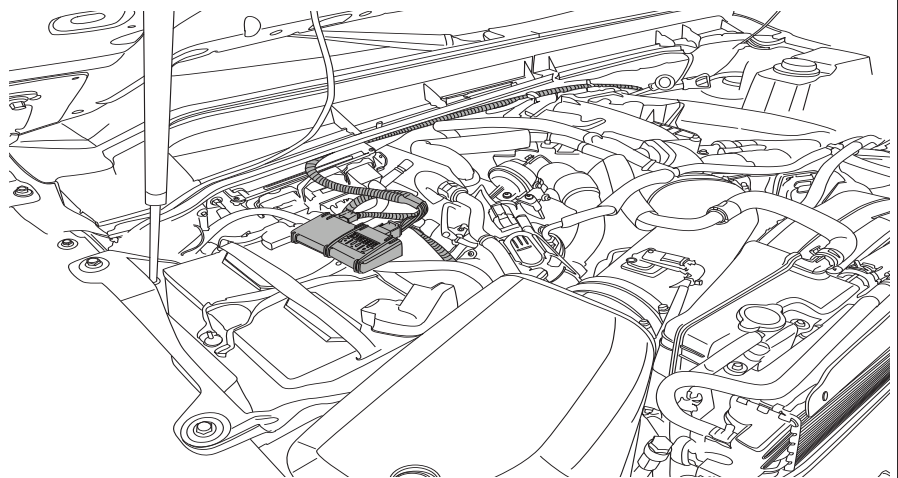
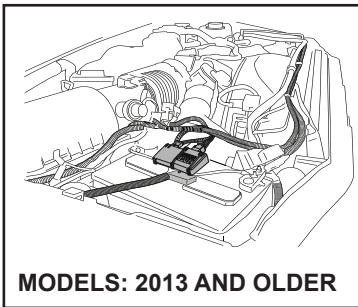

8

Run wire legs down and along underside of vehicle floor, securing with tie wraps. Run trigger wires (2) on Drivers side through grommet as shown below.

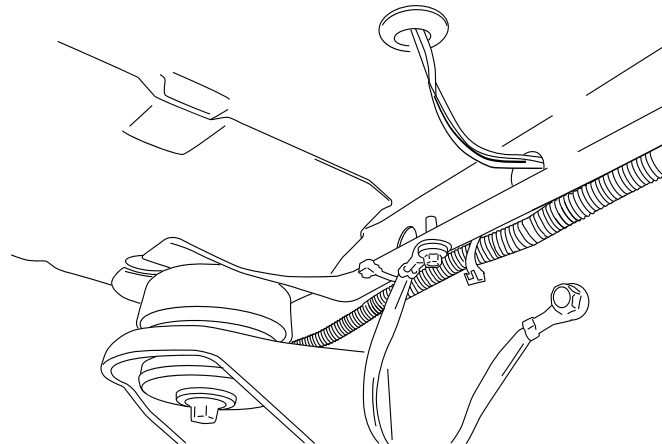

Driver-Side

9

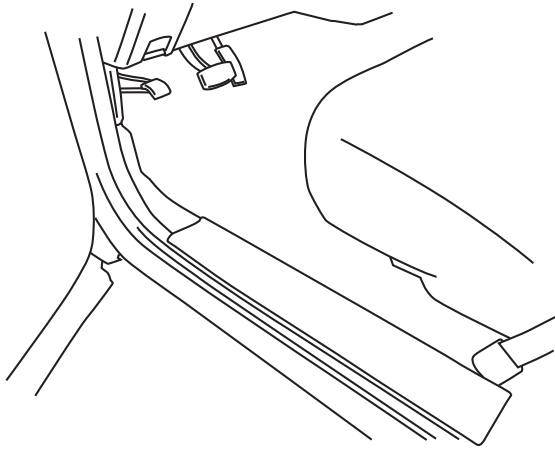

Wire OBD II connector with Posi-Splice and plug into port.

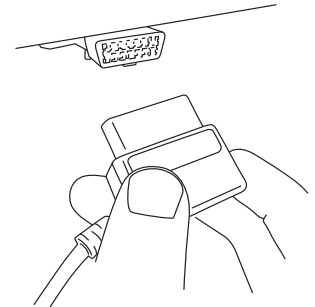
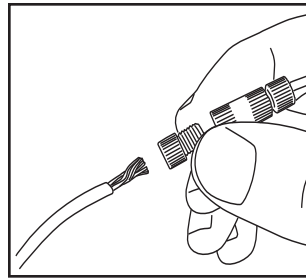

10 Open driver door and remove sill plate and kick panel.

11

OBD II install: Use Supplied Posi Twist connectors to attach the Plug and Play Module to the Harness. Attach matching colors on the harness to the wires on the module. Plug in module to OBD II port on the vehicle. Secure harness with supplied tie wraps.

Note: If the OBD II pass thru harness (76404-01A) was purchased see install sheet supplied in packaging. The pass through harness allows for an open port for other accessories. See below for a brief description.

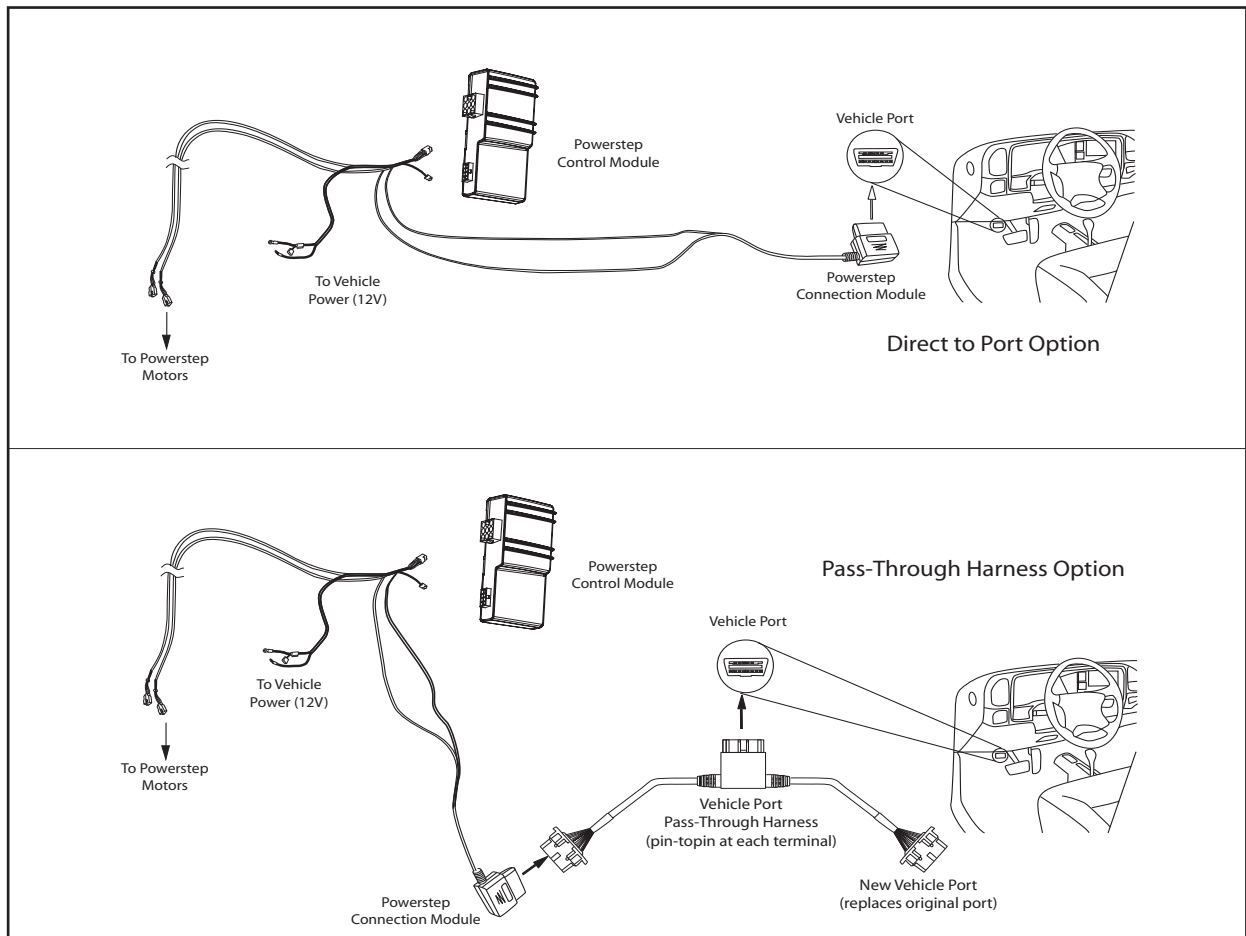

12

Secure wires and replace kick panel and sill plate. Be careful not to pinch any wires when replacing panels.

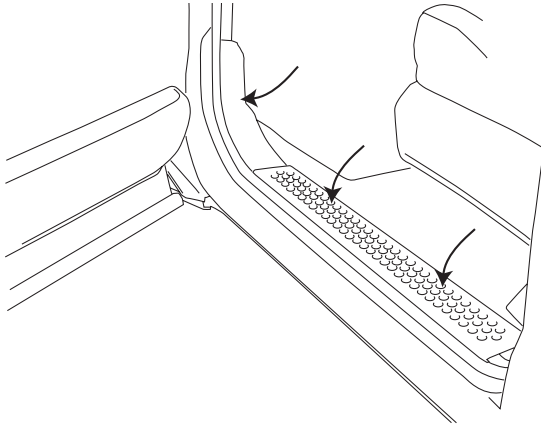

Plug in motors (both sides). Route remaining LED light wires back towards rear of vehicle.

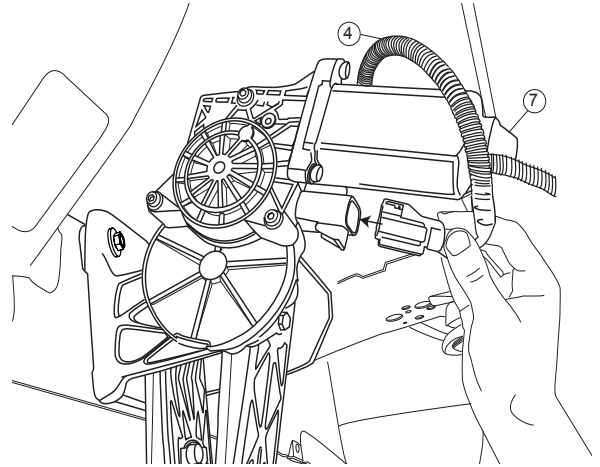

13

14

Slide mounting T-nut into position. Mount Board and tighten fasteners to 10ft-lbs. Align the end of the board with the rear edge of the back door.

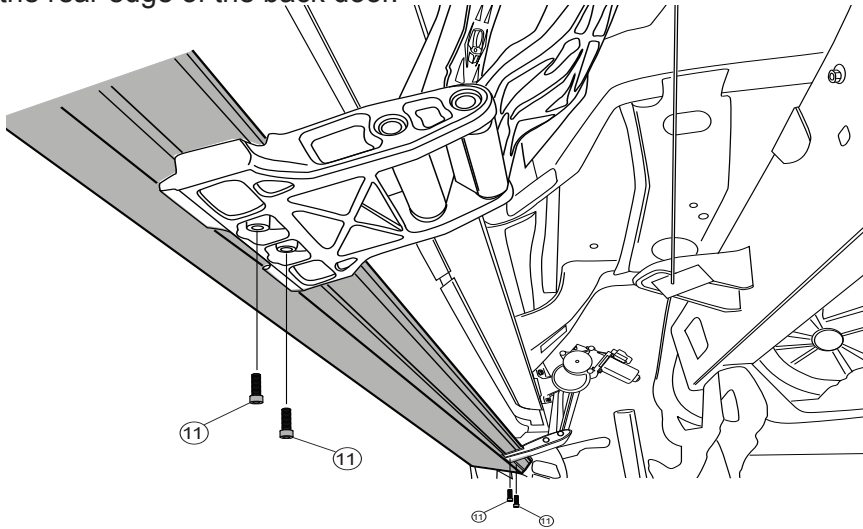

TORQUE
10 ft-lbs. (13.5 Nm)

15

On each side of the vehicle measure from the front edge of door line on the pinch weld to the specified lengths below. Measure at 27" for front LED Light and 65" for rear LED Light.

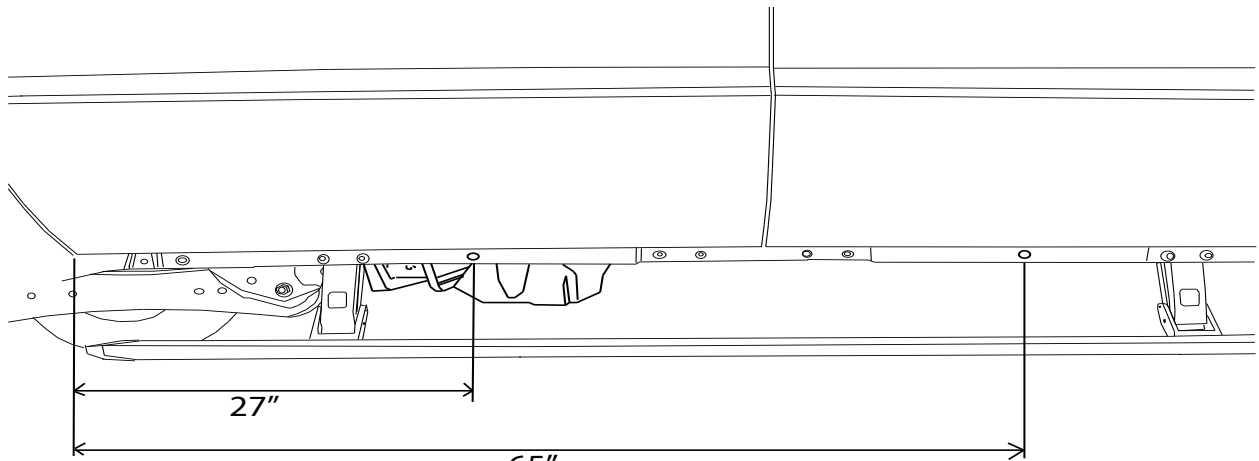

16

Drill a 9/32" hole through the pinch weld at marked locations. Deburr all holes.

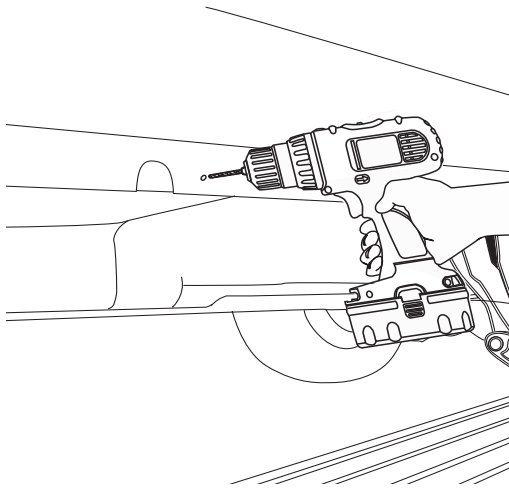

17

Insert grommet into drilled holes. Insert lamp wires through the grommets. (Silicon lube will help wires slip through grommets.)

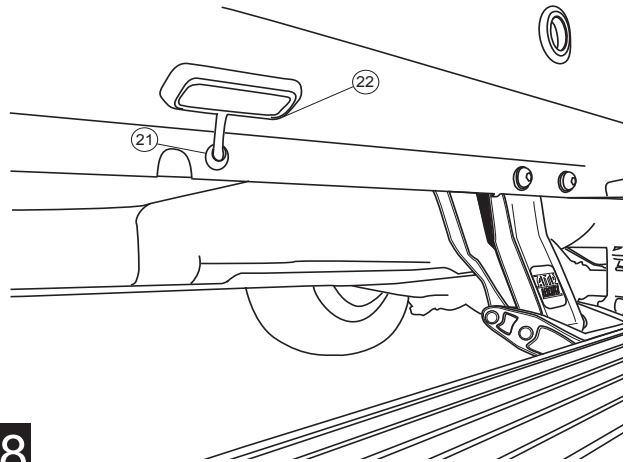

18

Affix lamp to rocker panel surface. Make sure lamp is affixed to a flat, clean surface.

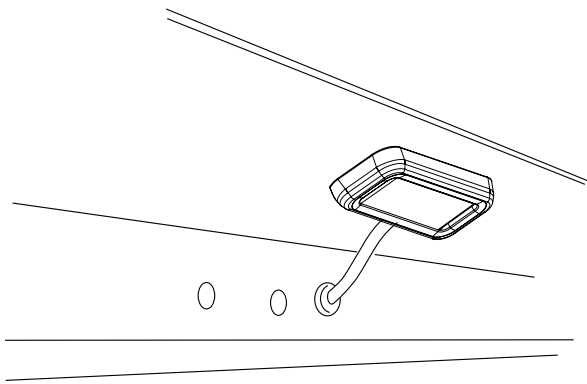

19

Using supplied butt connectors, connect the lamp wires. Red to Red, Black to Black. Once Crimped use heat gun to shrink tube.

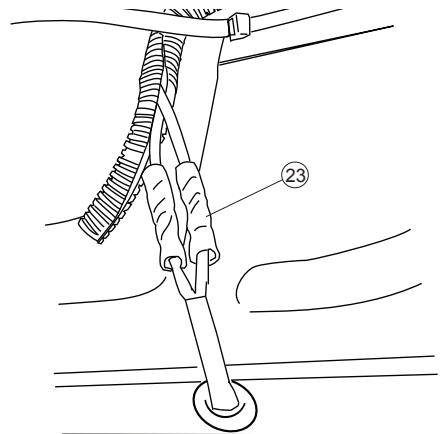

20

Close and wrap with conduit and electrical tape. Secure all loose wires with cable ties, with lamp wires pulled upward to avoid any wire snagging.

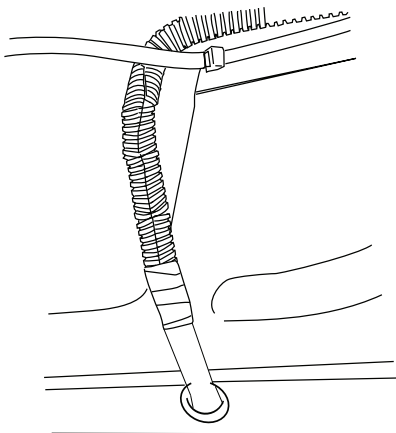

21

Reinstall the fuse.

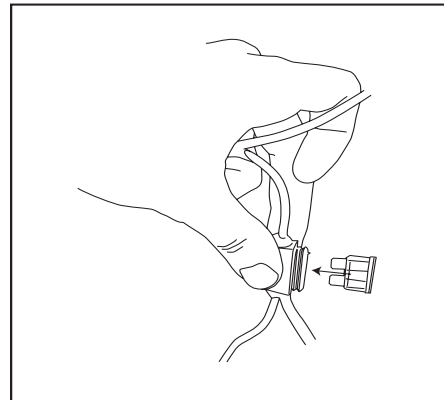

22

Check that all doors activate the Power Step and the LED Lights work when doors open and close. Reinstall any remaining trim panels.

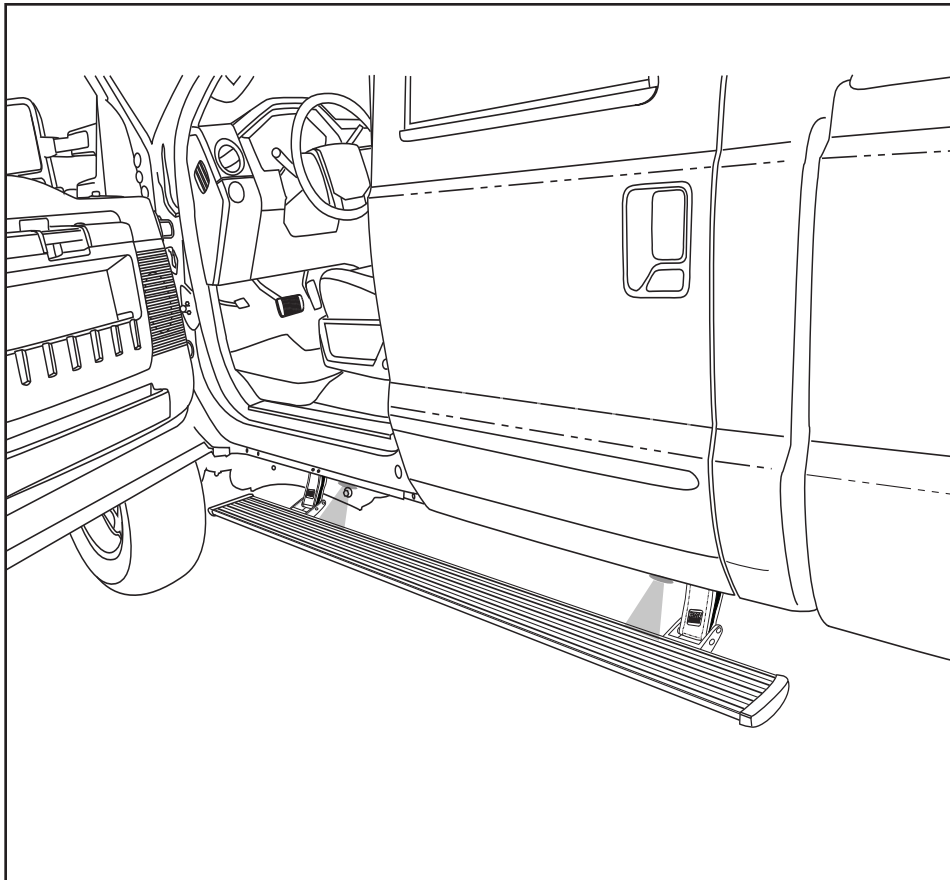

FINAL SYSTEM CHECK

Check that all doors activate the PowerStep and the LED lights work when doors open and close.

NORMAL OPERATION: When the doors open, PowerStep automatically deploys from under the vehicle. When the doors are closed, PowerStep will automatically return to the stowed/retracted position. ***Note that there is a 2-second delay before the PowerStep returns to the stowed/retracted position.***

CORRECT OPERATION OF LIGHTS: All four lamps will illuminate upon opening any door of vehicle. Lamps will stay on until restowing of both Power Steps or until 5 minutes has expired with the doors open. When the lights timeout after 5 minutes, they can be reilluminated by closing and opening any door of vehicle.