

AMP RESEARCH BedStep 2™

Chevy Silverado / GMC Sierra
 1500 2014 (all Beds)
 2500/3500 2015 (all Beds)

PART NUMBER:
 75407-01A

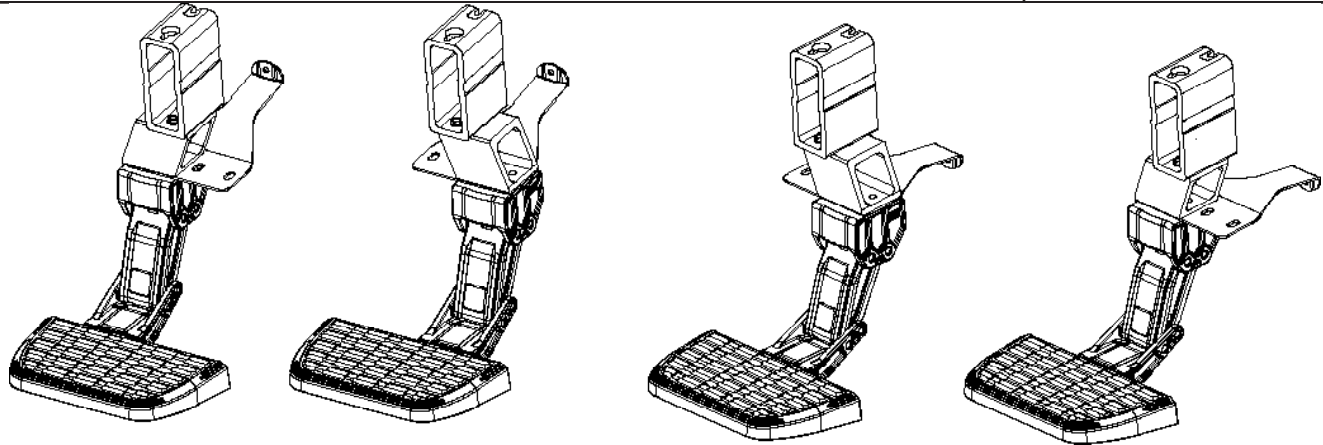
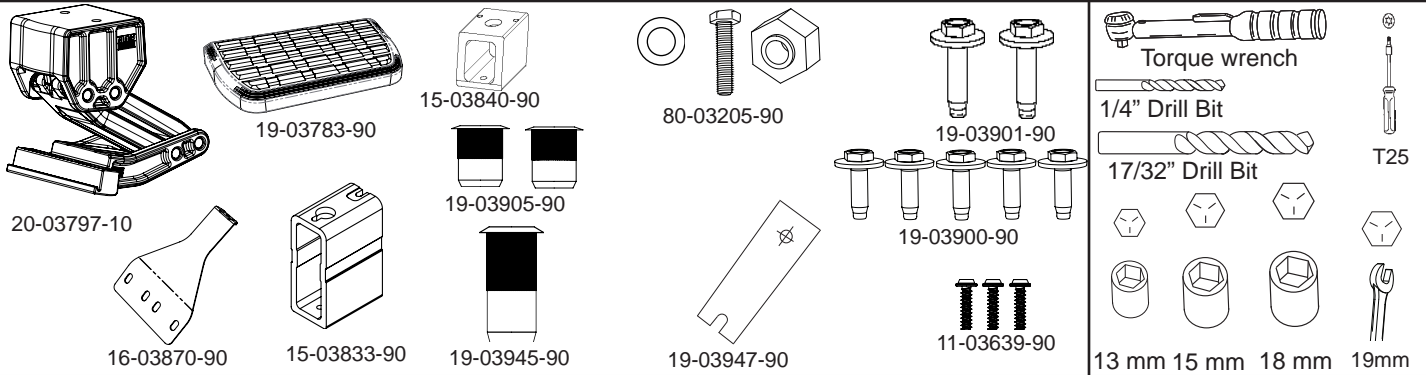

Drivers side Configuration all 5.5' [Bed Lengths](#) Passenger side Configuration all 5.5' Bed Lengths Drivers side Configuration all 6.5' & 8' Bed Lengths Passenger side Configuration all 6.5' & 8' Bed Lengths

1 Note: Part 15-03840-90 may not have angle cut in part.

Using a 15mm Socket assemble Lateral Mount onto Linkage Assembly with M10 Washered Hex Bolts. Steel Frame Bracket is to be assembled between Linkage Assembly and Lateral Mount. Do not tighten bolts yet. Driver's side configuration shown below... see Step 1 for passenger side configuration.

Using a 13mm Socket assemble Frame Mount onto Lateral Mount with M8 Washered Hex Bolts. Torque bolts to 16 ft-lbs.

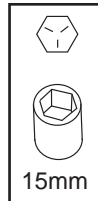
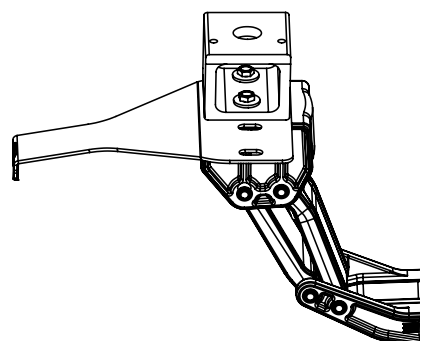

2

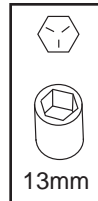
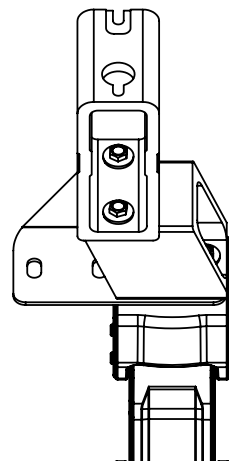

3

13mm

Using a 13mm socket, loosen M8 bolt from forward most bed channel on the underside of the truck. Loosen bolt to a gap of about 12mm (1/2"). Slide slotted end of the drill template over bolt and hold template in place with tape. Center punch hole and pre-drill using an 1/8" drill bit. Then drill to 17/32". Apply GM Vehicle Care Super Lube to drilled surface.

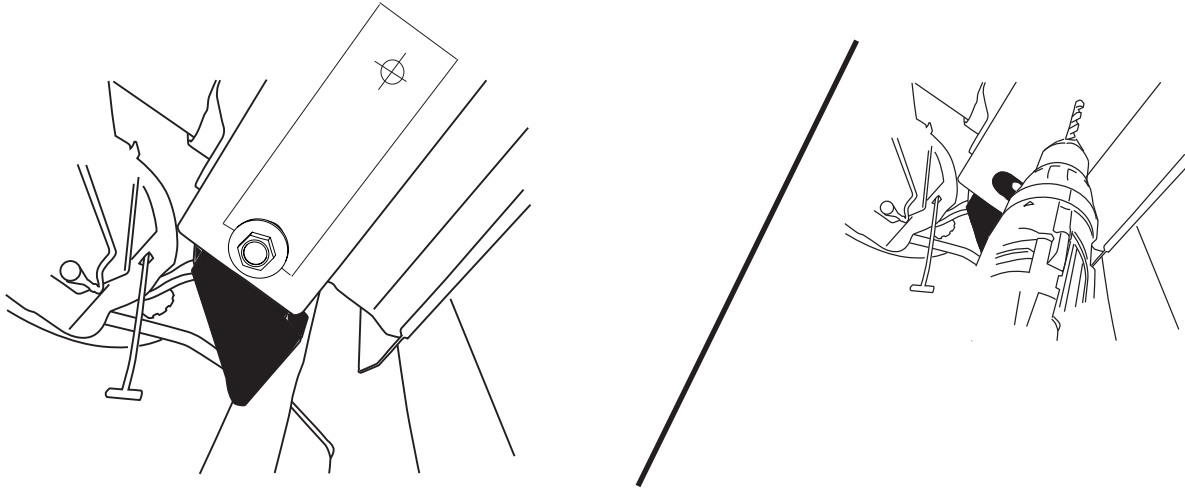

4

Install Rivet Nut onto bed channel. With Rivet nut tool held in place with 19mm wrench, tighten hex bolt until rivet nut deforms and secures itself to the sheet metal. Torque to 20ft-lbs. Remove hex bolt and rivet nut tool. See figure Figure 5a for rivet nut tool assembly. Install M8 Washered Hex Bolt into Rivet Nut, leaving gap of about 12mm (1/2").

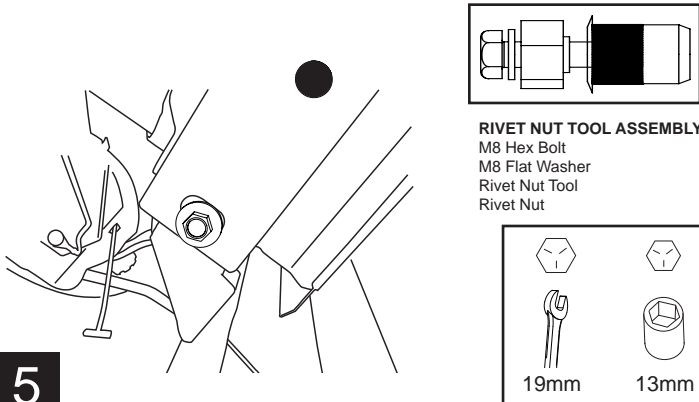

5

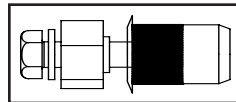

RIVET NUT TOOL ASSEMBLY
M8 Hex Bolt
M8 Flat Washer
Rivet Nut Tool
Rivet Nut

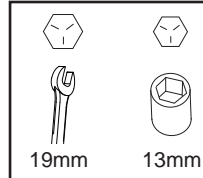

Lift Bedside Assist Step assembly into position, hooking Upper Mount onto installed bed channel bolts from Step 5. Snug bolts and slide Frame Bracket up to frame (in arrow direction) and mark hole location. Remove Step assembly, Center punch and pre-drill using a 1/8" drill bit. Then drill to 17/32".

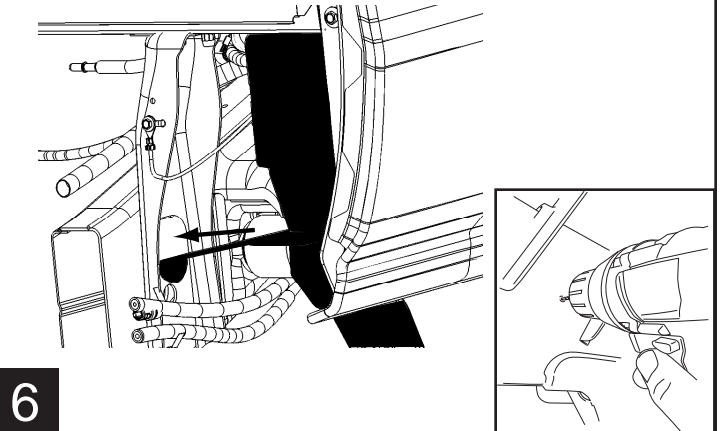

6

Install Rivet Nut onto frame rail just behind truck bed frame mount, just forward of rear wheel well. With Rivet nut tool held in place with 19mm wrench, tighten hex bolt until rivet nut deforms and secures itself to the sheet metal. Torque to 20ft-lbs. Remove hex bolt and rivet nut tool. See figure Figure 7a for rivet nut tool assembly

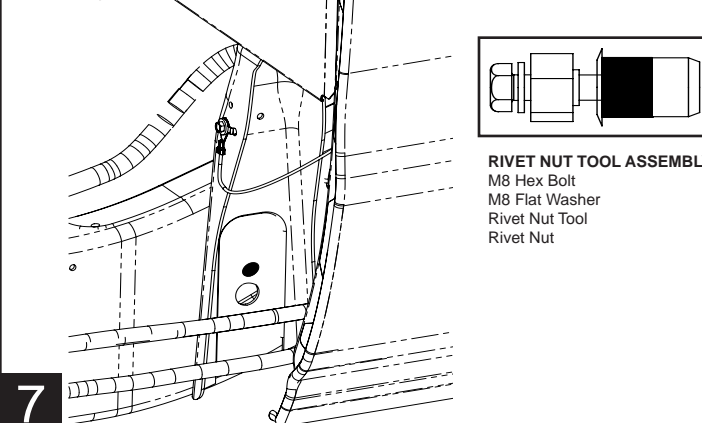

7

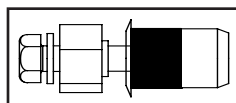

RIVET NUT TOOL ASSEMBLY
M8 Hex Bolt
M8 Flat Washer
Rivet Nut Tool
Rivet Nut

Lift Bedside Assist Step assembly into position, hooking Upper Mount onto installed bed channel bolts from Step 5. Install additional M8 Washered Hex Bolt through Frame Bracket and into Rivet Nut installed on frame rail. Straighten assembly and tighten bolts to 16 ft-lbs.

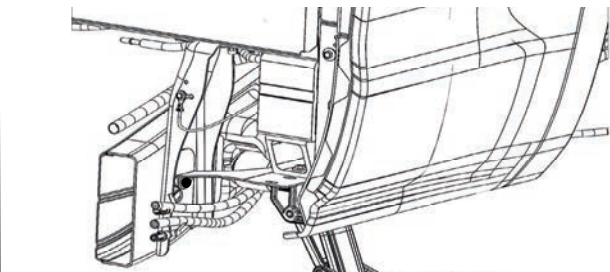

8

Place Step Pad on Linkage mounting interface. Mounting interface allows three positions, centered and offset to either side. Tighten all three screws to 5 ft-lbs. using T25 Torx Bit.

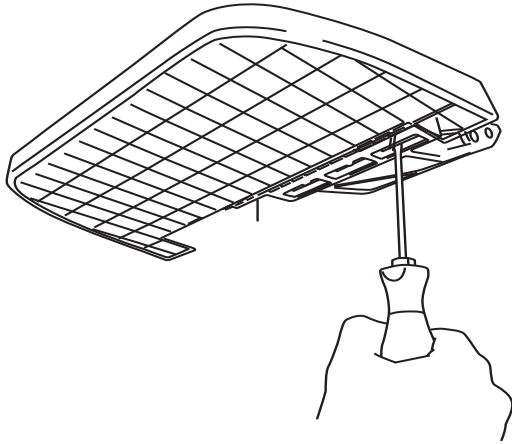

9

Adjust Step Pad to be in line with fender.

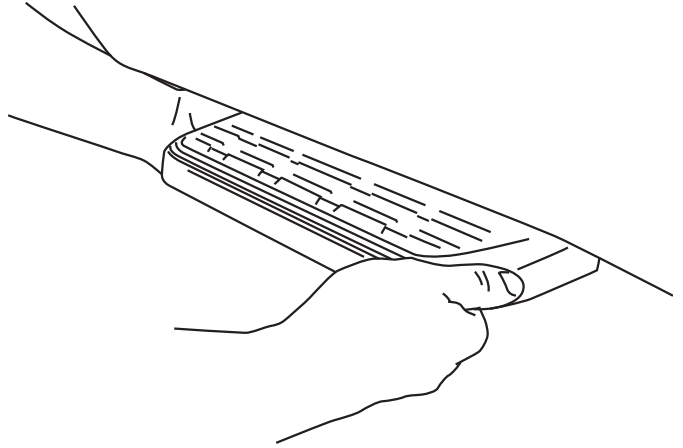

10

Tighten M10 Washered Hex Bolts using a 15mm Socket. Torque to 20 Ft-lbs.

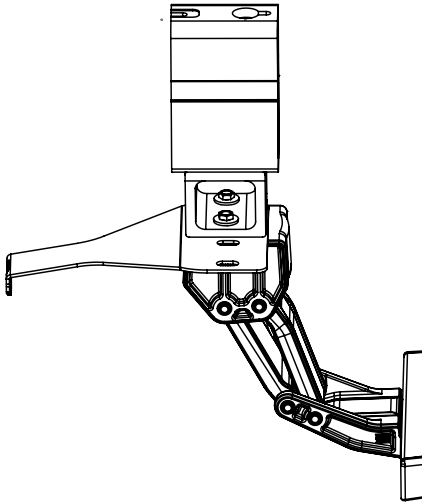

11

To deploy the step, press down using your foot on the outside edge of the step pad.

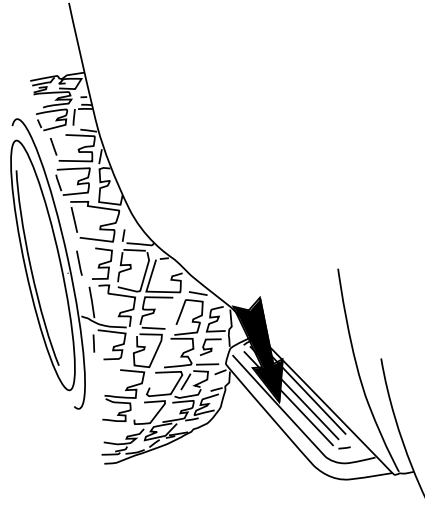

12

To retract, gently kick up on the underside of the step pad.

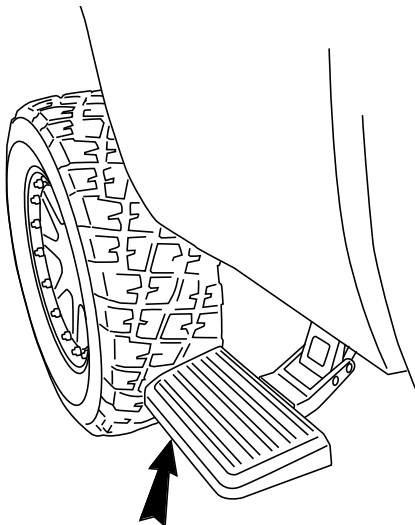

13



BEDSTEP2™ OPERATION

The AMP Research BedStep2™ is foot operated and deploys and retracts with a nudge of your foot. To deploy, press down using your foot, on the outside edge of the step pad.

Maximum load capacity of the deployed step pad is 300 lbs.

Always use appropriate hand holds when stepping up to or down from your truck's cargo bed.



To retract, gently kick up on the underside of the step pad.

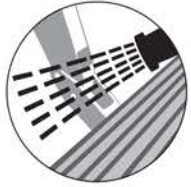

MAINTENANCE TIPS - The stepping surface and linkage should be periodically washed with mild soap and water using a soft brush or sponge to dislodge any mud, dirt or accumulated road grime.

In severe driving conditions, pressure washing the linkage is strongly recommended.

Do not apply silicone spray, waxes or protectants like Armor All® to the stepping surfaces.

CAUTION! BEDSTEP2™ SHOULD ALWAYS BE STOWED IN THE RETRACTED POSITION WHEN DRIVING.