

ASSEMBLY & INSTALLATION GUIDE

AMP RESEARCH MOTOXTender[®]

MADE IN USA

APPLICATION

Small Truck, Universal (Mid-size and small trucks, small beds)

PART

74809-00A (Silver)

74809-01A(Black)

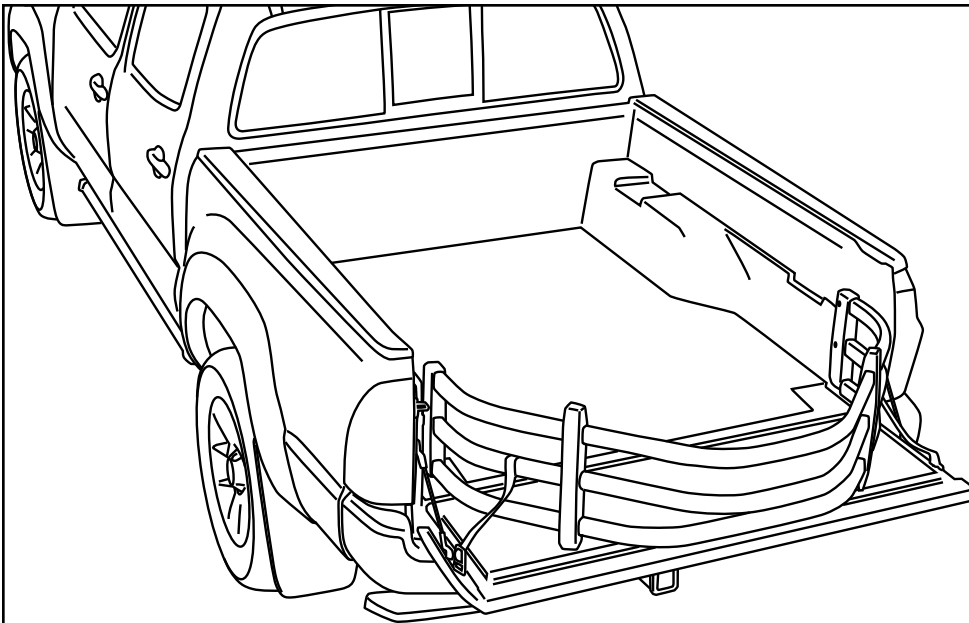

MOTOXTENDER HD™ shown assembled and installed on truck.

Remove contents from box and check for damage.

Verify all parts against parts list.

Read and understand instructions completely before attempting assembly and installation.

INSTALLATION TIME

1 Hour

SKILL LEVEL



1= Easy

TOOLS REQUIRED

Phillips screw driver

Torx T-25 driver

Power drill

9/64" drill bit

Center punch

Supplied templates

Soapy Water

Invented, engineered and manufactured exclusively by AMP Research in the USA. May be covered by one of the following patents:

5,700,047; 6,113,173; 6,402,215; 6,805,392; 7,063,366; 7,393,035; 7,654,598; 7,681,935; 7,841,638

AMP RESEARCH MOTOXTENDER HD™

PARTS LIST AND HARDWARE IDENTIFICATION

1 x2

74608-01A
Quick Mount
Bracket Set

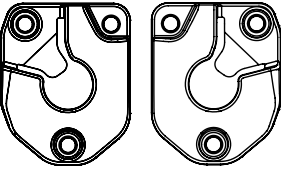

2 x6

20-01998-90
Phillips head
screw
(included in 74608-01A)

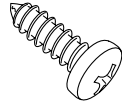

3 x12

11-03639-90
PT-Screw

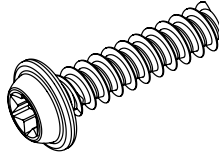

4 x4

20-3654-90
Bumper Upright

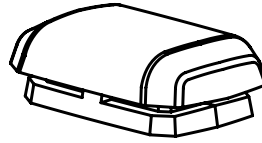

5 x2

80-01671-93
Strap Buckle Assembly

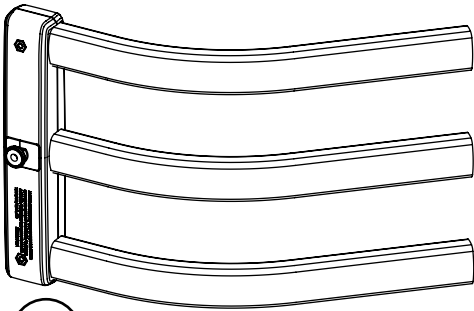

6 x2

Silver: 20-74801-00A
Black: 20-74801-01A

Pivot Upright Assembly



7 x2

20-3664B-90

Bumper Upright Outer



8 x2

20-3664A-90

Bumper Upright Inner

9

12-03791-52.5SP
12-03791-52.5BP

Double Bend Center Tube (With AMP Logo)

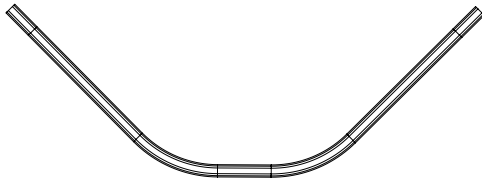

10

12-03791-52.5S
12-03791-52.5B

Double Bend Center Tube (Without AMP Logo)

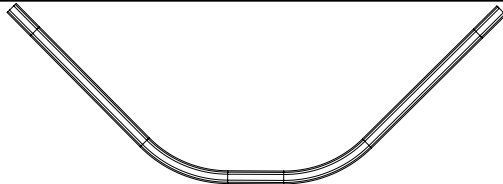

11

12-03791-49S
12-03791-49B

Double Bend Center Tube (Without AMP Logo)



12 x2

Strap latch insert

Kit number 74603-01A

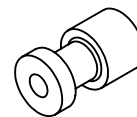

13 x2

Socket cap screw

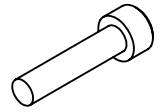

AMP RESEARCH MOTOXTENDER HD™

ADDITIONAL MOUNTING KITS

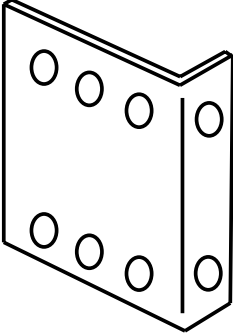
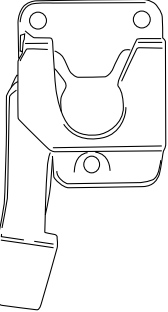
	DESCRIPTION	APPLICATION	PART #
 <p>The image shows an L-shaped metal bracket with eight circular holes. Four holes are arranged in a vertical line on the longer leg, and four are arranged in a vertical line on the shorter leg. The bracket is shown in a perspective view.</p>	<p>L-Bracket Mounting Kit</p> <p>REQUIRED ON SOME APPLICATIONS TO COMPLETE INSTALLATION</p>	<p>GM S-Series Mazda B-Series Nissan Pickup Toyota Pickup (Pre 2005 models)</p>	<p>10-74601-01A</p>
 <p>The image shows a metal mounting bracket with a latch mechanism. It has a U-shaped opening at the top and a vertical latch arm extending downwards. There are several circular holes for mounting.</p>	<p>QuickLatch Mounting Bracket Kit – Universal</p> <p>Required on some applications to install with motorcycles</p>	<p>All short bed trucks when hauling motorcycles.</p>	<p>10-02936-90</p>

UNIVERSAL MOUNTING BRACKET INSTALLATION

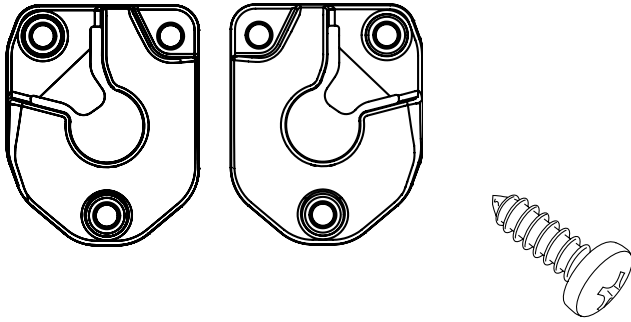

① x2

Quick Mount
Bracket

② x6

Phillips head
screw

Cut out supplied template and tape to the D-pillar as shown. Using a center punch, mark holes as specified by the template.



1

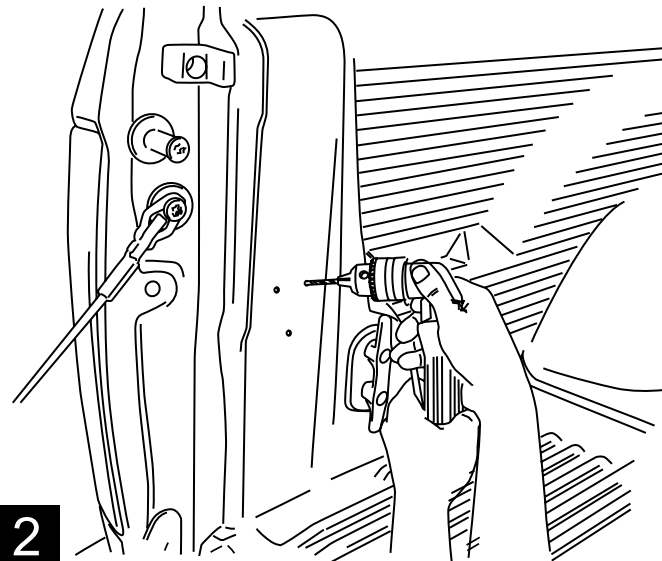

2

Using a power drill and 9/64" drill bit, drill through the sheet metal. If equipped with a bedliner, drill through bedliner.

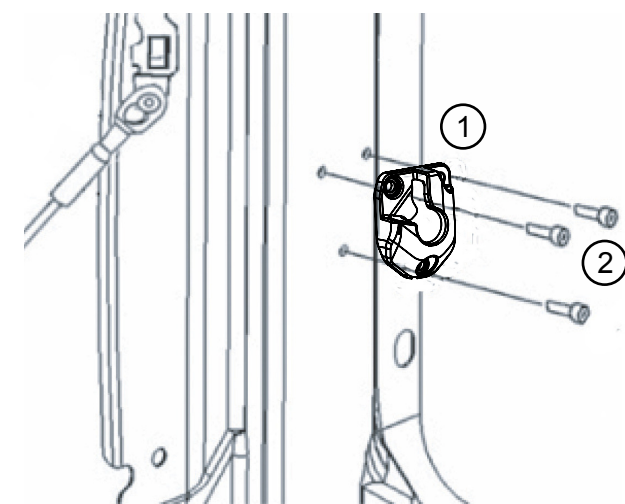

3

Fasten mounting brackets using the supplied self-tapping Phillips screws and torque to 30 in. lbs. If equipped with a bedliner, install mounting brackets over bedliner.

NOTE: If bedliner has contours that may prohibit a flat, solid mounting surface, cut out a rectangular section to clear the bracket and mount the bracket directly to the metal D-pillar.

BED X-TENDER ASSEMBLY

Using template measure 7" from each end of the three long tubes and mark with tape. **Tape is to be used as a reference point. (See step 6)**

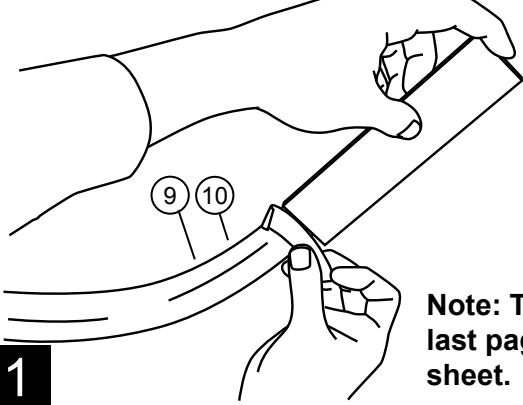

Note: Template on last page of install sheet.

1

Slide the center tube (With Amp logo) into the center tube of the 3-tube assembly. **Be sure to slide on Strap Buckle Assembly to center tube of Pivot Upright Assembly**

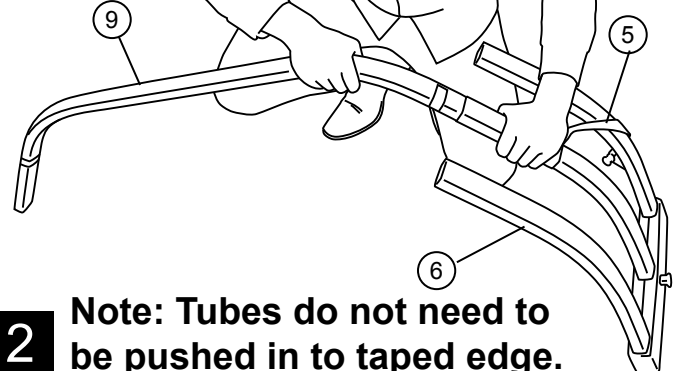

Note: Tubes do not need to be pushed in to taped edge.

2

Insert the top long tube into the top tube of the 3-tube assembly.

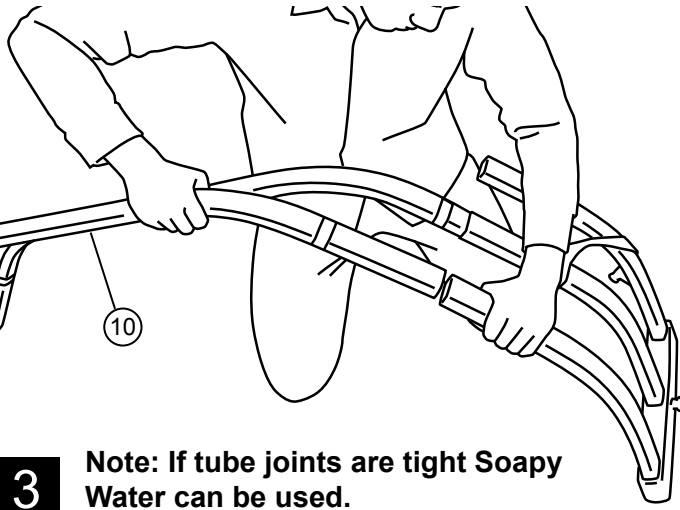

Note: If tube joints are tight Soapy Water can be used.

3

Insert the bottom long tube into the bottom tube of the 3-tube assembly.

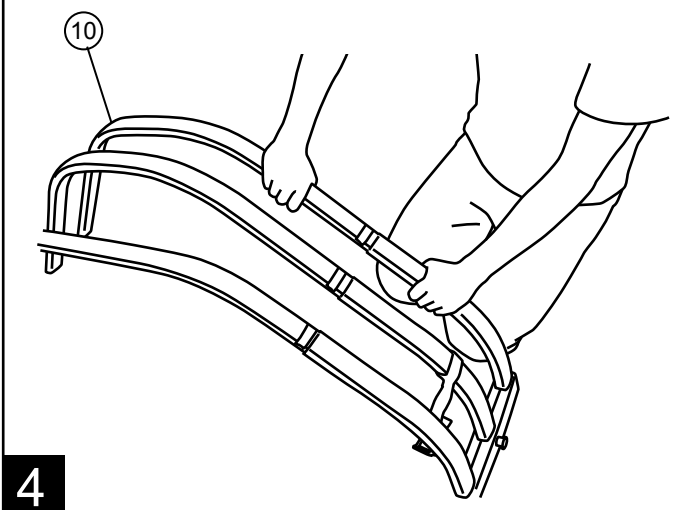

4

Repeat for the other side.

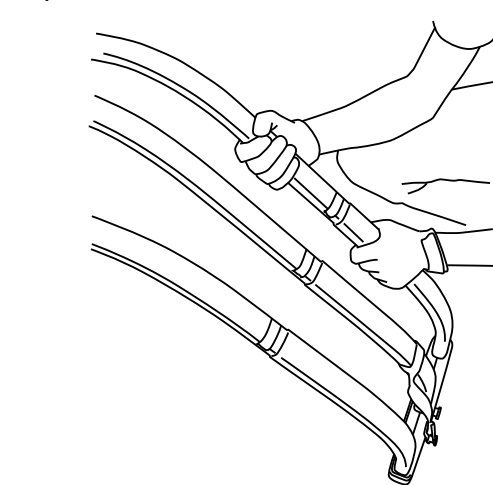

Note: Install Strap Buckle Assembly to center tube of Pivot Upright Assembly.

5

Adjust the width of the MOTOXTENDER to fit the pre-installed mounting brackets. To keep tube overlap constant, adjust each tube so that the gap between the edge and the tape is the same.

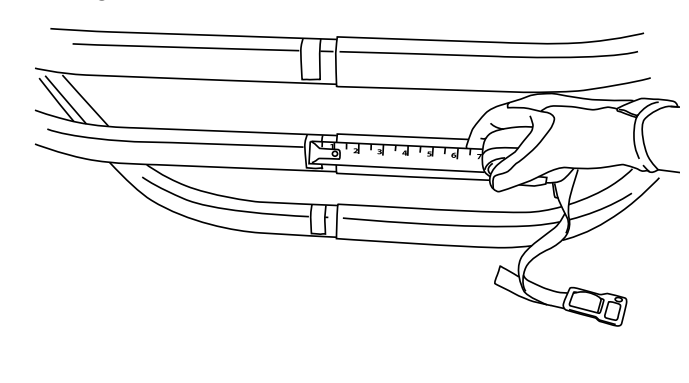

6

BED X-TENDER ASSEMBLY – CONTINUED

Attach plastic upright around the tube juncture, placing rubber bumpers into the two ends of the upright.

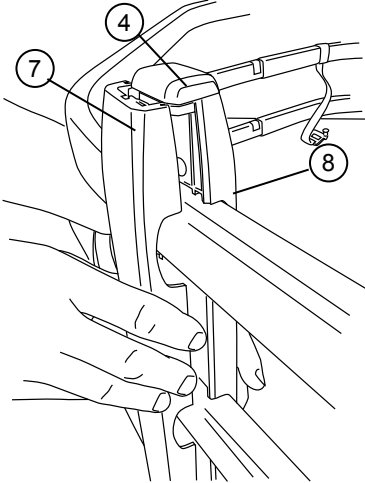

Upright is not positioned in center of tube joint.

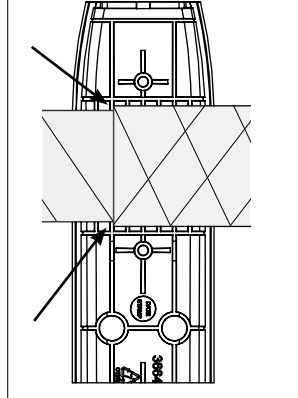

7 **NOTE:** The inside of the upright is stepped to fit correctly around the small and large diameter tubes.

Tighten PT-Screws using a T-25 torx driver, starting in the middle of each upright, then the outer screws and lastly the remaining two to evenly tighten.

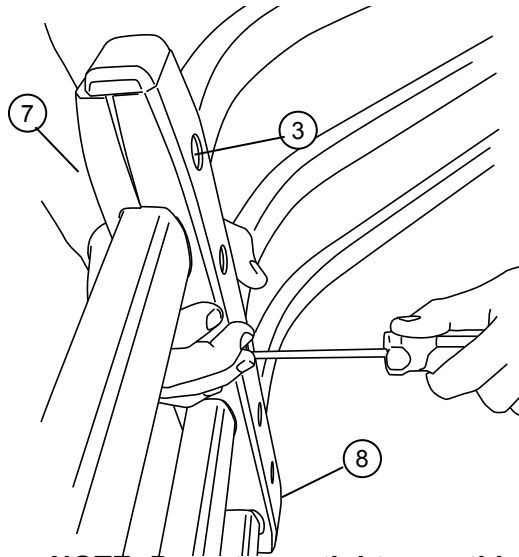

8 **NOTE:** Do not over tighten as this may strip out. Fastener will reach a noticeable stopping point.

Adjust Strap Buckles to lock into the tailgate when BEDXTENDER is deployed. Your assembly is now complete.

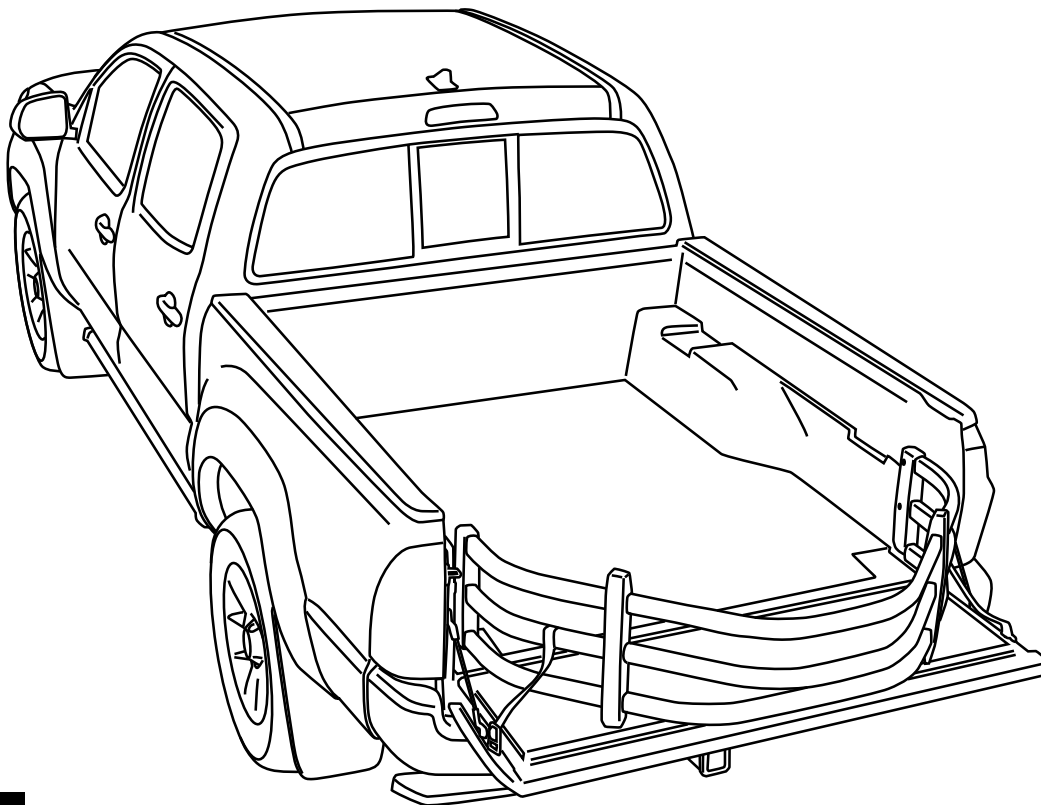

9

For Toyota applications the supplied Strap Buckle Insert must be used.

Remove the PT-Screw with a T20 Torx driver.

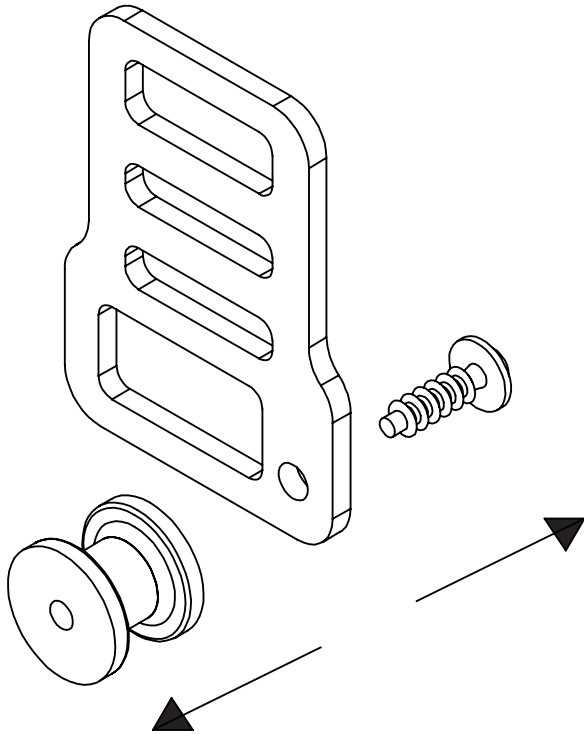

10

Install Strap Buckle Insert with the provided 10/32 x 7mm socket head cap screw with a 4mm hex key. Repeat for other strap.

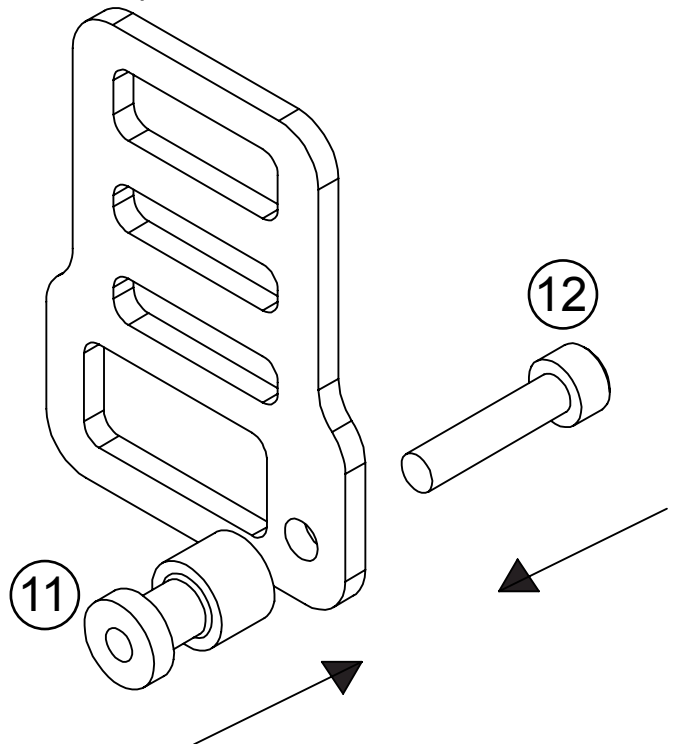

11

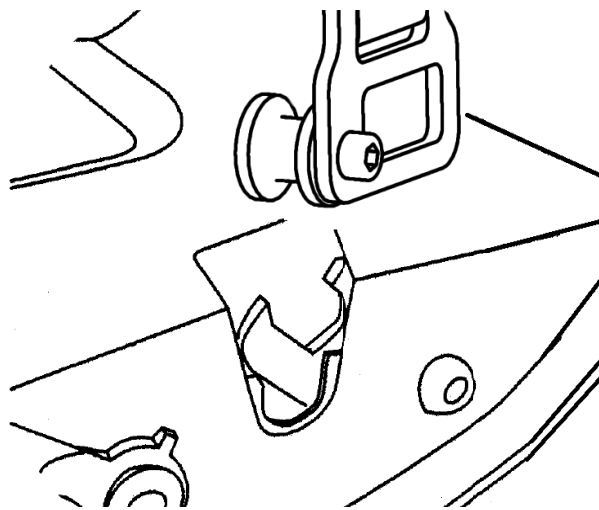

12

When the BEDXTENDER is at the furthest rear position, push down on the buckle to insert into tailgate latch. Tighten straps. To release, pull tailgate handle.

NOTE: Ensure that buckles are properly inserted into latches by pulling on the straps after both buckles have been inserted.