



FRONT RECIEVER INSTALL INSTRUCTIONS **2014+ DODGE / MERCEDES SPRINTER**

Please read before beginning

- *Stainless steel hardware may bind together when tightening—It is recommended that you apply an anti-seize assembly lubricant to the threads of each bolt before assembly*
- *This installation requires two people*

Required tools

- Standard wrench set
- Torx (6 point star head) wrench set
- Flat head screwdriver
- Hammer
- Putty knife
- Razor or box cutter
- Drill, with 3/8" drill bit

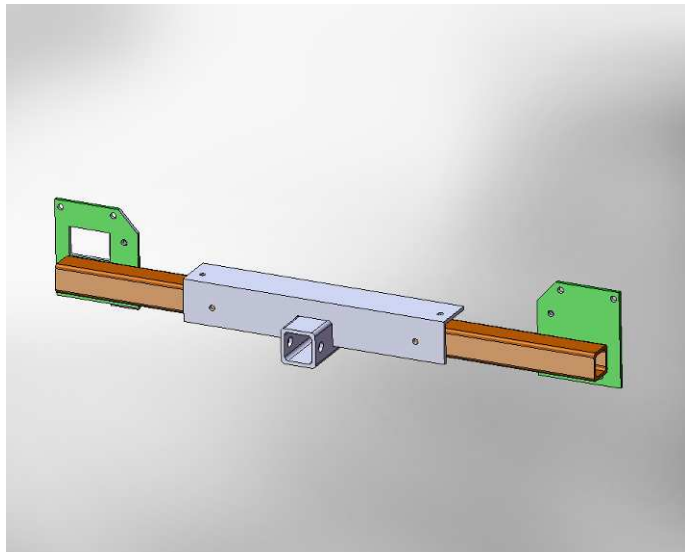

Included hardware

Quantity

- | | |
|---------------------------------------|---|
| • 70029 – 3/8" x 1 1/4" Hex head bolt | 4 |
| • 70024 – 3/8" Nut | 4 |
| • 70028 – 3/8" Washer | 8 |
| • 70185 – 7/16" X 4.5" Hex head bolt | 4 |
| • 70056 – 7/16" Nylock Nut | 4 |
| • 70057 – 7/16" Washer | 8 |
| • Steel Angle Brackets | 2 |
| • 2014 Sprinter Receiver Spacers | 2 |
| • DEF Tank support Bracket | 1 |
| • Aftermarket Bumper Assembly | 1 |
| • Cutting template | 1 |



Installation Instructions

1. To remove the stock bumper, begin by propping up the hood in order to access the grill
2. Remove the four torx-head bolts holding the grill on (indicated by the arrows in figure 1) – do not discard these, you will need them to put the grill back on
3. Once the bolts have been removed, the plastic clips holding the grill on must be released—pull the grill towards you gently to allow some space to put your hand behind it and reach the clips
 - To release the two large clips on the sides of the grill seen in figure 2, squeeze the top and bottom together (indicated by arrows) and push down—be careful, these break easily
 - To release the three bottom clips holding the grill to the bumper cover as seen in figure 3, push down on the tab sticking out from the grill while pulling the grill gently towards you—these
 - The use of gloves is strongly recommended here, as the metal heat exchanger tubes behind the grill are fairly sharp

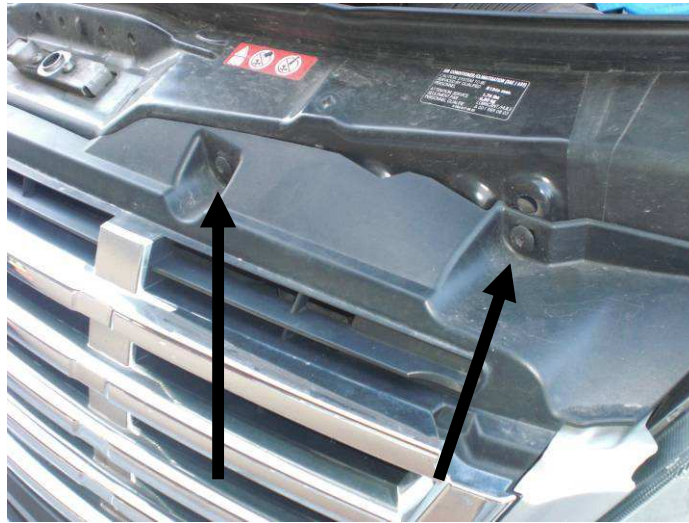

Figure 1: Stock grill hardware

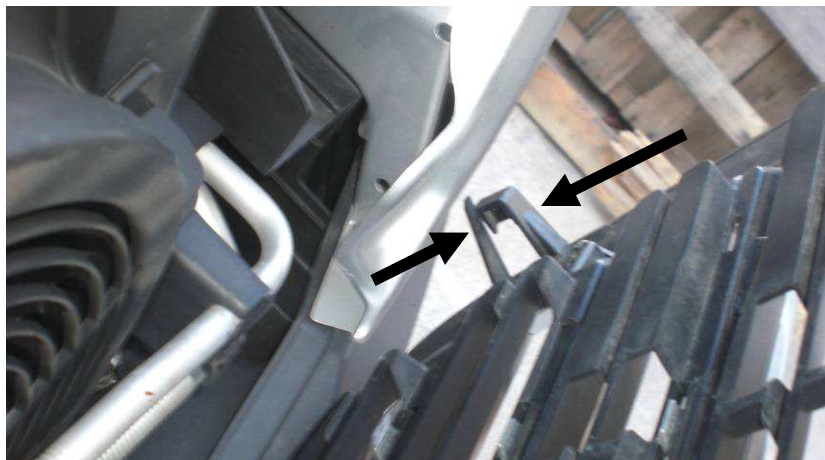

Figure 2: Grill retaining clips

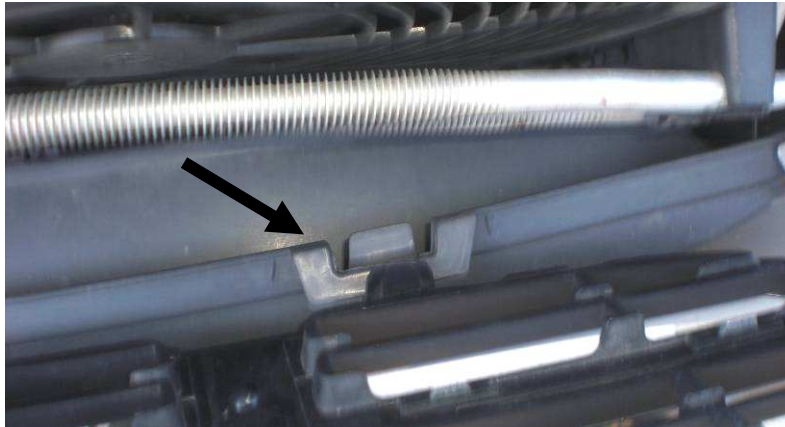

Figure 3: Lower grill retaining clips (top view)

4. Remove the plastic fasteners holding the bumper cover to the fender liners—there are three inside the fender and two underneath the front edge of the bumper cover on each side as seen in the photos below—in order to remove them, pry up on the center part of the fastener with a flat head screwdriver until it pops up, then the entire fastener may be removed by hand (see picture below)



Figure 4: (Clockwise from top left) Plastic fastener location in fender well; Plastic fastener locations under leading edge of bumper; Plastic fastener closed (left) and open (right)

5. Remove the metal trim pieces underneath the headlight by first removing the two torx screws holding them in (see figure 5) and then releasing the clips holding them to the bumper cover—the



best way to release these clips is to stick a flat object (such as a pry bar or putty knife) between the bumper cover and headlight trim and push down to release the clip—be careful not to damage the headlight or headlight trim pieces!

6. Once all of the fasteners are disengaged from the headlight trim piece, carefully lift up on the outside edge where it attaches to the fender and pull towards the front of the car to disengage it—you may have to squeeze the two plastic clips in order to get them to release—again, be careful not to damage the headlight or trim piece!



Figure 5: Headlight trim piece torx bolts

7. Now remove the plate cover shown in the image below and to the left; there are four bolts holding it on—there may be a sensor attached to it; make sure to disconnect the wiring connector
8. Once the plate cover is removed, the two bumper cover mounting bolts are exposed (indicated by circles below and to the right); these may be removed with a 13mm wrench—There are also two large torx-head bolts on top which must be removed, indicated by arrows below



Plate cover (left) and plate cover removed (right) showing bumper cover fasteners



10. Now simply slide the bumper cover forward to remove it—if resistance is encountered, stop and check for fasteners still attached; the bumper should slide off easily
11. Now the bumper should be exposed; there are four bolts on each side which must be removed, use a 13mm wrench—There may be some frame sealant stuck on the bolt heads; Use a box cutter to scrape it off in order to fit a wrench on the head of the bolt



Figure 6: Stock bumper, passenger side

12. Once the bolts are removed, the bumper usually is stuck to the frame of the vehicle because of the frame sealant; In order to release the bumper, gently tap on the seam between the bumper and the frame using a putty knife and hammer as shown in figure 7 below—Make sure there is someone supporting the bumper as you do this so that it does not fall and cause injury once released; once the seal is broken between the bumper and frame, pull the bumper forward on that side—the leverage should release the seal on the opposite side as well



Figure 7: Releasing stock bumper with hammer and putty knife



13. When spacers are placed on the frame, Line up the mounting plates on the frame with the mounting plates of the aftermarket receiver. Insert the four factory bolts and washers through the aftermarket hitch and into the frame mounting plates

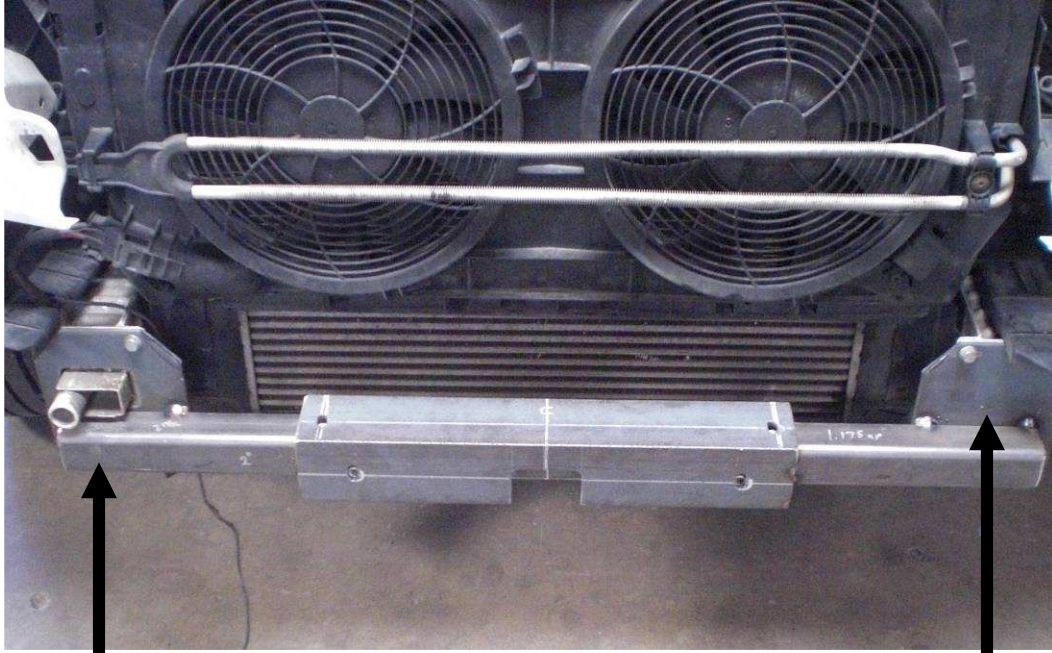

Figure 8: Attaching the aftermarket bumper to frame mounts

14. With the aftermarket receiver installed, attach the support bracket to the DEF tank bracket, and the top 2 bolts on the passenger side of the frame.



15. Attach the provided 2" X 1" angle brackets to the backside of the aftermarket bumper mounting plates. The 1" side should butt against the frame. Use the provided 3/8" bolt and nut, putting a washer on the bolt and nut side.



Figure 9: Attach the 2" X 1" angle brackets to the aftermarket bumper mounting plates (this is the passenger side)

16. Drill two equally spaced $7/16$ " holes through the frame as well as the 1" side of the angle bracket. The provided $7/16$ " 4.5" bolts will be used to mount this angle to the frame. Before bolting them through the frame they will be used to hold the cutting template to the plastic bumper cover.

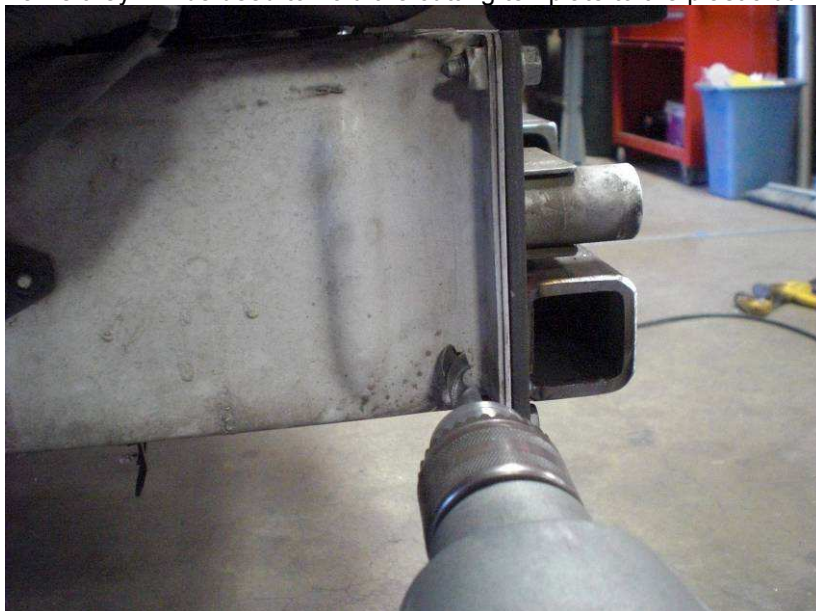

Figure 10: Drill 2 equally spaced $3/8$ " Holes through the frame and angle brackets

17. Place the cutting template over the receiver to determine which side is top and which side is bottom. The template should slide over the square receiver and the 2 holes should line up with the 2 holes in the front of the receiver.
18. Once you have determined the top, use the $7/16$ " bolts to hold the cutting template to the front of the plastic bumper. You do not need to tighten the bolts very much, they are just used to hold the cutting template in place so you can trace the cut out.



19. It is now a good idea to place the plastic bumper over the receiver to make sure the hold you cut lines up. You may need to open the cut out by 1/8"-1/4" for ease of installation.
20. Once you cut the hole in the plastic bumper you can put the chrome license plate holder over the plastic bumper. From behind trace the square that was cut out of the plastic bumper onto the license plate holder.
21. Cut the square out of the license plate holder. It is best to use a cutoff wheel for this step. Jigsaws can cause the chrome to flake and peel.
22. You can now put the 7/16" bolts through the angle and frame and tighten them down.
23. Re-install the factory bumper using the installation instructions in reverse.