



## Installation Instructions

For Part Numbers:

400-729      850-349 Airaid Oiled Media Filter  
 401-729      851-349 SynthaMax Dry Media Filter - Red

2005-07 Ford F-250/F-350 Super Duty  
 5.4L V8

**NOT LEGAL FOR SALE OR USE ON ANY POLLUTION CONTROLLED MOTOR VEHICLE IN CALIFORNIA OR STATES ADOPTING CALIFORNIA EMISSION PROCEDURES.**

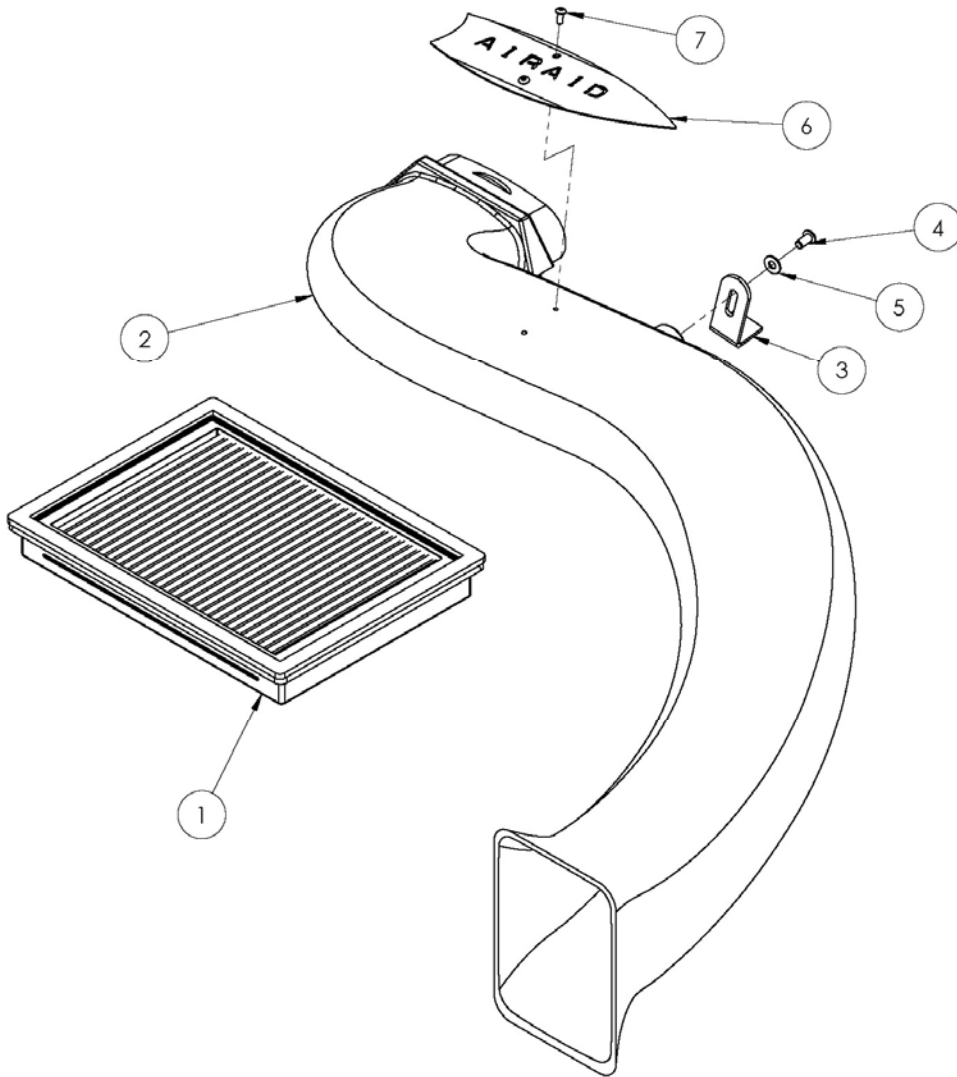

### Component Identification

1.	Airaid Premium Filter	1
2.	Modular Intake Tube	1
3.	L- Bracket	1
4.	1/4"-20x1/2" Button Head	1
5.	1/4" Flat Washer	1
6.	Airaid Logo Plate	1
7.	Button Head Screw	2



**1. Disconnect the negative battery cable.**  
 With a 10mm wrench or deep socket, remove the nut from the stud that holds the factory intake tube to the mounting bracket. Save the nut for re-use later in the install.



**2.** Grab the factory intake tube just above the fan shroud, and with a sharp lifting motion, remove it from the air cleaner housing.

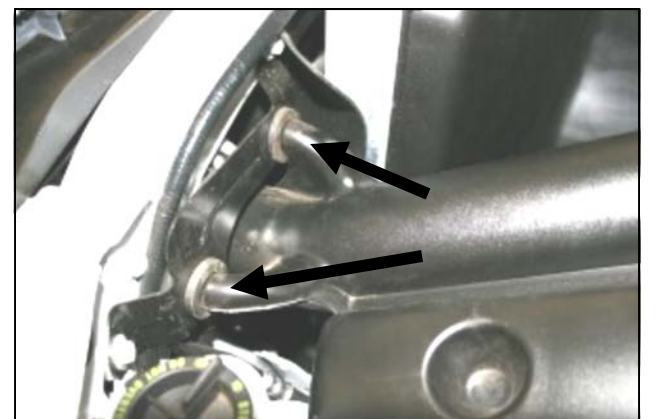

**3.** Remove the factory tube from the radiator support by pulling the tube out of the grommets. There are no bolts holding the tube. Remove the factory tube from the vehicle.



**4.** Unclip the two latches that hold the air cleaner tray into the air cleaner.



**5.** Slide the tray out of the factory airbox and remove the factory air cleaner.



**6.** Install the Airaid Premium Filter (#1) into the factory airbox tray, slide it back in, and re-latch the two clips.

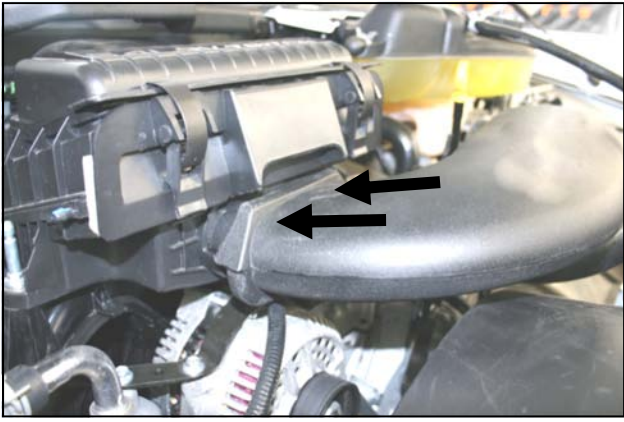

7. Install the Airaid Modular Intake Tube (#2) into the factory airbox. It will “snap” into place.

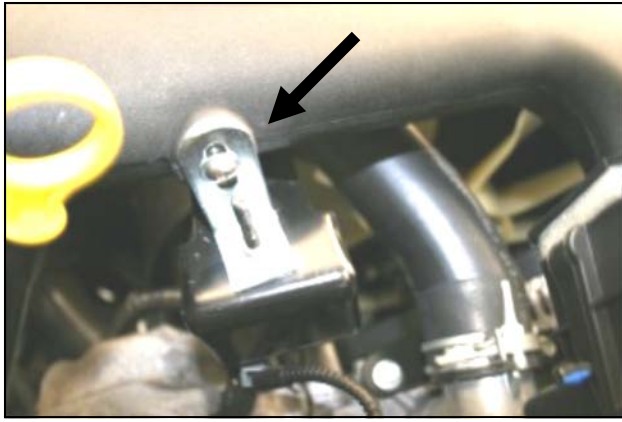

8. Install the L-bracket (#3) over the factory stud re-using the nut removed in step #1. Next install the button head bolt (#4) and washer (#5) thru the L-bracket, and into the tube. Leave loose until final adjustments have been made.



9. Due to inconsistent factory tolerances, some minor adjustment may be necessary to the factory A/C line so it will clear the Airaid MIT near the radiator support.. When all adjustments have been completed, tighten the nut, and button head bolt at the L-bracket.



10. Install the Logo Plate onto the Intake Tube as shown, using the two Button Head Screws.

### 11. Double check your work.

Make sure there is no foreign material in the intake path. Make sure all clamps, hoses, bolts, and screws are tight. **Reconnect the negative battery cable.**

Thank you for purchasing the Airaid Intake System. Your Airaid Intake System was carefully inspected and packaged. Check that no parts are missing, or were damaged during shipping. If any parts are missing, contact Airaid. The air filter element is protected from direct exposure to water and debris; care should be taken not to drive through deep water. WATER INGESTION IS THE DRIVERS RESPONSIBILITY! The air filter is reusable and should be cleaned periodically.

## FILTER IDENTIFICATION

850-349 Airaid Oiled Media

851-349 Airaid SynthaMax Dry Media - Red

For your Oiled media filter we suggest using the AIRAID Filter Tune-Up Kit!



P/N 790-551 Aerosol Spray  
P/N 790-550 Squeeze Spray



*SynthaMax*®

## Do Not Oil

Synthamax Air Filters do not require oil. Service air filter as needed by cleaning with common non-petroleum all-purpose household cleaner and water. Simple Green®, Formula 409® or equivalent works great. Apply cleaner to outside of air filter and allow to soak. Then flush filter clean from the inside out with a garden hose and repeat steps if necessary. Do not apply high pressure water or air to clean filter. Allow filter to air dry and reinstall.