

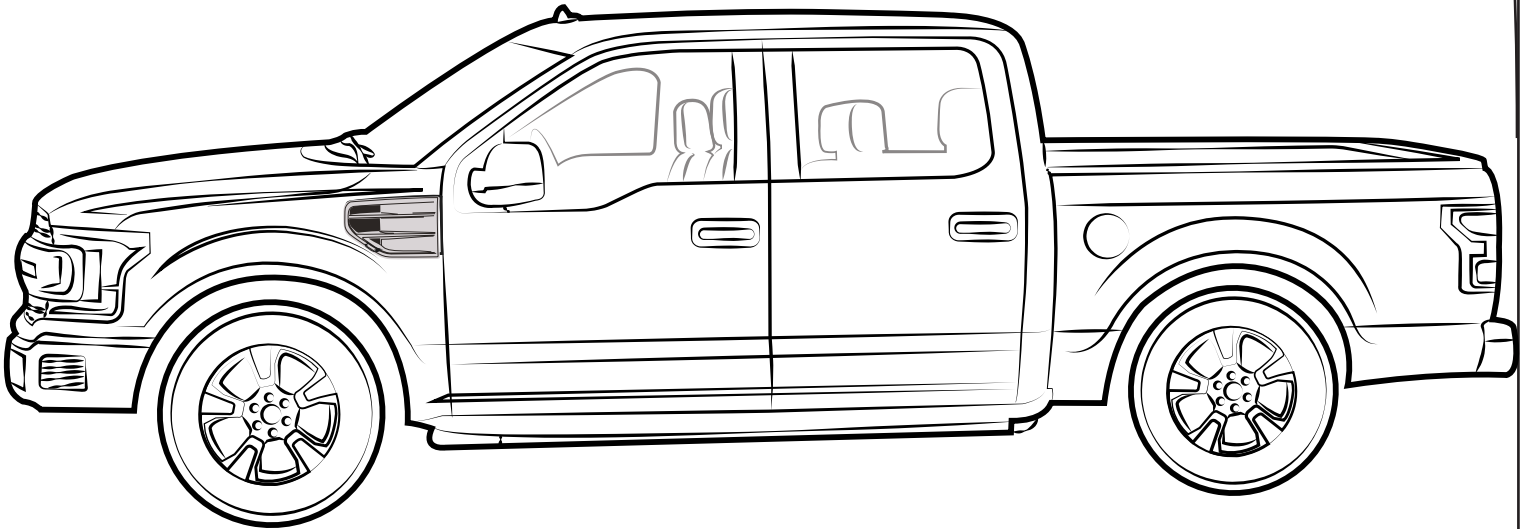

# FORD F-150 2018

## INSTALLATION MANUAL

### SPORT FENDER VENTS SET F-150 2015 SATIN BLACK PART # : 1128NZZJF020A17



**READ CAREFULLY BEFORE  
INSTALLATION**

#### AFTER INSTALLING

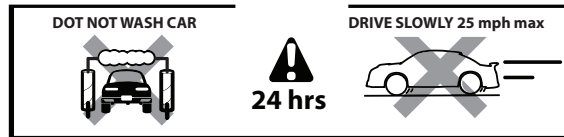

#### TOOLS

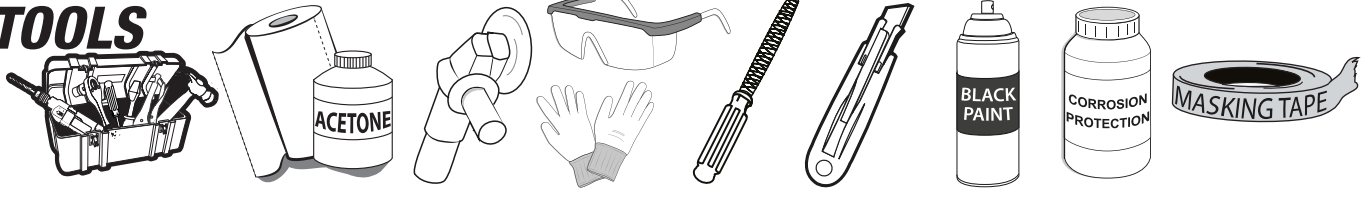

#### CHECK LIST

\*Already installed in the part

ITEM	DESCRIPTION	DRAWING	AMOUNT
A	*VHB TAPE		INCLUDED IN ALL PARTS
B	GREASE PENCIL		1 PC
C	AUTOMOTIVE ADHESION PROMOTER		1 PC
D	TEMPLATE		INCLUDED
E	*GRILL		2 PCS
F	*TIN SCREW 6X3/8"		8 PCS
G	*WASHER 4MM		8 PCS

### 1 GRILL MOUNT

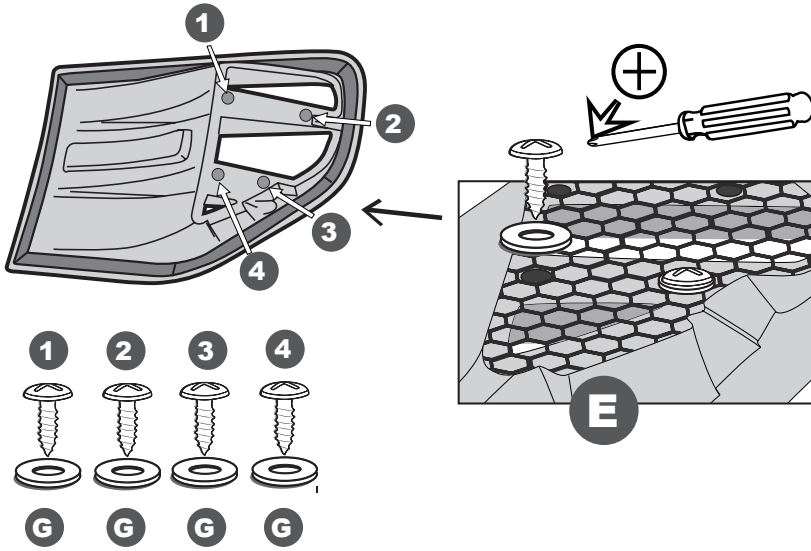

### 2 REMOVE

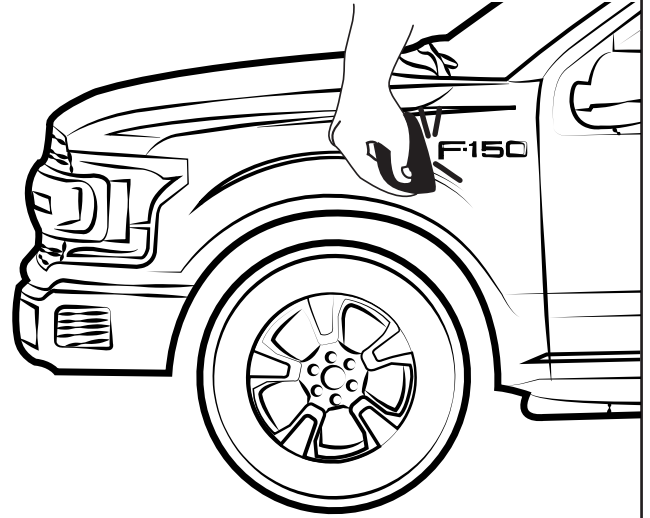

### 3 PLACE TEMPLATE

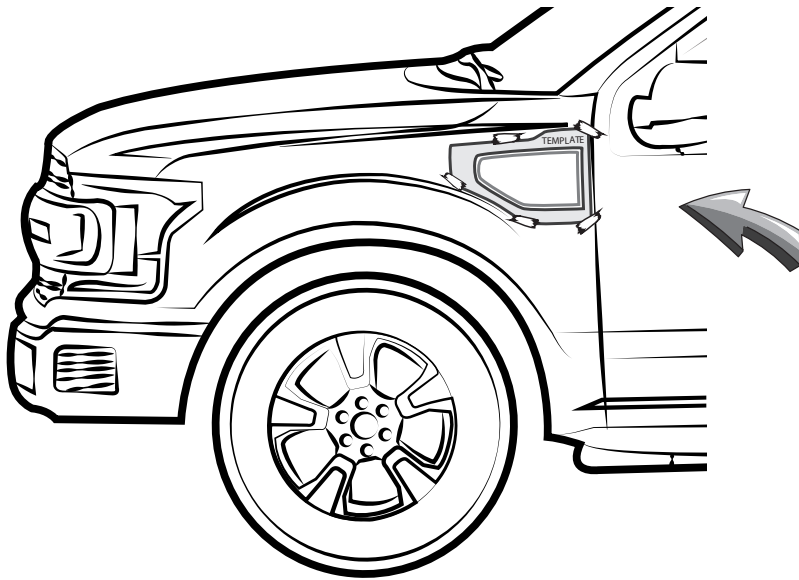

#### ALIGN

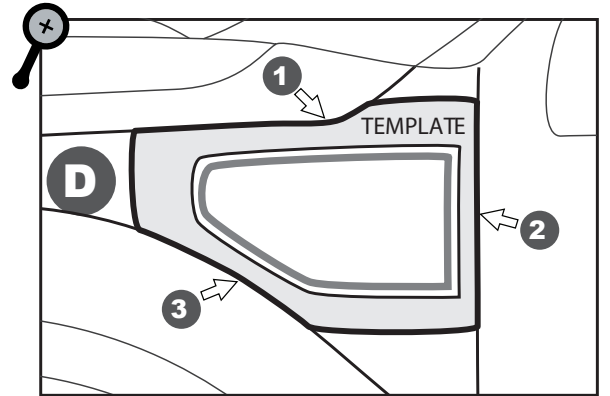

### 4 OUTLINE OUTER CONTOUR WITH MASKING TAPE

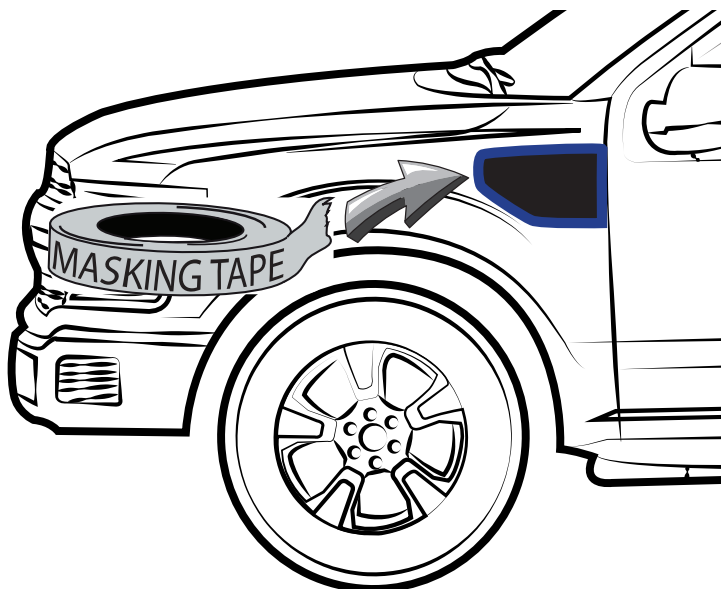

### 5 CUT

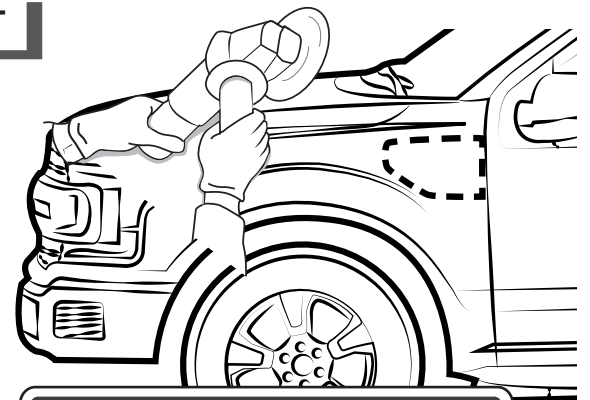

### CAUTION

PERSONAL  
PROTECTIVE EQUIPMENT  
REQUIRED

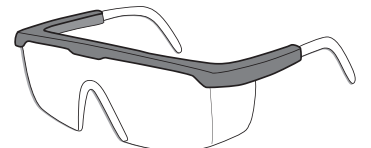
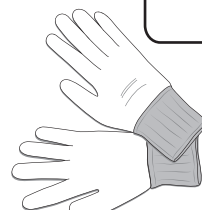

**6 FILE DOWN THE EDGE**

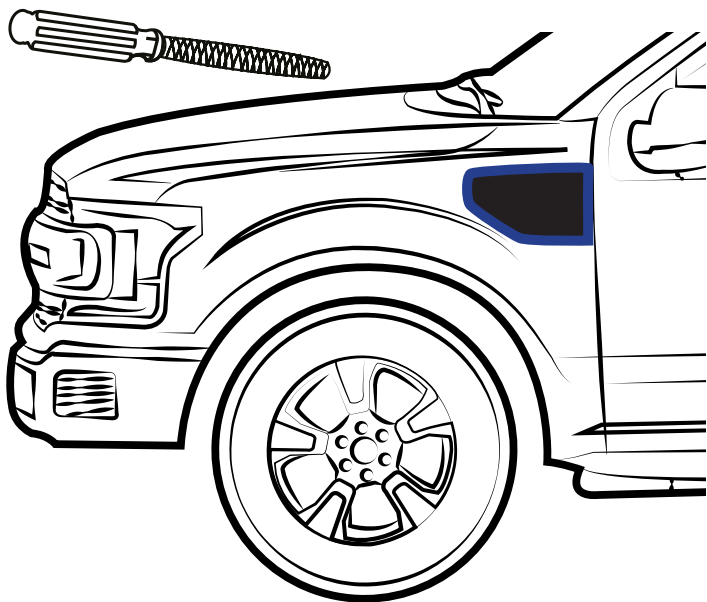

**7 CLEAN**

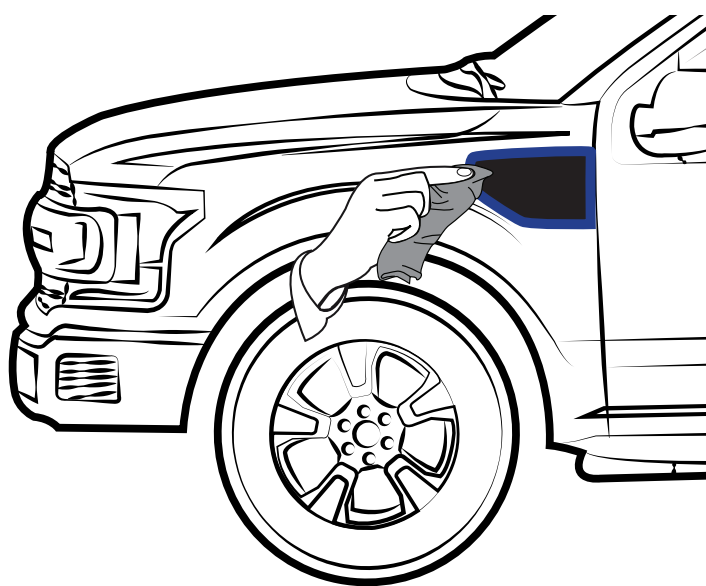

**8 CORROSION PROTECTOR**

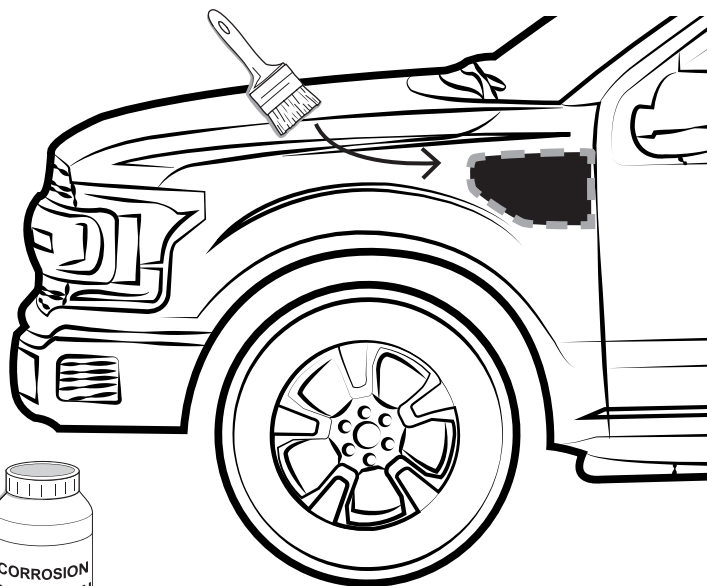

**9 PAINT INTERIOR WITH BLACK PAINT**

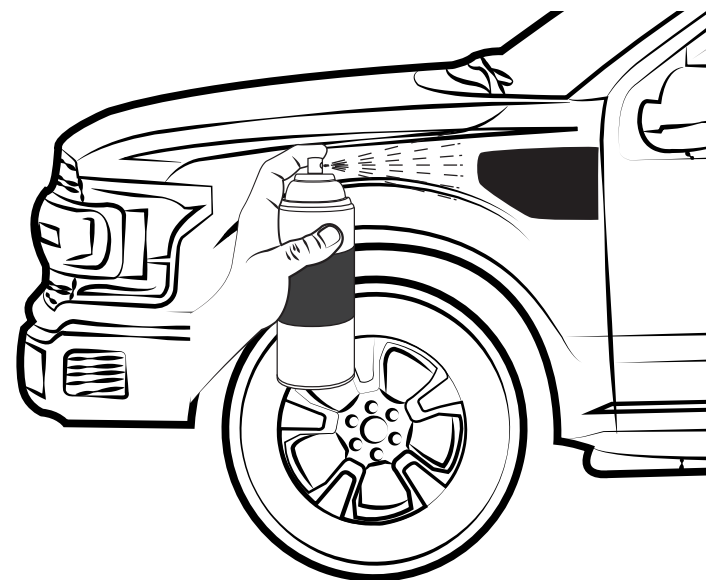

**10 ALING**

**!** ALIGN TO THE EDGE OF THE DOOR WITH 1/2" MASKING TAPE.

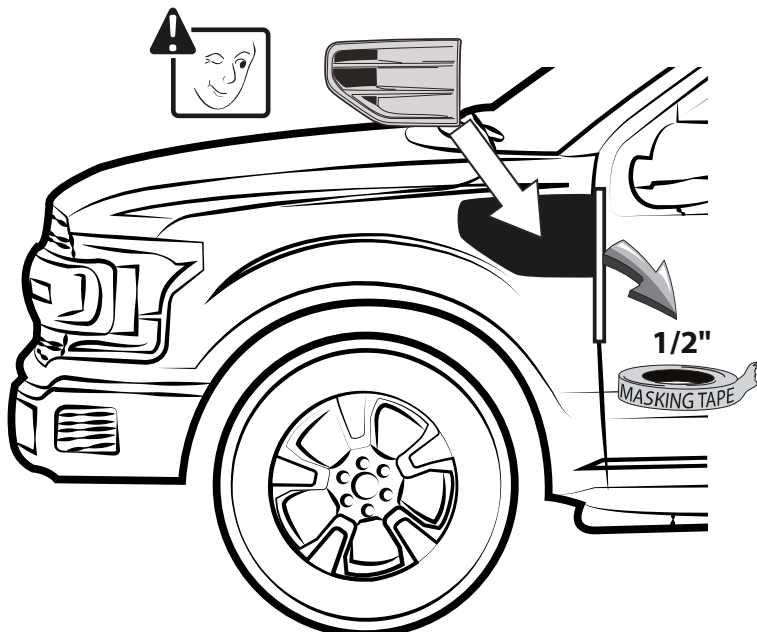

**11 MARK**

**!** HASH MARKS

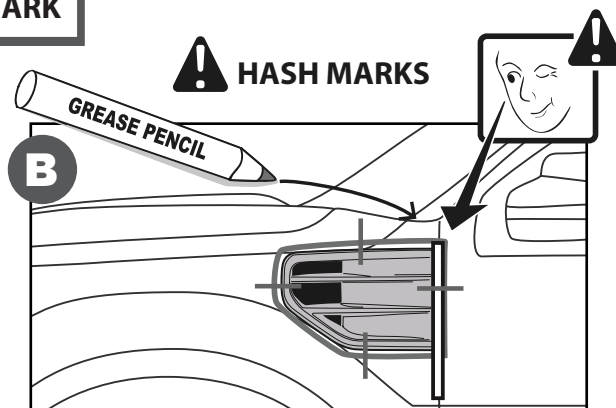

**DRAW CENTER HASH MARK WITH GREASE PENCIL ON FENDER VENTS AND SHEET METAL, THIS WILL ENSURE FENDER VENTS WILL BE CENTERED TO GREASE PENCIL OUTLINE.**

### 12 ADHESION PROMOTER

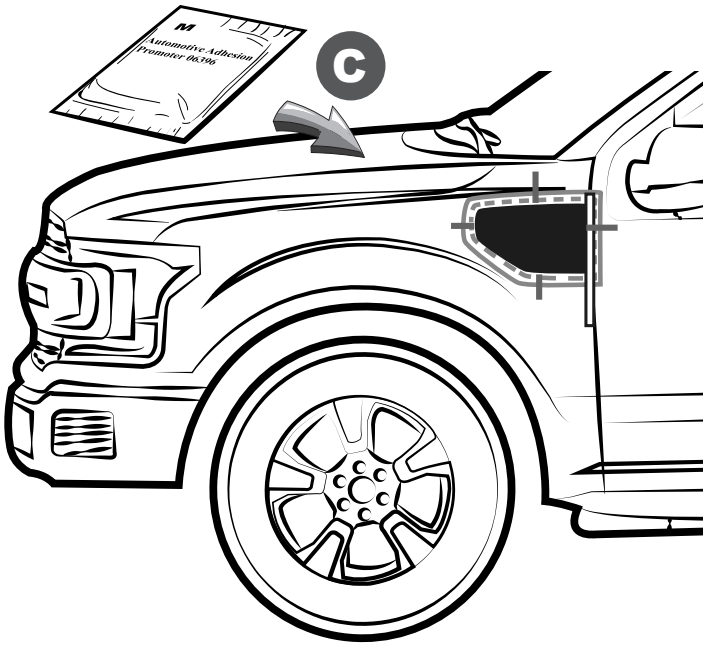

**!** A full surface contact between tape and substrate is decisive for good adhesion performance. Contact is achieved by applying pressure. In practice a pressure between 40 and 50 N/cm<sup>2</sup> is usually needed and an application temperature between 25 and 45 °C or 77 and 113 °F is also necessary. During application, add-on parts and tapes must have the similar temperature.

### 13 PEEL

**!** WARM SURFACES WITH HEAT GUN IF SURFACE TEMPERATURE IS TOO COLD.



### 14 PLACE

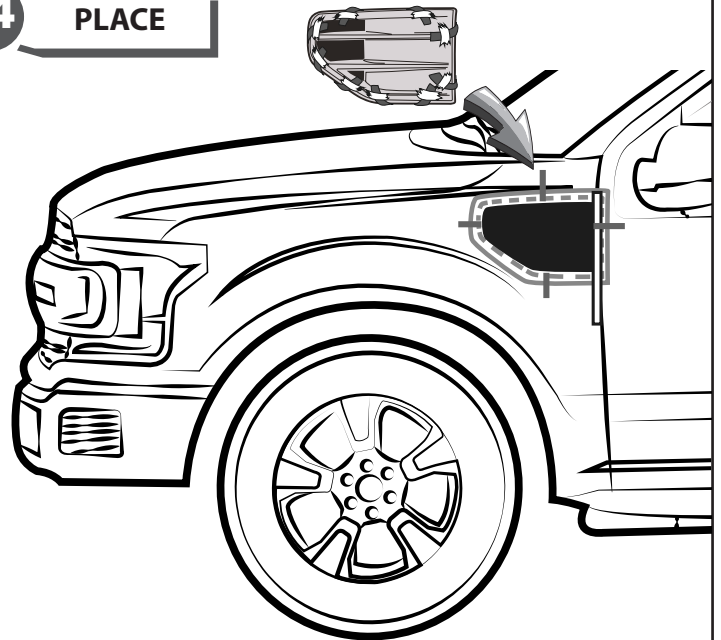

### 15 REMOVE LINER

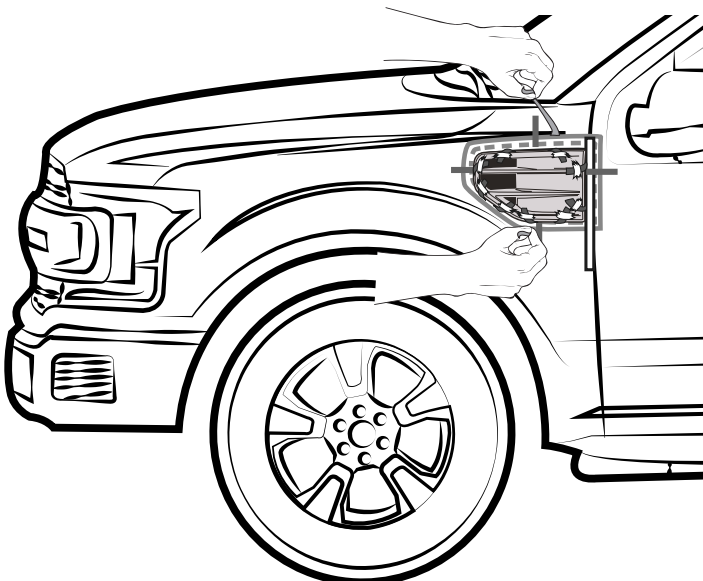

### 16 PRESS

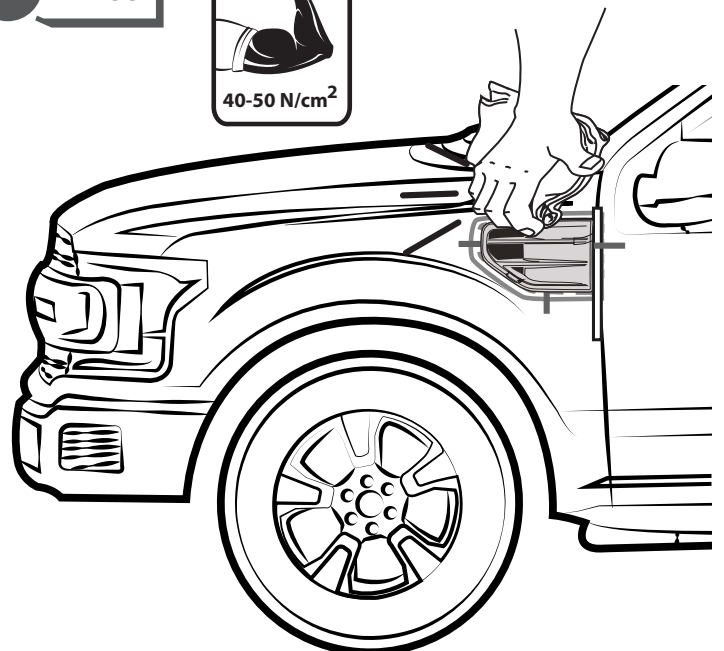



**17 CLEAN OFF GREASE PENCIL MARK**

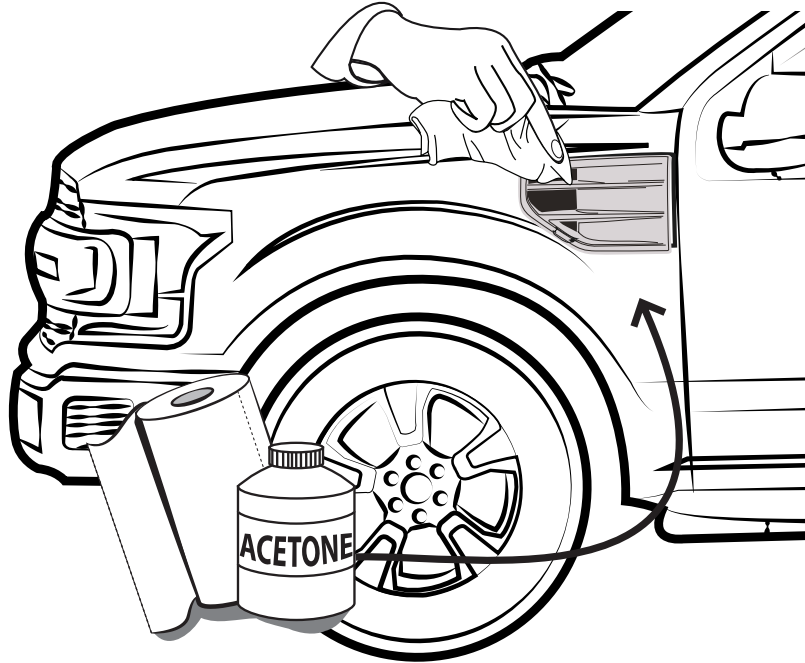

**18 INSTALLED PARTS**

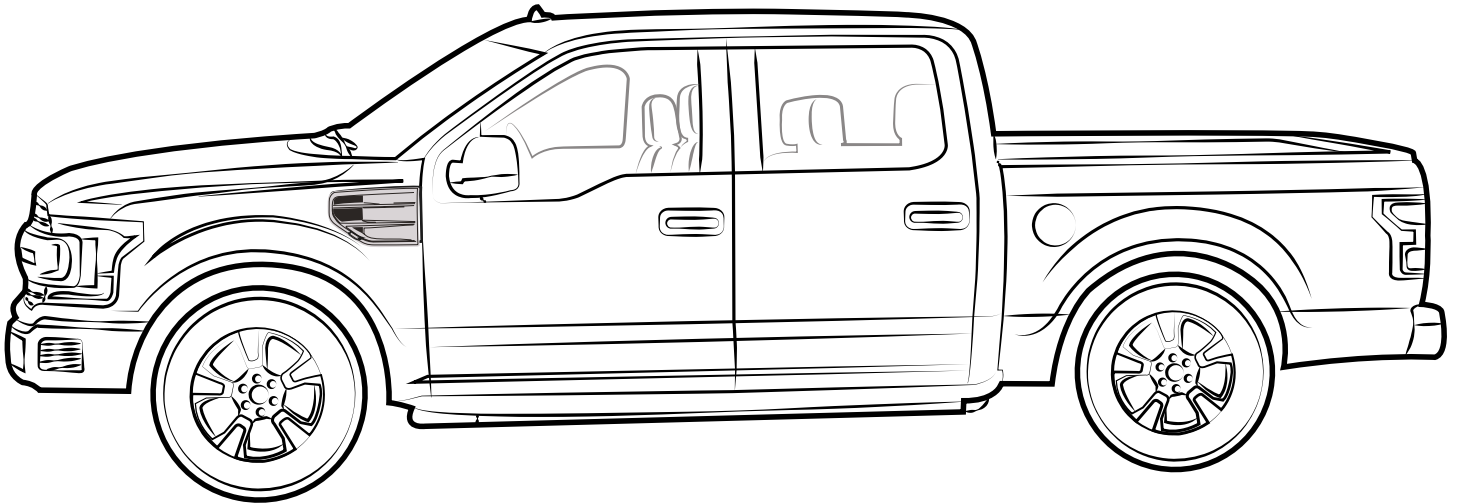

REFERENCE LINE

106mm  
TO FENDER  
CORNER

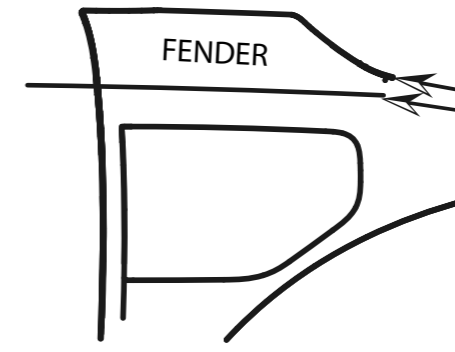
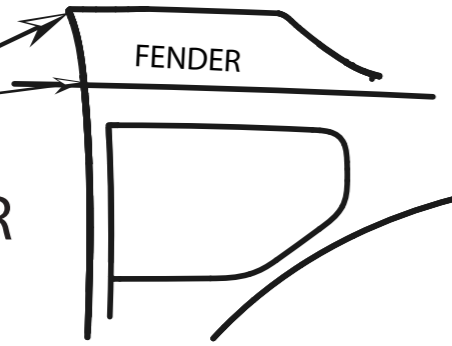

42mm  
TO HOOD EDGE

**FORD - F150  
FENDER VENT  
CUT TEMPLATE  
RH**

DOOR EDGE CLEARANCE

BONDING AREA

BONDING AREA

CUT AREA

BONDING AREA

BONDING AREA

WHEEL ARCH CLEARANCE

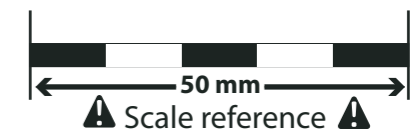

REFERENCE LINE

42mm  
TO HOOD  
EDGE

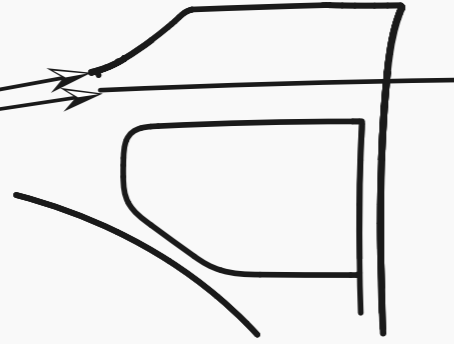

106mm  
TO FENDER  
CORNER

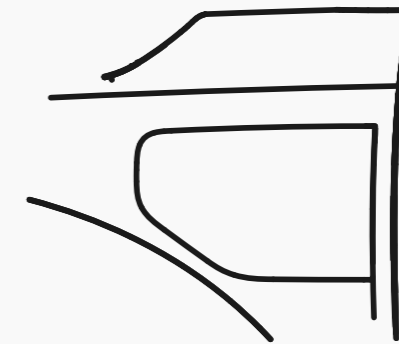

**FORD - F150  
FENDER VENT  
CUT TEMPLATE  
LH**

