



AIRDESIGN

SUPER RIM
TRUCK ACCESSORIES POWERED BY AIRDESIGN USA

GMC - SIERRA - 2016

INSTALLATION MANUAL

FLOOR LINERS SET SIERRA 2016

PART #: 1140NNTJGM24A16

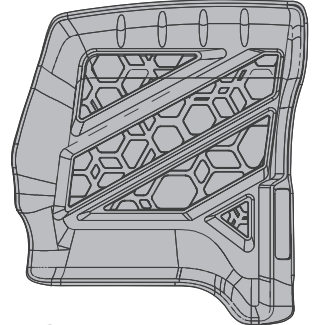
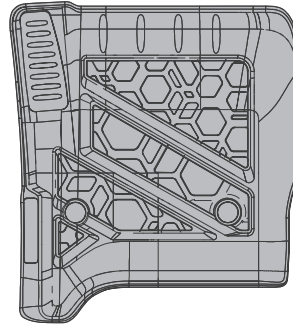
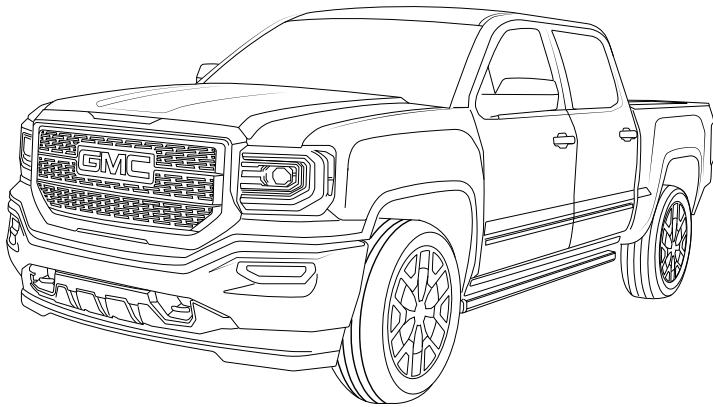

ALL TYPE OF CABS

LH

RH

PART #: 1140ENTUGM24A18 PART #: 1140FNTUGM24A17

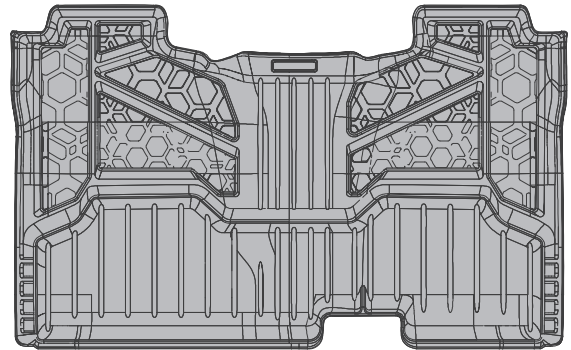

ONLY CREW CAB

PART #: 1140DNTUGM24A19

IMPORTANT

**NOT DESIGNED OR RECOMMENDED
FOR MODELS EQUIPPED WITH VINYL
FLOORING**

TOOLS

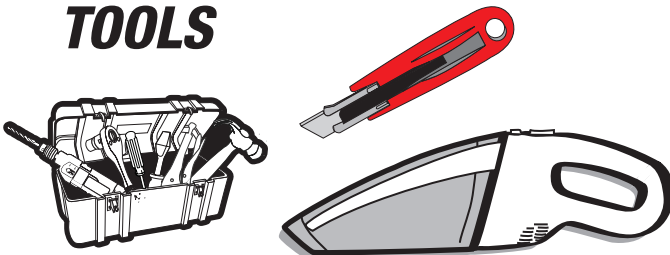

**READ CAREFULLY BEFORE
INSTALLATION**

CHECK LIST

ITEM	DESCRIPTION	DRAWING	AMOUNT
A	DOMES - AIRDESIGN		Included 3 pieces



CID DESIGN

SUPER RIM
TRUCK ACCESSORIES POWERED BY HANSON USA

GMC - SIERRA - 2016

INSTALLATION MANUAL

1 BEFORE INSTALLING

MAKE SURE YOUR VEHICLE ALREADY HAVE OEM CAR MAT FASTENERS YOU MUST HAVE THEM FOR PROPER INSTALLATION

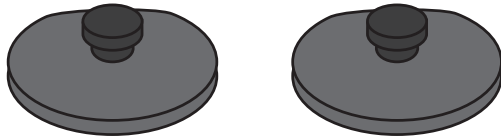

2 IDENTIFY

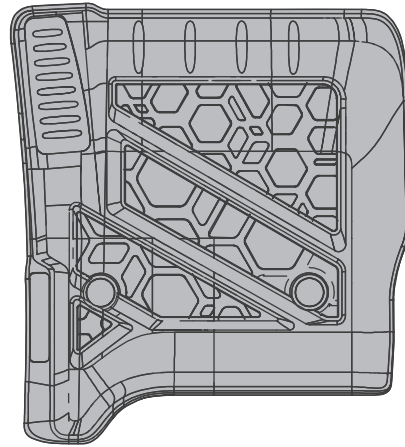

IF IT DOES NOT HAVE, GET THIS PARTS FROM YOUR LOCAL DEALER
DRIVER'S SIDE

3 REMOVE OEM MAT

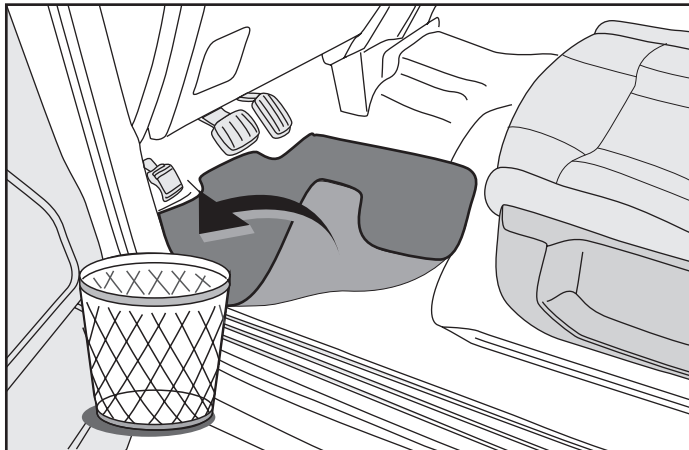

4 VACUUM

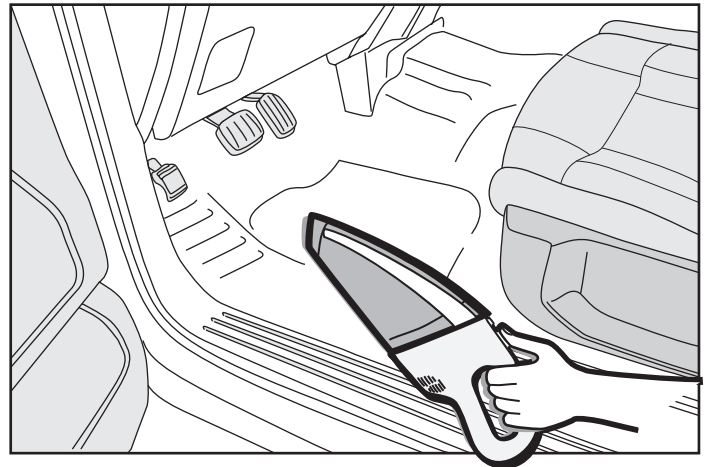

5 MOUNT

UNOBSTRUCTED

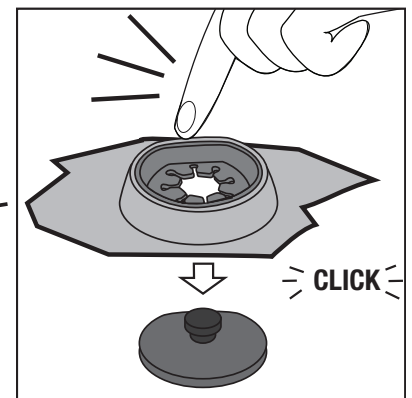
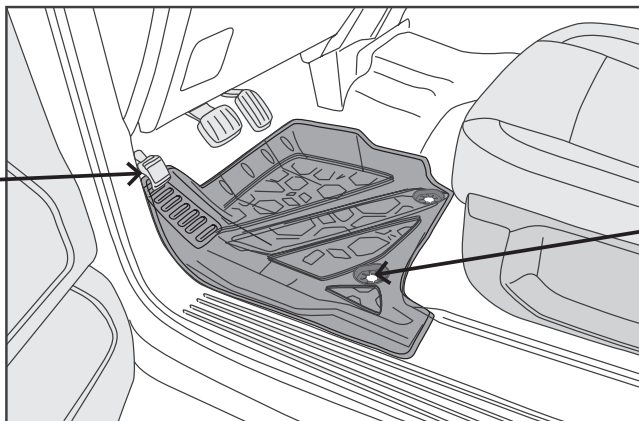
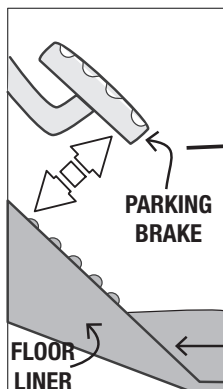



CID DESIGN

SUPER RIM
TRUCK ACCESSORIES POWERED BY AIRBORNE USA

GMC - SIERRA - 2016

INSTALLATION MANUAL

6 FOR CO-DRIVER'S SIDE REPEAT STEPS 3 & 4

RH

FRONT

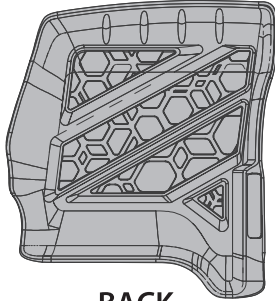

BACK

7 FOR REAR SIDE REPEAT STEPS 3 & 4

REAR

FRONT

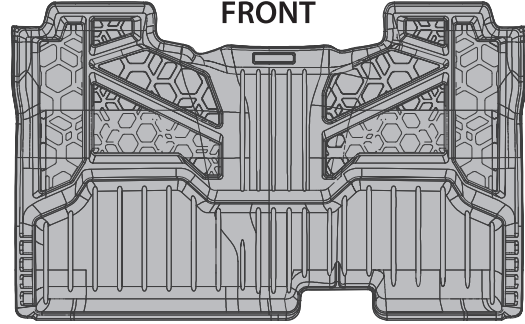

BACK

8 LIFT UP

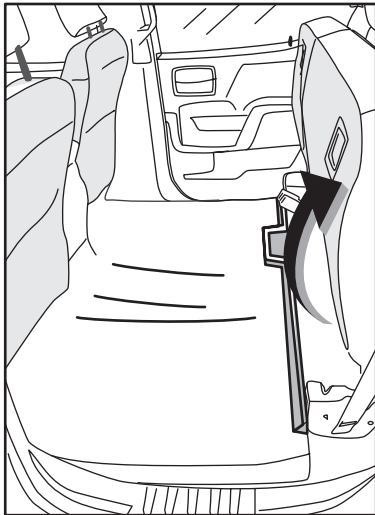

9 MOUNT

ALIGN

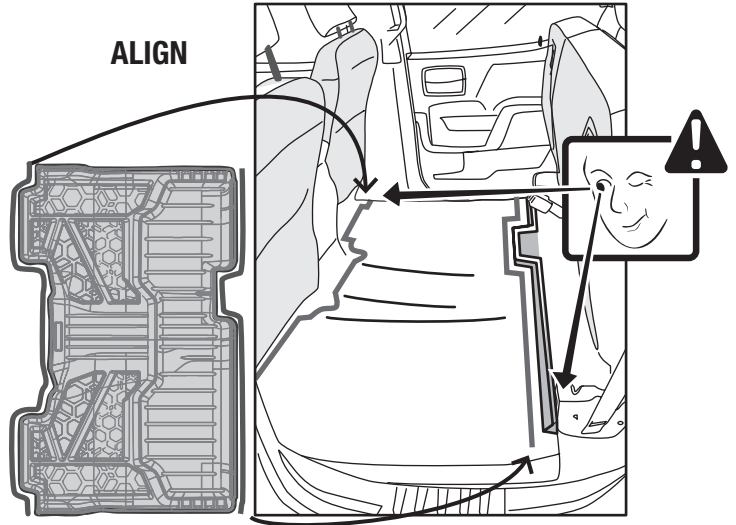

IMPORTANT

FAILURE TO CORRECTLY INSTALL OR RE-INSTALL THE FLOOR LINER TO THE ABOVE INSTRUCTIONS COULD RESULT IN THE LOSS OF CONTROL OF THE VEHICLE AND DEATH OR SERIOUS INJURY.

REGULAR CLEANING EXTENDS THE LIFE OF YOUR FLOOR LINERS. CLEAN USING ONLY A MILD DETERGENT SOAP AND WATER. DO NOT USE HARSH CHEMICALS OR ABRASIVE TYPE CLEANERS AS THESE PRODUCTS MAY DAMAGE THE FLOOR LINER.