



AIRDESIGN

SUPER RIM
TRUCK ACCESSORIES POWERED BY AIRDESIGN USA

TOYOTA - TUNDRA 2015

INSTALLATION MANUAL

FLOOR LINERS SET TUNDRA 2015 CREWMAX

PART #: 1140NNTJTO01A16

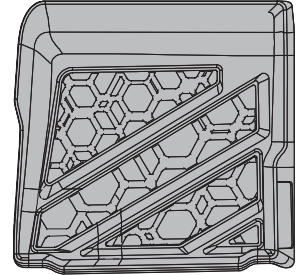
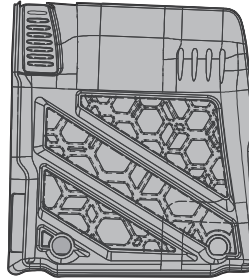
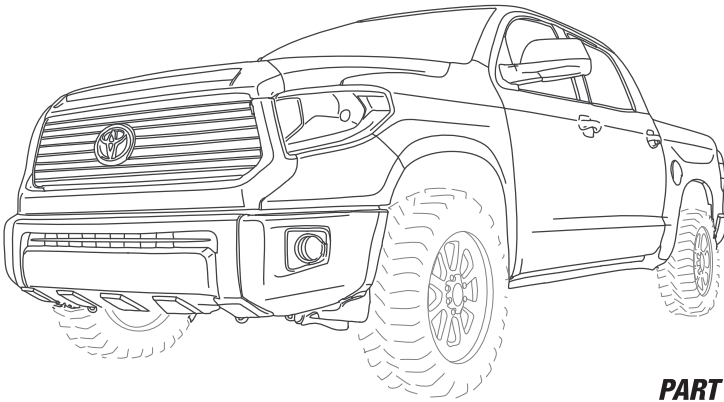

ALL TYPE OF CABS

LH

RH

PART #: 1140ENTUTO01A18 PART #: 1140FNTUTO01A17

IMPORTANT

**NOT DESIGNED OR RECOMMENDED
FOR MODELS EQUIPPED WITH VINYL
FLOORING**

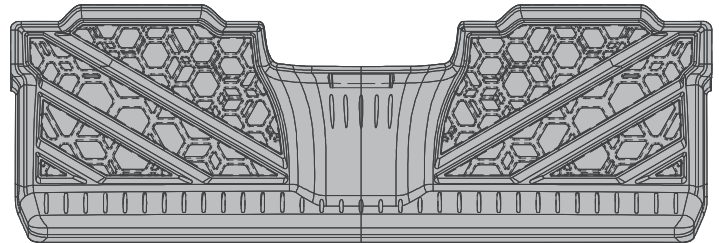

ONLY SUPER CREW CAB

PART #: 1140DNTUTO01A19

TOOLS

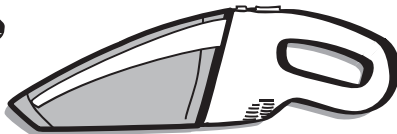
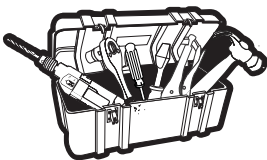

**READ CAREFULLY BEFORE
INSTALLATION**

CHECK LIST

*Already installed in the piece

ITEM	DESCRIPTION	DRAWING	AMOUNT
A	* DOME - AIRDESIGN		Included 3 pieces



CID DESIGN

SUPER RIM
TRUCK ACCESSORIES POWERED BY INNOVATION USA

TOYOTA - TUNDRA 2015

INSTALLATION MANUAL

1 BEFORE INSTALLING

MAKE SURE YOUR VEHICLE ALREADY HAVE OEM CAR MAT FASTENERS YOU MUST HAVE THEM FOR PROPER INSTALLATION

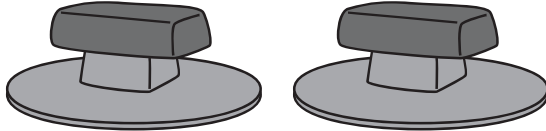

IF IT DOES NOT HAVE, GET THIS PARTS FROM YOUR LOCAL DEALER

2 IDENTIFY

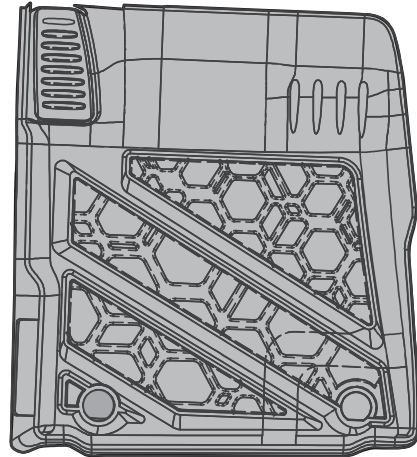

DRIVER'S SIDE

3 REMOVE OEM MAT

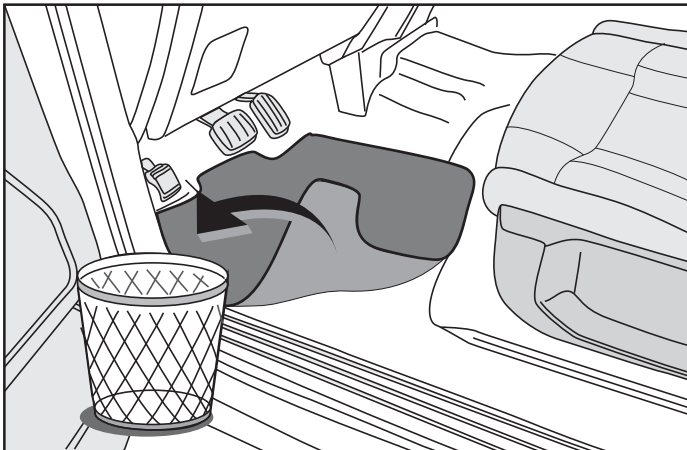

4 VACUUM

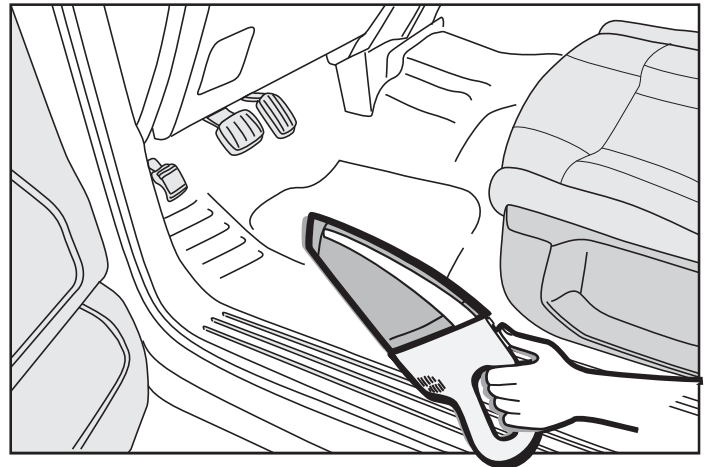

5 MOUNT

UNOBSTRUCTED

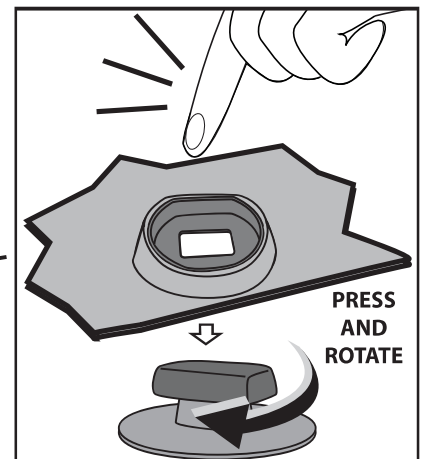
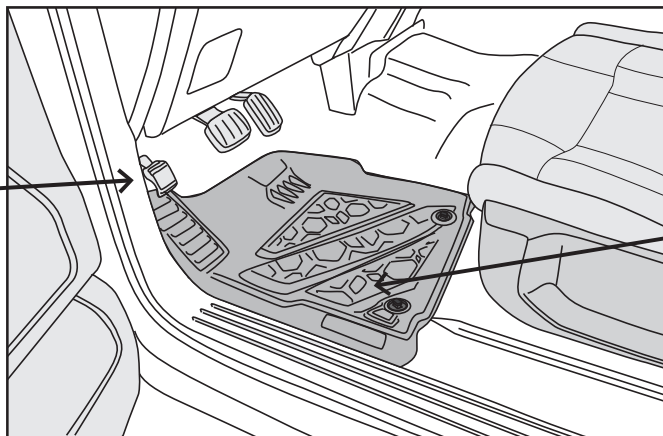
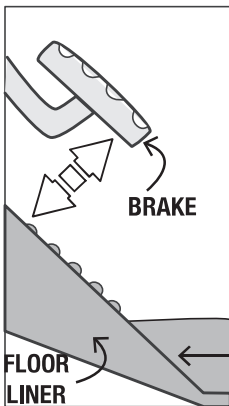

PRESS AND ROTATE



CID DESIGN

SUPER RIM
TRUCK ACCESSORIES POWERED BY INNOVATION USA

TOYOTA - TUNDRA 2015

INSTALLATION MANUAL

6 FOR CO-DRIVER'S SIDE REPEAT STEPS 3 & 4

RH

FRONT

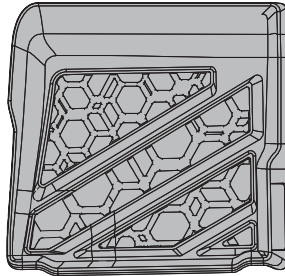

BACK

7 FOR REAR SIDE REPEAT STEPS 3 & 4

REAR

FRONT

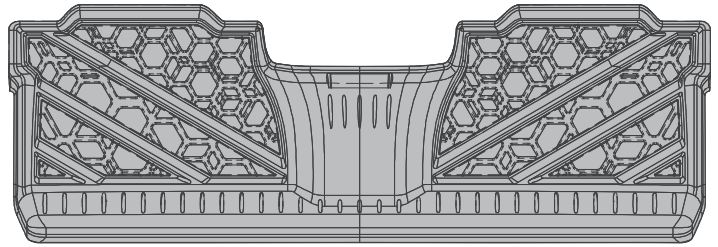

BACK

8 LIFT UP

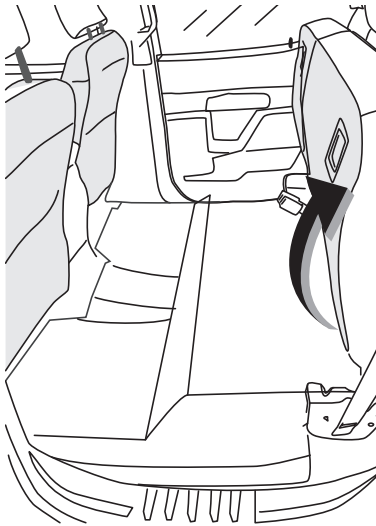

9 MOUNT

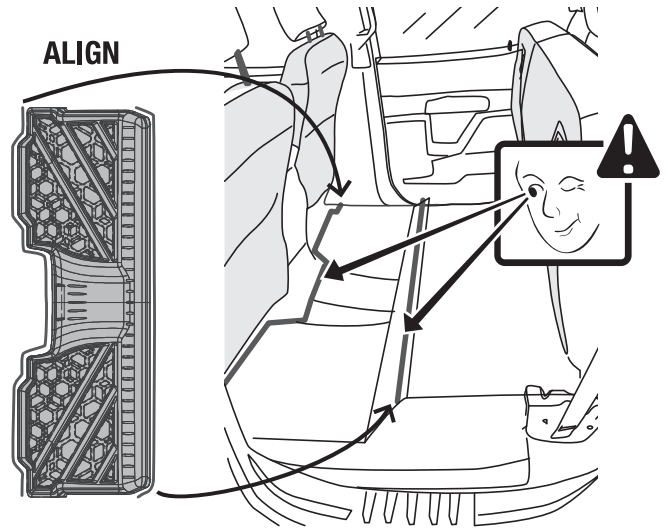

IMPORTANT

FAILURE TO CORRECTLY INSTALL OR RE-INSTALL THE FLOOR LINER TO THE ABOVE INSTRUCTIONS COULD RESULT IN THE LOSS OF CONTROL OF THE VEHICLE AND DEATH OR SERIOUS INJURY.

REGULAR CLEANING EXTENDS THE LIFE OF YOUR FLOOR LINERS. CLEAN USING ONLY A MILD DETERGENT SOAP AND WATER. DO NOT USE HARSH CHEMICALS OR ABRASIVE TYPE CLEANERS AS THESE PRODUCTS MAY DAMAGE THE FLOOR LINER.



CID DESIGN

SUPER RIM
TRUCK ACCESSORIES POWERED BY AMERICAN USA

TOYOTA - TUNDRA 2015

INSTALLATION MANUAL

DOOR ROCKER PANEL SET TUNDRA 2015 CREWMAX

PART # : 1124NNEJTO01D05

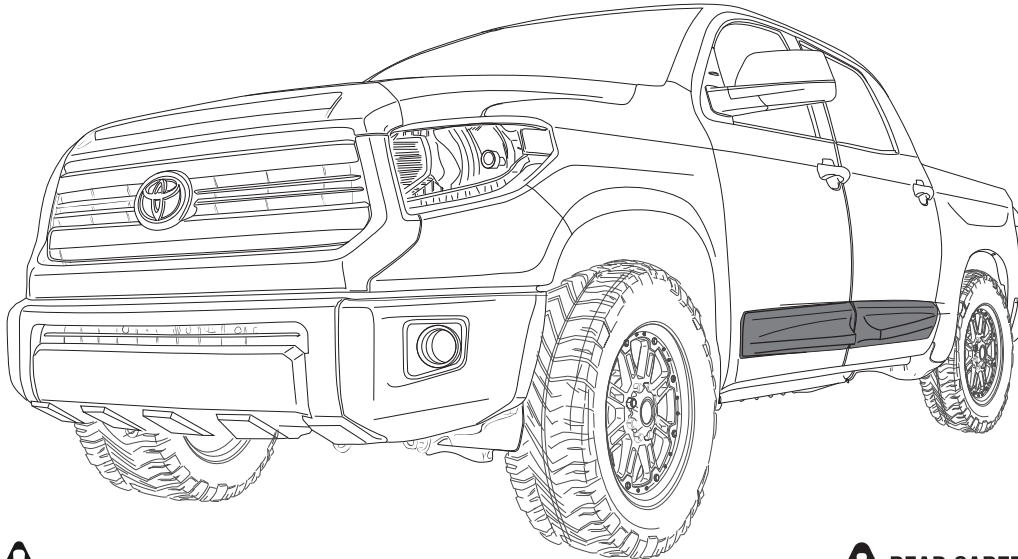

DO NOT
WASH CAR



DRIVE SLOWLY
25 mph max

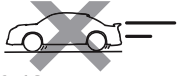

24 hrs



READ CAREFULLY BEFORE
INSTALLATION



We recommend 2 persons for installation



TOOLS

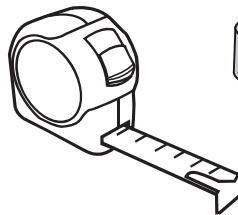
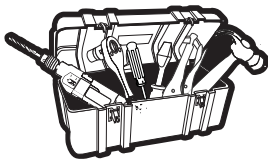

CHECK LIST

*Already installed in the part

ITEM	DESCRIPTION	DRAWING	AMOUNT
A	* VHB TAPE		Included in the parts
B	GREASE PENCIL		1 pc
C	ADHESION PROMOTER		1 pc
D	ECO DOME		1 pc



CID DESIGN

SUPER RIM
TRUCK ACCESSORIES POWERED BY INNOVATION USA

TOYOTA - TUNDRA 2015

INSTALLATION MANUAL

! WASH WITH WATER, DETERGENT AND SOFT CLOTH OR SPONGE

FRONT & REAR ROCKER PANEL

1 CLEAN

FACTORY DOOR MOLDING HAVE TO BE REMOVED BEFORE INSTALLING DOOR ROCKER PANEL

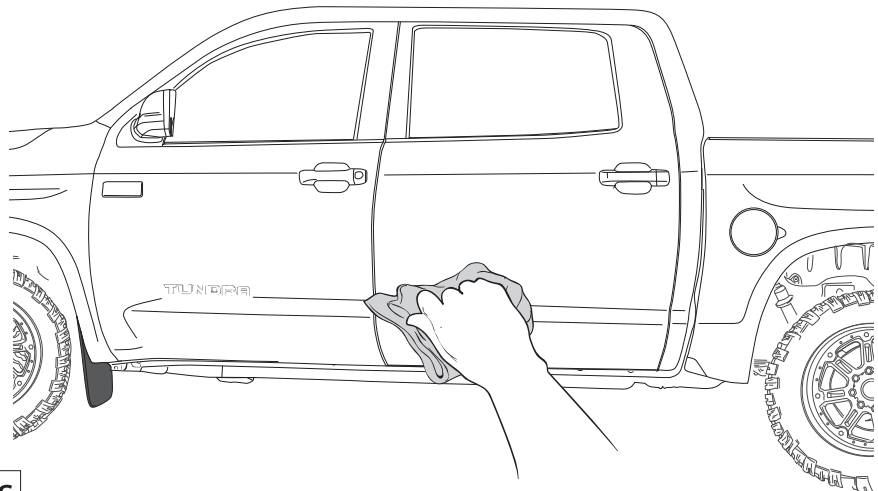

2 LOCATE REFERENCE POINTS

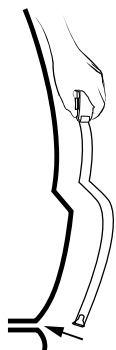
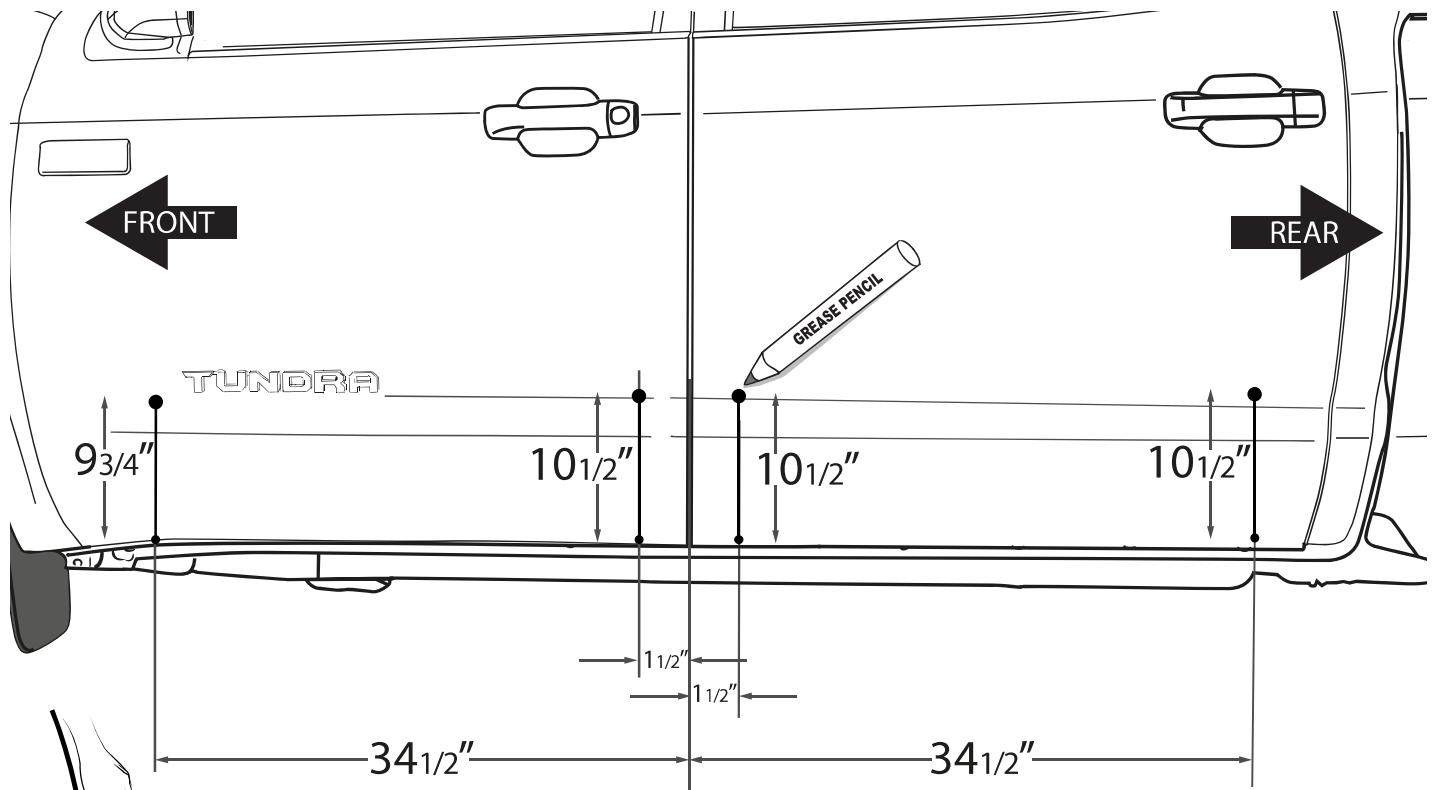

Measure following the door shape, hooking the tip of the measuring tape to the bottom of the door.



CID DESIGN

SUPER RIM
TRUCK ACCESSORIES POWERED BY AMERSON USA

TOYOTA - TUNDRA 2015

INSTALLATION MANUAL

3 PRE-MOUNT

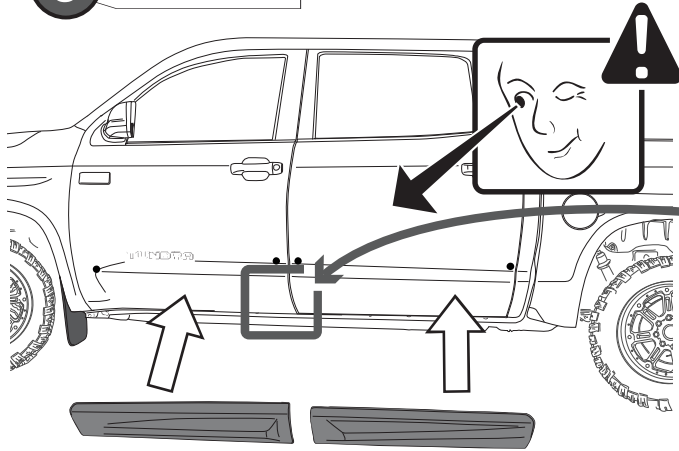

Keep the indicated separation between the panels and the edge of the doors as shown in the picture

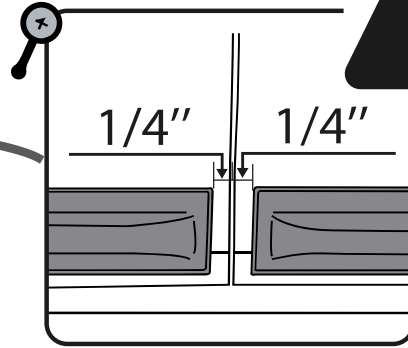

4 MARK

HASH MARKS

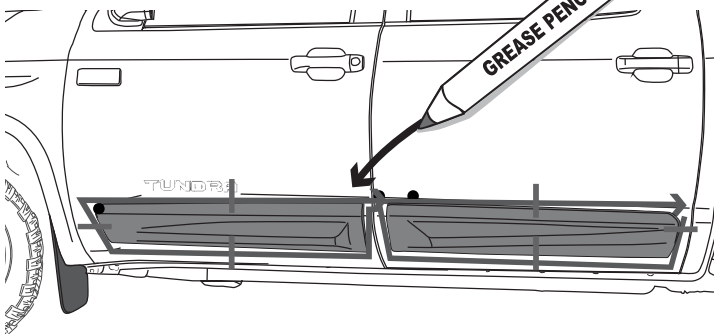

DRAW CENTER HASH MARK WITH GREASE PENCIL ON PANELS AND SHEET METAL, THIS WILL ENSURE PANELS WILL BE CENTERED TO GREASE PENCIL OUTLINE.

5 ADHESION PROMOTER

FIRST CLEAN ALL OVER THE APPLICATION AREA WITH ACETONE

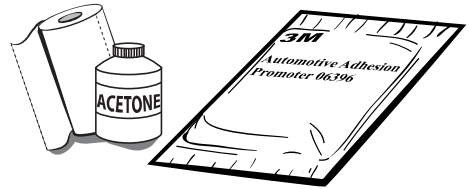
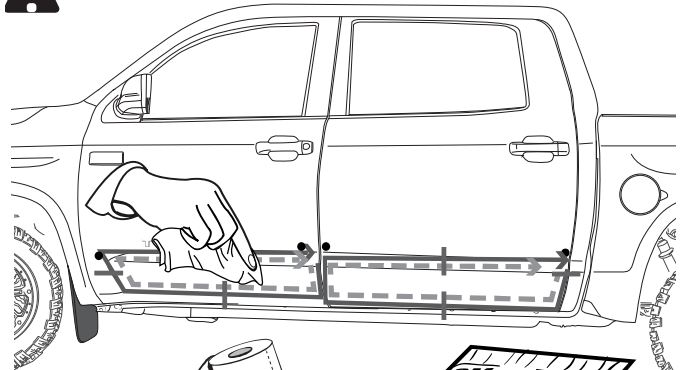

6 PEEL

WARM SURFACES WITH HEAT GUN IF SURFACE TEMPERATURE IS TOO COLD.

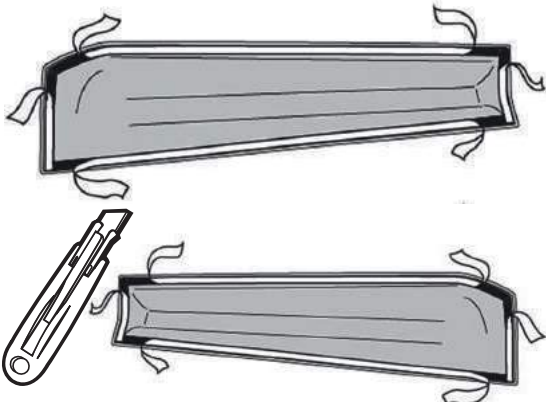

PEEL OFF

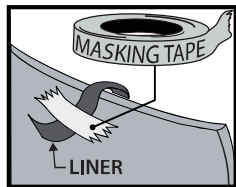
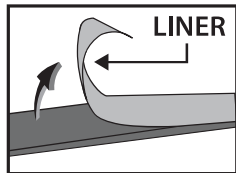

Hold the liner out



A full surface contact between tape and substrate is decisive for good adhesion performance. Contact is achieved by applying pressure. In practice a pressure between 40 and 50 N/cm² is usually needed and an application temperature between 25 and 45 °C or 77 and 113 °F is also necessary. During application, add-on parts and tapes must have the similar temperature.



CID DESIGN

SUPER RIM
TRUCK ACCESSORIES POWERED BY INNOVATION USA

TOYOTA - TUNDRA 2015

INSTALLATION MANUAL

7 PLACE

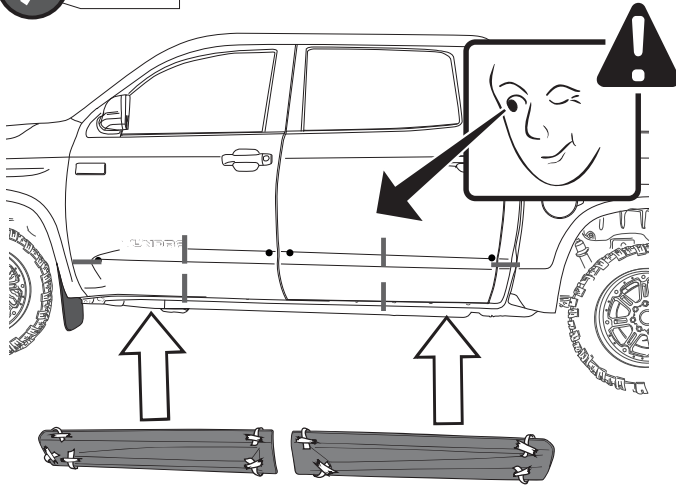

8 REMOVE LINER

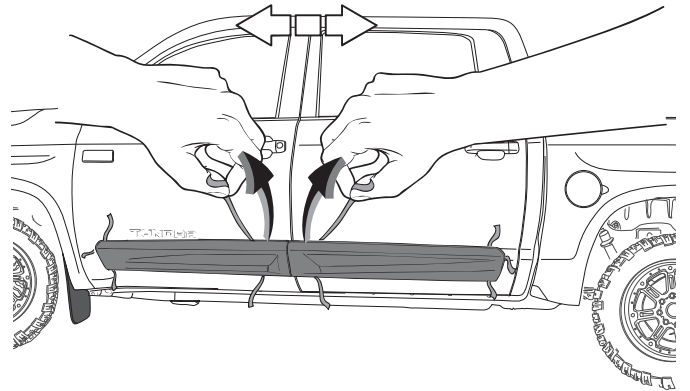

9 PRESS

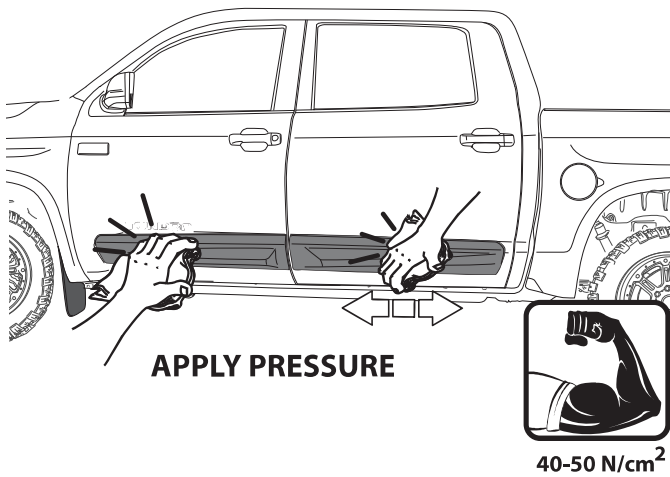

10 CLEAN OFF GREASE PENCIL MARK



INSTALLED PARTS

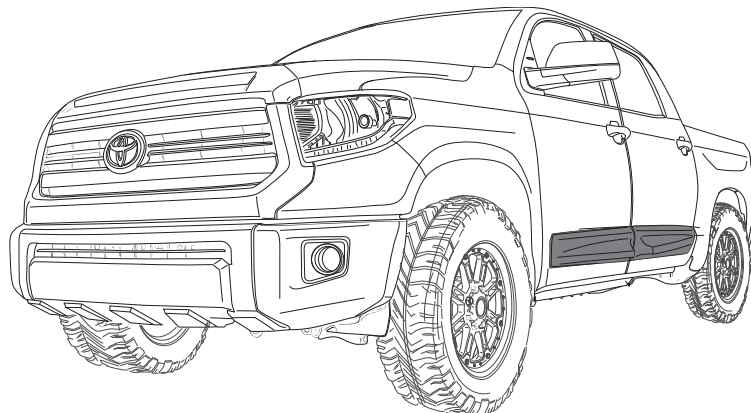



CID DESIGN

SUPER RIM
TRUCK ACCESSORIES POWERED BY INNOVATION USA

TOYOTA - TUNDRA 2015

INSTALLATION MANUAL

SUPER-BOLT FENDER FLARES SET TUNDRA 2015 LONG & STANDARD BED

PART #: 1109NNTJTO01A10



In case of installing Front Bumper and Fender Flares kit, make sure to install Front Bumper first

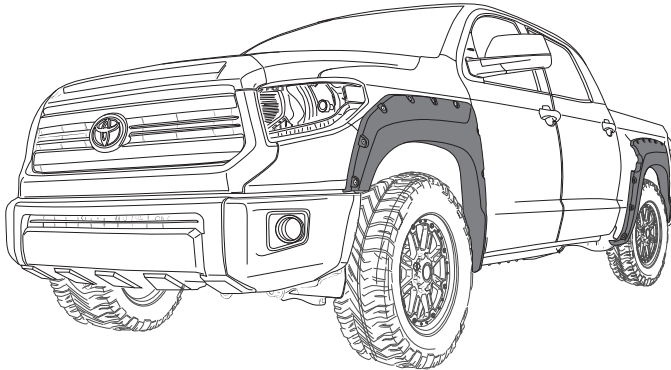

READ CAREFULLY BEFORE INSTALLATION

We recommend 2 persons for installation

DO NOT WASH CAR

DRIVE SLOWLY
25 mph max

24 hrs

TOOLS

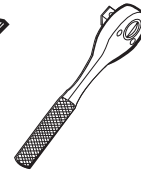
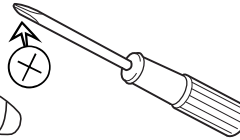

10mm

CHECK LIST

*Already installed in the part

ITEM	DESCRIPTION	DRAWING	AMOUNT
A	*SUPER BOLTS' RUBBER STUDS		26 pcs
B	*STAINLESS SUPER BOLT M6 X14		45 pcs
C	*STAINLESS LOCKNUT M6		19 pcs
D	PHILLIPS - HEX HEAD SEMS TAPPING SCREW M 6.3 X 25 M 16 M WASHER / 10 M		16 pcs
E	AUTOMOTIVE ADHESION PROMOTER TESA # 60153		1 pc
F	APPLICATION SPONGE		1 pc
G	GREASE PENCIL		1 pc
H	PVC TRIM		33 ft
I	STAINLESS LOCKNUT M5		2 pcs
J	L-BRACKET		2 pcs
K	BUTTON HEAD STAINLESS SCREW M5 X 10		2 pcs
L	WASHER M5		2 pcs
M	THREADLOCKER 222		1 pc
N	ECO DOME		1 pc



CID DESIGN

SUPER RIM
TRUCK ACCESSORIES POWERED BY INNOVATION USA

TOYOTA - TUNDRA 2015

INSTALLATION MANUAL

FRONT RIGHT & LEFT FLARE

! WASH WITH WATER, DETERGENT AND SOFT CLOTH OR SPONGE

1 REMOVE AND SAVE SCREWS

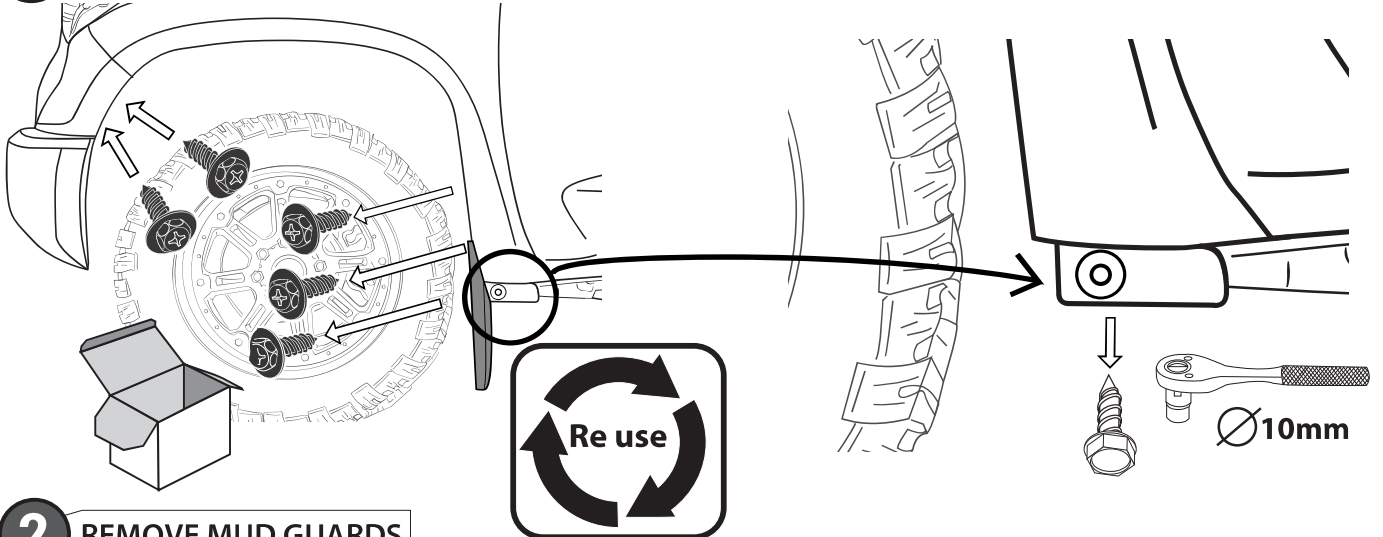

2 REMOVE MUD GUARDS

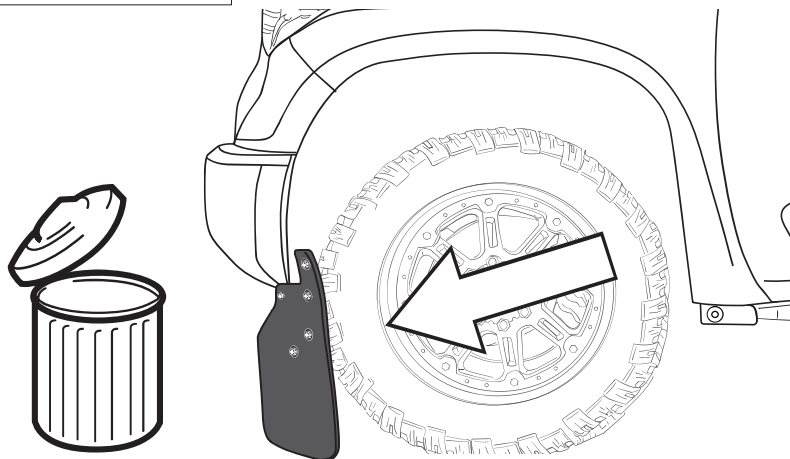

3 CLEAN

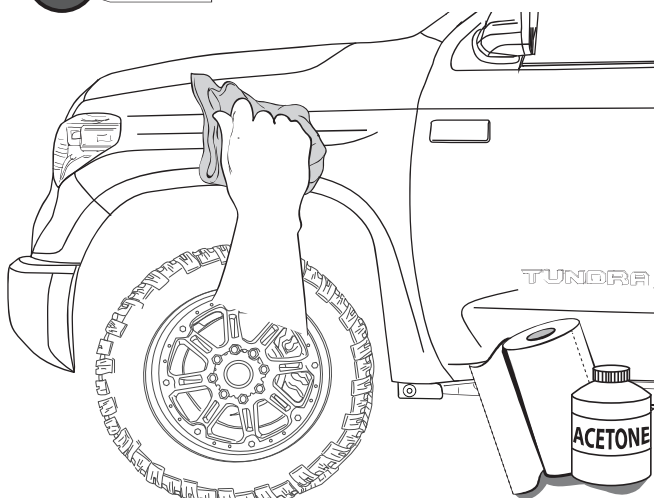

4 PRE-MOUNT

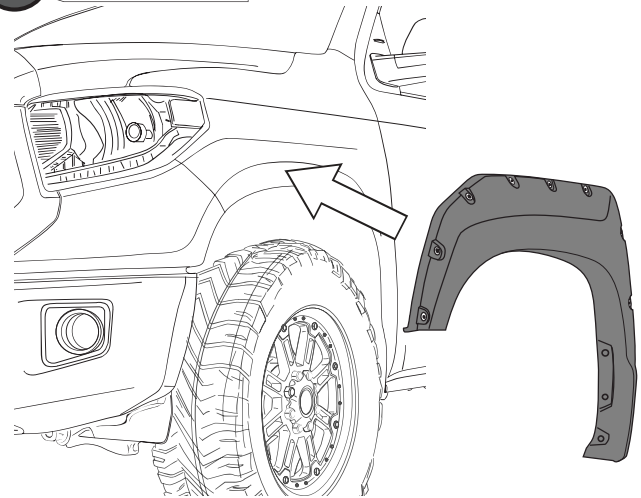



CID DESIGN

SUPER RIM
TRUCK ACCESSORIES POWERED BY INNOVATION USA

TOYOTA - TUNDRA 2015

INSTALLATION MANUAL

5 SECURE THE PART USING ORIGINAL SCREWS

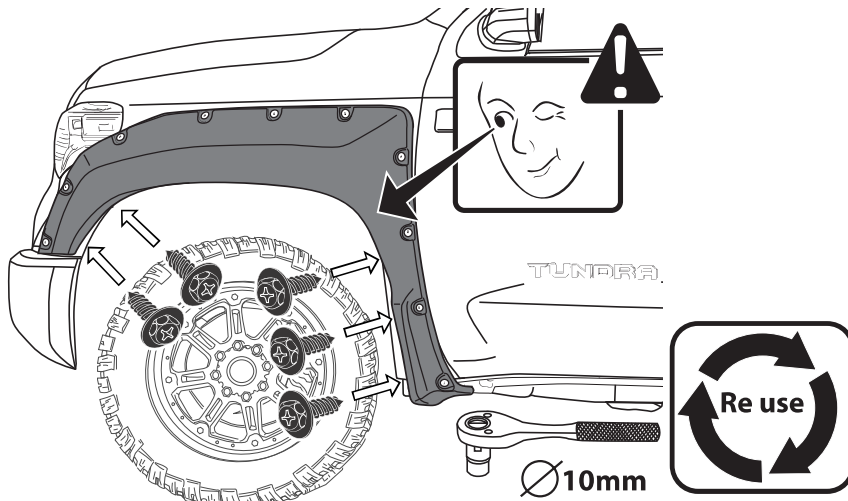

6 MARK SILHOUETTE AND SUPER BOLTS POSITIONS

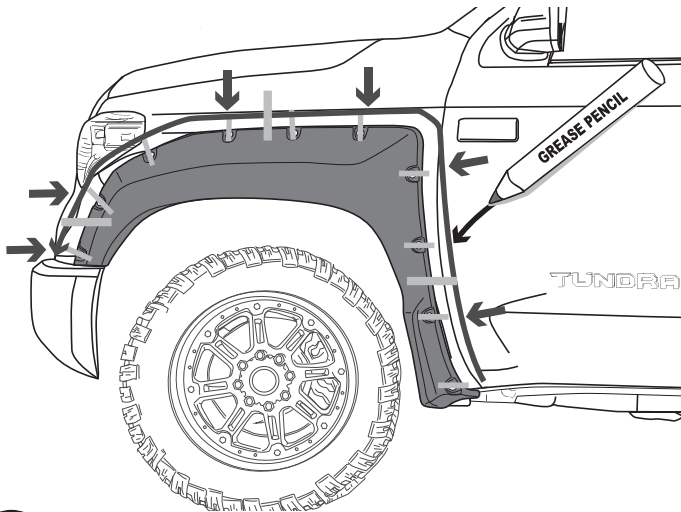

! HASH MARKS

DRAW CENTER HASH MARK WITH GREASE PENCIL AT CENTER, BOTH SIDES, ON EACH SUPER BOLT AND SHEET METAL. THIS WILL ENSURE WHEEL FLARE WILL BE CENTERED TO GREASE PENCIL OUTLINE.

7 UNSCREW & REMOVE

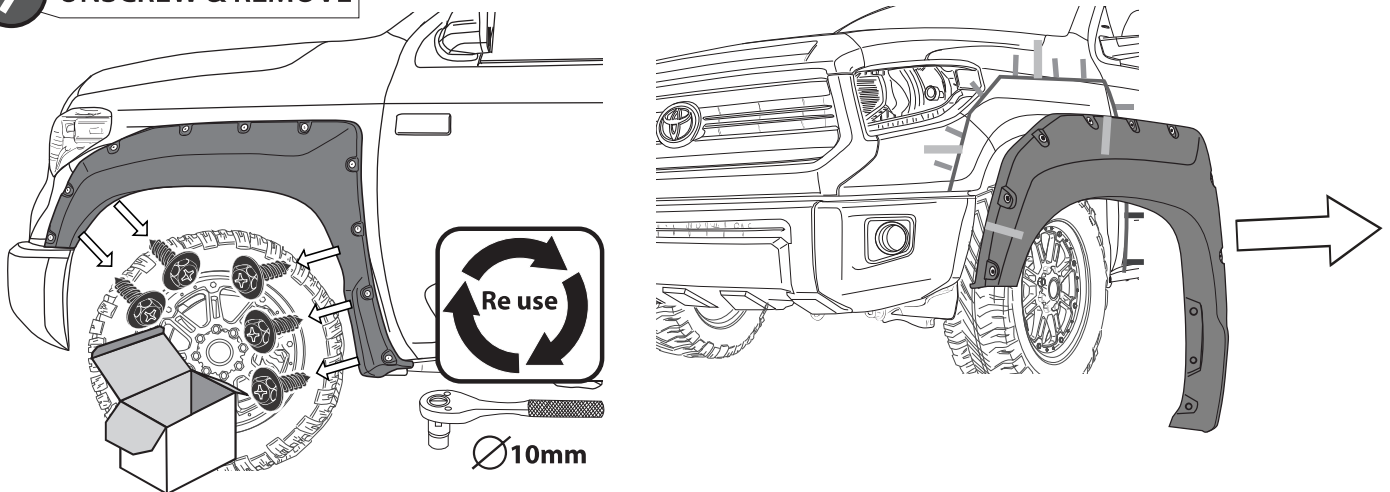



CID DESIGN

SUPER RIM
TRUCK ACCESSORIES POWERED BY INNOVATION USA

TOYOTA - TUNDRA 2015

INSTALLATION MANUAL

8 CLEAN



FIRST CLEAN ALL OVER THE APPLICATION AREA WITH ACETONE

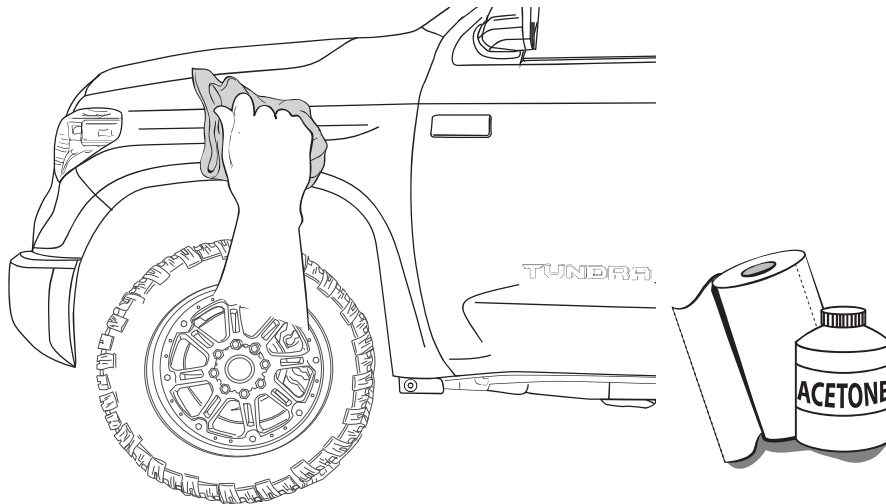

9 ADHESION PROMOTER

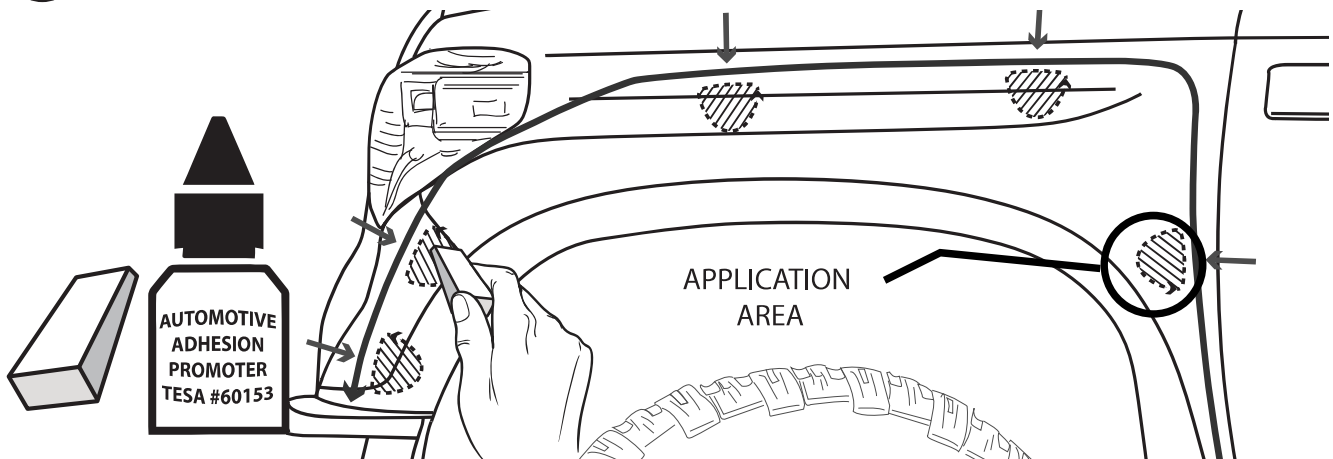

10 REMOVE LINER

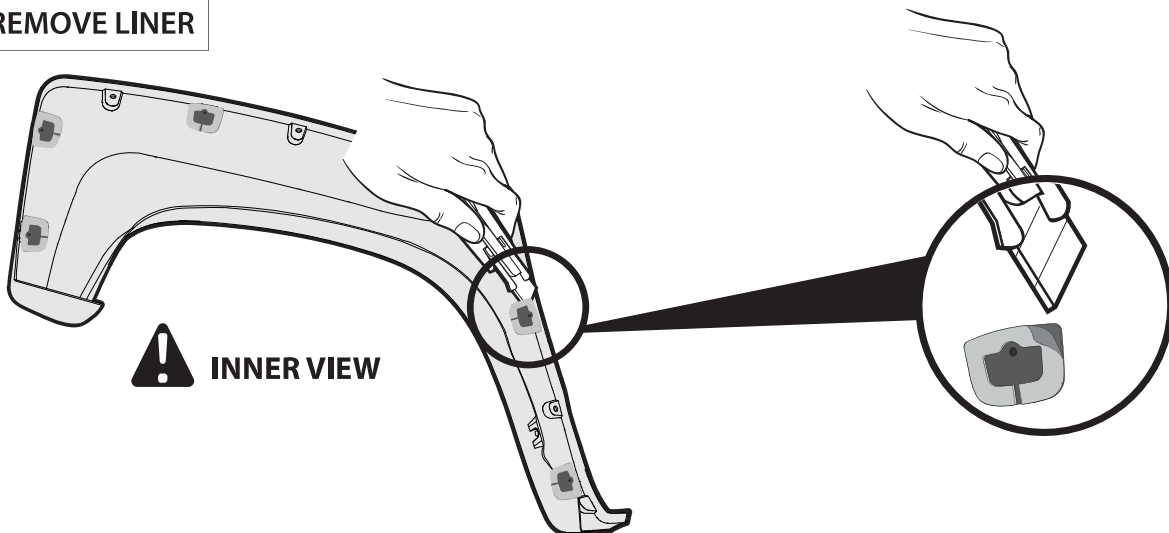



CID DESIGN

SUPER RIM
TRUCK ACCESSORIES POWERED BY INNOVATION USA

TOYOTA - TUNDRA 2015

INSTALLATION MANUAL

11 PRE-MOUNT

! ALIGN WHEEL FLARE TOP EDGE WITH THE GREASE PENCIL HASH MARKS AND PLACE.

We recommend 2 persons for installation

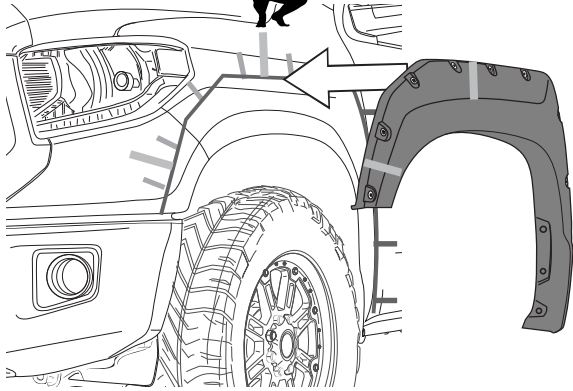

12 SECURE THE PART

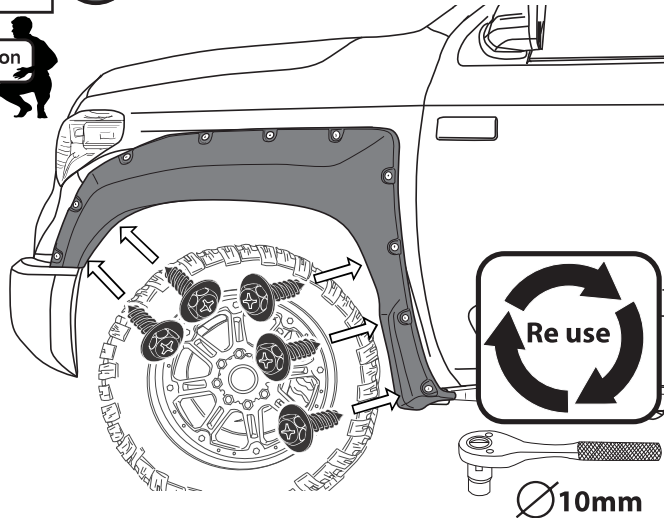

13 APPLY PRESSURE ON EACH SUPER BOLT

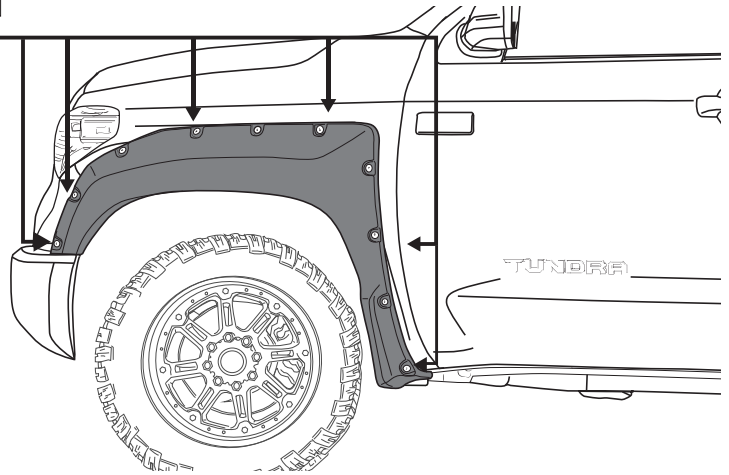
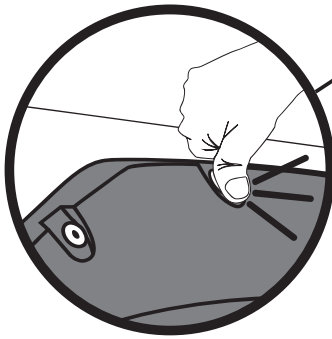

14 UNSCREW

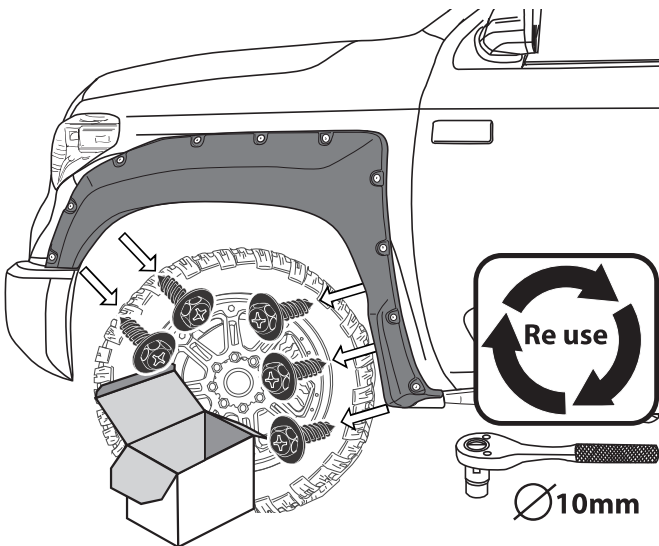

15 REMOVE SUPER BOLTS (B)

! ONLY THE ONES WITH RUBBER STUD

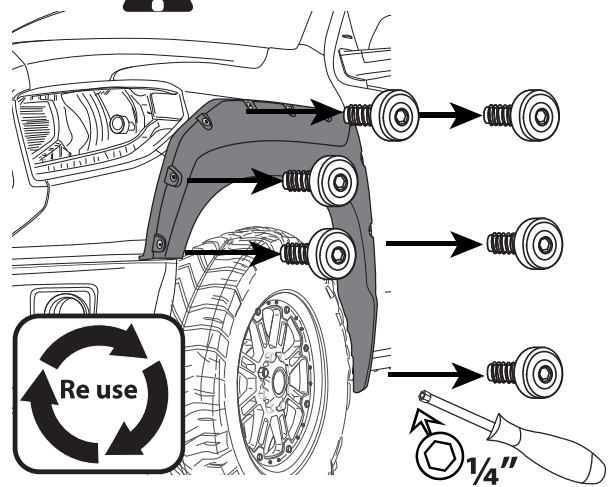



CID DESIGN

SUPER RIM
TRUCK ACCESSORIES POWERED BY INNOVATION USA

TOYOTA - TUNDRA 2015

INSTALLATION MANUAL

SUPER BOLT INSTALLATION

16 PRESS SUPER BOLTS' STUDS (A)

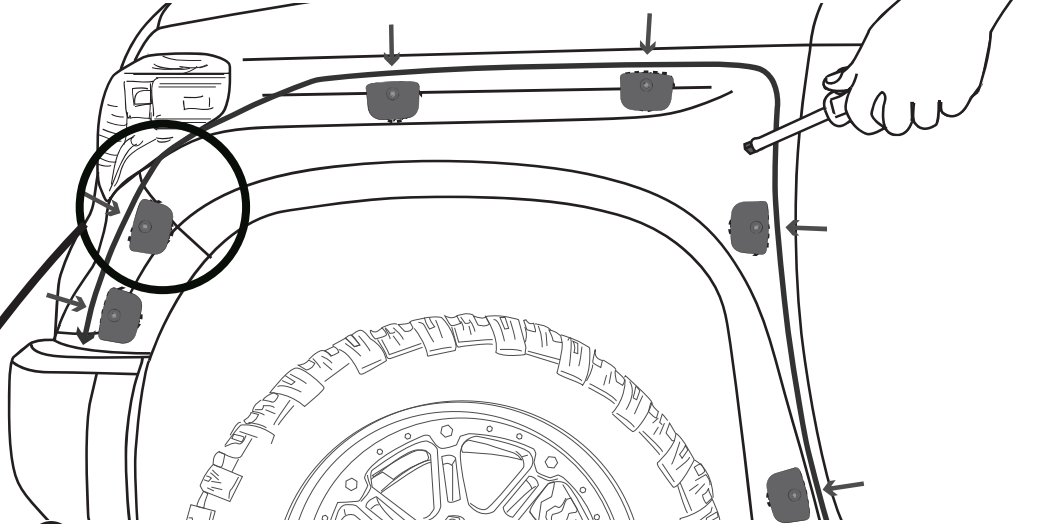

ATTENTION

FOR GOOD ADHESION IT IS NECESSARY TO APPLY AS MUCH PRESSURE AS POSSIBLE ALL OVER THE EDGE AND CENTER OF THE SUPER BOLTS STUDS.

SUPER BOLT STUDS

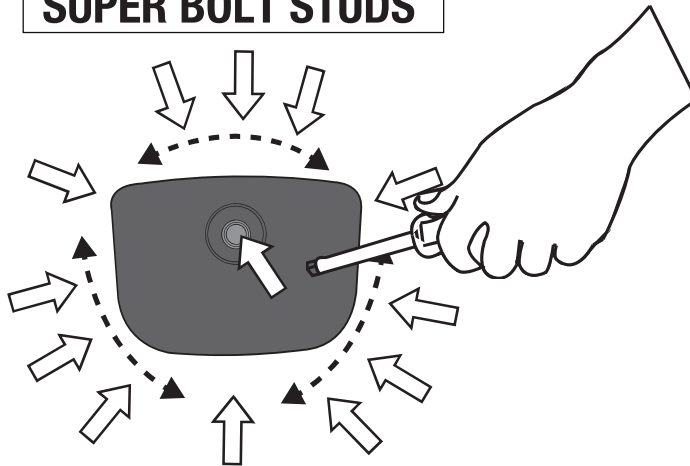

! PRESSURE POINTS



40-50 N/cm²



A full surface contact between tape and substrate is decisive for good adhesion performance. Contact is achieved by applying pressure. In practice a pressure between 40 and 50 N/cm² is usually needed and an application temperature between 25 and 45 °C or 77 and 113 °F is also necessary. During application, add-on parts and tapes must have the similar temperature.



CID DESIGN

SUPER RIM
TRUCK ACCESSORIES POWERED BY AMERICAN USA

TOYOTA - TUNDRA 2015

INSTALLATION MANUAL

17 PLACE "L" BRACKET (I) WITH BUTTON HEAD SCREW M5 (J), WASHER M5 (K) & LOCKNUT M5 (L)

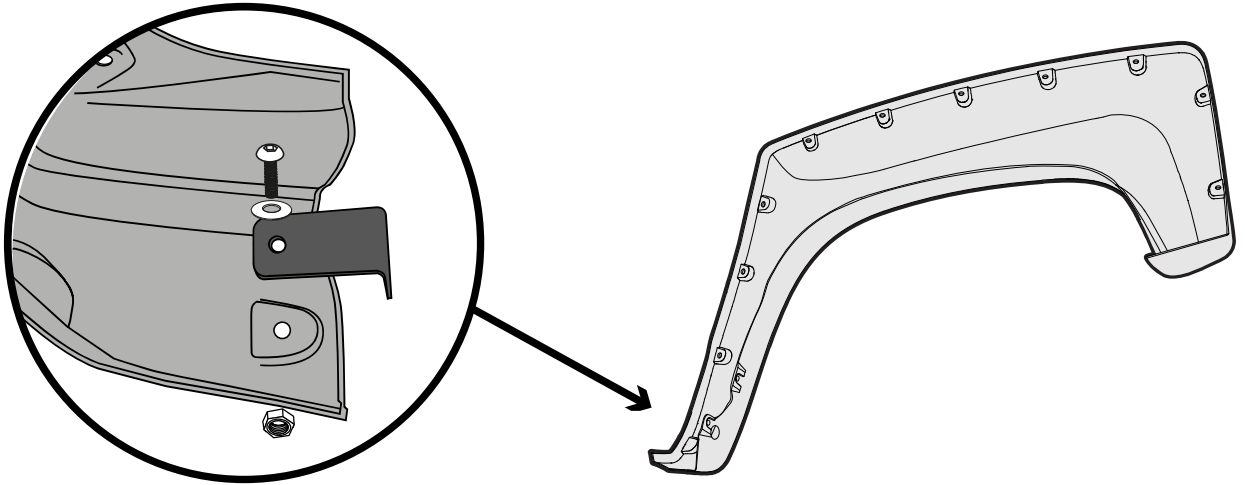

18 PLACE PVC TRIM

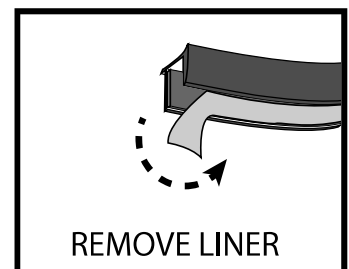
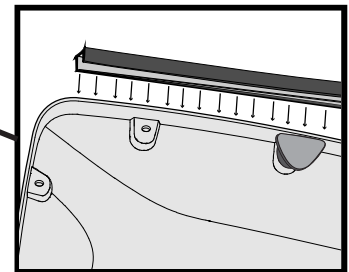
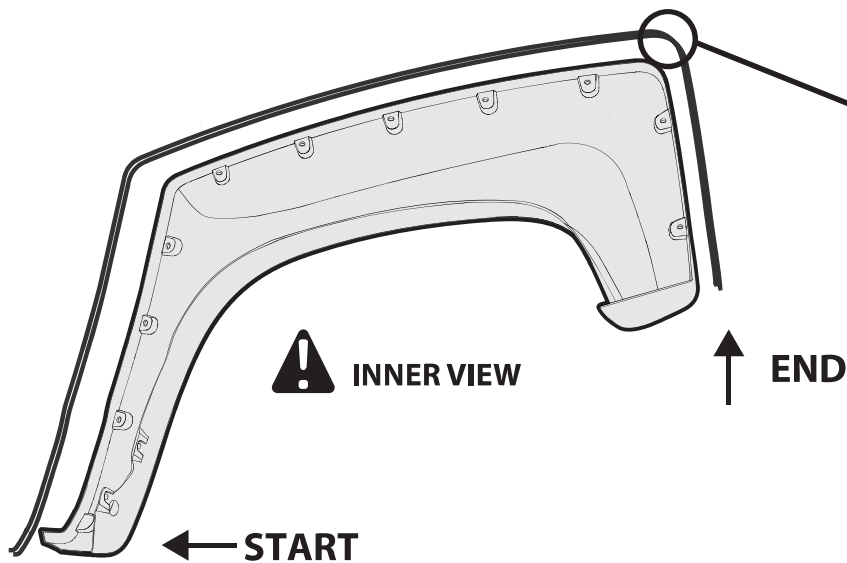
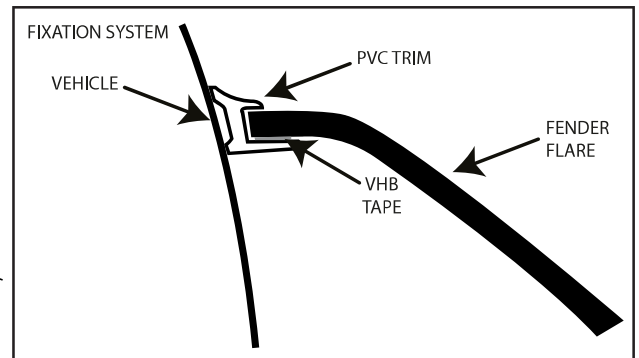
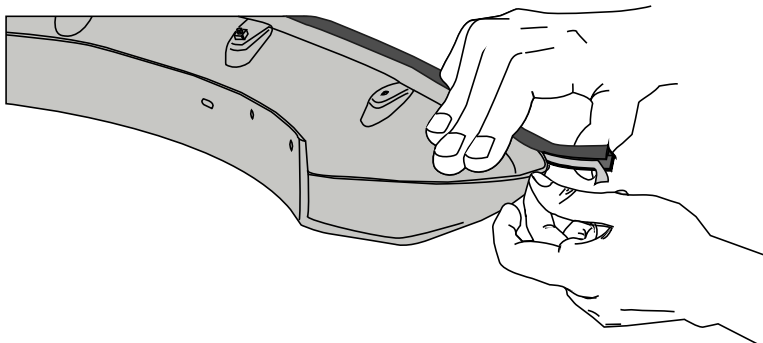



CID DESIGN

SUPER RIM
TRUCK ACCESSORIES POWERED BY INNOVATION USA

TOYOTA - TUNDRA 2015

INSTALLATION MANUAL

19 PLACE

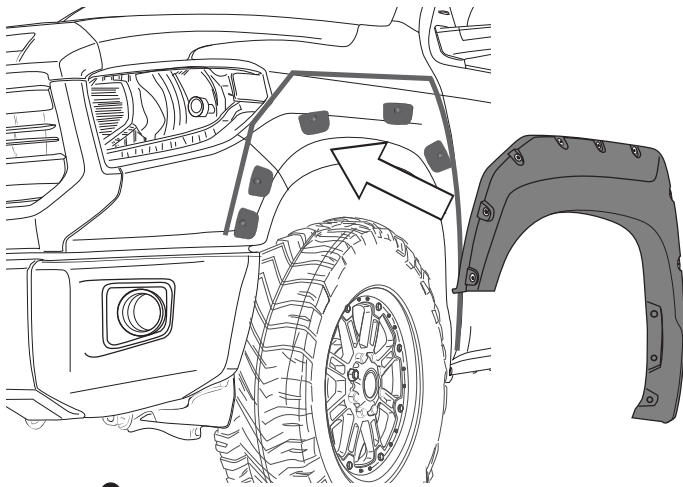

20 SECURE THE PART

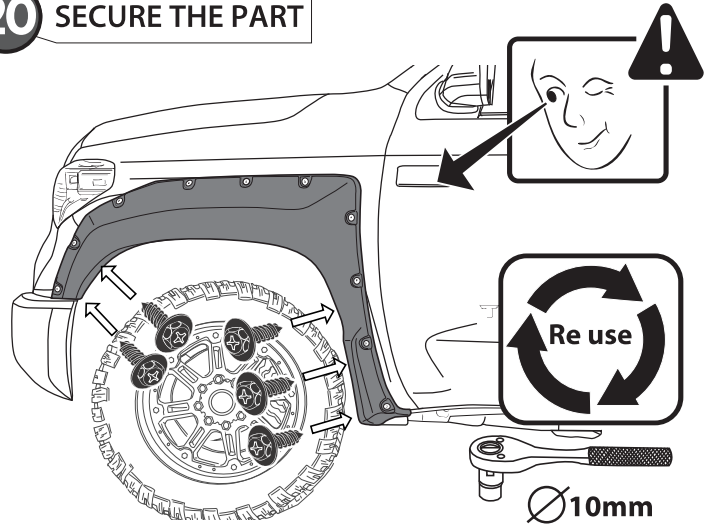

! ATTENTION

22 PLACE SUPER BOLTS

! HAND TIGHT

21 APPLY LOCTITE THREADLOCKER TO SUPER BOLT'S THREAD

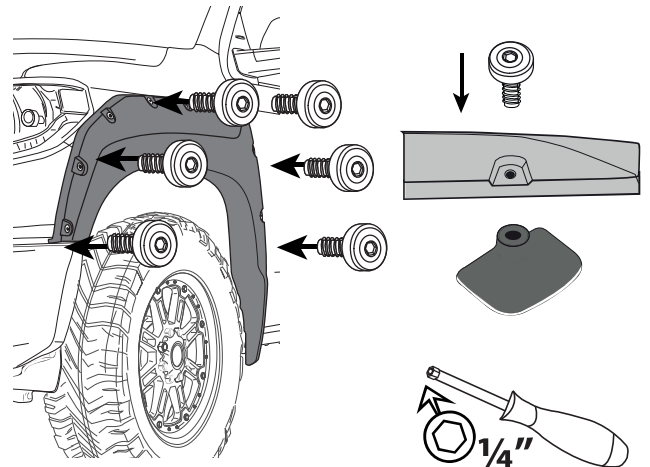
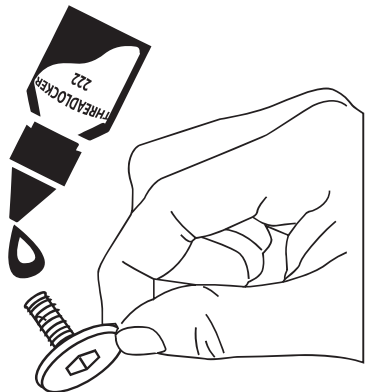

23 PIN UP BRACKET

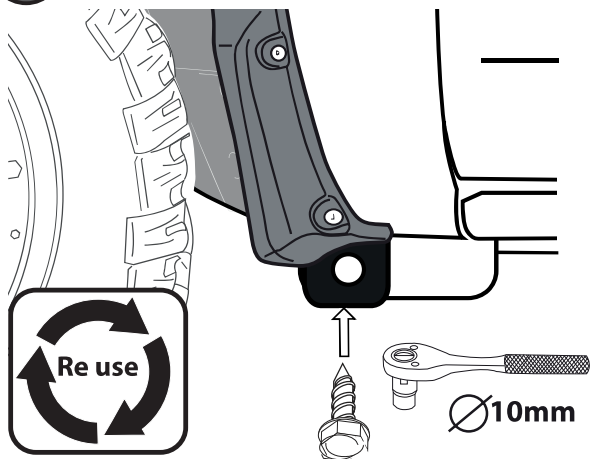

24 CLEAN THE GREASE PENCIL MARK

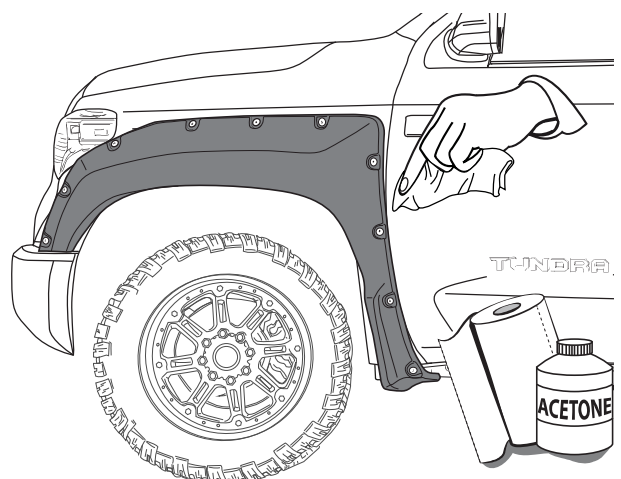



CID DESIGN

SUPER RIM
TRUCK ACCESSORIES POWERED BY AMERICAN USA

TOYOTA - TUNDRA 2015

INSTALLATION MANUAL

REAR RIGHT & LEFT FLARE

1 REMOVE AND SAVE SCREWS

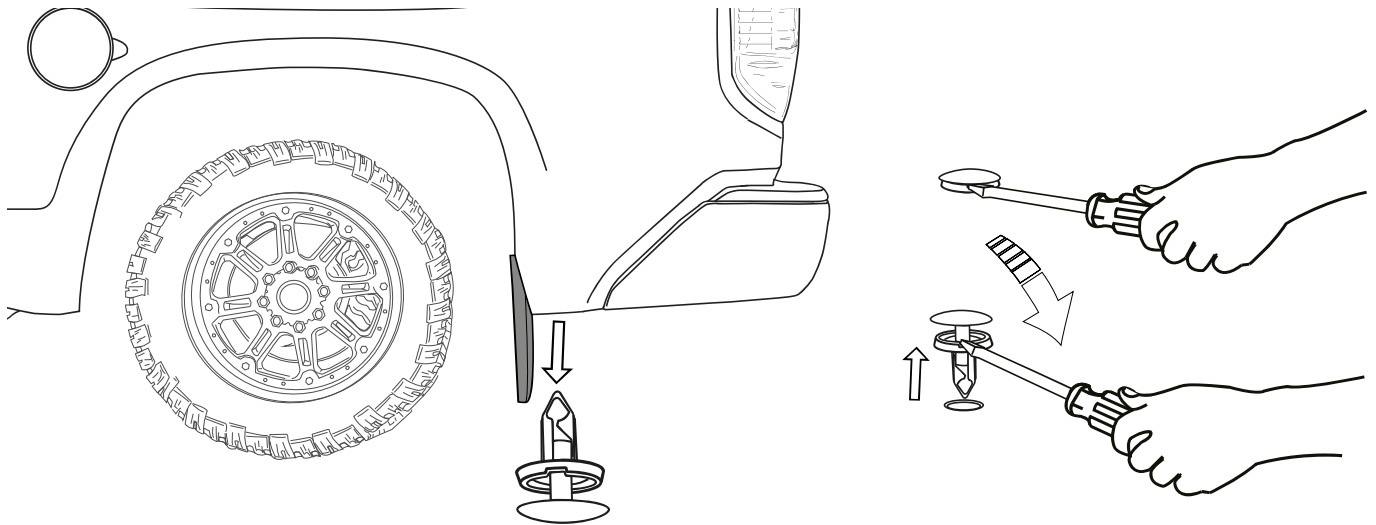
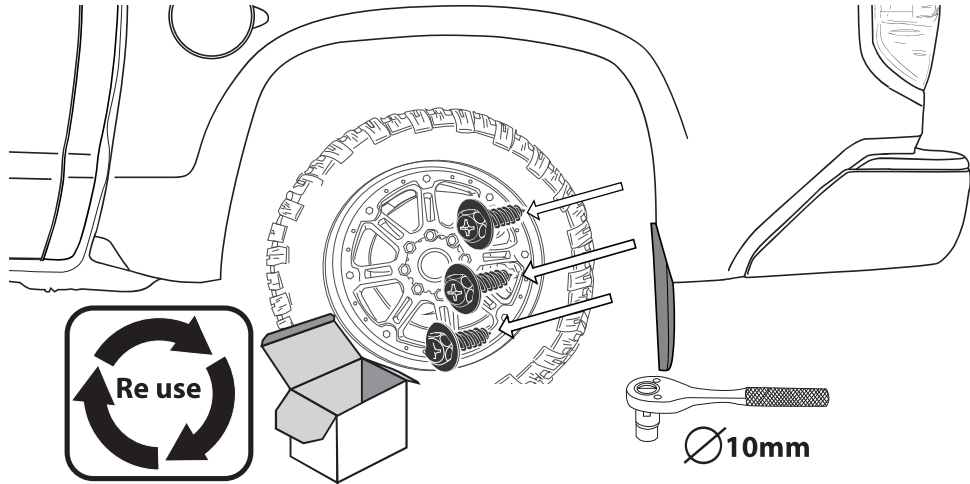

2 REMOVE MUD GUARDS

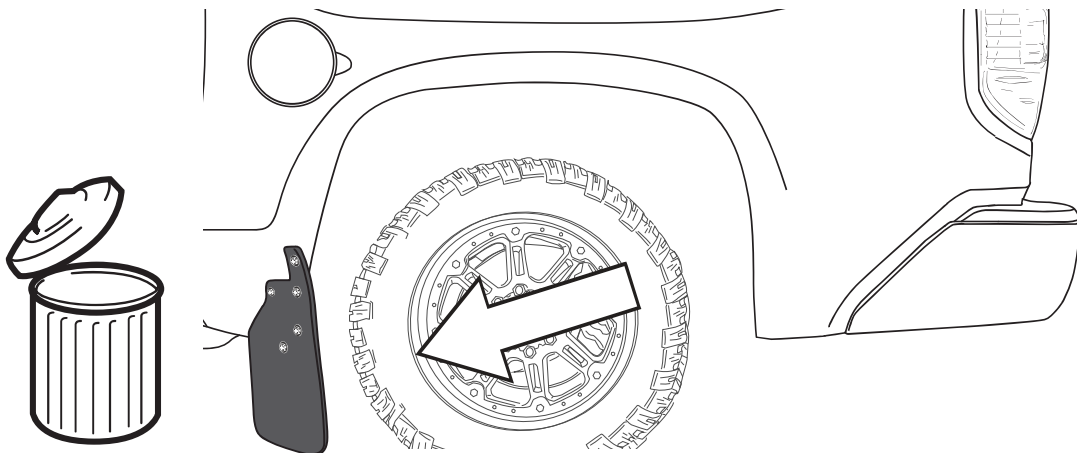



CID DESIGN

SUPER RIM
TRUCK ACCESSORIES POWERED BY INNOVATION USA

TOYOTA - TUNDRA 2015

INSTALLATION MANUAL

3 CLEAN

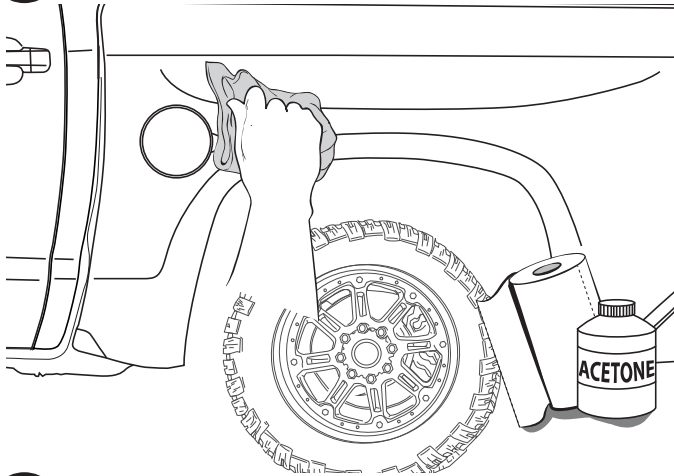

4 PRE-MOUNT

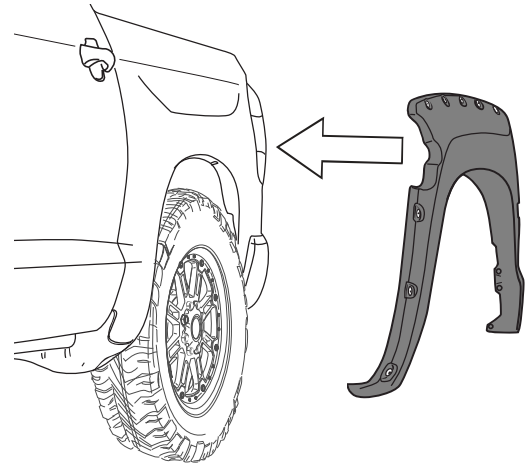

5 SECURE THE PART USING PHILLIPS SCREW 6.3X20 (D)

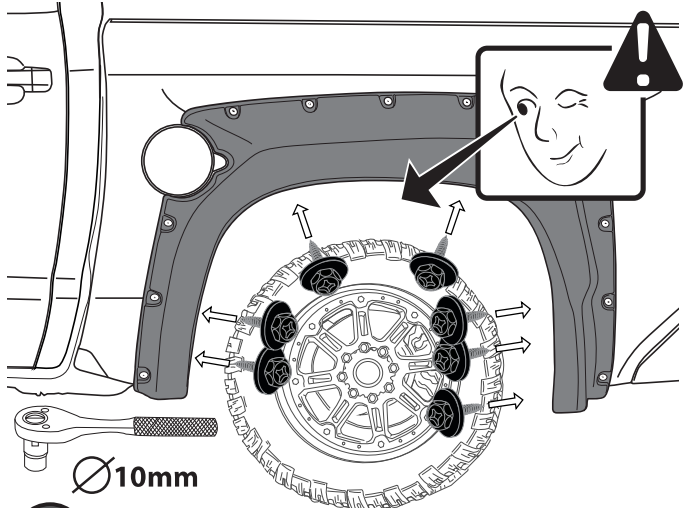

6 MARK

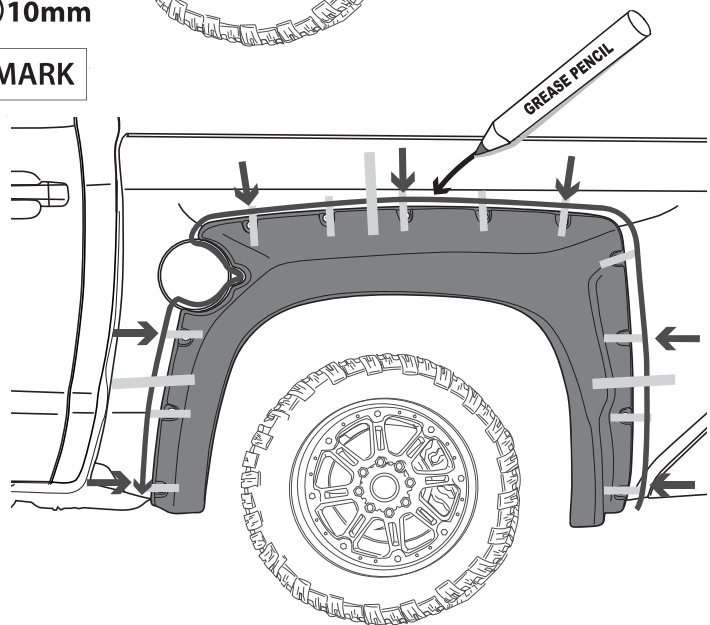

⚠ HASH MARKS

DRAW CENTER HASH MARK WITH GREASE PENCIL AT CENTER, BOTH SIDES, ON EACH SUPER BOLT AND SHEET METAL. THIS WILL ENSURE WHEEL FLARE WILL BE CENTERED TO GREASE PENCIL OUTLINE.



CID DESIGN

SUPER RIM
TRUCK ACCESSORIES POWERED BY INNOVATION USA

TOYOTA - TUNDRA 2015

INSTALLATION MANUAL

7 UNSCREW & REMOVE

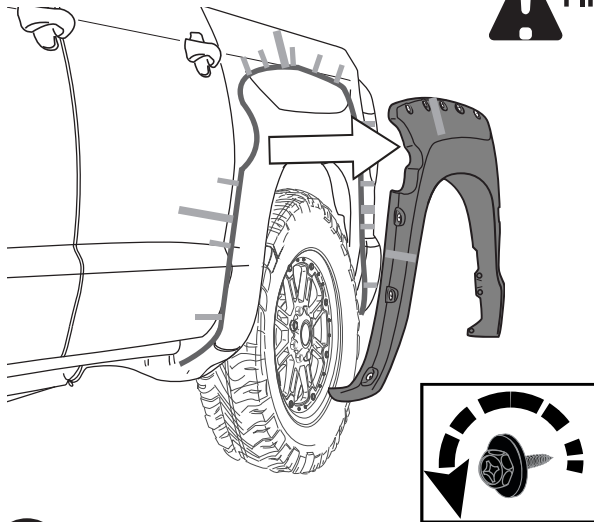

8 CLEAN



FIRST CLEAN ALL OVER THE APPLICATION AREA WITH ACETONE

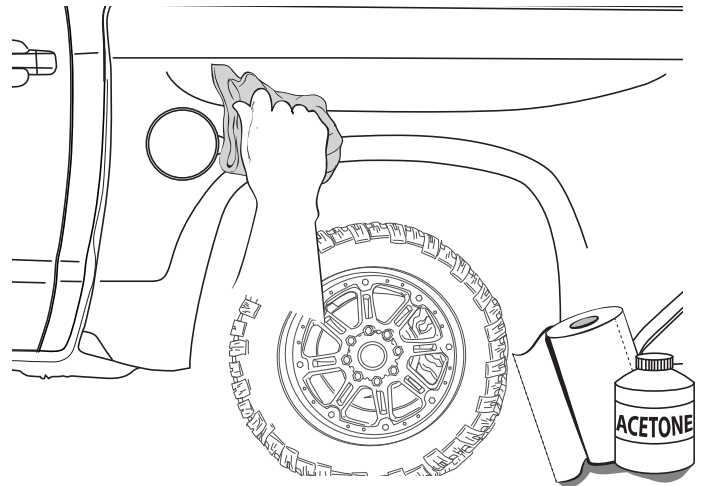

9 ADHESION PROMOTER

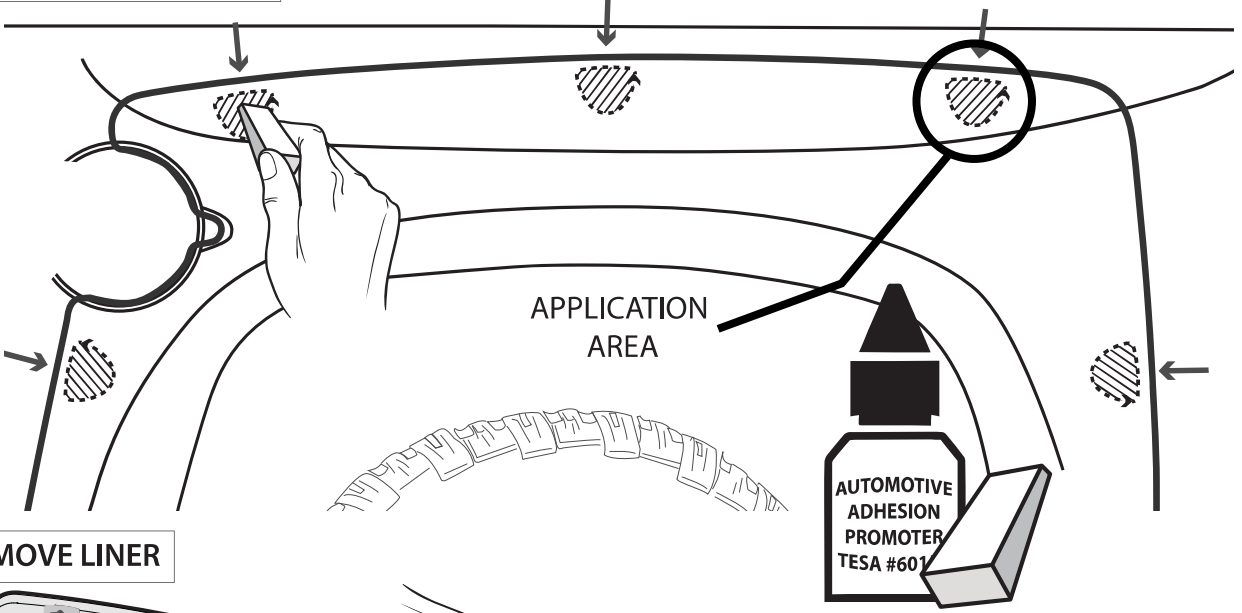

10 REMOVE LINER

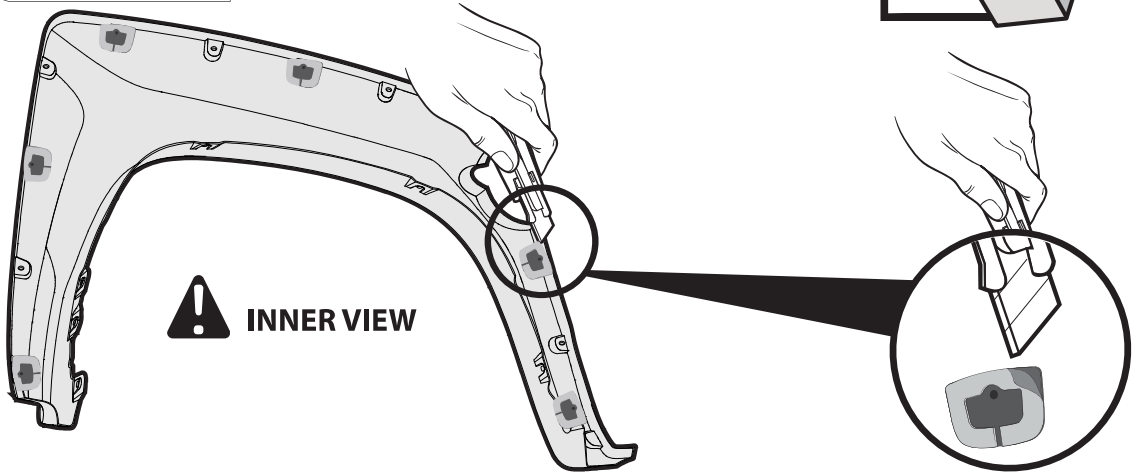

INNER VIEW



CID DESIGN

SUPER RIM
TRUCK ACCESSORIES POWERED BY INNOVATION USA

TOYOTA - TUNDRA 2015

INSTALLATION MANUAL

11 PRE-MOUNT

! ALIGN WHEEL FLARE TOP EDGE WITH THE GREASE PENCIL HASH MARKS AND PLACE.

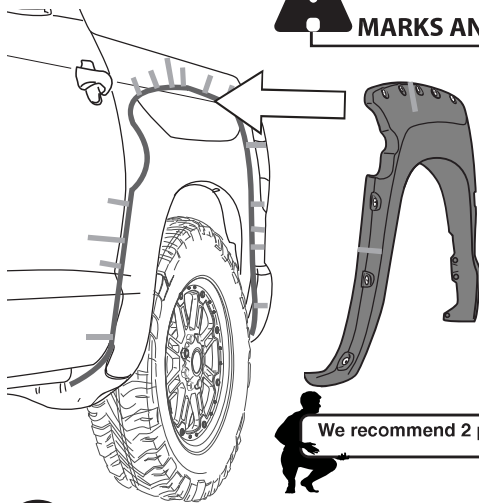

We recommend 2 persons for installation

12 SECURE THE PART

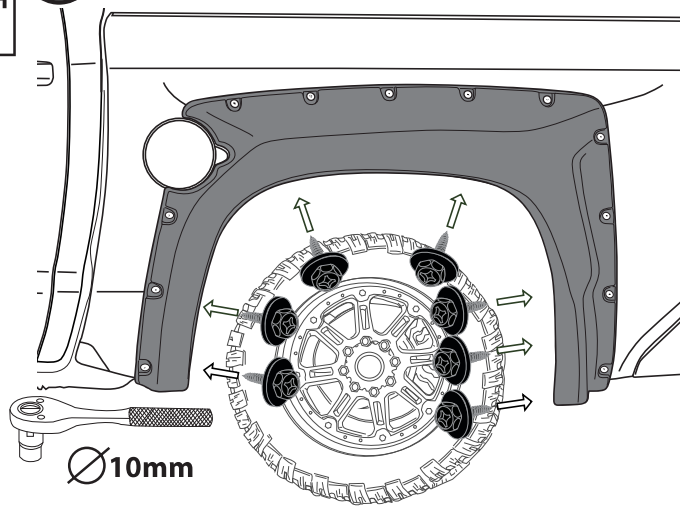

Ø10mm

13 APPLY PRESSURE ON EACH SUPER BOLT

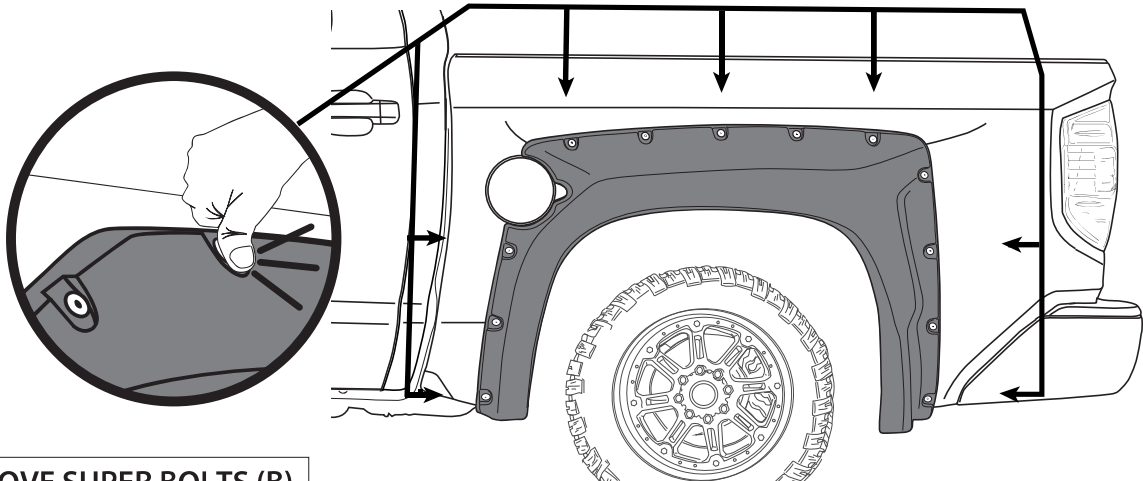

14 REMOVE SUPER BOLTS (B)

! ONLY THE ONES WITH RUBBER STUD

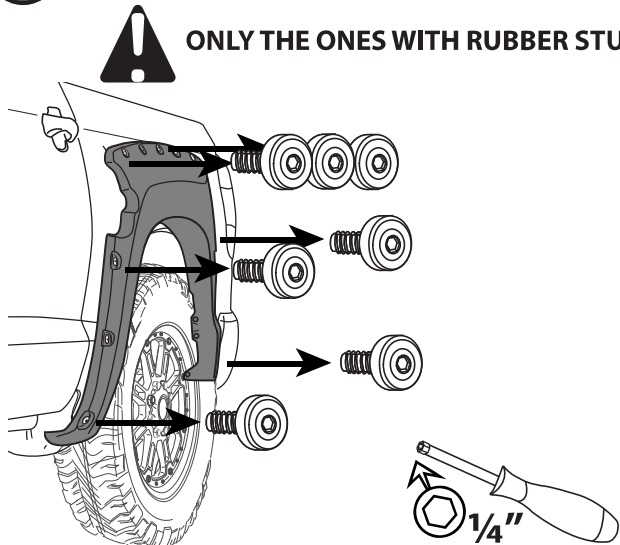

1/4"

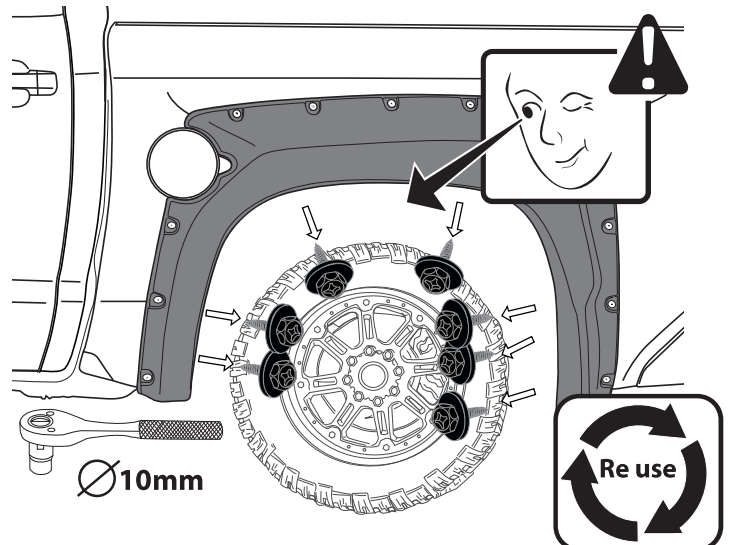



CID DESIGN

SUPER RIM
TRUCK ACCESSORIES POWERED BY ADHESION USA

TOYOTA - TUNDRA 2015

INSTALLATION MANUAL

SUPER BOLT INSTALLATION

15 PRESS SUPER BOLTS' STUDS (A)

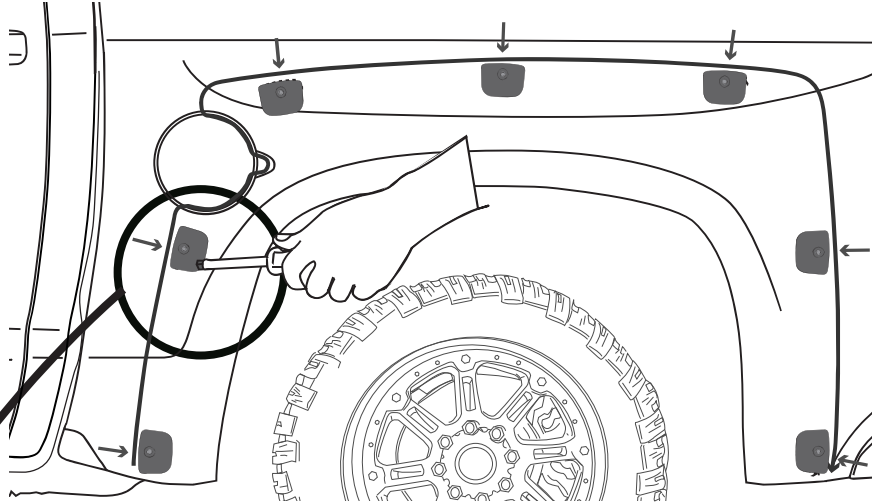

ATTENTION

FOR GOOD ADHESION IT IS NECESSARY TO APPLY AS MUCH PRESSURE AS POSSIBLE ALL OVER THE EDGE AND CENTER OF THE SUPER BOLTS STUDS.

SUPER BOLT STUDS

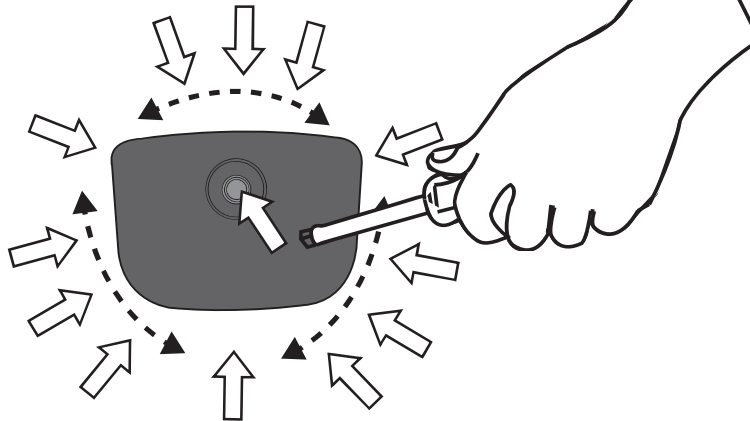

! PRESSURE POINTS



40-50 N/cm²

! A full surface contact between tape and substrate is decisive for good adhesion performance. Contact is achieved by applying pressure. In practice a pressure between 40 and 50 N/cm² is usually needed and an application temperature between 25 and 45 °C or 77 and 113 °F is also necessary. During application, add-on parts and tapes must have the similar temperature.



CID DESIGN

SUPER RIM
TRUCK ACCESSORIES POWERED BY INNOVATION USA

TOYOTA - TUNDRA 2015

INSTALLATION MANUAL

16 PLACE PVC TRIM

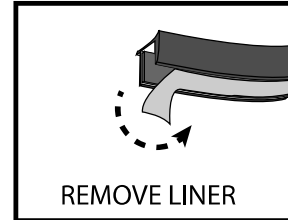
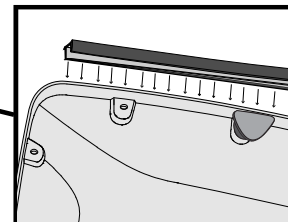
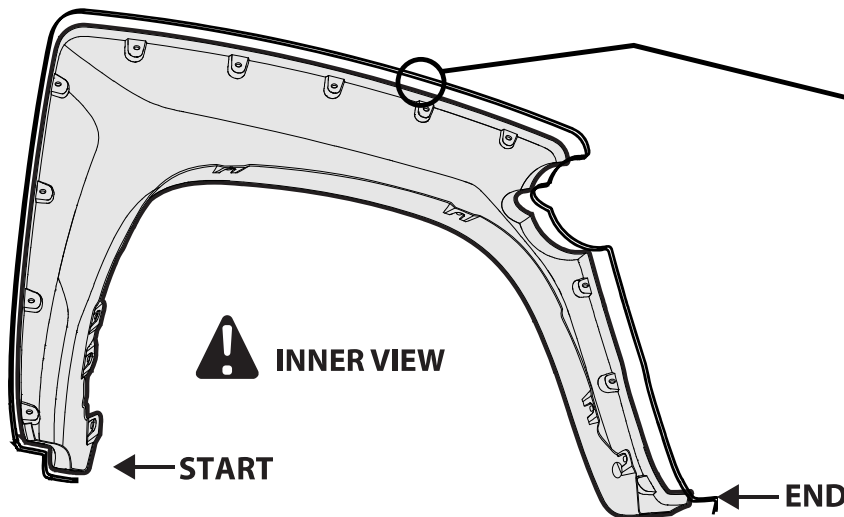
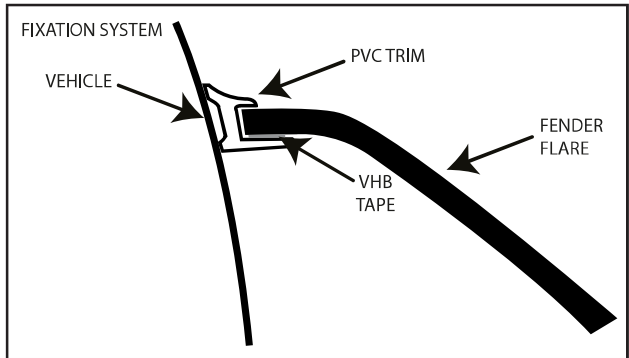
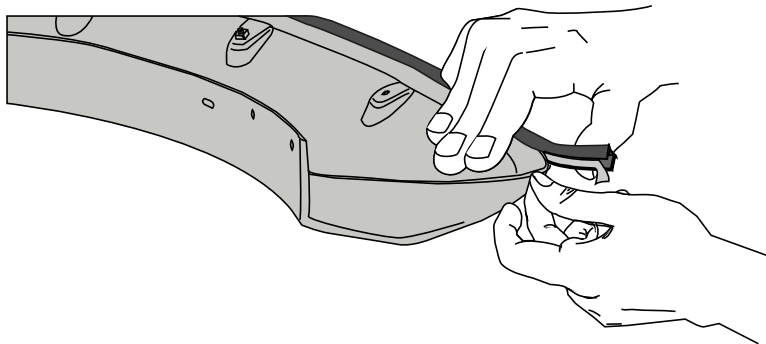

REMOVE LINER

17 PLACE

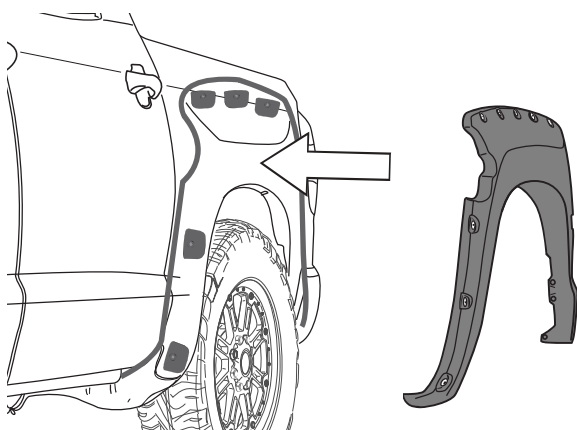

18 SECURE THE PART

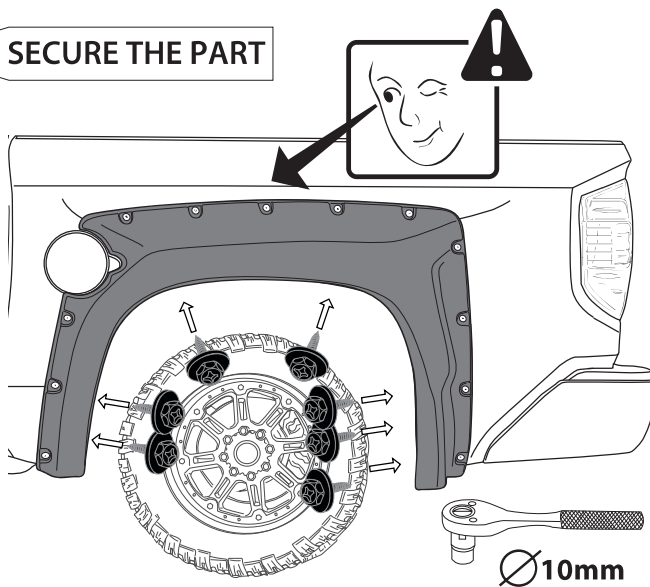



CID DESIGN

SUPER RIM
TRUCK ACCESSORIES POWERED BY AMERICAN USA

TOYOTA - TUNDRA 2015

INSTALLATION MANUAL

! ATTENTION

19 APPLY LOCTITE THREADLOCKER TO SUPER BOLT'S THREAD



20 PLACE SUPER BOLTS

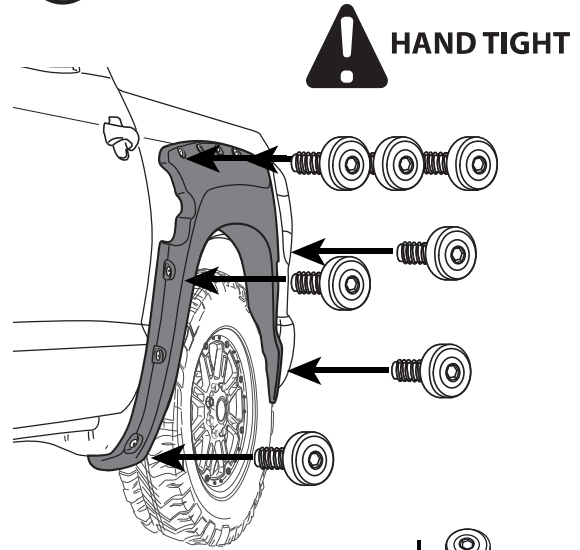

21 CLEAN THE GREASE PENCIL MARK

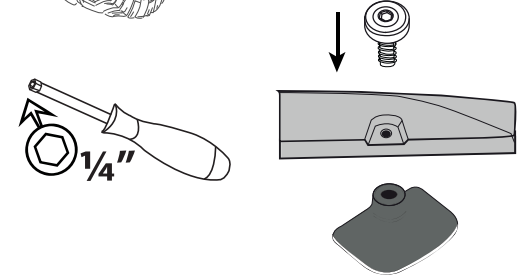
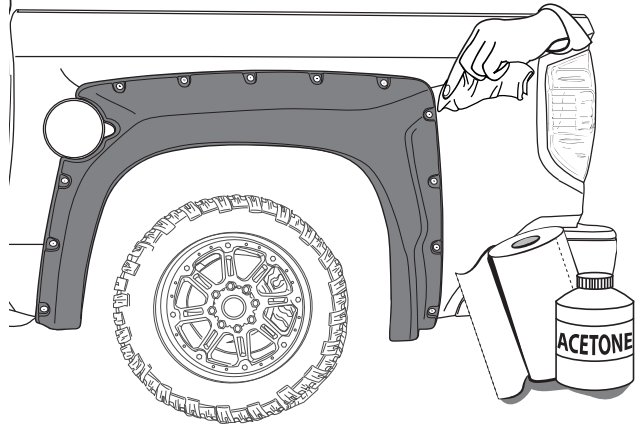

INSTALLED PARTS

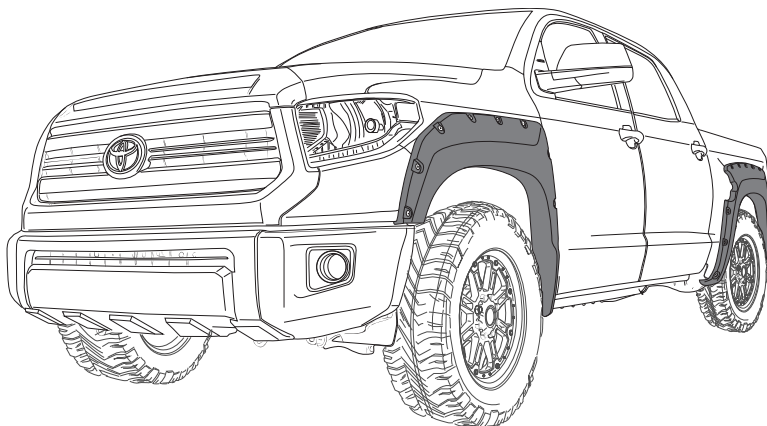



CID DESIGN

SUPER RIM
TRUCK ACCESSORIES POWERED BY INNOVATION USA

TOYOTA - TUNDRA 2015

INSTALLATION MANUAL

BUMPER PROTECTOR TUNDRA

PART #: 1107CNEUTO01A04



In case of installing Front Bumper and Fender Flares kit make sure to install Front Bumper first

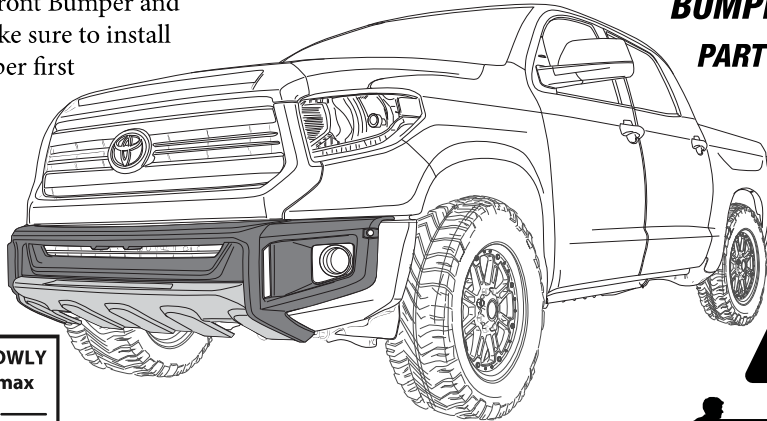

READ CAREFULLY BEFORE INSTALLATION

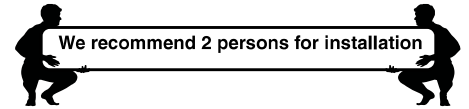

DO NOT WASH CAR



DRIVE SLOWLY
25 mph max



24 hrs

TOOLS

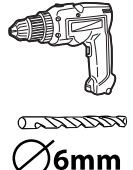
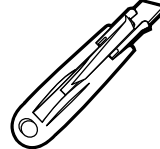
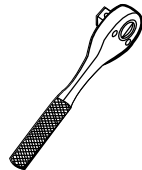

CHECK LIST

*Already installed in the part

ITEM	DESCRIPTION	DRAWING	AMOUNT
A	* VHB TAPE		Included in the parts
B	PUSH PIN WURTH 387		8 pcs
C	DRL LED OSRAM PX-5		1 set
D	* BUTTON HEAD ALLEN STAINLESS SCREW M4 X 16		4 pcs
E	* WASHER 3/16		4 pcs
F	* STAINLESS LOCK NUT M4		4 pcs
G	GREASE PENCIL		1 pc
H	AUTOMOTIVE ADHESION PROMOTER		1 pc
I	QUICK SPLICE TAP CONECTOR		4 pcs
J	WIRE EXTENSION		Included
K	POLYURETHANE ADHESIVE		1 pc
L	BLACKOUT		4 pcs
M	ECO DOME		1 pc



CID DESIGN

SUPER RIM
TRUCK ACCESSORIES POWERED BY INNOVATION USA

TOYOTA - TUNDRA 2015

INSTALLATION MANUAL

1 INSTALLATION DRL TO BATTERY

**"LED DAY TIME RUNNING LIGHTS"
(DRL) INSTALATION FOR FRONT
BUMPER PROTECTORS"**

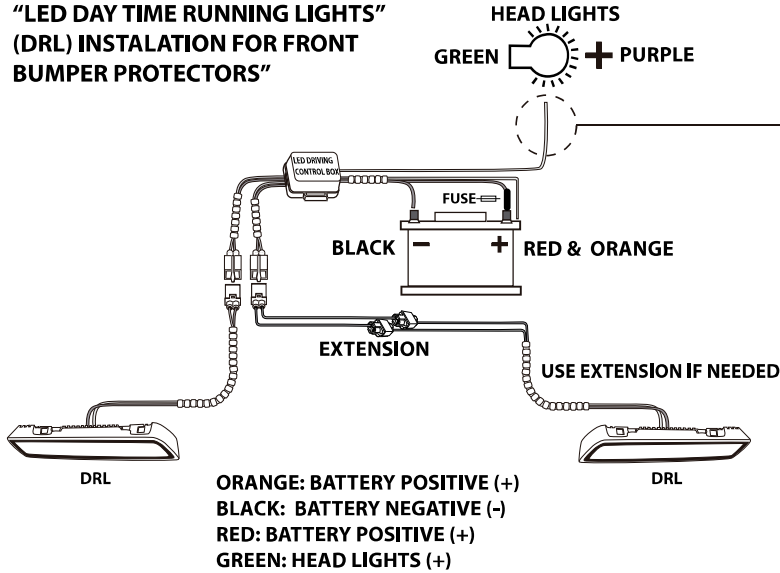

**THE ENGINE HAS TO BE RUNNING
FOR THE DRL'S TO FUNCTION**

HEAD LIGHT DRIVER'S SIDE

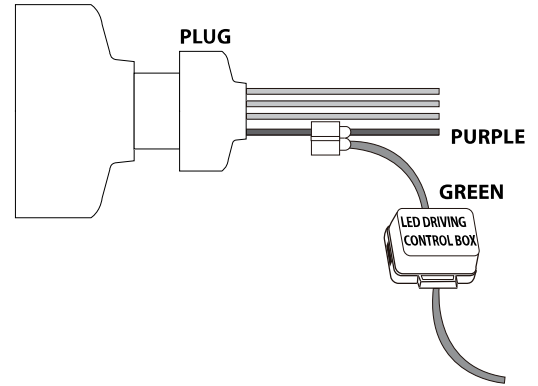

If the DRL's did not turn on inmediately when the vehicle starts, please wait a few minutes until the computer resets and then the lights will lit up



In case the vehicle counts with proximity sensors relocate them following the instructions, otherwise continue with the rest of the manual.

2 INSTALL EXTENCION

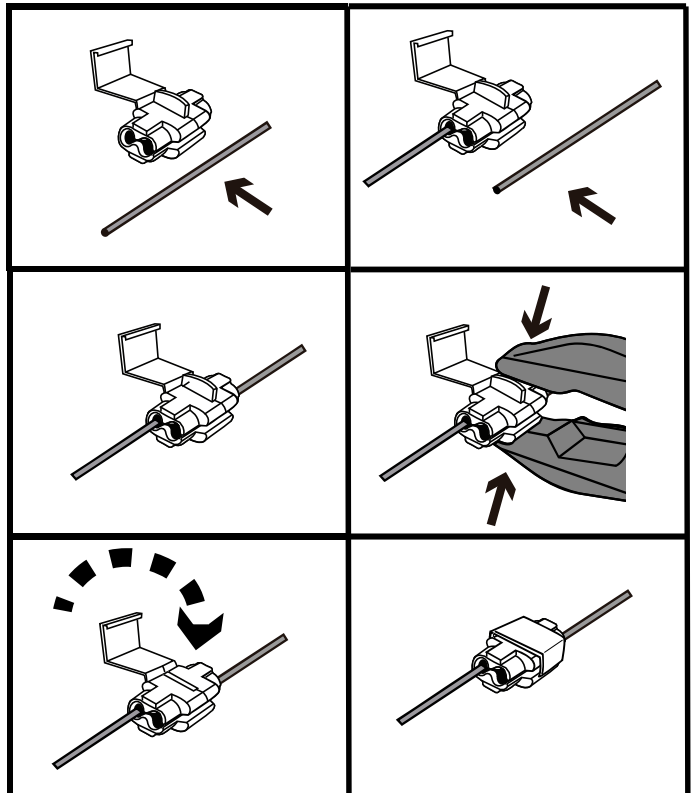
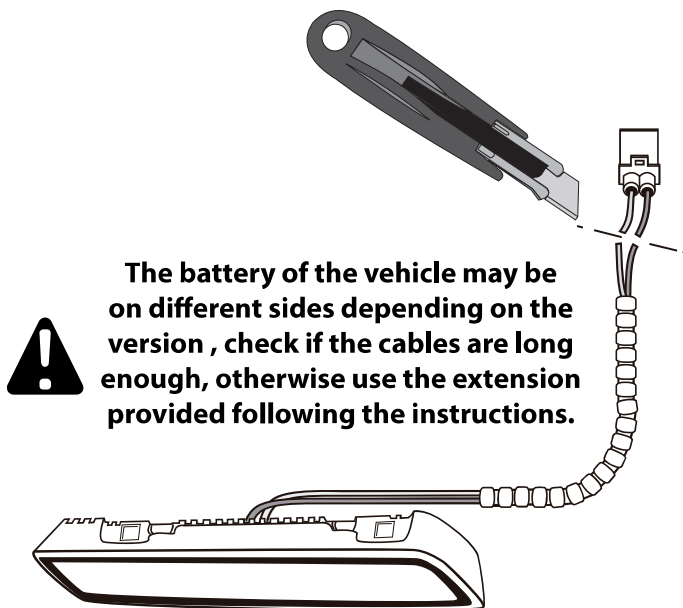



CID DESIGN

SUPER RIM
TRUCK ACCESSORIES POWERED BY INNOVATION USA

TOYOTA - TUNDRA 2015

INSTALLATION MANUAL



WASH WITH WATER, DETERGENT AND
SOFT CLOTH OR SPONGE

3 REMOVE GRILLE AND PLASTIC COVERS

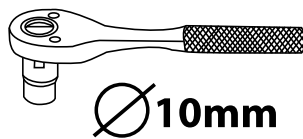
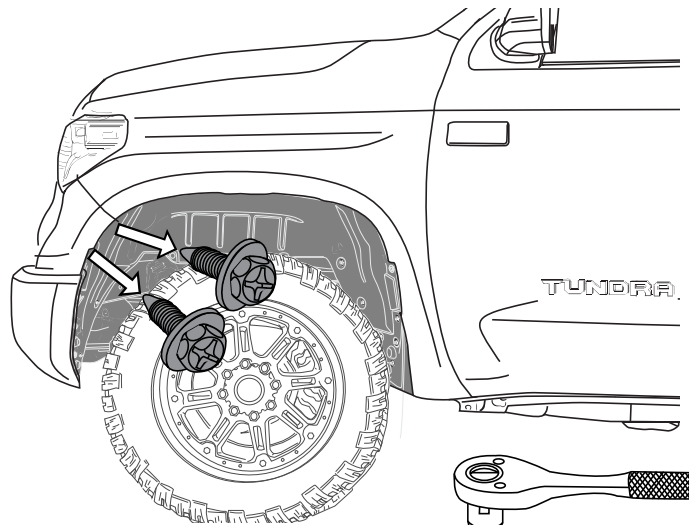
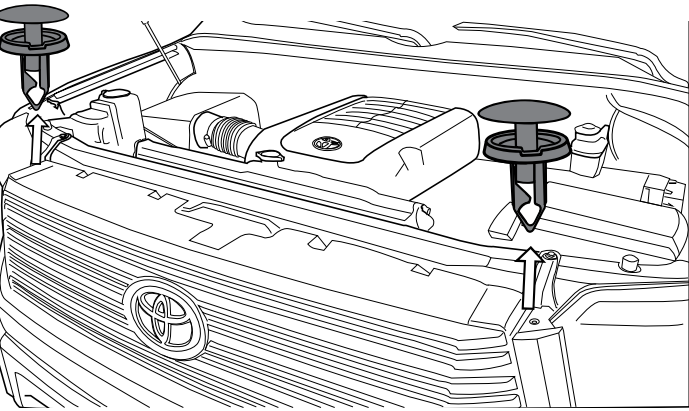
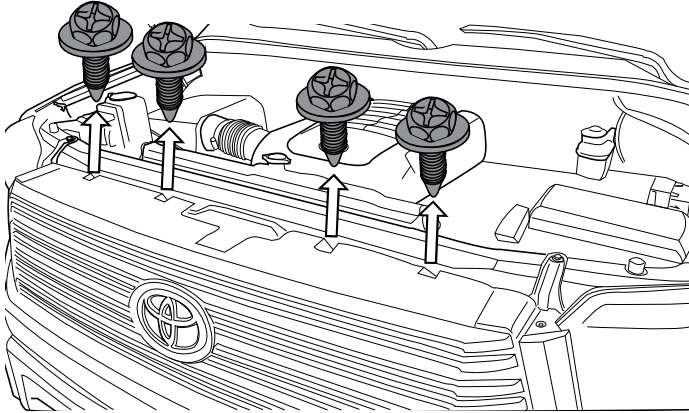

Ø10mm

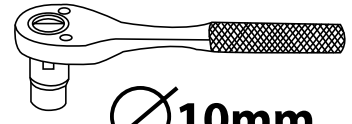

Ø10mm

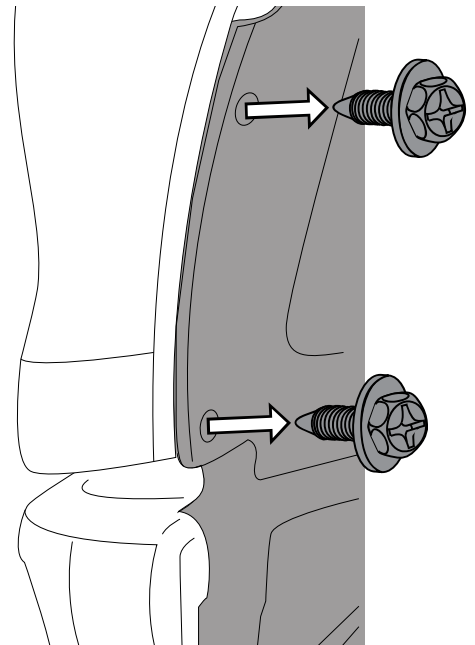
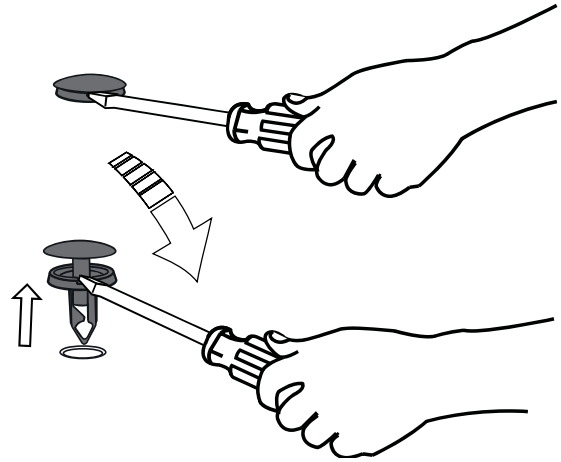



CID DESIGN

SUPER RIM
TRUCK ACCESSORIES POWERED BY INNOVATION USA

TOYOTA - TUNDRA 2015

INSTALLATION MANUAL

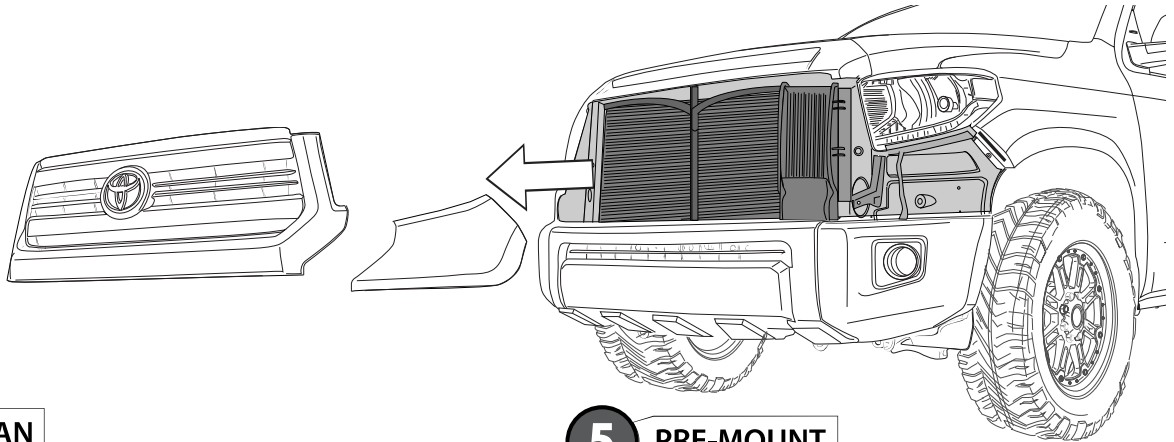

4 CLEAN

5 PRE-MOUNT

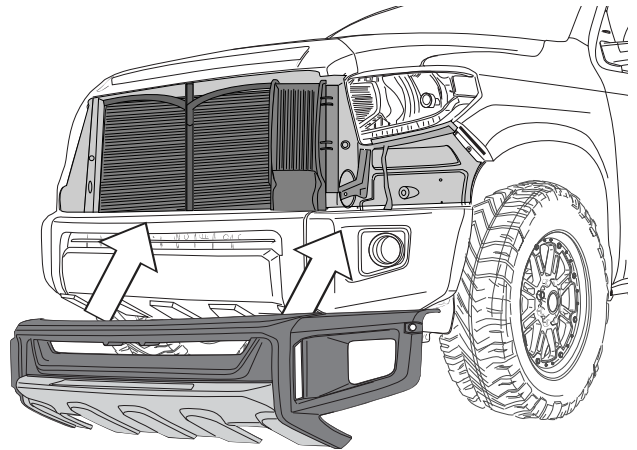
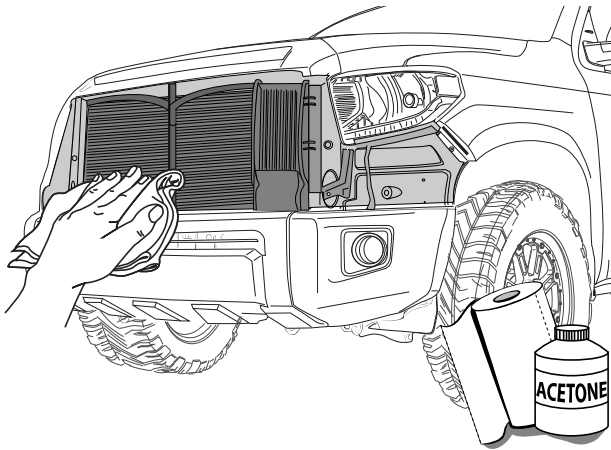

6 MARK

! HASH MARKS

7 REMOVE

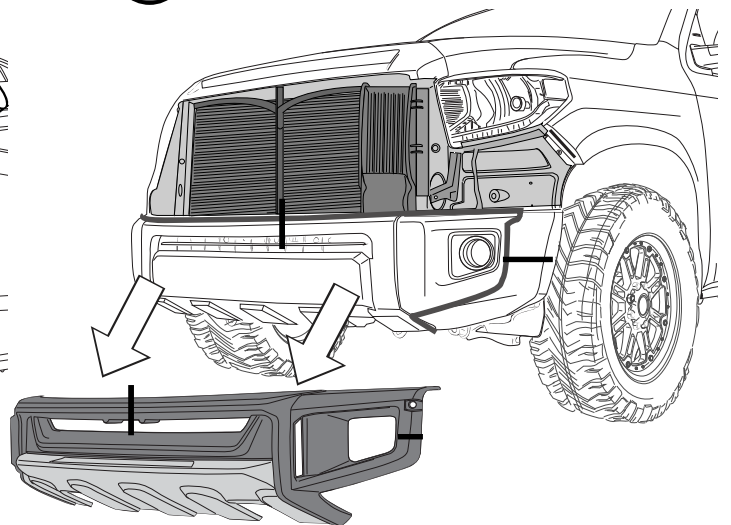
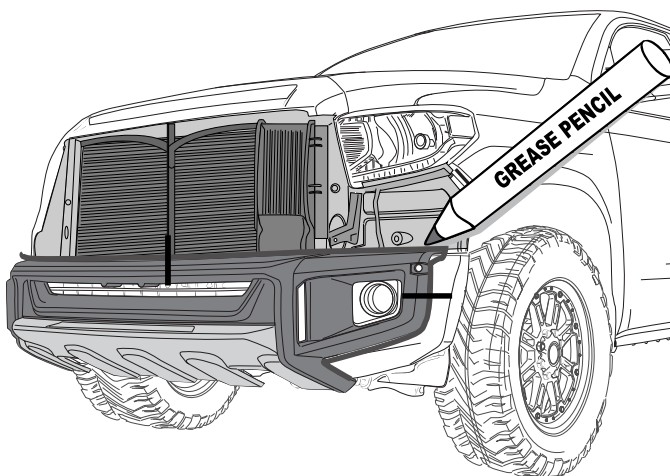

DRAW CENTER HASH MARK WITH GREASE PENCIL ON FRONT BUMPER AND SHEET METAL, THIS WILL ENSURE FRONT BUMPER WILL BE CENTERED TO GREASE PENCIL OUTLINE.



CID DESIGN

SUPER RIM
TRUCK ACCESSORIES POWERED BY KIMBERLIN USA

TOYOTA - TUNDRA 2015

INSTALLATION MANUAL

8 MOUNT ON BUMPER

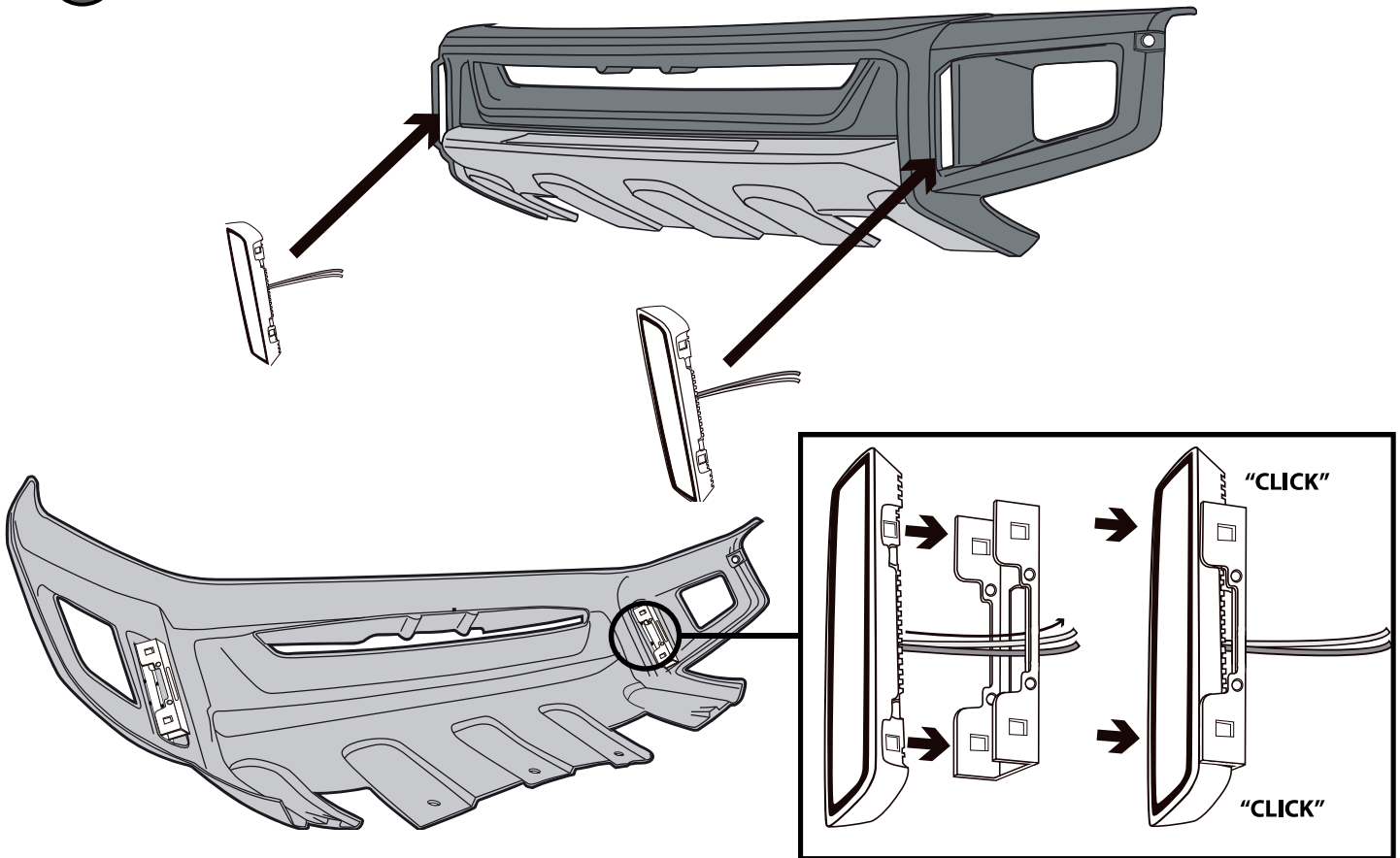

9 PEEL



WARM SURFACES WITH HEAT GUN IF SURFACE TEMPERATURE IS TOO COLD.

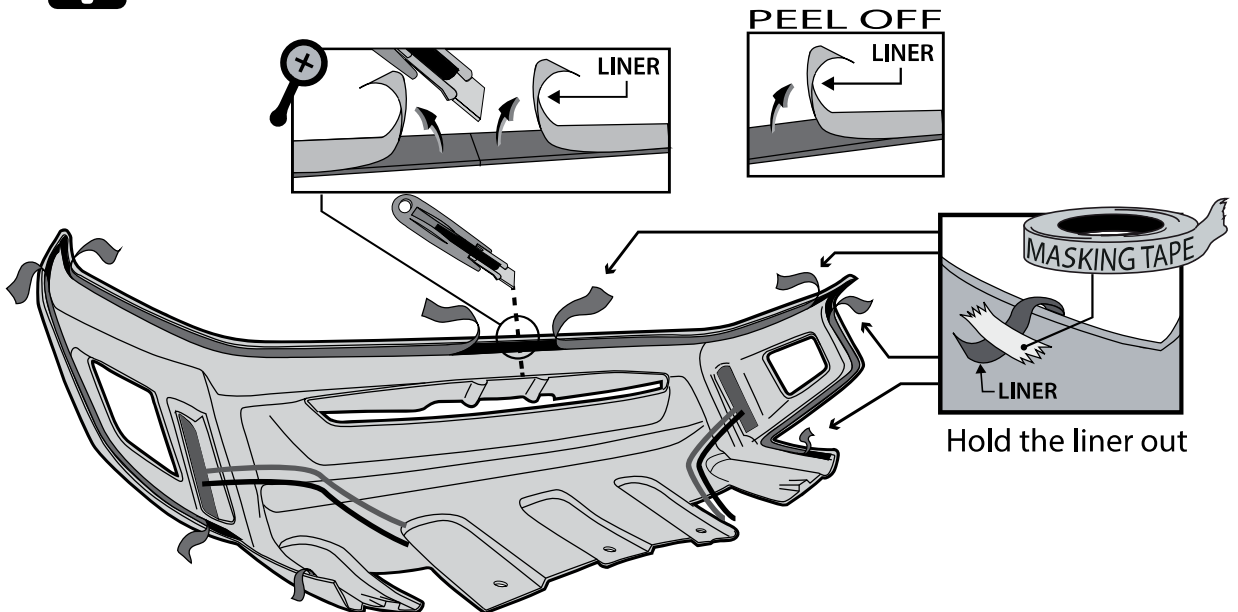



CID DESIGN

SUPER RIM
TRUCK ACCESSORIES POWERED BY INNOVATION USA

TOYOTA - TUNDRA 2015

INSTALLATION MANUAL

10 APPLY ADHESIVE

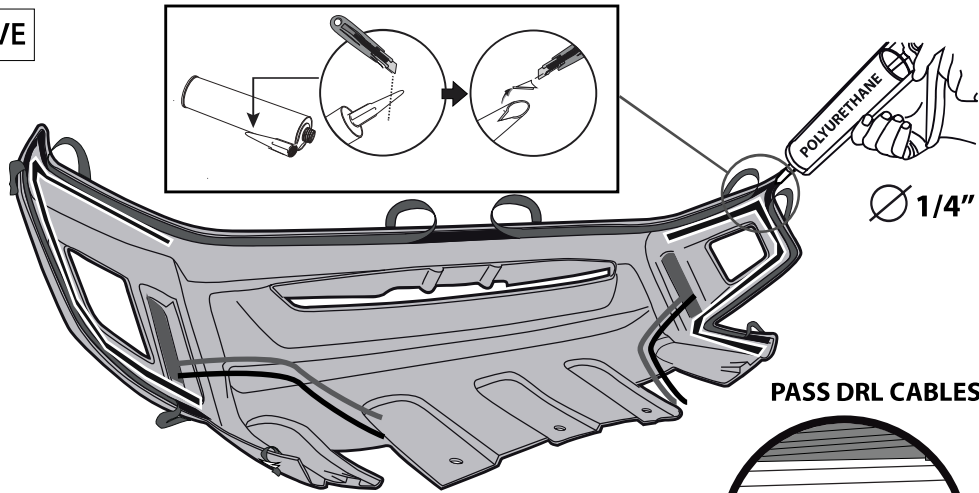

! FIRST CLEAN ALL OVER THE APPLICATION AREA WITH ACETONE

11 ADHESION PROMOTER

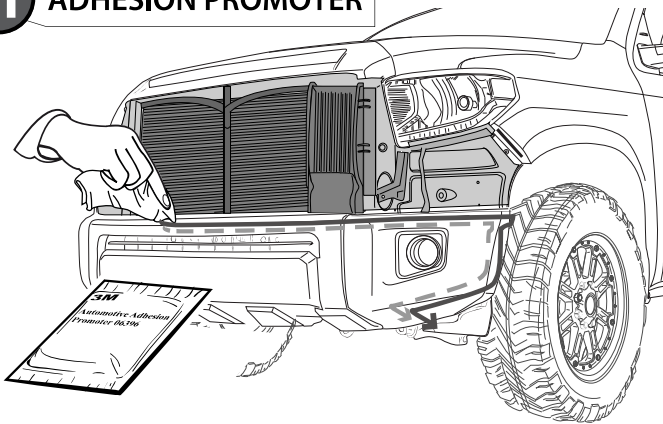

12 PLACE

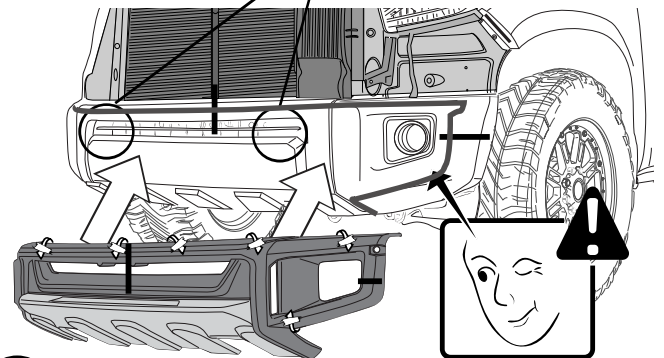

13 PLACE BLACKOUT

IF THE VEHICLE HAS SENSORS PLACE BLACKOUT

IF THE VEHICLE DOES NOT HAS SENSORS MARK AND PLACE BLACKOUT

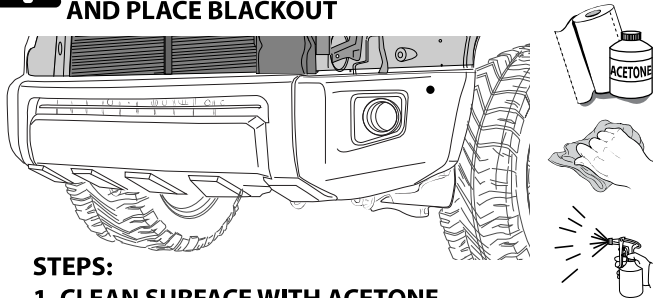

STEPS:

1. CLEAN SURFACE WITH ACETONE
2. APPLY WATER TO FRONT BUMPER AND STICKER
3. PLACE & PRESS

14 REMOVE LINER

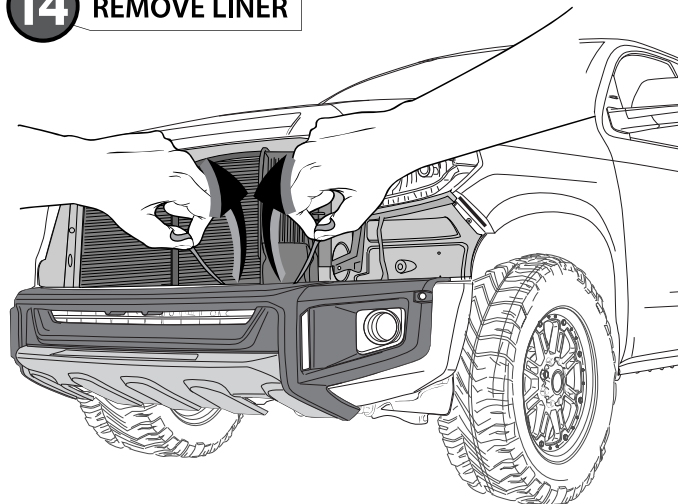

! A full surface contact between tape and substrate is decisive for good adhesion performance. Contact is achieved by applying pressure. In practice a pressure between 40 and 50 N/cm² is usually needed and an application temperature between 25 and 45 °C or 77 and 113 °F is also necessary. During application, add-on parts and tapes must have the similar temperature.



CID DESIGN

SUPER RIM
TRUCK ACCESSORIES POWERED BY INNOVATION USA

TOYOTA - TUNDRA 2015

INSTALLATION MANUAL

15 PRESS

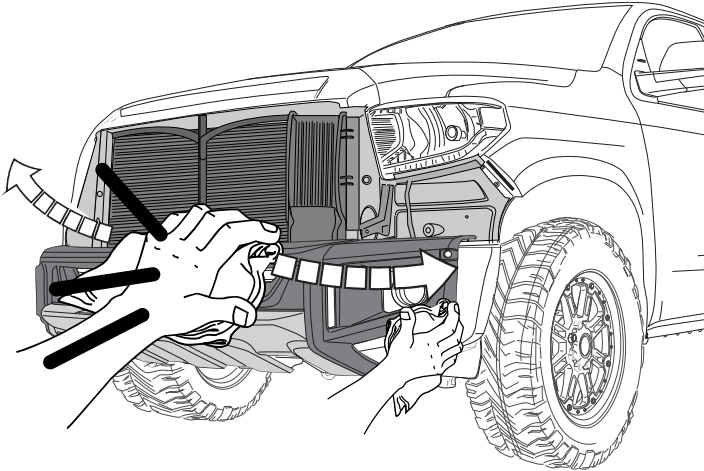

16 DRILL

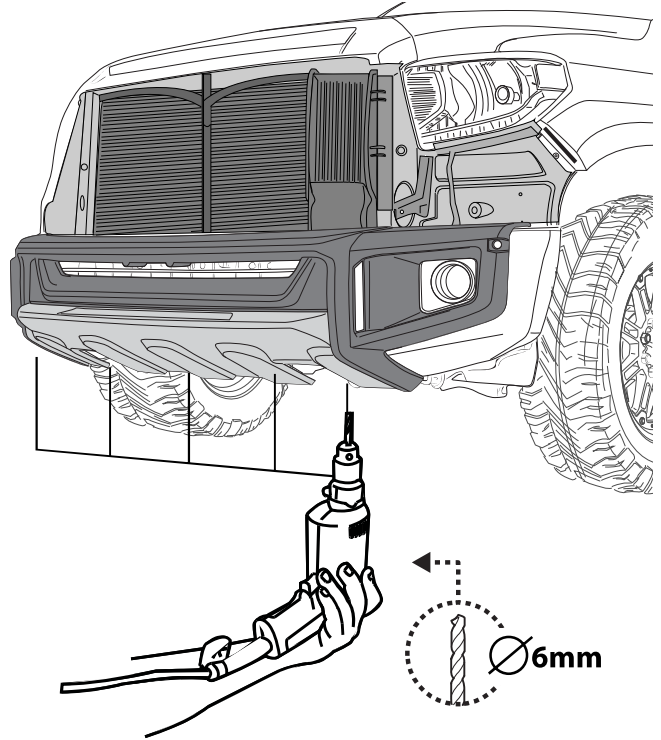

17 PLACE PUSH PINS

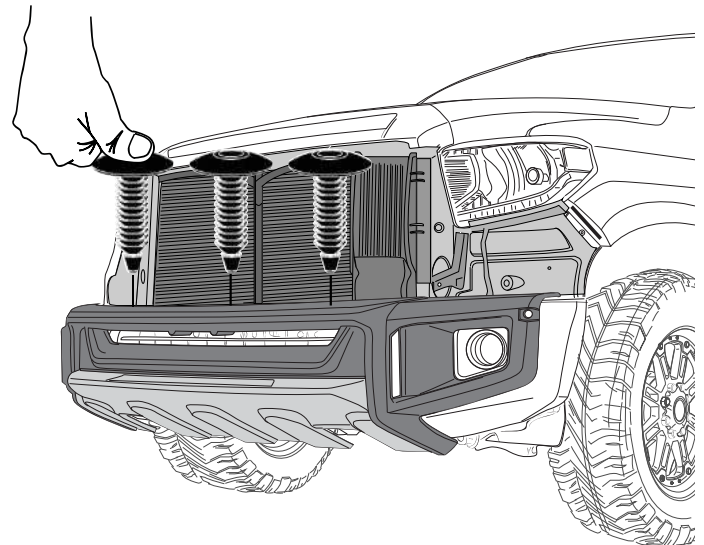
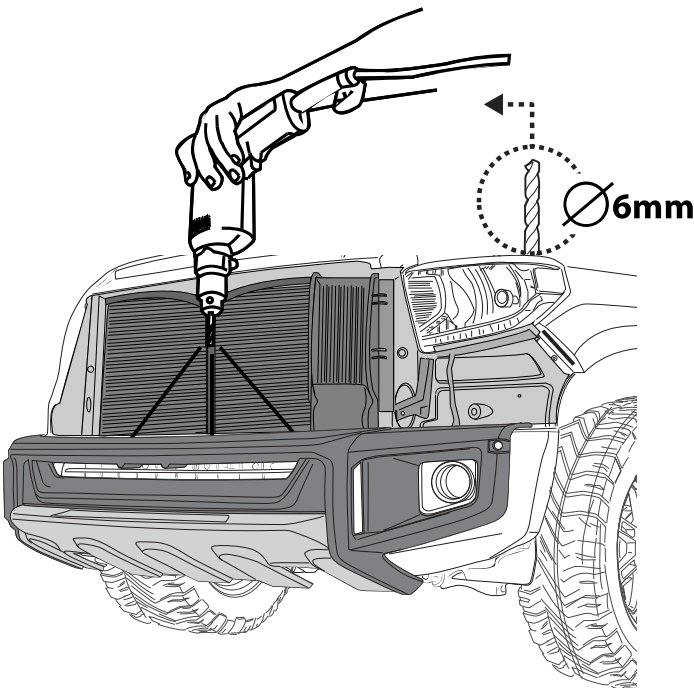



CID DESIGN

SUPER RIM
TRUCK ACCESSORIES POWERED BY INNOVATION USA

TOYOTA - TUNDRA 2015

INSTALLATION MANUAL

18 CONNECT CABLES TO BATTERY

SECURE CABLES

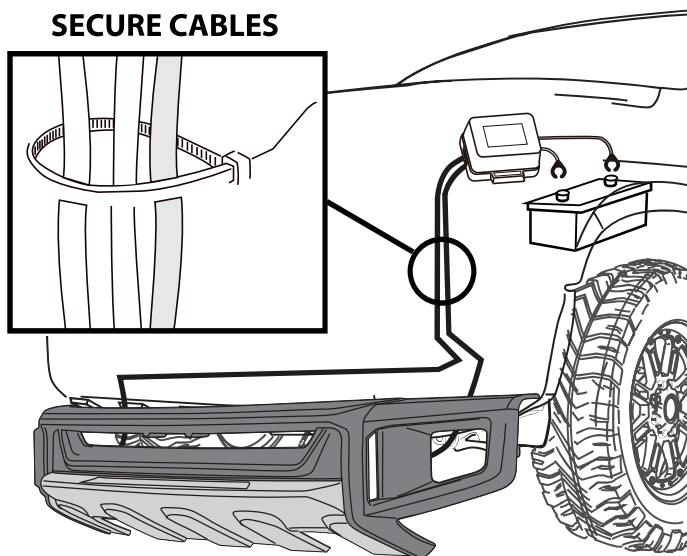
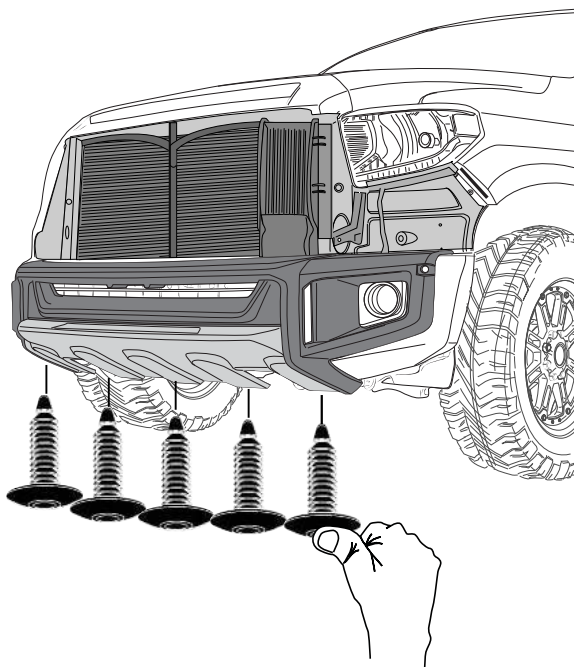

19 MOUNT GRILLE AND PLASTIC COVERS

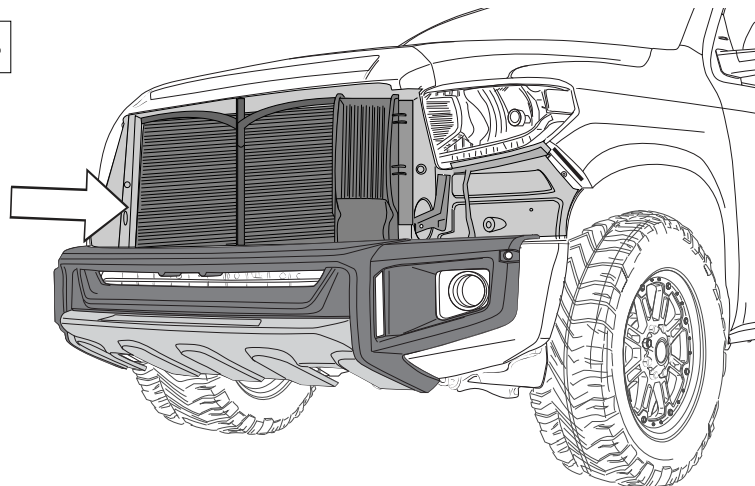
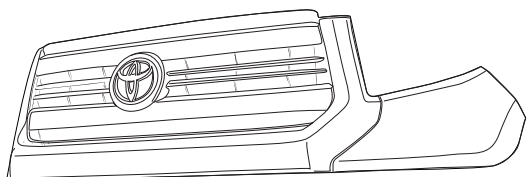

20 CLEAN OFF GREASE PENCIL MARK

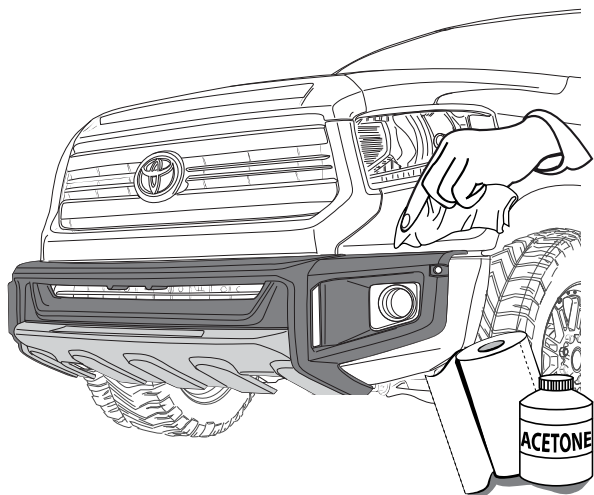

INSTALLED PARTS

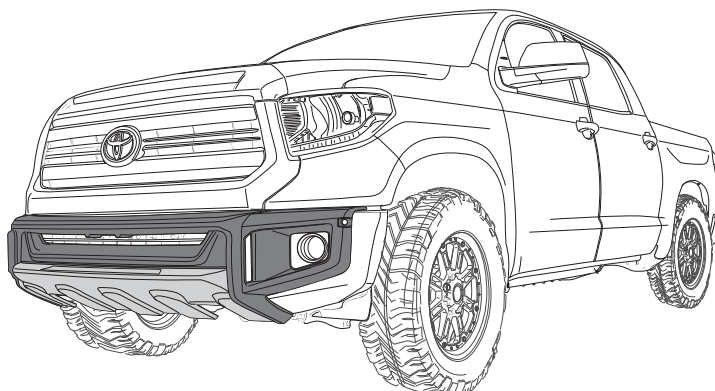



CID DESIGN

SUPER RIM
TRUCK ACCESSORIES POWERED BY AMERICAN USA

TOYOTA - TUNDRA 2015

INSTALLATION MANUAL

HOOD SCOOP TUNDRA

PART # : 1129CPNUTO01A01

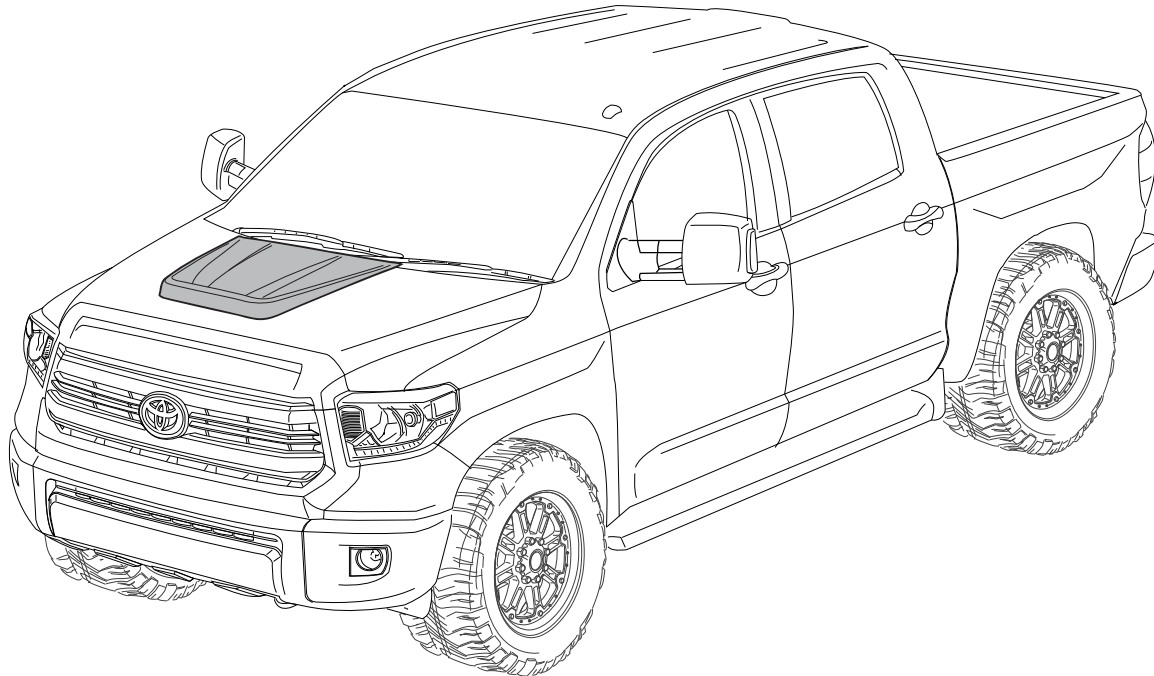

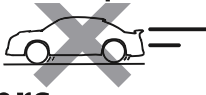
<p>DO NOT WASH CAR</p>  <p>24 hrs</p>	<p>DRIVE SLOWLY 25 mph max</p> 
--	---



READ CAREFULLY BEFORE INSTALLATION

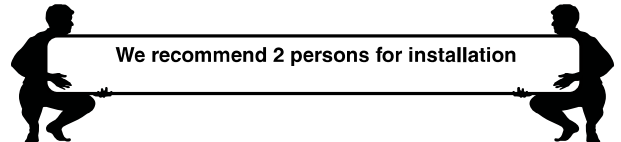

We recommend 2 persons for installation



WARNING!! Do not install Hood Scoops or other Body Parts directly Over Wrapped areas. Before installation of the parts , you must leave at least a 1/4" (6mm) perimetral clearance "Free from Vinyl" surrounding the part, before Part installation.



WARNING!! Do not install Hood Scoops Over Vinyl or Over Plastic Stripes on the Hood: 3M Adhesive Tape and PUR Adhesive must always be in contact with the Sheet Metal of the vehicle.



WARNING!! Rust Prevention Oils and other Petrol Based Anti Rust Treatments for Vehicles may affect 3M's Double Adhesive Tape and Polyurethane Adhesive performance!



CID DESIGN

SUPER RIM
TRUCK ACCESSORIES POWERED BY INNOVATION USA

TOYOTA - TUNDRA 2015

INSTALLATION MANUAL





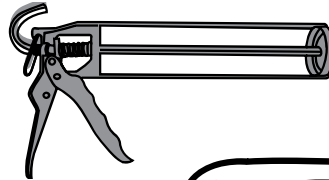

TOOLS

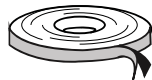
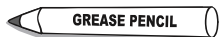

CHECK LIST

*Already installed in the part

ITEM	DESCRIPTION	DRAWING	AMOUNT
A	* VHB TAPE		Included in the parts
B	GREASE PENCIL		1 pc
C	POLYURETHANE ADHESIVE		1 pc
D	BLACKOUT		1 pc
E	ECO DOME		1 pc



CID DESIGN

SUPER RIM
TRUCK ACCESSORIES POWERED BY INNOVATION USA

TOYOTA - TUNDRA 2015

INSTALLATION MANUAL

WASH WITH WATER, DETERGENT AND SOFT CLOTH OR SPONGE

1 PRE-MOUNT Make sure the parts fit each other before peeling the tape.

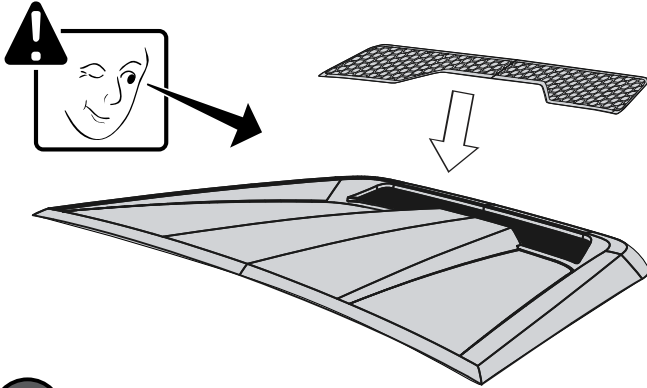

2 CLEAN THE SCOOP

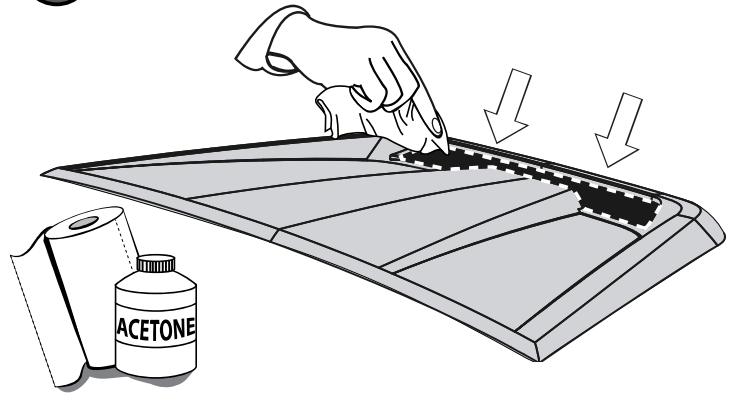

3 ADHESION PROMOTER

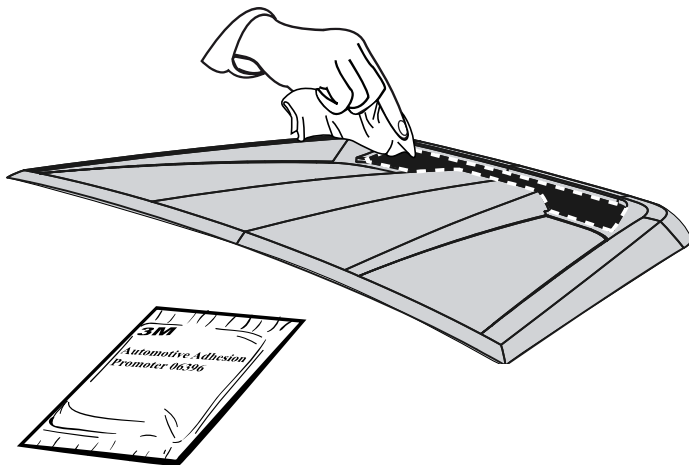

4 PEEL

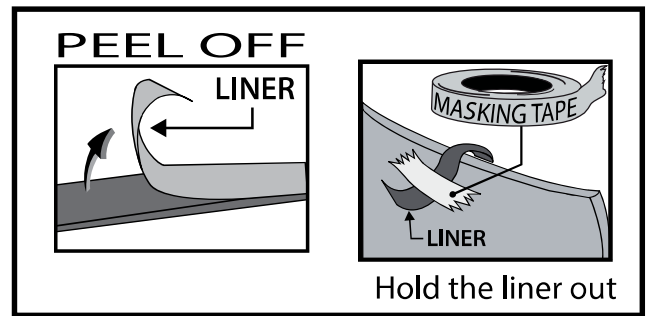
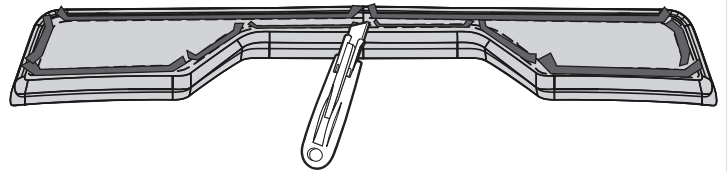

A full surface contact between tape and substrate is decisive for good adhesion performance. Contact is achieved by applying pressure. In practice a pressure between 40 and 50 N/cm² is usually needed and an application temperature between 25 and 45 °C or 77 and 113 °F is also necessary. During application, add-on parts and tapes must have the similar temperature.

5 PLACE

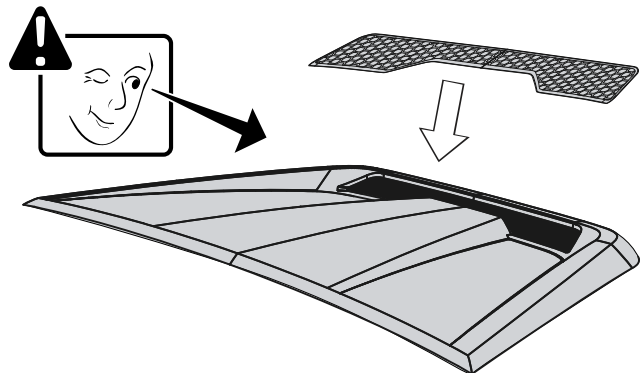



CID DESIGN

SUPER RIM
TRUCK ACCESSORIES POWERED BY INNOVATION USA

TOYOTA - TUNDRA 2015

INSTALLATION MANUAL

6 REMOVE LINER

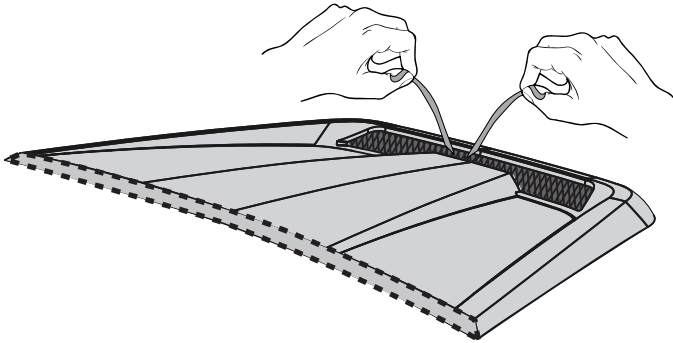

7 PRESS

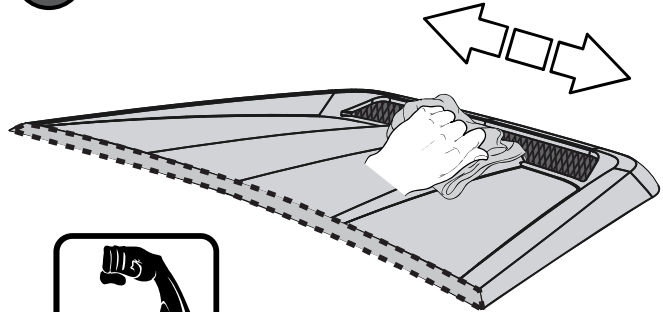

40-50 N/cm²

8 PRE-MOUNT BLACKOUT

STEPS:

1. CLEAN SURFACE WITH ACETONE
2. APPLY WATER TO SCOOP AND STICKER
3. PLACE & PRESS

THIS ELIMINATE GLARE CAUSED BY REFLECTED LIGHT.

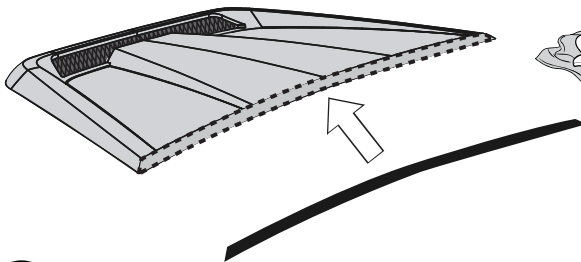

9 PLACE BLACKOUT

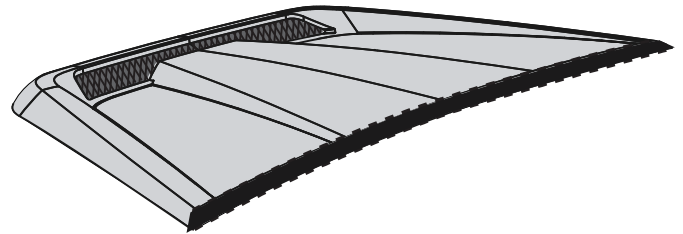

10 CLEAN

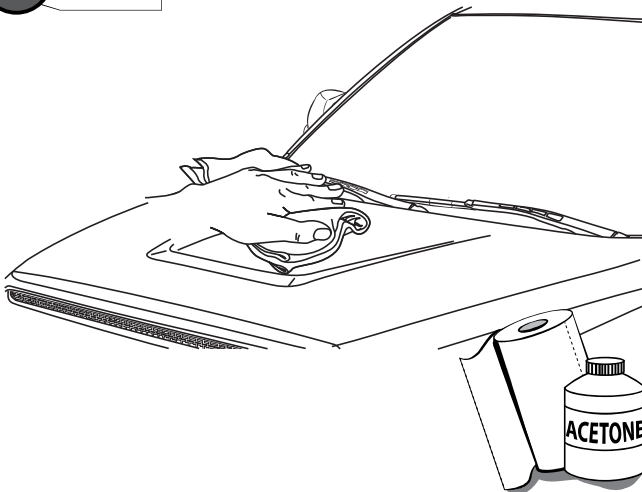

11 PRE-MOUNT

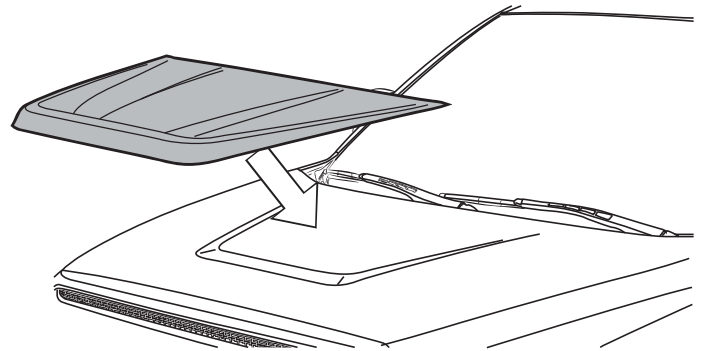



CID DESIGN

SUPER RIM
TRUCK ACCESSORIES POWERED BY KIMBERLY USA

TOYOTA - TUNDRA 2015

INSTALLATION MANUAL

12 ALIGN & CENTER

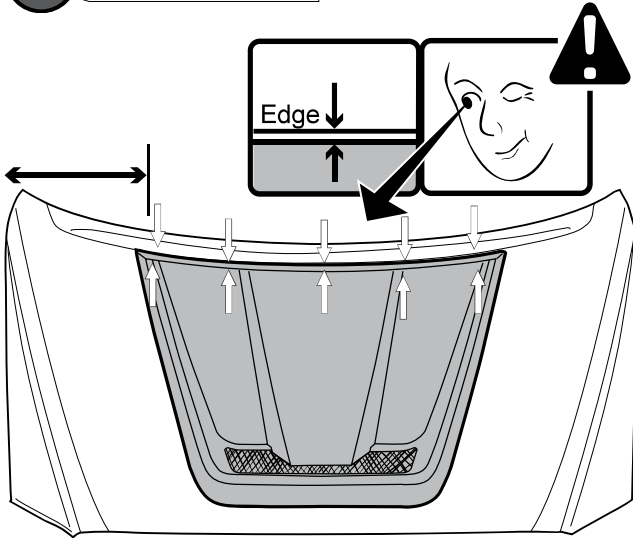

13 MARK

! HASH MARKS

DRAW CENTER HASH MARK WITH GREASE PENCIL ON HOOD SCOOP AND SHEET METAL, THIS WILL ENSURE HOOD SCOOP WILL BE CENTERED TO GREASE PENCIL OUTLINE.

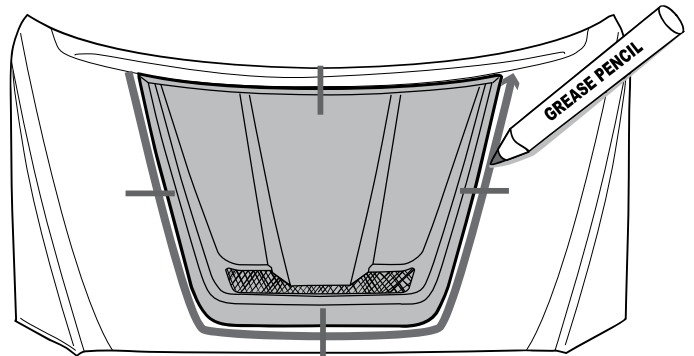

14 PEEL



WARM SURFACES WITH HEAT GUN IF SURFACE TEMPERATURE IS TOO COLD.

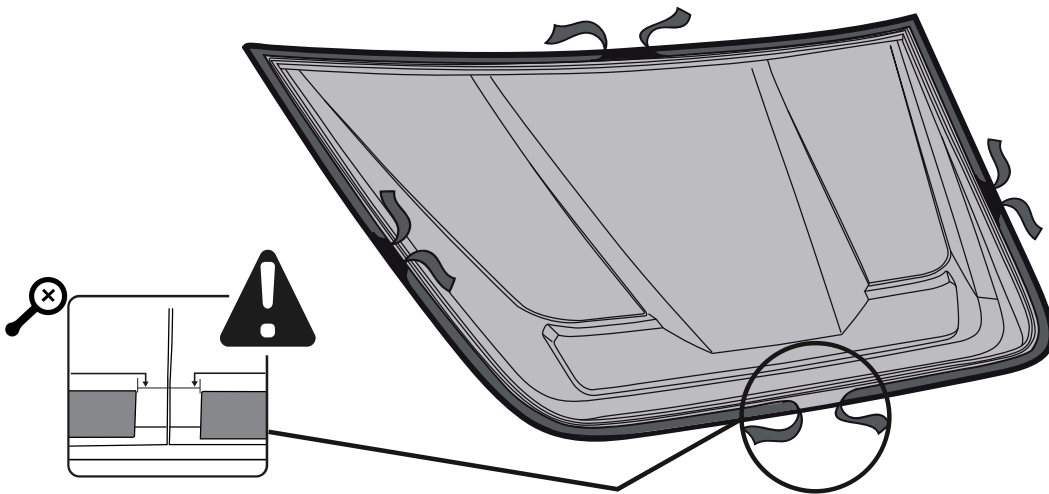

PEEL OFF

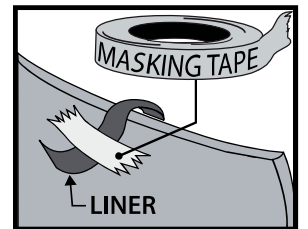
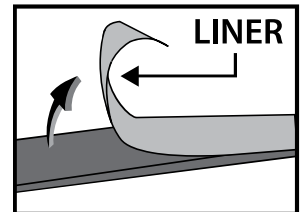

Hold the liner out



A full surface contact between tape and substrate is decisive for good adhesion performance. Contact is achieved by applying pressure. In practice a pressure between 40 and 50 N/cm² is usually needed and an application temperature between 25 and 45 °C or 77 and 113 °F is also necessary. During application, add-on parts and tapes must have the similar temperature.



CID DESIGN

SUPER RIM
TRUCK ACCESSORIES POWERED BY INNOVATION USA

TOYOTA - TUNDRA 2015

INSTALLATION MANUAL

15 APPLY ADHESIVE

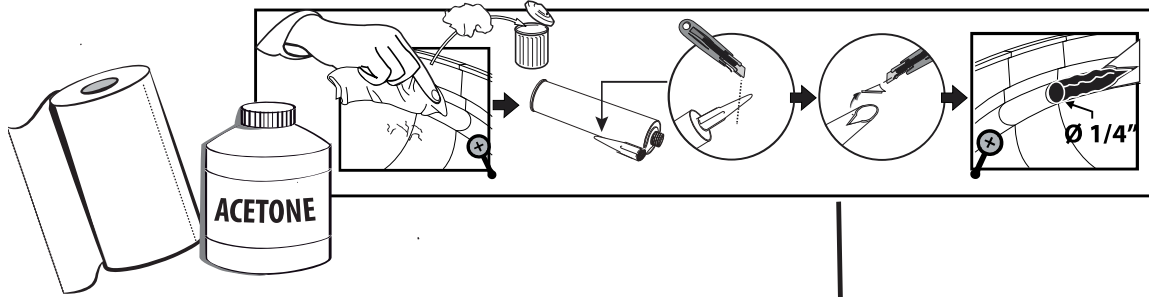

! USE ACETONE TO CLEAN

WATER DRAIN
KEEP OPEN WITHOUT
ADHESIVE

Keep the indicated
separation 1"

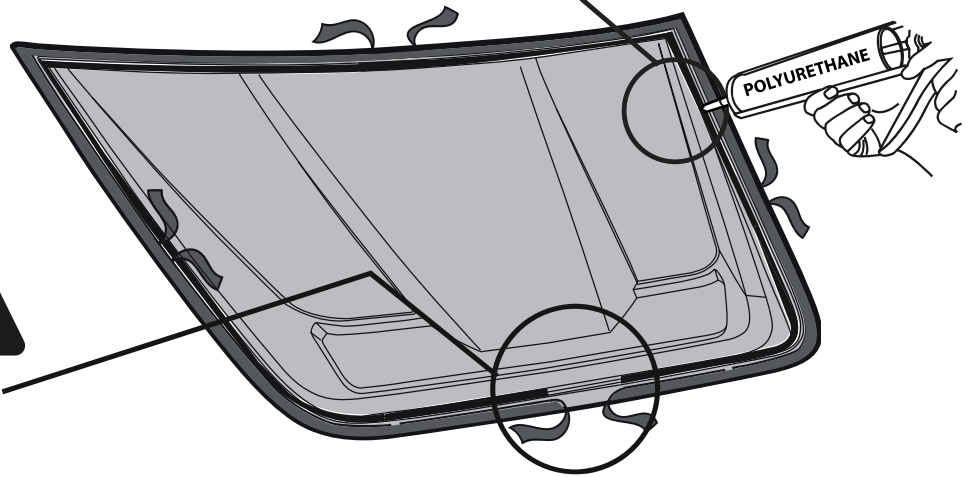
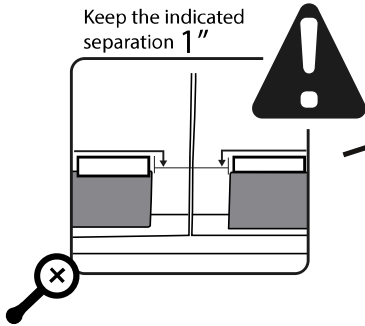

16 PLACE

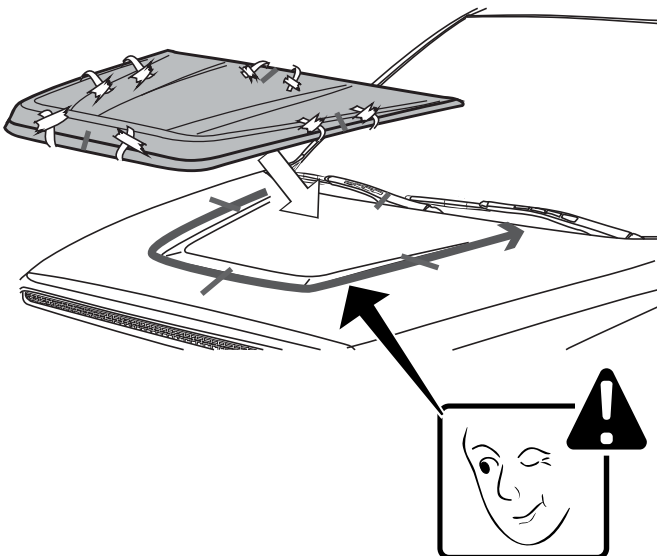

17 REMOVE LINER

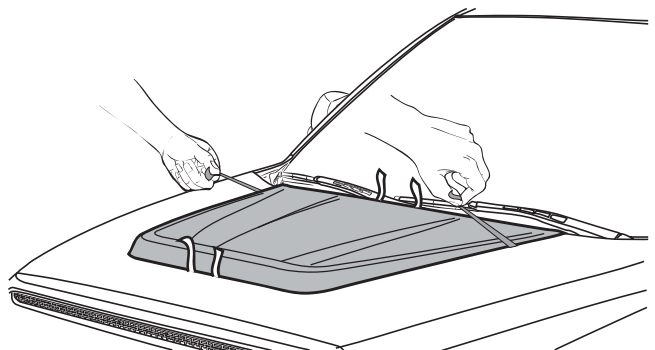



CID DESIGN

SUPER RIM
TRUCK ACCESSORIES POWERED BY KIMBERLY USA

TOYOTA - TUNDRA 2015

INSTALLATION MANUAL

18 PRESS

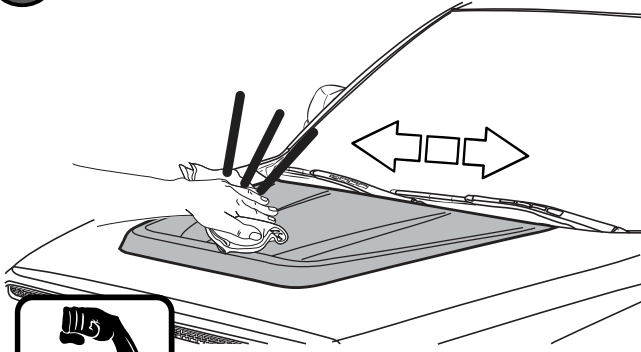

40-50 N/cm²

19 CLEAN OFF GREASE PENCIL MARK

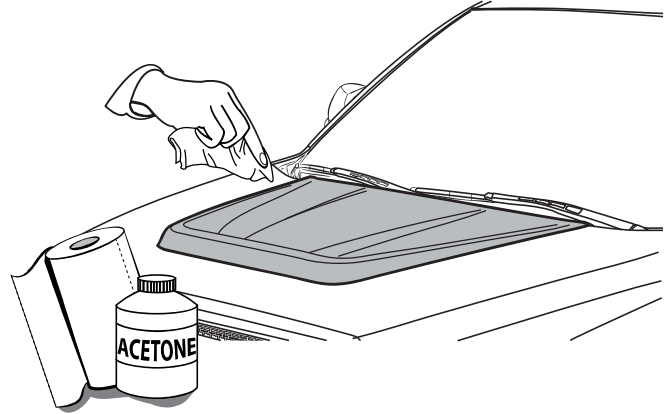

INSTALLED PART

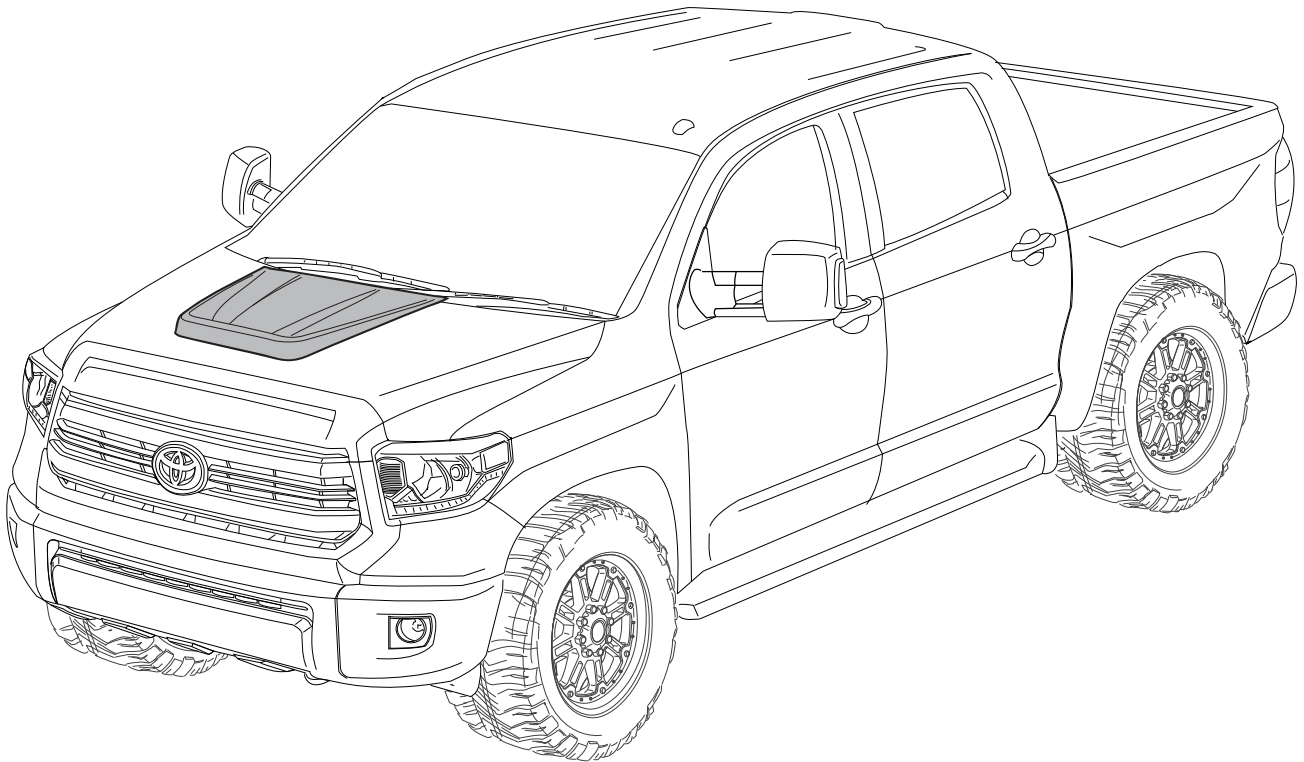



CID DESIGN

SUPER RIM®
TRUCK ACCESSORIES POWERED BY AMERICAN USA



TOYOTA - TUNDRA 2015

INSTALLATION MANUAL

TAILGATE APPLIQUE TUNDRA

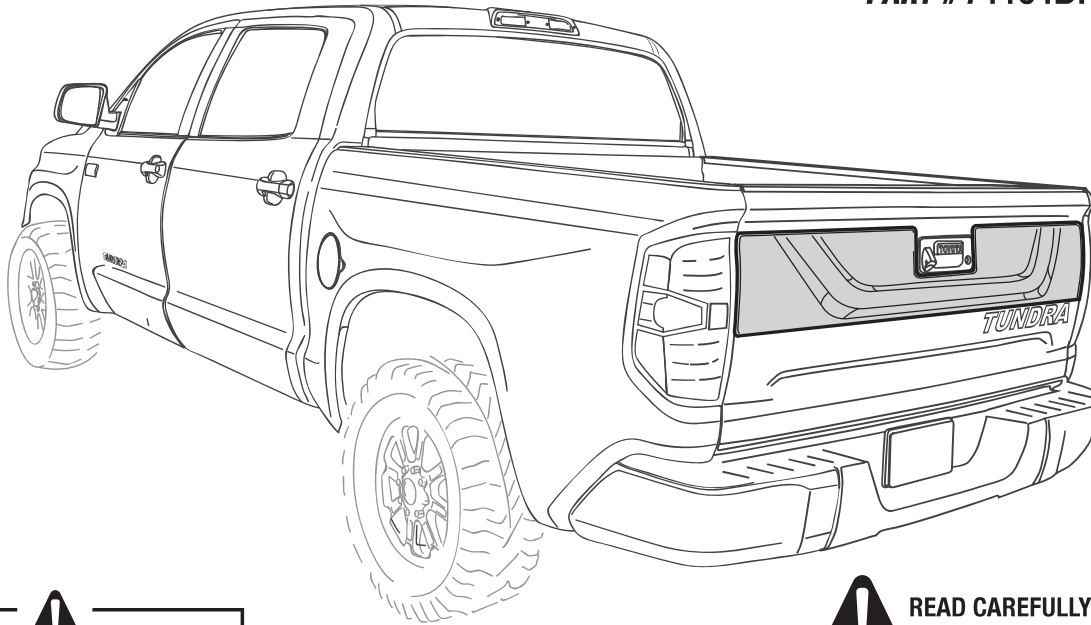
PART # : 1104DNTUTO01A21



 **55 mph max**
 **24 hrs** 

 **READ CAREFULLY BEFORE INSTALLATION**

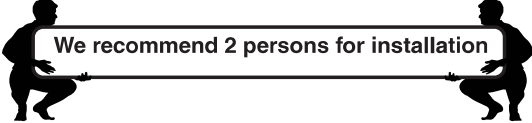



 **We recommend 2 persons for installation**

TOOLS



CHECK LIST

*Already installed in the part

ITEM	DESCRIPTION	DRAWING	AMOUNT
A	* VHB TAPE		Included in the parts
B	GREASE PENCIL		1 pc
C	ADHESION PROMOTER		1 pc
D	ECO DOME		1 pc



CID DESIGN

SUPER RIM
TRUCK ACCESSORIES POWERED BY INNOVATION USA

TOYOTA - TUNDRA 2015

INSTALLATION MANUAL

1 CLEAN

! WASH WITH WATER, DETERGENT AND SOFT CLOTH OR SPONGE

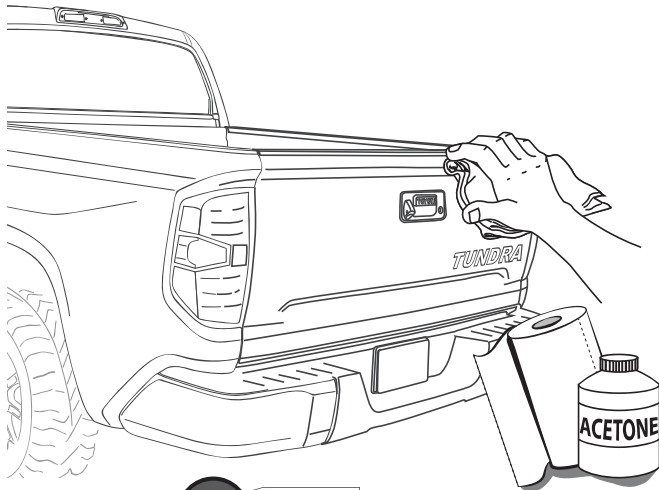

2 PRE-MOUNT

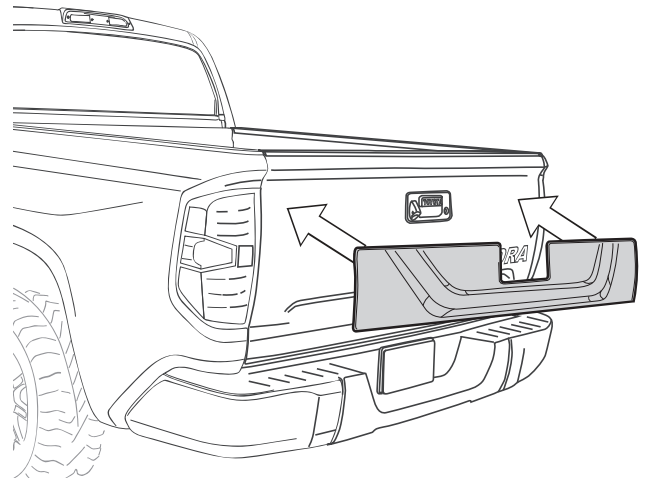

3 MARK

! HASH MARKS

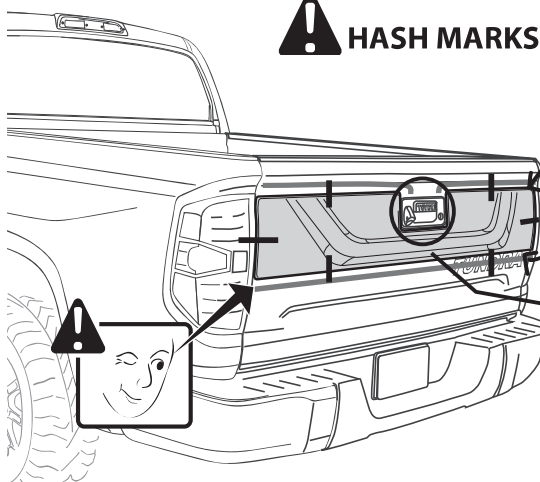

ALIGN & CENTER

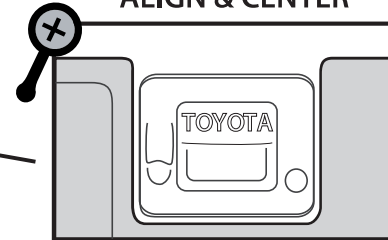

4 ADHESION PROMOTER

! FIRST CLEAN ALL OVER THE APPLICATION AREA WITH ACETONE

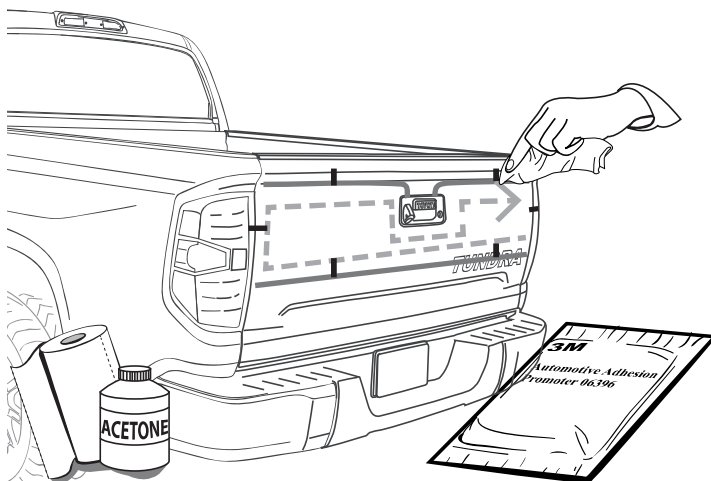

! A full surface contact between tape and substrate is decisive for good adhesion performance. Contact is achieved by applying pressure. In practice a pressure between 40 and 50 N/cm² is usually needed and an application temperature between 25 and 45 °C or 77 and 113 °F is also necessary. During application, add-on parts and tapes must have the similar temperature.



CID DESIGN

SUPER RIM
TRUCK ACCESSORIES POWERED BY INNOVATION USA

TOYOTA - TUNDRA 2015

INSTALLATION MANUAL

5 PEEL WARM SURFACES WITH HEAT GUN IF SURFACE TEMPERATURE IS TOO COLD.

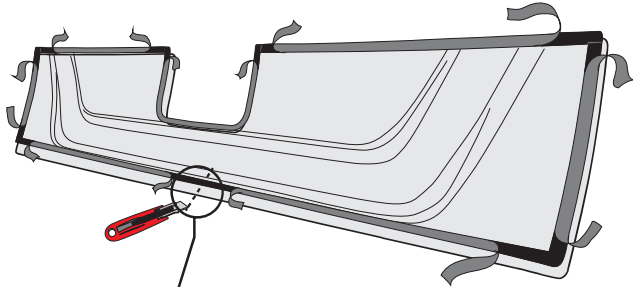

PEEL OFF
Hold the liner out

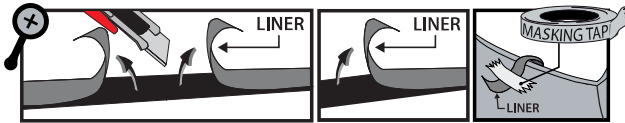

7 REMOVE LINER

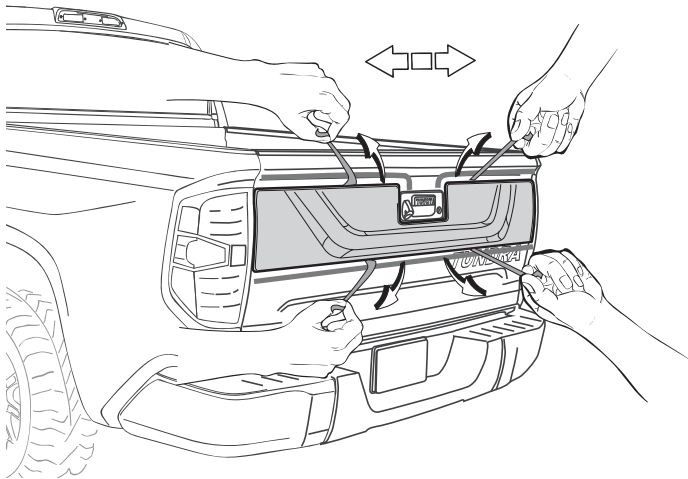

6 PLACE

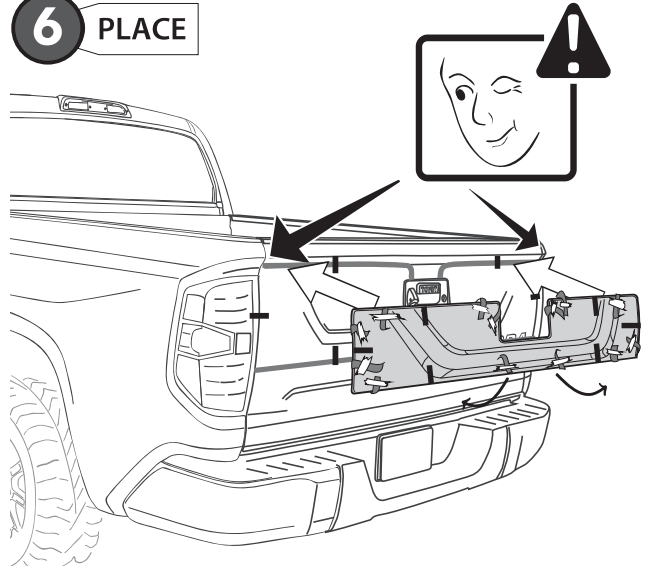

8 PRESS

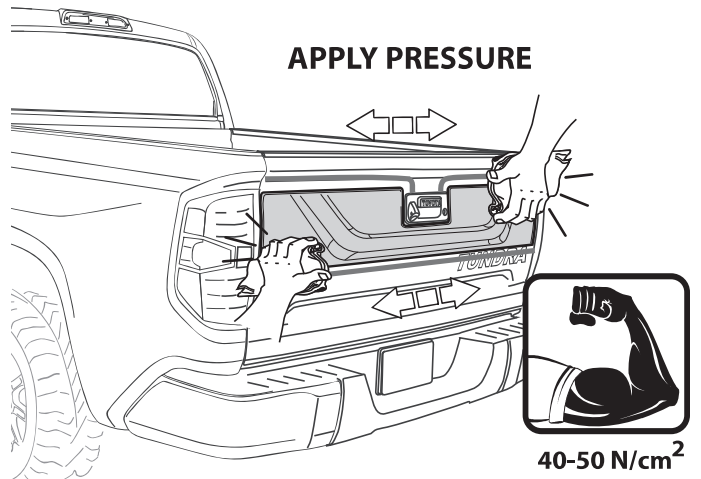

9 CLEAN OFF GREASE PENCIL MARK

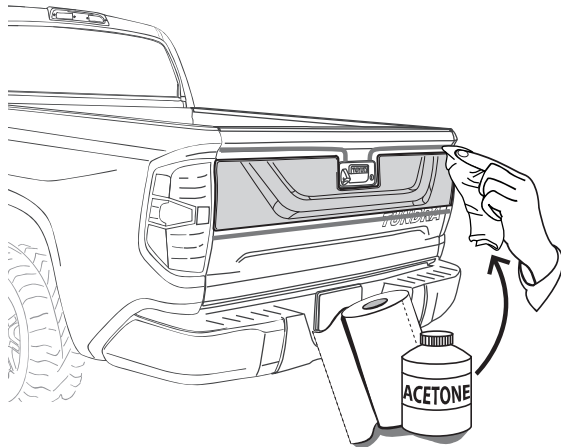

INSTALLED PART

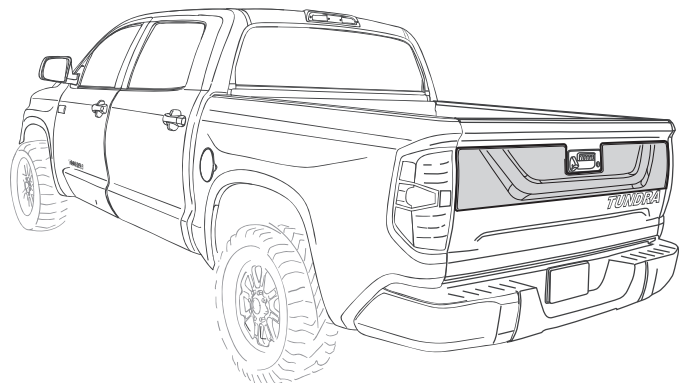



CID DESIGN

SUPER RIM
TRUCK ACCESSORIES POWERED BY KIMBERLY USA

TOYOTA - TUNDRA 2015

INSTALLATION MANUAL

TAILGATE SPOILER TUNDRA 2015

PART # : 1102DNTUTO01A15

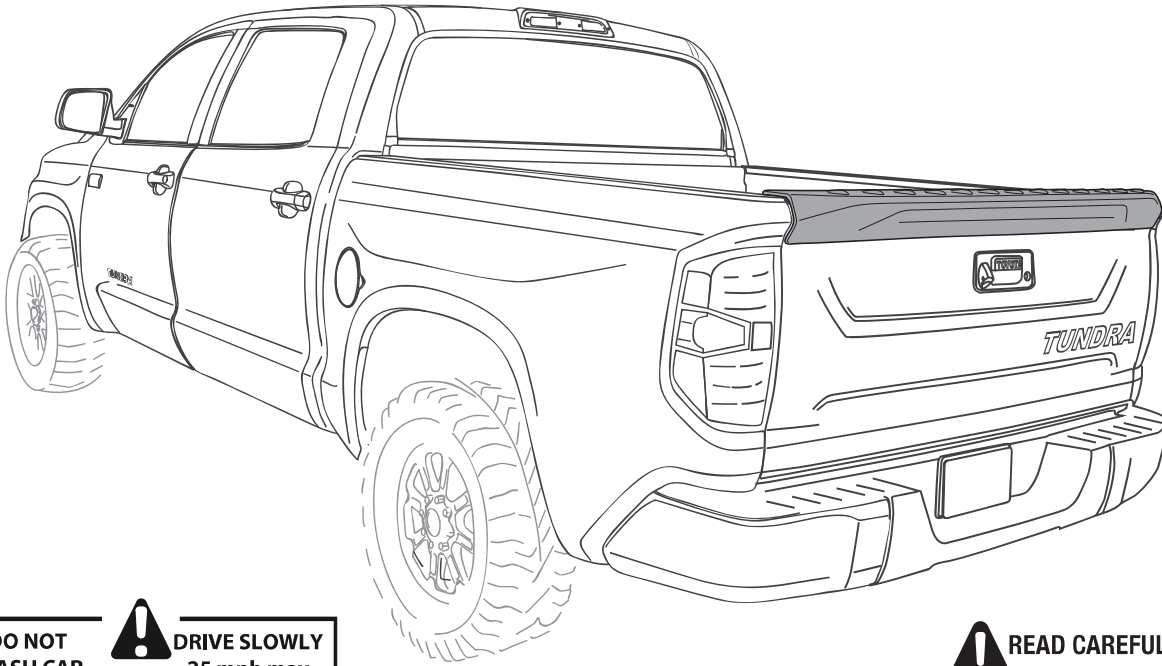

DO NOT WASH CAR  **24 hrs**

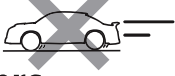
DRIVE SLOWLY 25 mph max 

READ CAREFULLY BEFORE INSTALLATION

We recommend 2 persons for installation





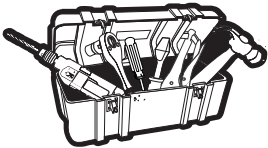

TOOLS



CHECK LIST

*Already installed in the part

ITEM	DESCRIPTION	DRAWING	AMOUNT
A	* VHB TAPE		Included in the parts
B	GREASE PENCIL		1 pc
C	ADHESION PROMOTER		1 pc
D	ECO DOME		1 pc



CID DESIGN

SUPER RIM
TRUCK ACCESSORIES POWERED BY INNOVATION USA

TOYOTA - TUNDRA 2015

INSTALLATION MANUAL

1 CLEAN

! WASH WITH WATER, DETERGENT AND SOFT CLOTH OR SPONGE

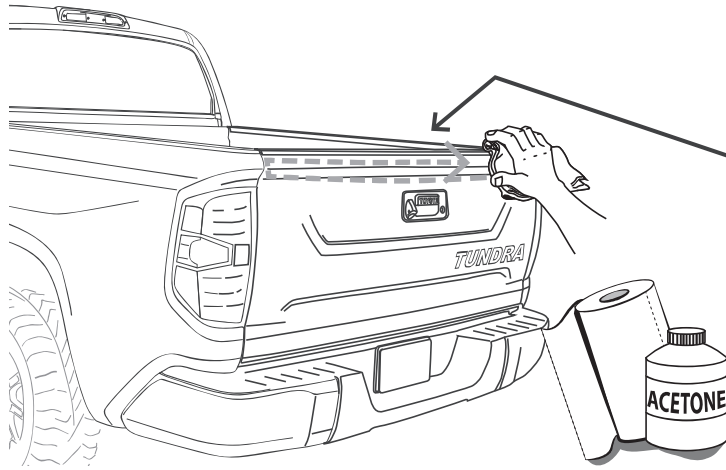

IMPORTANT

ENSURE THE SURFACES ARE COMPLETELY CLEAN BEFORE INSTALLING

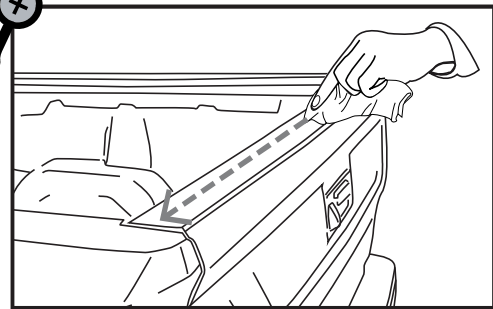

2 PRE-MOUNT

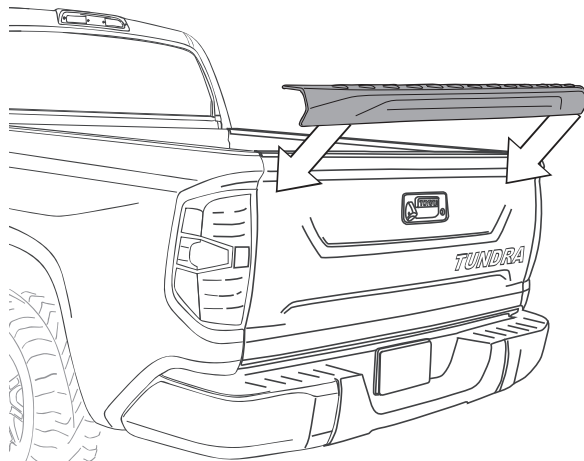

3 MARK

LEAVE APPROXIMATELY 1/8" FROM THE EDGE, ON BOTH SIDES

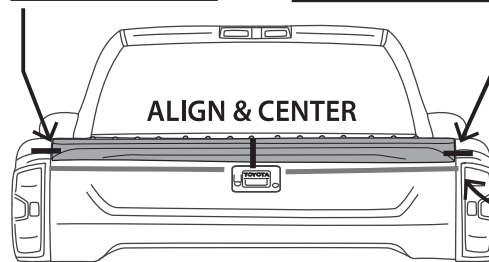
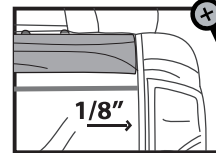
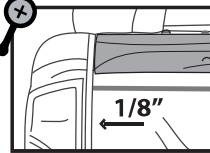

ALIGN & CENTER



HASH MARKS

DRAW CENTER HASH MARK WITH GREASE PENCIL ON SPOILER AND SHEET METAL, THIS WILL ENSURE SPOILER WILL BE CENTERED TO GREASE PENCIL OUTLINE.

4 ADHESION PROMOTER

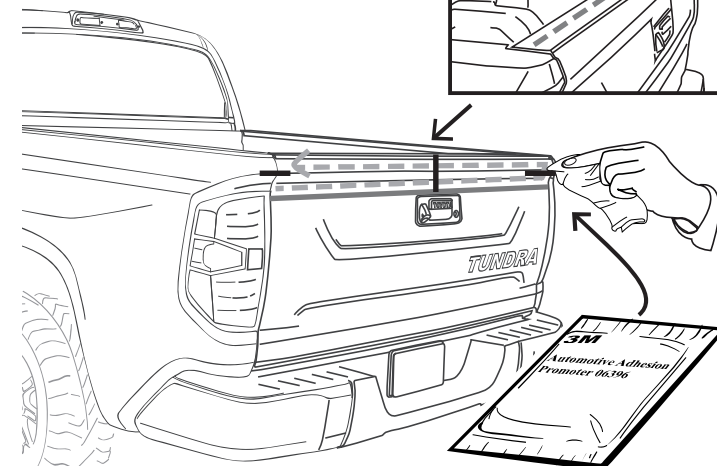
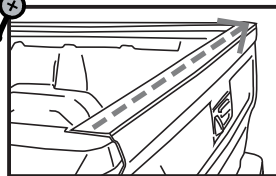

FIRST CLEAN ALL OVER THE APPLICATION AREA WITH ACETONE



A full surface contact between tape and substrate is decisive for good adhesion performance. Contact is achieved by applying pressure. In practice a pressure between 40 and 50 N/cm² is usually needed and an application temperature between 25 and 45 °C or 77 and 113 °F is also necessary. During application, add-on parts and tapes must have the similar temperature.



CID DESIGN

SUPER RIM
TRUCK ACCESSORIES POWERED BY INNOVATION USA

TOYOTA - TUNDRA 2015

INSTALLATION MANUAL

5 PEEL

PEEL OFF
Hold the liner out

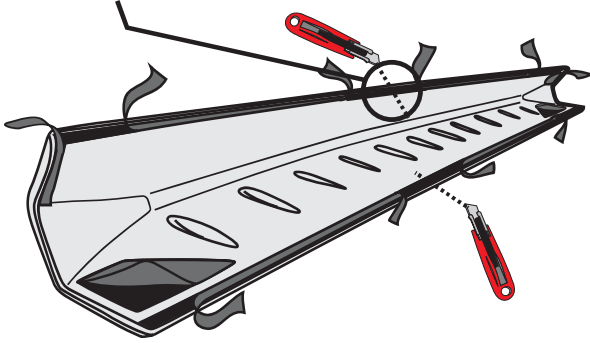
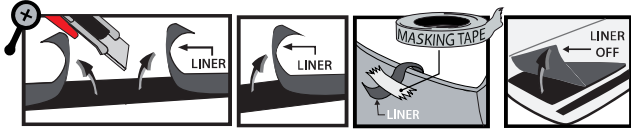

! WARM SURFACES WITH HEAT GUN IF SURFACE TEMPERATURE IS TOO COLD.

7 REMOVE LINER

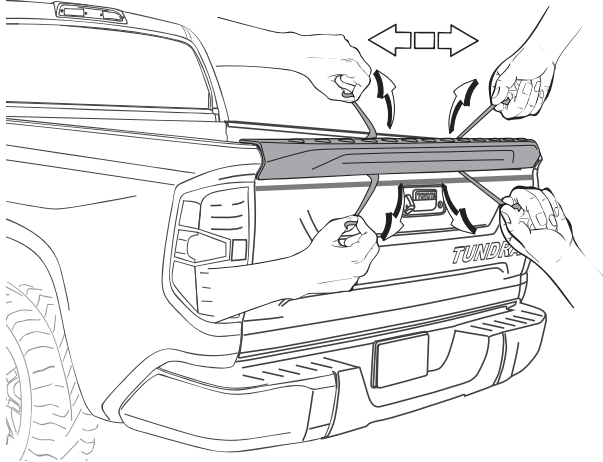

8 PRESS

APPLY PRESSURE

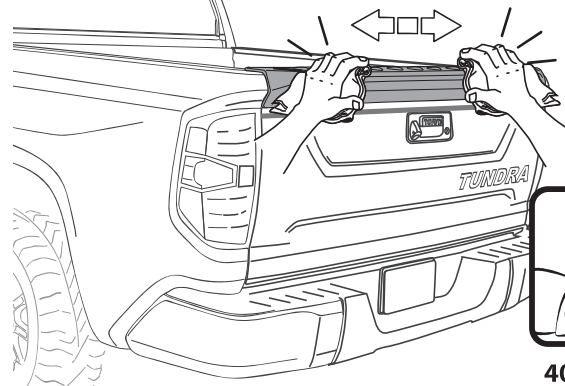

9 CLEAN OFF GREASE PENCIL MARK

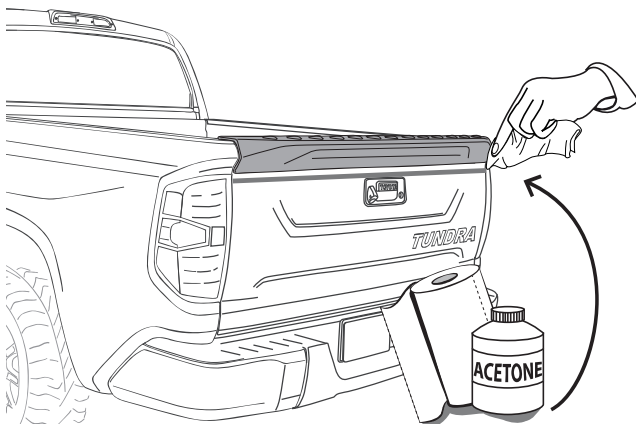

INSTALLED PART

