



**AMERICAN FORGE & FOUNDRY, INC.™**

## **10 TON LONG CHASSIS AIR / HYDRAULIC JACK**

Model 3135

The AFF 3135 - 10 Ton Service Jack with its thick walled frame and added versatility of having an air motor assist make this a must for any Heavy Duty Truck Shop.

- Long 61" body for easier lifting of vehicles with long overhangs
- Extra-wide stance for additional stability
- Integrated Descent Control Release Valving ensures a slow safe lowering of the load.
- Operates at 115-200 PSI, 7.8 cubic feet per minute
- Low Height: 7"
- High Height: 23"
- Front Width: 13"
- Rear Width: 18"
- Shipping Weight: 387 lbs.



### **RELATED PRODUCTS**



**Model 992**  
2 Drawer Work Bench



**Model 3140**  
20 Ton Long Chassis Service Jack



**Model 3700**  
Clutch Jack



# MODEL 3135 - 10 TON FLOOR JACK

PART ORDER NUMBER	KIT DESCRIPTION	KIT INCLUDES	
		REF. #	DESCRIPTION
3135KHU	HYDRAULIC UNIT	3.1	FILTER
		3.2	WASHER
		3.3	OUTSIDE TUBE
		3.4	WASHER
		3.5	VALVE SEAT
		3.6	NEEDLE
		3.7	WIRE
		3.8	NUT
		3.9	SPRING
		3.10	SCREW ROD
		3.11	RUBBER RING
		3.12	RUBBER RING
		3.13	CYLINDER BODY
		3.14	COVER PLATE
		3.16	BOLT
		3.17	BOLT
		3.18	WASHER
		3.21	NUT
		3.22	CONNECTING BRUSH
		3.23	COTTER PIN
		3.24	CONNECTING ROD
		3.25	DRIVING ROD
		3.26	COTTER PIN
		3.27	PIN
3.28	PISTON ROD		
3.29	LOCKING NUT		
3.30	RING		
3.31	DUST RING		
3.32	SEAL RING		
3.33	DUST PROOF RING		
6.3	SEAL RING		
6.4	LARGE NUT		
6.4A	DUST PROOF RING		
6.5	RING		
6.6	WASHER		
6.7	BUSHING		
6.8	SEAL RING		
6.9	PISTON		
6.10	RUBBER CUP		
6.11	STOP RING		
6.12	SPRING		
6.13	PISTON ROD		
6.14	STEEL BALL		
6.15	PUSH NEEDLE		
6.16	VALVE SEAT		
6.20	OUTER BODY		
6.22	STEEL BALL		
6.23	SMALL PUSH ROD		
6.24	STEEL BALL		

continued

**\* ONLY PARTS WITH A "PART ORDER NUMBER" ARE AVAILABLE FOR SALE.  
DO NOT COPY OR DISTRIBUTE THIS MATERIAL WITHOUT PERMISSION OF AFF, INC.**



# MODEL 3135 - 10 TON FLOOR JACK

PART ORDER NUMBER	KIT DESCRIPTION	KIT INCLUDES	
		REF. #	DESCRIPTION
continued			
3135KHU	HYDRAULIC UNIT	6.25	LARGE BALL ROD
		6.26	WASHER
		6.27	BOLT
		6.29	VALVE SEAT
		6.30	SPRING
		6.32	SCREW
		6.33	SEAL RING
		6.34	SCREW
		6.35	WASHER
		6.36	STEEL BALL
		6.37	SPRING
		6.38	VALVE CORE
		6.39	STEEL BALL
6.40	SPRING		
6.41	WASHER		
6.42	SCREW		
3130K40	CASTER COMPLETE	4.1	COVER
		4.2	WHEEL COVER
		4.3	INJECTING OIL NOZZLE
		4.4	WASHER
		4.5	SCREW
		4.6	BEARING COVER
		4.7	STEEL BALL
		4.8	BEARING HOLDER
		4.9	WHEEL FORK
		4.10	WHEEL
		4.11	RIVET
3130K50	FRONT WHEEL COMPLETE	5.3	STOP RING
		5.4	WHEEL
		5.5	PRESSURE FILL PORT
		5.6	ROLLER
		5.7	STOP RING
		5.8	SPLIT RING
3130K17	HANDLE RETAINER	1.6	WASHER
		1.7	BOLT
3130K27	SPRING SET	2.7	PEDAL RETURN SPRING
		6.18	LIFT ARM RETURN SPRING
3135K366	AIR HOSE KIT	3.65	SPIRAL CLAMP RING
		3.66	RUBBER HOSE
		3.67	SPRING
		3.68	SPIRAL CLAMP RING
3130K71	SADDLE	7.1	SADDLE

**\* ONLY PARTS WITH A "PART ORDER NUMBER" ARE AVAILABLE FOR SALE.  
DO NOT COPY OR DISTRIBUTE THIS MATERIAL WITHOUT PERMISSION OF AFF, INC.**



# MODEL 3135 - 10 TON FLOOR JACK

PART		KIT INCLUDES			
ORDER NUMBER	KIT DESCRIPTION	REF. #	DESCRIPTION		
3130K29	CAP SET	2.1	FOOT PEDAL		
		2.2	CIRCLIP		
		2.4	FORK MEMBER		
		2.5	BUSH		
		2.6	BASE		
		2.8	PIN		
		2.9	CAP		
		2.10	SHAFT		
		2.11	SCREW		
		2.12	WASHER		
		2.13	WASHER		
		2.14	CLAMP RING		
		3135K371	AIR VALVE COMPLETE	3.69	UNION
				3.70	FILTER NOZZLE
3.71	CASE				
3.72	SPRING				
3.73	PIN				
3.74	PISTON ROD				
3.75	SEAL RING				
3.76	RUBBER RING				
3.77	RUBBER RING				
3.78	THROTTLE				
3.79	HANDLE COVER				
3.80	LOCKING SPRING				
3.81	UNION				

**\* ONLY PARTS WITH A "PART ORDER NUMBER" ARE AVAILABLE FOR SALE.  
DO NOT COPY OR DISTRIBUTE THIS MATERIAL WITHOUT PERMISSION OF AFF, INC.**



# MODEL 3135 - 10 TON FLOOR JACK

PART ORDER NUMBER	KIT DESCRIPTION	KIT INCLUDES	
		REF. #	DESCRIPTION
3135KRK	REPAIR KIT	3.1	FILTER
		3.2	WASHER
		3.11	RUBBER RING
		3.12	RUBBER RING
		3.14	PAPER WASHER
		3.18	SEAL WASHER
		3.30	DUST RING
		3.31	STOP RING
		3.32	SEAL RING
		3.33	BUSH PREVENT RING
		3.34	DUST PROOF RING
		3.41	RUBBER PLUG
		3.42	SEAL RING
		3.43	PLUG BUSHING
		3.49	RUBBER RING
		3.50	SEAL RING
		3.51	THROTTLE SEAL
		3.54	RUBBER RING
		3.55	RUBBER RING
		3.59	RUBBER RING
		6.3	SEAL RING
		6.4A	DUST PROOF RING
		6.8	SEAL RING
		6.10	RUBBER CUP
		6.11	STOP RING
		6.22	STEEL BALL
		6.24	STEEL BALL
		6.26	SEAL WASHER
		6.30	SPRING
		6.33	SEAL RING
		6.36	STEEL BALL
		6.37	SPRING
		6.39	STEEL BALL
6.40	SPRING		
6.41	WASHER		
3135K10	HANDLE COMPLETE	1.1	END COVER
		1.2	COMPRESSION SPRING
		1.3	DEFLECTOR ROD
		1.4	SCREW ROD
		1.5	CONTROL ROD - HANDLE

**\* ONLY PARTS WITH A "PART ORDER NUMBER" ARE AVAILABLE FOR SALE.  
DO NOT COPY OR DISTRIBUTE THIS MATERIAL WITHOUT PERMISSION OF AFF, INC.**



# MODEL 3135 - 10 TON FLOOR JACK

PART ORDER NUMBER	KIT DESCRIPTION	KIT INCLUDES	
		REF. #	DESCRIPTION
3135K340A	AIR MOTOR ASSEMBLY	3.34	DUST RING
		3.35	OUTSIDE TUBE
		3.36	RING
		3.37	FASTENING NUT
		3.38	NUT
		3.39	CYLINDER BASE
		3.40	PUMP BODY
		3.41	RUBBER RING
		3.42	SEAL RING
		3.43	PLUG BUSHING
		3.44	PLUG
		3.45	CAP
		3.46	SPRING
		3.47	SPRING HOLDER
		3.48	PISTON
		3.49	RUBBER RING
		3.50	SEAL RING
		3.51	THROTTLE SEAL
		3.52	WASHER
		3.53	THROTTLE ROD
3.54	RUBBER RING		
3.55	RUBBER RING		
3.56	AIR PUMP BODY		
3.57	WASHER		
3.58	BOLT		
3.59	RUBBER RING		
3.60	END COVER		
3.61	SCREW		
3.62	SCREW TUBE		
3.63	ELBOW JOINT		
3.64	UNION		
NOT AVAILABLE		3.90	UNION
NOT AVAILABLE		5.1	AXLE
NOT AVAILABLE		5.2	NUT
NOT AVAILABLE		7.10	GREASE FITTING
NOT AVAILABLE		8.1	COVER PLATE
NOT AVAILABLE		8.2	SIDE PLATE
NOT AVAILABLE		8.3	RIVET
NOT AVAILABLE		8.5	SCREW
NOT AVAILABLE		8.6	WASHER
NOT AVAILABLE		8.7	NUT
NOT AVAILABLE		8.8	NUT
NOT AVAILABLE		8.9	WASHER

**\* ONLY PARTS WITH A "PART ORDER NUMBER" ARE AVAILABLE FOR SALE.  
DO NOT COPY OR DISTRIBUTE THIS MATERIAL WITHOUT PERMISSION OF AFF, INC.**



# MODEL 3135 - 10 TON FLOOR JACK

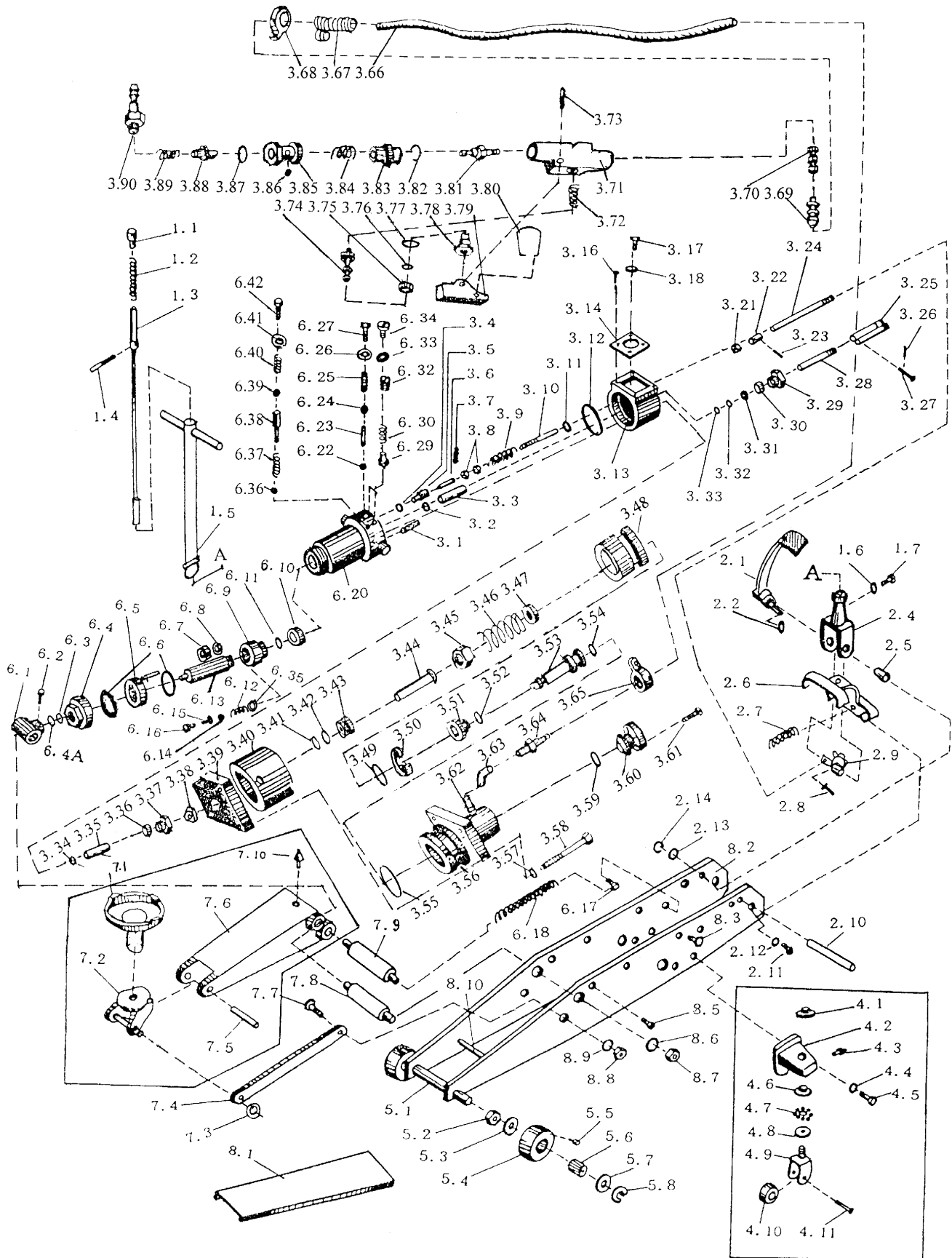

**\* ONLY PARTS WITH A "PART ORDER NUMBER" ARE AVAILABLE FOR SALE.  
DO NOT COPY OR DISTRIBUTE THIS MATERIAL WITHOUT PERMISSION OF AFF, INC.**

When it comes to quality car jacks, AFF is the brand you can depend on.