



**AMERICAN FORGE & FOUNDRY, INC.™**

## **10 TON LONG CHASSIS HYDRAULIC JACK**

Model 3130

Designed for heavy-duty lifting applications (such as bus and truck fleets, agricultural, industrial and heavy construction equipment) requiring access to very low hard-to-reach areas.

- Long 61" body for easier lifting of vehicle with long overhangs
- Foot-operated pump for quick lifting efficiency
- Automatic overload safety valves
- Swivel casters for ease of maneuverability in tight shop situations
- A handle-mounted control lever to lock handle in 1 of 3 positions
- Extra-wide stance for additional stability
- Low Height: 7"
- High Height: 23"
- Front Width: 13"
- Rear Width: 18"
- Shipping Weight: 366 lbs.



### **RELATED PRODUCTS**



**Model 992**  
2 Drawer Work Bench



**Model 3140**  
20 Ton Long Chassis Service Jack



**Model 3700**  
Clutch Jack



# MODEL 3130 - 10 TON FLOOR JACK

PART ORDER NUMBER	KIT DESCRIPTION	KIT INCLUDES	
		REF. #	DESCRIPTION
3130K10	HANDLE COMPLETE	1.1	CAP
		1.2	COMPRESSION SPRING
		1.3	DEFLECTOR ROD
		1.4	SCREW ROD
		1.5	CONTROL ROD - HANDLE
3130K17	HANDLE RETAINER	1.6	WASHER
		1.7	BOLT
3130KHU	HYDRAULIC UNIT	3.1	FILTER
		3.2	WASHER
		3.3	OUTSIDE TUBE
		3.4	WASHER
		3.5	VALVE SEAT
		3.6	NEEDLE
		3.7	WIRE
		3.8	NUT
		3.9	SPRING
		3.10	SCREW ROD
		3.11	RUBBER RING
		3.12	RUBBER RING
		3.13	CYLINDER BODY
		3.14	PAPER WASHER
		3.15	COVER PLATE
		3.16	BOLT
		3.17	SCREW
		3.18	WASHER
		3.19	SEAL WASHER
		3.20	BOLT
		3.21	NUT
		3.22	CONNECTING BRUSH
		3.23	COTTER PIN
		3.24	CONNECTING ROD
		3.25	DRIVING ROD
		3.26	COTTER PIN
		3.27	PIN
		3.28	PISTON ROD
3.29	LOCKING NUT		
3.30	DUST RING		
3.31	STOP RING		
3.32	SEAL RING		
3.33	BUSH PREVENT RING		
6.3	SEAL RING		
6.4	LARGE NUT		
6.4A	DUST PROOF RING		
6.5	RING		
6.6	WASHER		
6.7	BUSHING		
6.8	SEAL RING		

continued

**ONLY PARTS WITH A "PART ORDER NUMBER" ARE AVAILABLE FOR SALE.  
DO NOT COPY OR DISTRIBUTE THIS MATERIAL WITHOUT PERMISSION OF AFF, INC.**



# MODEL 3130 - 10 TON FLOOR JACK

PART ORDER NUMBER	KIT DESCRIPTION	KIT INCLUDES	
		REF. #	DESCRIPTION
continued			
3130KHU	HYDRAULIC UNIT	6.9	PISTON
		6.10	RUBBER CUP
		6.11	STOP RING
		6.12	SPRING
		6.13	PISTON ROD
		6.14	STEEL BALL
		6.15	PUSH NEEDLE
		6.16	VALVE SEAT
		6.17	SCREW
		6.18	SPRING
		6.20	OUTER BODY
		6.22	STEEL BALL
		6.23	SMALL PUSH ROD
		6.24	STEEL BALL
		6.25	LARGE BALL ROD
		6.26	WASHER
		6.27	BOLT
6.28	STEEL BALL		
6.29	VALVE SEAT		
6.30	SPRING		
6.31	STOP BLOCK		
6.32	SCREW		
6.33	SEAL RING		
6.34	SCREW		
6.35	WASHER		
3130K40	CASTER COMPLETE	4.1	COVER
		4.2	WHEEL COVER
		4.3	GREASE FITTING
		4.4	WASHER
		4.5	SCREW
		4.6	BEARING COVER
		4.7	STEEL BALL
		4.8	BEARING HOLDER
		4.9	WHEEL FORK
		4.10	WHEEL
		4.11	RIVET
3130K50	FRONT WHEEL COMPLETE	5.3	STOP RING
		5.4	WHEEL
		5.5	GREASE FITTING
		5.6	ROLLER (13)
		5.7	STOP RING
		5.8	SPLIT RING
3130K71	SADDLE	7.1	SADDLE

**ONLY PARTS WITH A "PART ORDER NUMBER" ARE AVAILABLE FOR SALE.  
DO NOT COPY OR DISTRIBUTE THIS MATERIAL WITHOUT PERMISSION OF AFF, INC.**



# MODEL 3130 - 10 TON FLOOR JACK

PART ORDER NUMBER	KIT DESCRIPTION	KIT INCLUDES	
		REF. #	DESCRIPTION
3130KRK	REPAIR KIT	3.11	RUBBER RING
		3.12	RUBBER RING
		3.14	PAPER WASHER
		3.18	SEAL WASHER
		3.19	SEAL WASHER
		3.30	DUST RING
		3.31	STOP RING
		3.32	SEAL RING
		3.33	BUSH PREVENT RING
		6.3	SEAL RING
		6.4A	DUST PROOF RING
		6.6	O-RING-TWO REQUIRED
		6.8	SEAL RING
		6.10	RUBBER CAP
		6.11	STOP RING
		6.14	STEEL BALL
		6.22	STEEL BALL
		6.24	STEEL BALL
6.26	SEAL WASHER		
6.28	STEEL BALL		
6.30	SPRING		
6.33	SEAL RING		
3130K29	CAP SET	2.1	FOOT PEDAL
		2.2	CIRCLIP
		2.3	PIN
		2.4	FORK MEMBER
		2.5	BUSH
		2.6	BASE
		2.8	PIN
		2.9	CAP
		2.10	SHAFT
		2.11	SCREW
		2.12	WASHER
		2.13	WASHER
		2.14	CLAMP RING
		3.24	CONNECTING ROD
NOT AVAILABLE		5.1	AXLE
NOT AVAILABLE		5.2	NUT
NOT AVAILABLE		6.1	JOINT
NOT AVAILABLE		6.2	SCREW
NOT AVAILABLE		7.2	SADDLE CARRIER
NOT AVAILABLE		7.3	AXLE
NOT AVAILABLE		7.4	LEVEL SUPPORTING ROD
NOT AVAILABLE		7.5	AXLE
NOT AVAILABLE		7.6	ROCKER
NOT AVAILABLE		7.7	BOLT
NOT AVAILABLE		7.8	AXLE

**ONLY PARTS WITH A "PART ORDER NUMBER" ARE AVAILABLE FOR SALE.  
DO NOT COPY OR DISTRIBUTE THIS MATERIAL WITHOUT PERMISSION OF AFF, INC.**



# MODEL 3130 - 10 TON FLOOR JACK

PART ORDER NUMBER	KIT DESCRIPTION	KIT INCLUDES	
		REF. #	DESCRIPTION
NOT AVAILABLE		7.9	AXLE
NOT AVAILABLE		7.10	GREASE FITTING
NOT AVAILABLE		8.1	COVER PLATE
NOT AVAILABLE		8.2	SIDE PLATE
NOT AVAILABLE		8.3	RIVET
NOT AVAILABLE		8.5	SCREW
NOT AVAILABLE		8.6	WASHER
NOT AVAILABLE		8.7	NUT
NOT AVAILABLE		8.8	NUT
NOT AVAILABLE		8.9	WASHER
NOT AVAILABLE		8.10	LIMITER AXLE

**ONLY PARTS WITH A "PART ORDER NUMBER" ARE AVAILABLE FOR SALE.  
DO NOT COPY OR DISTRIBUTE THIS MATERIAL WITHOUT PERMISSION OF AFF, INC.**

MODEL# 3130

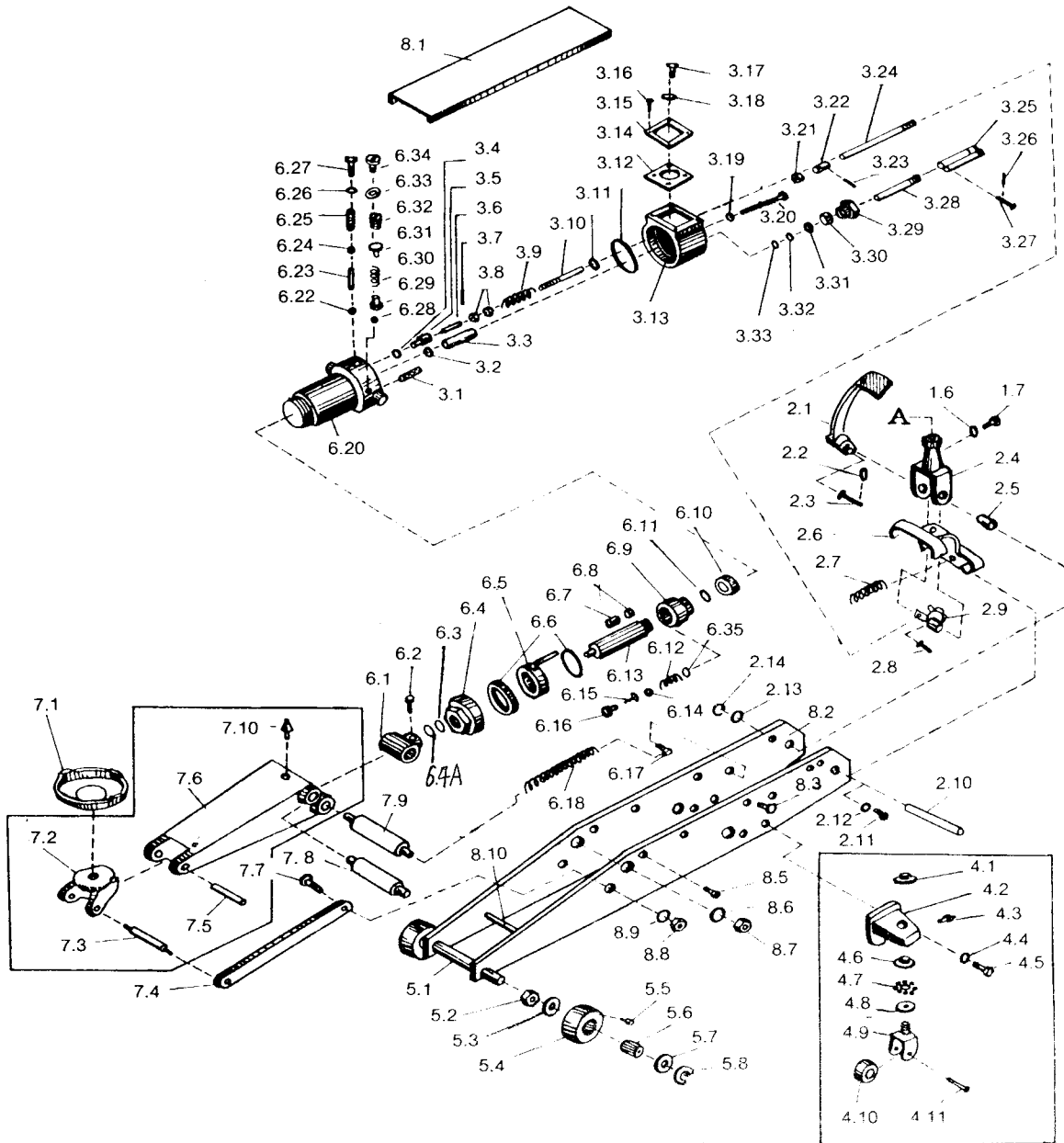

**DO NOT COPY OR DISTRIBUTE THIS MATERIAL WITHOUT PERMISSION OF AFF, INC.**

When it comes to quality car jacks, AFF is the brand you can depend on.