



# Intake Kit Installation Instructions: GM Diesel Trucks (LMM) 2007.5-2010 V8-6.6L (td) Duramax

<b>Kit Part #</b>	51-81332 / 75-81332-0		
<b>Make:</b>	GMC		
<b>Model</b>	<b>Year</b>	<b>Engine</b>	
Sierra 2500HD	2007.5-2010	V8-6.6L(td) LMM	
Sierra 3500HD	2007.5-2010	V8-6.6L(td) LMM	
<b>Make:</b>	Chevrolet		
<b>Model</b>	<b>Year</b>	<b>Engine</b>	
Silverado 2500HD	2007.5-2010	V8-6.6L(td) LMM	
Silverado 3500 HD	2007.5-2010	V8-6.6L(td) LMM	

<b>Tools Required:</b>
5/16" nut driver
10mm socket or wrench
7/16" socket or wrench
Flathead screwdriver
Phillips screwdriver
Ratchet and extension
T-20 torx bit ( included )
5/32" allen key

<b>Part List:</b>
1 Air Filter P/N: 21-90038 (Pro DRY S)
1 Air Filter P/N: 72-90038 (Pro-GUARD 7)
1 Housing, Rotomold (05-00880)
1 Tube, Rotomold (05-00935)
1 Cover (05C00880)
1 Coupler, Silicone Hump 4-1/4" x 3"L (05-01201)
2 Clamp, #072 (03-50010)
4 Screws, Button Head Socket: M6 (03-50102)
2 Spacer, Nylon 1/2" (05-50089)

2 Screws, Fill Head Slotted #8-32 x 5/8"L (03-50045)
1 Gasket, MAS Sensor (05-00631)
2 Screws, Hex Head: 1/4 (03-50072)
2 Locknut, Nylon Insert: 1/4 (03-50073)
4 Washers, Fender: 1/4 (03-50074)
1 Torx Bit: T20 (03-50066)



Complete kit components

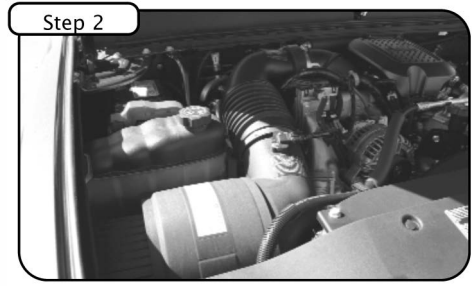

Complete stock intake.

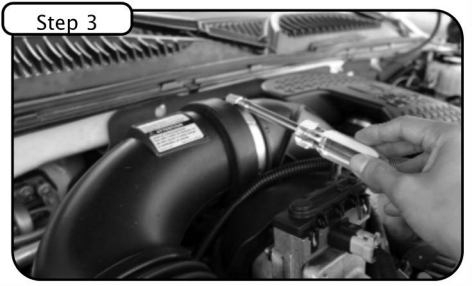

With 5/16" nut driver, loosen the clamp @ turbo end.



Disconnect MAF sensor harness .

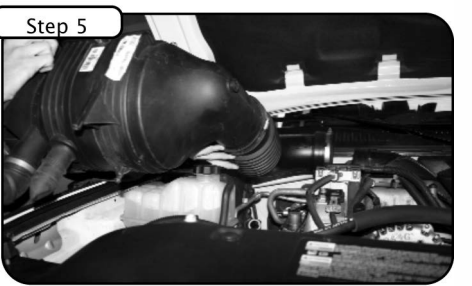

Carefully grab and pull out OE intake system from vehicle.

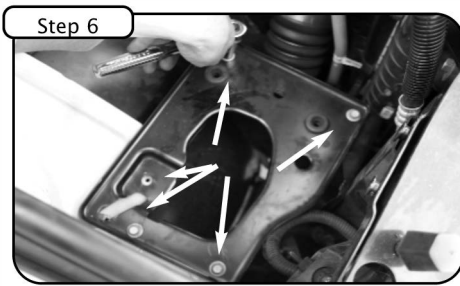

With 10mm socket, loosen the 5 screws holding the OE intake bracket and remove. Save 4 screws for later install.

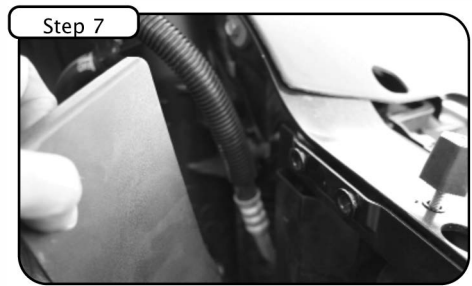

Remove plastic cover behind passenger head light.

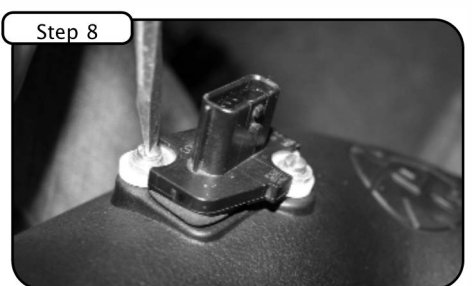

Remove MAF sensor from OE intake with T-20 torx bit. Insert MAF sensor into new tube with gasket, nylon spacer and #8-32 screws provided, spacers and gasket should be between tube and sensor.



Install tube to outside of housing. Tighten using screws, washers and nuts provided with 7/16" socket or wrench.



Place hump coupler at end of tube with clamps provided. Install into vehicle. Position tube and housing to factory position. Do not tighten clamps!

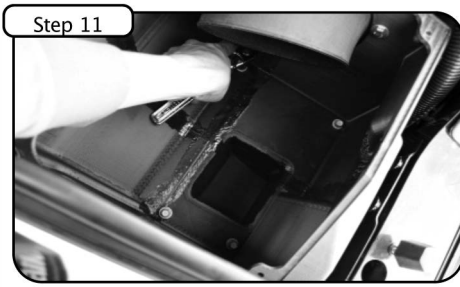

With 10mm socket or wrench, tighten down housing using 4 screws from step 6.

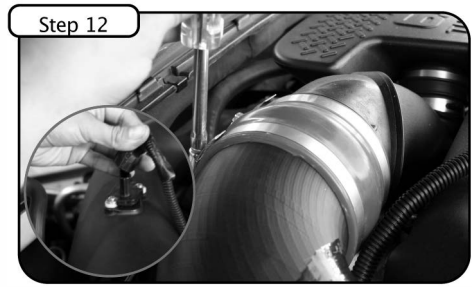

Tighten clamps @ turbo end with 5/16" nut driver. Re-connect MAF sensor harness.

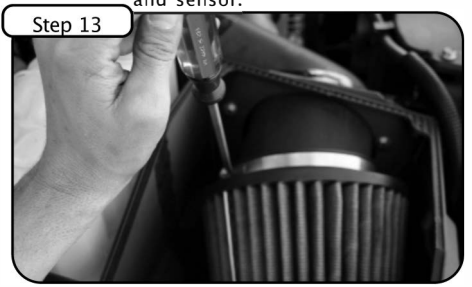

Install air filter and tighten using 5/16" nut driver.



With button head screws provided, install housing cover and tighten using 5/32" allen key.



Your installation is now complete. Check all clamps and connections. Periodically check all clamps and hoses. Thank you for choosing aFe!