



Air Filter Installation Instructions- GM HD Trucks V8-6.6L Duramax LLY/LBZ (TD)

Part #	10-10101/ 71-10101	Tools Required	Phillips Screwdriver	Parts List:	1 Air Filter PN 10-10101 or PN 71-10101
Year	2006				
Make	GMC/ Chevrolet				
Model	Sierra 2500HD/Silverado 2500HD Sierra 3500HD/Silverado 3500HD				
Engine	V8-6.6L Duramax LLY/LBZ (td)				



Loosen the phillips screw on the air box and remove the cover to access the air filter.



Remove air box cover. Remove air filter from air box.

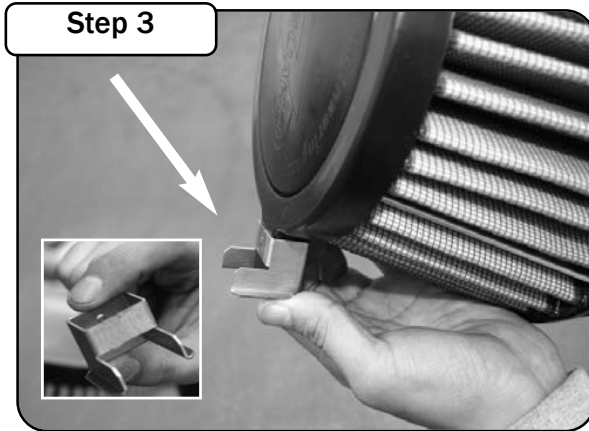

Attach the supplied clip to the post on the filter. Tilt and slide down. Notice the orientation of the clip. Make sure the clip's teeth point away from the filter.

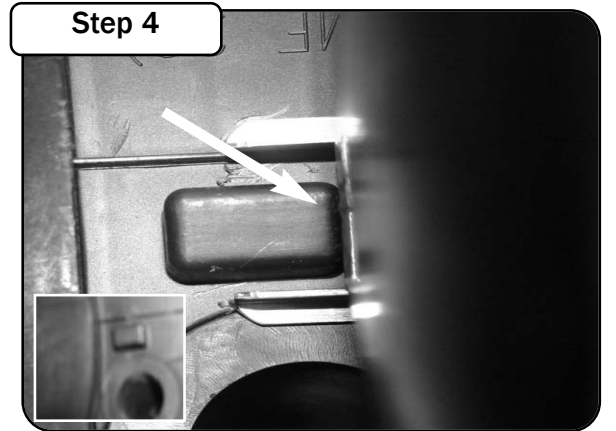

Notice the square tab at the bottom of the airbox. The clip should capture this as shown.

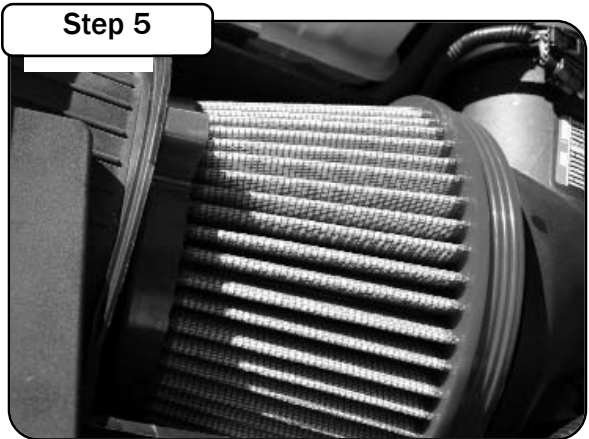

It will be necessary to tilt the filter to align the clip with the air box tab and then angle the filter into the OE air box.

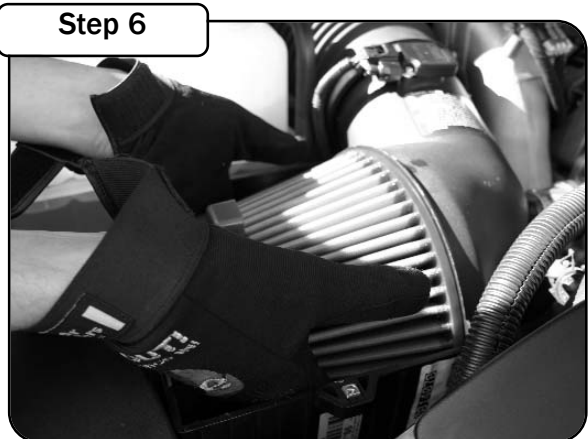

Carefully apply pressure to the filter to ensure a tight seal.

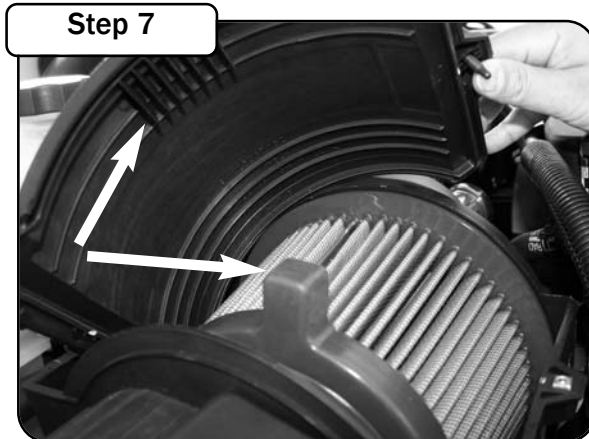

Close the air box with the lid and screw the lid down. If the bottom post is properly aligned, the top post and the fins on the lid should also align. If not, check that the bottom prongs still correctly capture the tab at the bottom of the air box.

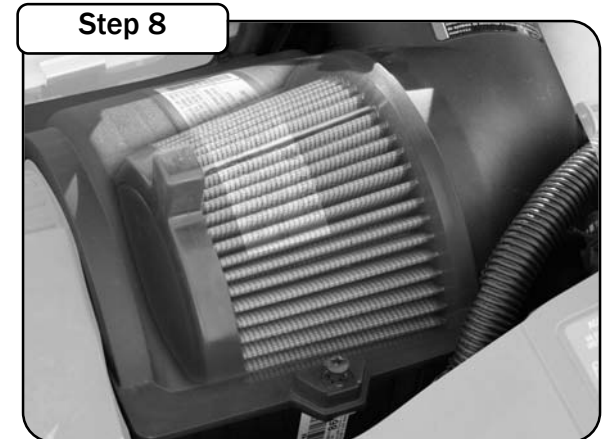

Screw the air filter cover down. Verify the air box cover closes correctly. Your installation is now complete.

Note: Filter Cleaning and Re-oiling: When cleaning your aFe filter, be sure to use only aFe's "Restore Kit" aFe P/N: 90-50000 gold oil aerosol, or aFe P/N: 90-50500 gold squeeze bottle oil