

advanced FLOW engineering

Instruction Manual P/N: 51-12092-1 / 54-12092-1/ 75-12092-1

Make: **Jeep** Model: **Wrangler JK** Year: **2012-2015** Engine: **V6-3.6L**
(CARB exempt 2012-2013 only)



- Please read the entire instruction manual before proceeding.
- Ensure all components listed are present.
- If you are missing any of the components, call customer support.
- Ensure you have all necessary tools before proceeding.
- Do not attempt to work on your vehicle when the engine is hot.
- Disconnect the negative battery terminal before proceeding.

NOTE: Retain factory parts for future use.

Label	Qty.	Description	Part Number
A1	1	Pro DRY S Air Filter	21-90045 (Gray Media) (Kit # 51-12092-1)
A2	1	Pro 5R Air Filter	24-91031 (Blue Media) (Kit # 54-12092-1)
A3	1	Pro-GUARD 7 Air Filter	72-90045 (Yellow Media) (Kit # 75-12092-1)
B	1	Housing	05-12092B1
C	1	Tube	05-12092B3
D	1	Coupling Straight	05-00419
E	1	Coupling Hump	05-00794
F	2	Clamp #052	03-50008
G	2	Clamp #072	03-50010
H	1	Adaptor	05-00611
I	5	Button Head Screw	03-50113
J	5	Washer, Wavy	03-50058
K	1	Grommet	03-50076
L	2	Urethane Spacer	05-01215
M	1	Seal Trim (24.5 Inches)	05-00072
N	1	Hose (9 Inches)	05-00069

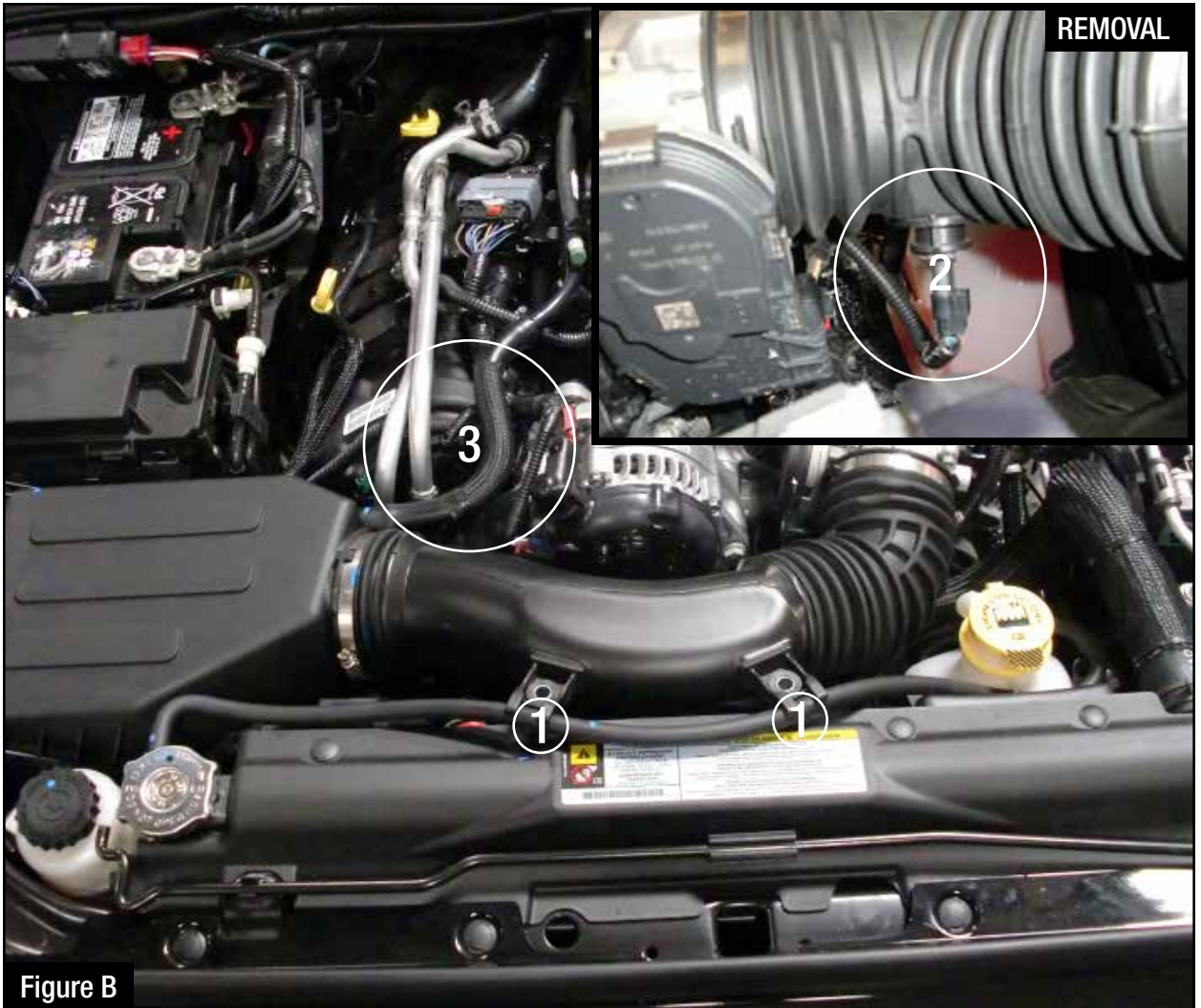



Figure A

Refer to Figure A for Step 1

Step 1: Remove the engine cover.



Refer to Figure B for Steps 2-6

Step 2: Remove the two 10mm bolts from the intake tube. ①

Step 3: Disconnect the temp sensor wire harness. ②

Step 4: Loosen the hose clamp at the throttle body.

Step 5: Completely remove the small section of crankcase vent (CCV) hose. It should be pulled off of the air filter housing and the tube to the engine. ③

Step 6: Remove the stock intake tube, and air filter housing by pulling straight up and out of the vehicle.



Figure C

Refer to Figure C for Step 7

Step 7: Twist the temp sensor about 45 degrees counter-clockwise and pull it straight up to remove from stock tube.



Figure D

Refer to Figure D for Step 8

Step 8: Remove the 10mm bolt that secures the plastic tray onto the inner fender, but do not remove the plastic tray.



Figure E

Refer to Figure E for Step 9

Step 9: Install the air filter adaptor in the housing and secure using the 5 washers and 5 screws provided.



Figure F

Refer to Figure F for Steps 10-12

Step 10: Install the trim seal on the housing.

Step 11: Install the two spacers on the pegs located on the bottom of the housing. ⑤

Step 12: Install the assembled housing into the vehicle as shown. Secure the housing using the OE bolt removed from Step 8.



Figure G

Refer to Figure G for Steps 13-14

Step 13: Insert the provided grommet into the new aFe intake tube.

Step 14: Insert the OE temp sensor into the grommet.



Figure H

Refer to Figure H for Steps 15-19

Step 15: Install the provided couplings and clamps onto the vehicle. The straight coupling (05-00419) goes on the throttle body. The hump coupling (05-00794) goes on the air filter adaptor.

Step 16: Install the intake tube as shown. Align the tube so that the coolant return line runs above the fan shroud.

Step 17: Plug in the temp sensor harness. ⑥

Step 18: Install the new CCV hose. (Note: Use lubricant on the outside of the OE tube)

Step 19: Snap the coolant line into the clips on the front of the aFe intake tube.

**Figure I****Refer to Figure I for Steps 20-23**

Step 20: Install the aFe high performance air filter.

Step 21: Tighten all clamps.

Step 22: Reinstall the engine cover

Step 23: Your installation is now complete

**NOTE: Retighten all connections after approximately 100-200 miles.
Place the included CARB EO sticker on or near the device on a smooth, clean
surface.**

EO identification label is required to pass the smog inspection.



Pro DRY S Air Filter



P/N: 21-90045

Pro 5R Air Filter



P/N: 24-91031

Pro-GUARD 7 Air Filter



P/N: 72-90045

Pro DRY S Restore Kit



P/N: 90-59999

Blue Squeeze Restore Kit



P/N: 90-50501

Blue Aerosol Restore Kit



P/N: 90-50001

Differential Cover



P/N: 46-70162

Programmer



P/N: 77-46201-1

Scorpion Exhaust



P/N: 49-08042

Scorpion Exhaust



P/N: 49-08047-P

Oil Filter



P/N: 44-LF026

Throttle Body Spacer

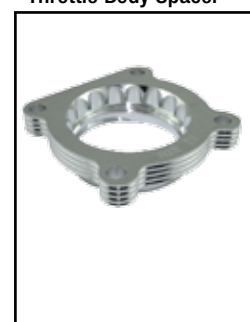

P/N: 46-35003

Warranty

General Terms:

- aFe warrants their products to be free from manufacturer's defects due to workmanship and material.
- This warranty applies only to the original purchaser of the product and is non-transferrable.
- Proof of purchase of the aFe product is required for all warranty claims.
- Warranty is valid provided aFe instructions for installation and/or cleaning were properly followed.
- Proper maintenance with regular inspections of product is required to insure warranty coverage.
- Damage due to improper installation, abuse, unauthorized repair or alteration is not warranted.
- Incidental or consequential damages or cost, including installation and removal of part, incurred due to failure of aFe product is not covered under this warranty.
- All warranty is limited to the repair and/or replacement of the aFe part. To request Return Goods Authorization ("RGA"). Upon receipt of the RGA, you must return the product to the address provided in the RGA, freight prepaid and accompanied with a dated proof of purchase and the RGA. Upon receipt of the defective product and upon verification of proof of purchase, aFe will either repair or replace the defective product within a reasonable time, not to exceed thirty days.

Product Category	P/N Prefix	Warranty duration
Direct OE Replacement Filters	10, 11, 30, 31, 71, 73	Life of the vehicle
Racing Filters	18	1 year
Universal	21, 24, 72	2 years
Air Intake Systems	50, 51, 54, 55, 75	2 years
Exhaust Systems	49	2 years
Intercoolers & Intercooler Tubes	46-2	2 years
Intake Manifolds	46-1	2 years
Differential Cover	46-7	Life of the vehicle
Exhaust Manifolds	46	2 years
Throttle Body Spacers	46-3	2 years
Fluid Filters	44	90 days
Pre-Filters	28	2 years
Heavy Duty OE Replacement	70	2 years
PowerSports OE Replacement	81, 87	2 years
PowerSports Intake Systems	85	2 years

No other warranty expressed or implied applies nor is any person or advanced FLOW engineering authorized to assume any other warranty. Some States do not allow the exclusion or limitation of incidental or consequential damages or do not allow limitations on how long an implied warranty lasts, so the above limitations or exclusions may not apply to you. This warranty gives you specific legal rights, and you may also have other rights which vary from State to State.

Buy quality performance air intake systems in our online store.