



Intake kit Installation Instructions: 2003-2009 Dodge Ram 2500-3500 Cummins (td)

Kit P/N: 51/54/75-11342-1 75-11343-1V	Tools Required: 11mm socket or wrench 10mm socket or wrench 5/16" nut driver 1/4" nut driver Flat head screwdriver Ratchet w/ extension T-20 torx bit (included) Pliers/cutters	Parts list: 1 Air filter (P/N Pro-5R™ 24-91046 ProDryS™ 21-91046 or Pro-GUARD 7™ 72-91046)(Step 14) 1 Housing, wrinkle black (Step 5) 1 Tube (Step 7) 1 Coupler, straight hi-temp 4" x 2-1/2" (Step 9) 1 3/4" trim seal @ 27.5"L (Step 5) 1 3/4" trim seal @ 13.5"L (Step 5) 2 Clamp, #064 (Step 10) 1 Torx bit, T-20 (Step 7) 1 Screw, hex M6 x 1 x 12 (Step 10) 1 Screw, hex M6 x 1 x 20 (Step 6) 3 Washer, flat (Step 6, 10)	1 Nut, hex M6 (Step 10) 1 Gasket, MAF sensor (Step 8) 1 Gasket, temp sensor (Step 8) 1 Bracket, "D" (Step 4) 1 Cover, MAFsensor (for use of 5.9L)(Step 7) 1 Grommet, rubber (for use of 5.9L)(Step 7) 1 Plug, 05-01968 (for use of 5.9L) (Step 7) 2 Screws, phillips #8-32 x 5/16" (Step 7) 3 Screws, phillips #8-32 x 5/8" (Step 8) 2 Screw, hex 3/8-16 x 1-1/2" (Step 6) 2 Locknut, hex 3/8-16 (Step 6) 4 Washer, flat 3/8" x 7/8"OD (Step 6) 1 Washers, lock M6 (Step 6)
---	--	---	---

Bonus Part List: (75-11342-1V Only)
 1 Air filter P/N (**Pro Dry S™** 21-91046)
 1 Restore kit, gold squeeze
 1 Pre-filter



Complete Stock Intake.

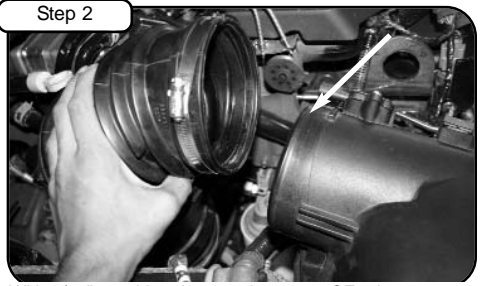

With 5/16" nut driver loosen clamps on OE tube at turbo/air box and remove. (6.7L remove crank case line with pliers and save OE plastic fitting for later install)



Disconnect air temp sensor. (6.7L, disconnect MAF sensor). Lift up and pull OE air box out of vehicle.

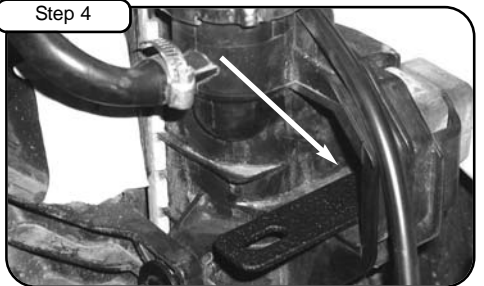

With 10mm socket, loosen bolt holding in radiator housing, install bracket "D" and re-tighten bolt.



Install 3/4" Trim seal to housing. Now install housing into vehicle.

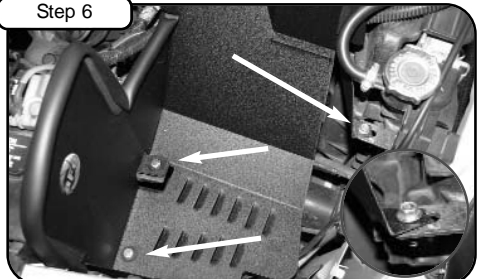

With 3/8" screws/nuts and washers provided install bottom of housing to factory position. Tighten using 9/16" wrench or socket. Use M6 screw/nut and washer and tighten housing to bracket "D" from Step 4 and tighten.



With T-20 torx bit remove temp sensor and (with gasket and screws provided) install into new tube. (5.9L place MAF cover with gasket and tighten using short screws provided.) Install plug into the hole in tube for crank case line.



(6.7L remove and install temp sensor, see step 7) . 6.7L, remove MAF sensor and install to new tube with screws and gasket (Make sure gasket is between sensor and tube) Install grommet only to tube. The 6.7L will not use small phillips screws.



Install hi-temp coupler with clamps provided to tube. Now install tube into vehicle.

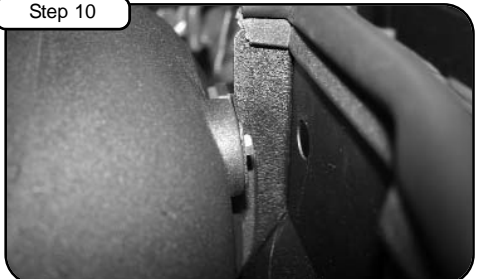

Place tube on top of housing. Install M6 screw and washer through housing to tube. Do not tighten!

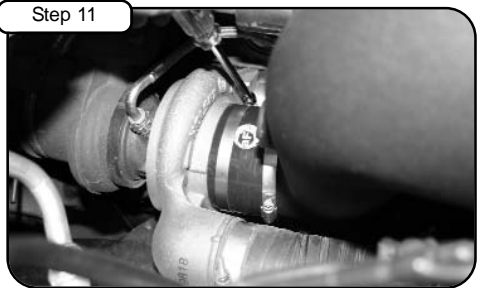

Tighten clamps using 5/16" nut driver. (6.7L, install OE crank case line from step 2 in to new tube)

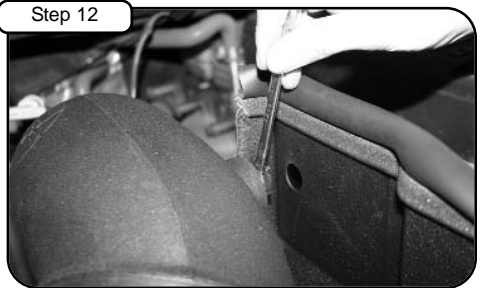

Now tighten screw using 10mm socket or wrench.



Reconnect all sensor harnesses.



Install air filter and tighten using 5/16" nut driver.



Place the included CARB EO Sticker on or near the intake system on a smooth, clean surface. E.O. identification label is required in passing the Smog Check Inspection. Your installation is now complete. Please check all bolts and clamps periodically. Re-tighten if necessary. Thank you for choosing aFe!

Note: Filter Cleaning and Re-oiling: When cleaning your aFe filter, be sure to use only aFe's "Restore Kit" (aFe P/N: 90-50000 gold oil aerosol, aFe P/N: 90-50500 gold squeeze oil, aFe P/N: 90-50001 blue oil aerosol, aFe P/N: 90-50501 blue squeeze oil or aFe P/N: 90-59999 dry restore kit).
 Filter Replacement: Magnum FLOW PN: 72-910046 **Pro-GUARD 7™** (black w/gold media), **Pro-5R™** 24-91046 (black w/blue media) or **Pro Dry S™** P/N 21-910046 (black w/white media) **Pro Dry S™** cleaning: see cleaning instruction sheet 06-00074