

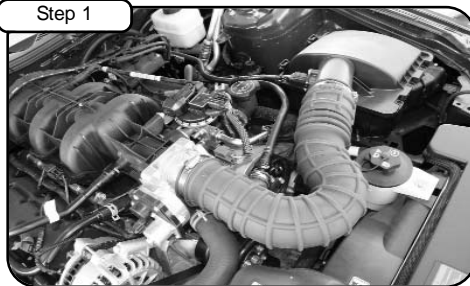

Intake kit Installation Instructions: 05-07 Ford Mustang V6-4.0L Stage 2 Cx

| | | | |
|-------------------------------------|---|---|--|
| Kit P/N: 51-11312 / 54-11312 | Tools Required: 10mm socket or wrench 5/16" nut driver Phillips screwdriver Ratchet w/ extension T-20 torx bit (included) | Parts list: 1 Air filter (P/N 24-90025 or Pro Dry S™ 21-90025) 1 Housing, wrinkle black 1 Tube 1 Coupling, straight 3" x 3" 2 Clamp, #052 2 Screw, hex M6 x 1 x 25 2 Washers, wavy M6 2 Nut, M6 2 Washer, flat 1 Gasket, MAF sensor 2 Spacer, nylon 1/2" x 1/4" x 1/8" 2 Screw, phillips #8-32 x 5/16" | 1 3/8" hose @ 30"L 1 7/16" trim seal 28.5"L 1 Grommet 1 Fitting, plastic 3/8" 2 Clamp, mini #006 |
| Make: Ford | | | |
| Model: Mustang | Year: '05-'07 | Engine: V6-4.0L | |



Step 1
Complete Stock Intake.

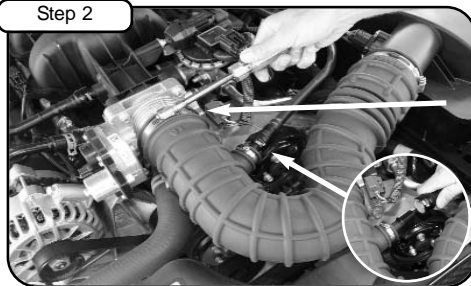

Step 2
With 5/16" nut driver loosen clamp at throttle body. Disconnect and remove OE crank case line.



Step 3
Loosen the clamp at air box side and remove OE intake tube.

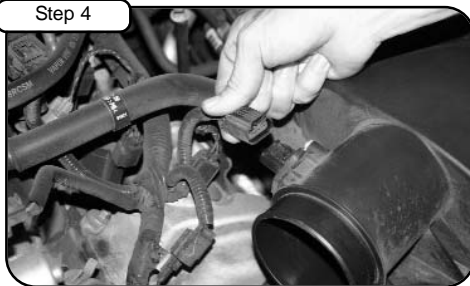

Step 4
Disconnect MAF sensor harness.



Step 5
With 10mm socket or wrench loosen the 2 screws holding in OE air box. Lift up and remove OE air box out of vehicle.

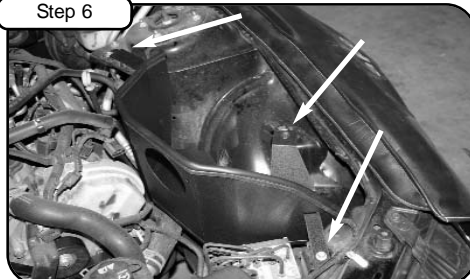

Step 6
With OE screws removed from step 5, install new aFe housing to vehicle. Tighten using 10mm socket or wrench.

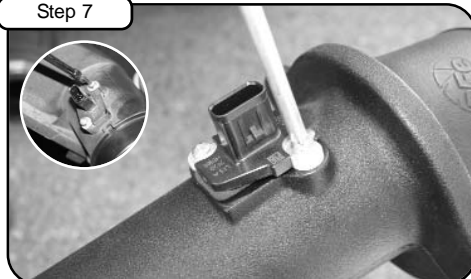

Step 7
With T-20 torx bit remove MAF sensor and (with gasket, nylon spacers and screws provided) install into new tube. Make sure gasket and nylon spacers are between sensor and tube.



Step 8
Remove factory crank case line from engine.

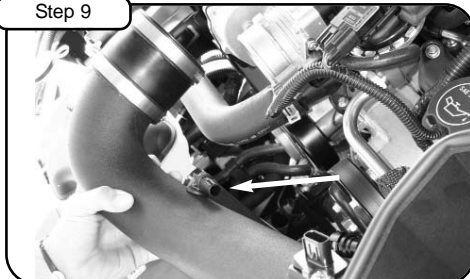

Step 9
Install coupler with clamps to tube. Also install grommet with elbow fitting to tube. Install tube to outside of housing and position coupler on to throttle body.



Step 10
Install screws/nuts and washer provided to mount tube to housing. Tighten using 10mm socket or wrench.



Step 11
Tighten clamps with 5/16" nut driver.



Step 12
Install new 3/8" hose provided to valve cover side and new tube side.

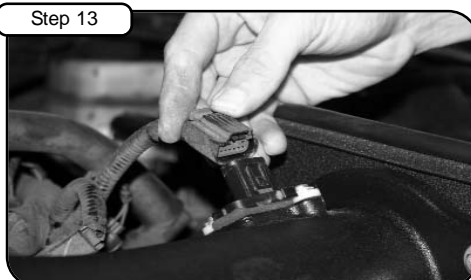

Step 13
Reconnect MAF sensor harness.

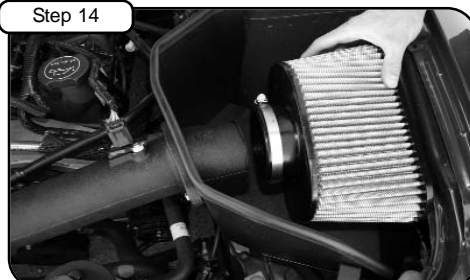

Step 14
Install air filter and tighten using 5/16" nut driver.

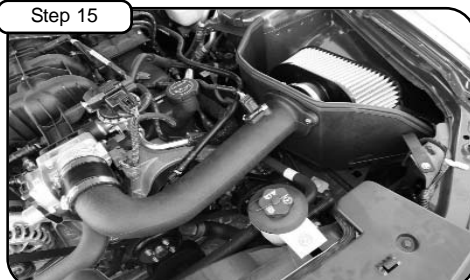

Step 15
Your installation is now complete. Please check all bolts and clamps periodically. Re-tighten if necessary. Thank you for choosing aFe!

Note: Filter Cleaning and Re-oiling: When cleaning your aFe filter, be sure to use only aFe's "Restore Kit" (aFe P/N: 90-50001 blue oil aerosol, or aFe P/N: 90-50501 blue squeeze bottle oil)
Filter Replacement: Magnum FLOW PN: 24-90025 (black w/blue media) or Pro Dry S™ P/N 21-90025 (black w/white media) Pro Dry S™ cleaning: see cleaning instruction sheet 06-00074

Buy quality performance air intake systems in our online store.