

advanced FLOW engineering Quantum Cold Air Intake System

Instruction Manual P/N: 53-10029D / 53-10029R

Make: Chevrolet	Model: Silverado 1500	Year: 2009-2013	Engine: V8-4.8L/5.3L/6.2L
Make: GMC	Model: Sierra 1500	Year: 2009-2013	Engine: V8-4.8L/5.3L/6.2L



- Please read the entire instruction manual before proceeding.
- Ensure all components listed are present.
- Ensure you have all necessary tools before proceeding.
- Do not attempt to work on your vehicle when the engine is hot.
- Disconnect the negative battery terminal before proceeding.
- Retain factory parts for future use.

Label	Qty.	Description	Part Number
A1	1	Air Filter (Pro 5R)	23-91129
A2	1	Air Filter (Pro DRY S)	21-90098
B	1	Tube	05-5310029B1
C	1	Housing	05-54006B2
D	1	Seal, Trim: 7/16" Bulb (26"L)	05-00072
E	1	Clamp, 080 (3-1/2" – 5-1/2")	03-50011
F	1	Clamp, 072 (3" - 5")	03-50010
G	1	Coupling, Silicone Bellow	05-01457
H	1	Coupling, Silicone Reducer	05-01459
I	1	Clamp, 060 (3-5/16" - 4-1/4")	03-50002
J	1	Clamp, 064 (2-1/2" – 4-1/2")	03-50006
K	2	Screw, Torx: M4 x .7 x 8mm	03-50491
L	1	Hose, Silicone Breather, Black (14"L)	05-01396
M	1	Clamp, Mini 006 (7/16" - 25/32")	03-50025

Installation will require the following tools:

8mm nut driver, T15 & T20 Torx drivers, Phillips #3 screwdriver, small flat-head screwdriver.

Emissions Disclaimer: This product is not currently CARB exempt and is not available for purchase in California or for use on any vehicle registered with the California Department of Motor Vehicles.

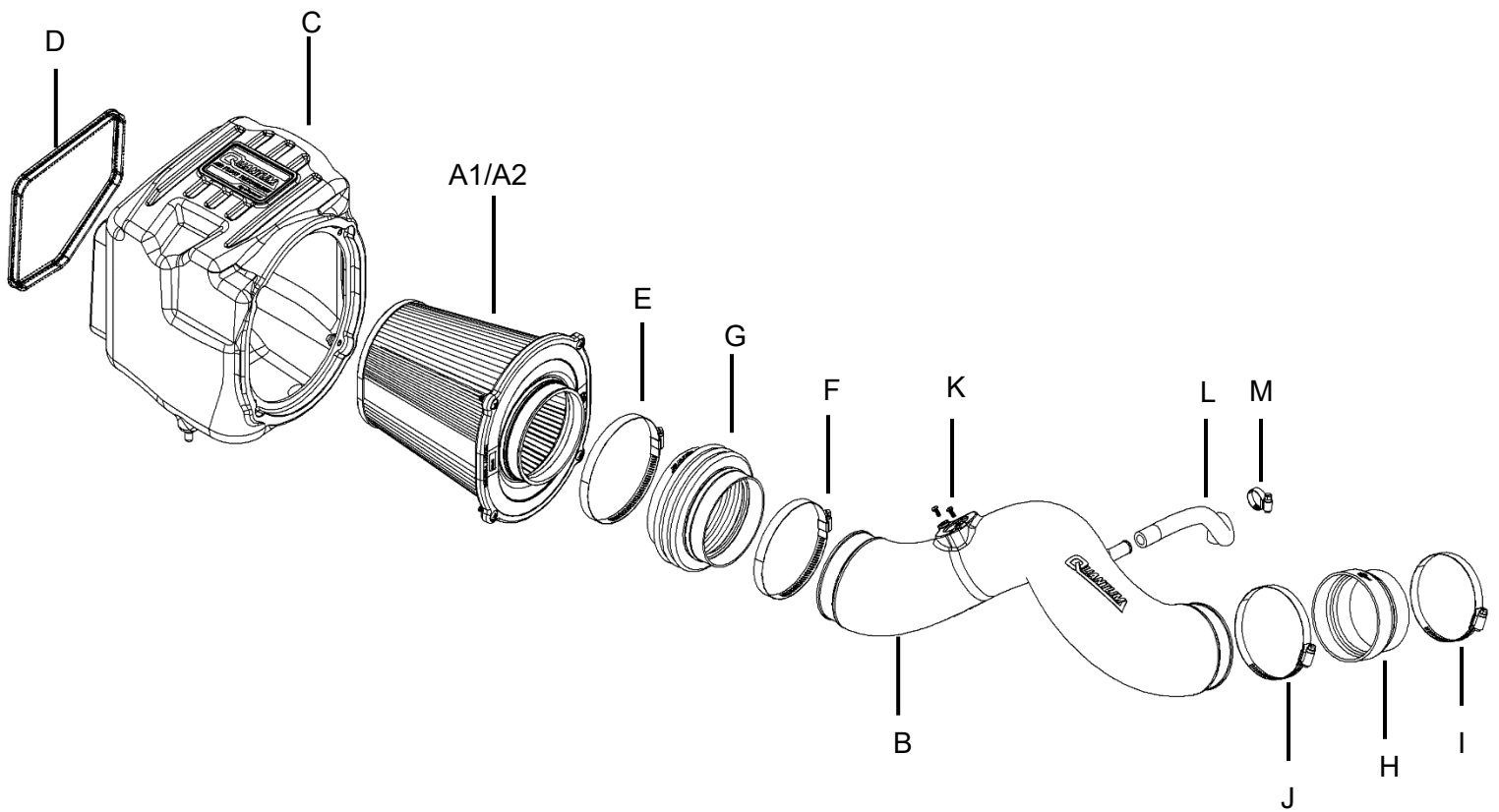

**Figure A****Refer to Figure A for Steps 1-3**

Step 1: Remove the engine cover ① and set aside.

Step 2: Disconnect the MAF sensor ②.

Step 3: Using an 8mm nut driver, loosen the hose clamps at the housing ③ and the throttle body ④.



Figure B

Refer to Figure B for Step 4

Step 4: Disconnect the radiator hose clip from the OE intake tube.



Refer to Figure C for Steps 5-6

Step 5: Disconnect the OE crankcase breather hose from the resonator chamber (as shown) and remove it from the valve cover fitting.

Step 6: Carefully remove the entire intake tube out of the vehicle.



Figure D

Refer to Figure D for Step 7

Step 7: Remove the factory housing ⑤ out of the vehicle.

**Figure E****Refer to Figure E for Steps 8-9**

Step 8: Slide the aFe filter into the aFe housing. Install the aFe filter using a #3 Phillips screwdriver. Tighten all (x4) screws.

Step 9: Install the supplied bellows coupling (6) onto the air filter using the supplied #80 clamp (7). Tighten the clamp.



Figure F

Refer to Figure F for Steps 10-11

Step 10: Install the trim seal (8) on the opening of the aFe housing.

Step 11: Remove the retaining plug (9) from the bottom of the factory housing and transfer it to the aFe housing.



Figure G

Refer to Figure G for Step 12

Step 12: Install the aFe housing assembly into the vehicle. Firmly push the housing into the factory mounting grommets.

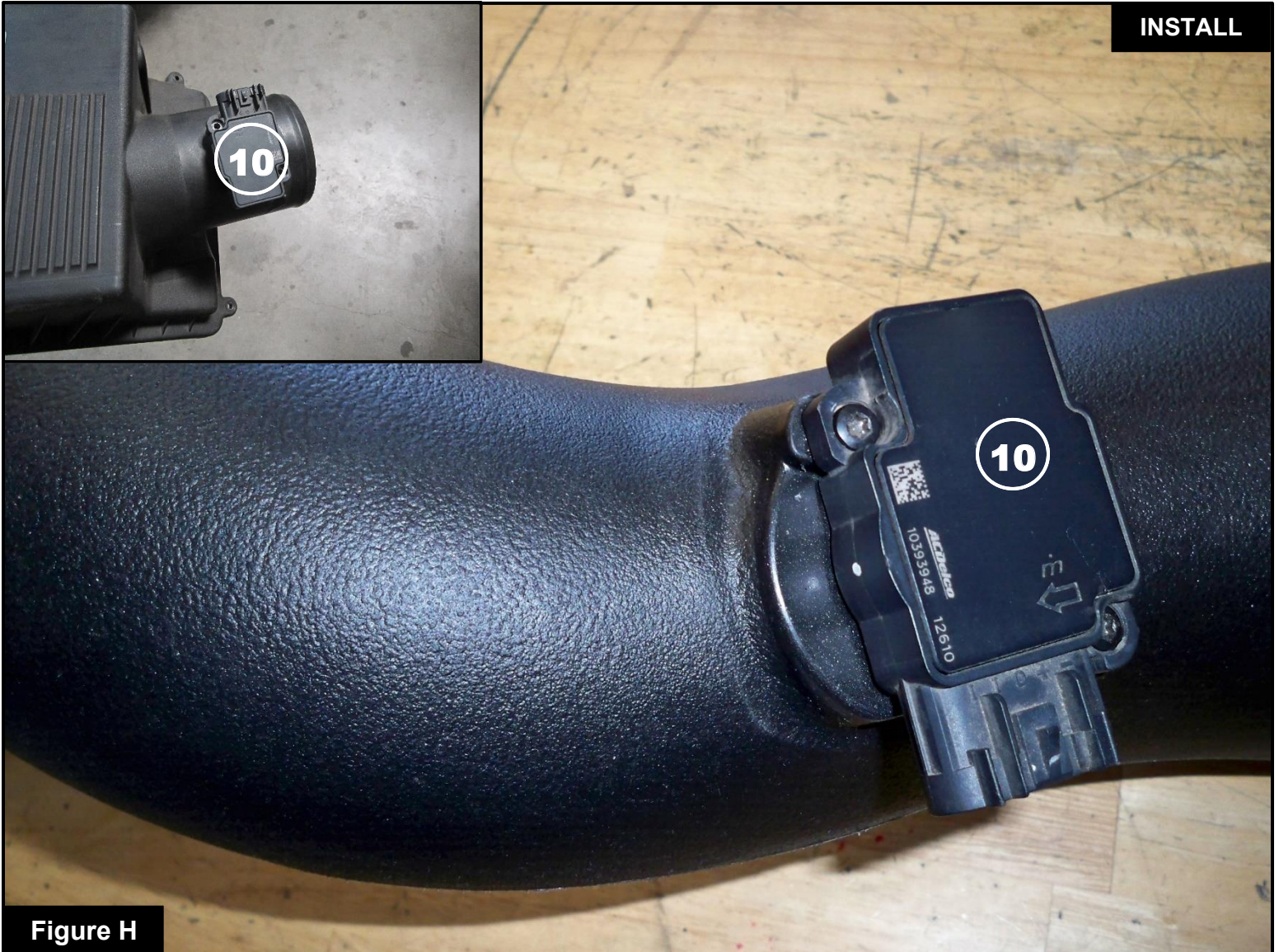
**Figure H****Refer to Figure H for Steps 13-14**

Step 13: Remove the MAF sensor (10) from the factory housing using a T15 Torx driver.

Step 14: Using a T20 torx driver, install the MAF sensor into the aFe intake tube using the supplied M4 screws.

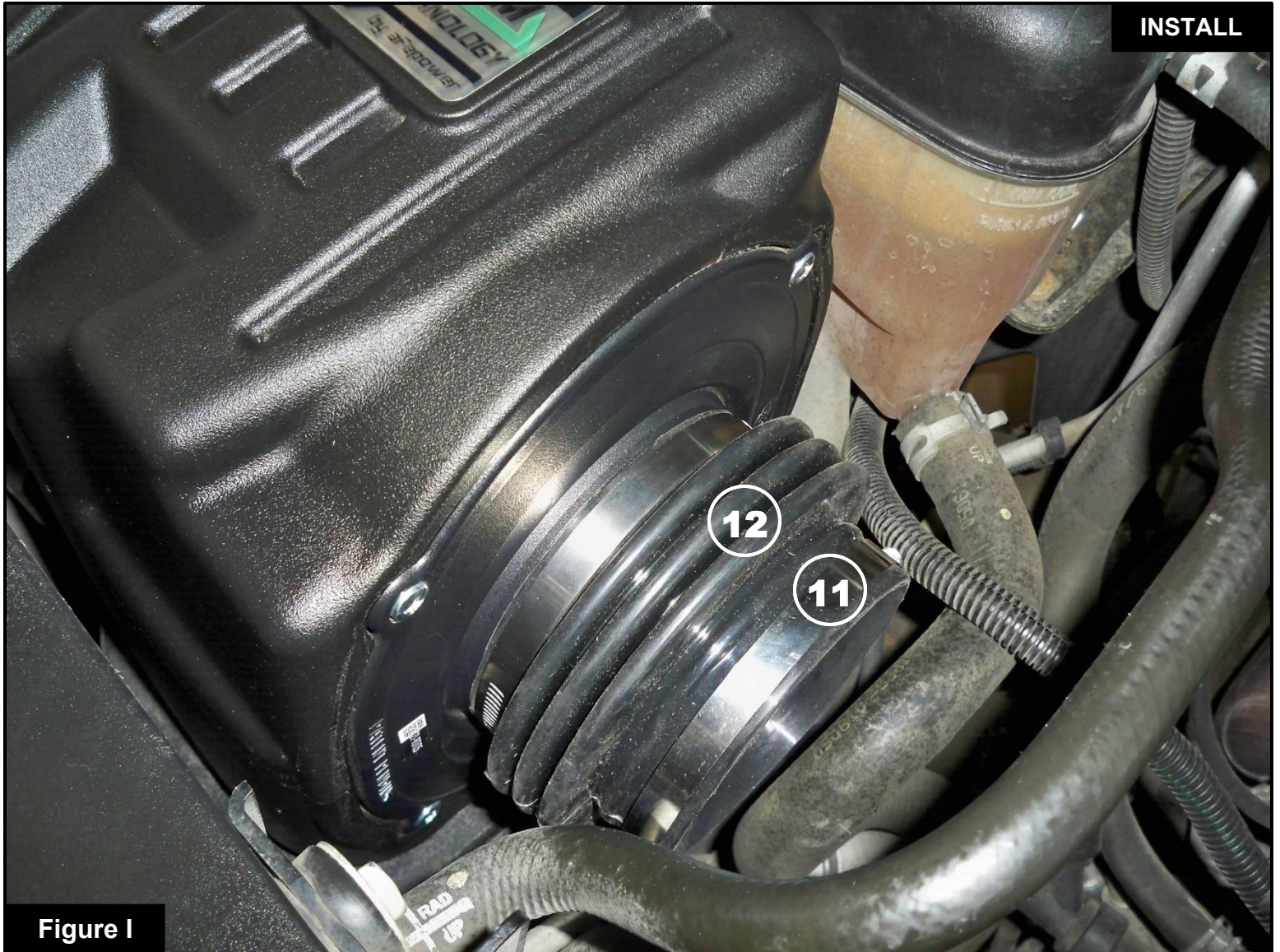
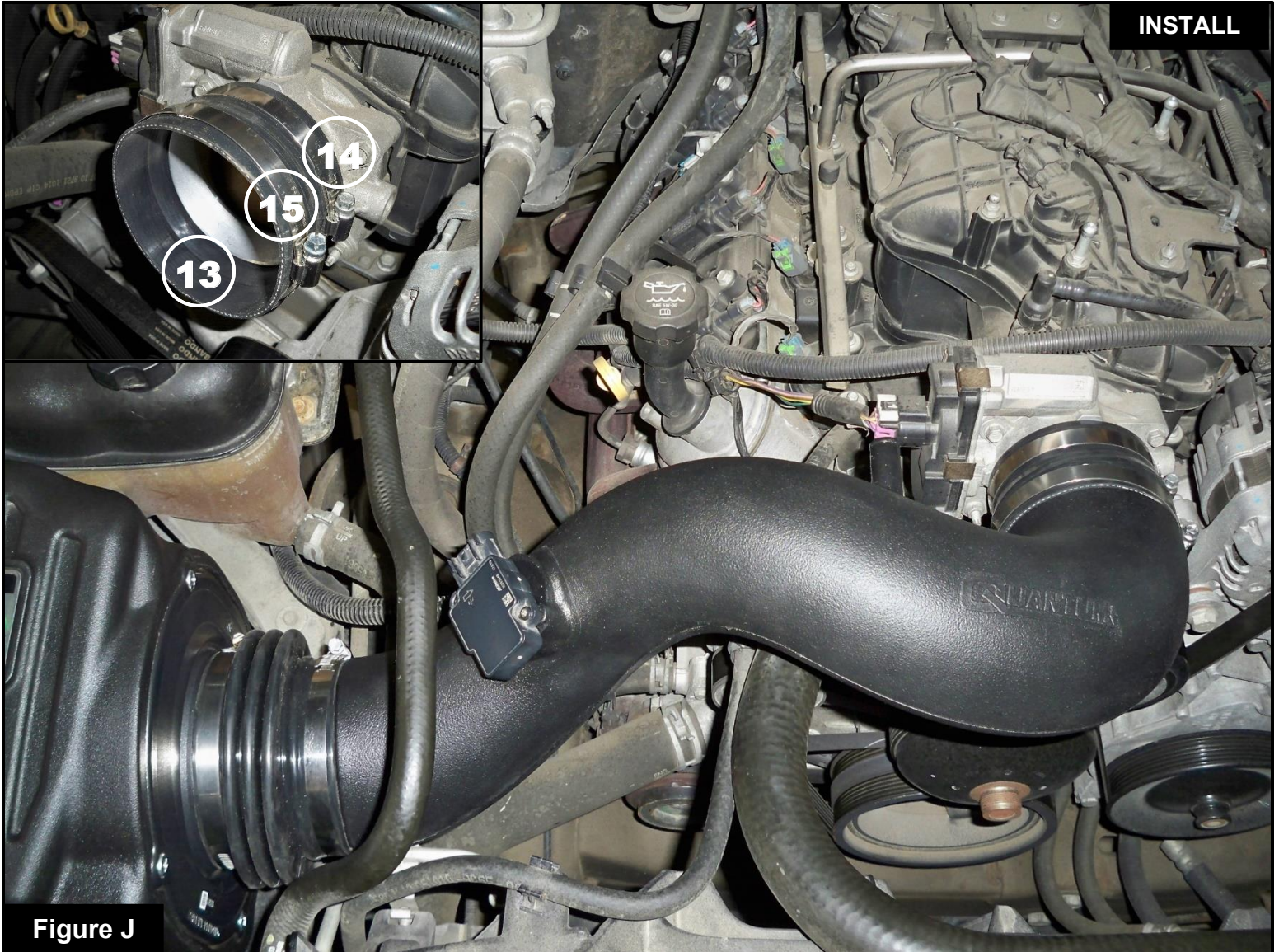

Figure I

Refer to Figure I for Step 15

Step 15: Place the #72 clamp (11) onto the filter coupling (12). Do NOT tighten the clamp.



Refer to Figure J for Steps 16-18

Step 16: Install the supplied reducer coupling (13) with the smaller diameter on the throttle body and the #60 clamp (14). Place the #64 clamp (15) on the other end of the coupling. Do not tighten the clamps at this time.

Step 17: Install the aFe intake tube into the vehicle. Slide the aFe intake tube into the filter coupling and then into the coupling on the throttle body.

Step 18: Align the aFe intake tube correctly then tighten all the clamps.

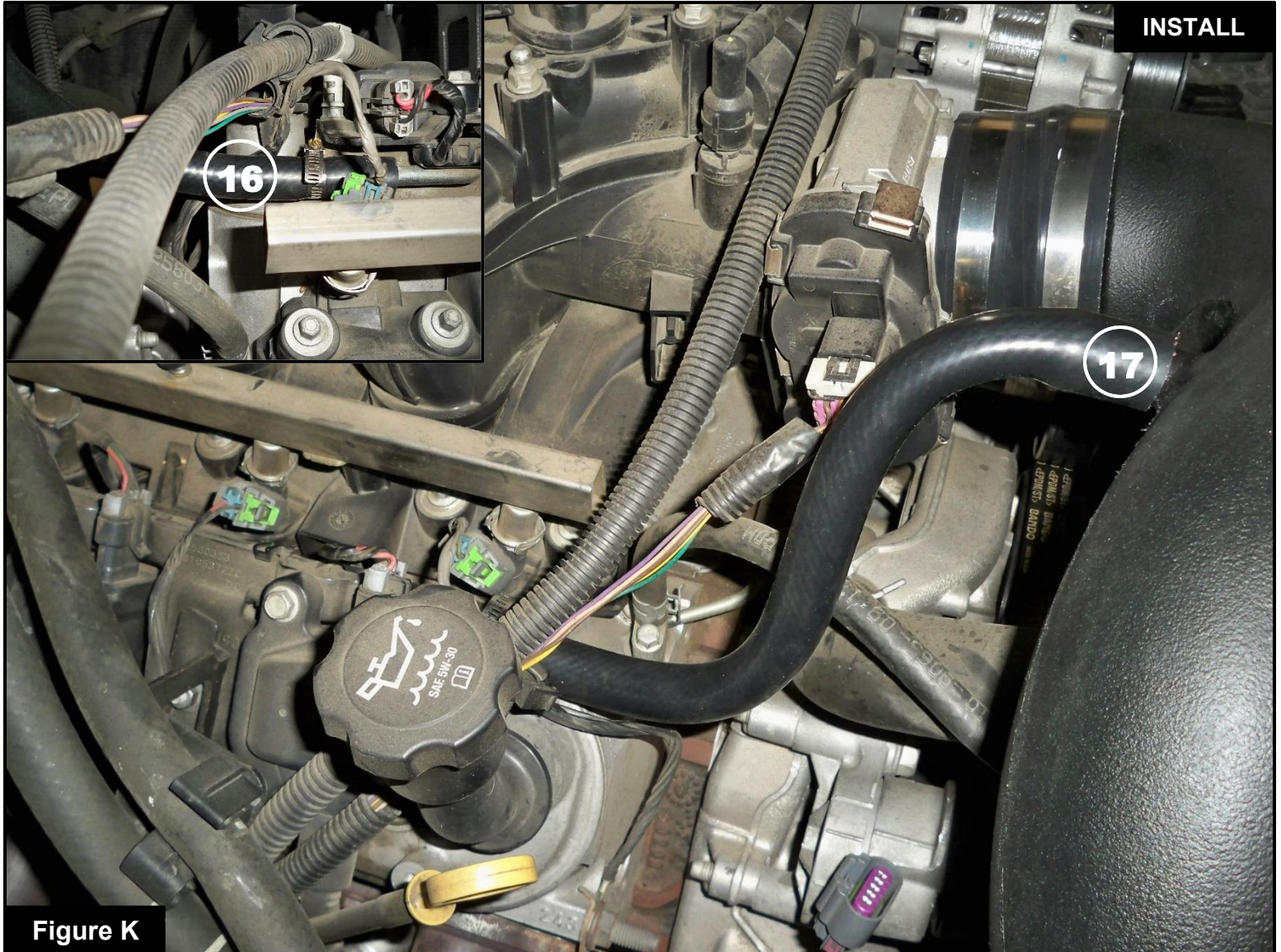

Refer to Figure K for Steps 19-20

Step 19: Using the supplied mini clamp, install one end of the supplied silicone breather hose (16) on the tube coming out of the valve cover where the stock vent hose was removed. (Make sure the hose goes over the bead on the tube). Tighten the mini clamp.

Step 20: Install the other end of the silicone breather hose (17) on the aFe intake tube.

**Figure L****Refer to Figure L for Steps 21-23**

Step 21: Reconnect the MAF sensor (18).

Step 22: Reinstall the engine cover (19).

Step 23: Check all the components are tight and secure. Your installation is now complete. Thank you for choosing aFe POWER!

NOTE: Check all screws, clamps, and connectors are secure after 100-200 miles.