

advanced FLOW engineering

Instruction Manual P/N: 53-10008S/53-10008SR/53-10008SL/53-10008SC

Make: Ford Model: F-150 EcoBoost	Year: 2015-2020	Engine: V6-2.7L(tt)/3.5L(tt)
Make: Ford Model: F-150	Year: 2018-2020	Engine: V6-3.3L
Make: Ford Model: F-150 Raptor	Year: 2017-2020	Engine: V6-3.5L(tt)
Make: Ford Model: F-150	Year: 2015-2020	Engine: V8-5.0L
Make: Ford Model: F-150	Year: 2015-2017	Engine: V6-3.5L
Make: Ford Model: F-150	Year: 2018-2020	Engine: V6-3.0L(td)



- Please read the entire instruction manual before proceeding.
- Ensure all components listed are present.
- If you are missing any of the components, call customer support.
- Ensure you have all necessary tools before proceeding.
- Do not attempt to work on your vehicle when the engine is hot.



Retain factory parts for future use.

Label	Qty.	Description	Part Number
A1	1	Scoop, Black	05-53112B3
A2	1	Scoop, Red	05-53112R3
A3	1	Scoop, Blue	05-53112L3
A4	1	Scoop, Carbon Fiber	05-5310008C3
B	2	Retainer Clip	03-50616
C	1	Seal, Trim: 7/16" (15.5")	05-00072

Installation will require the following tool(s):

8mm, 13mm nut driver or socket and extension, Flat screwdriver.

Note: Legal in California for use on race vehicles only. The use of this device on vehicles used on public streets or highways is strictly prohibited in California and others states that have adopted California emission regulations.

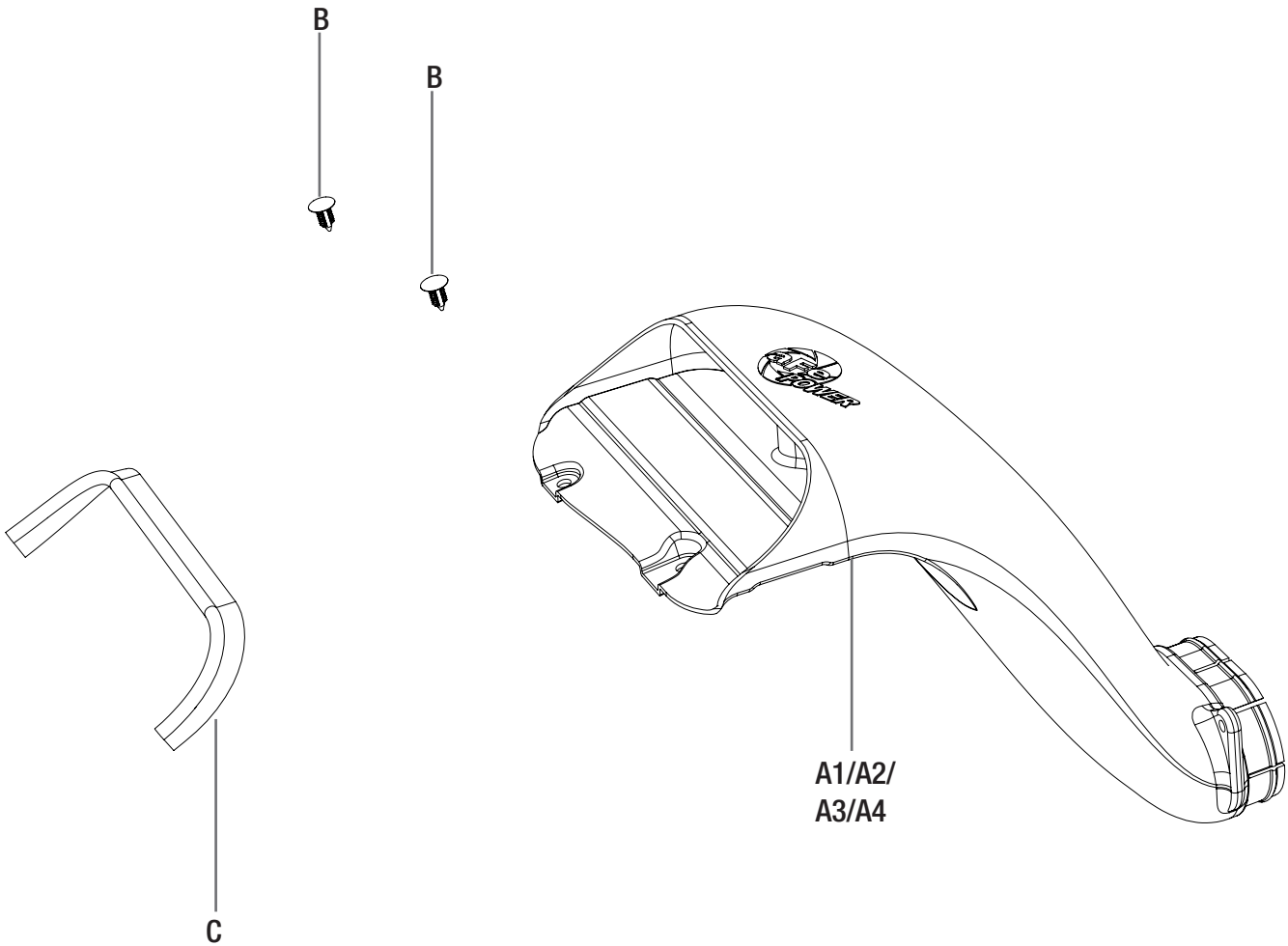



Figure A

Refer to Figure A.

This aFe POWER scoop is designed to work with the aFe POWER Quantum air intake kits, the aFe POWER Magnum FORCE air intake kits and the factory air intake system.

NOTE: This scoop does NOT fit aFe POWER Momentum intake systems.



Figure B

Refer to Figure B for Steps 1-2.

Step 1: Remove the aFe POWER or factory intake from the vehicle.

Step 2: Remove the screw securing the scoop to the factory housing then pull the scoop out of the factory housing.



Figure C

Refer to Figure C for Step 3.

Step 3: For installation on the factory housing, press the aFe POWER scoop into the factory housing and secure it using the factory screw.



Figure D

Refer to Figure D for Step 4.

Step 4: For the installation on the Quantum housing, push the aFe POWER scoop into the Quantum housing then secure it with the M6 screw and washer that was provided with the aFe Quantum intake kit.

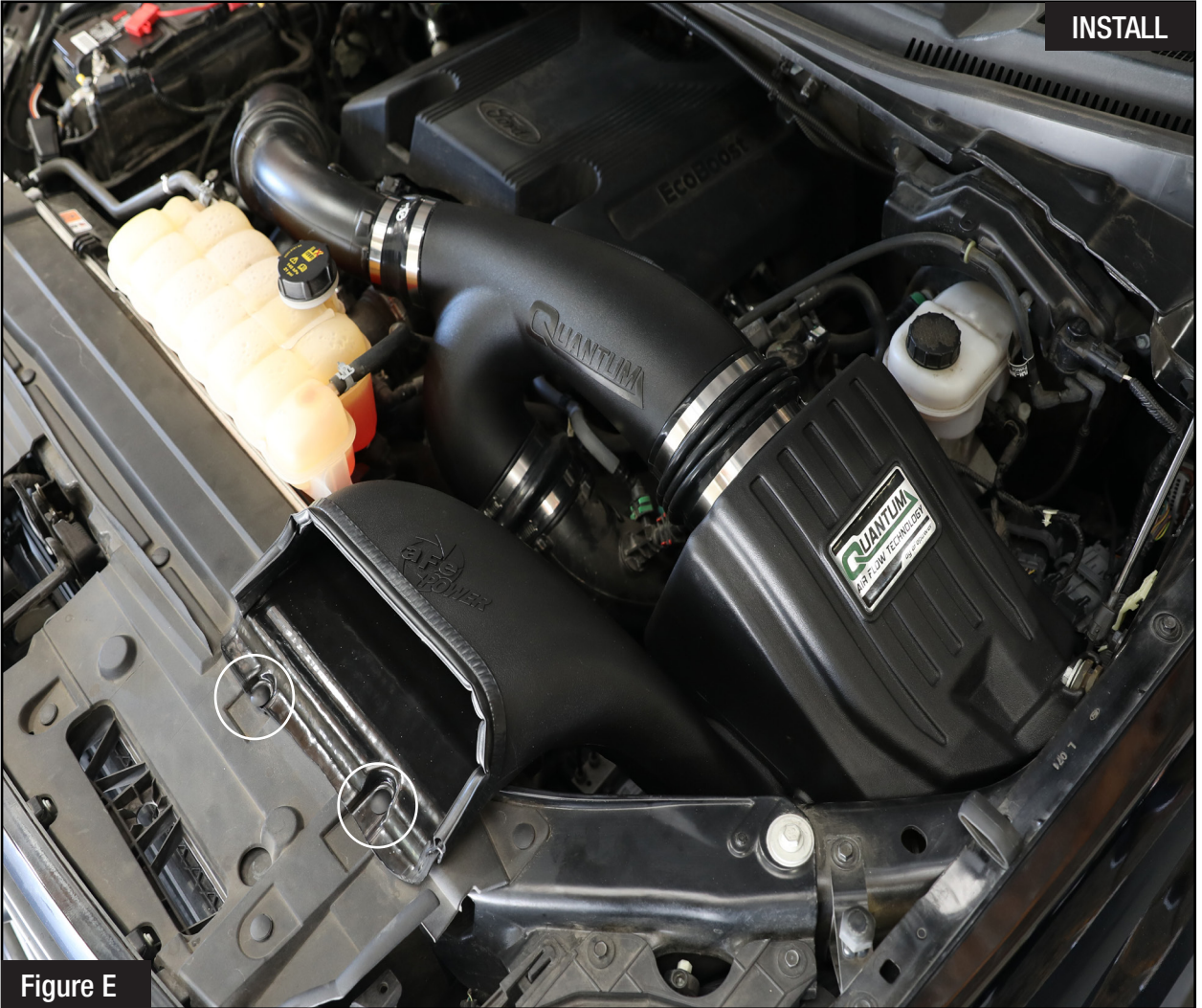
**Figure E****Refer to Figure E for Steps 5-7.**

Step 5: Reinstall the housing and scoop assembly into the vehicle. Secure the scoop using the provided plastic rivets.

Step 6: Install the seal trim on the top edge of the aFe POWER scoop.

Step 7: The installation of the aFe POWER scoop is complete. Finish installing the rest of the air intake system. Thanks for choosing aFe POWER.

NOTE: Check all bolts, clamps and connectors after 100-200 miles.



Quantum Intake System



P/N: 53-10008D (PDS)
53-10008R (P5R)

SCORCHER GT Module



P/N: 77-43023 (Raptor)
77-43025 (F-150 3.5L)
77-43017 (F-150 2.7L)

SCORCHER PRO Tune



P/N: 77-33001 (Raptor Only!)
77-33007 (2.7L Only!)
77-33008 (5.0L Only!)
77-33010 (3.5L Only!)

Turbo Downpipes



P/N: 48-43020-HC (Street)
48-43020-HN (Race)
For F-150 Raptor Only!

Exhaust System

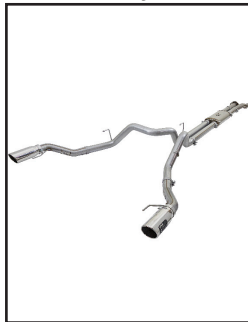

P/N: 49-43045-B (Bik. Tips)
49-43045-P (Pol. Tips)
49-43070-B (2.7L/3.5L)
49-43070-P (2.7L/3.5L)

Side Exit Exhaust System

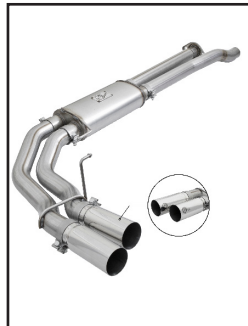

P/N: 49-43091-B (Bik. Tips)
49-43091-P (Pol. Tips)
49-43081-B (2.7L/3.5L/5.0L)
49-43081-P (2.7L/3.5L/5.0L)

Rear Differential Cover



P/N: 46-70152-WL (w/ Oil)
46-70152 (Black)
46-70150 (RAW)

Intercooler w/ Tube



P/N: 46-20292-B (Raptor)
46-20202-B (2.7L)
46-20292-B (3.5L)

Intercooler Cold-Side Tube



P/N: 46-20299-B (Raptor)

Oil Filter



P/N: 44-LF034 (2.7L Only!)

Oil Filter



P/N: 44-LF038 (3.5L Only!)

SPRINT BOOSTER V3



P/N: 77-13001