

**advanced FLOW engineering**

**Instruction Manual** P/N: 51-73203 / 54-73203

Make: **Ford** Model: **Mustang GT** Year: **2015-2017** Engine: **V8-5.0L**



- Please read the entire instruction manual before proceeding.
- Ensure all components listed are present.
- If you are missing any of the components, call customer support.
- Ensure you have all necessary tools before proceeding.
- Do not attempt to work on your vehicle when the engine is hot.

## Retain factory parts for future use.

Label	Qty.	Description	Part Number
A1	1	Air Filter (Pro 5R)	24-91062
A2	1	Air Filter (Pro DRY S)	21-91062
B	1	Tube	05-73203B1
C	1	Housing	05-73203B2
D	1	Clamp, T-bolt	03-50352
E	2	Clamp #56	03-50009
F	1	Coupling, Straight	05-01280
G	2	Fitting, Small	05-01338
H	1	Fitting, Large	05-01339
I	1	Plug, Urethane	05-01361
J	2	Screw, Torx: M4x.7x10mm	03-50490

Installation will require the following tools:

8mm nut driver, 7mm nut driver, 10mm deep socket & driver, 11mm deep socket, & driver, pliers, T20 Torx & driver, panel popper.

Note: Legal in California for use on race vehicles only. The use of this device on vehicles used on public streets or highways is strictly prohibited in California and others states that have adopted California emission regulations.

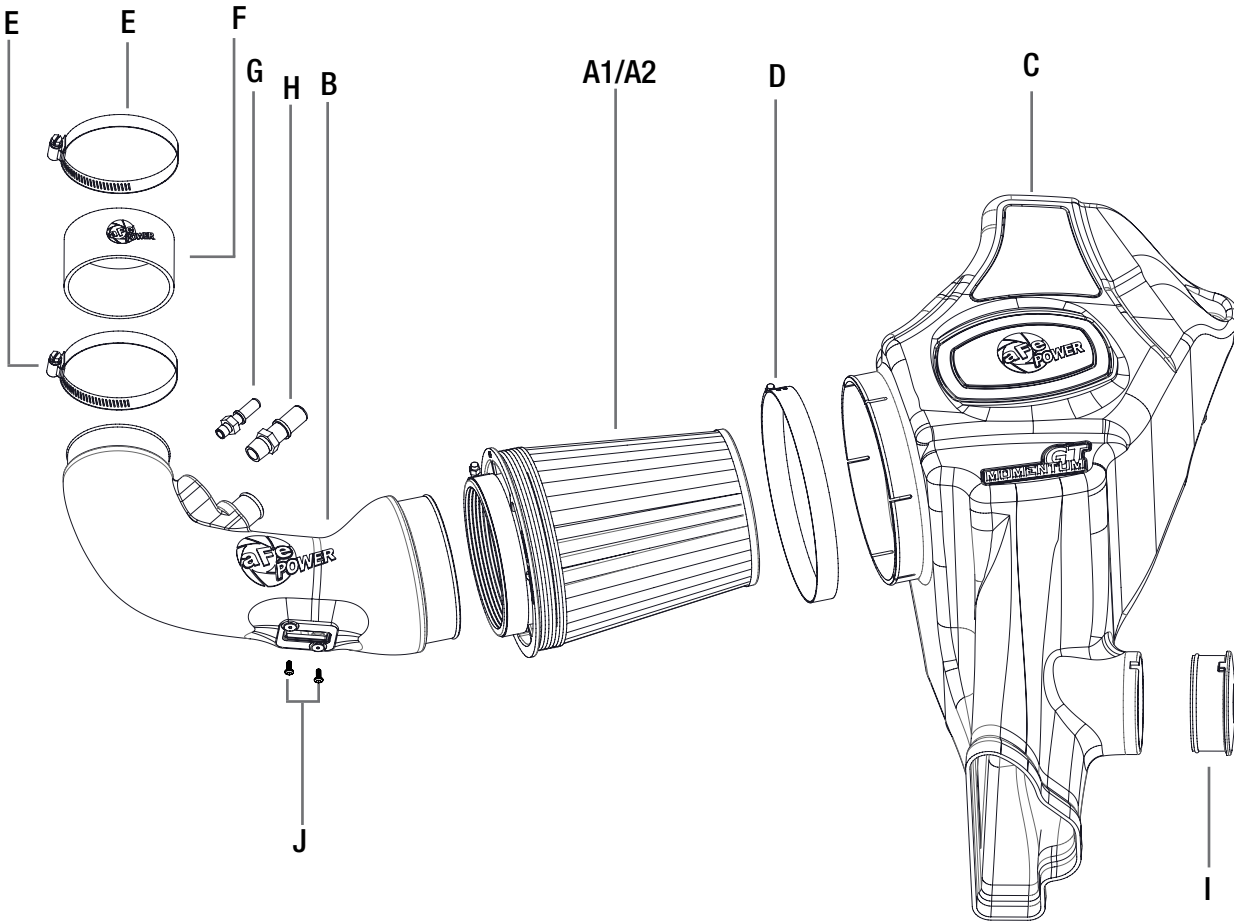



**Figure A**

**Refer to Figure A for Steps 1-5**

Step 1: Remove the engine cover.

Step 2: Loosen the two clamps (7mm nut driver) on the intake tube.

Step 3: Disconnect the three fittings on the intake tube.

Step 4: Slide the spring clamp [pliers] up and disconnect the 1" rubber hose from the intake tube.

Step 5: Remove the intake tube from the vehicle.



Figure B

**Refer to Figure B for Steps 6-9**

Step 6: Remove the bolt (10mm socket) that is securing the housing to the fender.

Step 7: Disconnect the Mass Air Flow (MAF) sensor and unclip the rest of the wire harness from the side of the factory air box.

Step 8: Remove the sound chamber from the air box by pulling straight up on the small box.

Step 9: Pull up on the air box and remove it from the vehicle.



**Refer to Figure C for Steps 10-11**

Step 10: Relocate the terminated connector, located on the fender well, to the hole nearest the front of the vehicle as shown. ②

Step 11: Disconnect the push clip located further down on the wire harness. This will allow slack to reconnect the MAF sensor later. ③



Figure D

**Refer to Figure D for Steps 12-14**

Step 12: Pull out the metal sleeve and rubber grommet from the factory air box.

Step 13: Remove the rubber guide bushing from the factory air box.

Step 14: Transfer the grommet, sleeve, and guide bushing to the new aFe housing.



Figure E

**Refer to Figure E for Steps 15-16**

Step 15: Remove the MAF sensor from the factory air box using a T20 torx bit.

Step 16: Install the MAF sensor into the new aFe intake tube using the new M4x10mm torx screws.





Figure F

**Refer to Figure F for Steps 17-18**

Step 17: Pre-install the three aluminum fittings into their proper locations on the intake tube.

Step 18: Install the new silicone coupler onto the small end of the intake tube and put the clamps in place on the coupler but do not tighten the clamps yet.

**NOTE: The supplied fittings are NPT threads and will not bottom out in the tube. DO NOT OVER TIGHTEN!**

**Figure G****Refer to Figure G for Steps 19-20**

Step 19: Install the new aFe housing into the vehicle making sure to line up the front snorkel over the factory air duct. The guide bushing will line up and sit flat on the fender when the snorkel is aligned properly.

Step 20: Use the factory bolt [10mm socket] to secure the new aFe housing in place.

**NOTE: Make sure the MAF sensor harness is pulled back out of the way before installing the housing. The wire harness will route over the top of the snorkel.**



Figure H

**Refer to Figure H for Steps 21-22**

Step 21: Place the large t-bolt clamp onto the housing but do not tighten.

Step 22: Install the new aFe air filter into the housing. Make sure the provided clamp is still in place on the filter flange.

**Figure 1****Refer to Figure 1 for Steps 23-24**

Step 23: Install the aFe intake tube into the filter first, connect all of the fittings and hoses, and then slide the coupler end of the tube over the throttle body.

Step 24: Make sure all of the hoses are fully seated on the fittings and that they cannot pull off.

**NOTE:** The tube that is going to the fitting located on the bottom may need to be rerouted to fit properly.



Figure J

**Refer to Figure J for Steps 25-27**

Step 25: Tighten all clamps, reconnect the MAF sensor, and make sure the 1" spring clamp is in place.

Step 26: Reinstall the engine cover.

Step 27: Your install is now complete!!

**NOTE: Check all bolts, clamps, and connectors after 200 miles.**



Pro DRY S Air Filter



P/N: 21-91062

Pro 5R Air Filter



P/N: 24-91062

Pre-Filter



P/N: 28-10043

Pro DRY S Restore Kit



P/N: 90-59999

Blue Squeeze Restore Kit



P/N: 90-50501

Throttle Body Spacer

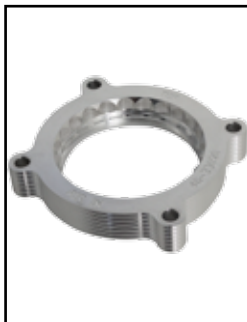

P/N: 46-33020

Headers



P/N: 48-33012-YC

Exhaust Cat-Back



P/N: 49-33072-B (BIK Tip)  
49-33072-P (Pol Tip)

Coilovers



P/N: 430-301001N

Sway Bars

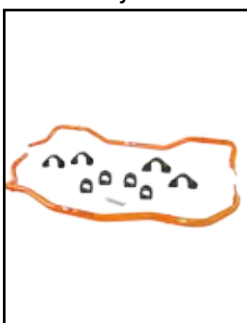

P/N: 440-301001N

Lowering Springs

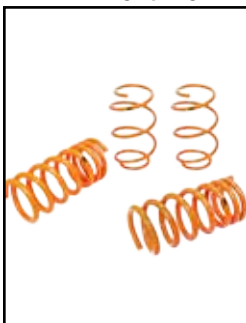

P/N: 410-301001N

Sprint Booster



P/N: 77-13004 (M/T)

# Warranty

## General Terms:

- aFe warrants their products to be free from manufacturer's defects due to workmanship and material.
- This warranty applies only to the original purchaser of the product and is non-transferrable.
- Proof of purchase of the aFe product is required for all warranty claims.
- Warranty is valid provided aFe instructions for installation and/or cleaning were properly followed.
- Proper maintenance with regular inspections of product is required to insure warranty coverage.
- Damage due to improper installation, abuse, unauthorized repair or alteration is not warranted.
- Incidental or consequential damages or cost, including installation and removal of part, incurred due to failure of aFe product is not covered under this warranty.
- All warranty is limited to the repair and/or replacement of the aFe part. To request Return Goods Authorization ("RGA"). Upon receipt of the RGA, you must return the product to the address provided in the RGA, freight prepaid and accompanied with a dated proof of purchase and the RGA. Upon receipt of the defective product and upon verification of proof of purchase, aFe will either repair or replace the defective product within a reasonable time, not to exceed thirty days.

<b>Product Category</b>	<b>P/N Prefix</b>	<b>Warranty duration</b>
Direct OE Replacement Filters	10, 11, 30, 31, 71, 73	Life of the vehicle
Racing Filters	18	1 year
Universal	21, 24, 72, TF	2 years
Air Intake Systems	50, 51, 54, 55, 75, TR, TA, TL	2 years
Exhaust Systems	49	2 years
Intercoolers & Intercooler Tubes	46-2	2 years
Intake Manifolds	46-1	2 years
Differential Cover	46-7	Life of the vehicle
Exhaust Manifolds	46	2 years
Throttle Body Spacers	46-3	2 years
Turbochargers	46-6	2 years*
Fluid Filters	44	90 days
Pre-Filters	28	2 years
Heavy Duty OE Replacement	70	2 years
PowerSports OE Replacement	81, 87	2 years
PowerSports Intake Systems	85	2 years

No other warranty expressed or implied applies nor is any person or advanced FLOW engineering authorized to assume any other warranty. Some States do not allow the exclusion or limitation of incidental or consequential damages or do not allow limitations on how long an implied warranty lasts, so the above limitations or exclusions may not apply to you. This warranty gives you specific legal rights, and you may also have other rights which vary from State to State.

\*See turbocharger warranty for more info

Feel the difference with aFe.

Buy quality performance air intake systems in our online store.