

**advanced FLOW engineering**

**Instruction Manual** P/N: 54-12202 & 51-12202

Make: **BMW** Model: **335i (F30)** Year: **2012-2015** Engine: **L6-3.0L (Turbo) N55**



- Please read the entire instruction manual before proceeding.
- Ensure all components listed are present.
- If you are missing any of the components, call customer support.
- Ensure you have all necessary tools before proceeding.
- Do not attempt to work on your vehicle when the engine is hot.



## Retain factory parts for future use.

Label	Qty.	Description	Part Number
A1	1	Air Filter (Pro 5R)	24-91074
A2	1	Air Filter (Pro DRY S)	21-91074
B	1	Tube	05-12202B1
C	1	Housing	05-12202B2
D	2	Screw, M4 x .7 x 10	03-50221
E	1	Screw, Hex Flg 1/4-20 x 3/4	03-50100
F	1	Grommet	03-50050
G	1	Cap 3/8"	03-50119
H	1	Fitting, Vacuum line	05-01246
I	1	Torx Bit	03-50066
J	1	Clip Nut 1/4-20	03-50389
K	1	Trim Seal 24"	05-00072

Installation will require the following tools:  
Phillips screw driver & 8mm nut driver.

Note: Legal in California for use on race vehicles only. The use of this device on vehicles used on public streets or highways is strictly prohibited in California and others states that have adopted California emission regulations.

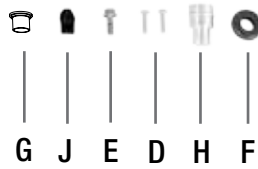
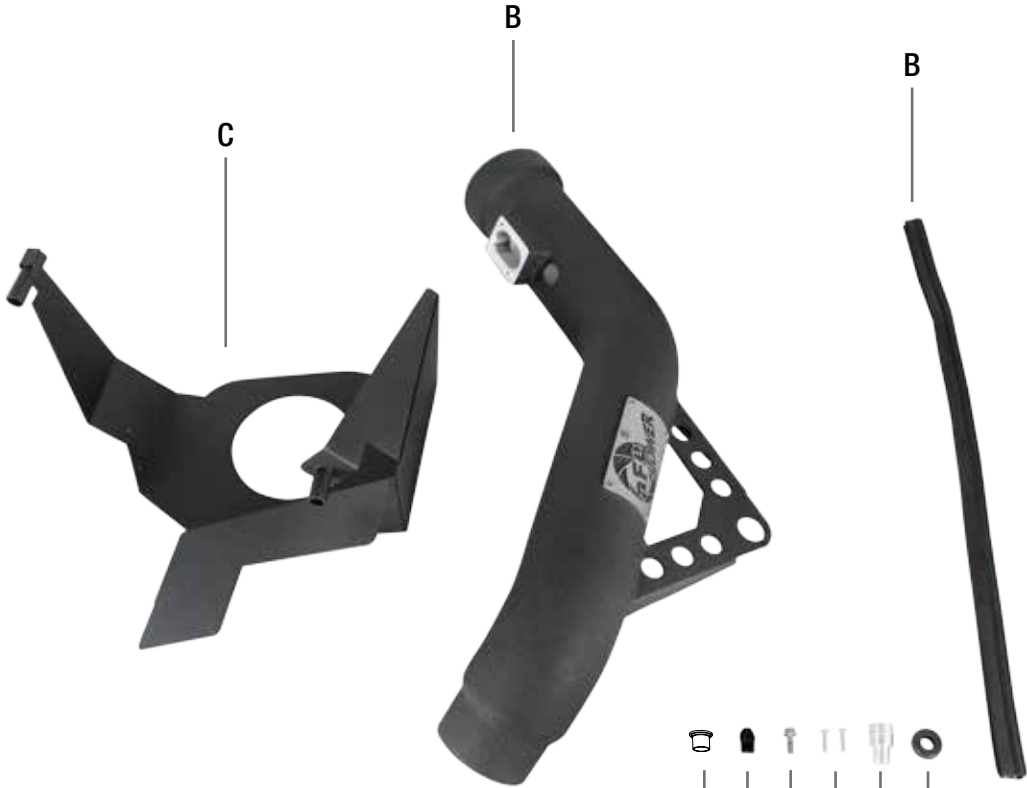

A1

A2



**Figure A****Refer to Figure A for step 1-3**

Step 1: Disconnect MAF sensor harness (1).

Step 2: Unplug the vacuum line (2) (Automatic vehicle only)

Step 3: Loosen the clamp on the factory intake tube (3).

Step 4: Remove your factory intake system out of the vehicle by pulling it off the mounting grommets.

DO NOT DISCARD YOUR ORIGINAL PARTS.



Figure B

**Refer to Figure B for steps 5-7**

- Step 5: Remove the MAF sensor off the factory intake tube using the furnished T20 torx bit and install onto the aFe intake tube with the furnished screws (4) .
- Step 6: Remove the OE grommet off the intake tube and install onto the aFe intake tube bracket (5) .
- Step 7: For vehicles with an automatic transmission, install the provided grommet and aluminum fitting into the hole of the aFe intake tube. For vehicles with a manual trasmission, simply cap off the hole with the grommet and plug provided (6) .

**Figure C****Refer to Figure C for step 8**

Step 8: Assemble the aFe housing. Install the trim seal on top of the edge of the housing.

Step 9: Install the aFe filter on the housing by sliding one side through the filter hole. Gently sliding the filter in the hole until its flat against the housing. The filter should be held in place by its molded retention lip and groove.





Figure D

**Refer to Figure D for steps 9-10**

Step 9: Install the aFe housing into the vehicle by pushing it into the factory grommets (7).

Step 10: Install the clip nut by sliding into the open channel of the supporting strut near the front of the aFe housing. Secure the aFe housing with the provided hardware (8).

Step 11: Slide the aFe intake tube into the aFe filter, make sure to push down.

**Figure E****Refer to Figure E for steps 11-12**

Step 12: Lift up the engine cover and re-route the MAF harness around the oil filter housing and re-connect it to the MAF sensor ⑨.

Step 13: Re-connect the vacuum line to the aluminum fitting ⑩ (Automatic vehicle only).

Step 14: Tighten all clamps.

Step 15: Verify all clamps are secure and re-check periodically. Your Installation is now complete.





Pro DRY S Air Filter



P/N: 21-91074

Pro 5R Air Filter



P/N: 24-91074

304 SS Cat-Back Exhaust



P/N: 49-36320-P

Pro DRY S Restore Kit



P/N: 90-59999

Blue Squeeze Restore Kit



P/N: 90-50501

Sprint Booster



P/N: 77-16301

Electronic Module



P/N: 77-46304

Intake System



P/N: 52-31912

Dynamic Air Scoop



P/N: 54-11478-L

Dynamic Air Scoop



P/N: 54-12208-C

Twisted Steel Header



P/N: 48-36311

Throttle Body Spacer



P/N: 46-31007

# Warranty

## General Terms:

- aFe warrants their products to be free from manufacturer's defects due to workmanship and material.
- This warranty applies only to the original purchaser of the product and is non-transferrable.
- Proof of purchase of the aFe product is required for all warranty claims.
- Warranty is valid provided aFe instructions for installation and/or cleaning were properly followed.
- Proper maintenance with regular inspections of product is required to insure warranty coverage.
- Damage due to improper installation, abuse, unauthorized repair or alteration is not warranted.
- Incidental or consequential damages or cost, including installation and removal of part, incurred due to failure of aFe product is not covered under this warranty.
- All warranty is limited to the repair and/or replacement of the aFe part. To request Return Goods Authorization ("RGA"). Upon receipt of the RGA, you must return the product to the address provided in the RGA, freight prepaid and accompanied with a dated proof of purchase and the RGA. Upon receipt of the defective product and upon verification of proof of purchase, aFe will either repair or replace the defective product within a reasonable time, not to exceed thirty days.

<b>Product Category</b>	<b>P/N Prefix</b>	<b>Warranty duration</b>
Direct OE Replacement Filters	10, 11, 30, 31, 71, 73	Life of the vehicle
Racing Filters	18	1 year
Universal	21, 24, 72, TF	2 years
Air Intake Systems	50, 51, 54, 55, 75, TR, TA, TL	2 years
Exhaust Systems	49	2 years
Intercoolers & Intercooler Tubes	46-2	2 years
Intake Manifolds	46-1	2 years
Differential Cover	46-7	Life of the vehicle
Exhaust Manifolds	46	2 years
Throttle Body Spacers	46-3	2 years
Turbochargers	46-6	2 years*
Fluid Filters	44	90 days
Pre-Filters	28	2 years
Heavy Duty OE Replacement	70	2 years
PowerSports OE Replacement	81, 87	2 years
PowerSports Intake Systems	85	2 years

No other warranty expressed or implied applies nor is any person or advanced FLOW engineering authorized to assume any other warranty. Some States do not allow the exclusion or limitation of incidental or consequential damages or do not allow limitations on how long an implied warranty lasts, so the above limitations or exclusions may not apply to you. This warranty gives you specific legal rights, and you may also have other rights which vary from State to State.

\*See turbocharger warranty for more info

Buy quality performance air intake systems in our online store.