

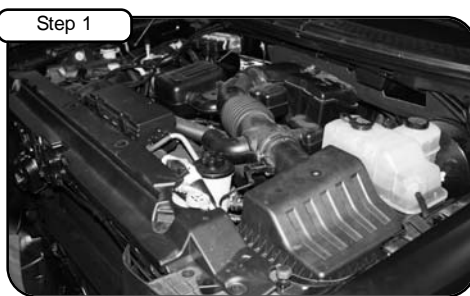

# Intake Kit Installation Instructions: 2009 Ford F-150; '07-'09 Expedition; '07-'09 Navigator V8-5.4L Stage 2

Kit P/N: 51/54-11622	<b>Tools Required:</b> 5/16" Nut Driver 4mm or 5/32" Allen Key 1/4" Nut Driver	<b>Parts List:</b> 1 Air Filter (Pro-5R™ 24-91040 or Pro Dry S™ 21-90053) 1 Housing 1 Coupler, Elbow (05-00464) 1 Coupler, Hump (05-00565) 1 Tube, Intake 3-1/2" 1 7/16" Trim Seal @ 24 5/8" L 1 Adaptor, Filter 3 Clamp, #056 5 Screws, Button Head M6	1 Torx Bit, T20 1 Clamp, #064 5 Washers, Wavy M6
----------------------	---	--	--



**Step 1**  
Complete Stock Intake. Disconnect the battery.

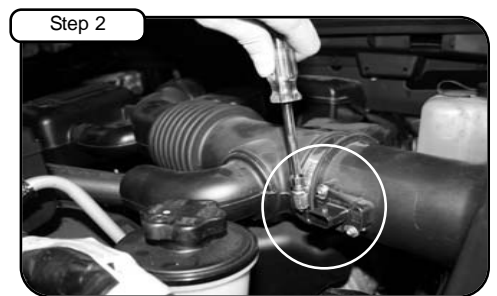

**Step 2**  
Disconnect the MAF sensor harness. Loosen the clamp on the airbox tube using a 5/16" nut driver.



**Step 3**  
Loosen the clamp on the throttle body tube using a 5/16" nut driver.



**Step 4**  
Disengage the 3 clips which secure the upper portion of the airbox. Remove the center clip which is not used with the aFe intake.

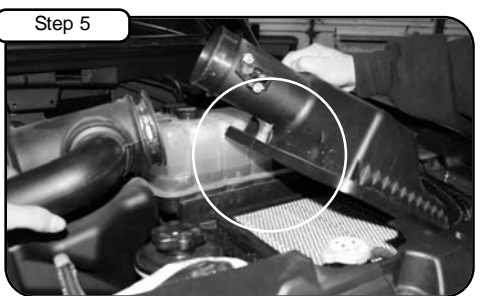

**Step 5**  
Remove the upper portion of the airbox from vehicle.

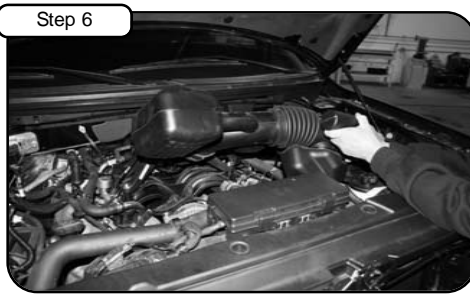

**Step 6**  
Remove the stock intake tube from the vehicle.

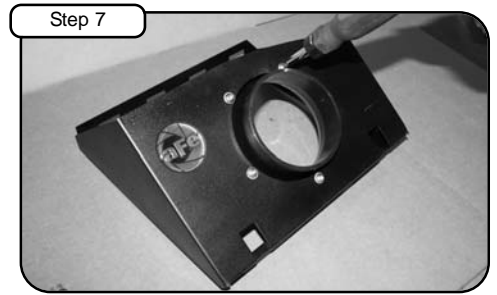

**Step 7**  
Attach the filter adaptor to the new housing using button head screws provided and tighten using a 4mm allen key.

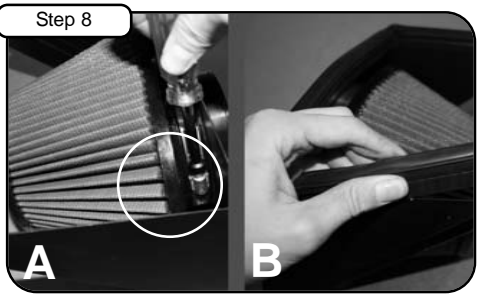

**Step 8**  
A) Attach the air filter to the adaptor and tighten using a 5/16" nut driver. B) Attach trim seal to housing.

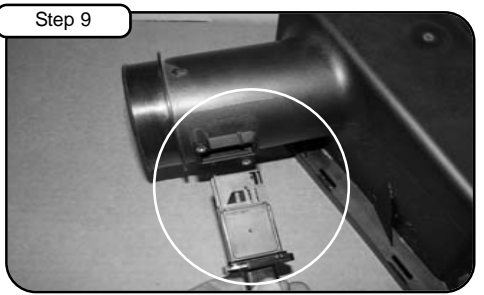

**Step 9**  
Remove the MAF sensor from the airbox using a T-20 torx bit and save hardware for later install.

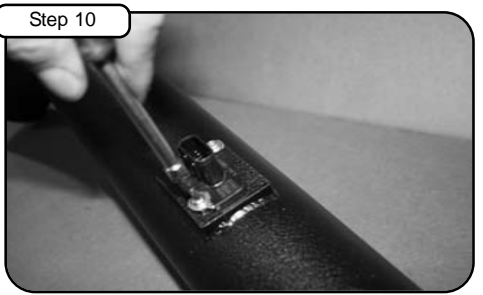

**Step 10**  
Install the MAF sensor into the new tube using the screws removed in step 9.



**Step 11**  
Attach the coupler with the clamps provided to the filter adaptor. Do not tighten clamps.

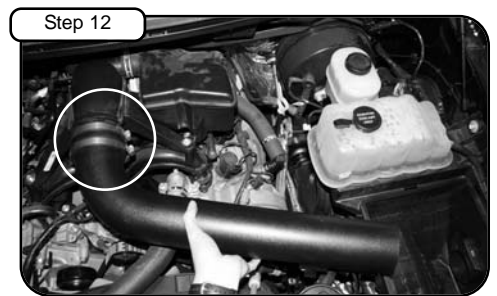

**Step 12**  
Attach the intake tube to the vehicle with the straight coupler and clamps provided. Do not tighten clamps.

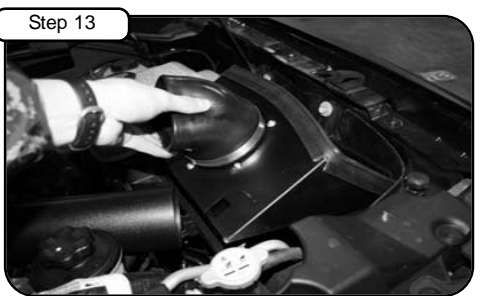

**Step 13**  
Install the new housing into vehicle. Engage the clips, secure housing and connect the intake tube to coupler.

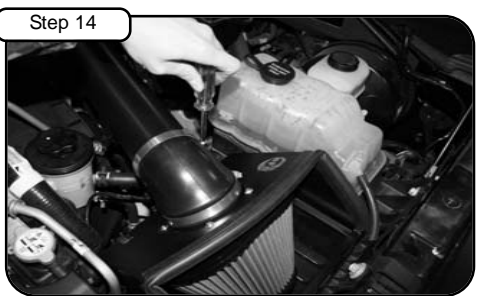

**Step 14**  
Position tube and tighten all clamps using 5/16" nut driver. Re-connect MAF sensor harness.

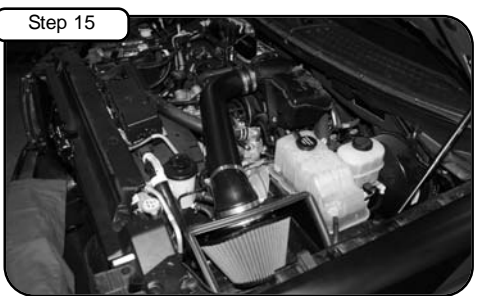

**Step 15**  
Your Intake is now complete. Please check all clamps periodically and tighten as needed. Thank you for choosing aFe power.