



Intake Kit Installation Instructions: 2003-2007 Dodge RAM L6-5.9L (td) Cummins

Kit Part # 51/54/75-10412 & 75-10412-0V	Tools Required 10mm socket or wrench 13mm socket or wrench 9/16" socket or wrench Ratchet and extension Small flat screwdriver Med flat screwdriver 5/16" nut driver	Part List: 1 Filter & clamp (PN 24-91032 or PN 72-90028 Pro-GUARD 7 PRO DRY S P/N 21-90028) 1 Filter housing 1 Intake tube 2 Screws for sensor pad (8-32 x 5/8") 2 Hex head screw, (3/8-16 x 1-1/2") 2 Nuts, locking (3/8" - 16) 4 Washer, (3/8" - 7/8") 3 1/4-20 combination head machine screw	3 1/4" split lock washer 1 Trim seal 47" long 3 1/4" flat washer 1 Temp sensor gasket 1 Torque Tube 1 4" x 3" straight coupler 1 4" x 2 1/2" high temp straight coupler 4 Clamps #064	Included in P/N 75-10412-0V Value Pack Only: 1 Spare Filter P/N 21-90028 1 Pre-filter P/N 28-10051 1 Cleaning Kit 90-50500
--	--	---	--	--



Complete kit components

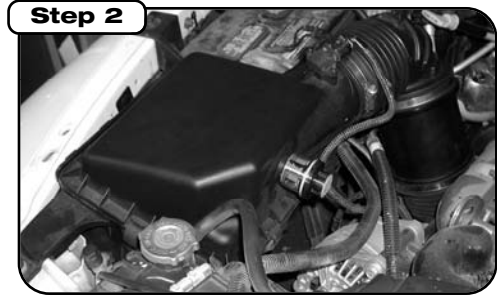

Complete stock intake. Make sure that the engine has sufficiently cooled down prior to starting installation of this kit.

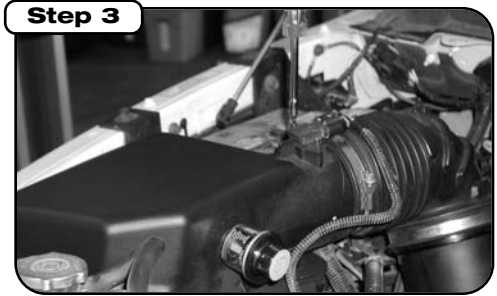

Disconnect the factory wiring harness from the intake temperature sensor located on the top of the airbox. Remove the intake temperature sensor from the airbox and set aside.

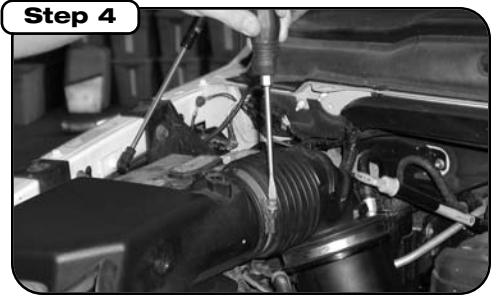

Loosen clamp holding factory tube to factory airbox and clamp at turbo. Remove complete system.



Using 10 mm wrench, remove the bolt that secures the factory airbox to the radiator bulkhead.



Remove factory airbox

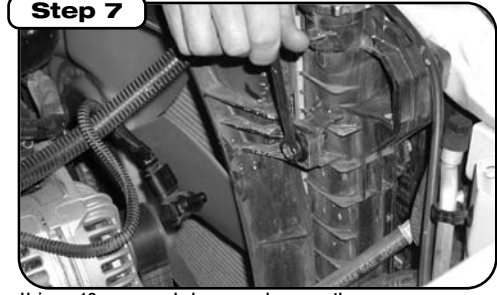

Using a 13mm wrench, loosen and remove the upper passenger-side bolt on the radiator shroud and set aside for installation of heat shield. Verify that the engine is cool, then temporarily remove the overflow hose from the radiator filler neck for clearance.

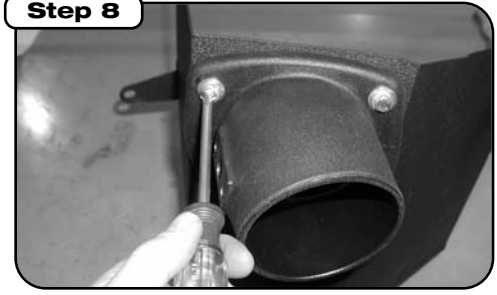

Install aFe intake tube and trim seal on the heat shield, be sure to install in the orientation shown. Install heat shield into engine compartment but do not attach any bolts. The bottom louvered panel must be positioned above the aluminum A/C line.



Using the bolt removed from the fan shroud earlier, secure the heat shield to the shroud using the tab extending from the heat shield, do not fully tighten.

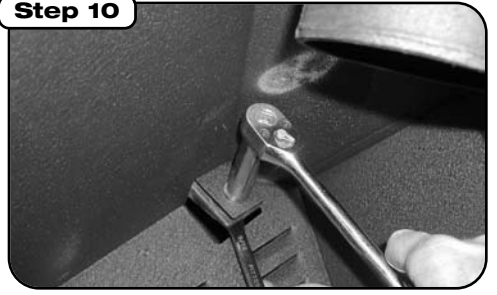

Using provided bolts, locking nuts and washers on both sides of the bolt, fasten lower tab on heat shield and slotted hole to the existing rubber mounts. Be careful not to over-tighten, it is only necessary that the rubber mounts be slightly compressed. Fully tighten shroud.

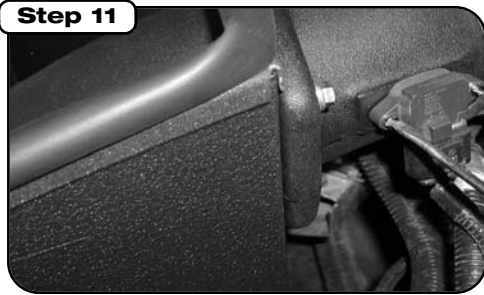

Install intake temperature sensor that was removed from the airbox onto the aFe intake tube using provided hardware and gasket, then tighten. Orientation does not matter on the temperature sensor. Re-connect factory harness to the temperature sensor.

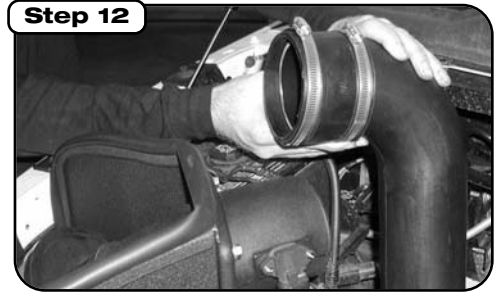

With clamps and couplers provided install high temp coupler at turbo side and 4"x3" urethane coupler at filter side, tighten using 5/16" nut driver. Install pre-oiled filter onto intake tube and tighten. Do not use any oil or grease when attaching filter. Reattach radiator overflow hose that was removed in Step 7.

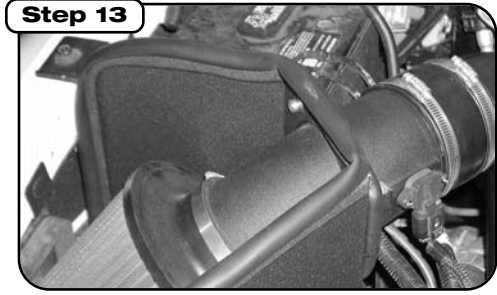

Complete intake kit installed. Be sure to re-check connections and re-tighten after a few hours of operation. Thank you for choosing aFe!

Place the included CARB EO Sticker on or near the intake system on a smooth, clean surface. E.O. identification label is required in passing the Smog Check Inspection.

Note: Filter Cleaning and Re-oiling: When cleaning your aFe filter, be sure to use only aFe's "Restore Kit" (aFe P/N: 90-50001 blue oil aerosol, or aFe P/N: 90-50501 blue squeeze bottle oil or aFe P/N: 90-50000 gold oil aerosol, or aFe P/N: 90-50500 gold squeeze oil). Filter Replacement: Magnum FLOW PN: 24-91032 (black w/blue media) or Pro-GUARD 7™ PN: 72-90028. ProDry S P/N 21-90028 (black w/ white media) Pro Dry S Cleaning: See cleaning instruction sheet 06-00074