

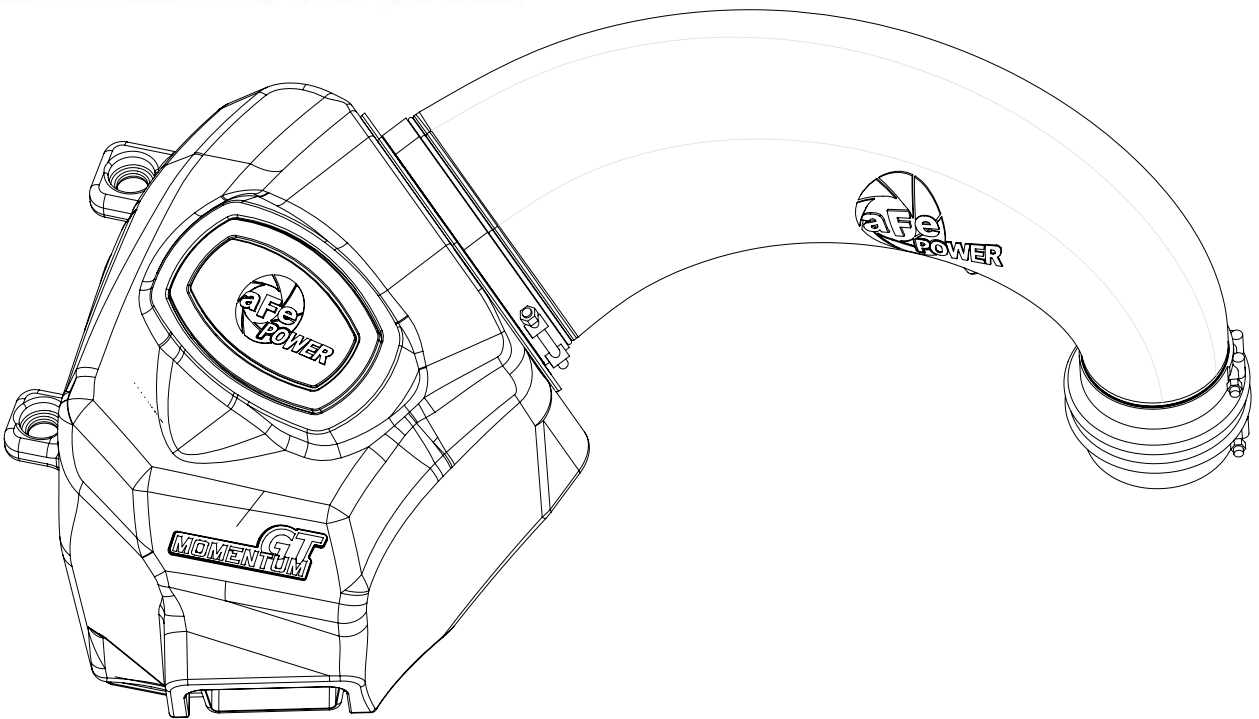

**GT**  
**MOMENTUM™**



**advanced FLOW engineering** Momentum GT Intake System

**Instruction Manual** P/N: 50-70013D / 50-70013R

Make: **RAM** Model: **1500** Year: **19-20** Engine: **V8-5.7L HEMI**

**NOTE: Will NOT fit RAM 1500 Classic models.**



- Please read the entire instruction manual before proceeding.
- Ensure all components listed are present.
- Ensure you have all necessary tools before proceeding.
- Do not attempt to work on your vehicle when the engine is hot.
- Disconnect the negative battery terminal before proceeding.

## Retain factory parts for future use.

Label	Qty.	Description	Part Number
A1	1	Air Filter (Pro DRY S)	21-91092
A2	1	Air Filter (Pro 5R)	24-91092
B	1	Tube	05-5070013B1
C	1	Housing	05-5070013B2
D	1	Plug, Silicone	05-01429
E	1	Coupling, Silicone Bellow	05-01389
F	1	Grommet, Rubber	03-50167
G	1	Fitting, Air Temp. Sensor	05-01454
H	1	Fitting, Vent	05-01339
I	2	Clamp, T-bolt (3-9/16"-3-7/8")	03-50498

### Installation will require the following tools:

8mm nut driver or socket, 11mm deep socket and driver, 20mm wrench or adjustable wrench.

Note: Legal in California for use on race vehicles only. The use of this device on vehicles used on public streets or highways is strictly prohibited in California and others states that have adopted California emission regulations.

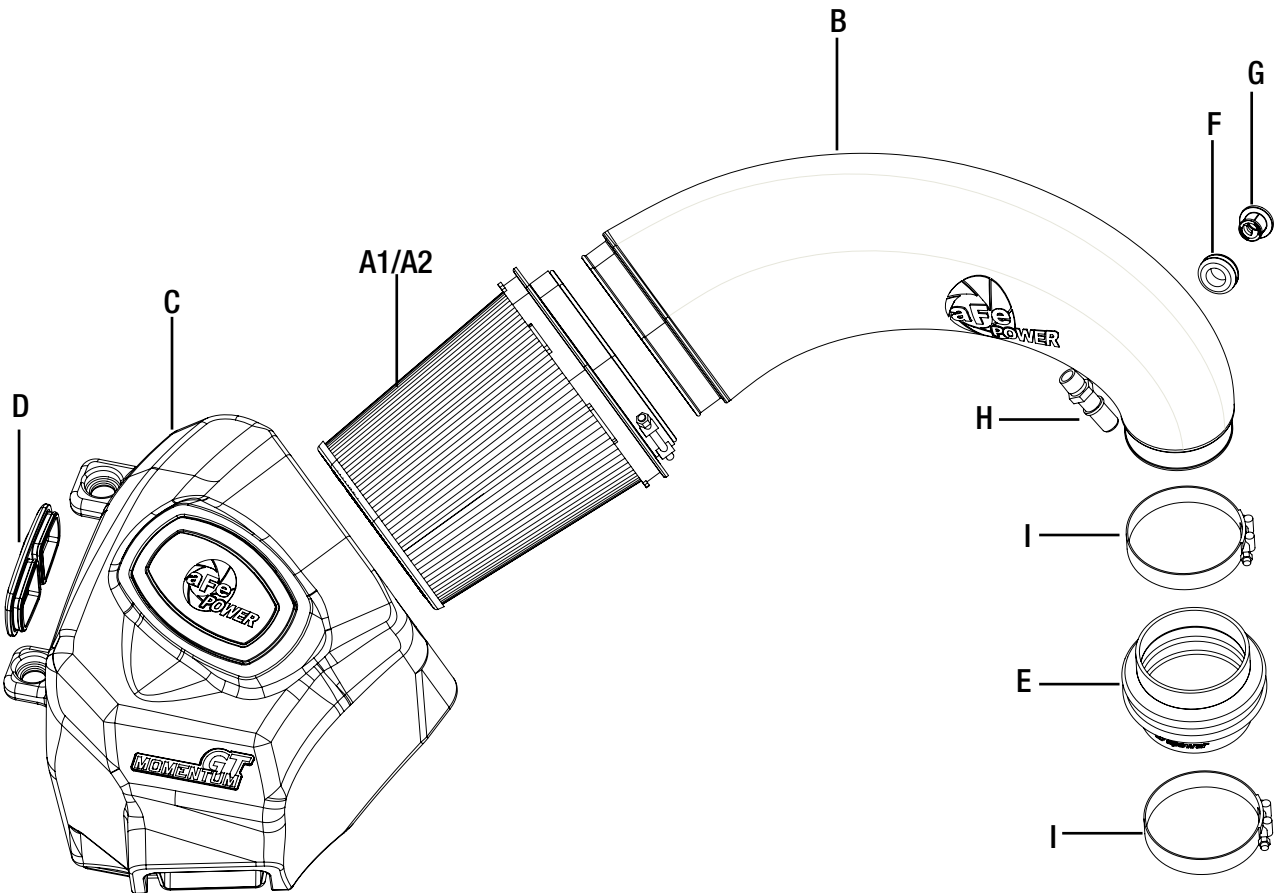

**Figure A**

**Refer to Figure A for Steps 1-4.**

- Step 1: Using an 8mm nut driver, loosen the stock clamps ① at the throttle body and filter housing.
- Step 2: Disconnect the temperature sensor harness ② from the stock intake tube.
- Step 3: Disconnect the crank case vent line ③ by disengaging the quick release connector and gently pulling the line away from the fitting on the stock intake tube.
- Step 4: Remove the stock intake tube by pulling up on the throttle body side, and away from the stock filter housing.



Figure B

**Refer to Figure B for Step 5.**

Step 5: Remove the stock filter housing by gently pulling straight upwards until the housing disengages from 4 mounting pegs and the inlet scoop towards the front of the vehicle. Set aside.



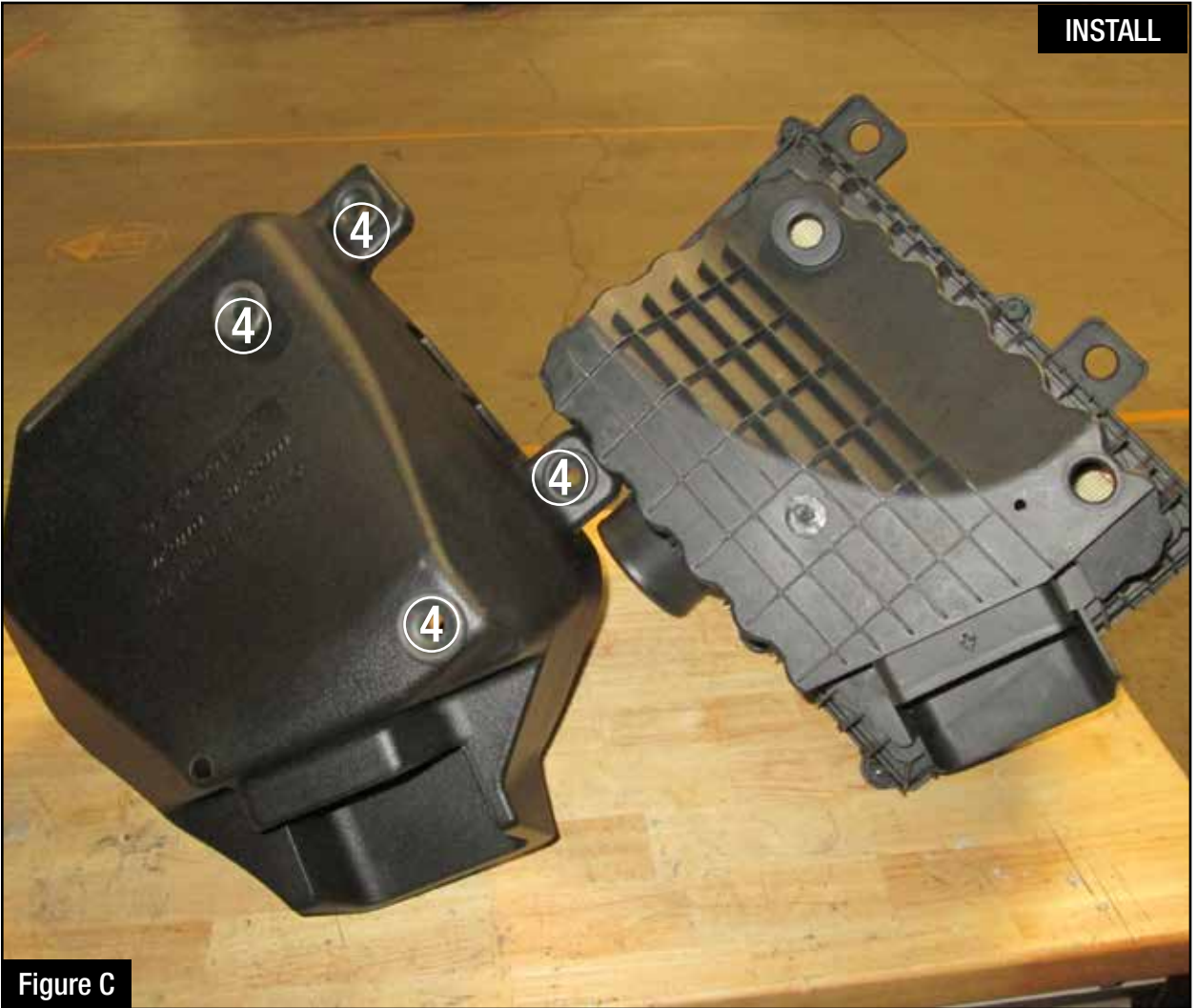

Figure C

**Refer to Figure C for Step 6.**

Step 6: Transfer all 4 rubber grommets (4) from the stock filter housing to your aFe POWER airbox as shown.



Figure D

**Refer to Figure D for Steps 7-9.**

Step 7: Install the provided rubber grommet and sensor fitting (5) into the aFe intake tube as shown.

Step 8: Install the provided NPT fitting (6) into your aFe intake tube in the threaded insert as shown.  
Tighten using a 20mm wrench or adjustable wrench.

Step 9: Remove the temperature sensor (7) from the stock intake tube by rotating a quarter turn and gently pulling outward. Reinstall the sensor into the aFe intake tube rotating a quarter turn to lock it into place.



Figure E

**Refer to Figure E for Step 10.**

Step 10: Install your aFe air filter and clamp (8) into the airbox before installing into the vehicle.





Figure F

**Refer to Figure F for Step 11.**

Step 11: Install the airbox into the vehicle by lining up the 4 mounting points and the air inlet scoop and gently pressing down until fully seated.

**Figure G****Refer to Figure G for Steps 12-13.**

- Step 12: Install the aFe coupler (9) onto the throttle body using one of the supplied T-bolt clamps (10). Tighten the clamp at the throttle body using an 11mm deep socket and driver.
- Step 13: Place the remaining T-Bolt clamp (11) onto the coupler, but do not tighten



**Refer to Figure H for Step 14.**

Step 14: Install the aFe intake tube into both the air filter and throttle body coupler. Tighten the clamps at both ends using an 11mm deep socket and driver.





Figure I

**Refer to Figure I for Step 15.**

Step 15: Reconnect the temperature sensor wire harness (12) and crank case vent connector hose (13).

INSTALL



Figure J

**Refer to Figure J for Step 16.**

Step 16: (Optional) Use the provided plug (14) to close off the additional air inlet if you wish to completely seal the airbox. Best performance gains are obtained without the plug. Check that all components are tight and secure. Your installation is now complete. Thank you for choosing aFe POWER!

**NOTE: Check all bolts, clamps, and connectors after 100-200 miles.**





Pro DRY S Air Filter



P/N: 21-91092

Pro 5R Air Filter



P/N: 24-91092

Pro DRY S Restore Kit



P/N: 90-59999

Blue Squeeze Restore Kit



P/N: 90-50501

Pre-Filter



P/N: 28-10283

Shorty Headers



P/N: 48-32023

Exhaust Y-Pipe

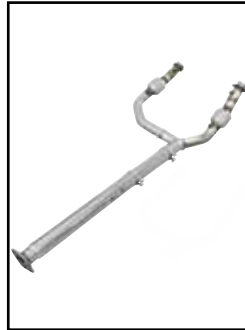

P/N: 48-42024-RC (Street)  
48-42024-RN (Race)

Exhaust Cat-Back



P/N: 49-42059-B (Blk. Tips)  
49-42059-P (Pol. Tips)

Oil Filter



P/N: 44-LF012