



## INSTALLATION INSTRUCTIONS

**MAKE:** GM  
**MODEL:** Silverado HD/Sierra HD  
**YEAR:** 2011-2016  
**ENGINE:** V8-6.6L (td) LML  
**WHEELBASE:** All except Cab & Chassis  
**Does not fit 2016 3500HD w/ NOX Sensor**

### 4" DPF-Back Aluminized

49-04043-P (Polished Tips)

49-04043-B (Black Tips)

### 4" DPF-Back Stainless Steel

49-44043-P (Polished Tips)

49-44043-B (Black Tips)

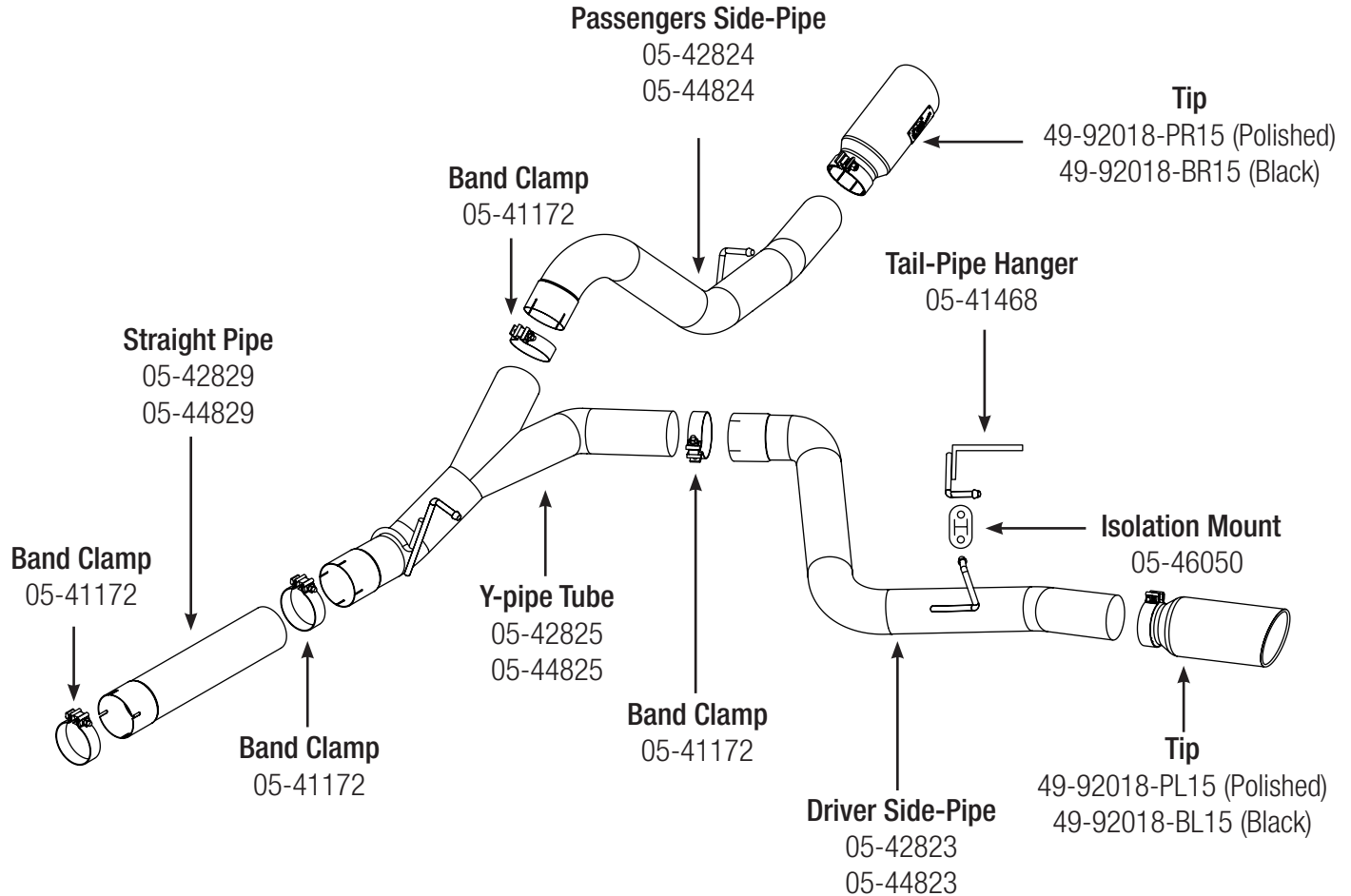

- Step 1: Read Instructions prior to installation** Loosen mounting flange at rear of particulate filter before muffler. Remove the stock exhaust from the rear of the truck working your way forward. Take caution not to damage the factory isolation mounts and gasket as they will be reused. **It is recommended to not fully tighten the clamps until the entire system has been installed.**
- Step 2: Requires Cutting** Measure 4" inches from the rear of your factory hanger, at the end of your DPF system. DO NOT cut the factory hanger off your exhaust. You will need to mark and cut off your tailpipe. This will allow you to separate and remove the tailpipe without removing your entire exhaust system.
- Step 3:** For faster installation spread the exhaust components alongside of your vehicle according to the diagram above.
- Step 4:** Install the passenger side tailpipe utilizing the factory isolation mounts.
- Step 5:** Install the "Y-pipe" tube onto the passenger tailpipe. Use the factory isolation mount to hang the Y-pipe in position.
- Step 6: Requires Cutting** Depending on your wheelbase the straight pipe may need to be trimmed to length. With the tailpipe and Y-pipe in position measure the distance from the end of the DPF to the inlet of the Y-pipe. You will need to add 6" inches to the length of the straight-pipe so it can slip into the Y-pipe. **(Measure twice cut-once).**
- Step 7:** Push back the tailpipe and install the straight pipe. Slip the tailpipe on and slightly secure the pieces together using band clamps. Do not completely tighten.

- Step 8:** Mount the driver side tailpipe hanger bracket. Use the two factory mounts on the frame that secure the trailer hitch. Loosen the bolts and install bracket. Re-tighten the bolt when completed. (See figure A).
- Step 9:** Install the driver side tailpipe, slip the tailpipe onto the Y-pipe and hang it on the isolation mount. Slightly secure the tailpipe into position.
- Step 10: Spare tire clearance** Included in the kit is a **ratcheting strap**. Slightly loosen the spare tire so it hangs from the bed. Attach the strap to the inner frame and wrap it around the spare tire securing it to the opposite inner frame. Position the spare tire in the center of the two tailpipes. Tighten the strap so it pulls the spare tire to the rear of the bed or against hitch. Tighten the spare tire into position locking it place. (See figure C).
- Step 11: Parking & brake line clearance** For additional clearance remove the brake line bracket attached to the rear differential cover. Position the emergency brake line behind the bracket. Re-attach the brake line bracket to the housing. Bend the brake line bracket back so it changes the angle of the hoses. This will create additional clearance from the exhaust. (See figure B below).
- Step 12: Heat shield adhesive** To further secure and create additional clearance, combine the brake lines together using a **4" x 12"** strip of heat shield adhesive. Wrap it around the two brake lines together on the driver-side. **Zip tie** over the adhesive on each end when completed. With the **2" x 12"** strip of adhesive wrap it around the parking brake line and **zip tie** on each end and to secure the wrap. (See figure D).
- Step 13:** The lines secured and exhaust installed position the exhaust tailpipes and tips. Secure the exhaust tightening all the clamps from the DPF back using an impact gun. Next position the tips and tighten using an impact gun or large ratchet. Double check angle for correct look.
- Step 14:** After 50-100 miles check the exhaust and retighten the clamps if necessary.



(figure A)

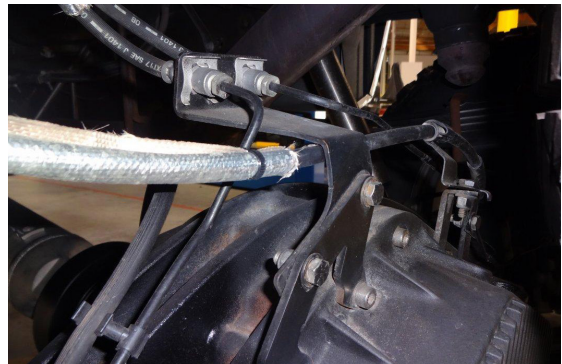

(figure B)



(figure C)



(figure D)

**NOTES:**

- aFe recommends that the tail-pipe be at least 1/2"-1" away from any body panels to avoid heat related body damage. **Tighten and secure.**

**Caution:** Allow time for your vehicle to cool down prior to installation. When working on or under your vehicle proceed with caution. Exhaust systems reach high temperatures and may cause serious burns. Wear protective safety equipment; eye goggles and gloves to ensure a safe installation. **aFe recommends professional installation on our products.**