



INSTALLATION INSTRUCTIONS

Cat -Back Exhaust

MAKE: Jeep
MODEL: Grand Cherokee
YEAR/ENGINE: 2011-2020 V8-5.7L
 2014-2020 V6-3.6L

49-38085-B
 49-38085-P

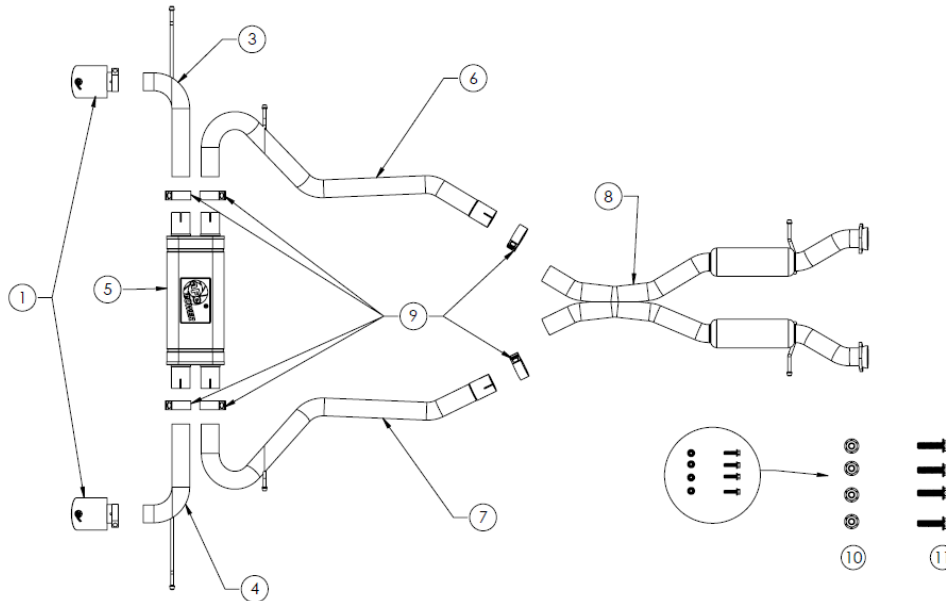

Item	Description	Part Number	Quantity
1	Exh Tip 2.5" In x 4.5" Out x 7" L Blk	49T25454-B071	2
2	Exh Tip 2.5" In x 4.5" Out x 7" L Pol	49T25454-P071	2
3	Driver's Side Tail pipe	05-145794	1
4	Passenger's Side Tail Pipe	05-145795	1
5	Muffler, 409 S/S: 2.5" In/Out 18"L	R49M91028-B	1
6	Driver's Side Mid Pipe	05-145792	1
7	Passenger's Side Mid Pipe	05-145793	1
8	X-Pipe	05-145791	1
9	Band Clamps 2.5"	05-41061	6
10	Nut, Flange 7/16-14	03-50208	4
11	Screw, Flanged Hex Cap 7/16-14 x 2-1/2	03-50209	4

aFe POWER recommends professional installation on this product. Thoroughly inspect the aFe POWER exhaust system to make sure there is no damage from shipping (if damage is noted, immediately contact aFe POWER customer service). Allow time for your vehicle to cool down prior to installation. When working on your vehicle proceed with caution. Wear protective safety equipment; eye goggles and gloves to ensure a safe installation.

Install band clamps to proper torque specifications of 40-45 ft-lb.





INSTALLATION INSTRUCTIONS

Cat -Back Exhaust

MAKE: Jeep
MODEL: Grand Cherokee
YEAR/ENGINE: 2011-2020 V8-5.7L
2014-2020 V6-3.6L

49-38085-B
49-38085-P

1. **(Read instructions prior to installation.)** It is recommended to not fully tighten the exhaust until it has been fully installed. Leave loose for adjustability.
2. Secure vehicle on jack stands (refer to your manual for specified jack stand positions).
3. For faster installation, spread out the parts of the exhaust alongside your vehicle as shown in the diagram above.
4. Secure the stock exhaust with jack/stands.
5. Remove the O.E. exhaust up to the flanged joint.
6. Now unbolt the front driver's side and passenger's side O.E. isolation mounts and flip them. The driver's side should go to the passenger's side and the passenger's side goes to the driver's side.
7. Now you can install the aFe POWER X-Pipe using the (x4) nuts and bolts that are provided. Slide the hangers into the O.E. isolation mounts.
8. Next, Install the driver and passenger side mid-pipes into the aFe POWER muffler using the (x4) provided 2.5" band clamps. (Do not completely tighten the band clamps, leave loose for adjustability.)
9. Now install the mid-pipes and muffler onto the X-Pipe. Slide the hangers into the O.E. isolation mounts.
10. Now install the driver's side and Passenger's side Tail Pipe and tips using the provided 2.5" band clamps. Slide the hangers into the O.E isolation mounts.
11. Ensure that all the components of the aFe POWER exhaust system are aligned and are at a safe clearance from all wires, hoses, brake lines, body parts, and tires.
12. Start from the front of the aFe exhaust system and evenly tighten all clamps and fasteners.
13. Start the vehicle and check for any leaks. If any leaks are found, determine cause and repair as necessary.
14. Remove vehicle from jacks stands.
15. It is recommended to re-tighten all clamps and hardware after 50-100 miles.