



# INSTALLATION INSTRUCTIONS

Cat-Back Exhaust

49-36903

MAKE: Alfa Romeo

MODEL: Giulia

YEAR: 2017-2021

ENGINE: L4-2.0L (t)

**NOTE: Does not fit vehicles with all-wheel drive**

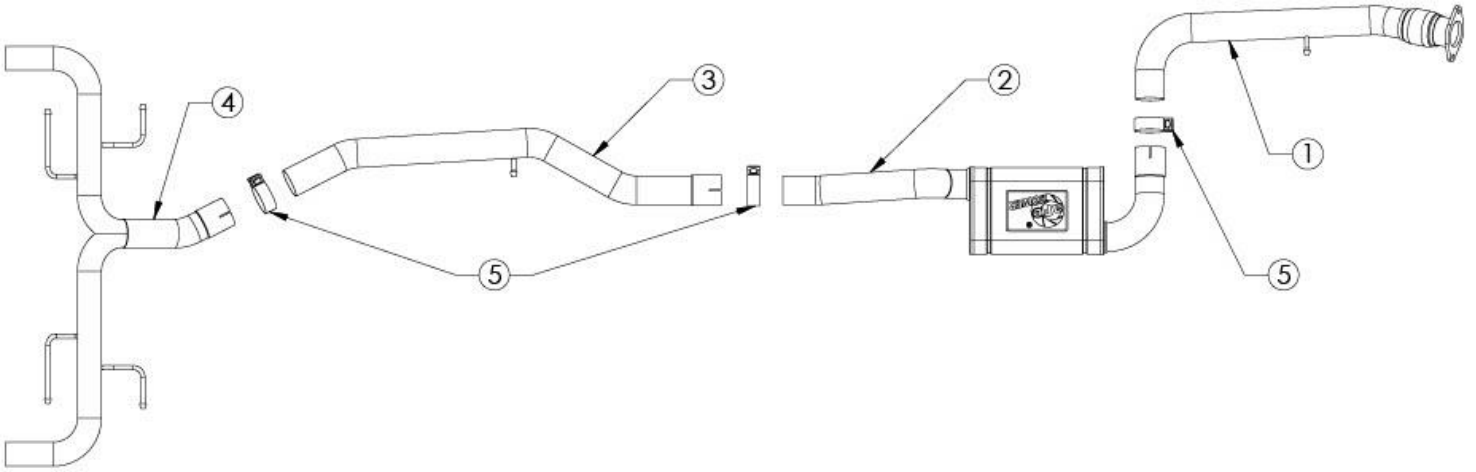

| Item | Description      | Part Number | Quantity |
|------|------------------|-------------|----------|
| 1    | Front Pipe       | 05-245171   | 1        |
| 2    | Muffler Assembly | 05-245195   | 1        |
| 3    | Mid-Pipe         | 05-245180   | 1        |
| 4    | Tailpipe         | 05-245153   | 1        |
| 5    | Clamp Band: 3"   | 05-41055    | 3        |

aFe POWER recommends professional installation on this product. Thoroughly inspect the aFe POWER exhaust system to make sure there is no damage from shipping (if damage is noted, immediately contact aFe POWER customer service). Allow time for your vehicle to cool down prior to installation. When working on your vehicle proceed with caution. Wear protective safety equipment; eye goggles and gloves to ensure a safe installation.

Install band clamps to proper torque specifications of 40-45 ft-lb.

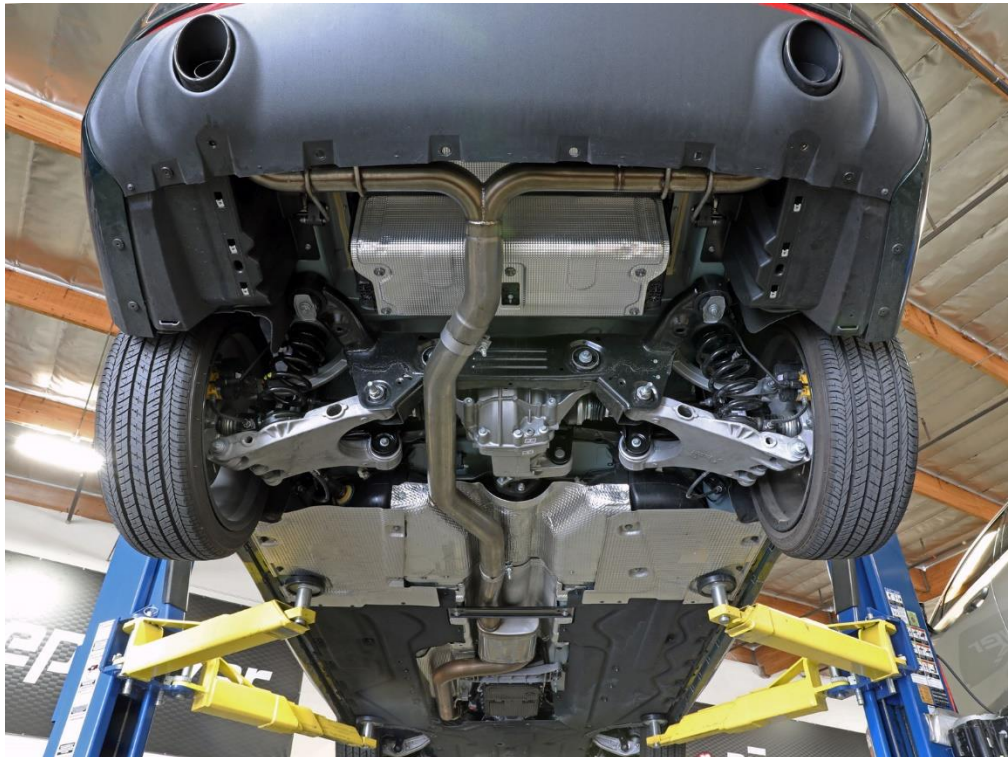



## INSTALLATION INSTRUCTIONS

Cat-Back Exhaust

49-36903

**MAKE:** Alfa Romeo

**MODEL:** Giulia

**YEAR:** 2017-2021

**ENGINE:** L4-2.0L (t)

**NOTE: Does not fit vehicles with all-wheel drive**

1. **(Read instructions prior to installation.)** It is recommended to not fully tighten the exhaust until it has been fully installed. Leave loose for adjustability.
2. Secure vehicle on jack stands (refer to your manual for specified jack stand positions).
3. For faster installation, spread out the parts of the exhaust alongside your vehicle as shown in the diagram above.
4. Secure the stock exhaust with jack/stands.
5. Remove rear bumper shield.
6. Remove the front splash shield
7. Remove (x4) bolts holding support brace.
8. Remove (x2) bolts on the front flange with a 13mm socket.
9. Remove (x1) OE hanger rod from the isolation mount located on the OE front pipe.
10. Remove (x1) OE hanger rod from the isolation mount located on the OE mid-pipe.
11. Remove (x4) OE hanger rods from the isolation mounts located on the OE rear muffler.
12. Install aFe Power Front Pipe and insert the hanger rod into the OE isolation mount.
13. Install aFe Power Muffler Assembly onto the aFe Power Front Pipe using the provided 3" band clamp.
14. Install the aFe Power Mid-Pipe onto the aFe Power Muffler Assembly using the provided 3" band clamp and insert the hanger rod into the OE isolation mount.
15. Install the aFe Power Tailpipe onto the aFe Power Mid-pipe using the provided 3" band clamp and insert the hanger rods into the OE isolation mounts.
16. Tighten the 3" band clamps slightly.
17. Reinstall the front splash shield.
18. Reinstall the rear bumper shield.
19. Reinstall the support brace.
20. Ensure that all the components of the aFe POWER exhaust system are aligned and are at a safe clearance from all wires, hoses, brake lines, body parts, and tires.
21. Start from the front of the aFe exhaust system and evenly tighten all clamps and fasteners.
22. Start the vehicle and check for any leaks. If any leaks are found, determine cause and repair as necessary.
23. Remove vehicle from jacks stands.
24. It is recommended to re-tighten all clamps and hardware after 50-100 miles.