



advanced FLOW engineering

Instruction Manual P/N: 46-20416-B

BladeRunner – Turbo Muffler Delete For OE Tubes

Make: **Volkswagen** Model: **GTI** Year: **2015-2020** Engine: **L4 – 2.0L(t)**

Make: **Volkswagen** Model: **Golf R** Year: **2015-2019** Engine: **L4 – 2.0L(t)**

Make: **Volkswagen** Model: **Jetta GLI** Year: **2019-2020** Engine: **L4 – 2.0L(t)**

Make: **Audi** Model: **A3** Year: **2015-2020** Engine: **L4 – 2.0L(t)**

Make: **Audi** Model: **S3** Year: **2015-2020** Engine: **L4 – 2.0L(t)**



- Please read the entire instruction manual before proceeding.
- Ensure all components listed are present.
- Ensure you have all necessary tools before proceeding.
- Do not attempt to work on your vehicle when the engine is hot.
- Disconnect the negative battery terminal before proceeding.
- Retain factory parts for future use.

Label	Qty.	Description	Part Number
A	1	Adaptor, Turbo Outlet: 46-20414	05-61104-1
B	1	Flange, Turbo Outlet: 46-20414	05-61104-2
C	1	O-Ring, Buna-N (-226)	05-61036
D	1	Coupling, Silicone 2.50" X 1.875" X 15 Deg	05-61113
E	1	Clamp, Spring Loaded T-Bolt: 2.06"	03-50613
F	1	Clamp, Spring Loaded T-Bolt: 2.50"	03-50560
G	3	Screw, M6x1.0x20	03-50241
H	3	Washer, M6	03-50177

Installation will require the following tools:

T30 socket, 7mm socket, 7/16" deep socket, 5mm allen wrench, 6" extension, ratchet, pick, flat head screwdriver

Note: Legal in California for use on race vehicles only. The use of this device on vehicles used on public streets or highways is strictly prohibited in California and others states that have adopted California emission regulations

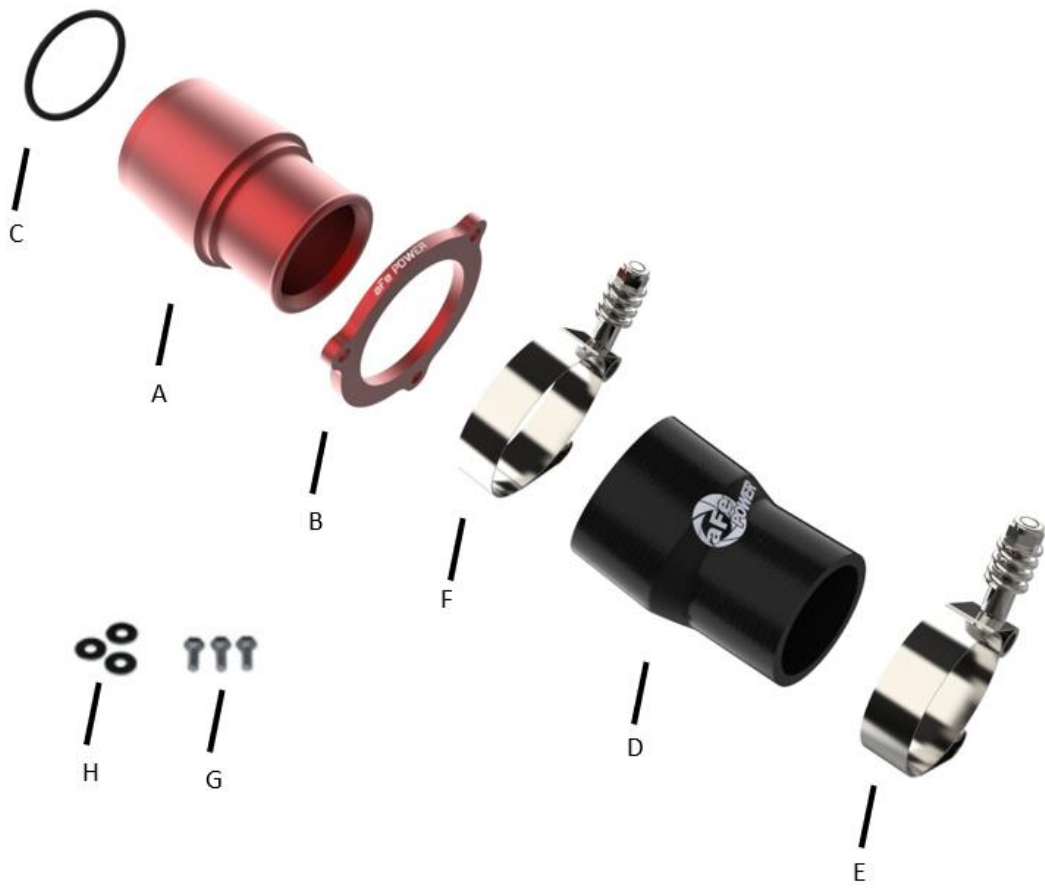

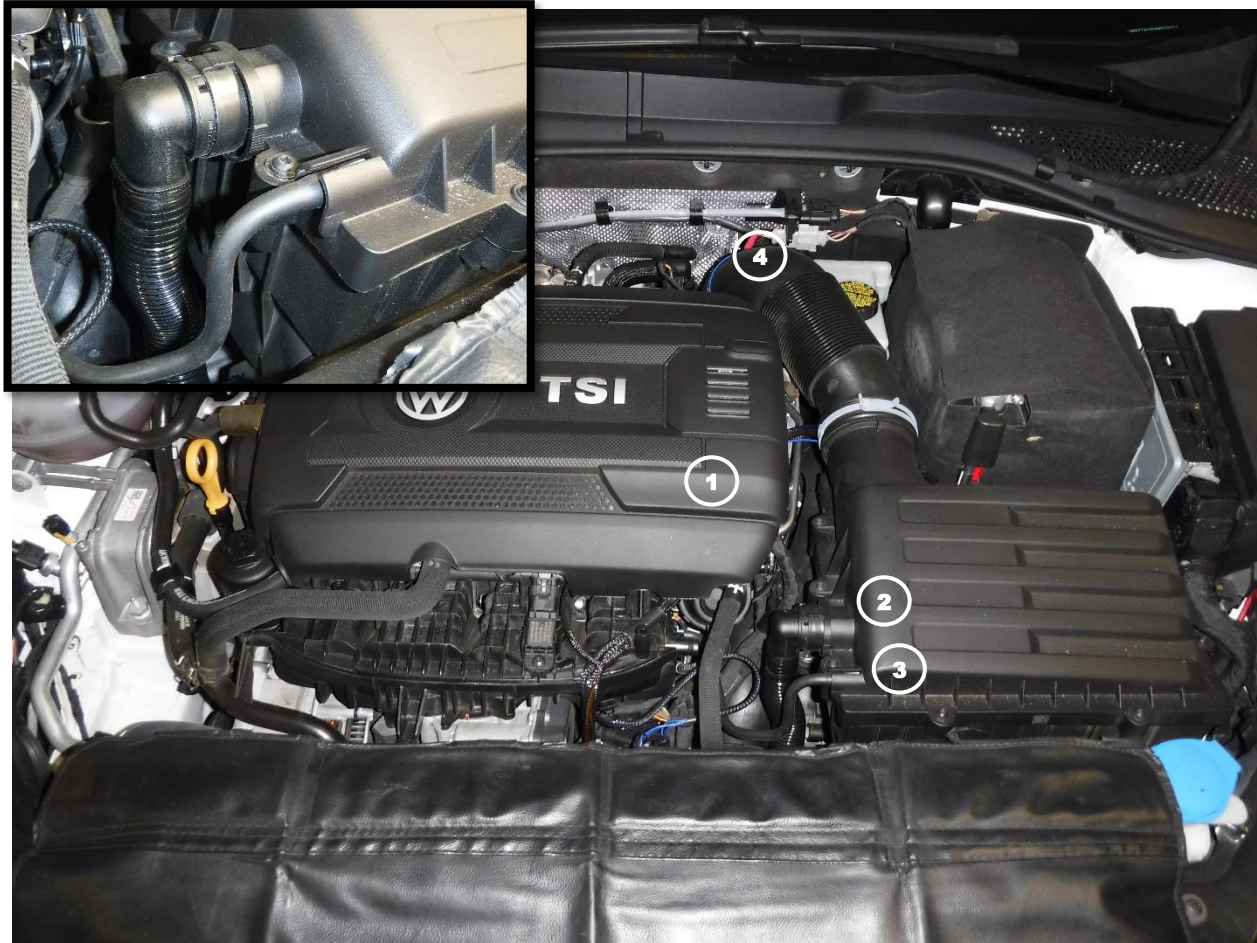

1. Park vehicle on level ground and engage the parking brake.
2. Disconnect the negative battery cable.
3. Remove the engine cover ① by lifting straight up on it from all four (4) corners.
4. Disconnect the blow off valve recirculation hose ② by squeezing on the raised sides at the same time and pull it off of the air intake box.
5. Disconnect the vacuum hose ③ from the air intake box
6. Loosen the clamp securing the air intake tube onto the turbo inlet tube ④
7. Remove the intake tube and box from the vehicle together by lifting the air box straight up out of its mounting grommets.

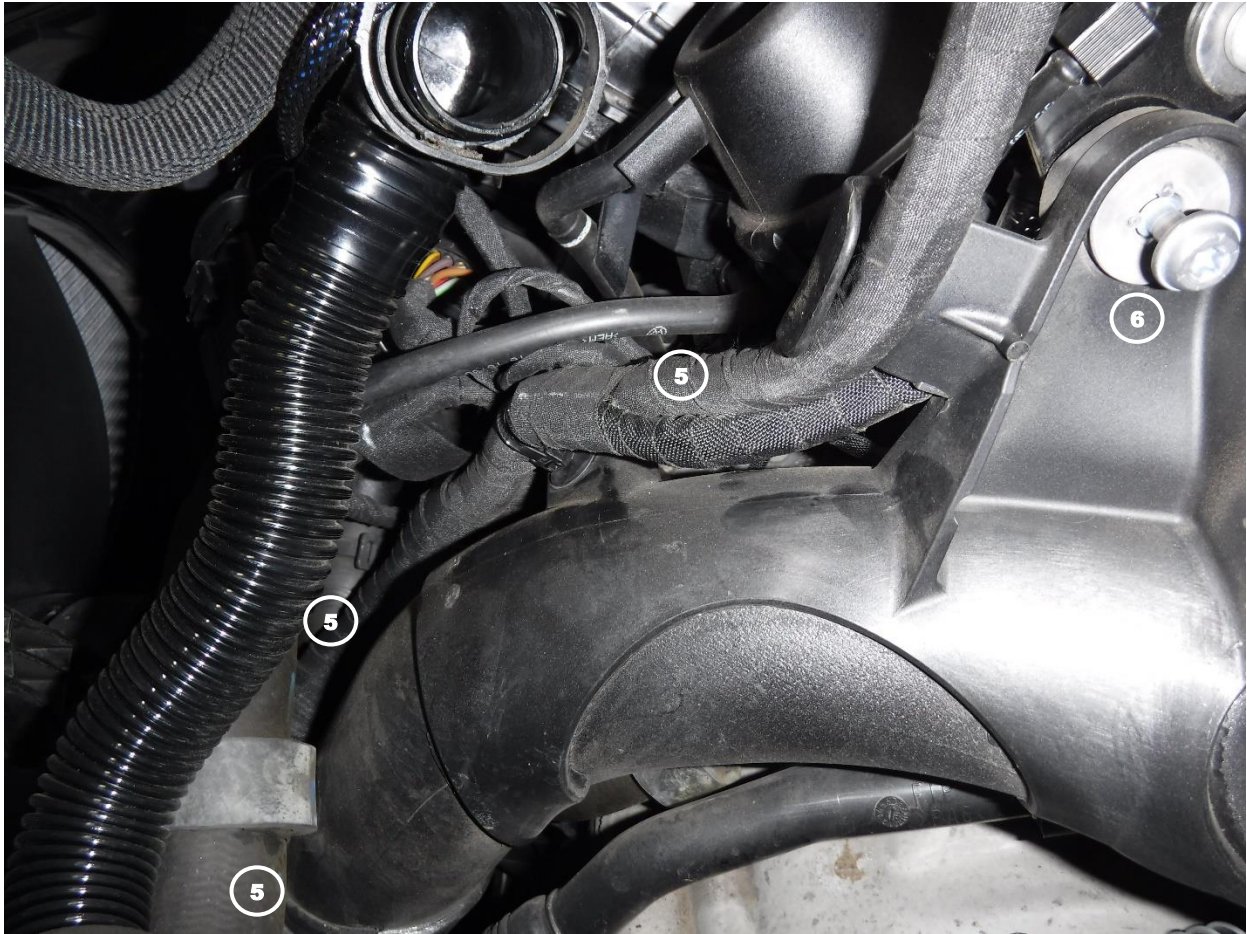

8. Unclip three (3) clips securing the wire harness to the factory hot side intercooler tube (5).
9. Remove the screw securing the hot side intercooler tube onto the engine (6).



10. Loosen the two (2) clamps securing the hot side intercooler tube onto the turbo outlet (7).

11. Remove the coupling (8) from the vehicle.

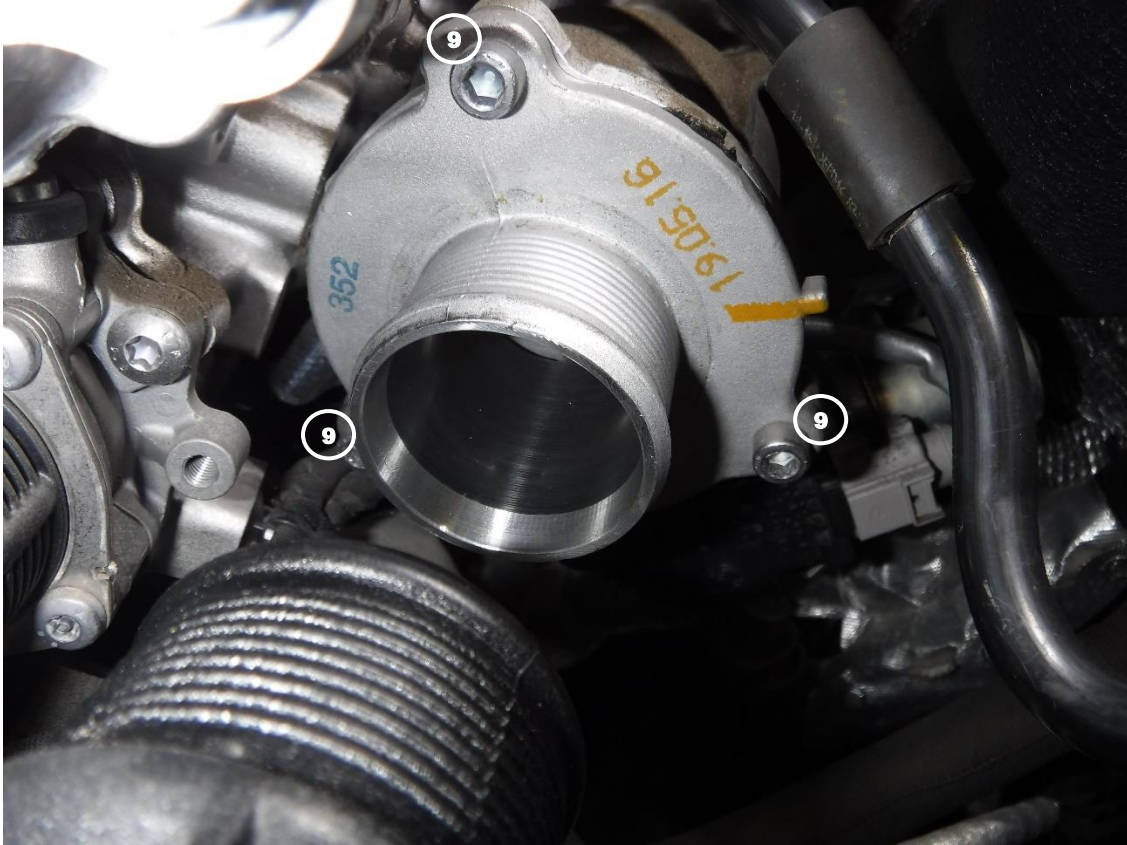

Note: Be sure not to misplace the O-ring on the back side of the turbo muffler

12. Remove the three (3) screws securing the turbo muffler onto the turbo ⑨
13. Remove the turbo muffler from the vehicle.

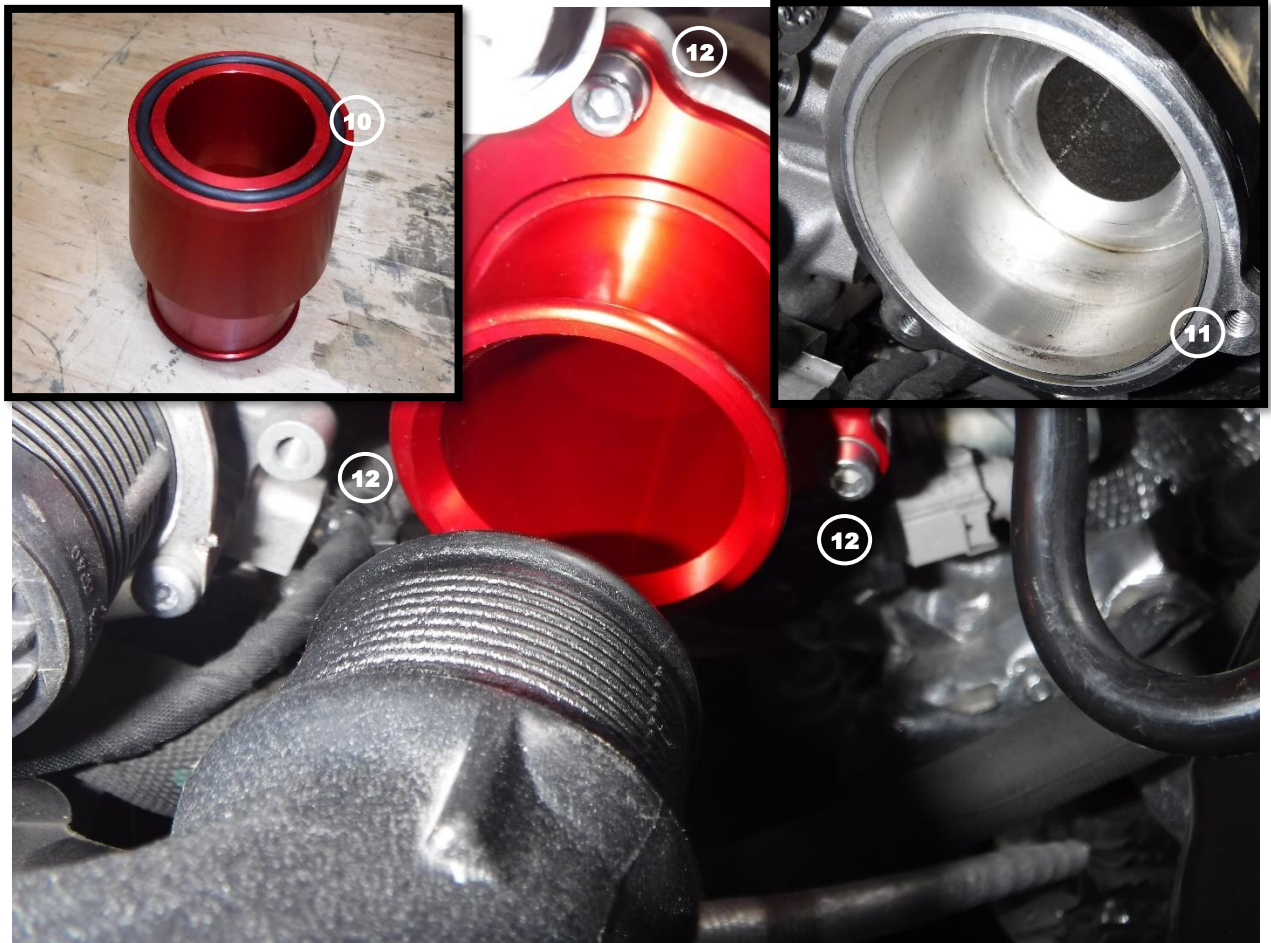

Note: Be sure to lubricate the O-ring with grease prior to installation.

14. Install the supplied -226 O-ring (10) into the groove on the back side of aFe turbo outlet adapter.
15. Ensure the factory O-ring is in its proper location on the turbo outlet (11).
16. Install the aFe turbo flange over the aFe turbo adapter and carefully maneuver the assembly into the turbo outlet and secure it to the turbo using the three (3) supplied M6x1x20 screws and washers (12).

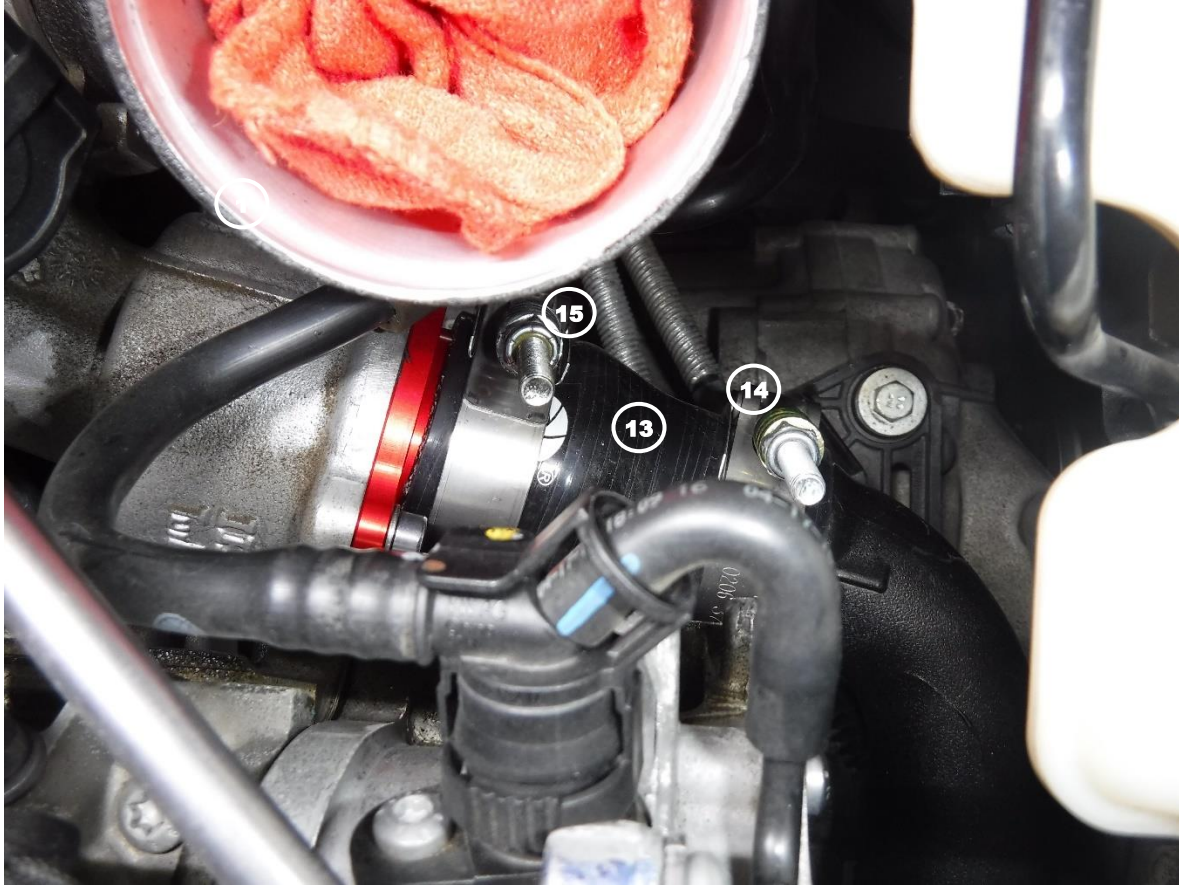

17. Install the aFe silicone 2.50" X 1.875" X 15 Deg coupling (13) and the 2.06" spring-loaded t-bolt clamp (14) onto the end of the factory hot side tube, do not tighten the clamp yet.
18. Install the coupling from the previous step onto the turbo outlet along with the supplied 2.50" spring-loaded t-bolt clamp (15) do not tighten the clamp yet.
19. Ensure the factory hot side intercooler tube is not touching any metal surfaces.
20. Secure factory hot side intercooler tube to the engine using the factory hardware from step 9.
21. Tighten all of the clamps.



22. Reinstall the air intake tube and air box (16) into the vehicle.
23. Secure the air intake tube onto the turbo inlet tube (17)
24. Reconnect the vacuum hose (18) onto the air intake box
25. Reconnect the blow off valve recirculation hose (19) onto the air intake box.
26. Reinstall the engine cover (20) onto the vehicle.
27. Reconnect the negative battery cable.
28. Install is now complete.

Note: Be sure to check all connections after 50-100 miles.

[View other performance air intake systems made by aFe on our website.](#)