



## Air Filter Installation Instructions- GMC Sierra/ Chevrolet Silverado 2500HD/ 3500HD V8-6.6L LLY/LBZ (TD)

<b>Part #</b>	10-10101 71-10101 Pro-GUARD 7	<b>Tools Required:</b>	<b>Parts List:</b>
<b>Make:</b>	GMC	Phillips Screwdriver	1 Air Filter (P/N: #10-10101) or Pro-GUARD 7 (P/N: #71-10101)
<b>Model</b>	<b>Year</b> <b>Engine</b>		
Sierra 2500HD	'06      V8-6.6L		
Sierra 3500HD	'06      V8-6.6L		
<b>Make:</b>	Chevrolet		
<b>Model</b>	<b>Year</b> <b>Engine</b>		
Silverado 2500HD	'06      V8-6.6L		
Silverado 3500HD	'06      V8-6.6L		



**Step 1**  
Loosen the phillips screw on the air box and remove the cover to access the air filter.

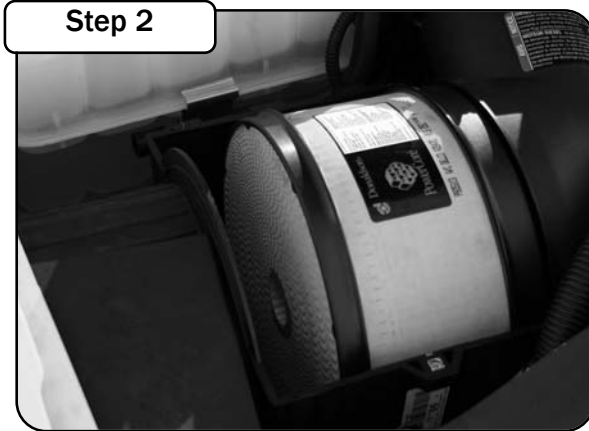

**Step 2**  
Remove air box cover. Remove air filter from air box.

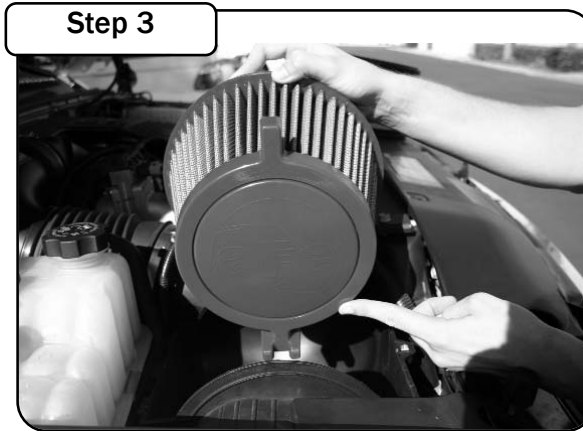

**Step 3**  
Notice the difference between the posts on the filter. The post with the two prongs is pointed down and should be inserted into the air box first. Tilt and slide down.

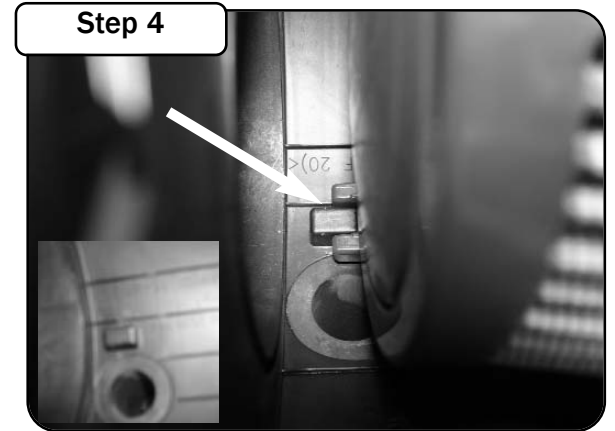

**Step 4**  
Notice the square tab at the bottom of the airbox. The pronged post should capture this as shown.

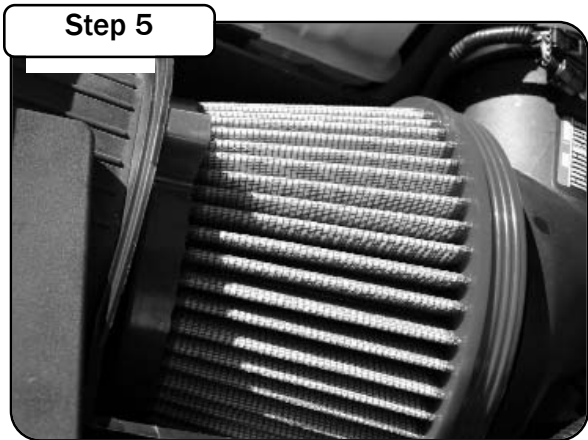

**Step 5**  
It will be necessary to tilt the filter to align the pronged post with the air box tab and then angle the filter into the OE air box.

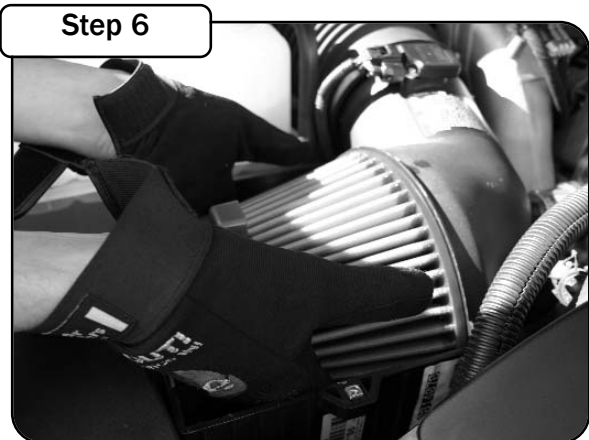

**Step 6**  
Carefully apply pressure to the filter to ensure a tight seal.

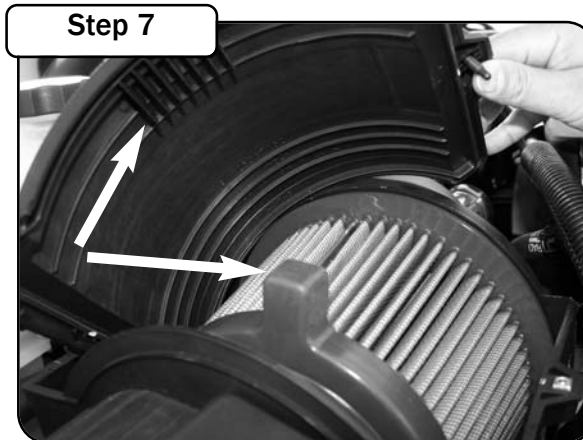

**Step 7**  
Close the air box with the lid and screw the lid down. If the bottom post is properly aligned, the top post and the fins on the lid should also align. If not, check that the bottom prongs still correctly capture the tab at the bottom of the air box.

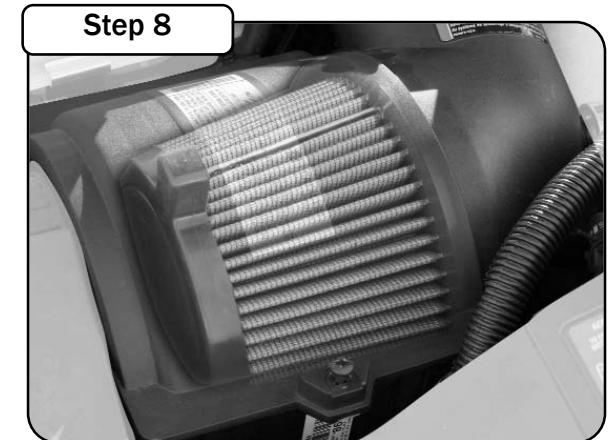

**Step 8**  
Screw the air filter cover down. Verify the air box cover closes correctly. Your installation is now complete.

Note: Filter Cleaning and Re-oiling: When cleaning your aFe filter, be sure to use only aFe's "Restore Kit" aFe P/N: 90-50000 gold oil aerosol, or aFe P/N: 90-50500 gold squeeze bottle oil