

Assembly Instructions

SOCKETLESS® Hose Assembly

SOCKETLESS® Hose Assembly



Eaton's AQP *SOCKETLESS* Performance Hose and Fittings are extremely easy to work with. Connecting the two is a snap since not even a wrench is needed! Simply slip the hose onto the fittings. It's that simple.

Applications: Gasoline, fuel and lubricating oils, air and water.

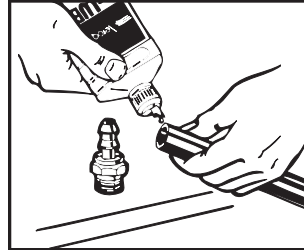

Step 1. Cut hose to required length with a sharp knife. Oil inside of hose and outside of nipple liberally.

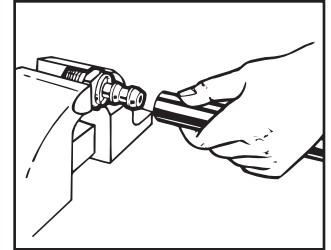

Step 2. Push hose on fitting until hose end bottoms underneath protective cap as shown. Clean, proof test to twice operating pressure and inspect all assemblies.

¹Never use a hose clamp with FBV *SOCKETLESS*.™

SOCKETLESS
Black Anodized
Aluminum



SOCKETLESS
Steel Swivel

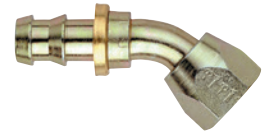

SOCKETLESS
Red/Blue Anodized
Aluminum

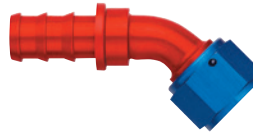

SOCKETLESS
Brass



SOCKETLESS
Nickel-Plated
Aluminum

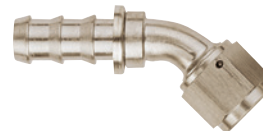

Important: It is recommended that all hose assemblies be proof pressure checked at twice the operating pressure using a proof test stand such as the Eaton's Aeroquip Performance Products FT1058 stand.