



Equipped with AEM® *Dryflow™* Filter
No Oil Required!

INSTALLATION INSTRUCTIONS

PART NUMBER: 22-680C (Gun Metal Grey Finish)

2007	Toyota	Tundra	V8-5.7L	C.A.R.B. E.O # D-670-20
2008	Toyota	Tundra	V8-5.7L	C.A.R.B. E.O # D-670-20
2009	Toyota	Tundra	V8-5.7L	C.A.R.B. E.O # D-670-20
2010	Toyota	Tundra	V8-5.7L	C.A.R.B. E.O # D-670-20
2011	Toyota	Tundra	V8-5.7L	C.A.R.B. E.O # D-670-20
2012	Toyota	Tundra	V8-5.7L	C.A.R.B. E.O # D-670-20
2013	Toyota	Tundra	V8-5.7L	C.A.R.B. E.O # D-670-20

ITEM NO.	PART NUMBER	DESCRIPTION	QTY.
1	5-1080	TUNDRA AIR ACCELERATOR	1
2	AEM-1228560	MOUNT, RUBBER 1" X 8MM	1
3	08160	WASHER; 1"D X 1/4 HOLE FENDER	1
4	AEM-444.460.08	NUT; M8 HEX SERRATED	1
5	N/A	LOWER AIRBOX	NOT PROVIDED
6	AEM-28-20387	AEM OE REPLACEMENT FILTER	1
7	N/A	UPPER AIRBOX	NOT PROVIDED
8	2-1433C	INTAKE TUBE; TOYTOA TUNDRA 5.7L	1
9	08760	HOSE; 3-3/4" ID X 2-1/4" L	1
10	9452	1/2" BNDHOSE CLAMP,2.90"-3.75"	1
11	08657	HOSE; HUMP;3.25 ID- 3.5 ID; BLK	1
12	9456	1/2" BNDHOSE CLAMP,3.15"-4.00"	3
13	08411	HOSE CLAMP #10 MINI	1
14	AEM-5-7022	HOSE; 5/8"ID X 22"L	1

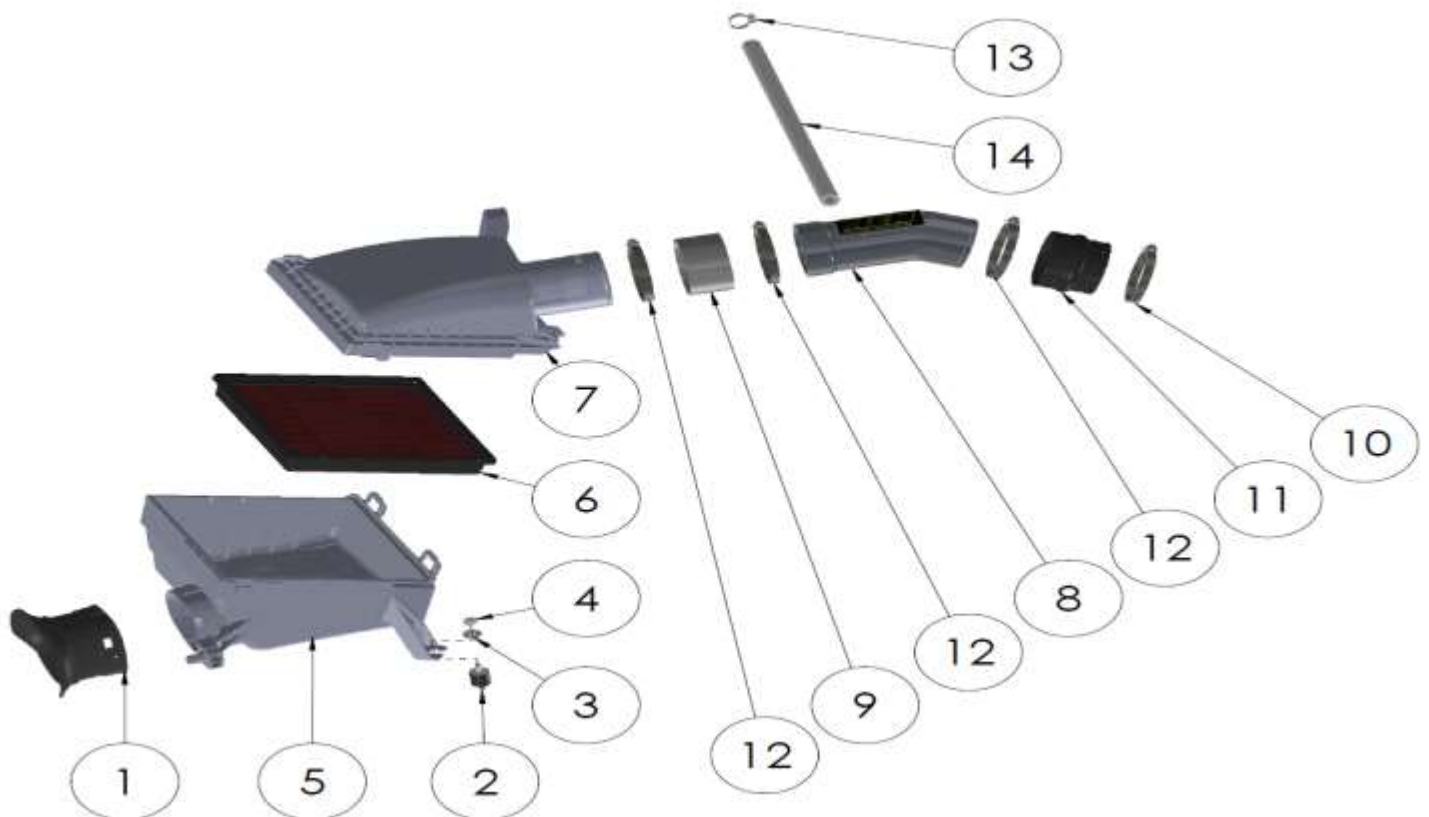

Read and understand these instructions **BEFORE** attempting to install this product. Failure to follow installation instructions and not using the provided hardware may damage the intake tube, throttle body and engine.

1. Preparing Vehicle

- a. Make sure vehicle is parked on level surface.
- b. Set the parking brake.
- c. If engine has run in the past two hours, let it cool down.
- d. Disconnect negative battery terminal.
- e. Do not discard stock components after removal of the factory system.
- f. Open the air intake kit package and make sure all parts are included.

Tools Needed:

Screwdriver

Ratchet

Extension

10MM Socket

2. Removal of stock system



a. Remove the engine cover by pulling up and out.



b. Loosen the hose clamp at the throttle body and the air box. Disconnect the small vacuum line on the intake resonator and the large vacuum line at the "T" above the intake manifold.



c. Remove the stock intake tube. **Note:** Do not discard your stock equipment.



d. Disconnect the mass air flow sensor connector and the retaining clip from the air box.



e. Loosen and remove the M6 bolts securing the air box to the vehicle. **Note:** One of the bolts is on the backside of the air box (not shown). One of the bolts will be re-used.



f. Remove the complete air box.



g. Disconnect the stock air inlet from the air box.



h. Unlatch the 4 clips holding the upper air box to the lower air box and remove the stock filter.

3. Installation of AEM® intake system.

- a. When installing the intake system, do not completely tighten the hose clamps or mounting hardware until instructed to do so.



a. Install the AEM air accelerator onto the air box by aligning the slot in the box and the air horn.



b. Install the provided (1228560) mount into the body of the vehicle where the M6 bolt was removed in 2e.



c. Install the lower air box into the vehicle by squeezing the air accelerator and inserting it into the fender opening in the vehicle. **Note:** it 's easier to have the air box lid and base separated to perform this step.

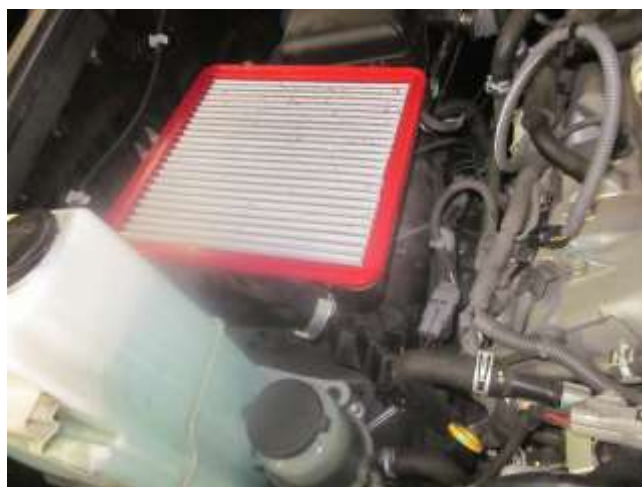

d. Install the AEM filter into the lower air box and install the upper air box lid. Once the upper and lower air box are securing the air filter, latch the four clips that were unlatched in 2h.



e. Slide the provided hose (5-1086) with the hose clamps (9456) onto the air box. Slide the provided hump hose (08657) with the hose clamps (9456 & 9452) over the throttle body.



f. Lift the air box slightly and slide the AEM intake into the throttle body hose, then the air box hose while lowering the air box over the mount installed in 3b. Tighten all four hose clamps at this point.



g. Re-clip the mass air flow sensor harness to the sensor. Re-attach the small vacuum line back onto the AEM intake tube. Install the provided hose (5-7022) onto the AEM intake tube.



h. Route the hose (5-7022) as shown and install on the "T" fitting and tighten provided hose clamp (08411).



i. Make sure air box is sitting on the previously installed mount and install the washer (559960) and nut (444.460.04) and tighten. Also re-install and tighten the backside bolt that was removed in step 2e.



Factory air box system installed



AEM® intake system installed

4. Reassemble Vehicle

- a. Position the inlet pipes for the best fitment. Be sure that the pipes or any other components do not contact any part of the vehicle.
- b. Check for proper hood clearance. Re-adjust pipes if necessary and re-tighten them.
- c. Inspect the engine bay for any loose tools and check that all fasteners that were moved or removed are properly tightened.
- d. Reconnect negative battery terminal and start engine. Let the vehicle idle for 3 minutes. Perform a final inspection before driving the vehicle.

5. CARB Sticker Placement

- a. The C.A.R.B. exemption sticker, (attached), must be visible under the hood so that an emissions inspector can see it when the vehicle is required to be tested for emissions. California requires testing every two years, other states may vary.

6. Service and Maintenance

- a. AEM Induction Systems requires cleaning the intake system's air filter element every 100,000 miles. When used in dusty or off-road environments, our filters will require cleaning more often. We recommend that you visually inspect your filter once every 25,000 miles to determine if the screen is still visible. When the screen is no longer visible some place on the filter element, it is time to clean it. To clean, purchase our Synthetic air filter cleaner, part number 99-0624 and follow the easy instructions.
- b. Use window cleaner to clean your powder coated AEM[®] intake tube.

NOTE: DO NOT USE aluminum polish on powder coated AEM[®] intake tubes.